

Volume 02

PRODUCT BROCHURE



FORZATM



 DIFFERENT. **BY DESIGN.**TM



SCAN ME



EXPERIENCE

FORZA

Ciao, America. Radical Italian design, plus a rebellious spirit and a distinct feeling of originality. This is Forza. An exceptional new suite of high-performance cooking appliances that give cooks not only confidence, but equal parts pride and excitement to stretch their culinary boundaries. Cooks who appreciate a true Italian cooking experience with style and flair will be prepared to make culinary magic morning, noon and night. Take a minute to explore these remarkably designed products, their oh-so-Italian lines and unexpected colors. This is a brave new world of kitchenalia, born and bred with a decidedly Italian accent. Buon appetito.



HERITAGE

Located in the heart of Emilia, Forza proudly carries on the culinary excellence, artistic tradition, passion for the land, spirit of innovation and craftsmanship of Italian design.



VALUES

Authenticity, Quality, and Pragmatism constantly guide Forza's quest to create reliable, high-performing products that are aesthetically pleasing, functional and ergonomic.



EXPERIENCE

Forza is powered by Glem Gas and backed by more than 60 years of experience in the design and manufacturing of luxury home appliances at an international level.

RADICAL ITALIAN DESIGN

Who We Are We're a determined group of people zealously committed to combining the best of design, aesthetics and styling to bring exquisitely manufactured cooking appliances to America's kitchens. We're dedicated to the proposition that dramatically sculpted lines, inspired colors, superb technology and engineering will enhance every culinary experience.

What We Believe It's our mission to design and craft high-performance products that rouse the senses. Because the world deserves appliances that are as striking and original as the chefs who cook with them.

Our Territory Forza appliances are designed and made in Modena, Italy—the very heart of the famed Emilia-Romagna region where even mere pasta is an elevated art form. This is the land where legendary brands like Ferrari and Maserati took their first muscular breaths—where form always meets function to create perfection.



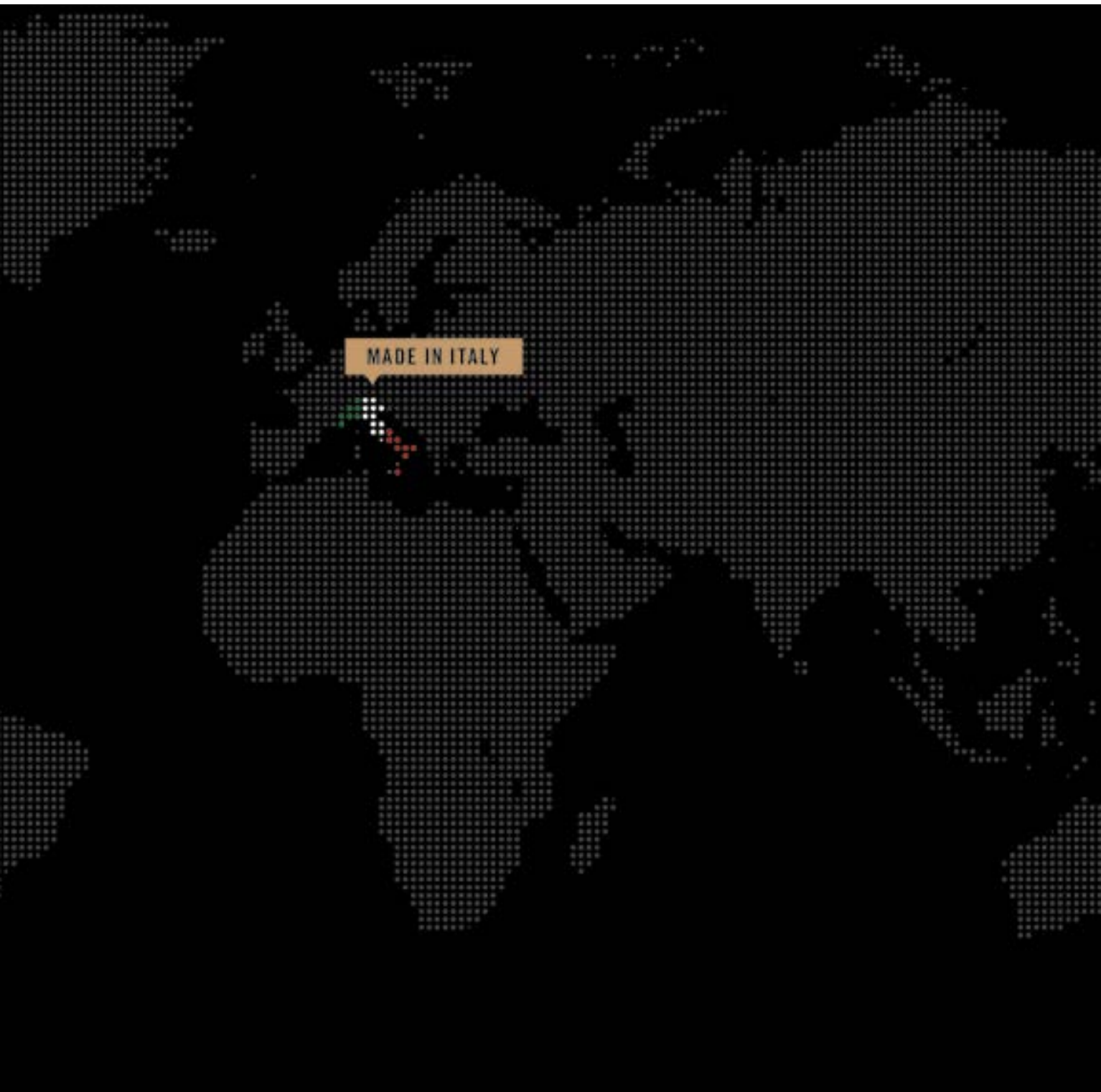





PROFESSIONAL ITALIAN RANGES



The heart of the kitchen has been, and always will be, the source of fire. Whether four burners or six burners, these handsomely designed Forza ranges continue that tradition in a distinctively modern way.

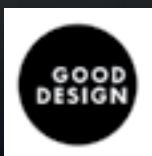



INFINITO™ GRATE SYSTEM

Radically designed with edge-to-edge cast iron grates and integrated bullnose, only Forza offers the largest continuous usable cooking surface.

DUAL-FLAME BRASS BURNERS

From simmer to sear, Forza's high power dual-flame full brass burners provide the precise heat control necessary to create masterful meals.

MASSIMOBLO™ DOUBLE BROILER

Forza's 18,000 BTU double broiler outperforms traditional infrared broilers with its powerful BLUE flame – spanning the widest oven cavity on the market and evenly distributing heat for consistent, top chef results.

INDUSTRY'S WIDEST OVEN CAVITY

With up to 6 cubic feet of usable oven space, Forza ranges have the capability to fit commercial size cooking trays.

UNIQUELY SHAPED WINDOW

Introducing the only range to feature a uniquely shaped oven window with dramatically sculpted lines and an edgy aesthetic.

PROFESSIONAL RANGE FEATURES

Forza's distinct and proprietary features make creating masterful meals an elegant experience. From intense blue flames to an infinity-style cooktop, you've never seen pro-style cooking like this.





SOFT CLOSE DOOR

The oven door closes gently to protect your exquisite soufflé and give you peace-of-mind while you're racing around the kitchen.



INFINITO™ GRATE SYSTEM

Radically designed with edge-to-edge cast iron grates and integrated bullnose, only Forza offers the largest continuous usable cooking surface for max efficiency while in the kitchen.

BLACK PORCELAIN SPILL TRAY

A luxurious touch for the range top that emphasizes the brass burners and makes cleanup simple.

EXTERIOR RANGE FEATURES

The heart of the kitchen has been, and always will be, the source of fire. Whether four burners or six burners, these handsomely designed Forza ranges continue that tradition in a distinctively modern way.



UNIQUELY SHAPED OVEN WINDOW

Introducing the only range to feature a uniquely shaped oven window with dramatically sculpted lines and an edgy aesthetic.

FULL GLASS INNER DOOR

The uniquely shaped, full inner glass window is designed to be removed by hand for easy cleaning.



COOKTOP PERFORMANCE



HIGH POWER DUAL-FLAME BURNERS

From simmer to sear, Forza's high power dual-flame full brass burners provide the precise heat control.





With the high-powered burners including four dual-flame burners that range from 685 BTU to 20,000 BTU and four from 2,200 to 12,000 BTU burners, this range gives you the precise heat control necessary to create masterful meals.

- + Front Burners: 20,000 BTU Full Brass Dual Burners with a 685 BTU Simmer Function
- + Rear Burners: 12,000 BTU Full Brass Burners
- + All burners are equipped with a thermocouple safety device, the maximum safety in any conditions
- + One-hand ignition (spark) for the best reliability in any conditions across the time

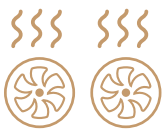

DUAL FAN

The dual fan was designed to give you maximum convection and heat distribution while cooking, baking and heating your dishes.



Exclusive

OVEN FEATURES

New

MASSIMOBLU™ HYPER DOUBLE BROILER 48" RANGE

Spanning a total width of 38 inches, the blue flame of the 18,000 BTU Hyper Double Broiler outperforms traditional infrared broilers evenly distributing heat to give you consistent, top chef results.



MASSIMOBLU™ DOUBLE BROILER 30" and 36" RANGES

Forza's 18,000 BTU double broiler outperforms traditional infrared broilers with its powerful BLUE flame—spanning the widest oven cavity on the market and evenly distributing heat for consistent, top chef results.



INDUSTRY'S WIDEST OVEN CAVITY

With up to 6 cubic feet of usable oven space, Forza ranges have the capability to fit commercial size cooking trays— perfect for your next dinner soirée.

New

WORLD'S FIRST 48" SINGLE OVEN CAVITY

Boasting a 7.8 cu. ft. oven capacity, the extraordinary oven spans a jaw-dropping 40" wide and can fit two turkeys, or a full goat, lamb or pig with ease. The oven can fit multiple commercial cooking trays on a single rack giving your home kitchen the output of a five star restaurant.

MAXI ROTISSERIE 48" RANGE

The 33" rotisserie rod and high-powered motor can hold the largest of meats with a 50 lb. capacity and brings outdoor BBQ technology direct to your kitchen.





COOKING VERSATILITY

The oven is equipped with 6 rack levels and includes 1 telescopic glide rack, 1 extra-large stainless steel tray and 2 wire shelves giving you the flexibility to customize the oven to your cooking needs.

BAKE BURNER

The 19,000 BTU bake burner gives you control to bake delicate breads and pastries and the power to roast your next holiday feast.

COLOR OPTION DOOR KITS

Match your desired kitchen aesthetic with Forza's colored door kits that are available in 6 colors and include all necessary parts for a seamless install.





RANGE COLOR OPTIONS



Cold line

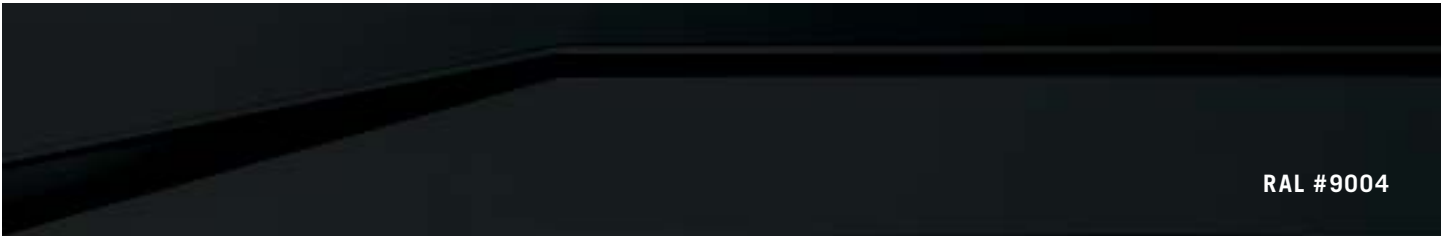
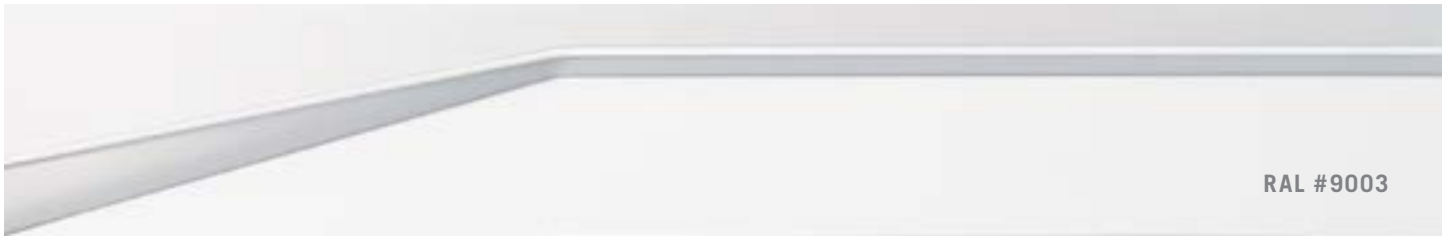



VALOROSO
white

AUDACE
black

DINAMICO
blue

RIBELLE
yellow



ARDEnte
orange



RADICALE
red



RANGE COLOR OPTIONS

Warm line



RAL #1023



RAL #2008



RAL #3001

Model N°

FR488GN



48" PROFESSIONAL RANGE *New*

4 x 12K BTU Single Burners, 4 x 20K BTU Dual-Flame Burners, 685 BTU Simmer Function, 7.8 ft.³ Oven Cavity, Dual Fans for Maximum Heat Distribution, Double Halogen Lamps, 6 Rack Levels, Full Inner Glass Door.

Professional Gas Range Features

- + Infinito™ Grate System with Integrated Bullnose
- + Dual-Flame Full Brass Burners
- + Easy-to-Clean Black Porcelain Spill Tray
- + Soft Close Door
- + MassimoBlu™ Hyper Double Broiler
- + Uniquely Shaped Window
- + 1 Commercial Tray 18" x 26" + 1 Commercial Tray 13" x 18" Compatible Oven Cavity
- + Full Width Enameled Tray

*Model N°***FR366GN***Model N°***FR304GN**

36" PROFESSIONAL RANGE

3 x 12K BTU Single Burners, 3 x 20K BTU Dual-Flame Burners, 685 BTU Simmer Function, 6.0 ft.³ Oven Cavity, Dual Fans for Maximum Heat Distribution, Double Halogen Lamps, 6 Rack Levels, Full Inner Glass Door.

30" PROFESSIONAL RANGE

2 x 12K BTU Single Burners, 2 x 20K BTU Dual-Flame Burners, 685 BTU Simmer Function, 5.2 ft.³ Oven Cavity, Dual Fans for Maximum Heat Distribution, Double Halogen Lamps, 6 Rack Levels, Full Inner Glass Door.

Professional Gas Range Features

- + Infinito™ Grate System with Integrated Bullnose
- + Dual-Flame Full Brass Burners
- + Easy-to-Clean Black Porcelain Spill Tray
- + Soft Closing Door
- + MassimoBlu™ Double Broiler
- + Uniquely Shaped Window
- + 18" x 26" Commercial Tray Compatible Oven Cavity
- + Full Width Enameled Tray

RANGE ACCESSORIES



Model N°

FAGP

DOUBLE-SIDED CAST IRON GRIDDLE + GRILL PLATE

From pancakes to steak and eggs, Forza's Double-Sided Griddle + Grill Plate provides cast iron cooking perfect for your next sunrise spread.



Model N°

FAPZS

PIZZA STONE

Share a taste of Italy with perfectly baked pizza using Forza's Pizza Stone—your friends and family will love it.



Model N°

FAIT36 / FAIT30

“FASTBACK” PORCELAIN TRIM KIT

Customize your range's backsplash with Forza's sleek “Fastback” Porcelain Trim Kit. The Forza accessory that allows your range to sit flush with your island countertop for a seamless aesthetic.



Model N°

FASCP

SLOW COOKING PLATE

Whether you're melting chocolate or preparing a day long stew, Forza's Slow Cooking Plate allows you to maintain a low and consistent temperature from start to finish.



Model N°

FARGC2 / FARGC2

GRATES COVER *New*

Whether you're cooking pasta sauce or frying tempura, Forza's broil-griddle cover allows you to maintain clean unused cooking zones. In addition, the broil-griddle cover is dishwasher safe for easy cleaning.



Model N°

FA36GRT1 / FA30GRT1

TELESCOPIC GLIDE RACK

Forza's fully extendable Telescopic Glide Rack slides effortlessly, making it ideal when roasting heavy items, using baking stones or accessing cookie sheets.



Model N°

FAWR

WOK ADAPTER

From stir-fry to deep-fry, Forza's Wok Adapter helps to stabilize your wok on the cooktop so you can safely prepare delicious meals with high heat.

THE NEW WALL OVENS

Embracing radical Italian design and powerful performance, the Forza 30-inch Built-in Wall Ovens bring cooking perfection to the heart of the home.

UNIQUELY SHAPED WINDOW

Proprietary window shape featuring dramaticall sculpted lines and radical design aesthetic. The full inner glass door provides a seamless look and easy to clean surface.

DIGITAL DISPLAY

Digital display is easy to read and displays time and functions for a simple and enjoyable cooking experience.

MULTIPLE COOKING MODES

Convection bake allows for even heat distribution as the internal fan continuously circulates the oven's heat evenly within the oven cavity. Convection roast mode surrounds the meat with heat on all sides, similar to a rotisserie. The classic pizza function reaches elevated temperatures (590 °F) allowing you to cook pizzas as you would in a wood oven. Fantastico!

SELF-CLEANING FUNCTION

Self-clean mode uses high temperatures to burn off spills and other messes, so all it needs is a quick wipe at the end of the cycle.



**SINGLE
OVEN**

**DOUBLE
OVEN**

+

WARMING DRAWER

Engineered to preserve food temperature and quality without compromising flavor or consistency.



MULTIPLE COOKING MODES

Convection bake allows for even heat distribution as the internal fan continuously circulates the oven's heat evenly within the oven cavity.

Convection roast mode surrounds the meat with heat on all sides, similar to a rotisserie - sealing in the juices quickly for moist and tender results.

The classic pizza function reaches elevated temperatures (590 °F) allowing you to cook pizzas as you would in a wood oven – evenly and in just two minutes. Fantastico!



RADICAL ITALIAN DESIGN

On the exterior, the wall oven features dramatic clean lines, a uniquely shaped oven window to view your culinary masterpiece, and a clear digital display for precise electronic control.

Exterior **stainless steel** and glass finish offers a professional look and easy to clean surface.





TELESCOPIC RACKS

Telescopic racks use ball bearing rack guides for an effortless glide in and out of the oven. This premium feature allows the rack to extend fully without tipping over for smooth, easy handling of even the heaviest dishes, and adjusts to fit different rack support levels.



SELF-CLEANING FUNCTION

Self-clean mode uses high temperatures to burn off spills and other messes, so all it needs is a quick wipe at the end of the cycle.



Exclusive

OVEN FEATURES

In the interior, the wall oven boasts premium features such as an impressive 4.1 cu. ft. of cooking capacity.

The **dual fan** was designed to give you maximum convection and heat distribution while cooking, baking and heating your dishes.



WARMING DRAWER

Serve each dish at its proper temperature with Forza's 30-inch warming drawer. Engineered to preserve food temperature and quality without compromising flavor or consistency. This stunningly designed 30-inch warming drawer makes it more convenient than ever to keep freshly cooked meals flawlessly heated. What's more, the sleek lines of the drawer front adds a refreshingly clean and simple design element to your kitchen. Different. By Design.™

VARIABLE TEMPERATURE RANGE

Variable degree control provides temperature settings from 86 to 194 degrees.











*Model N°***FODP30S**

30" DOUBLE DUAL CONVECTION ELECTRIC WALL OVEN

Dual fan with True Euro Convection and self cleaning, Digital display with electronic knob controls, 16 Cooking Modes, Pyrolitic Self-Clean with automatic door latch, 6 Rack levels, Meat Probe (upper oven only).

*Model N°***FOSP30S**

30" SINGLE DUAL CONVECTION ELECTRIC WALL OVEN

Dual fan with True Euro Convection and self cleaning, Digital display with electronic knob controls, 16 Cooking Modes, Pyrolitic Self-Clean with automatic door latch, 6 Rack levels, Meat Probe.

*Model N°***FWD30S**

30" PROFESSIONAL WARMING DRAWER

Temperature Range 86°F - 194°F / 30°C - 90°C, Volume 2,1 cbft (61.4 lt), Soft Close Drawer.



RANGE TOP



The Forza Professional Range Top is radically designed with profound tradition and modern sophistication. Dramatically sculpted lines, superb technology and engineering that enhancing every cooking experience. This product is engineered with four high-powered burners including two dual-flame burners that range from 685 BTU to 20,000 BTU and two from 2,200 to 12,000 BTU burners.



RANGE TOP DESIGN



INFINITO™ GRATE SYSTEM

Radically designed with edge-to-edge cast iron grates and integrated bullnose, only Forza offers the largest continuous usable cooking surface for maximum efficiency.

BLACK PORCELAIN SPILL TRAY

A dramatic aesthetic for the range top that emphasizes the brass burners and the porcelain is a practical feature that makes cleanup simple.







With the high-powered burners including four or six dual-flame burners that range from 685 BTU to 20,000 BTU and four or six from 2,200 to 12,000 BTU burners, this range gives you the precise heat control necessary to create masterful meals.

- + Front Burners: 20,000 BTU Full Brass Dual Burners with a 685 BTU Simmer Function
- + Rear Burners: 12,000 BTU Full Brass Burners
- + All burners are equipped with a thermocouple safety device, the maximum safety in any conditions
- + One-hand ignition (spark) for the best reliability in any conditions across the time

COOKTOP PERFORMANCE



HIGH POWER DUAL-FLAME BURNERS

From simmer to sear, Forza's high power dual-flame full brass burners provide the precise heat control.







Model N°

FRT366GN

Model N°

FRT304GN



36" PROFESSIONAL RANGE TOP

3 x 12K BTU Single Burners, 3 x 20K BTU Dual-Flame Burners, 685 BTU Simmer Function.

30" PROFESSIONAL RANGE TOP

2 x 12K BTU Single Burners, 2 x 20K BTU Dual-Flame Burners, 685 BTU Simmer Function.

Available as a standard configuration

"FASTBACK" PORCELAIN TRIM

The low profile of the Fastback Porcelain Trim increases the continuous usable cooking surface for maximum efficiency and allows for a seamless integration into your kitchen island.



ACCESSORIES

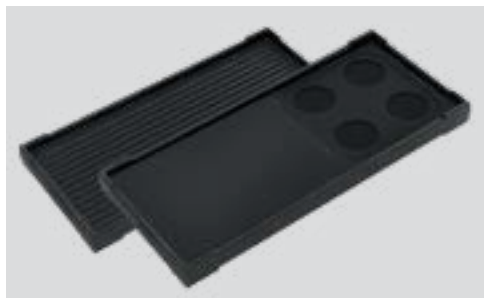

Model N°

FAGP

DOUBLE-SIDED CAST IRON GRIDDLE + GRILL PLATE

From pancakes to steak and eggs, Forza's Double-Sided Griddle + Grill Plate provides cast iron cooking perfect for your next sunrise spread.



Model N°

FARGC2 / FARGC2

GRATES COVER *New*

Whether you're cooking pasta sauce or frying tempura, Forza's broil-griddle cover allows you to maintain clean unused cooking zones. In addition, the broil-griddle cover is dishwasher safe for easy cleaning.



Model N°

FAWR

WOK ADAPTER

From stir-fry to deep-fry, Forza's Wok Adapter helps to stabilize your wok on the cooktop so you can safely prepare delicious meals with high heat.



Model N°

FASCP

SLOW COOKING PLATE

Whether you're melting chocolate or preparing a day long stew, Forza's Slow Cooking Plate allows you to maintain a low and consistent temperature from start to finish.



VENTILATION HOODS



Forza hoods are designed to enhance your kitchen design without compromising performance. With Featuring a powerful suction, professional hoods offer four speed levels that easily remove heat and odors found in any busy kitchen. The LED lights and illuminated electronic button controls let you shift through the various functions and the timer keeps you focused on what's important, your masterful meals.

HOODS

FEATURES



1200 CFM

MAXIMUM SUCTION



4

SPEED LEVEL



LED

LIGHTS



BAFFLE

FILTERS





3 DIFFERENT

WIDTHS

30"

36"

48"





3 DIFFERENT HEIGHTS



DYNAMIC LINES

Forza's Professional Wall Mounted Range Hood in Stainless Steel is radically designed with dynamic lines and a contemporary aesthetic.

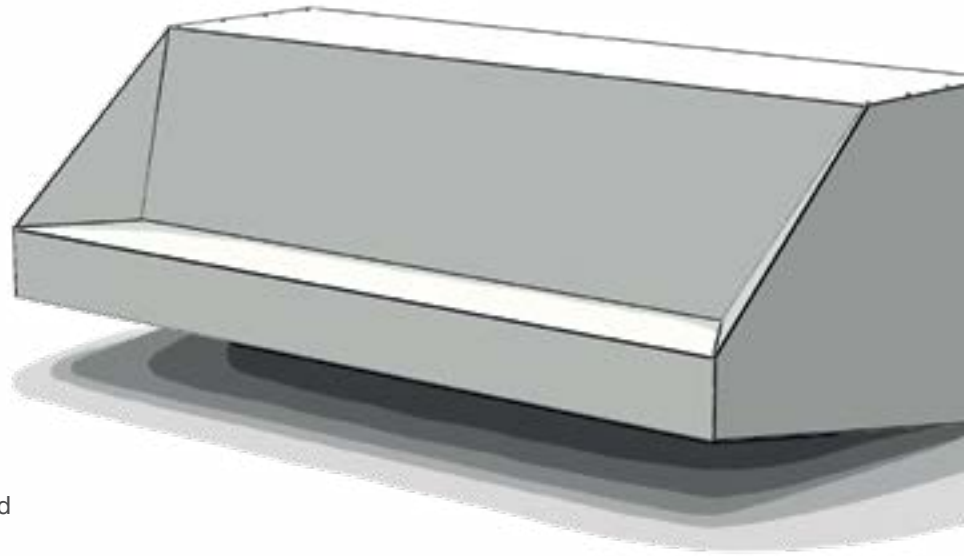

Model N°

FH4818 / FH4824



48" PROFESSIONAL WALL MOUNT HOODS

- 18" and 24" Height Options Available
- 4 x Stainless Steel Baffle Filters
- Illuminated electronic Button controls
- 2 x LED Lights
- 3 speed level + booster
- Timer function
- 600-1200 CFM Suction Power
- Air Outlet from Top

HOODS ACCESSORIES

Baffle Filter Pro Kit

FABPK2 / FABPK3 / FABPK4



Easily cleaned by hand or in the dishwasher

Model N°

FH3611 / FH3618 / FH3624



Model N°

FH3011 / FH3018



36" PROFESSIONAL WALL MOUNT HOODS

- 11", 18" and 24" Height Options Available
- 3 x Stainless Steel Baffle Filters
- Illuminated electronic Button controls
- 2 x LED Lights
- 3 speed level + booster
- Timer function
- 600-1200 CFM Suction Power
- Air Outlet from Top or Back

30" PROFESSIONAL WALL MOUNT HOODS

- 11" and 18" Height Options Available
- 2 x Stainless Steel Baffle Filters
- Illuminated electronic Button controls
- 2 LED Lights
- 3 speed level + booster
- Timer function
- 400-600 CFM Suction Power
- Air Outlet from Top or Back



Recirculating Flue Kit

FARK3011 / FARK3018 / FARK36



DISH WASHER

Even the most successful of dinner parties requires a little clean up. And with a Forza dishwasher on your side, all those baked-on sauces and sautéed morsels will have met their match.



DRYING

Double drying system grants you best and consistent result on every cycle.

THREE RACK SYSTEM

Three baskets with collapsible plate racks.

24"
DIMENSION

16
SETTINGS

45 DBA
NOISE LEVEL



Model N°

FD24DI



PROFESSIONAL 24" DISHWASHER

Stainless steel panel installed with FORZA matching handle

16 Place Settings

3 Flexible and adjustable racks + silverware basket

Quiet washing 45 dB(A)

6 Washing Programs

Extra Vortex washing cleans heavy soiled Pots and Pans

Internal light

Durable Stainless Steel

Double Drying (Heating Dry & Fan Dry)

Up to 24 hours delay start options

Low energy consumption (240KWH/Year)

Air exchange every 6 hours

Touch controls with LED display



Complementary Accessory

FADPH

FORZA DISHWASHER PANEL

Forza's stainless steel dishwasher panel with matching range handle can be applied to most brands' dishwashers, easily creating a sleek and cohesive look in your kitchen.









COLORS OF THE YEAR

Ultimate
GRAY

Illuminating
YELLOW

PRODUCT OVERVIEW

PROFESSIONAL RANGES



FR488GN

48" PRO-STYLE GAS RANGE

(4) 20K BTU Single Burners, (4) 12K BTU Dual-Flame Burners, 685 BTU Simmer Function, 7.8 ft.³ Oven Cavity, Dual Fans for Maximum Heat Distribution, Double Halogen Lamps, 6 Rack levels



FR366GN

36" PRO-STYLE GAS RANGE

(3) 12K BTU Single Burners, (3) 20K BTU Dual-Flame Burners, 685 BTU Simmer Function, 6.0 ft.³ Oven Cavity, Dual Fans for Maximum Heat Distribution, Double Halogen Lamps, 6 Rack Levels



FR304GN

30" PRO-STYLE GAS RANGE

(2) 12K BTU Single Burners, (2) 20K BTU Dual-Flame Burners, 685 BTU Simmer Function, 5.2 ft.³ Oven Cavity, Dual Fans for Maximum Heat Distribution, Double Halogen Lamps, 6 Rack Levels

RANGE ACCESSORIES

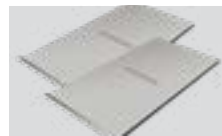

Grates cover (2 or 3 pcs)
FARGC2
FARGC3

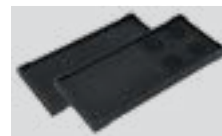

Double-Sided Cast Iron Griddle + Grill Plate
FAGP



Pizza Stone
FAPZS



Telescopic Glide Rack Kit
FA36GRT1
FA30GRT1



"Fastback" Porcelain Trim Kit
FAIT36 / FAIT30



Wok Adapter
FAWR



Slow Cooking Plate
FASCP

COLOR RANGE KIT



FA30DKW9003



FA36DKW9003



FA48DKW9003



FA30DKB9004



FA36DKB9004



FA48DKB9004



FA30DKB5005



FA36DKB5005



FA48DKB5005

30" 36" 48"



FA30DKY1023



FA36DKY1023



FA48DKY1023



FA30DKO2008



FA36DKO2008



FA48DKO2008



FA30DKR3001



FA36DKR3001



FA48DKR3001

RAL #9003

RAL #9004

RAL #5005

Kit Composition:

- + Colored Door
- + Handle
- + Colored Bottom Panel
- + Packaging Parts



RAL #1023

RAL #2008

RAL #3001

PRODUCT OVERVIEW

WALL OVEN



FODP30S

30" DOUBLE DUAL CONVECTION ELECTRIC WALL OVEN

Dual fan with True Euro Convection and self cleaning, Digital display with electronic knob controls, 16 Cooking Modes, Pyrolytic Self-Clean with automatic door latch, 6 Rack levels, Meat Probe (upper oven only).



FOSP30S

30" SINGLE DUAL CONVECTION ELECTRIC WALL OVEN

Dual fan with True Euro Convection and self cleaning, Digital display with electronic knob controls, 16 Cooking Modes, Pyrolytic Self-Clean with automatic door latch, 6 Rack levels, Meat Probe

WARMING DRAWER



FWD30S

30" PROFESSIONAL WARMING DRAWER

Compatible with FOSP30S and FODP30S ovens, Temperature Range 86°F - 194°F / 30°C - 90°C, Volume 2,1 cbft (61.4 lt), Soft Close Door,.

RANGE TOP



FRT366GN

36" PROFESSIONAL RANGE TOP

(3) 12K BTU Single Burners, (3) 20K BTU Dual-Flame Burners, 685 BTU Simmer Function

RANGE TOP



FRT304GN

30" PROFESSIONAL RANGE TOP

(2) 12K BTU Single Burners, (2) 20K BTU Dual-Flame Burners, 685 BTU Simmer Function

RANGE ACCESSORIES

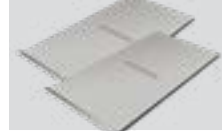

Grates cover (2 or 3 pcs)
FARGC2
FARGC3



Double-Sided Cast Iron Griddle + Grill Plate
FAGP



"Fastback" Porcelain Trim Kit
FAIT36 / FAIT30



Wok Adapter
FAWR



Slow Cooking Plate
FASCP

DISHWASHER



FD24DI

PROFESSIONAL 24" DISHWASHER

16 Place Settings, 3 Flexible and adjustable racks + silverware basket, Quiet washing 45 dB(A), 6 Washing Programs, Extra Vortex washing cleans heavy soiled Pots and Pans, Internal light, Durable Stainless Steel, Double Drying (Heating Dry & Fan Dry), Up to 24 hours delay start options, Low energy consumption (240KWH/Year), Air exchange every 6 hours, Touch controls with LED display

COMPLEMENTARY ACCESSORY



FADPH

Dishwasher Panel with Matching Forza Range Handle

Forza's stainless steel dishwasher panel with matching range handle can be applied to most brands' dishwashers, easily creating a sleek and cohesive look in your kitchen.

PRODUCT OVERVIEW

VENTILATION HOODS



FH4818



FH4824



FH3611



FH3618



FH3624

48" PROFESSIONAL WALL MOUNT HOODS

18" and 24" Height Options Available, (4) SS Baffle Filters, Square Push Buttons (White Retroluminated), (2) 2W LED Lights, 600-1200 CFM Suction Power, Air Outlet from Top or Back

36" PROFESSIONAL WALL MOUNT HOODS

11", 18" and 24" Height Options Available, (3) SS Baffle Filters, Square Push Buttons (White Retroluminated), (2) 2W LED Lights, 600-1200 CFM Suction Power, Air Outlet from Top or Back



FH3011



FH3018

30" PROFESSIONAL WALL MOUNT HOODS

11" and 18" Height Options Available, 2 x SS Baffle Filters, Square Push Buttons (White Retroluminated), (2) 2W LED Lights, 400-600 CFM Suction Power, Air Outlet from Top or Back



Recirculating Flue Kit
FARK3011 / FARK3018 / FARK36



Baffle Filter Pro Kit
FABPK2 / FABPK3 / FABPK4

FORZA

RANGE SPECIFICATIONS











MAIN FEATURES	48" (FR366GN)	36" (FR366GN)	30" (FR304GN)
Dimension	48" x 27"	36" x 27"	30" x 27"
Color	Stainless Steel	Stainless Steel	Stainless Steel
Oven type	Convection gas oven with double fan + MassimoBlu™ Hyper Double Broiler	Convection gas oven with double fan + MassimoBlu™ Double Broiler	Convection gas oven with double fan + MassimoBlu™ Double Broiler
Cook-top	8 burners	6 burners	4 burners

COOK-TOP			
Number of gas burners/ zone - material	8 full brass burners	6 full brass burners	4 full brass burners
Front burners	4 x 20,000 / 685 BTU	3 x 20,000 / 685 BTU	2 x 20,000 / 685 BTU
Rear burners	4 x 12,000 / 2,200 BTU	3 x 12,000 / 2,200 BTU	2 x 12,000 / 2,200 BTU

SAFETY & IGNITION			
Cooktop safety valves	Thermocouple safety system	Thermocouple safety system	Thermocouple safety system
Cooktop ignition	One hand ignition	One hand ignition	One hand ignition
Safety & Electronic ignition on cavity burners	by hot surface ignition & gas valve system	by hot surface ignition & gas valve system	by hot surface ignition & gas valve system
Reignition cavity burners	Yes	Yes	Yes
Dual control	on 4 front dual flame burners	on 3 front dual flame burners	on 2 front dual flame burners
Simmering power	685 BTU on front burners	685 BTU on front burners	685 BTU on front burners

COOKING ZONE			
Cast iron pan supports	Continuous Infinito™ Grate System with integrated bull nose	Continuous Infinito™ Grate System with integrated bull nose	Continuous Infinito™ Grate System with integrated bull nose

OVEN FUNCTIONS			
Bake			
Broil			
Convection Bake			

OVEN CAVITY			
Finishing	FORZA Gray Porcelain (Easy Clean)	FORZA Gray Porcelain (Easy Clean)	FORZA Gray Porcelain (Easy Clean)
Rack positions/levels	6	6	6

OVEN DOOR			
Type	Full inner glass door	Full inner glass door	Full inner glass door
Number of glass	Triple heat resistant glass	Triple heat resistant glass	Triple heat resistant glass
Oven light	2 lateral halogen lamps	2 lateral halogen lamps	2 lateral halogen lamps
Wire shelf	2	2	2
Enamelled tray	1 - Infinito™ broiler pan - full cavity width	1 - Infinito™ broiler pan - full cavity width	1 - Infinito™ broiler pan - full cavity width
Trivet (rack for broiling on tray)	Yes	Yes	Yes
Splash back/backguard	4" backguard	4" backguard	4" backguard
Telescopic glides	1 set movable on different levels	1 set movable on different levels	1 set movable on different levels
Removable inner glass	Yes	Yes	Yes
Hinge closing system	Soft closing	Soft closing	Soft closing



TECHNICAL FEATURES

Oven overall capacity	7.80 ft. ³	6.00 ft. ³	5.20 ft. ³
Bake burner	19,000 BTU	19,000 BTU	19,000 BTU
Massimo Blu™ Double Broiler	Hyper - 18,000 BTU	18,000 BTU	18,000 BTU
Voltage/frequency	120V / 60Hz	120V / 60Hz	120V / 60Hz

CABLE SPECS

Power W/Amps	600W / 5A	600W / 5A	200W / 5A
Plug type	120V 3 prong (Nema 5-15P)	120V 3 prong (Nema 5-15P)	120V 3 prong (Nema 5-15P)
Cable	59 1/16"	59 1/16"	59 1/16"

DIMENSIONS

H x W x D	39 39/64" - 41 1/16" x 47 7/8" x 30 1/2"	39 39/64" - 41 1/16" x 35 7/8" x 30 1/2"	39 39/64" - 41 1/16" x 29 7/8" x 30 1/2"
H x W x D including packaging	44" 3/8 x 54" 9/64 x 34" 21/32	43 37/64" x 32 9/32" x 39 49/64"	43 37/64" x 32 9/32" x 39 49/64"

GAS TYPE

Gas setting	NG (4")	NG (4")	NG (4")
Conversion kit	LP (11")	LP (11")	LP (11")



TECHNICAL DRAWING

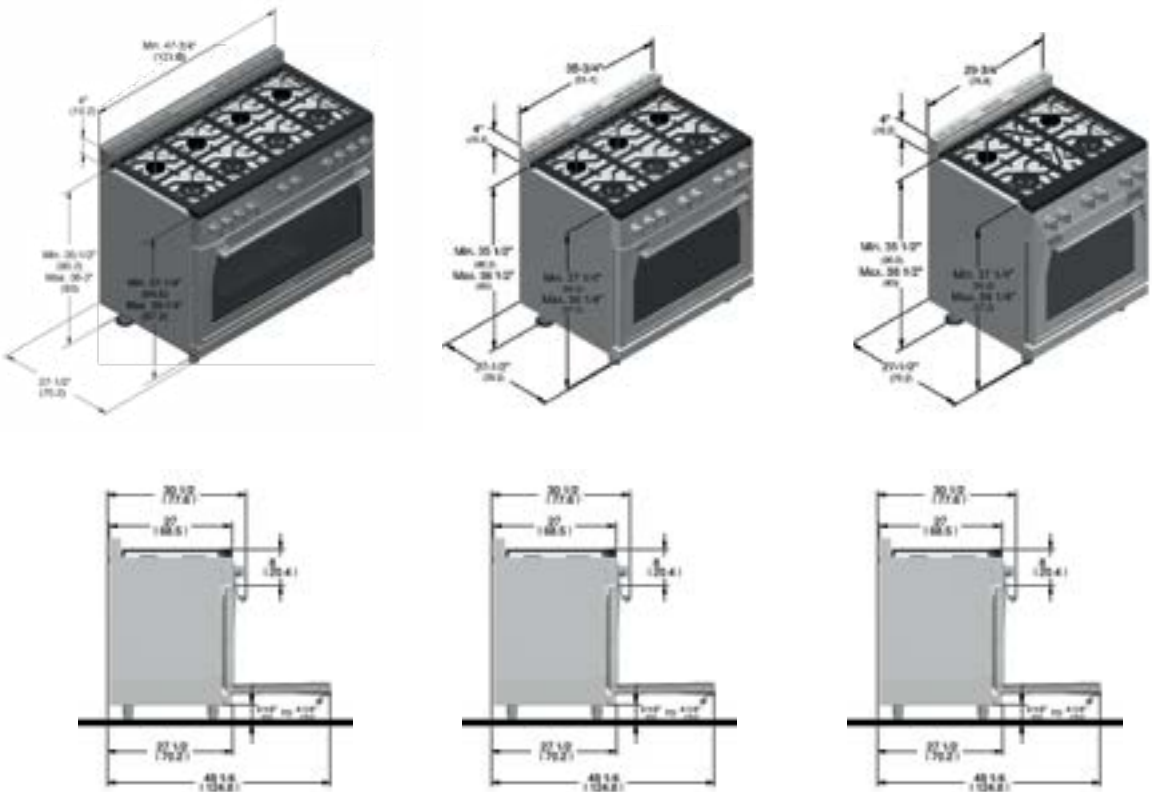

WALL OVENS SPECIFICATIONS



MAIN FEATURES		FODP30S	FOSP30S
Type		Dual fan with True Euro Convection and self cleaning	Dual fan with True Euro Convection and self cleaning
Dimensions (inches)		30"	30"
Color		Stainless Steel	Stainless Steel
CONTROLS			
User interface		5,7" TFT display with electronic control	5,7" TFT display with electronic control
Commands		4 Knobs	2 Knobs
Suction power (free delivery)		6 (IT, GB, EN-US, FR, DE, ES)	6 (IT, GB, EN-US, FR, DE, ES)
OVEN FUNCTIONS			
Thaw (defrost)			
Dehydrate			
Proofing (Warm)			
Keep warm (warm plus)			
Bake			
Roast			
True European Convection Bake (Multi level)			
Pizza			
Convection Roast			
Convection Bake			
Convection Grill			
Convection Broil			
Broil levels			
Classic pizza function 650°F			
Sabbath mode			
Self clean			
OVEN CAVITY (S)			
Gross Capacity (cuft)		4.4 per cavity	4.4
Usable Capacity (cuft)		4.1 per cavity	4.1
Cavity Enamel Colour		Black	Black
Rack levels		6 per cavity	6
Oven lights		3x20W Halogen per cavity	3x20W Halogen
Broil Upper Heating Element		3500 W (230/240V) per cavity	3500 W (230/240V)
Upper Auxiliary Element Wattage		1032 W (230/240V) per cavity	1032 W (230/240V)
Concealed Bake Lower Heating Element		3000 W (230/240V) per cavity	3000 W (230/240V)
Convection Element Wattage		2x1300 W (230/240V) per cavity	2x1300 W (230/240V)
OVEN DOOR(S)			
Door Glass		4 Pane Heat Resistant Glass	4 Pane Heat Resistant Glass
Door Hinges		Soft closing system	Soft closing system
OVEN ACCESSORIES			
Chromed racks		2 per cavity	2
Enameled Grill set (basin + anti splash)		1 per cavity	1
Telescopic chromed rack		1 per cavity	1
Meat probe		Upper oven only	•



POWER / RATINGS (208/240 V, 60 HZ)

KW/Amps rating at 240V, 60Hz	7.50kW - 31.2A	3.70kW - 15.4A
KW/Amps rating at 208V, 60Hz	6.30kW - 30.3A	3.50kW - 16.8A
Cable + Conduit	•	•

DIMENSIONS

H x W x D	51" x 29 7/8" x 29 31/32"	27 7/8" x 29 7/8" x 29 31/32"
H x W x D including packaging	33 15/32" x 33 15/32" x 55 33/64"	33 15/32" x 33 15/32" x 32 43/64"

TECHNICAL DRAWING

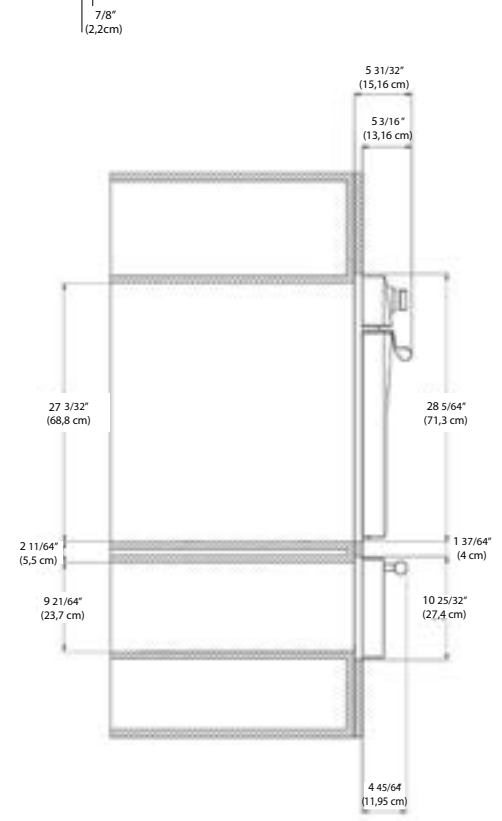
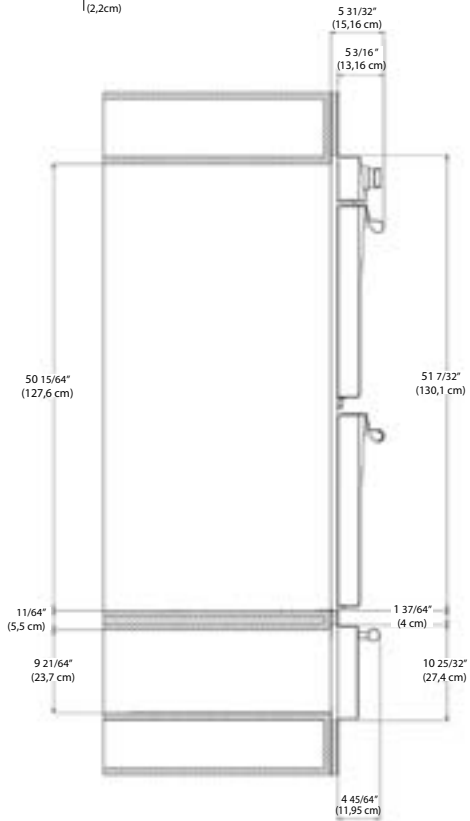
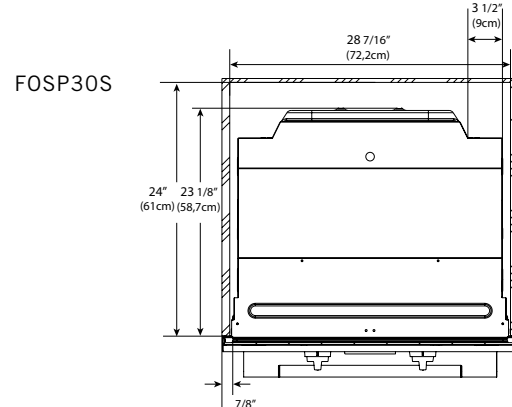
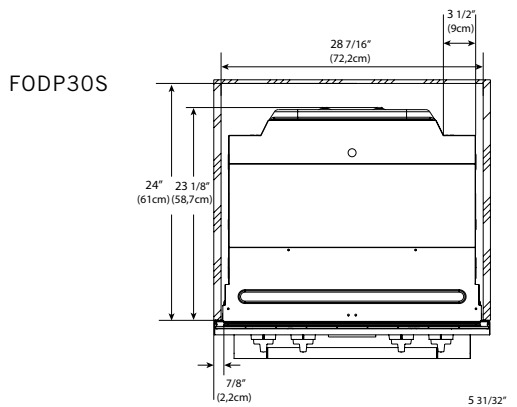

CUTOUT OVENS

FODP30S

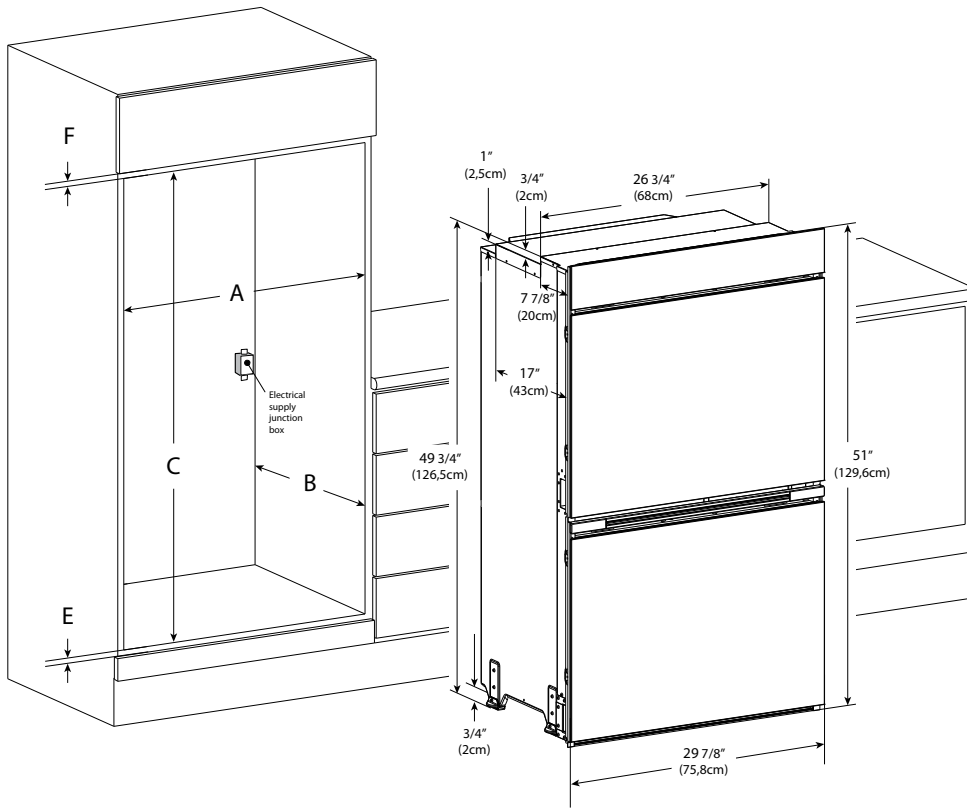

Ltr.	CUTOUT DIMENSION	inch	cm
A	Cutout Width	28 7/16"	72,2cm
B	Cutout Depth	24"	61cm
C	Cutout Height	50"	127cm
D	Floor Bottom of Cutout	NA	NA
E	Minimum Spacing	1/2"	1,3cm
F	Minimum Spacing	1 1/4"	3,2cm

PACKAGING		lb / inch	Kg / mm
GROSS WEIGHT		337 lb	153 Kg
DIMENSION	W	33 1/2"	850
	D	31 1/8"	790
	H	54 1/2"	1385

FOSP30S

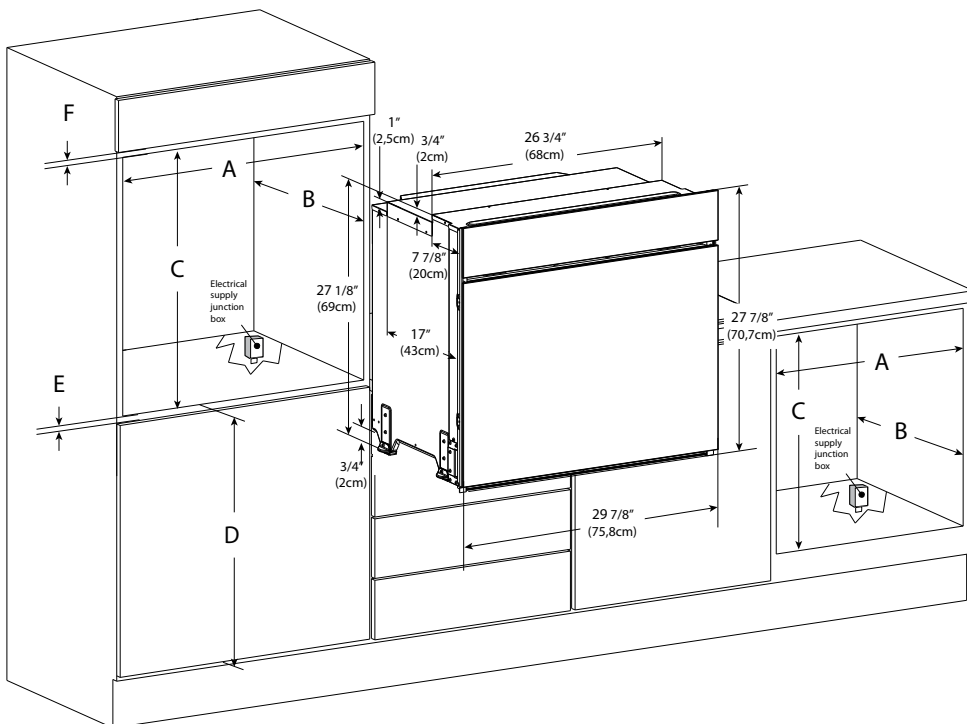

Ltr.	CUTOUT DIMENSION	inch	cm
A	Cutout Width	28 7/16"	72,2cm
B	Cutout Depth	24"	61cm
C	Cutout Height	27 3/8"	69,5cm
D	Floor Bottom of Cutout	34"	86,5cm
E	Minimum Spacing	1/2"	1,3cm
F	Minimum Spacing	3/4"	1,9cm

PACKAGING		lb / inch	Kg / mm
GROSS WEIGHT		187 lb	85 Kg
DIMENSION	W	33 1/2"	850
	D	31 1/8"	790
	H	31 1/8"	790

WARMING DRAWER SPECIFICATIONS



MAIN FEATURES		FWD30S
Type	Professional Warming drawer	
Dimensions (inches)	30"	
Color	Stainless Steel	
Compatible	with FOSP30S and FODP30S wall ovens	
CONTROL		
Temperature range	86°F - 194°F / 30°C - 90°C	
Fan assisted	•	
Function Indicator / Thermostat on/off	•	
PERFORMANCE		
Maximum temperature	194°F / 90°C	
Cooking at low temperature (slow cooking)	•	
Leavening	•	
Heating dishes and food	•	
Slow close assistance	•	
Open / Close push - pull system	-	
ELECTRICAL SPECIFICATIONS		
Max power absorbed (W)	1100 W	
Power (V/Hz)	120/60	
Power cord	59"	
Plug	NEMA 5 -15P	
CAPACITY		
Volume	2,1 cbft (61.4 lt)	
DIMENSIONS		
H x W x D	10 3/8" x 29 7/8" x 23 3/4"	
H x W x D including packaging	30 23/32" x 32 43/64" x 13 25/64"	

TECHNICAL DRAWING

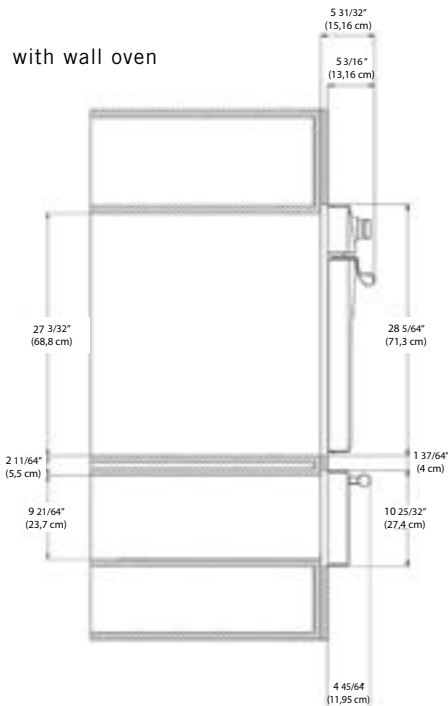
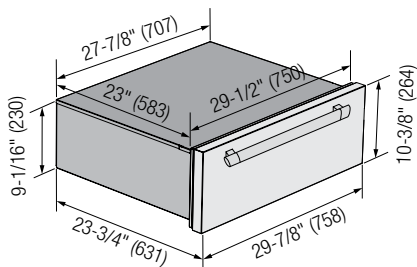

RANGE TOP SPECIFICATIONS



MAIN FEATURES		36" (FRT366GN)	30" (FRT304GN)
Dimension		36" x 27"	30" x 27"
Color		Stainless Steel	Stainless Steel
Cook-top		6 burners	4 burners
COOK-TOP			
Number of gas burners/zone - material		6 full brass burners	4 full brass burners
Front burners		3 x 20,000 / 685 BTU	2 x 20,000 / 685 BTU
Rear burners		3 x 12,000 / 2,200 BTU	2 x 12,000 / 2,200 BTU
SAFETY & IGNITION			
Cooktop safety valves		Thermocouple safety system	Thermocouple safety system
Cooktop ignition		One hand ignition	One hand ignition
Dual control		on 3 front dual flame burners	on 2 front dual flame burners
Simmering power		685 BTU on front burners	685 BTU on front burners
COOKING ZONE			
Cast iron pan supports		Continuous Infinito™ Grate System with integrated bull nose	Continuous Infinito™ Grate System with integrated bull nose
DIMENSIONS			
H x W x D		8" x 35 3/4" x 29 1/2"	8" x 29 3/4" x 29 1/2"
H x W x D including packaging		39 11/16" x 32 23/32" x 18 15/64"	33 31/32" x 32 23/32" x 18 15/64"

TECHNICAL DRAWING

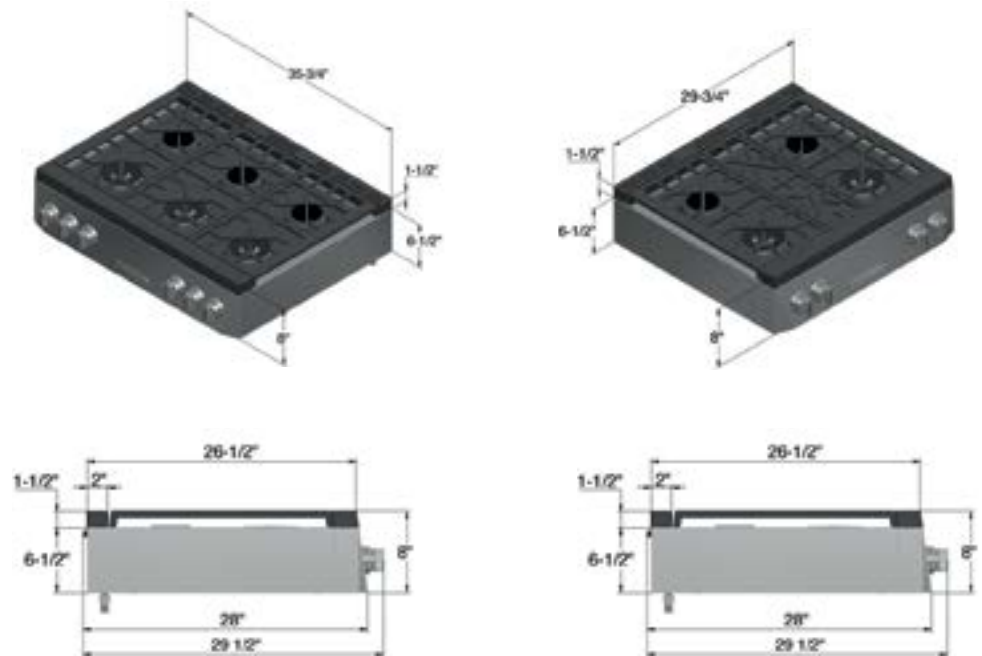

VENTILATION HOODS SPECIFICATIONS



MAIN FEATURES	FH4818	FH4824
Type	Professional Wall Mount Hoods	Professional Wall Mount Hoods
Dimensions (inches)	W 48" H 18" D 24"	W 48" H 24" D 24"
Color	Stainless Steel	Stainless Steel
FEATURES		
Aspiration system	Ducted out	Ducted out
Suction power	600 cfm	2 x 600 cfm
Suction power (free delivery)	1000 m3/h	2 x 1000 m3/h
Number of blowers / code type	1 - T7	2 - T7
Speeds	3 + booster	3 + booster
Booster	Yes	Yes
Lighting	2 x 2W LED	2 x 2W LED
Grease filters	3 x SS Baffle filters	3 x SS Baffle filters
Controls	Square push buttons (white retroluminated)	Square push buttons (white retroluminated)
Air outlet size	Ø150 mm - 6" (top or back exit available)	Ø250 mm - 10" (top exit only)
Plug	Yes - 3 prong	Yes - 3 prong
Cable length	59 1/16"	59 1/16"
Maximum power	354W	704W
Motor power	350W	2 x 350W
Voltage/frequency	120V / 60Hz	120V / 60Hz
DIMENSIONS		
Product dimensions	W 30" H 18" D 24"	W 36" H 24" D 24"

TECHNICAL DRAWING

FH4818

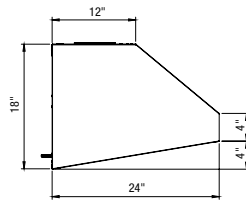

FH4824

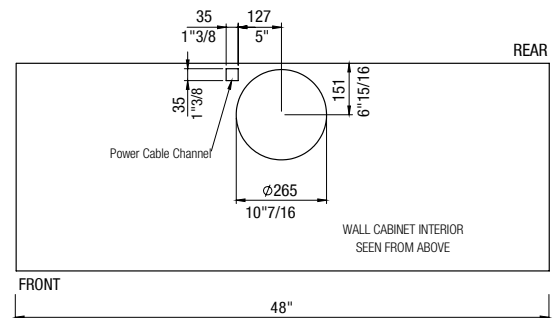
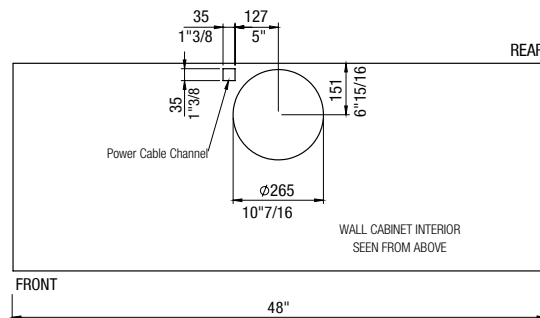
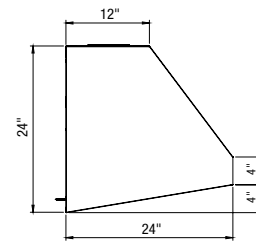



MAIN FEATURES	FH3611	FH3618	FH3624
Type	Professional Under Cabinet Hoods	Professional Wall Mount Hoods	Professional Wall Mount Hoods
Dimensions (inches)	W 36" H 11½" D 24"	W 36" H 18" D 24"	W 36" H 24" D 24"
Color	Stainless Steel	Stainless Steel	Stainless Steel
FEATURES			
Aspiration system	Ducted out	Ducted out	Ducted out
Suction power	600 cfm	600 cfm	2 x 600 cfm
Suction power (free delivery)	1000 m3/h	1000 m3/h	2 x 1000 m3/h
Number of blowers / code type	1 - T7	1 - T7	2 - T7
Speeds	3 + booster	3 + booster	3 + booster
Booster	Yes	Yes	Yes
Lighting	2 x 2W LED	2 x 2W LED	2 x 2W LED
Grease filters	3 x SS Baffle filters	3 x SS Baffle filters	3 x SS Baffle filters
Controls	Square push buttons (white retroluminated)	Square push buttons (white retroluminated)	Square push buttons (white retroluminated)
Air outlet size	Ø150 mm - 6" (top or back exit available)	Ø150 mm - 6" (top or back exit available)	Ø250 mm - 10" (top exit only)
Plug	Yes - 3 prong	Yes - 3 prong	Yes - 3 prong
Cable length	59 1/16"	59 1/16"	59 1/16"
Maximum power	354W	354W	704W
Motor power	350W	350W	2 x 350W
Voltage/frequency	120V / 60Hz	120V / 60Hz	120V / 60Hz
DIMENSIONS			
Product dimensions	W 36" H 11½" D 24"	W 36" H 18" D 24"	W 36" H 24" D 24"

FH3611

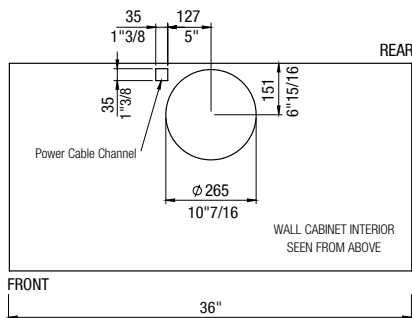
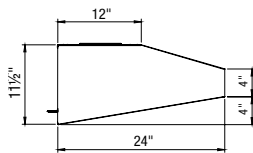

FH3618

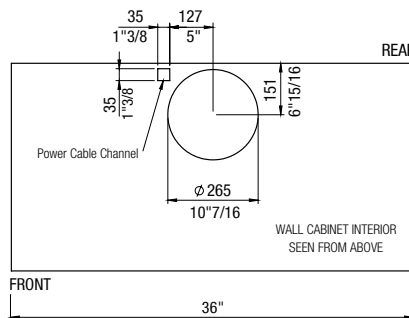
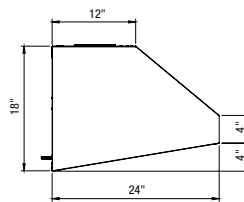

FH3624

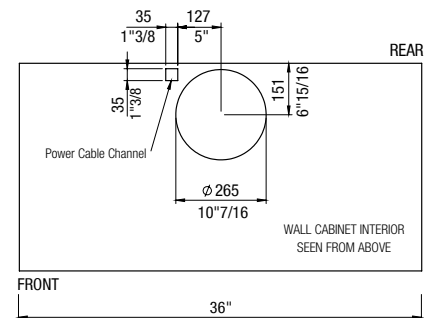
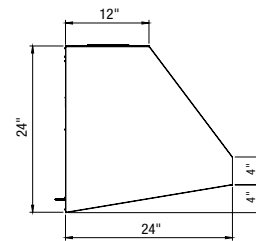

VENTILATION HOODS SPECIFICATIONS



MAIN FEATURES		FH3011	FH3018
Type		Professional Under Cabinet Hoods	Professional Wall Mount Hoods
Dimensions (inches)		W 30" H 11½" D 24"	W 30" H 18" D 24"
Color		Stainless Steel	Stainless Steel
FEATURES			
Aspiration system		Ducted out	Ducted out
Suction power		400 cfm	600 cfm
Suction power (free delivery)		680 m3/h	1000 m3/h
Number of blowers / code type		1 - T3	1 - T7
Speeds		3 + booster	3 + booster
Booster		Yes	Yes
Lighting		2 x 2W LED	2 x 2W LED
Grease filters		2 x SS Baffle filters	2 x SS Baffle filters
Controls		Square push buttons (white retroluminated)	Square push buttons (white retroluminated)
Air outlet size		Ø150 mm - 6" (top or back exit available)	Ø150 mm - 6" (top or back exit available)
Plug		Yes - 3 prong	Yes - 3 prong
Cable length		59 1/16"	59 1/16"
Maximum power		234W	354W
Motor power		230W	350W
Voltage/frequency		120V / 60Hz	120V / 60Hz
DIMENSIONS			
Product dimensions		W 30" H 11½" D 24"	W 30" H 18" D 24"

TECHNICAL DRAWING

FH3011

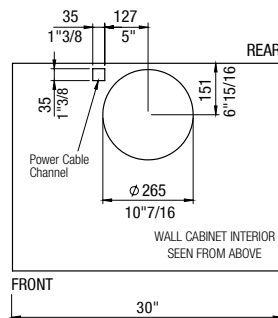
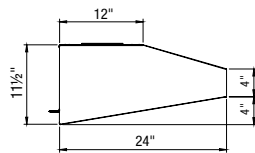

FH3018

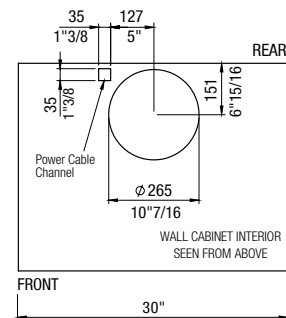
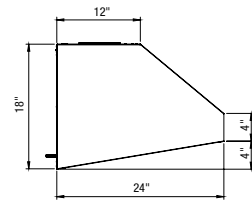

DISHWASHER SPECIFICATIONS



MAIN FEATURES		FD24DI
Product color	Stainless steel integrated door (Forza handle not included)	
Size	24"	
Type	Built-in tall tub	
Number of settings	16	
Energy Star Certified	Yes	
Annual energy consumption	249 kWh	
Type of drying	Double drying (heating + fan drying)	
Stainless steel interior	Yes	
Number of programs	6 (pots & pans, normal wash, China crystal, quick wash, rinse only, energy saver)	
Indicator of end of the cycle	Yes	
Indicator of time remaining	Yes	
Type of control	Touch control	
Internal Light	LED	
Type of display	LED display	
Anti leak device	Yes	
Anti flood device	Yes	
Delay timer	Up to 24 hours	
Audible signal at the end of the cycle	Yes	
Top sprayer	Yes	
Children security	Yes	
Stainless steel microfilter	Yes	
Self cleaning microfilter	Yes	
Adjustable feet	Yes	
Height adjustable upper basket when loaded	Yes	
Number of baskets	3	
Number of handle on baskets	1 on middle basket	
Cup support number	2	
Color of the basket	Grey	
Color of cutlery basket	Grey	
Color of dispenser	Grey	
Collapsible plate-racks	Yes	
TECHNICAL DATA		
Noise level	45 dBA	
Control panel	Touch control/LED display	
DIMENSIONS		
Product dimensions	W 23 ⁵⁵ / ₆₄ " H 33 ⁵⁵ / ₆₄ " D 26 ²⁹ / ₆₄ "	

BE THE FIRST TO KNOW



Stay one step ahead to have all our products sneak peeks.

Scan the QR code for watching the product videos on Forza youtube channel.



Youtube

Connect With Us



@ForzaCucina



@forzacucina



@ForzaCucina



@Forza Cucina

*The best **Forza** ever made...
is the next one.*

 **forzacucina.com** 

Via Modenese, 4266 / 41018 San Cesario S.P / Modena - Italy

Powered by Glem Gas S.p.A.

FORZATM

Via Modenese, 4266 / 41018 San Cesario S.P. / Modena, Italy

forzacucina.com

Powered by Glem Gas S.p.A.