

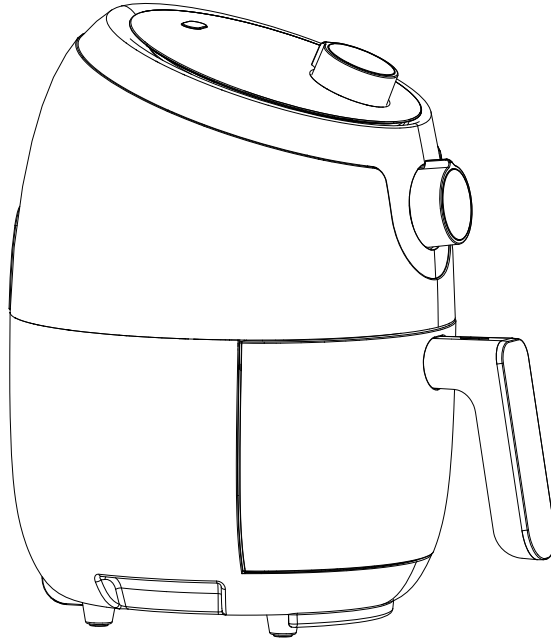

APPLIANCES

INSPIRING THE WORLD'S KITCHEN



2.3 QT AIR FRYER (OIL FREE FRYER)

COS-23AFAKB

USER MANUAL

IMPORTANT SAFETY INSTRUCTIONS

Carefully read the following Important information regarding installation safety and maintenance. Keep these instruction for future reference.

COS-23AFAKB

USER MANUAL

THANK YOU FOR YOUR PURCHASE.

Thank you for your purchase. We know that you have many brands and products to choose from and we are honored to know that you have decided to take one of our products into your home and hope that you enjoy it.

COSMO appliances are designed according to the strictest safety and performance standard for the North American market. We follow the most advanced manufacturing philosophy. Each appliance leaves the factory after thorough quality inspection and testing. Our distributors and our service partners are ready to answer any questions you may have regarding how to install, use and care for your products. We hope that this manual will help you learn to use the product in the safest and most effective manner .

If you have any questions or concerns, please contact the dealer from whom you purchased it, or contact our Customer Support at:

1-888-784-3108.

Please read the important safety instructions before using the Air Fryer for your own safety and to reduce the risk of fire or electrical shock, etc.

Please keep this manual for future use.

THANK YOU



IMPORTANT SAFETY INSTRUCTIONS

BEFORE YOU BEGIN:

Please Read all instructions completely and carefully.
Save these instructions for future references.



CAUTION

IMPORTANT: NEVER FILL THE POT WITH OIL, OR IT MAY CAUSE A FIRE HAZARD. This item is designed to cook using AIR.

The appliance contains electronic and heating elements. Do not put it in water or wash with direct water.

Use CAUTION when operating this Air Fryer, it will be HOT. Only open with the handle and use extreme care when moving the unit while in operation or after cooking. Use only insulated Pot Holder gloves to pick up the unit if needed.

Do not cover the air intake or outlet during operation. Do not touch the inside of the appliance to avoid burns and scalding. keep all ingredients in the basket.

High temperature air will flow from the outlet while the appliance is in use. Please keep a safe distance.

When pulling out the Fry Pot, please be careful of high temperature air. Use only the prescribed method of operation to avoid injury. Please read the section on removing and replacing the Fry Pot to be safe.



WARNING

FOR YOUR SAFETY:

If the information in this manual is not followed exactly, a fire, burn, electric shock or short circuit may result, causing property damage, personal injury or death.

Do not store or use gasoline or other flammable vapors and liquids in the vicinity of this or any other appliance.

FOR YOUR SAFETY:

Please keep the plug clean to avoid injury.

Do not damage, strongly pull or twist the power cord, use it to carry heavy loads, or alter it in any way.

Do not let cord hang over edge of table or counter, or touch hot surfaces, to avoid electric shock, fire and other accidents. Damaged power cord must be repaired by a trained technician or electrician.

Please do not plug and unplug with wet hands, otherwise it may cause electric shock.

Plug tightly, otherwise, it may cause electric shock, short circuit, smoking, sparking and other dangers.



! WARNING !

Read this instruction booklet before installing and using the appliance.

- Do not immerse the appliance, body, cord or plug in water or other liquid, to protect against electrical shock and damaging the unit.
- Do not allow children to play with the socket and plug to avoid electric shock.
- Do not place the appliance in the presence of explosive and /or flammable fumes.
- Do not place the appliance on or near the flammable material, such as tablecloths, curtains and others, to avoid fire hazard.
- Be sure to use on a heat resistant and even surface, keep the appliance at least 10 inches away the wall, furniture or other flammables.
- Do not use the appliance for other than intended use. Any persons that lack in knowledge of this appliance must be guided by persons who have experience, and who will be responsible for their safety.
- Keep the appliance away from children to avoid scalding, electric shock and/or other injuries. Close supervision is necessary when the appliance is used by or near children.
- This appliance is intended for Household Use Only.
- **Before beginning installation, please read these instructions completely and carefully.**
- Do not remove permanently affixed labels, warnings, or plates from the product. This may void the warranty. Please observe all local and national codes and ordinances.

CAUTION

When moving the airfryer, make sure that you hold it securely and support the base—do not rely on the food basket handle when moving the fryer!

TABLE OF CONTENTS

SAFETY INSTRUCTIONS	3-4
PRODUCT DIAGRAM	6
COSMO AIR FRYER QUICK FACTS	7
BEFORE FIRST USE	8
OPERATING INSTRUCTIONS	9
CARE & MAINTENANCE	10
TROUBLESHOOTING	11
WARRANTY & SERVICE	12-13

PRODUCT DIAGRAM

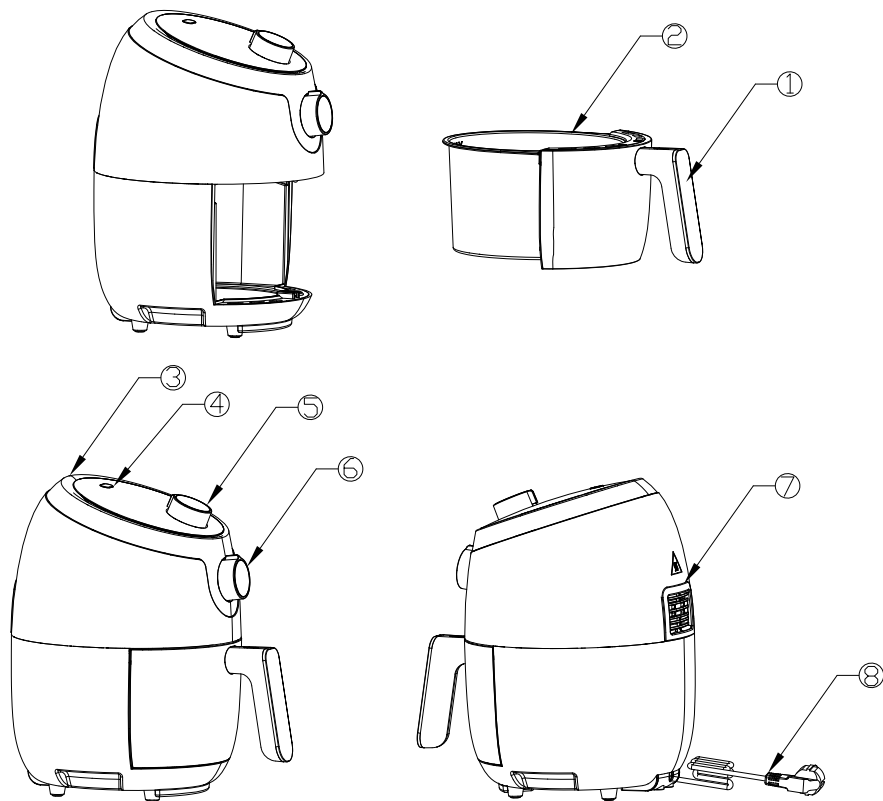

1. Handle bar
2. Food basket / drawer
3. Air inlet
4. Heating indicator lamps
5. Temperature controller (0-400°F; 0 = OFF)
6. Timer (0-30 Minutes)
7. Air outlet
8. Power cable

COSMO AIR FRYER QUICK FACTS

With the combination of High Speed Air circulation and heat, you can be excited to prepare your favorite foods and snacks in a quick, healthy, and easy way with your new Cosmo Air Fryer! This Smart Air Fryer houses a top grill to cook your ingredients from all sides simultaneously. It also allows you to prepare a variety of tasty dishes without the addition of excess oils or fats to most ingredients.

Some key features:

- Timer and temperature adjustments with knob control.
- A temperature control range of 180°F – 400°F
- Adjustable timer range from 0 to 30 minutes, and a convenient auto shut-off feature.
- Fast cooking, with little to no preheating required.
- Quick and easy clean-up: the non-stick coated parts are conveniently sized to fit in the dishwasher.
- Hassle-free frying—no splatters, no mess, and no oil smell!
- Versatility—with its frying, baking, grilling, and roasting capabilities, this unit serves as a great cooking tool for a busy kitchen.
- No assembly required—very easy and safe to use!

Model:	COS-23AFAKB
Rated Voltage:	120V
Rated Frequency:	60Hz
Rated Output Power:	1000W
Fry Basket Capacity:	2.3 Quarts
External Dimensions:	10.5 x 8.2 x 11 in. / 268 x 210x281 mm.
Net Weight:	Approx. 5.5 lbs. / 2.7 kg

BEFORE THE FIRST USE

- Unpack the appliance and its accessories (fry basket, basket pot).
- Remove any packaging or labels from the appliance.
- Wash the accessories in hot, soapy water and then wipe them dry. Wipe the interior of the frying cavity with a damp cloth or sponge, and then dry with a paper towel. **Make sure the cavity is dry before operating the unit.**
- Wipe the inside and outside of the appliance with a moist cloth.
- Place the appliance on a stable, horizontal and level heat-resistant surface at least 6 inches away from surrounding objects.
- Place the appliance in an area with good air circulation and away from hot surfaces and any combustible materials.
- Place the basket in the pan properly until it clicks into place. Slide the pan back into the appliance.
- Insert the power plug into a wall socket. Your Air Fryer is now ready for use!



THIS APPLIANCE WORKS ON HOT AIR. DO NOT FILL THE PAN WITH OIL OR FRYING FAT.

DO NOT PUT ANYTHING ON TOP OF THE APPLIANCE. THIS DISRUPTS THE AIRFLOW AND AFFECTS THE HOT AIR FRYING OPERATION. DO NOT ATTEMPT TO OPEN THE UNIT FROM THE TOP, THIS IS THE FAN AND HEATING COIL HOUSING AND DOES NOT OPEN.

OPERATION INSTRUCTIONS

- 1.) Plug in power cable into the grounded power outlet.
- 2.) Turn the Temperature Controller to desired temperature.
- 3.) Turn the Timer to 3 minutes for preheating.
- 4.) When the green light turns off, carefully pull the fry drawer out from the appliance, place the food material inside the fry basket (Attention: do not exceed the maximum line); put drawer back into main unit.
- 5.) Set the timer to the desired cooking time.
- 6.) The main unit will sound off with a signal indicating cooking time is done. Please pull the drawer out, place on heat resistant material, move food to dishes.

NOTE: For better cooking results, rotate/move food by shaking the fry basket in the middle of cooking process.

CAUTION

- Do not pull the drawer out during the cooking process. If the drawer must be moved, set the timer to 0 before pulling the drawer out.
- Do not cover the air inlet and outlet during the cooking process.
- Hot air will flow from the outlet during the cooking process, so keep a safe distance. Do not put hands and/or face near the outlet. Use caution when removing the drawer after cooking, as basket and contents will be very hot.

CARE & MAINTENANCE

- Please unplug the power cord and let it cool before cleaning the unit.
- Fryer drawer, fry basket and fryer cook surface can be cleaned with a sponge and mild detergent/soap. Do not clean with a wire sponge to avoid scratching/damaging the unit.
- Use a wet towel to wipe the surface of the fryer. Do not use corrosive or abrasive cleaning agents or soaps. Clean cook surface after cooking, once it has completely cooled.
- DO NOT immerse the unit or the power cord in water to prevent water damage. Any water inside the unit may cause a hazard.
- If you do not use air fryer for a long period of time, clean the unit, pack it into a box, and store it in a cool, dry place.

TROUBLESHOOTING

TROUBLE	POSSIBLE CAUSE	SOLUTION
Air fryer is not operational	a.) Power cord not plugged into power outlet	a.) Make sure power cord is securely plugged into power outlet
Food is not fried evenly	Some types of food need to be turned in the middle of cooking	In the middle of the cooking process, pull the drawer out and -- using caution --shake the drawer to evenly distribute any overlapping food -OR- rotate food with tongs, and push drawer back in to continue cooking
Fried food is not crisp	Some types of food must be fried with oil	Apply a thin layer of oil on the surface of the food before cooking, then fry
Drawer does not push back into fryer smoothly	a.) Drawer is overfilled with too much food and is heavy b.) The basket is not placed correctly in the drawer c.) Handle bar is stuck	a.) Food in the fry basket cannot exceed the maximum line b.) When the basket is fully cooled down, press the basket securely into the drawer c.) Place the handle bar into the horizontal position
Fryer is smoking	a.) Oily food is being fried b.) Fryer contains oil from previous cooking	a.) Situation is normal b.) Clean the drawer and basket after each use



APPLIANCES

WARRANTY AND SERVICE

For full warranty details on this product please visit:
<http://www.cosmoappliances.com/warranty>

TO RECEIVE WARRANTY SERVICE, YOUR
PRODUCT MUST BE REGISTERED. TO REGISTER, VISIT:

WWW.COSMOAPPLIANCES.COM/WARRANTY

SCAN TO REGISTER



IMPORTANT

Do Not Return This Product To The Store If
you have a problem with this product, please contact

Cosmo Customer Support at

+1(888)784-3108

DATED PROOF OF PURCHASE, MODEL #, AND SERIAL #
REQUIRED FOR WARRANTY SERVICE

IMPORTANT

Ne pas Réexpédier ce Produit au Magasin
Pour tout problème concernant ce produit, veuillez contacter
le service des consommateurs Cosmo Customer Support au

+1(888) 784-3108

UNE PREUVE D'ACHAT DATEE EST REQUISE POUR BENEFICIER DE
LA GARANTIE.

IMPORTANTE

No regrese este producto a la tienda
Si tiene algún problema con este producto, por favor contacte el
AYUDA AL CLIENTE COSMO al

+1(888)784-3108

(Válido solo en E.U.A).

NECESITA UNA PRUEBA DE DE COMPRA FECHADA, NÚMERO DE
MODELO Y DE SERIE PARA EL SERVICIO DE LA GARANTÍA

Correct Disposal of this product:

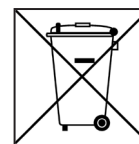

This marking indicates that this appliance should not
be disposed with other household wastes. To prevent
possible harm to the environment or human health
from uncontrolled waste disposal, recycle it responsibly to
promote the sustainable reuse of material resources.



Cosmo is constantly making efforts to improve the quality and performance of our products, so we may make changes to our appliances without updating this manual.

Electronic version of this manual is available at:
www.cosmoappliances.com