

## P3011-ARMU/P3011-SBMU/P3011-SDMU

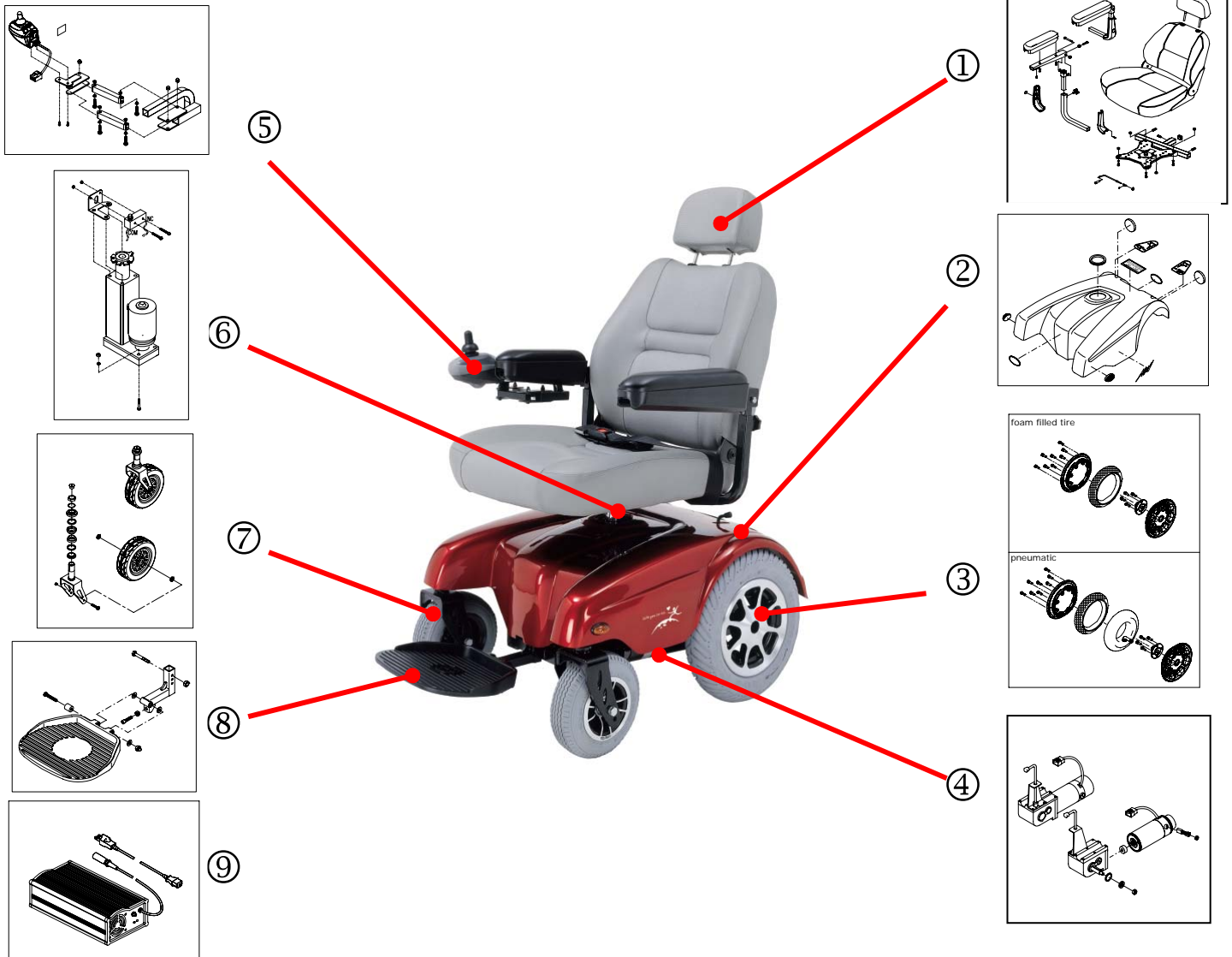

①	Seat ass'y	62120040(MOTOR ONLY,RH)
	32200049 (Seat Complete Ass'y.W/Seat Base And Armrest)	62410025(GEARBOX ONLY, M12-11, LH)
	32222013 (Captain Seat Only,20w*18d*20h(P00/P07)	62420025(GEARBOX ONLY, M12-11, RH)
	43701072(PAD, ARMREST(LONG),BLACK)	⑤
	43701073(PAD,ARMREST(SHORT),BLACK)	Controller
		33703040 (CONTROLLER ASS'YSHARK SEATLIFT)
②	Shroud ass'y	64810008 (JOYSTICK SHARK(SEATLIFT)
	30510869 (SHROUD ASS'Y(CANDY APPLE RED))	64210006 (CONTROLLER SHARKDK-PMB11)
	30515969 (SHROUD ASS'Y(BLUE))	⑥
	30552060 (SHROUD ASS'Y(BLACK))	Seat lift ass'y
		62100078(LIFTING MOTOR ASS'Y(P301))
③	Rear wheel ass'y.	⑦
	32600204 (DRIVE WHEEL ASS'Y,LH3.00-8 C917 PU)	Caster Wheel with Fork Ass'y.
	32600205 (DRIVE WHEEL ASS'Y,RH3.00-8 C917 PU)	33100634 (FRONT WHEEL ASSY., GRAY,2.80/2.50-4 PU)
		⑧
④	Motor and gearbox complete, LH and RH.	Footplate ass'y.
	62010073(MOTOR & GEAR BOX, LHM12DA-11)	33303037 (ALUM. FOOTPLATE&BRACKETASS'Y.)
	62020073(MOTOR & GEAR BOX, RHM12DA-11)	⑨
	62110040(MOTOR ONLY,LH)	Charger unit
		65142005 (CHARGER, HP8204-5A-OFF)
		63600008 (CHARGER POWERCORD W/PLUG,US SPEC)