

BougeRV

User Manual

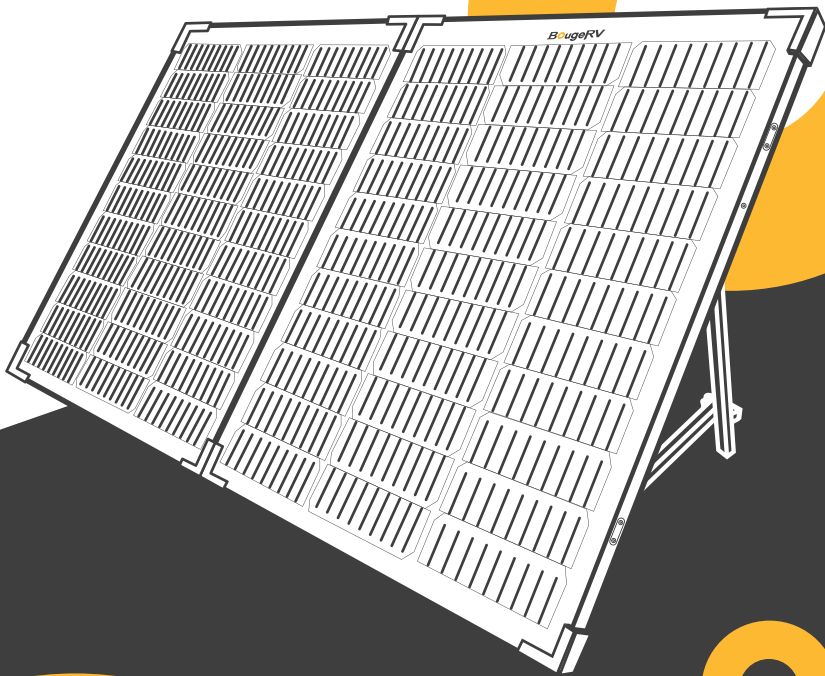

9BB-130W Portable Solar Panel



www.bougerv.com



Contents

- Features ----- 1
 - Safety Precautions ----- 1
 - Limited Warranty ----- 2
 - How To Use ----- 3
 - Electrical Parameters ----- 5
 - Frequently Asked Questions ----- 6
- 
- 

Features

- **Better Waterproof Performance** — IP67, use waterproof junction box.
- **Lighter Structure and Robust Kickstands** — Weight < 11lbs, the panel features two more robust kickstands made of aluminum than conventional portable solar panels.
- **Longer Service Life** — 9BB cell reduces internal resistance loss.
- **Better Light-receiving Area** — 9BB cell uses a thinner ribbon, and the area covering the cell becomes smaller.
- **Higher Efficiency** — 23.5%, 9bb design increases conversion efficiency.
- Suitable for solar power station systems and solar off-grid systems (RV, Home, Boat).

Safety Precautions

- Do not stand on, drop, scratch, or allow objects to fall on the solar panels as doing so may damage them and void the warranty.
- Do not place anything on the solar panel, even for a moment because the resulting residue may damage or stain the surface.
- Do not install or handle the solar panel when they are wet or during periods of high wind.
- Save these instructions!

Limited Warranty

BougeRV Solar Panel comes with an **18-month warranty** that commences from the date of purchase.

If you have any questions during use the product, please feel free to contact us:



service@bouge rv.com



1-669-232-7427



www.bouge rv.com

Ps: The Limited Warranties do not apply to any of the following:

The solar panel which in BougeRV's absolute judgment have been subjected to misuse, abuse, neglect or accident, alteration, or improper installation, application, or removal. This includes, but is not limited to, installation, application, or removal by any party other than a BougeRV authorized dealer; non-observance of BougeRV's installation, user's and/or maintenance instructions; power failure surges, lightning, flood, fire, accidental breakage, or other events beyond BougeRV's control.

How To Use

1.Solar Power Station System

(1) Release the buckle

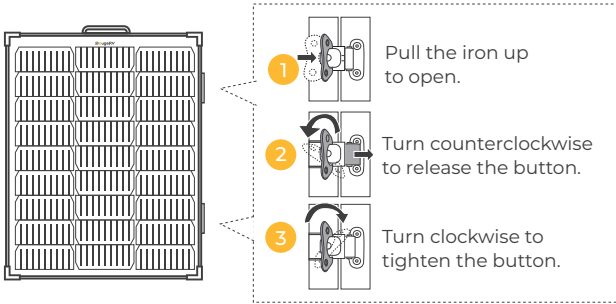

(2) Adjust the bracket

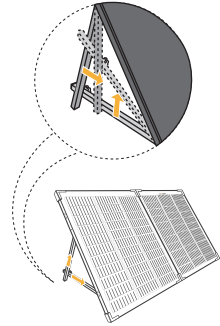

(3) Connect the MC4 connectors A of the solar panel with the MC4 to DC7909 cable B

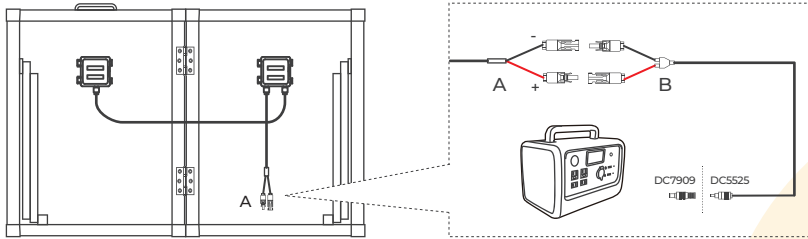

Compatible with various types power stations

As long as your other cable is equipped with MC4 connectors, then it could connect with our connector A of the solar panel.

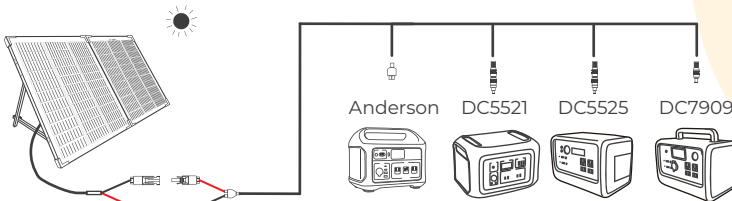

Charge solar power station

2.Solar Off-grid System

- First connect battery terminal wires to the charge controller.
- Then connect the solar panel to the charge controller.

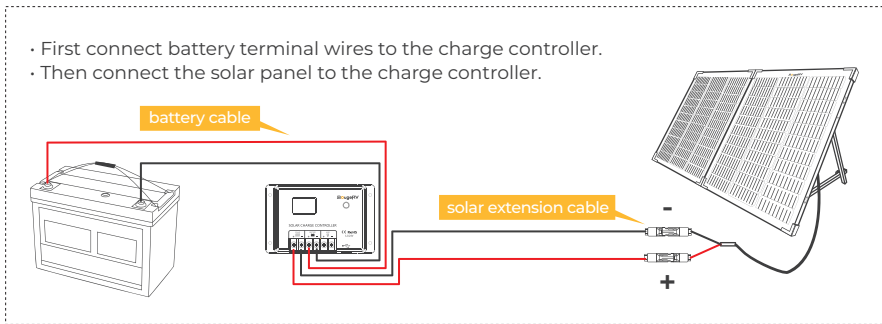

(1) Series Connection

The panel can be wired in series to produce the desired voltage output.

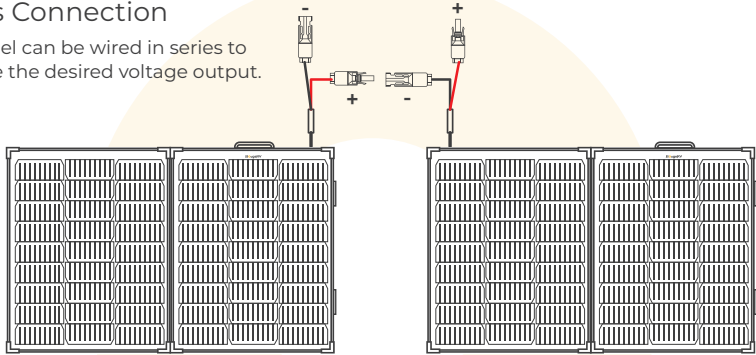

(2) Parallel Connection

The solar panel can be wired in parallel to produce the desired current output with the solar parallel connector.

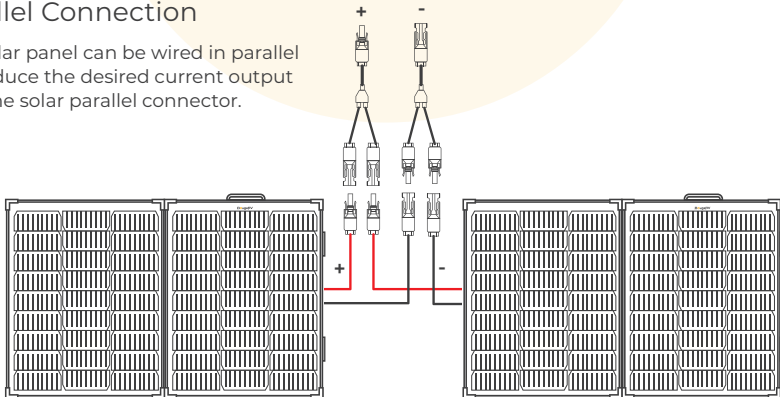

Electrical Parameters

Maximum Power (Pmax)	130 W
Solar cells Efficiency	23.5%
Max. Power Voltage (Vmp)	19.02V
Max. Power Current (Imp)	6.83A
Open Circuit Voltage(Voc)	22.40V
Short Circuit Current(Isc)	7.59A
Max. System Voltage	1000V DC
Operating Temperature Limits	-40°F ~ +185°F
Series Fuse Rating	10A
Dimensions (folded)	26.6*21*2 inches
Dimensions (unfolded)	26.6*42*1 inches

BougeRV provides you with professional technical services. You can send your needs and the parameter information or instructions of your purchased accessories directly to our email: service@bougerv.com, we will help you build the ideal DIY solar system.

Frequently Asked Questions

Q1

What should I do if the solar panel I received is damaged, missing parts, or has no output?

A1

Please send relevant pictures to our after-sales mailbox service@bougerv.com immediately, and leave your order number. We will reply one by one according to the chronological order sent by the customers.

Q2

What kind of device can be charged by this solar panel ?

A2

1. Solar Power Station
2. Lead-acid Battery (need the solar charge controller)
3. Lithium Battery (need the solar charge controller)

Q3

What causes the low output power or no output during the use of solar panels? How can I solve it?

A3

The output power of solar panels is mainly affected by light intensity, light angle, and shadow occlusion during the use of solar panels. Therefore, during daily use, the angle of illumination must be adjusted to prevent shadows, and the obstructions on the solar panel must be cleaned regularly, such as bird droppings, dust, and garbage. Such obstructions may cause the solar panel to not output at all.

Q4

Is this solar panel waterproof?

A4

Yes, this solar panel complies with the dustproof and waterproof standard IP67 (main body panel part), do not install it in water or frequently submerged places.

BougeRV

Limitless energy, limitless life.

www.bougerv.com