

SIERRA DRESSER



SHOWN IN OAK MATTE POLY

CREDENZA 90"L + 20"W + 28"H 400LBS

INDUSTRIAL STEEL + POLY FINISH CASING
BLEACHED OAK + POLY DOORS
INDUSTRIAL STEEL + POWDER COATED LEGS

//DIMENSIONS + FINISHES CUSTOMIZABLE

price may increase for material/finish change

for more information please contact our design team at info@crofthouse.com

OAK ALTERNATIVES:

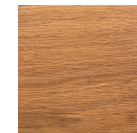

OIL



MATTE POLY

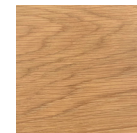

SMOKE

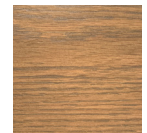

FRENCH



ARDEN, OIL



CORNSILK

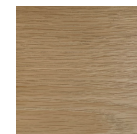

BLEACHED



BONE

TOP VIEW

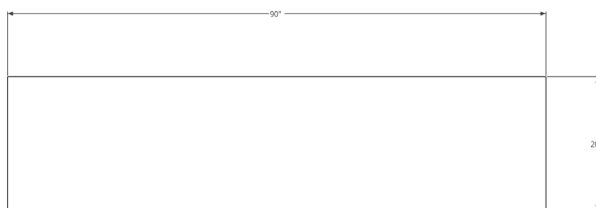

FRONT ELEVATION

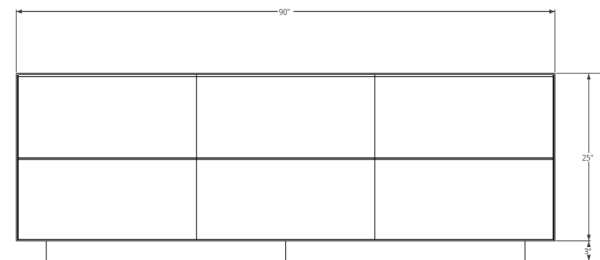

326 NORTH LA BREA AVENUE
LOS ANGELES, CALIFORNIA 90036

323.424.7743
WWW.CROFTHOUSE.COM



**CROFT
HOUSE**