

GRANADA CREDENZA



SHOWN IN SEA PEARL

CREDENZA 80"L + 20"W + 27"H 400LBS

LACQUERED HDF CASING
HONED MARBLE DOORS
INDUSTRIAL STEEL + POWDER COATED LEGS

//DIMENSIONS + FINISHES CUSTOMIZABLE

price may increase for material/finish change

for more information please contact our design team at info@crofthouse.com

MARBLE ALTERNATIVES:

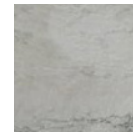

SEA PEARL

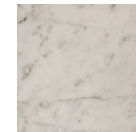

CARRARA

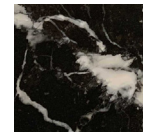

NERO
MARQUINA

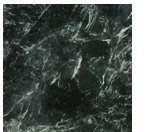

GREEN
EMPRESS



BRONZE
AMANI

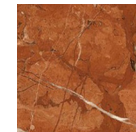

ROJO
ALICANTE

TOP VIEW

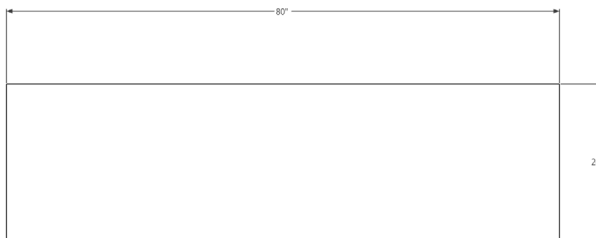

FRONT ELEVATION

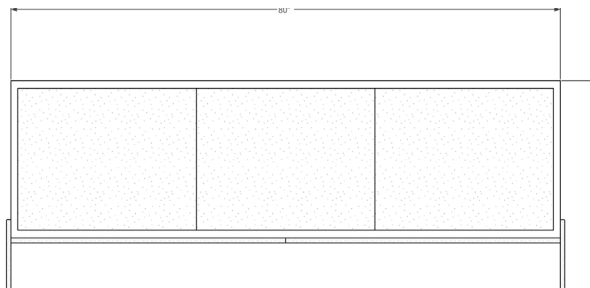

326 NORTH LA BREA AVENUE
LOS ANGELES, CALIFORNIA 90036

323.424.7743
WWW.CROFTHOUSE.COM



CROFT
HOUSE