

# CRANK AND PULL

## Manual Cab Level Tarp System



We appreciate your purchase of a tarp system. We promise that all our tarp systems are built from the highest quality material available, therefore we can also vow to stand behind the quality of our product.

### **WARNING:**

- Never operate tarp system while moving.

### **CAUTION:**

- Read through instructions for entire system and follow directions thoroughly to ensure the system functions properly.

### **TOOLS REQUIRED:**

- Ratchet
- 3/8", 1/2", 9/16", and 3/4" Sockets and Wrenches
- Screw Driver
- Drill
- 3/8" and 1/2" Drill

# CONTENTS OF THE CRANK AND PULL

## CRANK AND PULL – MANUAL CAB LEVEL KIT

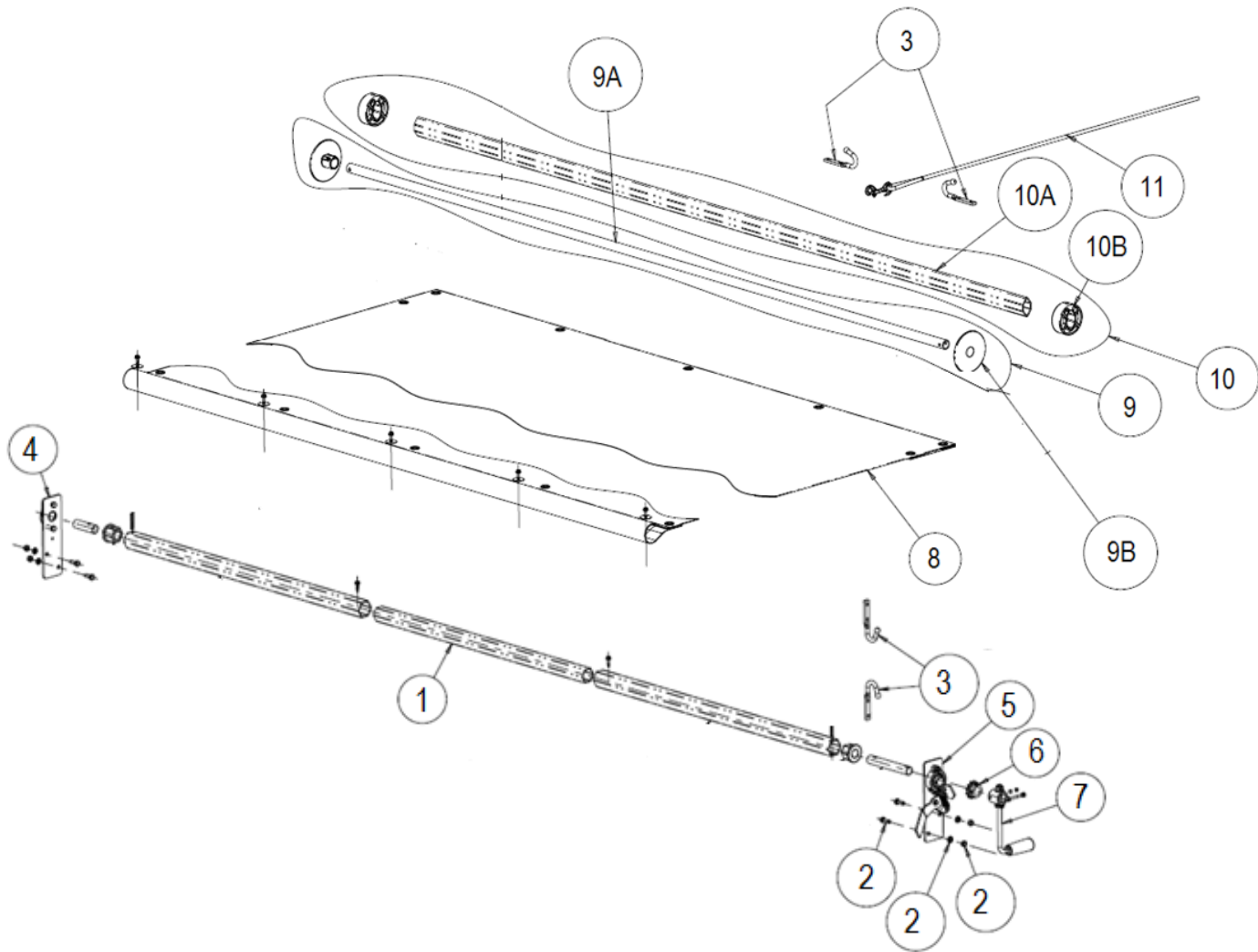

Item #	Description	Part Number	Item #	Description	Part Number
1	Cab Level Tarp Axle	T-CABLATA	8	Tarp	T-MISC. TARP
2	Assorted Hardware	T-CABLCKHW	9	Standard Pull Bar Assembly	T-CABLCK2
3	Box Hooks for Derby Rope	T-312JH	9A	Steel Pull Bar	T-312JH
4	Passenger Side Mounting Bracket & Bearing	T-CABLMB	9B	Aluminum End Foot Cap	T-CABLMB
5	Driver Side Mounting Bracket, Bearing, & Break	T-CABLMBWB	10	Aluminum Pull Bar Assembly	T-CABCK3
6	Sprocket Attachment	T-CABAS1	10A	Aluminum Pull Bar	T-CABAS1
7	Crank Handle	T-CLCH	10B	PATROT Tarp Centering Flanges	T-CLCH

# INSTALLATION INSTRUCTIONS

## CRANK AND PULL – MANUAL CAB LEVEL KIT

1. Determine the location of the tarp roller. The tarp roller should be mounted above the cab on the dump body's cab guard. To prevent damage from loads being dumped into the body, the tarp roller should be mounted outside of the dump body's load area. Also, verify the location is accessible for winding the tarp up. (Figure 1)

2. Clamp the bearing bracket assemblies (item 4&5) to the dump body in the locations determined in step 1. The bearing bracket assembly with the detent lever (item 5) is to be mounted on the driver's side of the dump body. Make sure the brackets are aligned vertically as well as from front to back by measuring from a common point on each side of the body. Verify the bearing bracket assemblies are mounted high enough to accommodate the tarp when rolled onto the roll bar assembly.

3. Mark the bearing bracket mounting hole's locations onto each side of the dump body. Remove the brackets and drill 13/32" holes in the four marked locations.

4. Assemble the bearing brackets to the dump body using the four 3/8-16 x 1 cap screws, lock washers and nuts supplied. Do not tighten fasteners at this time, just hand tighten to hold brackets in position.

5. Locate the inner hex tube (item 1) and make a pencil mark in the center of the tube's length. Insert the inner hex tube half way into the driver's side roll tube assembly. Insert the passenger's side roll tube assembly onto the opposite end of the inner hex tube. Measure the distance between the inside of the mounted bearing brackets (for measurements less than 81.75": The driver's and passenger's side roll tube assemblies will need to be shortened by an equal amount to obtain the proper width). Separate the roll tubes, so the length of the

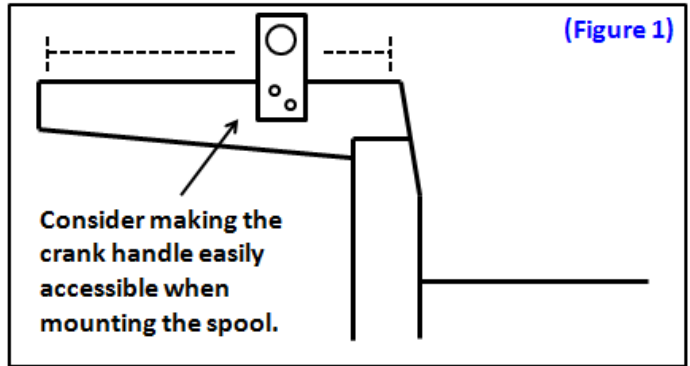

of the complete roll tube assembly from adaptor to adaptor is ¼" less than the distance between mount brackets. Locate the pencil mark, and verify that the inner hex tube is centered inside the outer roll tube assemblies. Screw each roll tube assembly to the inner hex tube using one ¼" x 1" self drilling and tapping screw 2" from the end of the outer tube.

6. Slide the complete roll tube assembly into the 5" loop in the end of the tarp. Verify that the webbing in the seams of the tarp will be on the bottom when installed. Note: The roll tube end of the tarp only has one row of webbing reinforcement.

7. Center the roll tube assembly in the tarp. Holding the roll tube assembly tightly in the end of the pocket, screw in place with five evenly spaced ¼" x 1" self-drilling tapping screws and fender washers. Make sure the screws are centered in the hex tube and the screws on each end are at least 2" from the end of the roll tube assembly. Be careful not to screw into the shaft adaptors on each end.

8. Remove one of the bearing bracket assemblies and slide the tarp roll assembly in to the remaining bearing. Slide removed bearing bracket over shaft and reassemble to the dump body. Tighten 3/8" bracket mounting bolts at this time.

# INSTALLATION INSTRUCTIONS

## CRANK AND PULL – MANUAL CAB LEVEL KIT

9. Center the tarp roll assembly between the mounting brackets and tighten set screws in each bearing race.

10. Assemble sprocket (item 6) onto the 1" shaft of the driver's side roll tube assembly (item 1). With the detent lever in the open position, slide the sprocket down the shaft until it is tight against the bearing.

11. Assemble crank handle assembly (item 7) onto the driver's side roll tube shaft using the 1/4" X 2" screw and lock nut provided.

12. Assemble pull rope assembly (item 11) to the center grommet on the rear of the tarp (item 8). (See figure 3.)

13. Assemble two rope storage hooks (item 3) to the dump body tailgate to wrap the pull rope for storage when tarp is covering the body. The hooks should be mounted horizontally and may be bolted (bolts not included) or welded to the dump body. The recommend distance between the hooks is 15-17". (See figure 1.)

14. Assemble two rope storage hooks to the side dump body near

assembly to wrap the pull rope for storage when tarp is retracted. The hooks should be mounted vertically and may be bolted (bolts not included) or welded to the dump body. (See figure 2.)

## Optional Accessory

### Optional Pull Bar Kit Installation [T-CABLCK2]

*Note: For tarps narrower than 6 feet the center tube (item 9A or 10A) will need to be shortened and re-drilled.*

1. Slide rear pull bar (item 9A or 10A) into the pocket in the rear of the dump body tarp. Center the bar in the tarp. The same amount of bar should be exposed on each side of the tarp.

4. After the rear bar is centered to fit the tarp, the excess bar may be cut off to limit the amount of bar protruding outside the body. If the rear bars are cut, the cut ends should be painted to prevent premature rusting.

3. Attach the Aluminum End Foot Caps (Item Centering Flanges of the pull bar to

### MANUAL – CRANK ASSEMBLY INSTALLATION

#### INSTALLATION INSTRUCTIONS

##### STEP 5: ATTACHING THE CRANK BOX AND CHAIN

1. Choose a comfortable position that the crank handle can be operated from the ground. Mark this location. *Note: The crank box does not need to be directly below the sprocket.*
2. Wrap the #40 chain over the sprocket of the tarp spool and pull it through the center point of the area you marked as the location for the crank box. Trace a 6" line along the edge of the chain from the center point of the crank box toward the tarp spool.
3. Place the crank box back over the center point and angle it so the line is exiting the top of the box. *Note: If the box cannot be mounted because it extends past the edge of the box, repeat step 5-1 and 5-2. Drill and mount the crank box.*
4. Release the master link of the #40 chain, adjust the length of the chain, install the chain on both the crank box and the spool's sprocket bar.
5. Install the optional chain guard at this time.

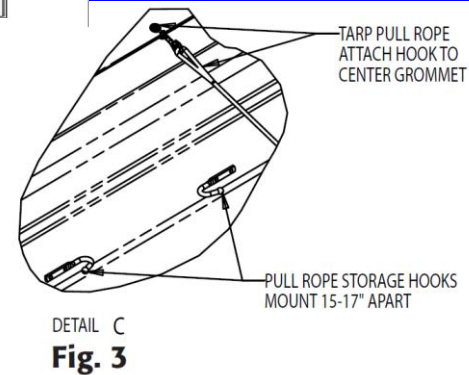
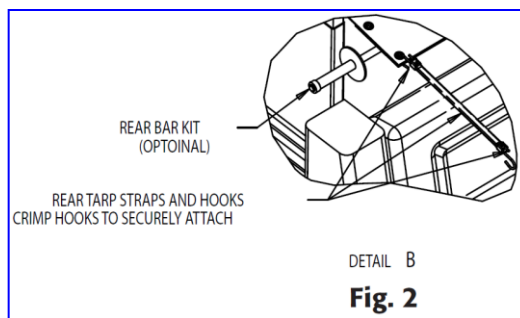
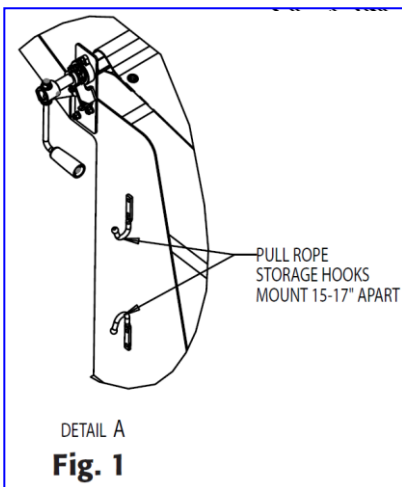
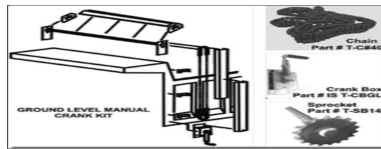

# MANUAL – CRANK ASSEMBLY INSTALLATION

## INSTALLATION INSTRUCTIONS

### STEP 5: ATTACHING THE CRANK BOX AND CHAIN

1. Choose a comfortable position that the crank handle can be operated from the ground.  
Mark this location. **Note: The crank box does not need to be directly below the sprocket.**
2. Wrap the #40 chain over the sprocket of the tarp spool and pull it through the center point of the area you marked as the location for the crank box. Trace a 6" line along the edge of the chain from the center point of the crank box toward the tarp spool.
3. Place the crank box back over the center point and angle it so the line is exiting the top of the box. **Note: If the box cannot be mounted because it extends past the edge of the box, repeat step 5-1 and 5-2.** Drill and mount the crank box.
4. Release the master link of the #40 chain, adjust the length of the chain, install the chain on both the crank box and the spool's sprocket bar.
5. Install the optional chain guard at this time.

## OPTIONAL

