

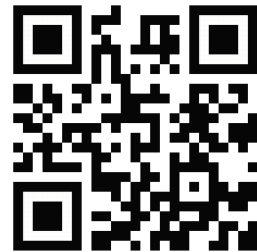

Scan the QR code to
access additional info
and follow us!

SCAN ME



User Guide and Instruction Manual



WARNING: Read all instructions carefully before
using this sauna. This product should
always be used with care.

Congratulations on your purchase of our personal portable sauna, another of our personal care products. We appreciate your business and we hope that you are completely satisfied with your purchase.

Features

- Ultra-thin, Active Carbon Fiber ("ACF") heating elements
- Easy and fast assembly, convenient fold-up and storage
- Portable - easy to move from one location to another
- Low energy usage for lower energy costs
- Low maintenance, lightweight and portable
- Multi-level temperature controller with safety shut-off
- Comfortable sports canvas folding chair
- Antibacterial Technology
- Negative ION Technology

What's Included

- One frame of side walls and back wall, the interior which has the heating elements
- Electronic control box attached to the back panel
- Controller for adjusting heat and time settings
- Folding chair
- Foam floor cushion
- Frame cross bar
- Heating footpad

To Assemble

1. Unfold both sides' walls of the sauna so it stands upright.
2. Close the zipper from the bottom of the back wall towards the front.
3. Place the foam floor cushion in place, shiny side up.
4. Place the folding chair on the floor cushion.
5. Place the footpad, printed side up in front of the chair.
6. Plug electrical power cord into a standard outlet

You are now ready to enjoy your sauna experience.

Instructions for the time and temperature controller

1. Press POWER key to turn on the instrument. The TEMP will display 131 F (default) while the TIME will display 5 minutes (default).
2. Press START key to start the session. The indicating light will be on.
3. Press FOOT HEAT key to heat the bottom footpad.
4. Temperatures range from 113-150 F, 131 F would be considered the middle temp, 150 F is the highest temperature available.
5. Times range from 1-30 minutes, you can increase or decrease the time in increments of 5 minutes by pressing the (+) or (-) keys.

CAUTION: Please be aware of that the metal frame of the chair will warm and increase in temperature while being used.

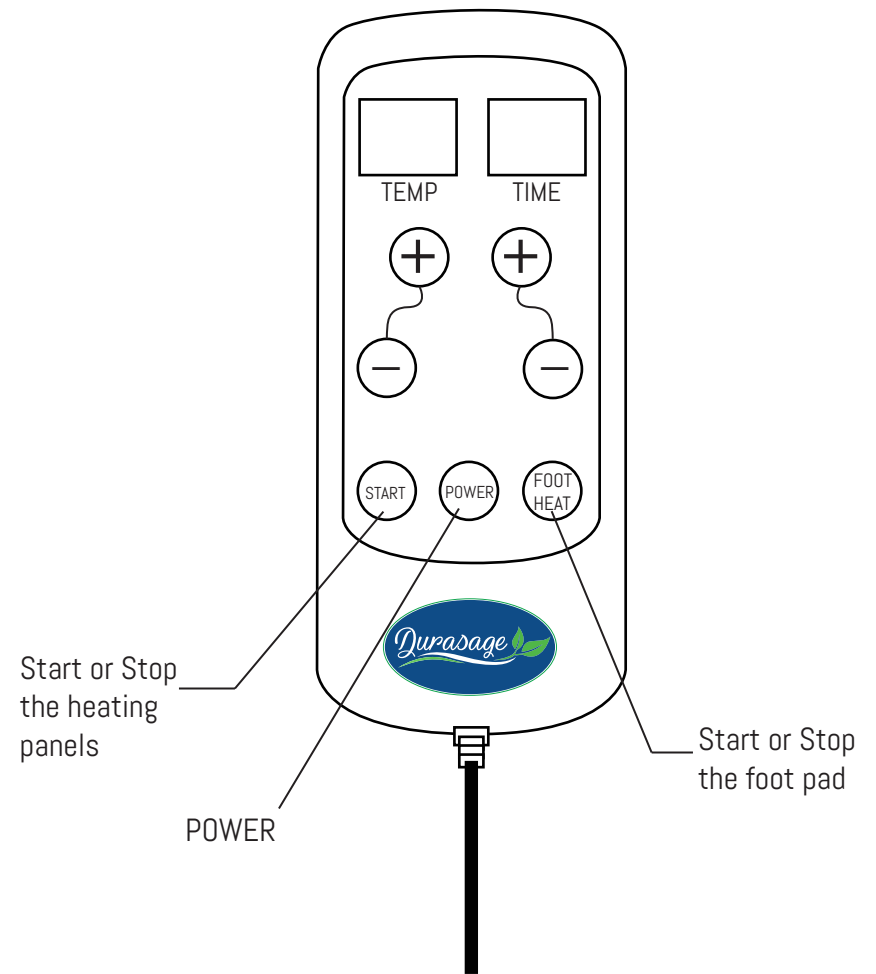

INSTRUCTIONS AND PRECAUTIONS

1. This is a product for relaxation and rejuvenation. This product is not intended for use by persons with reduced physical, sensory, or mental capabilities. If you are under 18 years of age, elderly, or infirm, you should consult with a healthcare professional before using this product.
2. If you are pregnant, or have diabetes, a pacemaker or defibrillator implant, a blood-based disorder, a skin disease, a respiratory condition, a heart condition, high or low blood pressure, any medical condition or are under medical care, you should consult with a healthcare professional before using this product.
3. Stop using the Sauna immediately if you feel uncomfortable, dizzy, or sleepy.
4. Staying in the Sauna too long may cause overheating. Initially it is recommended that the sauna be used no more than 30 minutes per session by any one user.
5. It is recommended to stay well hydrated with water and replace electrolytes lost during perspiration.
6. Do not use in or around water due to the danger of electrical shock. This product is designed for indoor use only.
7. Do not position this Sauna near sources of heat or electromagnetic radiation such as radiators, heat registers, stoves, television sets or magnetized objects.

8. Sharing power sources with unrelated products, overloading power cords and strips and using non-standard power sources are not recommended.

9. If smoke is ever detected from this product, immediately unplug from the outlet and contact the Customer Service Department at Comsis Computer during standard business hours.

TO CLEAN, FOLD AND STORE

Open the zipper to ventilate and cool. After each use, remove any condensation or perspiration from the chair and the interior of the unit with a clean damp cloth. Do not use any cleaning agents or solvents.

After the Sauna has been wiped off and is fully cooled, simply reverse the steps above to fold for storage.

If left assembled, unplug the power cord after each use.

Limited Warranty

1. WHAT THIS LIMITED WARRANTY COVERS AND HOW LONG

This Product includes the product itself, and, unless specifically excluded below, all material, parts, and components related to functionality. This Limited Warranty applies only when all of these parts are genuine Angels Investments components. Cosmetic components are not covered by this Limited Warranty.

a) **COVERAGE** Subject to the limitations and exclusions below, and for the duration of the applicable Warranty Period, Angels Investments, and any of its affiliates, ("Seller") warrants that the Product's components will be free from material and functional non-conformities in material and workmanship under normal and reasonable consumer conditions.

b) **WARRANTY PERIOD** For the one year period of this Warranty, Angels Investments, at its discretion, will repair or replace any defective part, component, mechanism, or material. This warranty coverage shall include all defective parts, but shall exclude all labor charges. The Warranty Period shall commence upon purchase of the product by the end-user consumer from an authorized dealer. Each consumer is urged to register the Product through the Warranty Registration Form attached hereto. This Limited Warranty is not transferable. This Warranty can only commence once proof of purchase (or gift) is provided.

2. WHAT THIS LIMITED WARRANTY DOES NOT COVER

a) **GENERALLY** This Limited Warranty does not include non-conformities or damages attributable to or arising from: • Minor scratches or minor visual imperfections • Negligence; improper use, installation, finishing, maintenance operation inconsistent with Seller's recommendations and written instructions that are generally available in Seller's Product Manual as updated by bulletins or other written communications • Improper storage, including inadequate shelter or inadequate venting of shipping wrap in humid locations • Misapplication of use, commercial use, or use other than generally intended • Normal wear and tear • extraordinary force majeure

b) **CERTAIN CONDITIONS** This Limited Warranty does not guarantee health claims. Further, this Limited Warranty does not cover damage attributable to or caused by acts of God that include, but are not limited to, power surges, stresses, fire and other conditions that exceed Product designs. Seller is not responsible for claims or damages caused by water or condensation infiltration.

3. THIS LIMITED WARRANTY'S EXCLUSIVE REMEDY

If the Product or any components fail to meet this Limited Warranty, Seller's sole obligation is to either (as Seller elects): a) repair the component (color matching not guaranteed); or b) provide replacement component(s) to the Warranty Holder or the Seller's dealer designated (color matching not guaranteed); or c) refund the Warranty Holder's purchase price (the lesser of the original Product/component purchase price or the original catalog list price). Repaired or replaced components are warranted only on the same terms and for the remainder of the Warranty Period. Seller reserves the right to discontinue or change any Product. If the Product or component is not available, Seller may select and provide a replacement Product or component of equal quality and price. This is the Warranty Holder's sole and exclusive remedy for the Product under this Limited Warranty. By example but not limitation, this Limited Warranty does not cover the following costs and expenses: (i) labor; (ii) shipping/freight expenses to return the Product to Seller, or Seller's designated service center; (iii) normal maintenance; or (iv) consequential, special, or indirect losses or damages of any kind.

4. DISCLAIMER OF WARRANTIES

THIS LIMITED WARRANTY IS IN LIEU OF AND EXCLUDES ALL OTHER WARRANTIES NOT EXPRESSLY SET FORTH HEREIN, EXPRESSED OR IMPLIED BY OPERATION OF LAW OR OTHERWISE, INCLUDING BUT NOT LIMITED TO ANY IMPLIED WARRANTIES OF MERCHANTABILITY OR FITNESS FOR A PARTICULAR PURPOSE. TO THE EXTENT THAT ANY IMPLIED WARRANTIES MAY NONETHELESS EXIST BY OPERATION OF LAW, SUCH WARRANTIES ARE LIMITED TO THE DURATION PROVIDED BY LAW. SOME STATES DO NOT ALLOW LIMITATIONS ON HOW LONG AN IMPLIED WARRANTY LASTS, SO THE ABOVE LIMITATIONS MAY NOT APPLY. SELLER DOES NOT AUTHORIZE ANYONE TO CREATE FOR IT ANY OBLIGATION OR LIABILITY IN CONNECTION WITH PRODUCTS.

5. LIMITATION OF LIABILITY

SELLER'S SOLE LIABILITY UNDER THIS LIMITED WARRANTY IS REPLACEMENT, REPAIR, OR REFUND OF THE PURCHASE PRICE AS SET FORTH ABOVE. IN NO EVENT, WILL SELLER BE LIABLE FOR INCIDENTAL, CONSEQUENTIAL, INDIRECT, SPECIAL, OR PUNITIVE DAMAGES INCLUDING, BUT NOT LIMITED TO, DAMAGE OF ANY KIND TO A PREMISES, LOSS OF PRODUCT USE, LABOR, LOST PROFITS/REVENUE, INTEREST, LOST GOODWILL, WORK STOPPAGE, IMPAIRMENT OF OTHER GOODS OR WORK, INCREASED OPERATING EXPENSES, EMOTIONAL DISTRESS CLAIMS, LOSS OF CONSORT CLAIMS, OR CLAIMS OF THIRD PARTIES FOR SUCH DAMAGES, WHETHER BASED ON CONTRACT, WARRANTY, TORT (INCLUDING, BUT NOT LIMITED TO, STRICT LIABILITY OR NEGLIGENCE) OR OTHERWISE, EVEN IF ADVISED OF THE POSSIBILITY OF SUCH DAMAGES.) SOME STATES DO NOT ALLOW THE EXCLUSION OR LIMITATION OF INCIDENTAL OR CONSEQUENTIAL DAMAGES, SO THE ABOVE LIMITATION OR EXCLUSION MAY NOT APPLY. THIS LIMITED WARRANTY PROVIDES SPECIFIC LEGAL RIGHTS BUT WARRANTY HOLDER MAY HAVE OTHER RIGHTS WHICH VARY FROM STATE TO STATE. IF THIS LIMITED WARRANTY IS DEEMED TO HAVE FAILED OF ITS ESSENTIAL PURPOSE, IN NO EVENT WILL SELLER'S ENTIRE LIABILITY EXCEED THE LESSER OF THE PRODUCT'S OR THE NON-CONFORMING COMPONENT'S PURCHASE PRICE.

6. CLAIMS

Claims must be initiated during the Warranty Period. Claimant will be required to provide proof of purchase and the date of Product purchase (unless the Product was registered at the time of purchase) and may be required to return the Product or component to Seller at Claimant's expense).

To initiate a claim, please scan the QR code below to send us a message.

Customer Service Department

Please scan the QR code to send us an email if you have any questions or concerns.

Angels Investments, L.L.C.
Telephone (480) 878-4789
Support@durasagehealth.com
1609 W 17th St, Tempe, AZ, 85281

SCAN ME

