



Scan the QR code to  
access additional info  
and follow us!



**SCAN ME**



User Guide and Instruction Manual

**WARNING:** Read all instructions carefully before  
using this sauna. This product should  
always be used with care.

Congratulations on your purchase of our personal portable sauna, another of our personal care products. We appreciate your business and we hope that you are completely satisfied with your purchase.

## Features

- Ultra-thin, Active Carbon Fiber ("ACF") heating elements
- Easy and fast assembly, convenient fold-up and storage
- Portable - easy to fold up and bring with you
- Low energy usage for lower energy costs
- Low maintenance, lightweight and portable
- Multi-level temperature controller with safety shut-off
- Comfortable sports canvas folding chair
- Antibacterial Technology

## What's Included

- One frame of side walls and back wall, the interior which has the heating elements
- Electronic control box attached to the back panel
- Controller for adjusting heat and time settings
- Folding chair
- Foam floor cushion
- Frame cross bar
- Heating footpad
- Cloth neck collars x2

## To Assemble

1. Unfold both sides' walls of the sauna so it stands upright.
2. Close the zipper from the bottom of the back wall towards the front.
3. Place the foam floor cushion in place, this side up sticker.
4. Place the folding chair on the floor cushion.
5. Place the footpad, printed side up in front of the chair.
6. Plug electrical power cord into a standard outlet

## Instructions for the time and temperature controller

1. Press POWER key to turn on the instrument. The TEMP will display 131 F (default) while the TIME will display 5 minutes (default).
2. Press START key to start the session. The indicating light will be on.
3. Press FOOT HEAT key to heat the bottom footpad.
4. Temperatures range from 113-150 F, 131 F would be considered the middle temp, 150 F is the highest temperature available.
5. Times range from 1-30 minutes, you can increase or decrease the time in increments of 5 minutes by pressing the (+) or (-) keys.

CAUTION: Please be aware of that the metal frame of the chair will warm and increase in temperature while being used.

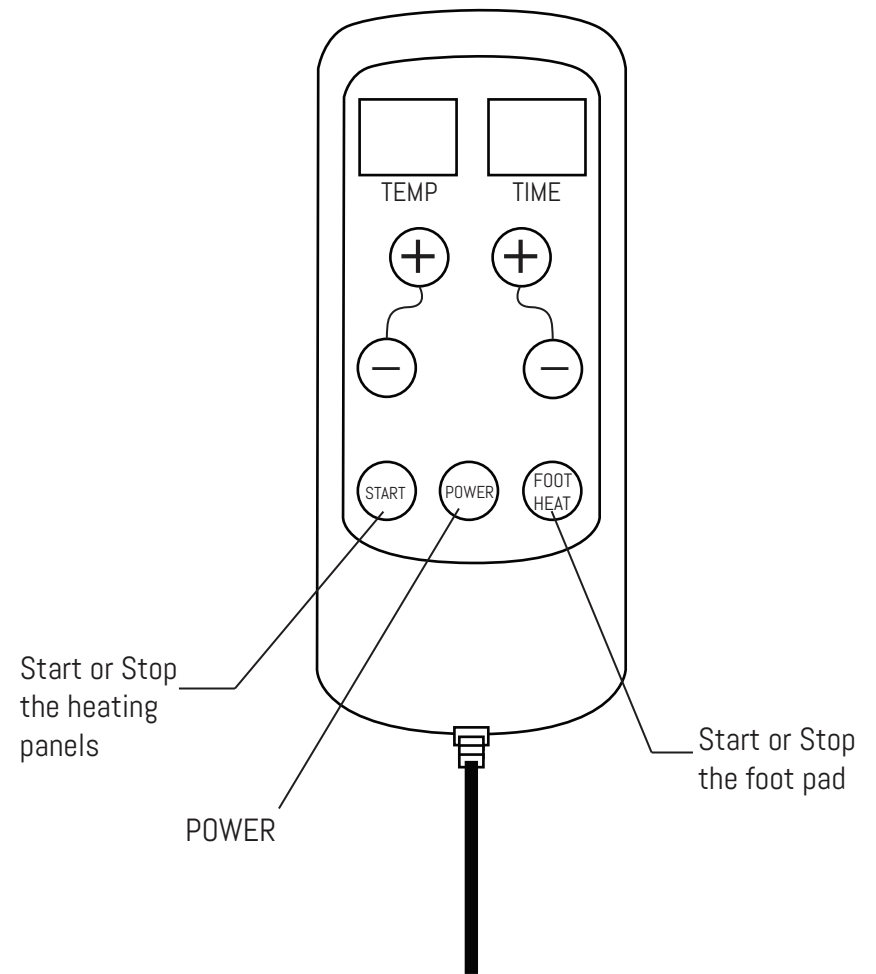

## INSTRUCTIONS AND PRECAUTIONS

1. This is a product for relaxation and rejuvenation. This product is not intended for use by persons with reduced physical, sensory, or mental capabilities. If you are under 18 years of age, elderly, or infirm, you should consult with a healthcare professional before using this product.
2. If you are pregnant, or have diabetes, a pacemaker or defibrillator implant, a blood-based disorder, a skin disease, a respiratory condition, a heart condition, high or low blood pressure, any medical condition or are under medical care, you should consult with a healthcare professional before using this product.
3. Stop using the Sauna immediately if you feel uncomfortable, dizzy, or sleepy.
4. Staying in the Sauna too long may cause overheating. Initially it is recommended that the sauna be used no more than 30 minutes per session by any one user.
5. It is recommended to stay well hydrated with water and replace electrolytes lost during perspiration.
6. Do not use in or around water due to the danger of electrical shock. This product is designed for indoor use only.
7. Do not position this Sauna near sources of heat or electromagnetic radiation such as radiators, heat registers, stoves, television sets or magnetized objects.

8. Sharing power sources with unrelated products, overloading power cords and strips and using non-standard power sources are not recommended.

9. If smoke is ever detected from this product, immediately unplug from the outlet and contact the Customer Service Department at Comsis Computer during standard business hours.

10. It is not recommended to sit fully inside the sauna. It is designed to keep your head outside the tent while using a chair to sit inside.

## TO CLEAN, FOLD AND STORE

Open the zipper to ventilate and cool. After each use, remove any condensation or perspiration from the chair and the interior of the unit with a clean damp cloth. Do not use any cleaning agents or solvents. We recommend the use of natural cleaning agents.

After the Sauna has been wiped off and is fully cooled, simply reverse the steps above to fold for storage.

If left assembled, unplug the power cord after each use.

## WARRANTY

Angels Investments LLC ("Durasage ") warrants that its products will be free from defects in workmanship and materials under normal use for the period listed below (the "Limited Warranty Period").

One Year Limited Warranty Period: One and a half Year (1.5) from original purchase date

All Electronic Durasage Products unless otherwise stated.

During the Warranty Period, Durasage will repair, replace, at no charge, products or parts of a product that proves defective because of improper material or workmanship, under normal use and maintenance.

What does this limited warranty not cover?

- Normal wear and tear of product use
- Misuse, lack of care, mishandling, accident, abuse, or other abnormal use
- Use of the Product other than for its intended purpose
- Damage caused by improper or unauthorized repair or maintenance
- Product that has been modified or altered
- Any product that is not manufactured by Durasage
- Any Product that is not purchased from a Durasage authorized retailer

## CLAIMS

Claims must be initiated during the Warranty Period. Claimant will be required to provide proof of purchase and the date of Product purchase (unless the Product was registered at the time of purchase) and may be required to return the Product or component to Seller at Claimant's expense).

To initiate a claim, please scan the QR code below to send us a message.

## Customer Service Department

Please scan the QR code to send us an email if you have any questions or concerns.

Angels Investments, L.L.C.  
Telephone (480) 878-4789  
Support@duragehealth.com  
1609 W 17th St, Tempe, AZ, 85281

### Legal Disclaimer:

These statements have not been evaluated by the U.S. Food and Drug Administration. This product is not intended to diagnose, treat, cure or prevent diseases. If a condition persists, contact a doctor. We recommend that you do not rely solely on the information presented and that you always read labels, warnings, and directions before using or consuming a product. This is not a medical device.

SCAN ME

