

# INSTALLATION INSTRUCTIONS

## DRAG SPECIALTIES GAS TANK P/N DS-390078, DS-391272

**CAUTION:** Gas tanks **MUST** be properly installed, sealed and pressure tested **BEFORE** painting.

**ATTENTION INSTALLER:** (if other than owner): Please forward this instruction sheet to the purchaser of this product. These instructions contain valuable information necessary to the end user.

**INTRODUCTION:** These instructions describe the procedure for properly installing rubber-mounted Quick-Bob gas tanks on 82-02 XL models.

Review instructions carefully before beginning, as they contain important information. Please retain for future reference.

Particularly important information is distinguished in these instructions by the following notations:

**NOTE:** A NOTE provides key information to make procedures easier or clearer.

**CAUTION:** A CAUTION indicates special procedures that must be followed to avoid damage to the motorcycle and/or accessories.

**WARNING:** A WARNING indicates special procedures that must be followed to avoid injury to a motorcycle operator or person inspecting or repairing the motorcycle.

### TOOLS REQUIRED:

7/16" combination wrench  
1/2" combination wrenches  
9/16" combination wrench  
Large adjustable wrench  
1/8" hex key  
1/4" hex key  
Flat blade screwdriver

**CAUTION:** Tank should be mounted, then removed, sealed on the inside and then pressure tested before painting to prevent leaks. When mounting tank, do not stress any of the mounting tabs as this could cause failure at a later date, use washers for shims if necessary.

### PROCEDURE:

Begin by placing the motorcycle on its side stand.

1. Drain fuel from existing gas tank into an approved container. Make sure you are in a well ventilated area away from any flame or sparks. Remove the existing gas tank and retain the OEM petcock.



2. Mount front bracket (6) on to frame using bolt (7), star washers (8) and nut (9). Pass the bolt through unthreaded hole closest to the front of the bracket, then through the front frame mounting hole.

3. On 883 models only, attach horn bracket (15) to front bracket (6) using bolt (14), star washers (8) and nuts (9).

4. Attach OEM coil and coil bracket using button head screws (13), star washers (8) and nuts (9). Coil bracket attaches to holes on front bracket that are farthest back.

## DRAG SPECIALTIES

Box 9336, Minneapolis, MN 55440

# INSTALLATION INSTRUCTIONS

## DRAG SPECIALTIES GAS TANK P/N DS-390078, DS-391272

**NOTE:** On 95-99 models use the included coil bracket to mount the coil, replacing the OEM threaded back plate with the provided "L" shaped threaded back plate. The "L" should hang down on the right side of the bike. Attach the ignition switch housing to the front side of this bracket using the original button-head screw.

5. Install rubber grommets (3) into holes in front of fuel tank, then push inserts (4) into grommets.
6. Push shoulder inserts (10) into rubber shoulder spacers (11).
7. Pass double-threaded bolt (12) through rear tank mounting hole in frame tube, then assemble rubber shoulder spacers/inserts and washers (2) on to bolt. Tighten securely.
8. Attach petcock to tank using thread sealer and adapter (5) if necessary.
9. Carefully slide tank on to rear mount until front grommets align with threaded holes in front mount. Install assembly using bolts (1) and washers (2). Tighten securely.

**WARNING!** Check all mounts and fuel line fittings before filling with fuel. Double-check all fuel lines and fittings for leaks. Check all electrical wiring to be sure it is not binding or pinched. Test ride motorcycle and recheck all fuel lines and fittings for leaks.

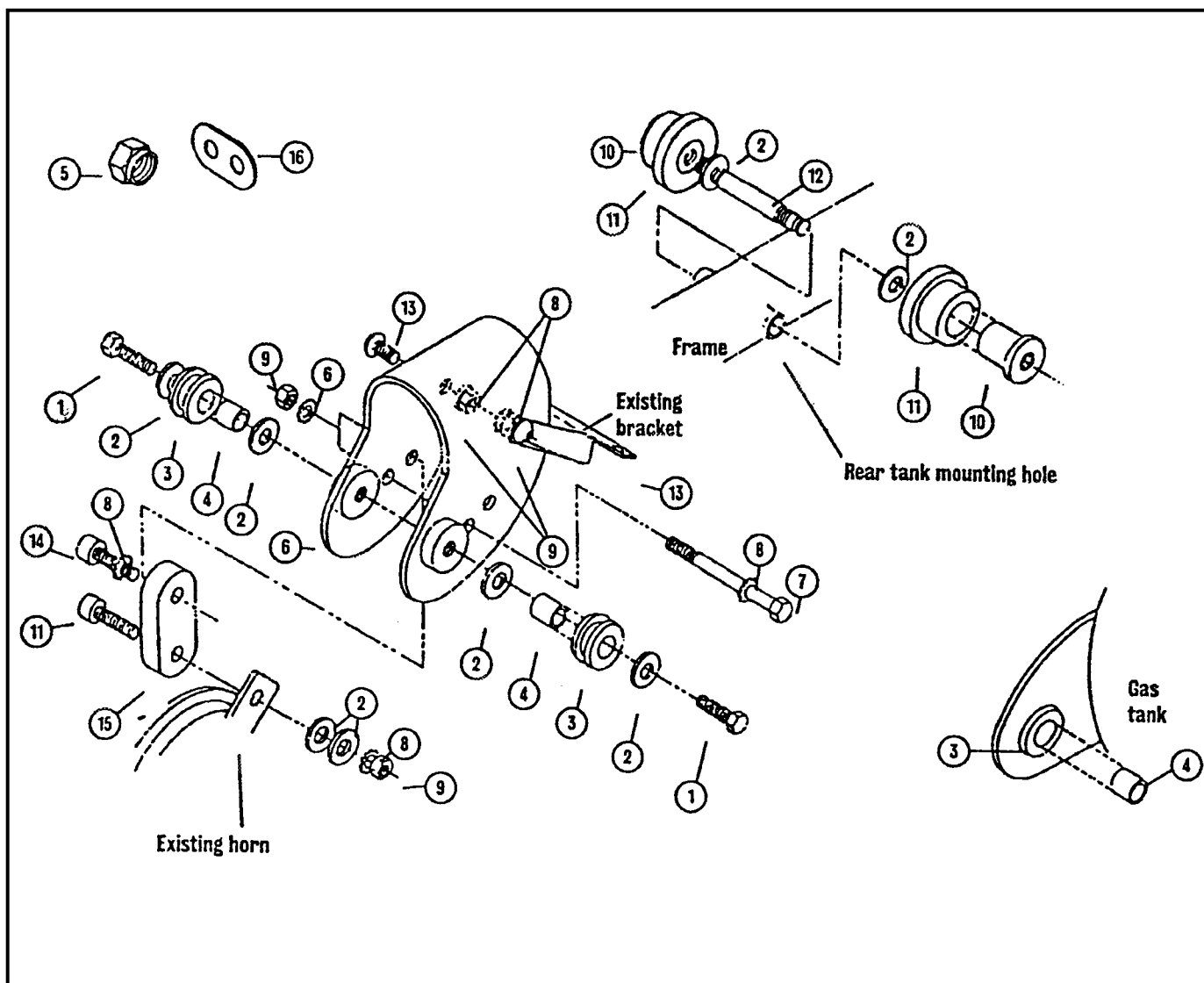

**DRAG SPECIALTIES**

Box 9336, Minneapolis, MN 55440