



INSTRUCTIONS: SOLID LIFTER KIT

Colony Part No. 8603-8 (Lowbrow Sku: 004960)

This kit contains four sleeves needed to convert hydraulic lifters (tappets) to solid tappets for use in 1984-1999 Evolution engine.

Modifying Tappets:

1. Remove tappets from tappet guides and mark them so they will be returned to their original locations.
2. Bleed down tappet following Service Manual procedure.
3. See Figure 1. Press down on socket in tappet and remove retaining clip.
4. Remove socket, plunger and spring from tappet.
5. See Figure 1. Insert sleeve from kit into tappet. 1984-early 1985 use longer cylinder, slotted end up (toward pushrod). Late 1985-1999 use the smaller spacer only, either end up. Place socket into tappet and replace retaining clip.
6. Repeat steps 2 thru 5 for the remaining tappets.
7. Install tappets and tappet guides following Service Manual procedures.

Installing and Adjusting Pushrods:

1. Rotate engine so both front cylinder tappets are at their lowest point.
2. Check condition of o-rings in pushrod covers and replace if required.
3. Insert the pushrod cover for the front cylinder exhaust valve into the hole in the cylinder head. The cover may be held in position with a rubber band and a paper clip hooked into the bottom of the lower pushrod cover.
4. See Figure 2. Loosen locknut on one of the long pushrods and turn adjuster clockwise to shorten pushrod.
5. Insert long pushrod, with adjuster end down, through pushrod covers, hole in head and lower rocker box at the front cylinder exhaust valve.
6. Insert ball end of adjuster into tappet socket.
7. Place rocker arm socket on ball end of pushrod and insert rocker arm shaft.

Engine must be cold before adjusting pushrods and tappets must be at their lowest position. Long pushrods are for exhaust valves and shorter pushrods are for intake valves.

8. Turn adjuster on pushrod until zero clearance exists in valve train. Pushrod should turn with slight drag and no up-down "shake".
9. Hold adjuster with a 7/16" open-end wrench and tighten locknut down against adjuster. If pushrod turns with locknut, use three open-end wrenches: that is, one wrench to hold pushrod, one end to turn locknut and one to hold adjuster.
10. Repeats steps for the remaining pushrods.
11. Install pushrod spring cap retainers on pushrod covers.
12. Replace upper and middle rocker covers following the procedure in the Service Manual.

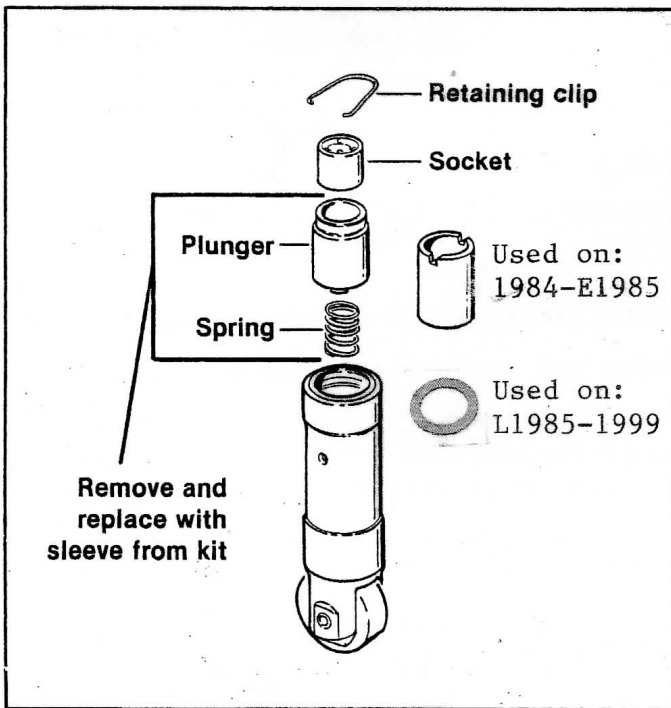

Figure 1

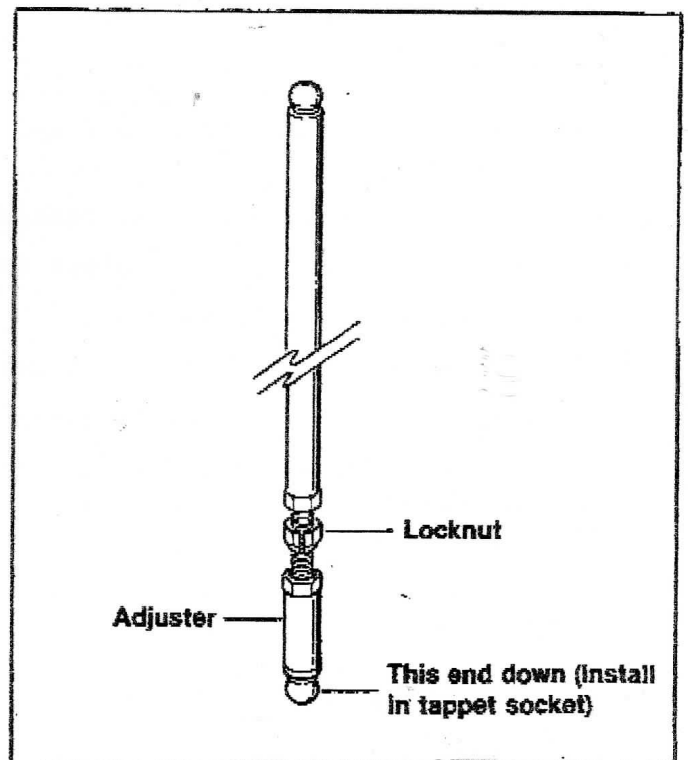

Figure 2

COLONY

**LOWBROW
CUSTOMS**
MOTO PARTS & ACCESSORIES