

A 280L frost free vertical freezer with a stainless steel finish, 6 full width freezer baskets & electronic temperature controls. Can be paired with fridge model WRB3504SA to provide you with plenty of fresh food and freezer storage.

RRP AUS \$1,849.00



Product Details

FEATURES

Quick freeze function

Freezer temperature alarm

Pigeon pairing capability

Twist ice and serve
(removable)
make ice with ease and cool
drinks at a twist

Full-width freezer baskets

Multi-flow air delivery system

Electronic temperature
controls

R600a refrigerant
better for the environment

BENEFITS

Pigeon Pair

Westinghouse's vertical fridges and freezers can be combined in one space to give you a pigeon pair. This provides you with the maximum fresh food and freezer storage in one unit- truly the big fridge for the big family

Twist ice & Serve

Twist ice and serve with ice caddy provides you with easy access to more ice, more often

Full-width freezer baskets

Easy storage, ultimately reducing the time you need to keep the door open and making life easier when entertaining or preparing for the family.

Specifications

PRODUCT PROFILE

Domestic warranty details (yrs)	2
Additional domestic warranty for the sealed refrigeration system only (yrs)	3
Refrigerator Type	vertical freezer
Exterior door finish	Stainless steel
Fridge door opening	reversible
Cooling system	frost free
Refrigerant	R600a

DIMENSIONS

Total height (mm)	1746
Cabinet height (mm)	1746
Total width (mm)	595
Cabinet width (mm)	595
Total depth (mm)	700
Cabinet depth (mm)	560
Depth door open 90degree (mm)	1175
Freezer Compartment Capacity AS/NZS IEC 62552-3 (L)	254
Total Capacity AS/NZS IEC 62552-3 (L)	254
Freezer compartment capacity (gross in litres)	280
Total Gross Capacity (L)	280

ENERGY

REFRIGERATOR SYSTEM

ENERGY

Energy Star Rating AS/NZS 3
IEC 62552-3

Energy Consumption 286
AS/NZS IEC 62552-3
(kWh/year)

Energy Star Rating AS/NZS 3.0
4474.2:2009

Energy consumption 352
AS/NZS 4474.2:2009
(kWh/yr)

FREEZER COMPARTMENT

ICE FACILITY

Ice cube storage bin 1

Twist ice and serve 2

BASKET/DRAWER

Full width plastic basket 4

Basket/Drawer runner system rollers

REFRIGERATOR SYSTEM

Controls electronic (with display)

Controls location external

Controls type touch

Control functions quick freeze function, freezer temp alarm, eco mode

SHELVING

Shelving glass shelf

Type of shelf spill safe shelf

Number of shelves 2

OTHER PROPERTIES

Half width shallow freezer drawer 1

Dimensions

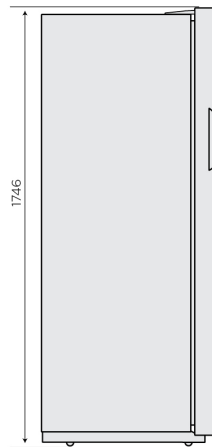
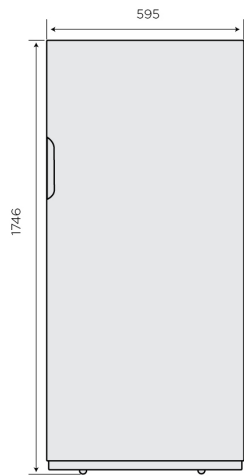

Recommended minimum clearances

Please note: Doors are designed to sit proud of cabinetry (not flush).

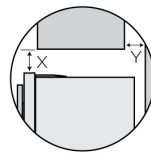

If you have a cupboard above the refrigerator with a rear gap of less than 100mm (Y), recommended minimum clearance at the top of the refrigerator increases from 30mm to 70mm (X).

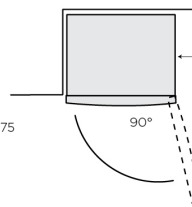
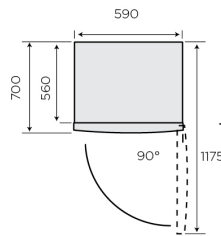
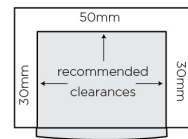

When positioned in a corner area, clearance of at least 350mm on the hinge side will allow the doors to open enough to enable the removal of the bins and shelves.

Terms and Conditions

IMPORTANT

This is a guide of product dimensions only. For complete installation instructions, refer to the manual provided with product.

PRODUCT INFORMATION

The descriptors and illustrations in this publication apply to the specific products and models described as at the date of issue. Under our policy of continuous product development, product specifications may change without notice. Prospective purchasers should therefore check with their retailer to ensure this publication correctly describes the products that are being offered for sale. All information supplied is to be used for general reference purposes only and is on the understanding that Electrolux Home Products Pty Ltd (Australia) and Electrolux (NZ) Ltd (New Zealand) will not be liable for any loss, liability or damage of whatever kind arising as a result of reliance on such information. Colours of products illustrated are as close as printing limitations allow. Electrolux will at all times comply with its obligations pursuant to law including Trade Practices (Australian Consumer Law) Act and Regulations.

WARRANTY

This warranty only applies to Appliances purchased and used in Australia or New Zealand and used in normal domestic applications and is in addition to (and does not exclude, restrict, or modify in any way) any non-excludable statutory warranties in Australia or New Zealand. All warranties are subject to the conditions set out in the warranty card accompanying the product when purchased.

ELECTROLUX HOME PRODUCTS AUSTRALIA

telephone: 1300 363 640

fax: 1800 350 067

email: customercare@electrolux.com.au

web: www.electrolux.com.au

ELECTROLUX HOME PRODUCTS NEW ZEALAND

telephone: 09 573 2230

fax: 09 573 2221

email: customercare@electrolux.co.nz

web: www.electrolux.co.nz