

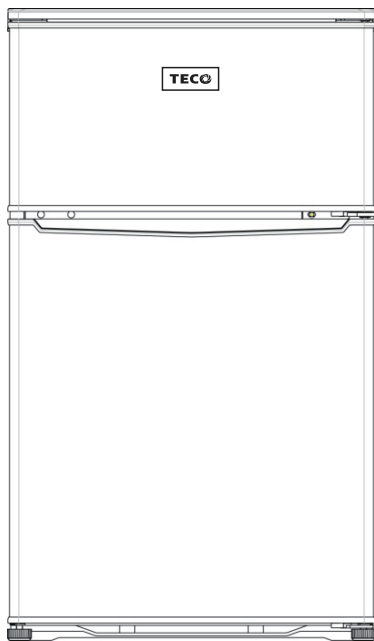

The Comfortable Choice

REFRIGERATOR / FREEZER

User Manual



Model:

TBF86WMTAG

TBF86SMTAG

TBF86BMTAG

IMPORTANT NOTE:

Thank you for selecting a TECO quality Refrigerator. Please read this manual carefully before installing or operating your new appliance. Make sure to save this manual for future reference.

The design and specifications are subject to change without prior notice for product improvement.

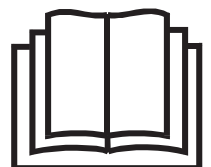

TABLE OF CONTENTS

| | |
|---|-----------|
| Important safety instructions..... | 1 |
| Parts and features..... | 4 |
| Installation instructions..... | 5 |
| Operating instructions..... | 5 |
| Cleaning..... | 6 |
| Defrosting..... | 6 |
| Power failure..... | 7 |
| Vacation..... | 7 |
| Moving the refrigerator..... | 8 |
| Troubleshooting tips..... | 8 |
| Reversing the door..... | 10 |
| Replacement of interior light..... | 11 |
| Specifications..... | 12 |
| Repairs, service & warranty..... | 13 |

IMPORTANT SAFETY INSTRUCTIONS

- Thank you for purchasing our product and thank you for placing your confidence in us.
- Read this manual carefully before use. Follow instructions and keep the manual for future reference.
- Follow the operating instructions and safety notices in this manual.
- If any trouble arise, do not attempt to fix it yourself. Please contact TECO service on 1300 660 037 (8:30am - 4pm Mon~Fri AEST).
- This refrigerator is designed and approved for use with flammable R600a refrigerant.
- The appliance is specifically constructed for domestic use only. The appliance has not been designed or manufactured for professional use. TECO declines all responsibility for damage deriving from improper use of the appliance. The refrigerator has undergone the necessary tests on the tightness of the refrigeration circuit and complies with the safety regulations for electrical appliances.
- All images, illustrations and photos contained in this manual are for illustration purposes only and may differ from your appliance.



WARNING ICON

This symbol indicates information concerning your personal safety



CAUTION ICON

This symbol indicates information on how to avoid damaging the appliance.



FLAMMABLE ICON



R600a WARNING LABEL



R600a Isobutane Refrigerant

- This appliance contains a small quantity of flammable, non-synthetic R600a refrigerant.
- The room for installing the appliance must be at least 1m³ per 8g of refrigerant. The amount of refrigerant in the appliance can be found on the rating plate attached to the appliance.



Risk of fire

- If the refrigerant circuit should become damaged. Avoid open flames and sources of ignition. Disconnect the appliance from the mains power. Thoroughly ventilate the room in which the appliance is situated for several minutes.
- The refrigerator is designed to operate on a single phase power supply within a voltage range of 220~240V/50Hz.
- The refrigeration system contains refrigerant. Do not allow any sharp objects to come in contact with the refrigerant system to avoid damage the refrigerant circuit.
- This product is for indoor use only.
- Do not place electrical items or cooking equipment nearby. Keep away from substances which could cause ignition and good ventilation shall be always maintained.
- Do not place objects on top of the appliance which are magnetic, heavy or filled with water.
- If the supply cord is damaged, it must be replaced by authorised TECO service personal, service agent or similarly qualified persons in order to avoid a hazard.
- Do not store flammable, explosive, volatile and highly corrosive materials in the refrigerator. Containers with flammable gases or liquids can leak at low temperature. There is a risk of explosion or fire.
- Do not splash water on the appliance. It may cause malfunction or electricshock.
- Always switch off and unplug appliance before cleaning.

- Keep ventilation openings, in the appliance enclosure or in the built-in structure, clear of obstruction.
- Do not use mechanical devices or other means to accelerate the defrosting process, other than those recommended by the manufacturer.
- Do not use electrical appliances inside the food storage compartments of the appliance.
- For appliances which use flammable insulation blowing gases, Please keep the products away from the fire or similar glowing substance.
- This appliance is intended to be used in household and similar applications such as:
 - staff kitchen areas in shops, offices and other working environments;
 - farm houses and by clients in hotels, motels and other residential type environments;
 - bed and breakfast type environments;
 - catering and similar non-retail applications.



- This appliance is not intended for use by persons (including children) with reduced physical, sensory or mental capabilities, or lack of experience and knowledge, unless they have been given supervision or instruction concerning use of the appliance by a person responsible for their safety.

- Young children should be supervised to ensure that they do not play with the appliance.
- Packing (e.g. wraps, polystyrene etc.) can be dangerous for children. There is a risk of suffocation. Keep packaging materials away from children.
- Contact your local authorities for correct method of disposal. Dispose of all packaging in a responsible manner in accordance with local regulations.



Dispose of old appliances in accordance with local regulations. Remove the doors, cut off the main cable, break or remove spring or bolt catches if fixed to prevent children getting trapped or involve themselves in other dangers.

PARTS AND FEATURES

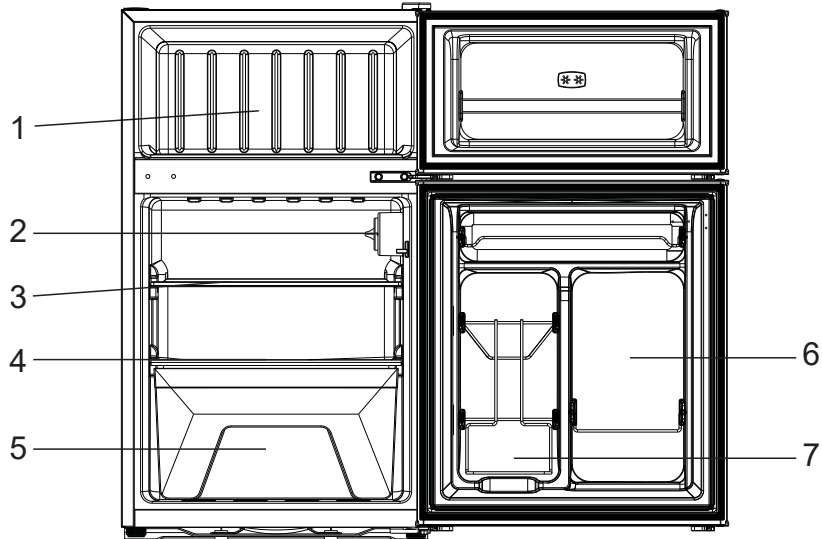

1. Freezer compartment
2. Interior light and temperature control knob
3. Removable glass shelf
4. Glass crisper cover
5. Vegetable crisper
6. Bottle storage
7. Can dispenser

INSTALLATION INSTRUCTIONS

1. Before using the refrigerator for the first time, remove all of the packing materials, including the foam base and adhesive tape holding accessories in place.
2. The refrigerator should be located on a firm, flat surface that is strong enough to support the refrigerator when it is fully loaded.
3. Choose a location that is not exposed to direct sunlight, high temperatures, heat sources such as a stove or radiator, or in a moist area. Do not choose a location where the temperature will go below 12°C as this could cause the refrigerator to not function properly.
4. Leave a minimum of 50mm between each side of the appliance and the wall. The top of the appliance should have a minimum of 300mm clearance. This allows for proper air circulation. This appliance is intended to be free-standing and should not be built-in or placed in a recessed area.
5. The refrigerator legs must be adjusted during installation in order to function properly. The leveling legs on the front corners can be adjusted by turning clockwise to raise the appliance, and counter-clockwise to lower it. Be sure to have the appliance slope slightly backward to ensure that the door closes tightly.

OPERATING INSTRUCTIONS

1. Allow refrigerator to stand up right for 4 hours before using.

2. Plug into a grounded outlet.

3. Use the control dial to control the temperature of the refrigerator manually. As shown in Figure, The numbers shown on the dial does not represent the temperature, instead the larger number is, cooler the interior temperature. To stop the cooling, turn the dial to "0".

Do not switch off the power.

- Turn the knob to number "4" for normal use.
- Turn the knob to number "5-7", when cooler temperature needed.
- Turn the knob to number "1-3", when warmer temperature needed.

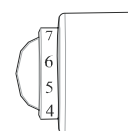
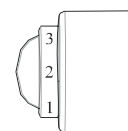

4. Food should be kept in a sealed container to prevent odors or drying.
5. Hot food should be cooled down before placing into the appliance to prevent an increase in interior temperature and power consumption. Adding food in too soon will impact the performance.
6. Reducing the frequency of door opening can lower power consumption.

CLEANING



WARNING

The appliance should be maintained and cleaned frequently. For your safety, unplug the appliance from the mains power source before performing any maintenance.

Interior

Clean the interior of the appliance with a mixture of warm water and baking soda, using about 1–2 tablespoons per liter of water. Use a sponge or soft cloth and be sure to wring excess moisture out before cleaning around the controls.

Rinse thoroughly with warm water and dry with a clean, soft cloth.

Exterior

The exterior surface can be cleaned using warm water and a mild detergent.

Rinse thoroughly and dry with a clean, soft cloth.

Door Gasket

The door gasket must be kept clean to ensure a proper seal. Be sure to clean the gasket frequently, using the method described above.

DEFROSTING

Frost build-up on the walls of the ice making section will increase energy consumption and reduce the efficiency of the appliance. Defrost the section whenever the frost reaches a thickness of 5mm.

1. Remove food from the refrigerator and ice making compartment.

2. If your model has a drip tray, be sure to place it under the ice making compartment to collect water. It may be necessary to empty the drip tray during the defrosting process.
3. Turn the unit off and unplug it from the outlet.
4. The defrosting process can take several hours. Open the door to speed up the process.
5. When defrosting is completed, wipe the compartment with a soft cloth to remove any remaining water.
6. Reset the refrigerator to the desired temperature.
7. Refer to Operating Instructions.



ATTENTION: Do not use sharp or pointed objects to remove frost or ice from the surfaces of the ice making compartment. This can cause damage to the compartment walls and cooling coils, and will void the warranty.

POWER FAILURE

When a power failure occurs, the refrigerator can normally store food for several hours. Do not put additional food into the appliance during a power failure, and do not operate door. Disconnect the plug from the outlet, and reconnect when the power has been restored. **Always inspect for, and discard, any spoiled or thawed food in the refrigerator before resuming use of the appliance.**

VACATION

Before leaving on any vacation, remove food that could spoil while you are gone. If you plan to be gone for an extended period of time, we recommend that all of the food should be removed from the appliance and it should be turned off and unplugged from the outlet. Clean the interior according to the directions provided in the CLEANING section of this manual, and leave the door open.

MOVING THE REFRIGERATOR

1. Turn off the refrigerator and unplug from the outlet.
2. Remove all food; securely tape down all loose items inside.
3. Tape the door shut.
4. Do not lift or pull the door or door handle during transportation.
5. When moving, the appliance cannot be tilted over 45 degrees as possible damage to the sealed system could occur.
6. Take care to avoid strong vibration or impact to the appliance.

TROUBLESHOOTING TIPS

| Problem | Possible Cause | What to do |
|---|---|---|
| Refrigerator does not operate | <ul style="list-style-type: none">• Not plugged in correctly• Tripped circuit breaker or blown fuse• Problem with electrical outlet | <ul style="list-style-type: none">• Unplug, wait 10 seconds, then plug in again• Replace fuse or reset circuit breaker• Consult with a professional electrician |
| Refrigerator seems too warm/ food does not seem to cool | <ul style="list-style-type: none">• Temperature setting may be too warm• Door not closed tightly• Door opened too frequently | <ul style="list-style-type: none">• Lower the temperature setting• Check to make sure nothing inside is causing the door to not close• This is normal |

| Problem | Possible Cause | What to do |
|---|--|--|
| Compressor runs too long, or cycles on and off frequently | <ul style="list-style-type: none"> . Hot weather . Door opened too frequently . Door not closed tightly . Temperature control set at coldest setting . Large amounts of food placed in refrigerator | <ul style="list-style-type: none"> . This is normal . This is normal . Check to be sure nothing inside the refrigerator is preventing the door from closing . Adjust temperature to a warmer setting . This is normal |
| Moisture forms on the outside of the appliance | <ul style="list-style-type: none"> . This is normal during periods of high humidity . The door is slightly open | <ul style="list-style-type: none"> . Wipe the surface dry using a soft cloth . Close the door tightly |
| Moisture forms on the inside of the appliance | <ul style="list-style-type: none"> . This is normal during periods of high humidity . Door is opened too long or too frequently | <ul style="list-style-type: none"> . This is normal . Do not open the door too long or too frequently |
| Vibration noise | <ul style="list-style-type: none"> . Refrigerator is on an uneven surface . Refrigerator is touching a wall | <ul style="list-style-type: none"> . Adjust the leveling legs . Move the refrigerator away from the wall |

The following are normal conditions that can be encountered during the operation of this appliance:

- . The flow of refrigerant through the coils can cause a noise.
- . The sides of the appliance may become warm as a result of the cooling function.

REVERSING THE DOOR

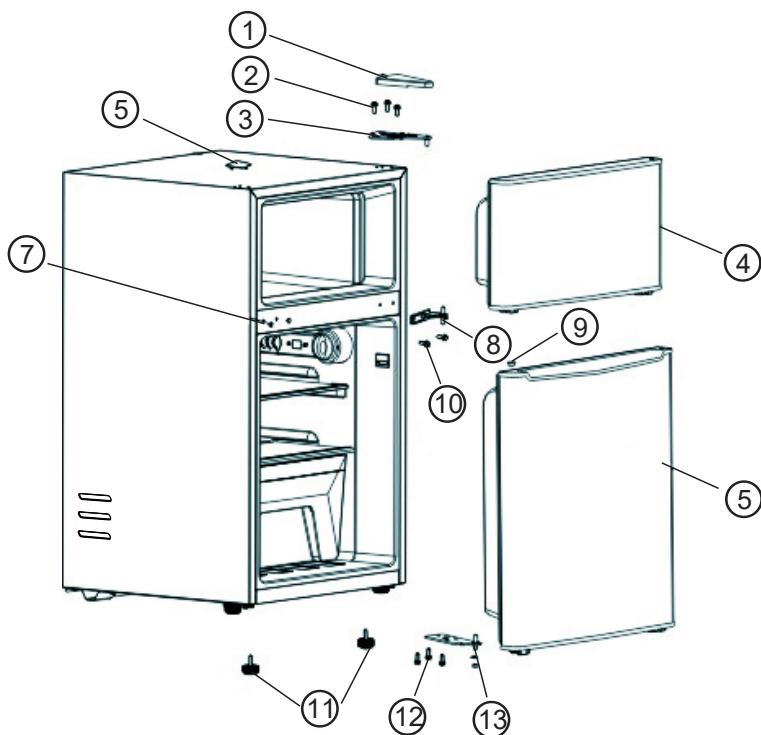

1. Top hinge cover
2. Top hinge screws
3. Top hinge
4. Freezer door
5. Cabinet plugs
6. Refrigerator door
7. Middle plug
8. Middle hinge
9. Refrigerator door plug
10. Middle hinge screws
11. Leveling legs
12. Bottom hinge screws
13. Bottom hinge

1. Remove top hinge cover and 3 top hinge screws which are below it. Then remove top hinge.
2. Remove the freezer door.
3. Remove 2 cabinet plugs and 1 door handle plug.
4. Remove middle hinge screws and middle hinge.
5. Remove the refrigerator door.
6. Remove right and left leveling legs.
7. Remove 3 bottom hinge screws and bottom hinge.
8. Install the bottom hinge on the other side of the leveling legs with 3 bottom hinge screws.
9. Install right and left leveling legs. There are two holes below the refrigerator to fit the two leveling legs.
10. Install the refrigerator door.
11. Install the middle hinge on the other side.
12. Install the freezer door with top hinge and 3 top hinge screws. Then install top hinge cover.
13. Adjust the leveling legs.

REPLACEMENT OF INTERIOR LIGHT

Uninstall the cover and replace the light with a 220V, 10W bulb. Refer to the illustrations and instructions below:

1. Slide the light cover 30-50mm to the left as shown by arrow.

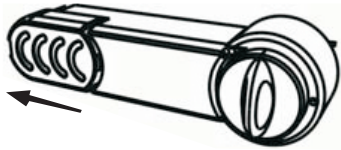

2. Pull and remove the light cover as shown.

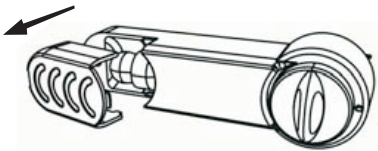

3. Twist bulb in counterclockwise direction to remove.

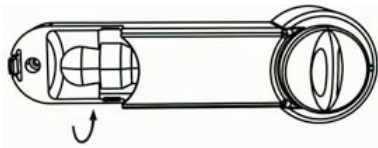

4. Install new bulb and reinstall light cover.

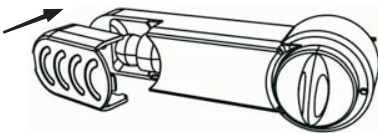

SPECIFICATIONS

| | | |
|--------------------------------|--------------|--|
| Model Number | | TBF86WMTAG TBF86SMTAG TBF86BMTAG |
| Climate class | | T |
| Electric shock protection type | | I |
| Capacity (L) | Refrigerator | 60 |
| | Freezer | 26 |
| Voltage (V) | | 220 - 240 |
| Frequency (Hz) | | 50 |
| Current (A) | | 0.6 |
| Voice [dB(A)] | | ≤42 |
| Refrigerant | | R600a/30g |
| Net Weight (kg) | | 25 |
| Interior temperature | Refrigerator | 0 - 8 °C |
| | Freezer | ≤ -18 |
| Dimension (mm) | Width | 486 |
| | Depth | 536 |
| | Height | 840 |

NOTE: This product is subject to continuous improvement, specifications are subject to change without prior notice. This product was tested in accordance with Electrical safety of electrical appliances AS/NZS 60335, Energy consumption and performance AS/NZS 4474.1 and Energy labelling and minimum energy performance AS/NZS 4474.2.

REPAIRS, SERVICE & WARRANTY

It is hazardous for anyone installing, removing, altering, repairing, servicing, testing or certifying the gas system of a gas device (i.e. charging, discharging or breaking into the refrigeration system that uses hydrocarbon refrigerants).

Only an Authorised Service Person can carry out servicing or repairs to this appliance. In Queensland the authorised person must hold a Gas Work Authorisation for hydrocarbon refrigerants, before carrying out servicing or repairs which involve the removal of covers.

IF SERVICE IS REQUIRED

If you have a problem, and the problem persists after you have made the checks mentioned in this manual, contact:
TECO Australia's Service on 1300 660 037 (8:30am - 4pm Mon~Fri AEST).

For warranty details please visit

www.teco.com.au

Service Email : had.service@teco.com.au

Spare Parts : had.parts@teco.com.au

Did you know?

TECO Australia's product range also includes:

- ◆ Top Load Clothes Washers
- ◆ Front Load Clothes Washers
- ◆ Auto Sensing Vented Clothes Dryers
- ◆ Heat Pump Clothes Dryer
- ◆ Refrigerators
- ◆ Chest and Vertical Freezers
- ◆ Bar Fridges
- ◆ Televisions
- ◆ Air Curtains
- ◆ Air Conditioners

Visit **www.teco.com.au** for our full range.



WARRANTY INFORMATION

Teco's warranty information for the product purchased is available at www.teco.com.au.

A copy of the warranty may also be obtained by contacting Teco's Warranty and Service Department on 1300 660 037 during business hours (Mon - Fri 8.30am – 4pm AEST).

To arrange for servicing of a Teco product, please contact our Warranty and Service Department on 1300 660 037 during business hours (Mon - Fri 8.30am – 4pm AEST).

To assist in processing any warranty claim that you may have Teco recommends that you:

1. Complete the following information in relation to your purchase:

Name of retailer: _____

Name of owner: _____

Date of purchase: _____

Model No. : _____

Serial No. : _____

MFG code: _____

2. Retain proof of your purchase for any warranty claim. Ideally this proof of purchase will be the tax invoice issued for your purchase.

3. Complete the following information in relation to the person that installed your Teco appliance (if applicable):

Installer's name: _____

Telephone No.: _____

Licence No.: _____



www.teco.com.au