

OPERATION, MAINTENANCE AND SAFETY INSTRUCTIONS

FOR OMEGA ALTISE CERAMIC HEATER

MODEL:

OACH15KWR

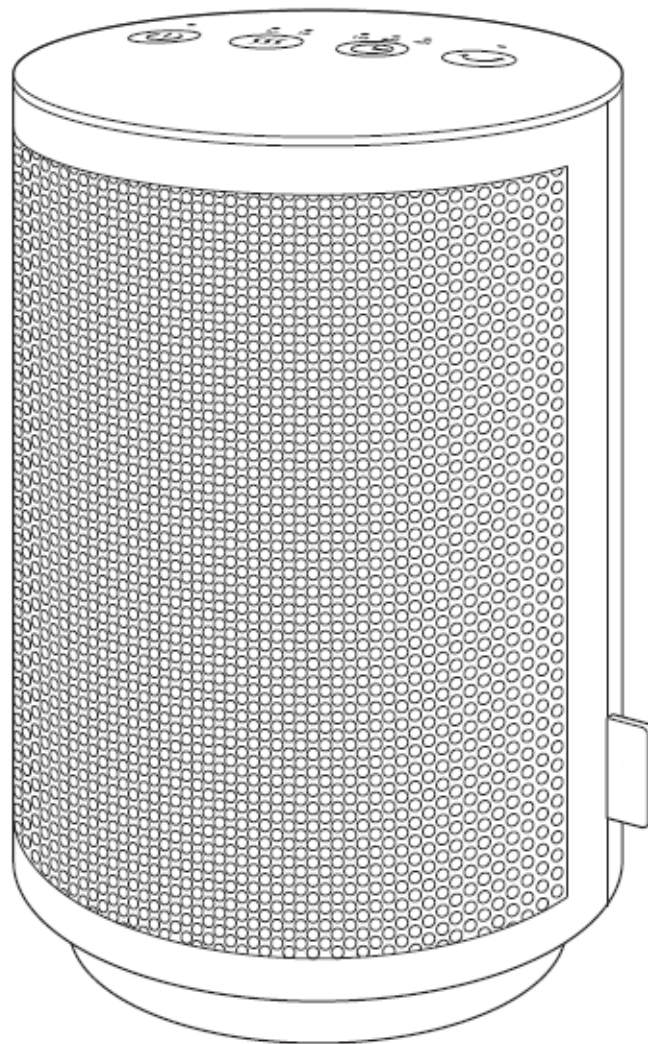



TABLE OF CONTENTS

IMPORTANT SAFETY INSTRUCTIONS	1-2
APPLIANCE DETAILS.....	3
OPERATION.....	4-5
MAINTENANCE AND CLEANING	6
WARRANTY	7

IMPORTANT SAFETY INSTRUCTIONS

Read the safety precautions of this booklet carefully before attempting to assemble, install, operate or maintain the product described. Protect yourself and others by observing all safety information. Failure to comply with instructions could result in personal injury and/or property damage. If you are unsure about anything regarding your heater or these instructions, please contact Omega Altise on 1300 795 572 in Australia or (09) 415 6000 in New Zealand before operating your appliance.

1. Use this heater only as described in this manual. Any other use not recommended by the manufacturer may cause fire, electrical shock, or injury to persons. Do not modify this appliance.
2. Remove the package and ensure that the appliance is undamaged (keep packing box for later storage). In case of doubt do not use the appliance and contact Omega Altise Service. Do not let children play with any parts of the packaging.
3. This appliance is not intended for use by persons (including children) with reduced physical, sensory or mental capabilities, or lack of experience or knowledge, unless they have been given supervision or instruction concerning the use of the appliance by a person responsible for their safety. Children should be supervised to ensure that they do not play with the appliance. Extreme caution is necessary when the heater is used by or near children or individuals with decreased mental and physical capacity and whenever the heater is left operating unattended.
4. Before you use the appliance, check if the voltage marked on the rating label corresponds to the mains in your home. The appliance must be connected to a grounded power supply.
5. Avoid using extension cords as the extension cord may overheat and cause a risk of fire. If the use of an extension cord cannot be avoided, always use one with a minimum rating of 13Amps. Do not use this appliance with a programmer, timer or any other device that switches the appliance on automatically, since a fire risk exists if the appliance is covered or positioned incorrectly.
6. Do not pull the power cord to disconnect with the power source. Always grasp the plug to pull it out.
7. Do not run power cords under rugs or other combustible materials. Do not place power cords in areas where they can be a tripping hazard. Do not operate directly below a power outlet.
8. Do not insert any objects into the heater as it may cause an electric shock or fire or damage to the heater. Do not block or tamper with the heater in any manner while it is in operation. To prevent a possible fire, do not cover the appliance in any manner. Do not place on soft surfaces, like a bed, where openings may become blocked.
9. Do not leave the heater unattended. Always unplug the heater when not in use.

WARNING:  The control buttons and power switch should not be used as the sole means of disconnecting power. Always unplug the power cord before servicing or moving the unit.

10. This heater is hot when in use. To avoid burns, do not let bare skin touch hot surfaces. Always use the handle when moving the heater (where available) or hold on the sides if not available (make sure the unit is turned off). Keep combustible materials such as furniture, pillows, bedding, papers, clothes and curtains at least 1m from the heater to the sides, front, rear & top.
11. The heater has hot and arcing or sparking parts inside. It must NOT be used in potentially dangerous locations such as flammable, explosive, chemical-laden, corrosive, salty or wet atmospheres. This heater is intended for general indoor domestic use ONLY.
12. This heater is not intended for use in wet or damp locations. Never locate a heater where it may fall into a bathtub or other water container.

IMPORTANT SAFETY INSTRUCTIONS

13. Do not use the heater outdoors.
14. This heater includes a tilt switch that turns the heater off if it falls over. Once righted, the heater will completely reset and can be used as normal.
15. Always move or hold the heater from the top & bottom of the appliance, where less heat is generated.
16. NOTE that over time, the front grill section may darken due to the extreme heat being generated by the heater elements. This is a normal occurrence & is not a fault in the heater.
17. Do not use this heater if it has been dropped
18. Do not use if there are visible signs of damage to the heater
19. Use this heater on a horizontal and stable surface.

WARNING:



To avoid danger of electric shock, unplug from outlet when not in use and before cleaning. If the supply cord is damaged, it must be replaced by the manufacturer, its Service Agent or similarly qualified persons in order to avoid a hazard. In order to avoid overheating, do not cover the heater. The heater must NOT be located immediately below a socket outlet. Do not use the heater in the immediate surrounding of a bath, shower or swimming pool.

WARNING: Do not use this heater in small rooms when they are occupied by persons not capable of leaving the room on their own, unless constant supervision is provided.

WARNING: To reduce the risk of fire, keep textiles, curtains, or any other flammable material a minimum distance of 1 m from the air outlet.



Warning: In order to avoid overheating, do not cover the heater

CAUTION: In order to avoid a hazard due to inadvertent resetting of the thermal cut-out, this appliance must not be supplied through an external switching device, such as a timer, or connected to a circuit that is regularly switched on an off by the utility.

CAUTION: Some parts of this product can become very hot and cause burns. Particular attention has to be given where children and vulnerable people are present

APPLIANCE DETAILS

Components

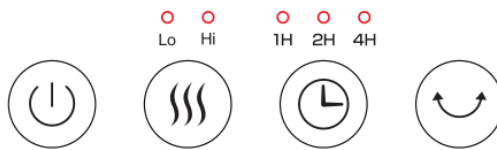
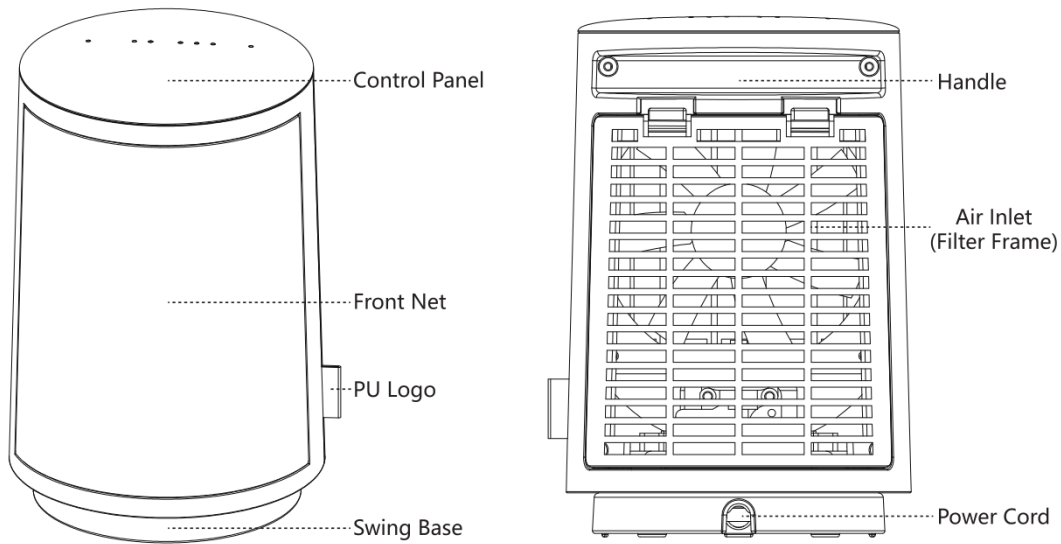



Technical Details

Voltage Rating	220 – 240 Vac ~50 Hz
Power Rating	1500W
Dimensions	145W x 145H x 219D mm
Weight	1.5 kg

OPERATION

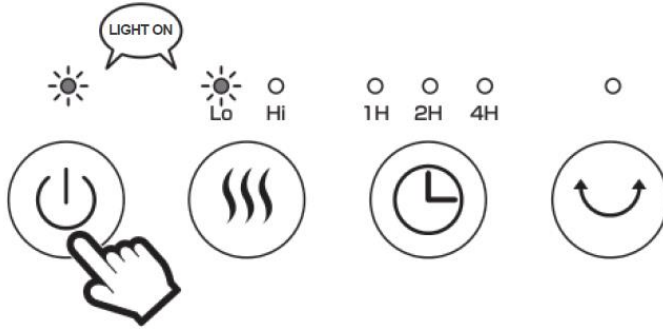
- 1) Press the button “” to turn on the unit, which works as Lo Power & Lo Temp mode for the first time. Press again to turn off the heater and the fan inside will cut off 60s later.



- 2) Press the button “” to choose the power you need, there are two power for setting, Lo&Hi.

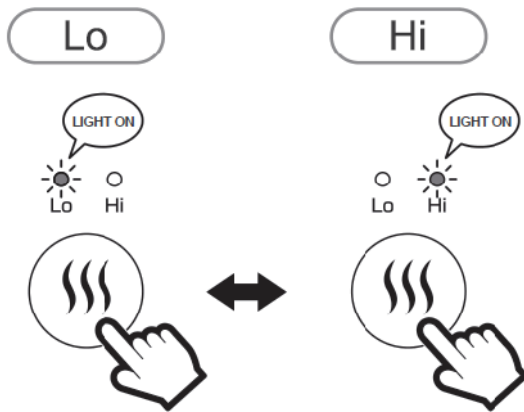

- 3) Press the “” button of the host during operation. Auto shutdown time can be set for 1/2/4 hours. Every time you press the "timing" button, there will be a "wow" sound to switch the setting time. According to the setting, the "timing" indicator light will be on or off.

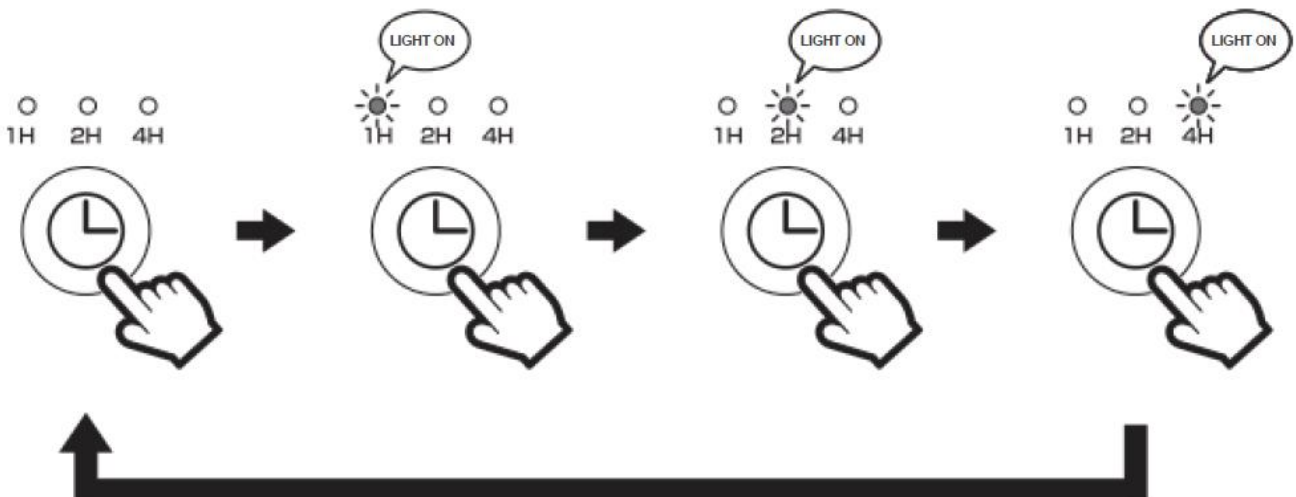

OPERATION

- 4) Press the button “” to turn on or off the auto oscillation function.

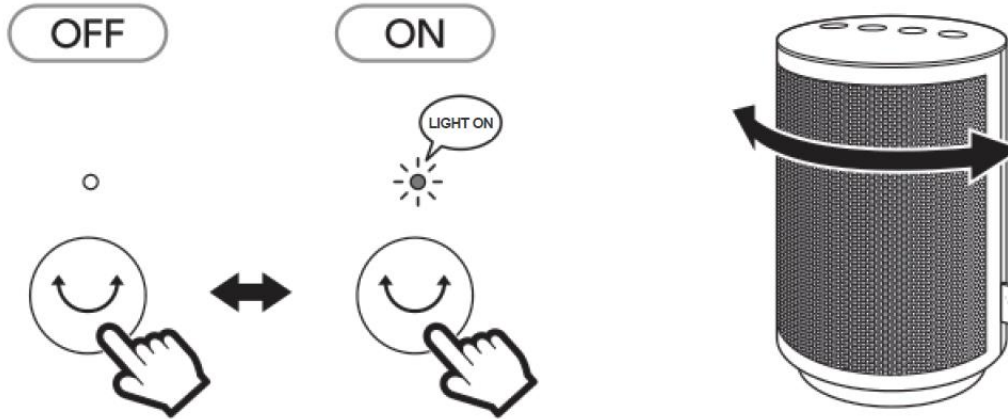

- 5) **Auto power off function**

8 hours after your last operation, the heater will turn off automatically to ensure the safety.

If you do not need this function, you can cancel this function by continuously press “” for 5s within 20s after turn on the heater. This function will resume after re-plug in.

MAINTENANCE AND CLEANING

Before cleaning or performing maintenance disconnect the heater from the power supply and ensure that it has cooled.

Wipe the surface of the heater with a soft, damp cloth. Do not use flammable cleaning agents.

To clean the filter, remove the back cover by pressing down the two clips. Remove the filter from the back cover and clean it. Secure the filter back onto the back cover and reattach the cover onto the heater.

Environmental Protection



To prevent possible harm to the environment or human health from uncontrolled waste disposal, recycle it responsibly to promote the sustainable reuse of material resources.



WARRANTY



AUSTRALIAN CUSTOMERS

Our goods come with guarantees that cannot be excluded under the Australian Consumer Law. You are entitled to a replacement or refund for a major failure and for compensation for any other reasonably foreseeable loss or damage. You are also entitled to have the goods repaired or replaced if the goods fail to be of acceptable quality and the failure does not amount to a major failure.

NEW ZEALAND CUSTOMERS

Nothing herein contained shall be construed in any way as excluding or limiting your rights under the Consumer Guarantee Act 1993.

Our Warranty

This product is also covered by the manufacturer's warranty set out in this document (**Our Warranty**). Our Warranty is for a period of **twelve (12)** months from the date of purchase. This is in addition to (and does not exclude, restrict or modify) any rights or remedies to which you may already be entitled under the Australian Consumer Law or the New Zealand Consumer Guarantee Act 1993 relating to this product.

Our Warranty (which is subject to the conditions below) covers rectification free of charge of any fault arising from defective materials or components, or faulty workmanship. The product will be repaired or replaced at the option of Omega Altise.

OUR WARRANTY is subject to the following conditions:

1. That the purchaser contact Omega Altise prior to any product repair.
2. That the purchaser carefully follows all instructions provided with the product and complies with all relevant electrical & plumbing regulations in their State when installing the product.
3. That the purchaser carefully follows the instructions provided in the owner's handbook relating to the proper use and care of the product and does not use the product for any purpose other than the DOMESTIC use for which it has been designed. If the appliance is used in commercial applications or for rental purposes, Our Warranty is limited to a warranty of Twelve (12) months covering all parts with Three (3) months on any labour cost of service or repair.

WHAT IS COVERED: By Our Warranty:

During the warranty period, Omega Altise or its authorised Service Centre will at no extra charge, if your appliance is readily accessible without the need of special equipment and subject to the terms and conditions of this warranty, repair or replace any parts which it considers defective.

WHAT IS NOT COVERED: By Our Warranty:

1. Products installed damaged or incomplete or not in compliance with the relevant electrical & plumbing regulations in their State.
2. Normal wear and tear e.g. cleaning, filters etc.
3. Failure resulting from power surges and electrical storms.
4. Insect or vermin infestation.
5. Unauthorised repairs or use of non-genuine parts.
6. Any failure caused by the product not being used in accordance with the instruction and the installation manual provided with the product.
7. Misuse or abuse, including failure to properly maintain or service.
8. The clearing of lint, hair or dirt from within the appliance.
9. Damage which occurs during delivery or installation.
10. Claims to product surface coating due to liquid or solid spill-overs, accidental damage or damage caused from cleaning products not recommended by Omega Altise.

HOW TO CLAIM OUR WARRANTY

Please refer to our website address below for Shriro Australia in Australia or Monaco Corp in New Zealand to register your warranty online. If you are contacting us regarding any warranty claims and spare part enquiries, please make sure you have the following information on hand:

1. Product Name/Model Number
2. Serial Number
3. Purchase Date (as per invoice, or proof of purchase)
4. Purchased from
5. Warranty Registration Number

IN AUSTRALIA

Omega Altise is a division of Shriro Australia Pty Limited
 ABN 28 002 386 129
 Customer care: 1300 739 033
 Email: customercare@shriro.com.au
 Web: www.omegaaaltise.com.au

IN NEW ZEALAND

Omega Altise is a division of Monaco Corporation Ltd
 (Member of Shriro Australia PTY LTD)
 Phone (09) 415 6000
 Email: customercare@monacocorp.co.nz
 Web: www.omegaaaltise.com.au

It is important that you retain these instructions, proof of purchase as well as other important documents about this product for future reference. Due to continual product development, Omega Altise reserves the right to alter specifications or appearances without notice.

Dispose of packaging responsibly – recycle where facilities are available.