

TOURING ITEMS
TYPES[®]

SMART WHEEL WELL LIGHTS

6 Diecast Aluminium LED Pods

WP ITM. LM532851

Installation Guide & Safety Information

**Important, retain for future reference:
Read carefully**

PACKAGE CONTENTS

4 x Wheel Well Lights
with 135.4" Wire



2 x Wheel Well Lights
with 194.5" Wire

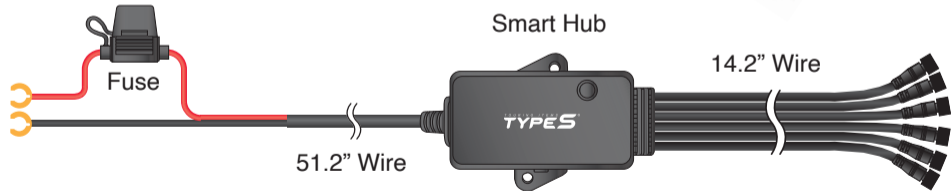

PACKAGE CONTENTS

WHEEL WELL LIGHT ACCESSORIES

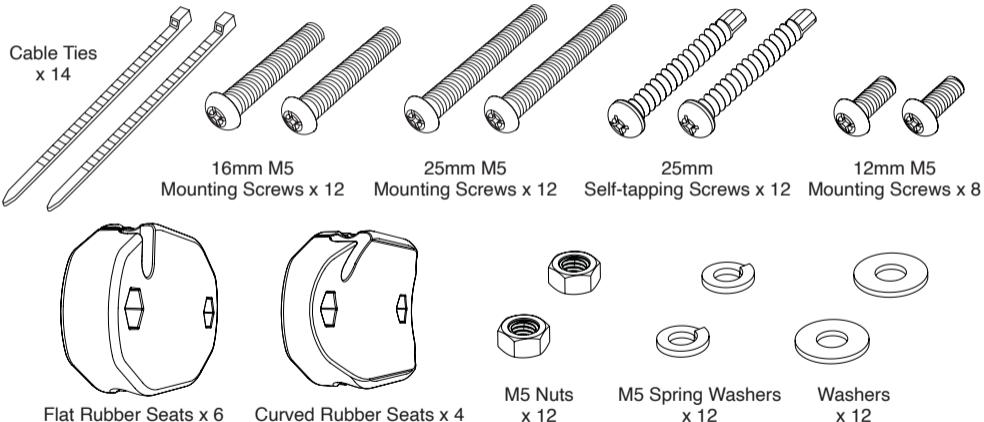

PACKAGE CONTENTS

SMART HUB ACCESSORIES

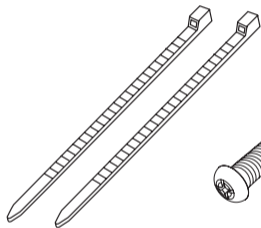

Cable Ties
x 2

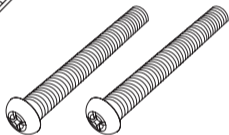

25mm M5
Mounting Screws
x 2

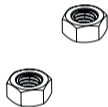

M5 Lock Nuts
x 2

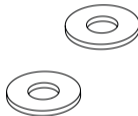

Washers
x 4

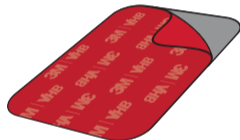

3M™ VHB
Double-sided Tape x 1

TOOLS REQUIRED (NOT INCLUDED)

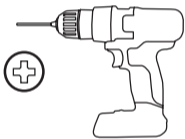

Power Drill with
"#2" Phillips Driver Bit



Safety Glasses



Wrench



13/64 inch Drill Bit

TECHNICAL SPECIFICATIONS

Operating Voltage: 12VDC System Only

LED Power Consumption: 10W

Bluetooth / App Distance: 30 ft Line-of-sight (Obstacles may create interference)

OS Compatibility: iOS & Android

LED Types: RGB 3030

Number of modes: 25

LED Color: 49

Effective Lumens: 205.08LM

IP Rating of Smart Wheel Well Lights: IP68 Waterproof* (for light pod only)

Replacement Fuse: 3A

*Although the light pods are specified for protection during water submersion of up to 1 meter for up to 30 minutes, we do not recommend prolonged submersion of the hub under water. Waterproof is evaluated according to IEC60529 Ingress Protection standard.

INSTALLATION

Choose Installation Method:

- A. Install using included Self-tapping Screws to wheel well liner.
- B. Install using included Mounting Screws to wheel well liner.
- C. Install using included Curved Rubber Seats and Cable Ties to round tubular frame.
- D. Install using included Flat Rubber Seats and Cable Ties to flat tubular frame.

Choose the best type of installation for your vehicle's application.

NOTE: Lay out all the Wheel Well Lights, Smart Hub and wires and decide where you are going to mount the Smart Hub and run all the wires prior to installation.

Before you install the Wheel Well Lights, it is recommended that you loosen the screws and remove the Wheel Well Liners for easier installation.

Be sure to power on and test the lights and app-control prior to installation.

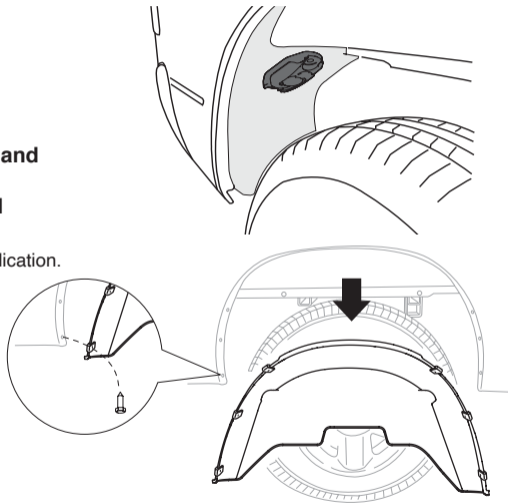

INSTALLATION

A. Install using included Self-tapping Screws to wheel well liner.

Requires: - 25mm Self-tapping Screws
- M5 Spring Washers
- Washers
- Power Drill with "#2" Philips Driver Bit

1. Drill a hole for running the wire all the way to the location where you mount the Smart Hub.
2. Mark your desired location on the Wheel Well Liner.
3. Mount the Wheel Well Light on the Wheel Well Liner with 25mm Self-tapping Screws and tighten with Power Drill with "#2" Philips Driver Bit.

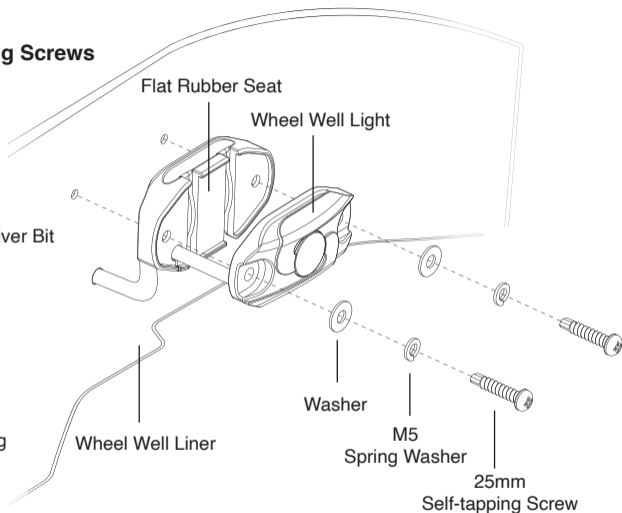

INSTALLATION

B. Install using included Mounting Screws to wheel well liner.

Requires: - 25mm M5 Mounting Screws
- M5 Nuts
- M5 Spring Washers
- Washers
- Power Drill with "#2" Phillips Driver Bit
- 13/64 inch Drill Bit
- Wrench

1. Mark your desired location and drill 2 pilot holes on the Wheel Well Liner using a 13/64 inch drill bit.
2. Drill one more hole for running the wire all the way to the location where you mount the Smart Hub.
3. Mount the Wheel Well Light on the Wheel Well Liner with 25mm M5 Mounting Screws and M5 Nuts. Tighten with screwdriver and wrench.

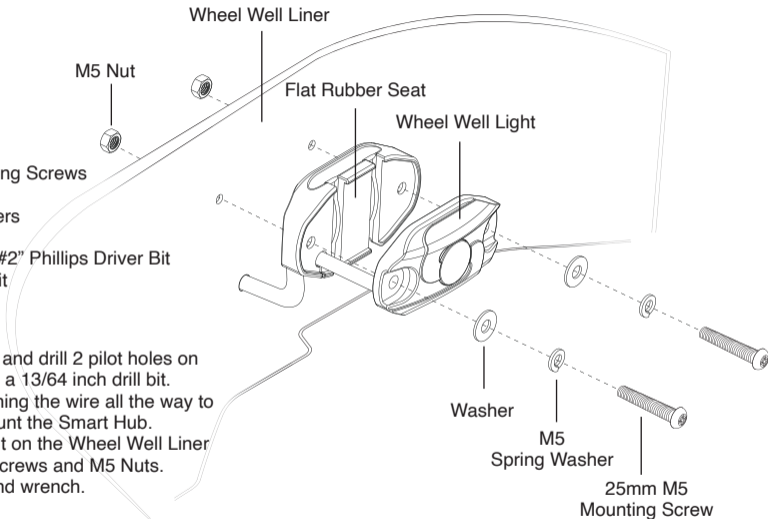

INSTALLATION

C. Install using included Curved Rubber Seats and Cable Ties to round tubular frame.

Requires: - 12mm M5 Mounting Screws
- M5 Nuts
- M5 Spring Washers
- Washers
- Screwdriver and wrench
- Cable Ties

1. Secure the Wheel Well Light to the Curved Rubber Seat with 12mm M5 Mounting Screws and M5 Nuts. Tighten with screwdriver and wrench.
2. Tight the Wheel Well Light to the round tubular frame with Cable Ties.

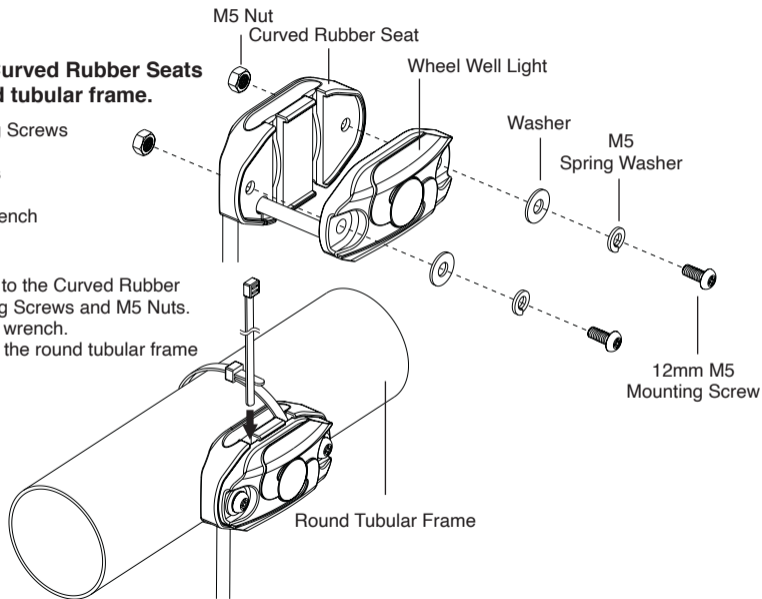

INSTALLATION

D. Install using included Flat Rubber Seats and Cable Ties to flat tubular frame.

Requires: - 16mm M5 Mounting Screws
- M5 Nuts
- M5 Spring Washers
- Washers
- Screwdriver and wrench
- Cable Ties

1. Secure the Wheel Well Light to the Flat Rubber Seat with 16mm M5 Mounting Screws and M5 Nuts. Tighten with screwdriver and wrench.
2. Tight the Wheel Well Light to the flat tubular frame with Cable Ties.

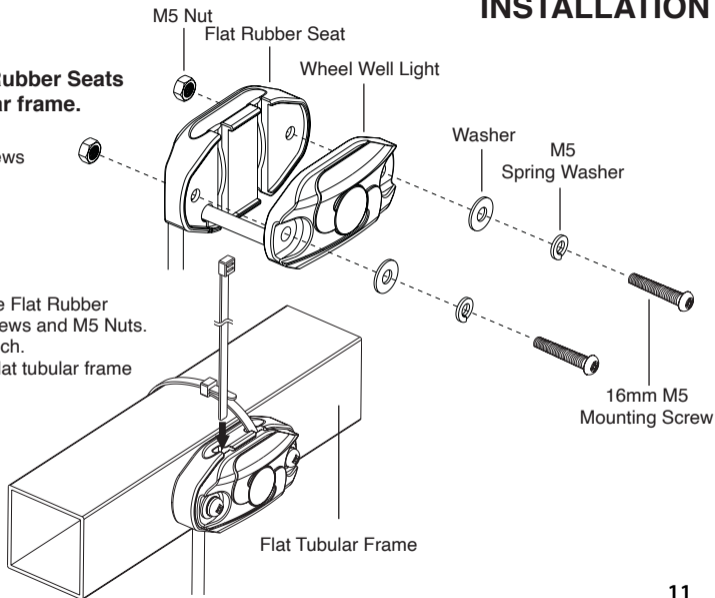

INSTALLATION

Connecting the Wheel Well Lights to the Smart Hub:

Connect the Wheel Well Lights to the Smart Hub. Make sure the weatherproof 4 pin connectors are securely fastened and route cables away from engine. The connectors are directional, make sure to connect to the correct position and fasten each end of the cap.

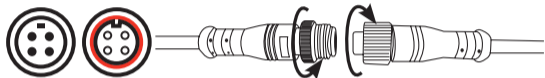

Installing the Smart Hub:

Secure the Smart Hub away from the car engine or any moving components. Make sure to avoid placing the Smart Hub or cables near any extremely HOT location or next to the car engine. Use 3M™ double-sided tape to secure to any flat location and use Cable Ties to tie all wiring away from all moving components.

NOTE: Do not install the Smart Hub until after the Wheel Well Lights have been installed.

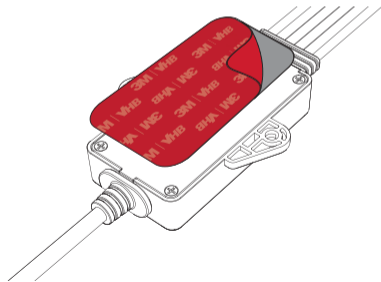

Connecting the Smart Hubs to power:

Smart Hub hardwire cables are color coded, **RED** for POSITIVE (+) and **BLACK** for NEGATIVE (-). Connect the **RED** cable to the POSITIVE (+) battery clamp as illustrated. The POSITIVE battery post will be slightly larger than the NEGATIVE post, and will be marked with a PLUS (+) sign. There may also be a **RED** protective cover over the positive battery post. Connect the **BLACK** cable to the NEGATIVE (-) battery clamp as illustrated. The NEGATIVE will be marked with a MINUS (-) sign. There may also be a **BLACK** plastic protective cover over the negative battery post.

NOTE: After connecting the Smart Hub to the car battery, the LED power indicator will flash Blue. If the LED power indicator does not flash once connected, please double check your power connections.

The Smart Hub has built-in voltage protection to prevent car battery from draining in case the Wheel Well Lights are accidentally left on. The lights will be turned off automatically and the Smart Hub will be on standby mode when the voltage drops to approximately 12V. Once on standby mode, if the car battery is producing below 12V, do not turn on the Wheel Well Lights until your next engine start or when the power is back to 12V or above.

WARNING: DO NOT mix up the cables or allow the metal ends to touch together because this may damage the battery, charging system and/or electronics on a vehicle. When installing, please make sure your engine is not running.

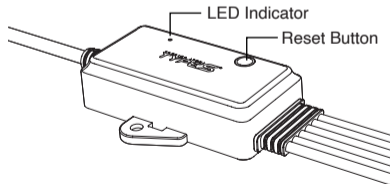
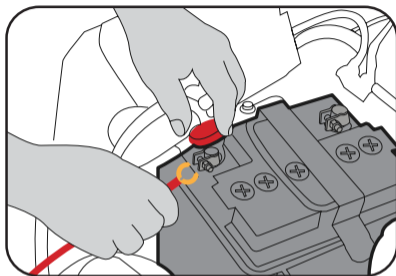

APP INSTALLATION

Install the TYPE S LED APP on your smart device. Scan below QR code or search for the TYPE S LED APP in the APP Store or Google Play.



Compatible with iPhone 4s & higher, iPad3, iPad Mini, iPad Air & higher, and iPod touch 5th Generation & higher. Requires iOS 9.0 or higher.



Compatible with phones with Android™ 4.3 or higher.

Note: not all Android™ phones are equipped with Bluetooth® v4.2 required for this application.

USING THE APP

Home Page



Tap “SMART EXTERIOR” icon to start. The APP will automatically pair to the Smart Hub when the Wheel Well Lights and your device are powered on and within the 30-foot Bluetooth® range. We strongly recommend that you setup a private password to prevent unauthorized devices from connecting to the Smart Hub. (Refer to password instructions on page 18)

NOTE: The Smart Hub has built-in voltage protection to prevent car battery from draining in case the Wheel Well Lights are accidentally left on. The Wheel Well Lights will be turned off automatically and the Smart Hub will be on standby mode when the voltage drops to approximately 12V. Once on standby mode, if the car battery is producing below 12V, do not turn on the LED lights until your next engine start or when power is back to 12V or above.

Smart Exterior Page



USING THE APP

LED Zone Functions

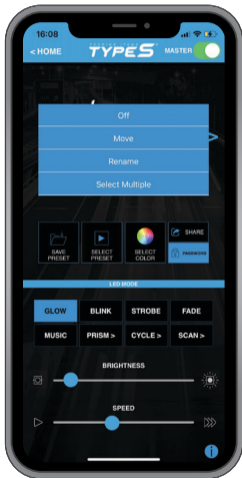

A. Master On/Off Switch

B. LED Zone Functions

Zone On/Off: Press the zone icon to turn LED On or Off.

Move Zone Icon:

Press and hold the zone icon, select “Move” to position each zone icon at your desired location.

Rename Zone Icon:

Press and hold the zone icon, select “Rename” to rename each icon. (NOTE: Maximum 4 characters).

Select Multiple:

If you have purchased other TYPE S Smart LED products you can assign them to different zones. You can select and control multiple zones at the same time. Press and hold the zone icon, select “Select Multiple” then select your desired zones by pressing “Confirm”. To ungroup your selection, press and hold the zone icon and select “Ungroup”.

USING THE APP

Preset Functions

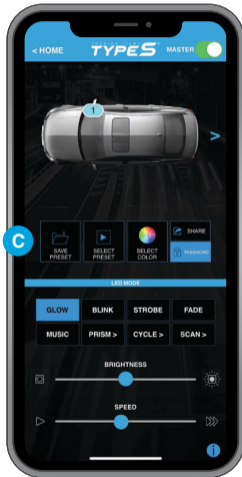

Select Color



C. Preset Functions

Save Preset:

Save your favourite settings.

After choosing your settings, press **“Save Preset”** and enter your preset name. Save up to 10 Presets.

Select Preset:

To select your previously saved preset setting, simply press **“Select Preset”** and choose your saved setting.

Delete Saved Preset Setting:

To delete a saved preset setting, press **“Select Preset”**, press and hold the preset you wish to delete. Press **“Yes”** to delete.

NOTE: Make sure the preset you wish to delete is not currently in use.

Select Color:

Choose from up to 49 different colors. Press **“Select Color”**, select your desired color and press **“Confirm”**.

USING THE APP

Password

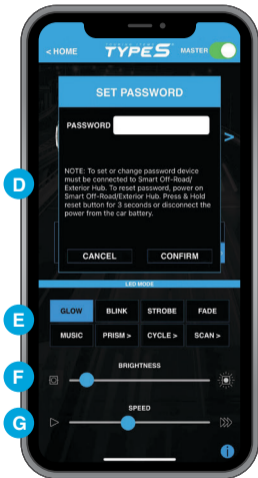

D. Password

You can set up a password to prevent other devices from controlling your lights. Once you have entered your password, it will be saved in the APP and the Smart Hub.

NOTE: To set or change the password, your device must be connected to the Smart Hub simply follow on-screen instructions. Changing the password without connecting to the Smart Hub may cause an invalid password the next time your APP and Smart Hub are activated. If you forget your password, simply reset by pressing the Smart Hub's reset button for three seconds or disconnect the power from the car battery.

E. LED Modes

Choose up to 25 different modes including unique scan effects and Preset color themes.

F. Brightness

Slide bar to adjust brightness setting.

G. Speed

Slide bar to adjust the speed of the movement from each LED mode.

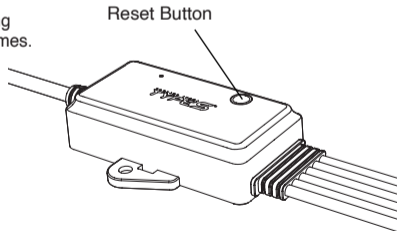

Important Safety Instructions:

1. SAVE THESE INSTRUCTIONS - This manual contains important safety and operating instructions for LED Kit model LM532851.
2. NEVER use the APP while operating your vehicle. Use the APP when vehicle is stationary only.
3. Before using this LED Kit, read all instructions and cautionary markings to ensure the product is properly & safely installed.
4. Do not expose LED Kit to rain, moisture, or snow.
5. Use of an attachment not recommended or sold by the LED Kit manufacturer may result in a risk of fire, electric shock, or injury to persons.
6. Do not operate with damaged cord.
7. Do not disassemble LED Kit; take it to a qualified serviceperson when service or repair is required. Incorrect reassembly may result in a risk of electric shock or fire.
8. To reduce risk of electric shock, disconnect all power before attempting any maintenance or cleaning. Turning off the lights will not reduce this risk.

WARNING: Do not install or use product if it, in any way, impairs the safe operation of your vehicle. Follow manufacturer's instructions to ensure the product is properly & safely installed. Neither the manufacturer nor the reseller can be held responsible or liable for consequential, incidental, or indirect damages to either person or property resulting from the installation or improper use of this product. Check your state, provincial, or local laws before installing.

This product is not DOT approved.

WARNINGS

FCC Compliance Statement:

This device complies with Part 15 of the FCC rules:

- (1) This device may not cause harmful interference, and
- (2) this device must accept any interference received, including interference that may cause undesired operation.

WARNING: Changes or modifications to this unit not expressly approved by the party responsible for compliance could void the user's authority to operate the equipment. The manufacturer is not responsible for any radio or TV interference caused by unauthorized modifications or change to this equipment. Such modifications or change could void the user's authority to operate the equipment.

NOTE: This equipment has been tested and found to comply with the limits for Class B digital device, pursuant to part 15 of the FCC Rules. These limits are designed to provide reasonable protection against harmful interference in a residential installation. This equipment generates, uses and can radiate radio frequency energy and, if not installed and used in accordance with the instructions, may cause harmful interference to radio or television reception, which can be determined by turning the equipment off and on, the user is encouraged to try to correct the interference by one or more of the following measures:

- Reorient or relocate the receiving antenna.
- Increase the separation between the equipment and the receiver.
- Connect the equipment into an outlet on a circuit different from that to which the receiver is connected.
- Consult the dealer or an experienced radio/TV technician for help.

WARNINGS

The device has been evaluated to meet general RF exposure requirement.

This equipment complies with FCC RF radiation exposure limits set forth for an uncontrolled environment.

⚠ WARNING: This product can expose you to chemicals including DEHP and DINP, which are known to the State of California to cause cancer and birth defects or other reproductive harm. For more information go to www.P65Warnings.ca.gov.

The Bluetooth® word mark and logos are registered trademarks owned by the Bluetooth SIG, Inc. and any use of such marks by ADC Solutions Auto, LLC is under license. Other trademarks and trade names are those of their respective owners.

3M VHB™ is a trademark of 3M company.

Smart Wheel Well Lights
6 Diecast Aluminium LED Pods
LM532851
Responsible Party:
TYPE S
2975 Red Hill Ave., Ste. 100,
Costa Mesa, CA 92626, U.S.A.
Tel: 1.866.294.9244

NOTES



A Horizon Brands Company

2975 Red Hill Ave., Ste. 100, Costa Mesa,
CA 92626, U.S.A.

1.866.294.9244 | info@typesauto.com

©2022 TYPE S. All rights reserved.

www.typesauto.com