

TOURING ITEMS
TYPE S

SHIFT KNOB Carbon Fiber

Installation and Use Instructions
Model number: AC58274 / AC58275

Quick Installation Guide

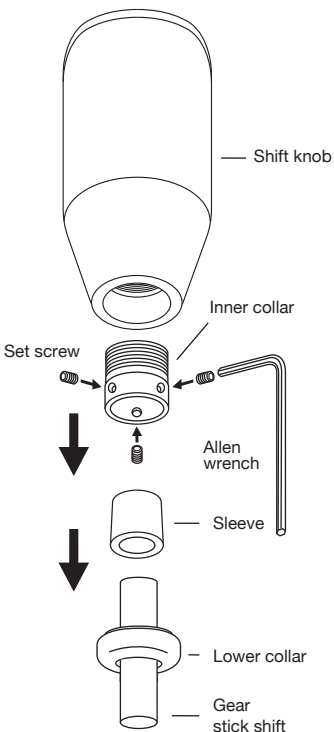

Before you start :

Please note this shift knob is for threaded shifter sticks.

How to install the shift knob:

- Unpack and identify your new TYPE S shift knob components
- Remove the shift knob's lower collar and slide over gear stick shift
- Fasten the new inner collar to the top of the stick shift using the correct sized sleeve supplied (if needed) and firmly tighten the set screw with the allen wrench provided
- Now that the inner collar is securely attached to the stick shift, screw the TYPE S shift knob onto the inner collar and tighten
- Finally, screw the lower collar onto the TYPE S shift knob and tighten
- Check for tightness after driving 50 miles

WARNING: This product is intended solely for decorative purposes. Check local laws and regulations regarding installation and use. Manufacturer and seller assume no liability for improper installation or use, which are solely the responsibility of the purchaser.

TOURING ITEMS
TYPE S

A Horizon Brands Company
2975 Red Hill Ave., Ste. 100,
Costa Mesa, CA 92626
1.866.294.9244 | info@typesauto.com
©2021 Type S. All rights reserved.

www.typesauto.com

Made in China

ML-58274_V1