

WIRELESS SMART LED SWITCH PANEL

COMPATIBLE WITH
TYPE S SMART LED PRODUCTS

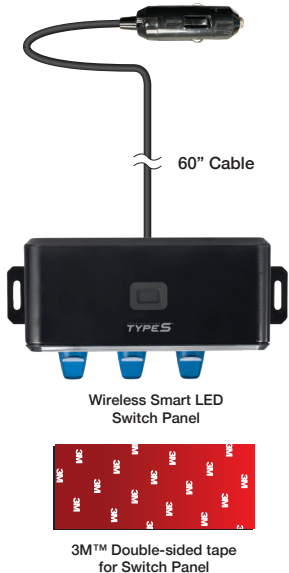

PACKAGE CONTENTS



TECHNICAL SPECIFICATION

Working voltage: DC 12V Only
Maximum amperage draw: 1.5A at 12V

INSTALLATION

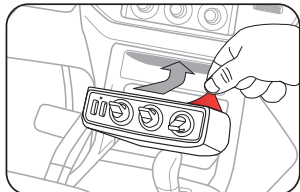

NOTE: We recommend installing the APP, pairing, and testing Switch Panel before adhering to vehicle.

- 1) Choose a flat and easy to reach surface somewhere within the dashboard to install the Wireless Smart LED Switch Panel.
- 2) Clean the mounting surface thoroughly with isopropyl alcohol. Dry completely.
- 3) Mount the Wireless Smart LED Switch Panel on the dashboard using the provided 3M™ double-sided tape.

POWER

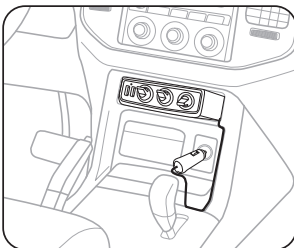

Connect the Wireless Smart LED Switch Panel to the 12V power socket.

NOTE:

- For use with 12V power only.
- Suitable temperature for installation is 70°F (21°C) or above.

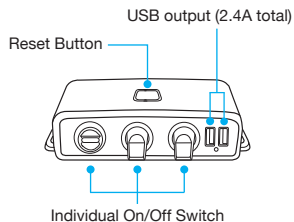

APP INSTALLATION



Compatible with iPhone-4s & higher, iPad3, iPad Mini, iPad Air & higher, and iPod touch 5th Generation & higher. Requires iOS 8.0 or higher.

Note: not all Android™ phones are equipped with Bluetooth™ v4.2 required for this application.

Install Type S LED APP on your smart device. Search for the APP through the APP Store or Google Play by:

- Or scan above QR code to find the compatible APP for iOS or Android.
- Once installed, open the APP and begin enjoying your Plug & Glow™ experience.

USING THE APP



USING THE APP CONT...

1 Home Page

APP will be connected to the Wireless Smart LED Switch Panel simultaneously when both the Switch Panel and any/all of your Type S Smart LED products are connected, powered on and within the 30ft. Bluetooth range.

NOTE: Before making any customizations or presets using the APP, test all your Type S Smart LED products using the APP and the Switch Panel, and make sure they are all installed, connected and powered correctly.

All connected Smart Hubs are highlighted in **Blue**.

Tap the Smart Hub icon to enter each of the **3 Smart Hub Preset Page**.

Tap the **Smart LED Switch** icon to enter the **2 Smart LED Switch Preset Page**.

If you encounter any issue or question, please feel free to contact us at info@typesauto.com or visit us online at: www.typesauto.com.

USING THE APP CONT...

NOTES:

- In-app presets can be made and synced to the Switch Panel even if each individual switch is not turned on.
- One individual switch cannot control two or more Smart Hubs at the same time.
- If multiple APPs are connected to the Smart LED Switch Panel and have made presets separately, the Switch Panel will only keep the most recent preset that it receives.

OPERATING INSTRUCTIONS

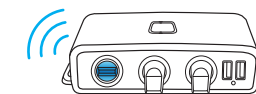

- When all 3 switches are paired, the Wireless Smart LED Switch Panel can control 3 different Smart Hubs at the same time. Flip the switch to turn On/Off. The blue LED indicator in the switch indicates it is on.

NOTES: Press and hold the Reset Button for 5 seconds to clear all the presets.

OPTIONAL PRODUCTS

Optional Smart LED products also available to enhance your experience (sold separately).



48" Smart Lighting Deluxe Kit (LM55369)



72" Exterior Smart Lighting Kit (LM55878)

USING THE APP CONT...

2 Smart LED Switch Preset Page

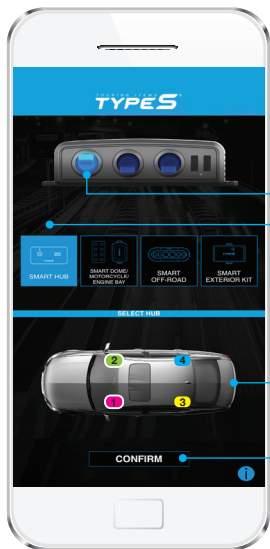

User can customize their favorite lighting options using in-app presets.

Tap to choose a switch to begin with the preset. The chosen switch will be highlighted in blue.

Tap to choose a Smart Hub that you prefer to be controlled by this switch.

The in-app preset from the **3 Smart Hub Preset Page** will appear in here. You can control the number of zone(s) by tapping on the icons. The selected zone(s) will be indicated by a white border.

Once you are done with the settings, tap confirm. This Smart Hub will be paired to the switch. The preset will be saved and synced to the switch as well.

USING THE APP CONT...

2 Smart LED Switch Preset Page

USING THE APP CONT...

3 Smart Hub Preset Page

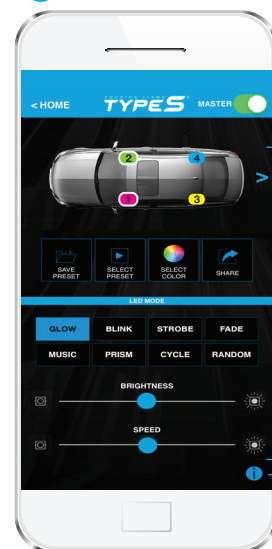

USING THE APP CONT...

3 Smart Hub Preset Page

User can preset the Smart Hub in here.

Refer to the manual that comes with the Type S Smart LED product for step-by-step instructions on how to preset the Smart Hub.

Or tap the **i** icon for on-screen instructions.

4 Close the APP

Close the Type S LED APP after you are done with the preset in order to let the switch that is paired with the Smart Hub to take effect.

WARNING

IMPORTANT SAFETY INSTRUCTIONS

1. SAVE THESE INSTRUCTIONS - This manual contains important safety and operating instructions for LED Switch Panel Model LM57366.
2. Before using this product, read all instructions and cautionary markings.
3. Use of an attachment not recommended or sold by the manufacturer may result in a risk of fire, electric shock, or injury to persons.
4. Do not operate with damaged cord - replace it immediately.
5. Do not operate Switch Panel if it has received a sharp blow, been dropped, or otherwise damaged in any way; take it to a qualified serviceperson.
6. Do not disassemble Switch Panel; take it to a qualified serviceperson when service or repair is required. Incorrect reassembly may result in a risk of electric shock or fire.

Wireless Smart LED Switch Panel
Compatible with Type S Smart LED Products
LM57366
Responsible Party:
Winplus North America Inc.
2975 Red Hill Ave., Ste. 100, Costa Mesa,
CA 92626, USA
Tel: 1-866-294-9244

FCC / IC Compliance Statement:

This device complies with Part 15 of the FCC rules and Industry Canada. Operation is subject to the following two conditions:

- (1) This device may not cause harmful interference, and
- (2) this device must accept any interference received, including interference that may cause undesired operation.

Warning: Changes or modifications to this unit not expressly approved by the party responsible for compliance could void the user's authority to operate the equipment. The manufacturer is not responsible for any radio or TV interference caused by unauthorized modifications or change to this equipment. Such modifications or change could void the user's authority to operate the equipment.

NOTE: This equipment has been tested and found to comply with the limits for Class B digital device, pursuant to part 15 of the FCC Rules. These limits are designed to provide reasonable protection against harmful interference in a residential installation. This equipment generates, uses and can radiate radio frequency energy and, if not installed and used in accordance with the instructions, may cause harmful interference to radio or television reception, which can be determined by turning the equipment off and on, the user is encouraged to try to correct the interference by one or more of the following measures:

- Reorient or relocate the receiving antenna.
- Increase the separation between the equipment and the receiver.
- Connect the equipment into an outlet on a circuit different from that to which the receiver is connected.

• Consult the dealer or an experienced radio/TV technician for help.

The device has been evaluated to meet general RF exposure requirement.

To maintain compliance with FCC/IC's RF exposure guidelines, this equipment should be installed and operated with a minimum distance of 20cm between the radiator and your body.

CAN ICES-005 (B) / NMB-005 (B)

WARNING: This product can expose you to chemicals including DEHP and DINP, which are known to the State of California to cause cancer and birth defects or other reproductive harm. For more information go to www.P65Warnings.ca.gov.

Have a comment or question? Email us at: info@typesauto.com or visit us online at: www.typesauto.com

Winplus North America, Inc.
2975 Red Hill Ave., Ste. 100,
Costa Mesa, CA 92626
Tel: 1.866.294.9244

© 2019 Winplus North America, Inc.
All rights reserved.
3M™ is a trademark of 3M Company.

The Bluetooth® word mark and logos are registered trademarks owned by the Bluetooth SIG, Inc. and any use of such marks by Winplus Co. Ltd is under license. Other trademarks and trade names are those of their respective owners.

iPhone, iPad and iPod touch are trademarks of Apple Inc.

Android is a trademark of Google Inc.

Instruction Manual