

TOURING ITEMS
TYPES

T400 PLUS

4K Full Coverage Dashcam with AI Driver Assistant Functions

WP ITM. BT533645
Care & Use Instructions



**Important, retain for future reference:
Read carefully**

TABLE OF CONTENTS

1. Introduction	1
2. Package Contents	2
3. Product Specifications	3
4. Dimensions	4
5. Product Overview	5
6. Controlling The Camera	6
7. Installing The Cameras	6
8. Configuring The Menu Settings	9
9. Camera Status & LED Indicators	18
10. Recording Time	18
11. Technical Specifications	18
12. Downloading The App	19
13. Setting Up The App	20
14. Using The App	23
15. Safety Information	26
16. Maintenance & Warranty	28
17. General Information	30

1. INTRODUCTION

Please carefully review all installation instructions before installing the product. Improper installation may void the manufacturer's warranty. These instructions are not applicable to all vehicle types and are provided as guidelines to aid in product installation.

If you require assistance with camera installation, please feel free to either consult an experienced technician or reach out to TYPE S customer support at **1.866.294.9244**.

BEFORE using the cameras, please read the safety information in this manual, and always follow the guidelines outlined in it while using the product.

Please make sure you've read and understood local laws and regulations regarding cameras in vehicles, as these laws can vary by state.

2. PACKAGE CONTENTS

1. 1 x T400 PLUS Dashcam
2. 1 x Rear Camera
3. 1 x 12/24V Power Adapter
4. 1 x Windshield Mount (Flat)
5. 1 x Windshield Mount (Angled)
6. 1 x Spare 3M VHB™ Double Sided Tape
7. 1 x Adhesive Film
8. 1 x 64GB MicroSD Card (Class:U3)
9. 1 x Instruction Manual
10. 1 x Warranty Card

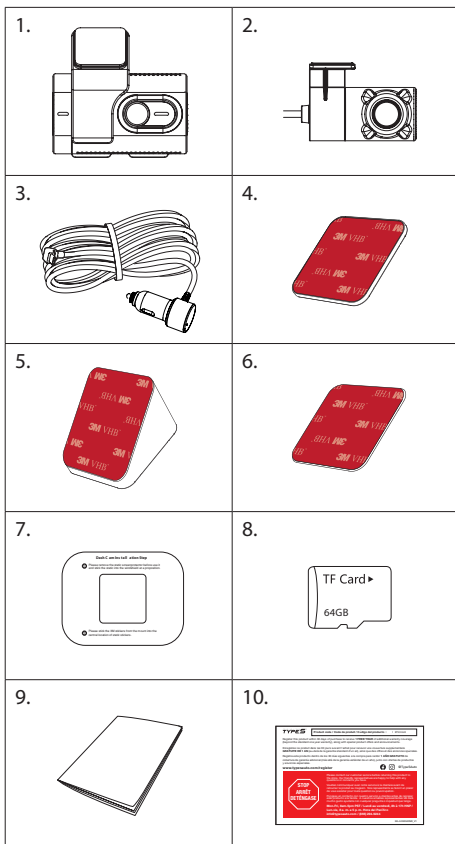

3. PRODUCT SPECIFICATIONS

T400 PLUS Dashcam

Display:	3.0"
Video Resolution:	UHD 4K (3840 x 2160) / 30 FPS
Frequency:	2.4GHz
Operating Voltage:	DC 12/24V / DC 5.2V (USB-C)
Operating Temperature:	14°F~140°F (-10°C~60°C)
Lens (View Angle):	164°
Image Sensor:	8MP
Maximum Signal Range:	Up to 10ft / 3m

Rear Camera

Video Resolution:	FHD 1080P (1920 x 1080) / 30 FPS
Operating Voltage:	DC 5V
Operating Temperature:	14°F~140°F (-10°C~60°C)
Lens (View Angle):	122°
Image Sensor:	2MP

4. DIMENSIONS

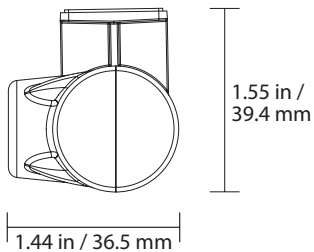
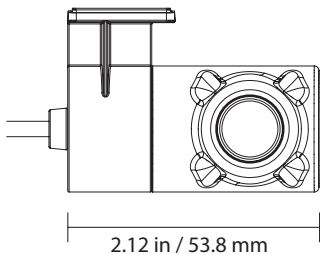
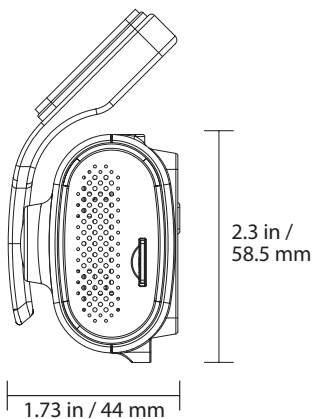
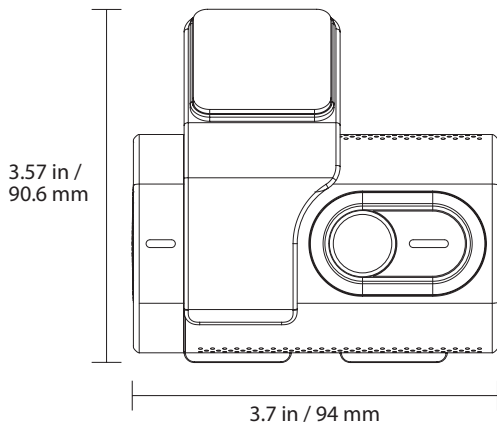



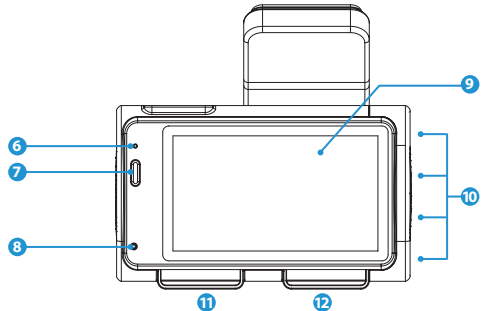
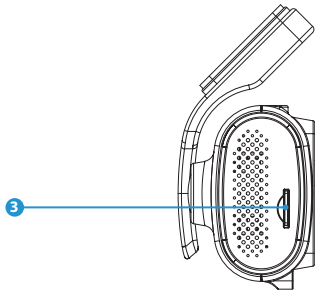
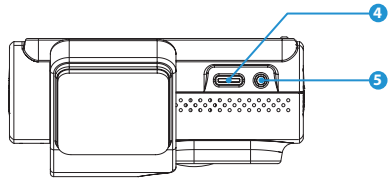
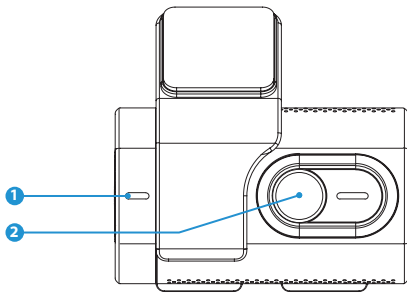

5. PRODUCT OVERVIEW



1. Speaker
2. Camera Lens
3. MicroSD Card Slot (MicroSD Card Factory-Installed)
4. Power Input
5. Rear Camera AV-IN Input
6. Microphone
7. Event Recording Button
8. LED Indicators
9. Display Screen
10. Function Buttons
11. Orange Warning Light - Left Blind Spot
12. Green Warning Light - Right Blind Spot

6. CONTROLLING THE CAMERA

Apply configuration and settings to the dashcam using the 4 function buttons. Please refer to the section below for the functions of each button under different modes

-  Switch between ADAS/PIP/Front/Rear view (click once)
-  Audio Recording On/Off (click once)
-  Snapshot (click once)
Record (press and hold)
-  Open Settings Menu (click once)

NOTE: PIP (picture-in-picture) and Rear views only available when the rear camera is connected.

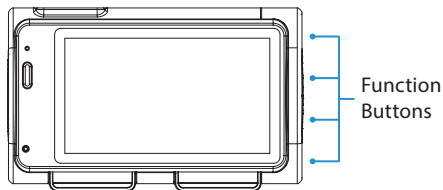

7. INSTALLING THE CAMERAS

- 1 Remove the protective film from the display screen. Connect the USB-C power cable to the input port on the dashcam.

NOTE: Please test the dashcam by connecting it to a power source before mounting.

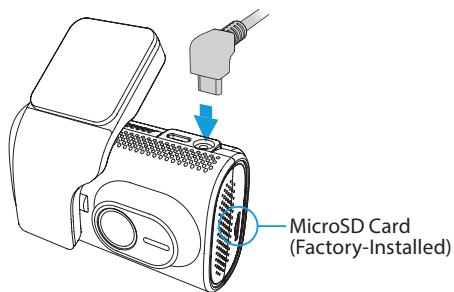

- 2 Attach the windshield mount securely into the socket on the dashcam. Please select the appropriate mount according to your windshield type. For a tilted windshield, use the flat mount. For a vertical windshield, use the angled mount.

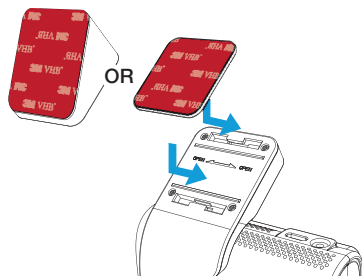

- 3 Mount the dashcam onto the windshield:
- Apply the adhesive film onto the cleaned windshield and remove the protective film.
 - Peel off the 3M VHB™ tape backer from the windshield mount and affix the dashcam to the center of the adhesive film.

NOTE: To optimize the accuracy of AI calibration, we recommend placing the dashcam at the center of your windshield, right behind your rear view mirror.

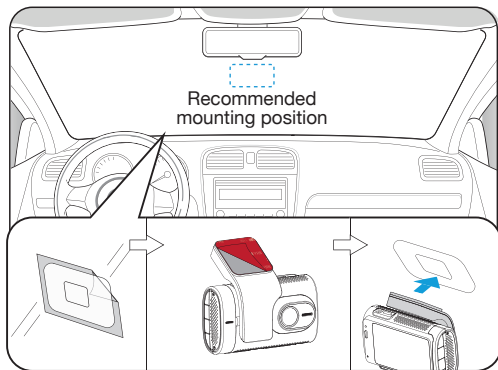

- 4 Route the power cable through the headliner and pillars inside your vehicle. Connect the power adapter to your vehicle's 12/24V DC outlet. To ensure it doesn't obstruct the driver while driving, we recommend passing it through the passenger side.

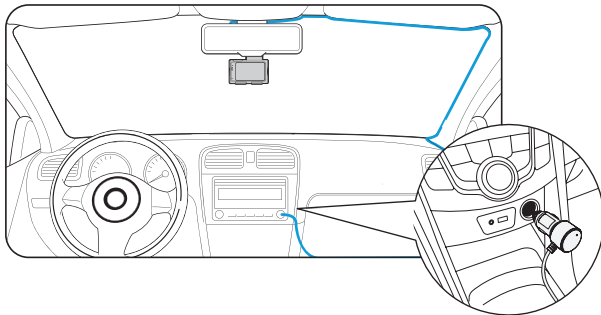

- 5 Plug the rear camera into the AV-IN port on the dashcam.

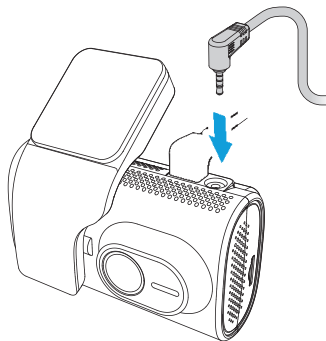

- 6 Mount the rear camera on the rear window inside your vehicle. Adjust the camera to your desired angle. Route and hide the power cable in your vehicle.

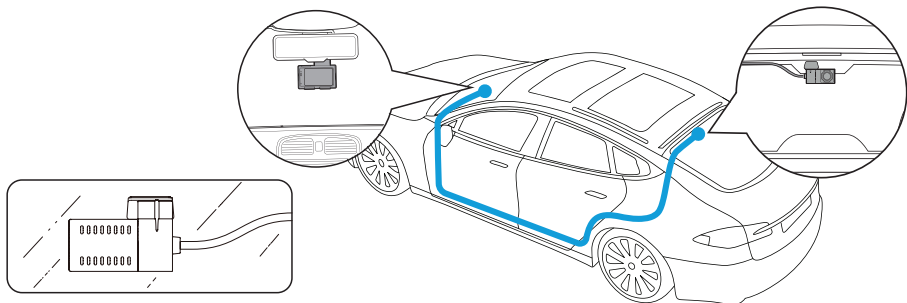

CAUTION: Before mounting the camera on your rear window, please power on the dashcam to ensure that it is in the correct orientation.

8. CONFIGURING THE MENU SETTINGS

Initial Setup

Set the date & time before using the dashcam. The date stamps that appear on all future recordings will follow this setting. You may also sync the date & time to your phone by connecting the dashcam to the TYPE S Drive App.

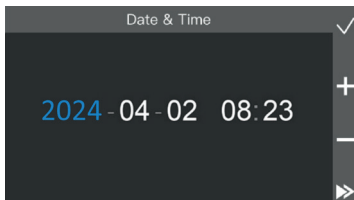



Auto-Calibration

The dashcam features an Advanced Driver Assistance System (ADAS) function. Upon initial use, the device will automatically calibrate to enhance the accuracy of detecting safety events. Please note that this calibration process may take up to 15 minutes to complete.

The calibration will complete once the following conditions are met:

- Driving on a straight and level road
- Vehicle speed is greater than 13 MPH (20 KM/H)
- Ensuring a clear view of the sky for GPS signal reception
- Avoid switching lanes in order for the system to recognize the lane markings

The  icon will appear in live view when calibration is completed. If you have the rear camera connected, the  icon will appear as well.



WARNING: Please ensure that you complete the auto-calibration process. Failure to do so may result in inaccurate data, potentially affecting your safety and the performance of Advanced Driver Assistance features while driving.

NOTE: Recalibration is required when transferring the dashcam to a different vehicle. To do this, reset the dashcam to factory defaults under System Setting (refer to page 17), and then repeat the calibration process.

Video Mode

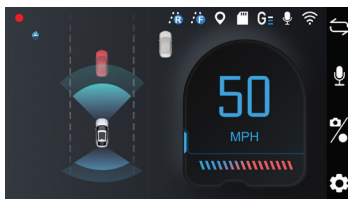



- This is the default recording setting. The dashcam will start recording automatically once it is powered on.
- By default, videos are recorded in 1-minute segments and saved onto the MicroSD card. When the memory reaches capacity, new videos will overwrite the old ones.



- Click  to switch between ADAS, picture-in-picture, front and rear view. Picture-in-picture and rear views are only available when the rear camera is connected.
- Click  to turn audio recording on/off.
- Press and hold  to start/stop recording, or click once to take a photo.
- Click the event recording button to start an emergency video recording. The footage will be stored in the Event folder.



Gallery Mode

- Click  to open settings menu and select **Gallery**.
- Utilize  and  to cycle through Event, Video, Parking and Photo folders, then click  to select.
- In each folder, you can select between browsing front and rear camera footages or photos if the rear camera is connected.

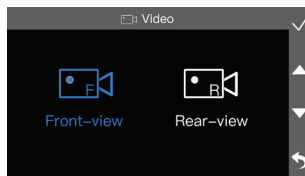
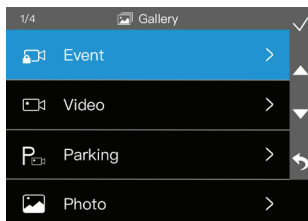
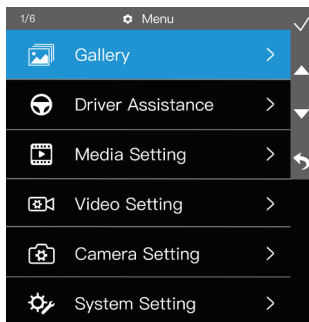

Play Back and Manage Files

- Utilize ▲ and ▼ to browse through the previews, then click ✓ to open the file in full screen.
- During video playback, click || to pause and ▶ to resume the video.
- Click x 1 to adjust video speed to x 2, x 4 or x 8.

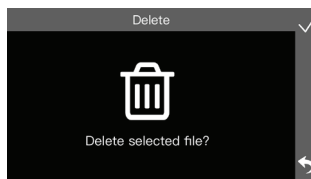

Erase Files

- Click 🗑️ to delete the current file, then click ✓ to confirm the erase.

Advanced Driver Assistance System (ADAS)

- To adjust the Advanced Driver Assistance System settings, select **Driver Assistance** in the settings menu.
- Navigate to **Vehicle Mode** and designate your vehicle as either a Sedan or Truck. Make sure the rear camera is connected in advance.
- Within each function setting, adjust the level of sensitivity between High, Mid, Low and OFF.

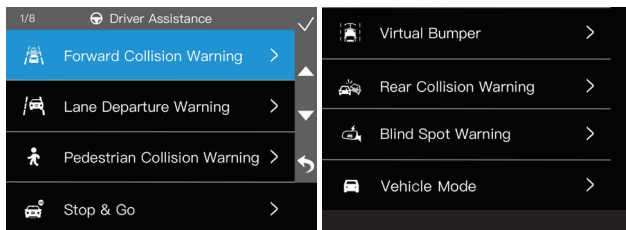

1. Forward Collision Warning

Select the speed at which you would like the feature to be activated. If you select 20 MPH, this feature will only activate when you're driving at over 20 MPH.

- | | | |
|-----------|-----------|-----------|
| - 20 MPH | - 25 MPH | - 30 MPH |
| - 30 KM/H | - 40 KM/H | - 50 KM/H |



The dashcam calculates an estimated safe following distance between your vehicle and the vehicle ahead while driving above the speed you select. When the distance falls below 2.7 seconds, visual and audio alerts will be issued.

NOTE: Please set your desired speed unit before adjusting the activation speed.

2. Lane Departure Warning

Select the speed at which you would like the feature to be activated.

- | | | |
|-----------|-----------|-----------|
| - 40 MPH | - 45 MPH | - 50 MPH |
| - 60 KM/H | - 70 KM/H | - 80 KM/H |

The Lane Departure Warning system provides alerts when your vehicle deviates from the driving lane at a speed over the selected threshold.

NOTE: Please set your desired speed unit before adjusting the activation speed.

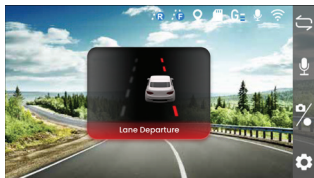

3. Pedestrian Collision Warning

The dashcam tracks moving and stationary pedestrians in close proximity to your vehicle. When the distance to the pedestrian ahead falls below 1.2 seconds, and your vehicle's speed is between 0.7 MPH and 40 MPH (1 KM/H and 60 KM/H), an alert will sound and an on-screen warning will appear.

4. Stop & Go

Stop & Go system notifies you if traffic starts moving, but your vehicle hasn't. When your vehicle has stopped for more than 5 seconds, and the vehicle within 6 meters ahead departs for more than 1 second, the dashcam will issue both visual and sound reminders.

5. Virtual Bumper

The Virtual Bumper system helps prevent minor collisions and scratches when parking or maneuvering in tight spaces. When the distance to the vehicle ahead falls below 0.7 seconds, and your vehicle's speed is between 0.7 MPH and 20 MPH (between 1 KM/H and 30 KM/H), the system provides real-time visual and audible feedback to avoid contact.

6. Rear Collision Warning

The Rear Collision Warning system calculates the real-time distance between your vehicle and the vehicle behind. When driving at a speed greater than 20 MPH (30 KM/H), and your vehicle is less than 2.7 seconds away from the vehicle behind, audible and visual warnings will be generated.

NOTE: Feature only available when the rear camera is connected.



7. Blind Spot Warning

The Blind Spot Warning system keeps an eye on vehicles approaching in adjacent lanes and warn if you try to pull out. The detection range increases with higher speeds up to 12.5 meters.

Preliminary Alert

When your vehicle surpasses a speed of 7 MPH (10 KM/H), an orange warning light on the dashcam will activate if another vehicle approaches from your left rear. Conversely, if the vehicle approaches from your right rear, a green warning light on the dashcam will activate.

Secondary Alert

When your vehicle surpasses a speed of 20 MPH (30 KM/H), an audio alert will be triggered simultaneously with the activation of the orange/green warning light.

NOTE: Feature only available when the rear camera is connected.



Media Setting

1. Keypad Tone

Mute/Unmute keypad tone.

2. Video Volume

Adjust the volume of the recorded footage.

3. Startup Sound

Startup Sound On/Off.

4. Alarm Sound Setting

Toggle between Sound Notifications or Voice Alerts when the Advanced Driver Assistance features are activated. You may also turn the alerts OFF.

5. Anti Flicker

Adjust anti-flickering setting between 50Hz and 60Hz.

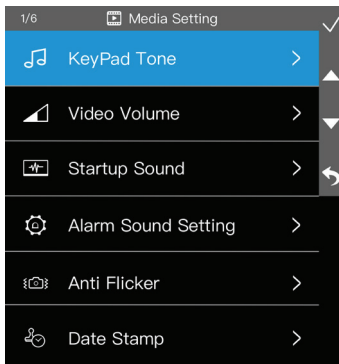

6. Date and TYPE S Logo Stamp

Enable or disable the Date and TYPE S Logo Stamp. When set to ON, the date and TYPE S logo will be displayed on all recorded media files.

Video Setting

1. Resolution

Switch video resolution between 4K, 2K (1440P) and FHD (1080P).

NOTE: The resolution of the rear camera is fixed at 1080P.

2.G-Sensor

Adjust the G-Sensor sensitivity between High, Mid, Low and OFF.

When the G-Sensor detects a sudden impact such as a collision, it'll automatically lock and store the footage in the Event folder so that it doesn't get overwritten by the loop record feature.

3.Parking Monitor

Parking Monitor On/Off. The Parking Monitor function allows the dashcam to record videos when an impact is detected while the vehicle's engine is off. The dashcam will power on automatically and record a 20-second video clip then shut down.

NOTE: Feature only available when the dashcam is hardwired to the fuse panel. Hardwiring kit not included.

4.Loop Record

Select the duration of each recorded footage between 1 minute, 3 minutes and 5 minutes. Oldest and unlocked files will be overwritten once the storage limit is reached.

5.Audio Recording

Audio Recording On/Off. This feature enables the dashcam to capture sound during recording.



Camera Setting

1.Resolution

Select photo resolution between 8M (3840 x 2160) and 5M (3072 x 1728).

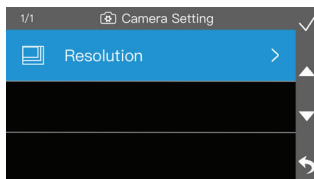

System Setting

1. Screen Save

Select the period of inactivity that prompts the activation of screen save mode. While in screen save mode, a digital clock will be displayed on the screen.

2. WiFi

The auto-sync feature via WiFi allows you to view/manage/download files onto your smart device wirelessly via the TYPE S Drive App.

NOTE: Refer to page 20 for pairing procedure.

3. Date & Time

Update the date & time shown on the dashcam and on all its recorded media files.

4. Date Format

Select your desired date format.

5. Digital Clock

Enable or disable the digital clock displayed during screen save mode. If set to OFF, the screen save mode will present a black screen instead.

6. Plate Stamp Setting

Input your vehicle license plate number here. When activated, your plate number will be displayed on all recorded media files.

7. Speed Unit

Select the unit of speed between MPH and KM/H. Default speed unit is set as MPH.

8. Format

Format the MicroSD card. This action will erase all data stored on the MicroSD card.

9. Default Setting

Reset settings to factory defaults.

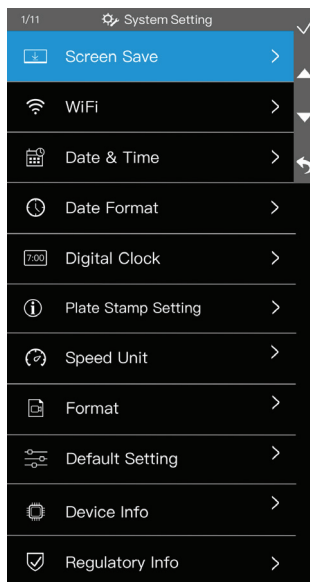

10. Device Info

Show the current firmware version of the dashcam.

11. Regulatory Info

Show regulation related information.

9. CAMERA STATUS & LED INDICATORS

Power / Mode Status	LED Indicators
Power On Dashcam powers ON when the engine is turned on.	Blue LED light stays on when dashcam is powering on.
Recording	Red LED light stays on.
Recording Stopped	Blue LED light stays on.

10. RECORDING TIME

Memory Card Capacity	Total Recording Time		
	(4K + 1080P)	(2K + 1080P)	(1080P + 1080P)
64GB	At least 80 minutes	At least 100 minutes	At least 150 minutes
128GB	At least 90 minutes	At least 125 minutes	At least 175 minutes
512GB	At least 370 minutes	At least 500 minutes	At least 700 minutes

NOTE: If you use your own MicroSD card please insert it into the dashcam and format it before first use.

11. TECHNICAL SPECIFICATIONS

Memory Management

Mode	Resolution	1-Minute Video Size	Loop Period (64GB SD Card)
4K + 1080P	3840 X 2160 + 1920 X 1080	280MB	80 Minutes
2K + 1080P	2560 X 1440 + 1920 X 1080	180MB	100 Minutes
1080P + 1080P	1920 X 1080 + 1920 X 1080	100MB	150 Minutes

Memory Card Capacity	Usable Space	System Reserve	Event	Video	Parking	Photo
64GB	58.9GB	5.1GB	17.6GB	29.4GB	5.8GB	5.8GB
128GB	114GB	14GB	34.2GB	57GB	11.4GB	11.4GB
512GB	462GB	50GB	138GB	230GB	46GB	46GB

12. DOWNLOADING THE APP

The auto-sync feature in the TYPE S Drive App allows you to 1) Synchronize the dashcam's time with your phone's time, 2) Manage the dashcam's functions from your phone, and 3) View and download recorded videos. To access this feature, scan the QR code below or search for "TYPE S Drive" on the App Store or Google Play. Download and install the App.



SSID:
TYPE_S_DVR14_4K_xxxxxx
Password:
12345678

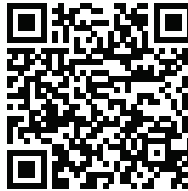

Compatible with iPhone, iPad,
Mac and iPod touch with iOS 13
or higher.

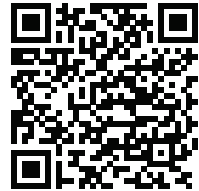

Compatible with devices with
Android™ 7.0 or higher.

13. SETTING UP THE APP

Auto-sync with the Dashcam

1. Open the dashcam's settings menu and navigate to **System Setting**.
2. Go to **WiFi**. The designated QR code will appear.
NOTE: Make sure that WiFi is ON.

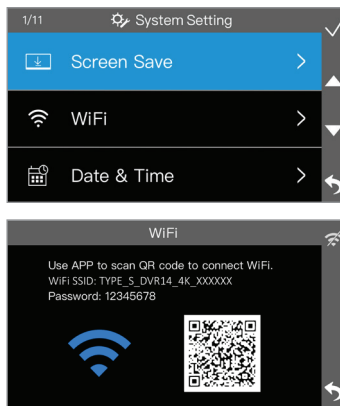

Android Device

3. Run the TYPE S Drive App. Click **Allow** in the pop-up message when prompted to allow the App to access your location.
4. Select the **Dash Camera** category.
5. Select AI SERIES DASHCAM from the list of devices. Click **Set Up Device**.

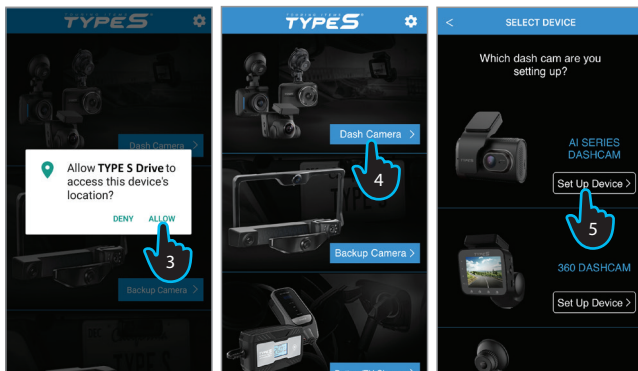

6. Scan the QR code on the dashcam.

7. After establishing the connection, you will have the ability to view the live feed from the dashcam through the App.

NOTE: After the initial connection, the App retains your dashcam's network information. This ensures that you will be automatically directed to the live view the next time you connect, eliminating the need for manual reconnection.

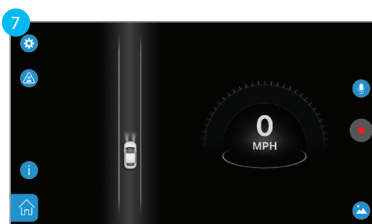

iOS Device (Follow Steps 1-2 from previous instructions)

3. Please make sure Bluetooth, Location Services and Local Network Access are enabled on your device.

4. Run the TYPE S Drive App and select the **Dash** **Camera** category.

5. Select AI SERIES DASHCAM from the list of devices. Click **Set Up Device**.

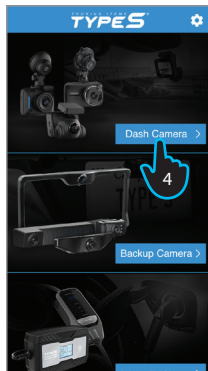

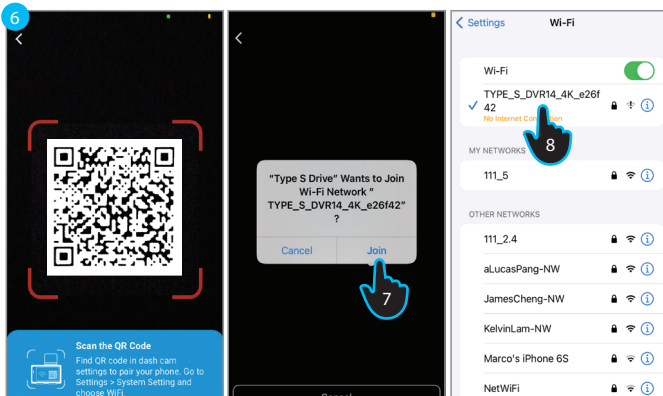

6. Scan the QR code on the dashcam.
7. Click **Join** in the pop-up message when prompted to connect to the dashcam's WiFi network.
8. (Optional) If there is any issue with the auto pairing, exit the App and navigate to the WiFi setting page on your device. Connect to "TYPE_S_DVR14_4K_xxxxxx" with the default password "12345678", then return to the App.
9. After establishing the connection, you will have the ability to view the live feed from the dashcam through the App.

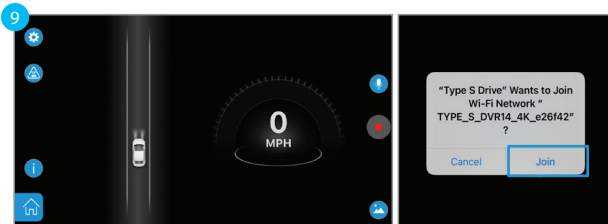

NOTE: After the initial connection, the App retains your dashcam's network information. Simply click **Join** to reconnect.

14. USING THE APP

Main Interface

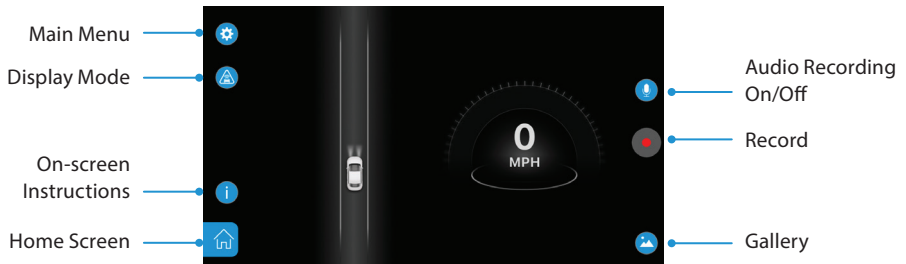

Display Mode

Select from 5 different viewing modes.

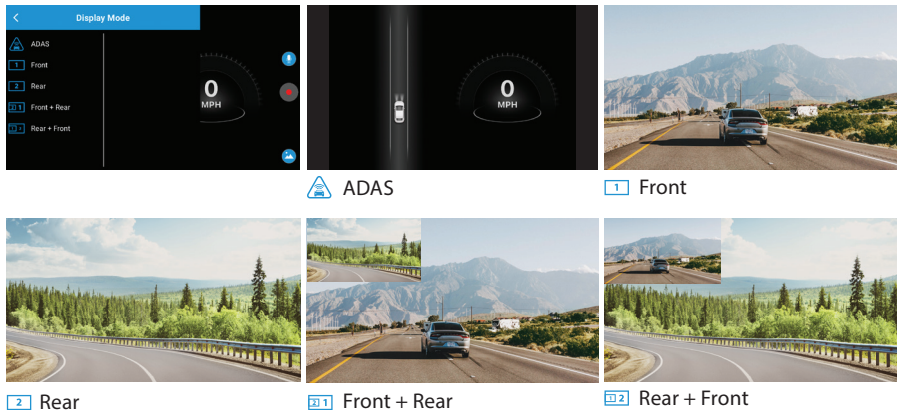

NOTE: "Rear", "Front + Rear" and "Rear + Front" modes only available when the rear camera is connected.

Change WiFi Password

Click  to open Main Menu, then navigate to System Setting > Change WiFi Password. Enter your preferred password (must be exactly 8 numeric characters), then click **OK**.

Connect to your dashcam's WiFi network again with the revised password.

NOTE: It is recommended to reset your WiFi password upon initial connection to protect your data from unauthorized access.

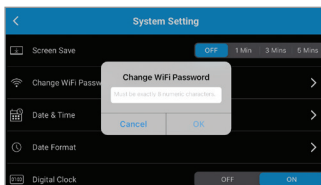
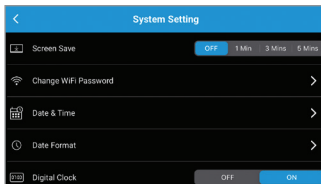

Gallery



Click  on the main interface to enter the media gallery. Select **SD CARD** to access all media files sorted from latest to oldest in the MicroSD card. Scroll down the list to access the file.

In each file, you can browse between front and rear camera footages and photos.

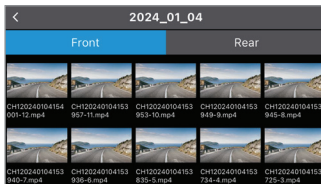
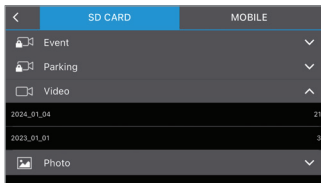

NOTE: Rear camera footages and photos only available when the rear camera is connected.



SD CARD

Click  to download the selected file onto your smart device or  to delete the file from the MicroSD card.

GPS Information

Click  to play the footage, and click  to view embedded GPS location simultaneously during playback.

NOTE: The  icon will only appear if the GPS signal was present while the recording took place.

GPS Signal Status 1

The GPS receiver was still searching for GPS signal when the video was being recorded. If this status persists through multiple recordings, please contact our technical support for troubleshooting.

GPS Signal Status 2

Map tracking is not working. Please turn on your mobile data.

MOBILE

Select **MOBILE** to access and manage downloaded files on your smart device, even when it is disconnected from the dashcam.



15. SAFETY INFORMATION

IMPORTANT SAFETY INSTRUCTIONS

1. SAVE THESE INSTRUCTIONS – This manual contains important safety and operating instructions of 12/24V car charger for Model BT533645.
2. Before using the product, read all instructions and cautionary markings.
3. Do not expose car charger to rain, moisture, or snow.
4. Use of an attachment not recommended or sold by the product manufacturer may result in a risk of fire, electric shock, or injury to persons.
5. To reduce risk of damage to cigarette lighter connector and cord, pull by cigarette lighter connector rather than cord when disconnecting car charger.
6. Make sure the cord is located so that it will not be stepped on, tripped over, or otherwise subjected to damage or stress.
7. Do not operate the car charger with a damaged cord or cigarette lighter connector – replace the damaged items with new factory replacement items immediately.
8. Do not operate the car charger if it has received a sharp blow, been dropped, or otherwise damaged in any way; take it to a qualified serviceperson.
9. Do not disassemble the car charger; take it to a qualified serviceperson when service or repair is required. Incorrect reassembly may result in a risk of electric shock or fire.
10. To reduce risk of electric shock, unplug the charger before attempting any maintenance or cleaning. Turning off controls will not reduce this risk.

WARNING: A failure to read and follow these warnings and instructions may result in a serious accident, including damaged property or a serious injury, including loss of life.

- The AI Dashcam is designed as an aid to the driver in detecting large stationary objects to help avoid damaging the vehicle. However, you, the driver, must use it safely and properly. Use of the AI Dashcam is not a substitute for safe, proper and legal driving.
- Never depend on the AI Dashcam and Rear Cam entirely when driving and backing up. The image on the screen is different from actual conditions. Objects viewed in the AI Dashcam display screen differ from actual distance because a wide-angle lens is used.
- If you use Rear Camera, never back up while looking only at the screen. You should always check behind and around the vehicle when backing up just as you would if the vehicle did not have the Rear Camera. Always make sure your intended path is clear. If you back up while looking only at the monitor, you may hit a vehicle, pedestrian, bicyclist, child, pet or other object resulting in injury or death. Always back up slowly.

- The area displayed by the AI Dashcam and Rear Cam is limited. The AI Dashcam does not display objects that are out of the AI Dashcam's field of view. The area displayed on the screen may vary according to vehicle orientation or road conditions. The Rear Camera does not display objects that are close to or below the bumper, underneath the vehicle, or objects out of the camera's field of view. The area displayed on the screen may vary according to vehicle orientation or road conditions.
- Be sure to check the AI Dashcam's position and mounting angle before each use.
- Do not strike the AI Dashcam. It is a precision instrument. Otherwise, it may malfunction or cause damage resulting in a fire or an electric shock.
- This product will only provide images of items that are within the field of view of the AI Dashcam. Thus, it is imperative that the AI Dashcam should be kept clean and unobstructed.
- Adhere to all applicable traffic laws and motor vehicle regulations applicable to the device.
- Consult local laws and regulations for any restrictions on installation or use.
- Never allow children to play with the device. Small parts may be a choking hazard.
- There is a plastic cover over the AI Dashcam. Do not scratch the cover when cleaning dirt or snow from the cover.
- If the temperature changes rapidly, the system may not operate normally.
- If you replace the tires, the area displayed on the monitor may change and you may need to adjust the camera.
- When strong light directly enters an AI Dashcam, objects may not be displayed clearly.
- The screen may flicker under fluorescent light.
- The colors of objects on the AI Dashcam may differ from those of the actual objects.
- Do not use alcohol or thinner to clean the AI Dashcam. This will cause discoloration. To clean the AI Dashcam, wipe with a clean cloth dampened with mild cleaner diluted with water and then wipe with a dry cloth.

SAFETY AROUND AND BEHIND OTHER VEHICLES

Many preventable injuries and deaths occur in driveways or parking lots when drivers do not see children, pets, or others near their vehicles. Here are a few safety tips that will help you to avoid a back-over accident:

- Walk completely around your vehicle before getting in. Check for kids, toys, and pets before entering the vehicle and starting the engine.
- Know where children are. Have children stand in a place where they are in full view.

- Be aware of young children. Young children are small and hard to see.
- Parents, caregivers and all adults need to be vigilant in supervising children, especially when children are in the yard, driveway or parking lot playing near parked cars.
- Roll down your window so you will be able to hear what is happening outside your vehicle.
- Owners of SUVs, trucks, and vans need to take extra care to avoid hitting or running over a child.
- Teach children to move away from a vehicle whenever it is started.

16. MAINTENANCE & WARRANTY

CLEANING

- If dirt, rain or snow attaches to the camera, the display screen may not clearly display objects. If water droplets, snow or mud adhere to the camera lens, rinse with water and wipe with a dry cloth.
- Do not use alcohol, benzene or thinner to clean the AI Dashcam. This will cause discoloration. To clean the AI Dashcam, wipe with a clean cloth dampened with mild cleaner diluted with water and then wipe with a dry cloth.

WARRANTY

- **TYPE S**

LIMITED WARRANTY

TYPE S warrants, to the original purchaser, that its products are free from defects in material and workmanship for 1 year from the date of original purchase. Where permitted by law, TYPE S liability shall be limited to that set forth in this limited express warranty. This limited express warranty shall be the exclusive remedy of the purchaser and TYPE S makes no other warranty of any kind aside from the limited express warranty stated above.

NOTE: Warranty only applies for North American customers of purchases made in North America.

CONDITIONS OF WARRANTY

If during the 1 year warranty period your new product is found to be defective, TYPE S will repair such defect, or replace the product, without charge for parts or labor subject to the following conditions:

1. All repairs must be performed by TYPE S.
2. All warranty claims must be accompanied by a copy of the sales receipt or bill of sale.
3. The equipment must not have been altered or damaged through negligence, accident, improper operation, or failure to follow the product instructions for installation, use, or care.

4. The replacement of parts is excluded from the warranty when replacement is necessary due to normal wear and tear.
5. Repair or replacement parts supplied by TYPE S under this warranty are protected only for the unexpired portion of the original warranty.
6. This is a "repair or replace" warranty only, and does not cover the costs incurred for the installation, removal or reinstallation of the product, or damage to any mobile phone device or vehicle.

OWNER'S RESPONSIBILITIES:

TYPE S will make every effort to provide warranty service within a reasonable period of time. SHOULD YOU HAVE ANY QUESTIONS ABOUT SERVICE RECEIVED OR IF YOU WOULD LIKE ASSISTANCE IN OBTAINING SERVICE, PLEASE CALL TOLL FREE 1.866.294.9244 DURING REGULAR BUSINESS HOURS MONDAY THROUGH FRIDAY 8:00 AM TO 5:00 PM.

NOTE: Toll Free # is for North America Customers ONLY. See Customer service section for customer contact numbers for other regions/offices.

For customer service and technical support, please call us at 1.866.294.9244. If at that time it is determined that a replacement unit is needed, the support representative will issue a Return Authorization and instruct on how to get a new unit. TYPE S makes no other warranty of any kind aside from the limited express warranty stated herein.

DISCLAIMER OF WARRANTIES, INCLUDING WARRANTY OF MERCHANTABILITY AND WARRANTY OF FITNESS FOR PARTICULAR PURPOSE: EXCEPT AS SPECIFICALLY SET FORTH HEREIN, NO WARRANTY OR REPRESENTATION, EXPRESS OR IMPLIED, IS MADE AS TO THE AI DASHCAM. EXCEPT AS EXPRESSLY SET FORTH HEREIN, TYPE S AND/OR ITS AFFILIATES EXPRESSLY DISCLAIMS, WITHOUT LIMITATION, ANY STATUTORY WARRANTIES AND ALL IMPLIED WARRANTIES, INCLUDING ANY IMPLIED WARRANTY OF MERCHANTABILITY OR FITNESS FOR A PARTICULAR PURPOSE.

TYPE S and/or its affiliates do not guarantee or promise that the user of AI Dashcam will not be in an accident or otherwise not collide with an object and/or person. Our AI Dashcam is not intended in any way to be a substitute for careful and cautious driving or for the consistent adherence to all applicable traffic laws and motor vehicle safety regulations.

The AI Dashcam is not intended to be a substitute for rearview mirrors or for any other motor vehicle equipment mandated by law. Even when properly installed, our AI Dashcam has a limited field of vision and does not provide a comprehensive view of the rear area of the vehicle.

TYPE S and/or its affiliates are not responsible for a user's intended or actual use of the AI Dashcam. In no event shall TYPE S and/or its affiliates have any liability for any losses (whether direct or indirect, in contract, tort or otherwise) incurred in connection with the AI Dashcam, including but not limited to damaged property, personal injury and/or loss of life. Neither shall TYPE S and/or its affiliates have any liability for any decision, action or inaction taken by any person in reliance on the AI Dashcam, or for any delays, inaccuracies and/or errors in connection with the AI Dashcam and its functioning.

TYPE S and/or its affiliates shall have no responsibility or liability for damage and/or injury resulting from accidents occurring with vehicles having the installed, and TYPE S and/or its affiliates, the manufacturer, distributor and seller shall not be liable for any injury, loss or damage, incidental or consequential, arising out of the use or intended use of the product.

17. GENERAL INFORMATION

CUSTOMER SERVICE/CONTACT

IF YOU ARE EXPERIENCING ANY ISSUES WITH THE PRODUCT DURING OPERATION, DO NOT RETURN THE PRODUCT TO THE STORE. CONTACT TYPE S DIRECTLY FOR INSTRUCTIONS ON HOW TO RETURN/ EXCHANGE THE PRODUCT.

FCC Compliance Statement:

This device complies with Part 15 of the FCC rules. Operation is subject to the following two conditions: (1) This device may not cause harmful interference, and (2) this device must accept any interference received, including interference that may cause undesired operation.

WARNING: Changes or modifications to this unit not expressly approved by the party responsible for compliance could void the user's authority to operate the equipment. The manufacturer is not responsible for any radio or TV interference caused by unauthorized modifications or change to this equipment. Such modifications or change could void the user's authority to operate the equipment.

NOTE: This equipment has been tested and found to comply with the limits for a Class B digital device, pursuant to part 15 of the FCC Rules. These limits are designed to provide reasonable protection against harmful interference in a residential installation. This equipment generates uses and can radiate radio frequency energy and, if not installed and used in accordance with the instructions, may cause harmful interference to radio communications. However, there is no guarantee that interference will not occur in a particular installation. If this equipment does cause harmful interference to radio or television reception, which can be determined by turning the equipment off and on, the user is encouraged to try to correct the interference by one or more of the following measures:

- Reorient or relocate the receiving antenna.
- Increase the separation between the equipment and receiver.
- Connect the equipment into an outlet on a circuit different from that to which the receiver is connected.
- Consult the dealer or an experienced radio/TV technician for help.

This equipment complies with FCC RF radiation exposure limits set forth for an uncontrolled environment. In order to avoid the possibility of exceeding the FCC radio frequency exposure limits, human proximity to the antenna shall not be less than 20cm during normal operation.

T400 PLUS

4K Full Coverage Dashcam with AI Driver Assistant Functions

BT533645

Responsible Party:

TYPE S

2975 Red Hill Ave., Ste. 100,
Costa Mesa, CA 92626, U.S.A.

Tel: 1-866-294-9244

Android is a trademark of Google Inc.

iPhone, iPad, Mac and iPod touch are trademarks of Apple Inc.

3M VHB™ is a trademark of 3M Company.



A Horizon Brands Company

2975 Red Hill Ave., Ste. 100, Costa Mesa, CA 92626, U.S.A.

1.866.294.9244 | info@typesauto.com

©2024 TYPE S. All rights reserved.

www.typesauto.com

ML-533645E_V1