

Stowsen®

WHAT'S IN THE BOX

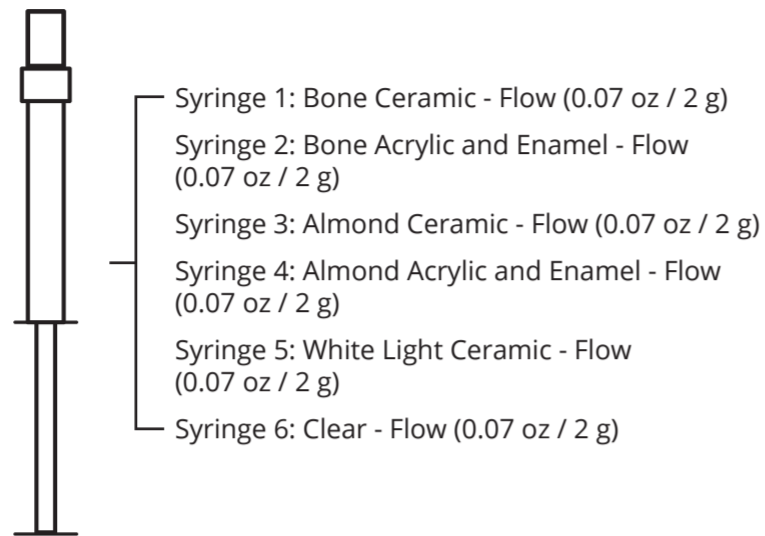

Syringe 1: Bone Ceramic - Flow (0.07 oz / 2 g)

Syringe 2: Bone Acrylic and Enamel - Flow (0.07 oz / 2 g)

Syringe 3: Almond Ceramic - Flow (0.07 oz / 2 g)

Syringe 4: Almond Acrylic and Enamel - Flow (0.07 oz / 2 g)

Syringe 5: White Light Ceramic - Flow (0.07 oz / 2 g)

Syringe 6: Clear - Flow (0.07 oz / 2 g)



6 x Microtips for the syringes

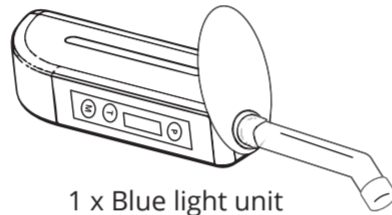

1 x Blue light unit

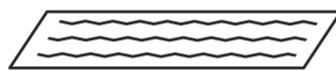

4 x Sheets of 220 grit sandpaper

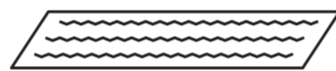

2 x Sheets of 2500 grit sandpaper



1 x Stick

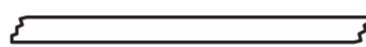

4 x Pieces of leveling tape

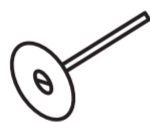

1 x Polishing wheel and mandrel

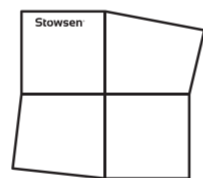

1 x User's manual

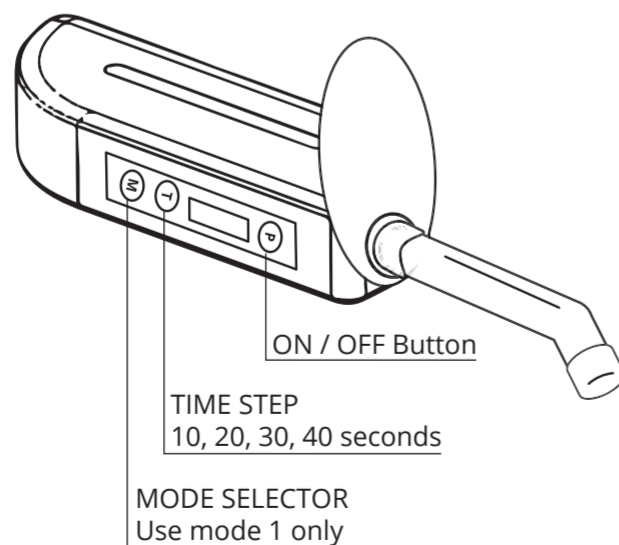

User's Manual Bone & Almond Color Surface Repair Kit

Congratulations on becoming the owner of the fastest retail surface repair kit on the market! You are now equipped and ready to get rid of that chip. Fast!

Here's a short manual to help you get started right away.

For any questions or assistance, contact us at hello@stowsen.com. We are here to help!

stowsen.com

hello@stowsen.com

WHAT TYPE OF DEFECTS CAN BE FIXED?

Can be fixed

- Ceramic, acrylic, enameled, or fiberglass surfaces.
- Sinks, bathtubs, tiles, toilets, and other similar bathroom fixtures.
- Chips, nicks, pits, or deep scratches.
- Defects larger than 0.08 x 0.08 x 0.08 in (2 x 2 x 2 mm).

Can't be fixed

- Hairline cracks - these are too thin for the repair material to penetrate.
- Surfaces which have completely broken apart into multiple pieces.
- Defects in car windshields or any type of glass surface.

INSTRUCTIONS FOR USE

PICKING THE RIGHT SYRINGE

- For ceramic surfaces (such as sinks, toilets, bathtubs, etc.) of linen, biscuit, sedona beige, ivory, off white or pergamon color, use the Bone Ceramic filling. For almond or dark bone color, use the Almond Ceramic filling. To make the color lighter, add White Light Ceramic filling.
- For acrylic and enamel surfaces of linen, biscuit, sedona beige, ivory, off white or pergamon color, use the Bone Acrylic and Enamel filling. For almond or dark bone color, and with surfaces with black substrate at the bottom, use the Almond Acrylic and Enamel filling.
- For corian like surfaces, dilute the chosen color with the Clear filling to make the repair look better.

Tip 1: The viscosity of the flow-type fillings can be adjusted with temperature. Just cool it to 35°F (0-5°C) in your fridge, and it will be ready to make repairs on vertical surfaces. Alternatively, you can leave in hot water for 30 minutes, and it becomes more flowable, making self-leveling easier on a horizontal surface.

Tip 2: When mixing different colors, make the mixture a tiny bit lighter than the chip itself. This will make the end result look better.

PREPARING THE REPAIR AREA

1. USE MASKING TAPE

Make sure the repair area is clean and dry. Apply masking tape around the defect to avoid scratching the surrounding surface during the repair.

Products to use:
Masking tape (excluded)

2. SAND THE DEFECT

Gently sand the defect area with the 220 Grit (yellow) sandpaper. This will help the filling material more easily stick to the surface.

Products to use:
220 Grit yellow sandpaper (4 pcs included)

3. CLEAN THE AREA

Clean the defect and surrounding area with a paper towel or piece of cloth.

Products to use:
Paper towel or piece of cloth (excluded)

FILLING THE DEFECT

4. ATTACH A MICROTIP

Remove the cap from the selected syringe and attach a microtip to the end.

Products to use:
Microtip for syringes (6 pcs included)
A suitable syringe (6 pcs included)

Visit stowsen.com for FAQs and instruction videos. Should you require any assistance, contact us at hello@stowsen.com for help.

5. FILL THE DEFECT

5.1 Using a single color

Fill the defect until above the surrounding surface. Avoid excessive overfilling, as this may require extra sanding later.

5.2 Using a mixture of colors

To obtain a desirable color match, mix different colors on a separate surface prior to filling the defect. Use a toothpick (or any other small stick) for mixing.

Once a suitable color is achieved, fill the defect with the help of the stick included in the kit. Avoid excessive overfilling, as this will require extra sanding later.

5.3 Defects deeper than 0.06 in (1.5 mm)

For defects deeper than 0.06 in (1.5 mm), fill and cure the repair area in layers (one layer should not exceed 0.06 in (1.5 mm) in depth). Use the leveling tape only for the top layer. A proper curing process is described in the following steps.

Products to use:

Stick (1 pcs included)

Toothpick (excluded)

A suitable syringe (6 pcs included)

6. COVER WITH LEVELING TAPE

Cover the repair material with a piece of leveling tape and gently press on it with your finger to flatten the surface. Leveling tape must remain on top of the filling during the curing process. If the defect is large, you may use multiple pieces of leveling tape next to each other to cover the whole area.

Products to use:

Leveling tape (4 pcs included)

SETTING UP THE BLUE LIGHT UNIT

7. ASSEMBLE THE UNIT

7.1 Place the included metal pointer through the eye protection shield and attach both to the blue light unit. Although the blue light is not harmful, the shield is designed to make working with it more comfortable for your eyes.

7.2 Remove the red protection from the metal pointer.

7.3 Connect the device to a wall plug and press the “P” button to start curing. The default mode is set to 20 seconds. You can adjust the curing duration by pressing the “T” button. Out of the box, the mode is set to 1. This is the one you want, so no need to press the “M” button.

Products to use:

Blue light unit (1 pcs included)

CURING THE REPAIR MATERIAL

8. CURE THE FILLING

After pressing the “P” button, hold the blue light unit 0.4-0.8 in (1-2 cm) above the repaired area for 20 seconds. For larger than 0.08 x 0.08 x 0.08 in (2 x 2 x 2 mm) size chips, you may want to cure the filling for 80 seconds to be sure it has completely hardened. You should also cure each section of the surface separately to make sure the entire area completely solidifies.

After curing the area, put the red protection back on the metal pointer to keep it safe.

Products to use:

Blue light unit (1 pcs included)

9. REMOVE THE LEVELING TAPE

After curing, press on the leveling tape to make sure the whole area is fully solidified. If not, cure for an additional 20 seconds, then gently remove the leveling tape.

FINISHING THE SURFACE

10. SAND OFF EXCESS MATERIAL

Carefully level the surfaces with a 220 grit sandpaper. Make sure to not scratch the surrounding surface.

Products to use:

220 Grit yellow sandpaper (4 pcs included)

11. WET SAND THE SURFACE

Once you have leveled the surfaces, add a few droplets of water on the repair patch and gently buff it with a 2500 grit wet sandpaper.

Products to use:

2500 Grit black wet sandpaper (2 pcs included)

12. CLEAN THE AREA

Once completed, clean the area with a paper towel or piece of cloth.

Products to use:

Paper towel or piece of cloth (excluded)

POLISHING THE SURFACE (OPTIONAL)

13. USE THE POLISHING WHEEL

Use the polishing wheel and a mandrel at 3000 rpm to slowly polish the repaired area as well as any scratches on the surrounding surface. You need a hand tool (e.g. a Dremel power tool) in order to use the polishing wheel. Please note that this step is not necessary - we simply make this available in case you require a polished surface.

Products to use:

Polishing wheel with a mandrel (1 pcs included)

Hand tool (excluded)

14. CLEAN THE AREA

Once completed, clean the area with a paper towel or piece of cloth.

Products to use:

Paper towel or piece of cloth (excluded)

FOR BEST RESULTS

1. USE LEVELING TAPE

Make sure to use a piece of leveling tape as directed. Otherwise, the top layer of the filling will not harden, resulting in a “sticky” surface. You should have a plastic bag containing these pieces of tape next to the sandpapers in your kit.

2. FULLY UTILIZE THE REPAIR KIT

To fully utilize the repair kit, you need a few extra items, including a hand tool (e.g. a Dremel power tool) and masking tape.

3. REPAIR THE RIGHT DEFECTS

Do not use the repair kit to attempt to fix hairline cracks, glass, or glue multiple pieces together. Find out which defects can and cannot be fixed at the beginning of the manual.

STORAGE INFORMATION

The average shelf life of the repair material is 3 years when stored in standard room conditions. Simply use the syringe to repair your surface, and close the cap to keep it safe. Just make sure the contents are kept away from direct sunlight and high temperatures.

Visit stowsen.com for FAQs and instruction videos.

Should you require any assistance, contact us at hello@stowsen.com for help.