



OLLA FLOATING MIRROR LARGE 1800X900 (3022M-2)

MCM HOUSE

Assembly instructions

We recommend MCM mirrors are hung by professional installers for the safest and most precise results.

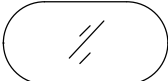
PARTS

A  Mirror frame 1x	B  38mm Self-tapping Screw 3x	C  Plastic anchor 3x
--	---	---



2 people
required for
assembly

1

Lock the screw B and plastic anchor C to the wall,
and then Hang the mirror frame A on the wall.

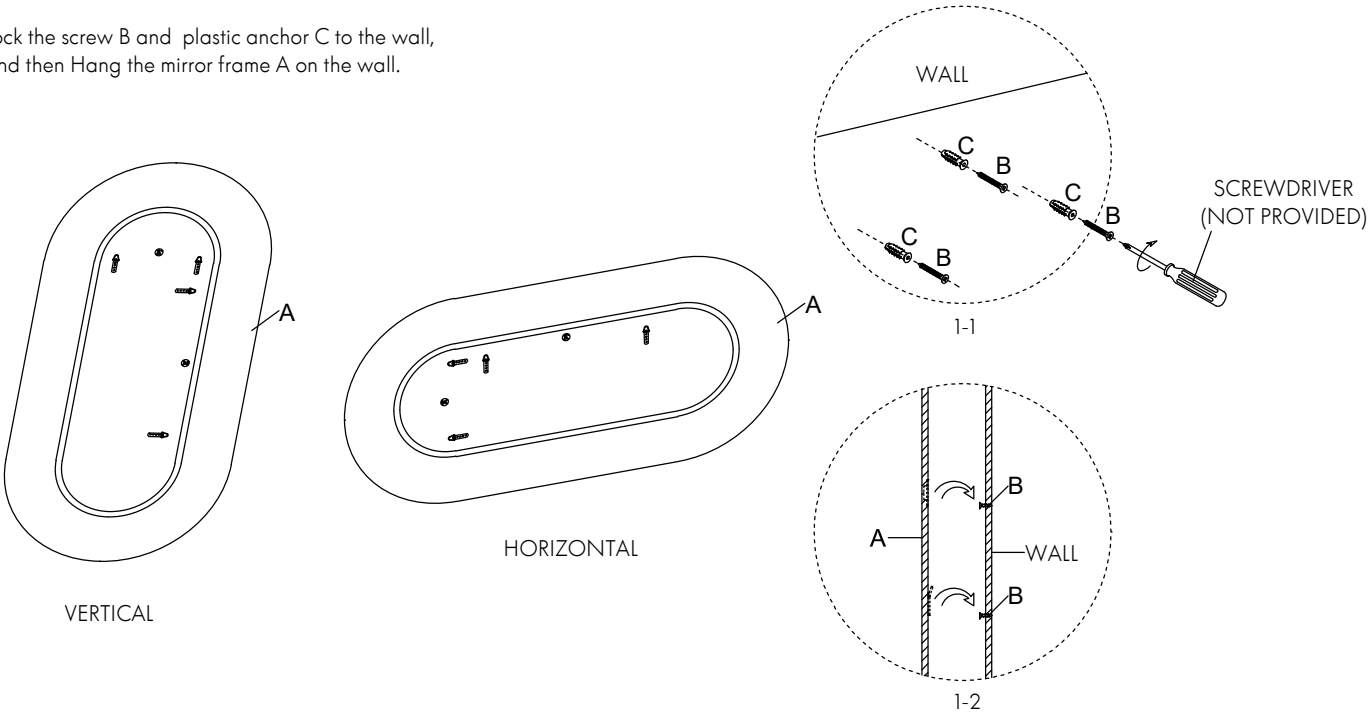

2

Finished assembly.

