



VC001

2014-19 (Classic) Chevy Silverado / GMC Sierra  
2015-20 Chevy Tahoe and Suburban / GMC Yukon and  
Yukon XL / Cadillac Escalade and Escalade ESV 5.3L & 6.2L



# IMPORTANT! WARRANTY AND INSTALLATION INSTRUCTIONS

*Please Forward All Information to End Consumer*

Be sure to review the enclosed instructions prior to beginning the installation process. If you have any questions about the enclosed parts or instructions, or if you encounter a problem during installation:

**CALL TECHNICAL SUPPORT: 440.891.0999 or 800.486.0999**

**TO ACTIVATE YOUR WARRANTY, GO TO:  
[volant.com/warranty](http://volant.com/warranty)**

This warranty does not extend to damaged or defect in the finish of a product or to any product, that in the opinion of Volant Performance, has been misused, damaged by accident or negligence, altered, or modified in any way, faulty installation, or installed contrary to Volant installation instructions, or repaired by an unauthorized service facility.

Full warranty available on [Volant.com](http://Volant.com)



**NEVER work on a hot engine bay.**  
Allow time for the vehicle to cool.



**Always wear eye protection**  
when working on a vehicle.

**Color instructions are available at [Volant.com](http://Volant.com). Search by kit number**

**Please take time to read and understand these installation instructions.**

Volant recommends that the installation of this system be performed by a qualified service center or professional installer who has the necessary equipment, tools, and experienced personnel. However, if you decide to perform this installation yourself, the use of an additional person may be required.

**WARNING:** Never work on a hot engine bay. Allow time for the vehicle to cool.

Always wear eye protection when working on a vehicle.

---

**Recommended Tools & Supplies**

- 7mm Socket & Ratchet or Wrench
  - 11/16in Wrench
  - 13mm Socket & Ratchet or Wrench
  - 2.5mm Hex Driver
- 

**INSTALL DIFFICULTY**



**Please confirm that all parts are present according to the bill of materials before beginning the installation.**

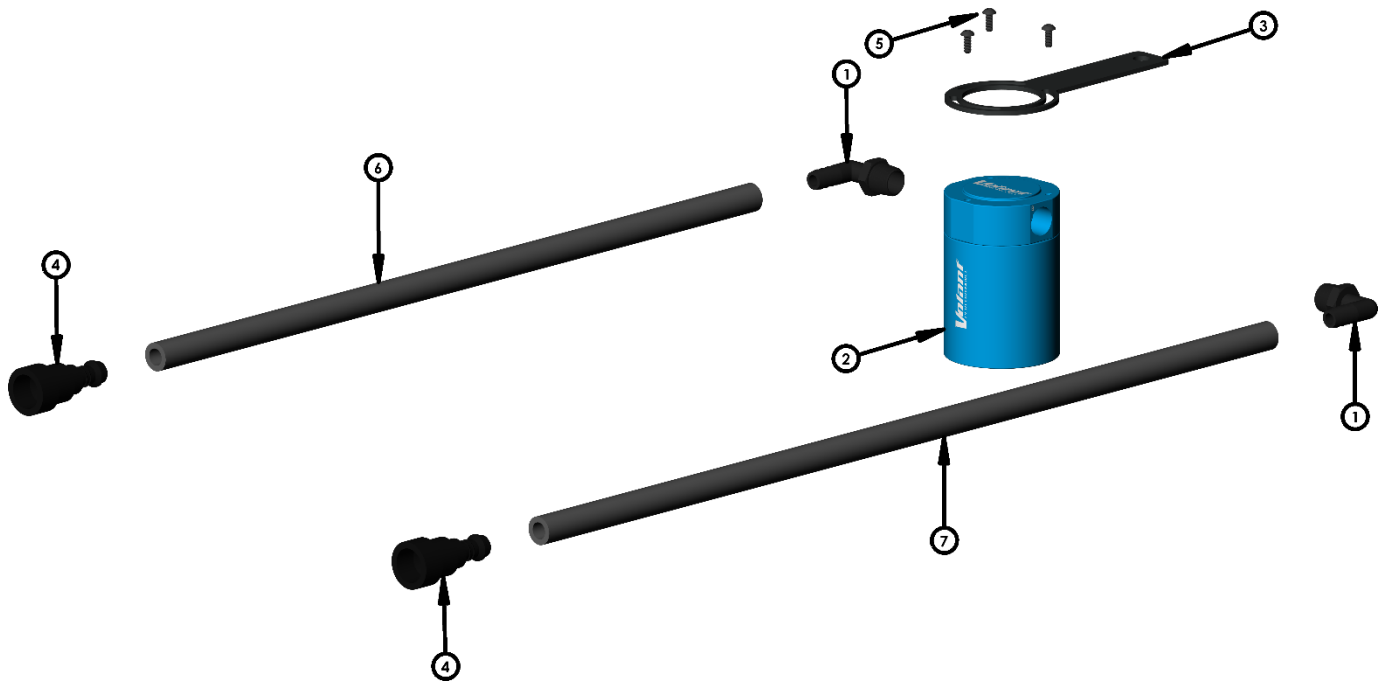

### Bill of Materials

1. 3/8" NPT Barbed Elbow Fitting (652190) (Qty 2)	2. Volant Catch Can (652287)
3. Mounting Bracket (652181PCB)	4. 10mm Quick Connect Fitting (652198) (Qty 2)
5. 4mm Button Head Screws (652187) (Qty 3)	6. Hose A - 3/8in x 18in (53003-18)
7. Hose B - 3/8in x 22in (53003-22)	

If something is missing, call Volant Tech Support at 440.891.099 or Toll Free: 1.800.486.0999

If you are using an aftermarket air intake, you may need to determine how the PCV lines run compared to the Factory air intake.

Instructions

Volant Catch Can

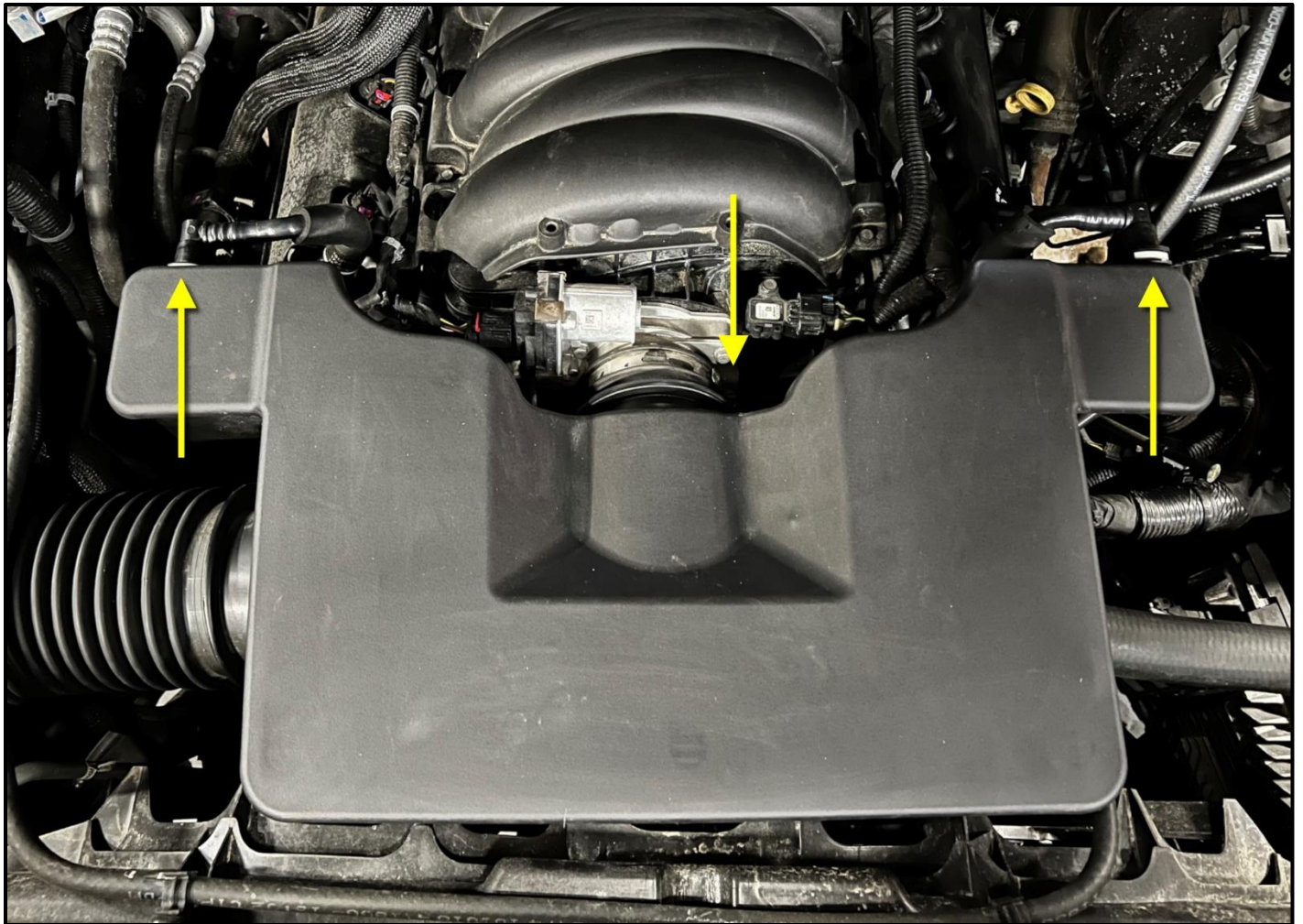

1. Begin by removing the Factory Air Intake by using a 7mm Socket & Ratchet or Wrench to loosen the clamp on the Throttle Body. Next, squeeze the locking tabs on the Quick Connect fittings to release them.

Continued on Next Page...

## Instructions

## Volant Catch Can

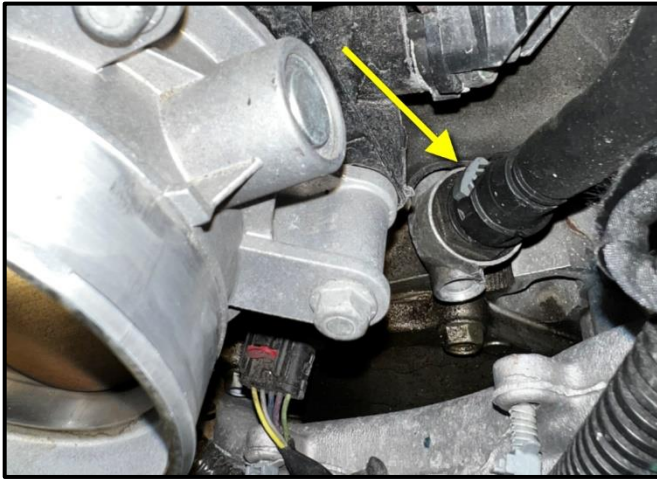

2. Locate the stock PCV line, located by the driver's side of the throttle body. Squeeze the tabs on the quick connect fitting to release it.

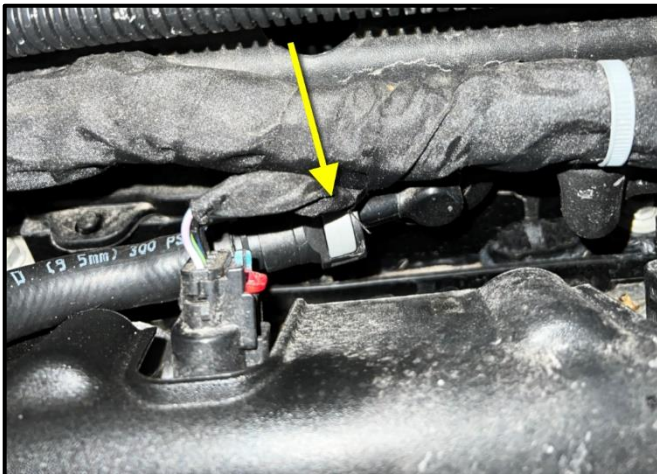

3. Locate the other end of PCV line located along the Intake Manifold on the driver's side of the vehicle. Squeeze the tabs on the quick connect fitting to release it. Remove the Factory PCV line.



4. Using an 11/16in wrench, install Barbed fittings. **DO NOT OVER TIGHTEN!**

**IMPORTANT:** Volant recommends using thread sealant or PTFE tape on the barbed fittings to prevent any leaks.

5. Using a 2.5mm Hex Wrench, snug the Button Head Screws through the Mounting Bracket and into the Catch Can. **DO NOT FULLY TIGHTEN AT THIS TIME.**

Continued on Next Page...

## Instructions

## Volant Catch Can



- Attach quick disconnect fittings to one end of each of the provided hoses. A mild lubricant or heat may be needed to fully install fitting into hose.



- Locate the Fender Brace on the Driver's side, above the Brake Fluid Reservoir. Using a 13mm Socket & Ratchet or Wrench, remove the Bolt. Place Catch Can Bracket on top of flat surface and reinstall the Bolt.

**DO NOT FULLY TIGHTEN AT THIS TIME.**

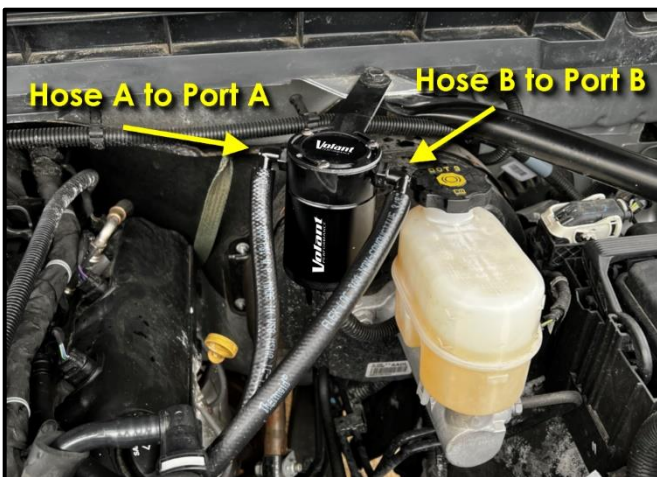

- Route Hose A to the fitting located along the Intake Manifold. (Step 3 location) and then attach it to the Barbed Fitting in Port A of the Catch Can.
- Route Hose B to the fitting located next to the Throttle Body (Step 4 location) and then attach it to the Barbed Fitting in Port B of the Catch Can.
- Make sure all Quick Connect fittings are secured in place and the hoses are pushed all the way over the barbed ends of the fittings. Fully tighten the hardware from Steps 5 and 7.
- Reinstall the Air Intake reversing Step 1.

**This concludes the installation of the Volant Catch Can.**

*Check that this Catch Can complies with your Federal, State and Local laws.  
We recommend saving your stock PCV line(s).*

### Before Road Testing

1. Start engine, leaving the transmission in park and/or securing the parking brake.
2. Make sure to look and listen for any unusual noises. Repair problems if needed.
3. Once completed it will be necessary to check periodically, after a few heat cycles, for realignment and tightening of all connections.

### Emptying Catch Can and Care

The Volant Catch Can will need to be emptied periodically. Volant recommends, at minimum, emptying at every oil change. When the Catch Can is full, the PCV line will operate normally, but the Catch Can will allow the oil and vapor to pass through.

1. Hold the top of the Catch Can and Bracket firmly.
2. Twist the bottom of the can counterclockwise (loosen) until is free of the top and bracket.
3. Properly dispose of the oil and vapor residue.
4. If the threads of the bottom are dry, apply some fresh oil or petroleum jelly to the threads. This will help with removing the bottom the next time.
5. Reinstall the bottom of the can while firmly holding the top and bracket.  
**Caution:** DO NOT OVER TIGHTEN. It will make removal difficult.