



## IMPORTANT! WARRANTY AND INSTALLATION INSTRUCTIONS

*Please Forward All Information to Consumer*

Be sure to review the enclosed instructions prior to beginning the installation process. If you have any questions about the enclosed parts or instructions, or if you encounter a problem during installation:

**CALL TECHNICAL SUPPORT: 440.891.0999 or 800.486.0999**

**COLOR INSTRUCTIONS ARE AVAILABLE BY PART NUMBER ON:**

[VOLANT.COM](http://VOLANT.COM)



**NEVER work on a hot engine bay.**

**Allow time for the vehicle to cool.**

**INSTALL DIFFICULTY**



---

## RECOMMENDED TOOLS & SUPPLIES

- 8mm and 10mm Socket
  - Flat Head Screwdriver
  - Trim Removal Tool
  - Philips Head Screwdriver
-

**Please take time to read and understand these installation instructions.**

Volant recommends that the installation of this system be performed by a qualified service center or professional installer who has the necessary equipment, tools, and experienced personnel. However, if you decide to perform this installation yourself, the use of an additional person may be required.

**WARNING:** Never work on a hot engine bay. Allow time for the vehicle to cool.

Check that this air intake complies with your Federal, State, and Local laws. We recommend saving your stock system.

This warranty does not extend to damaged or defect in the finish of a product or to any product, that in the opinion of Volant Performance, has been misused, damaged by accident or negligence, altered or modified in any way, faulty installation or installed contrary to Volant installation instructions, or repaired by an unauthorized service facility.

Full warranty available on <http://www.volant.com>

**Please confirm that all parts are present according to the bill of materials before beginning the installation.**

If something is missing call Tech Support at 440.891.099 or Toll Free: 1.800.486.0999

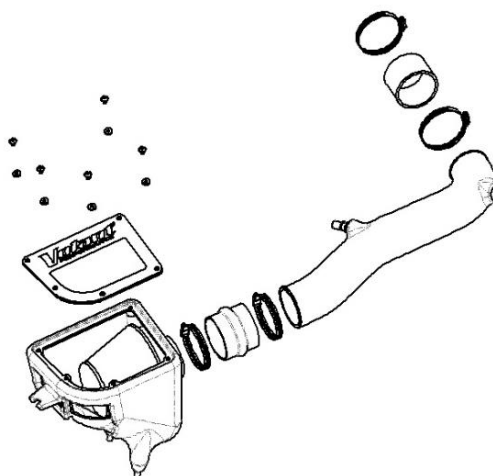

### PREASSEMBLED MATERIALS

412219 - Volant Filter Box		441304 - Volant Air Duct		652075 - Volant Air Box Lid	
460635 - Filter Adapter	1	59034138 - 5/8" Fitting	1	5900 - Lid Screws	5
		59045101 - Rubber Grommet	1	59025122 - Rubber Washers	5

### FILTER OPTIONS

Pro 5 (Oiled) Part # 5120	PowerCore® (Dry) Part # 61513
---------------------------	-------------------------------

### HARDWARE KIT

52056 - #56 Clamp	4	53106 - Straight Sleeve (Ø3.25")	2.5"	53203 - Hump Hose (Ø3.5")	1
652061-240 – Air Box Mounting Bracket	1				

*Locate the vehicle's battery and disconnect the negative battery cable.  
This may reset the computer and clear old air flow data to help prevent CEL errors.*

**REMOVAL INSTRUCTIONS**

**FACTORY INTAKE**



1. Unclip wiring harness from air temp sensor.



2. Using trim removal tool, remove the (2) clips attaching the ATS wiring harness to the factory air duct.



3. Using trim removal tool, remove the clip attaching coolant line to factory air duct.



4. Remove the two 10mm bolts holding the factory air duct to the core support using a 10mm socket and ratchet.

Continued on Next Page . . .



### REMOVAL INSTRUCTIONS

### FACTORY INTAKE



5. Remove the 10mm bolt holding the factory air box to the fender using a 10mm socket and ratchet. **Save for reinstallation.**



6. Disconnect the breather hose from the factory air duct.



7. Loosen clamp holding factory air duct to throttle body using an 8mm socket and ratchet or flat head screwdriver.

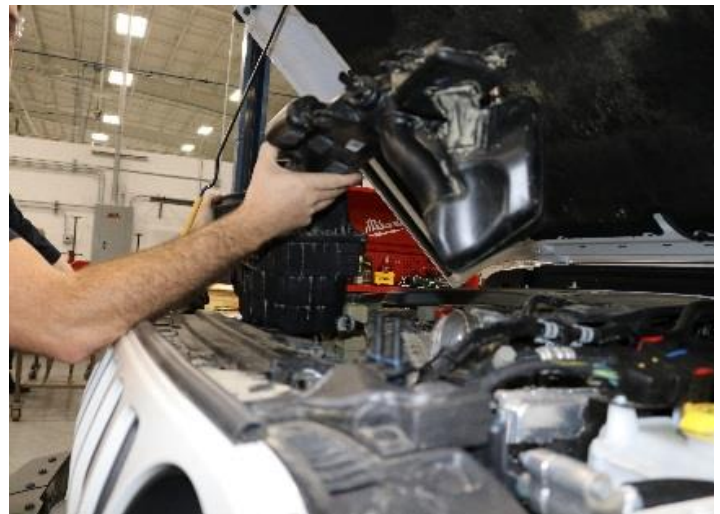

8. Remove factory intake as one assembly by pulling up, then out. **Save in case vehicle needs to be returned to stock.**

Continued on Next Page . . .

REMOVAL INSTRUCTIONS

FACTORY INTAKE



9. Remove both grommets from bottom of factory air box. **Save for reinstallation.**



10. Remove ATS from factory air duct by gently lifting tab and twisting.

This concludes the removal of the factory intake.



**INSTALLATION INSTRUCTIONS**

VOLANT INTAKE



1. Place the (2) rubber grommets from removal step 9 back into the factory location.



2. Press the air temperature sensor into the grommet in the Volant air duct. A light amount lubricant will help installation.



3. Make sure the sensor is oriented as shown.

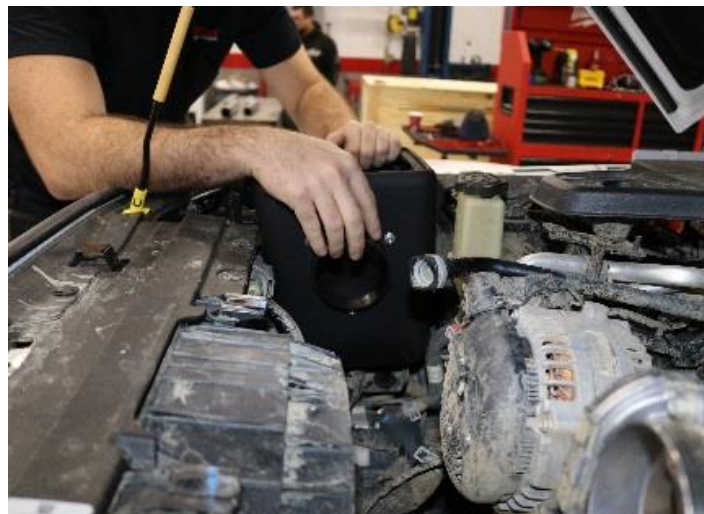

4. Place the Volant air box into the vehicle by fitting the bottom of the box into the (2) grommets from install step 1.

Continued on Next Page . . .

INSTALLATION INSTRUCTIONS

VOLANT INTAKE



5. Install the hump hose onto the Volant filter adapter along with a #56 clamp. Tighten the clamp using an 8mm socket or nut driver.



6. Install the straight sleeve onto the shorter end of the Volant air duct along with a #56 clamp. Do not tighten clamp at this time.



7. Install Volant air duct into hump hose along with a #56 clamp. Do not tighten the clamp at this time.



8. Install the straight sleeve onto the throttle body along with a #56 clamp. Do not tighten clamp at this time.

Continued on Next Page . . .



### INSTALLATION INSTRUCTIONS

VOLANT INTAKE



9. Tighten the clamp holding the straight sleeve to the throttle body with an 8mm socket or nut driver, ensuring the straight sleeve is completely bottomed out. Tighten the remaining clamps, taking care that the Volant air duct has clearance above the fan shroud.



10. Reconnect the factory breather hose to the fitting installed in the Volant air duct.



11. Reconnect the factory air temperature sensor wiring harness to the sensor.



12. Secure Volant air box to the fender with the bolt from removal step 4 and air box mounting bracket. Install bracket from inside air box, underneath the mounting tab of air box. Install bolt through bracket and tighten with 10mm socket.

Continued on Next Page . . .



### INSTALLATION INSTRUCTIONS

VOLANT INTAKE



13. Install the Pro5 Filter #5120 or PowerCore Filter #61513 along with clamp into the Volant air box and onto the filter adapter. Make sure to press the filter onto the adapter completely so it is bottomed out.



14. Tighten the filter clamp using an 8mm socket or nutdriver.



15. Install the Volant lid onto the Volant air box.



16. Secure lid to Volant air box with the (5) provided truss head screws and rubber washers, using a Philips head screwdriver. Tighten only enough to slightly compress the lid gasket..

Continued on Next Page . . .

### INSTALLATION INSTRUCTIONS

### VOLANT INTAKE



17. Place CARB EO label in visible location under hood. This completes your Volant air intake installation.

*Check that this air intake complies with your Federal, State and Local laws.  
We recommend saving your stock system.*

#### BEFORE ROAD TESTING

1. Start engine, leaving the transmission in park and securing the parking brake.
2. Make sure to look and listen for any unusual noises or air leaks. Repair problems if needed.
3. Once completed it will be necessary to check periodically, after a few heat cycles, for realignment and tightening of all connections.

#### PRO5 CARE AND CLEANING

Check the Pro-5 cotton reusable filter periodically and remove any excessive dirt build-up by tapping the filter on the ground and brushing off the loosened dirt. Clean the filter by using a two stage cleaning kit to thoroughly clean and re-oil the filter. Re-oil every 10,000 miles without cleaning to improve filtering in sand and dirt. Clean only when dirt is very excessive or 50,000 miles.

**Reference for Replacement Filters:** Pro5 Filter Part # 5120 or PowerCore® Filter Part # 61513