

Use and Maintenance

- SC500

ATTENTION! Do not use the machine before you have read and understood the Instructions for use manual

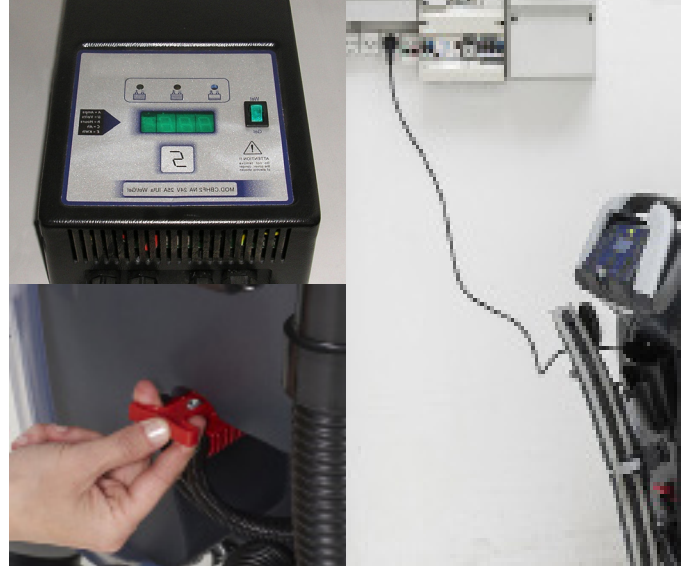

- 1a. Unplug the Battery charger cable. Reconnect it to the machine.
1b. Disconnect the battery charger cable from the electrical socket.



2. Fill the tank with a clean water. The clean water temperature must not exceed 40 °C. Make sure the solution valve under the machine is open.



3. Fill the EcoFlex™ tank with a detergent suitable for cleaning machines (highly concentrated and low foaming detergent).



4. Install the squeegee and fasten it with the knob.



5. Place the brush or the pad-holder under the deck. Use the appropriate brush to clean the floor.



6. Insert the operator key, then start the machine by pressing the One-Touch button. To engage the brush, slightly press the drive paddle and then release it.



7. Lower the squeegee with the pedal.



8. Push forward the drive paddle to start cleaning. Adjust maximum speed by the speed regulation buttons.



9. To change the solution flow level push the solution button and change flow level according to the cleaning performance and application.



10. If necessary press the extra pressure function (hold for one second). If necessary press the silent mode button for extra low sound level.



11. Press the EcoFlex™ button whenever you temporarily need a greater cleaning power.



12. Machine with Ecoflex, always end the daily work with turning off the detergent 2 minutes before finishing by pressing the detergent button. To rinse out detergent from the system and brush before handling and cleaning.



13. Empty the recovery tank with the hose. Then empty the solution tank with the transparent hose.



14. Empty the debris tray and clean/wash the recovery tank inside.

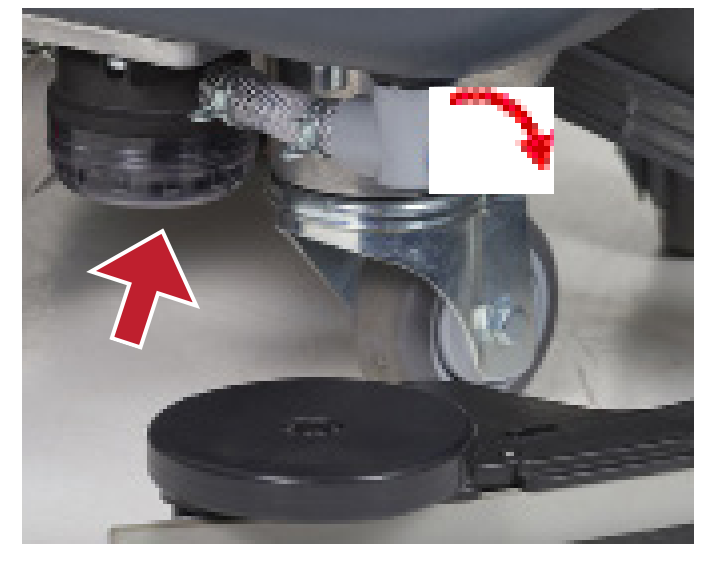

15. Clean the filter:
A) Close the solution valve under the machine.
B) Remove the transparent cover and the gasket, then remove and clean the filter inside.
C) Reassemble the filter.



16. Press the click-off button and wait for the brush/pad holder to fall on the floor. Remove to clean or change brush.



17. Take the squeegee off and remove debris. Check and clean the squeegee blades.



18. Clean the machine using a damp cloth and where needed use a neutral cleaning product.



19. Charge the batteries: Connect the battery charger cable to the electrical socket.



20. Park the machine with the recovery tank cover open.

If the machine has been used until the Red light illuminates on the battery level indicator on the machine, a full recharge of the batteries (10-12 hours) will be required. Failure to carry out this procedure may cause damage to the batteries. Charging the batteries after every use is recommended.

PLEASE ENSURE THE CHARGER IS ALWAYS CONNECTED TO THE BATTERIES EVEN IF NOT USED FOR LONGER PERIOD OF TIME TO PREVENT DAMAGE TO THE BATTERY DUE TO LOW VOLTAGE

Troubleshooting

- SC500

ATTENTION! Do not use the machine before you have read and understood the Instructions for User Manual

The machine doesn't work as it should?



1 Check if the power cable is correctly connected.



2 Check if the battery is charged.



3 Restart the machine without pressing the paddle.



4 Check floor inclination is not exceeding specifications.

The suction doesn't work as it should?



1 Check if the suction hose is correctly installed and cleaned.



2 Open the recovery tank and check the debris tray and float are clean and working.



3 Check if squeegee blades are damaged or dirty.



4 Check the lid gasket is in good and working condition and sealing when lid is closed.

The machine doesn't clean as it should?



1 Check if you have the right detergent and water settings.



2 Check if the solution valve is open.



3 Check if the solution filter is cleaned.



4 Check the EcoFlex™ system is cleaned, eventually purge the system.

The brush don't work as they should?



1 To adjust machine direction turn front knob until machine is working straight.



2 Check if there isn't any brush motor overload "WARNING ALARM F2" on the display.



3 Check if the brush are correctly installed and not worn out or if there are external materials avoiding brush rotating.