

Use and Maintenance

– SC5000

ATTENTION! Do not use the machine before you have read and understood the User Manual



1. Verify the batteries are fully charged (and if necessary re-charge).



2. If the E-stop icon appears on the display this indicates the E-stop is engaged and the machine will not function. Twist the E-stop switch to enable machine function.



3. Verify recovery tank cover seal is properly installed and in good condition.



4. Verify the squeegee blades are not damaged and install the squeegee by turning the yellow knobs. Verify the height of the squeegee by adjusting the castor wheels and the angle knob.



5. Manually install disc brushes or auto-install brushes by aligning brush directly below motor using alignment system and then pushing brush install button. (Disc version only).



6. Verify side skirts are not damaged, adjust height if needed.



7. Fill the tank with a clean water. The clean water temperature must not exceed 130°F (54°C). Make sure the solution valve under the machine is open.

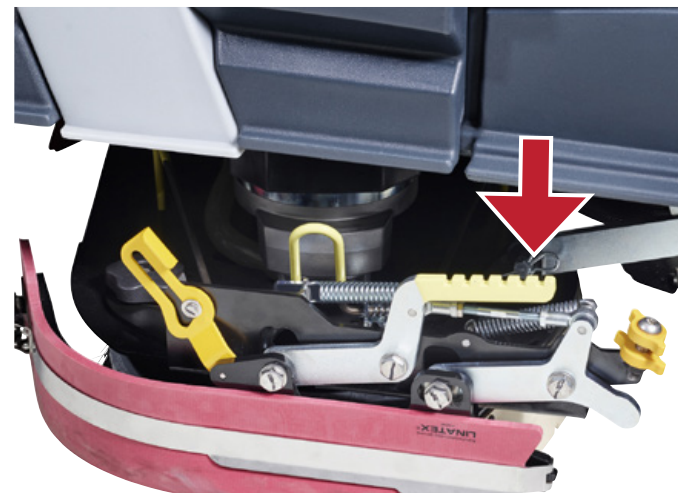

8. Lift side skirts when double scrubbing is needed.



9. Press One-Touch button to engage brush deck and squeegee.



10. Adjust scrub parameters to meet application requirements.



11. Press "I" scroll down to faults and press ">" button to view faults if needed.



12. Empty the recovery tank using the drain hose. Empty the debris tray and rinse the recovery tank using clean water. Leave the lid open to allow tank to dry.

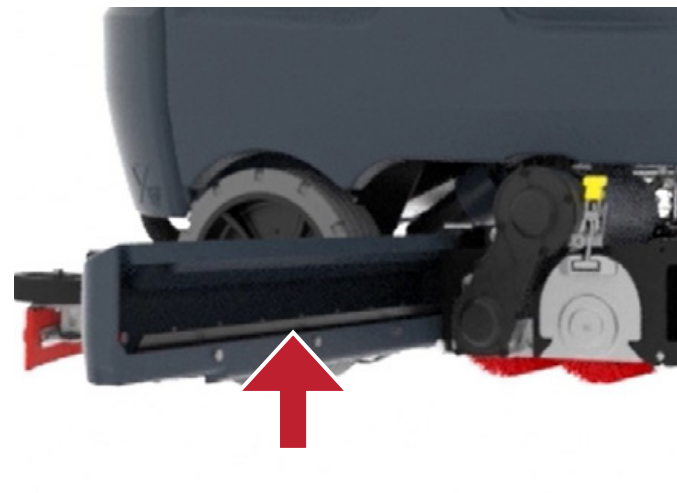

13. Remove and empty the debris hopper. (cylindrical version only).



14. Remove brushes, inspect and remove any debris.

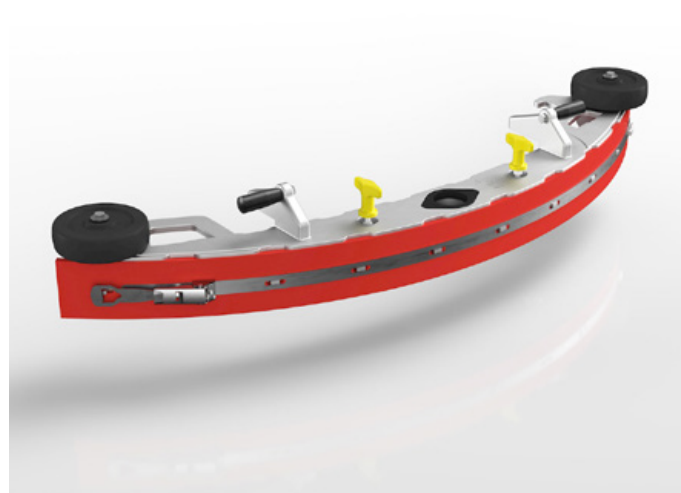

15. Untighten the yellow knobs, take the squeegee off and remove debris. Check and clean the squeegee blades.



16. Clean the filter:
A) Close the solution valve under the machine.
B) Remove the transparent cover and the gasket, then remove and clean with fresh water the filter inside.
C) Reassemble the filter and open the solution valve.



17. Clean the machine using a damp cloth and where needed use a neutral cleaning product.



18. Charge the machine.

If the machine has been used until the Red light illuminates on the battery level indicator on the machine, a full recharge of the batteries (10-12 hours) will be required. Failure to carry out this procedure may cause damage to the batteries. Charging the batteries after every use is recommended.

PLEASE ENSURE RED SOCKET IS LEFT DISCONNECTED AFTER RECHARGE IF THE MACHINE IS NOT TO BE USED ON A DAILY BASIS.

Troubleshooting

– SC5000

ATTENTION! Do not use the machine before you have read and understood the Instructions for User Manual

The machine doesn't work as it should?



1. Check battery charge gauge.

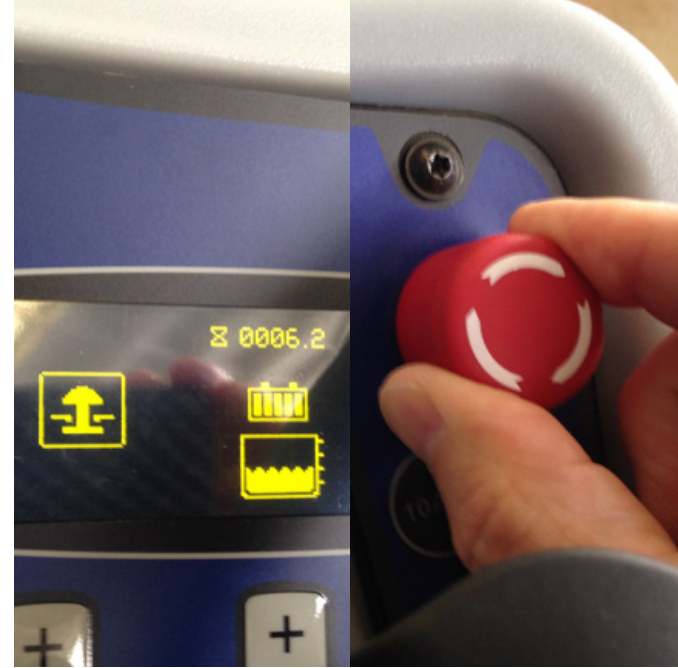

2. Verify E-stop is not engaged. E-stop icon that appears on display when E-stop switch is engaged. Twist E-stop switch to enable machine function.



3. Verify the battery cables are properly connected.

The suction doesn't work as it should?



1. Verify recovery hose is clean and free of debris. Ensure it is properly connected to the squeegee.



2. Inspect recovery tank float switch operation.

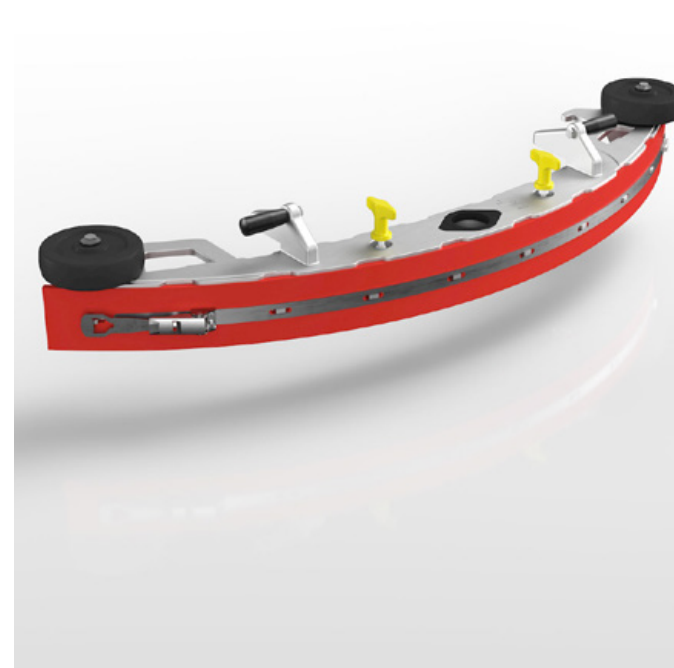

3. Check if squeegee blades are damaged or dirty.



4. Recovery tank seal cover must correctly installed and in good condition.

The machine doesn't clean as it should?



1. Verify that scrub parameters are correct for the required job. Increase pressure, solution and/or detergent concentration as needed.

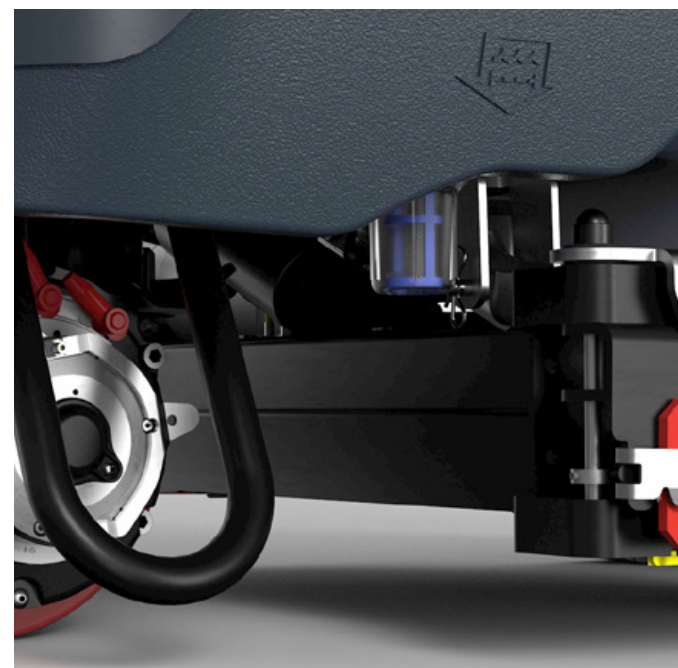

2. Verify solution is flowing to the deck. If not, verify solution tank is not empty, and solution valve is open.

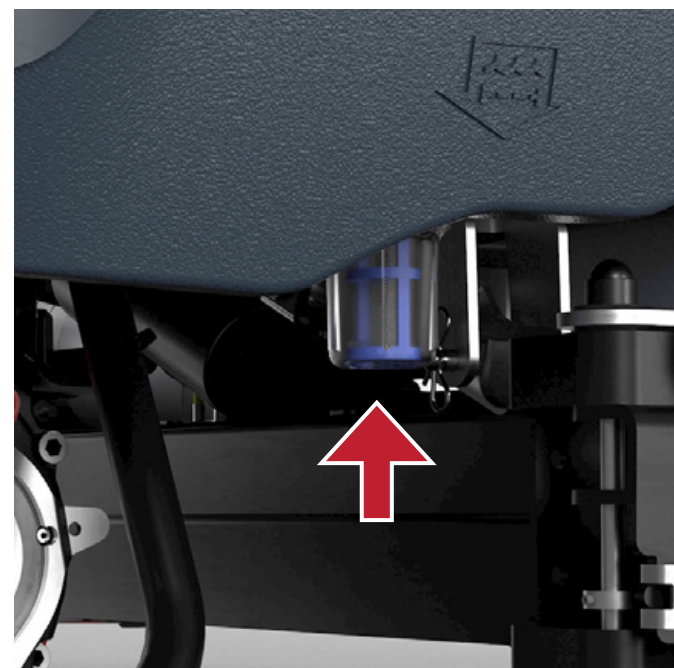

3. Verify the solution filter is clean.

The brushes don't work as they should?



1. Remove side skirt assembly and verify brush installation and condition.



2. Press "I" scroll down to faults and press ">" button to view faults.



3. Turn brushes counter clockwise and check if there are external materials avoiding brush rotating.