





A Quick guide for

ST7 / HT7 installation

Shifting cable and brake hose routing

Get your new handlebar and stem set up in no time with our easy-to-follow instructions.

Rear brake hose  Rear derailleur cable 
Front derailleur cable  Front brake hose 
Di2 wire 



Fixing Bolts

Stem Body

Spacers

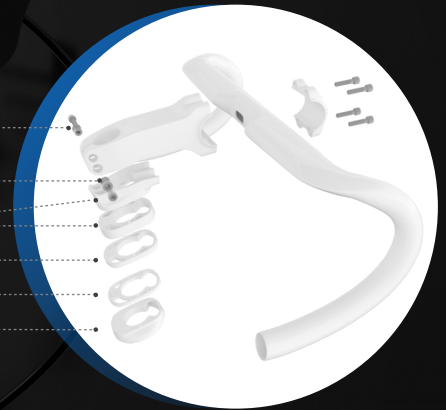

Cable Routing Variations

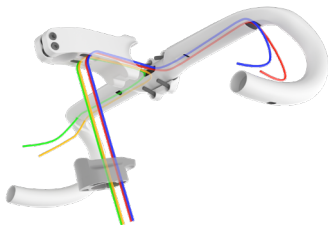

Internal Routing Frameset

To use the complete internal cable routing, you need to ensure that both the frame and fork are compatible. Specifically, for the fork, it needs to have a hole where the front brake cable can enter the fork-tube, so that the cable can be routed internally and exit near the front brake caliper.

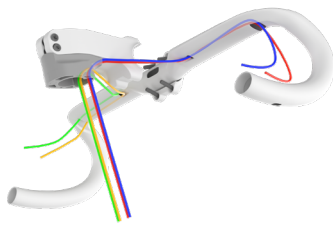

Semi-Integrated Cable Routing

To seamlessly incorporate your existing handlebar with our ST1 stem, follow the optimal cable routing method outlined below. This approach eliminates the need to drill the back of the handlebar, ensuring a hassle-free installation.

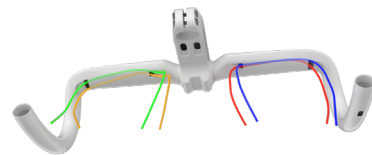

Traditional Frameset

In case of assembling on traditional frameset, cables will enter close to the levers and will go out from central holes. Here above a picture showing the cables passages.

Shifter/Brake lever Installation

Carefully observe the bolt's length before attempting to tighten. Use torque wrench to precisely tighten the bolt around **6-8Nm**

