



www.agama-rc.com

A319

**1/8 SCALE 4WD NITRO
OFFROAD BUGGY**

Ryan Lutz

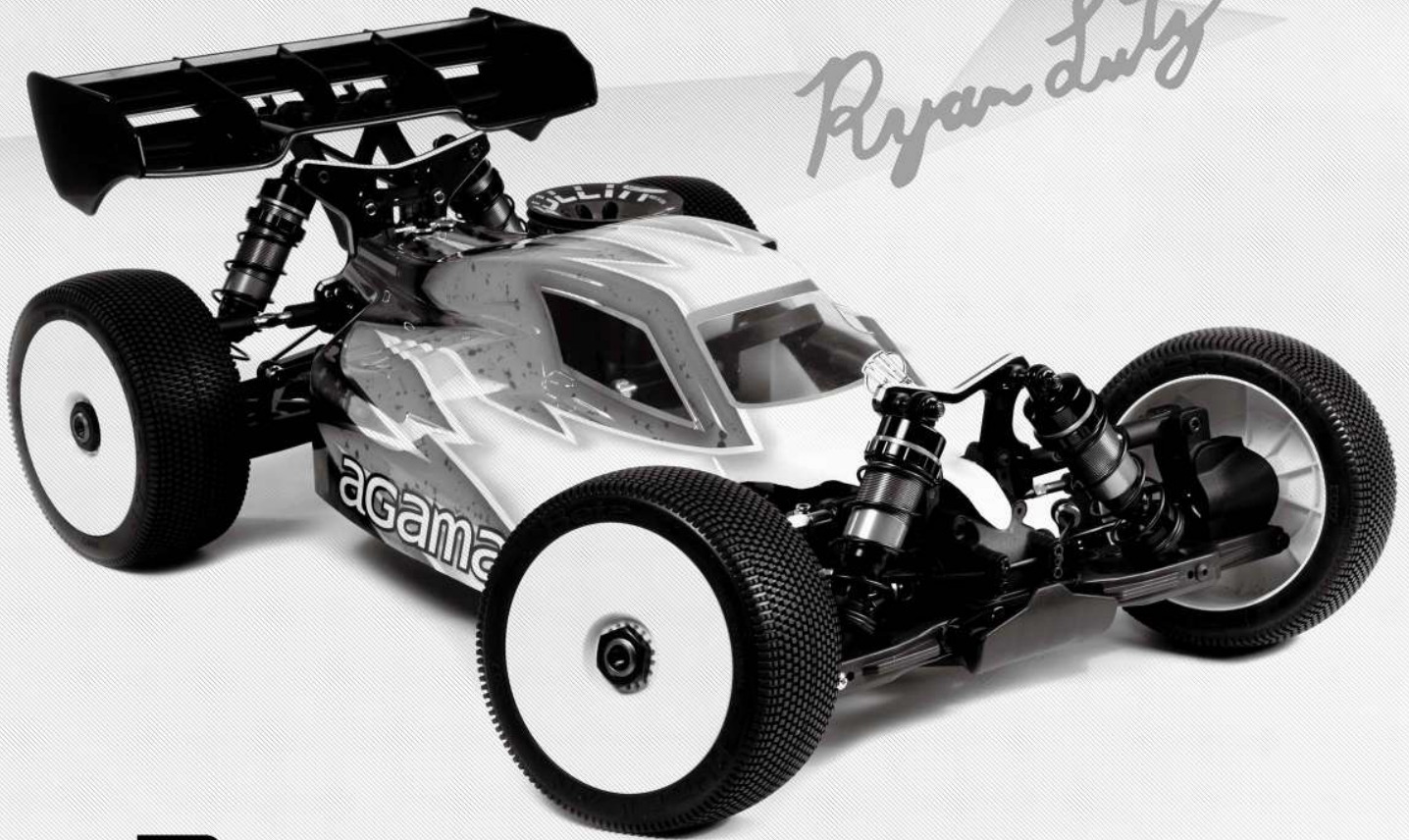

GEN 3 PRO KIT

Instruction Manual

Agama vehicles fit a wide range of skilled drivers. Pros and Beginners alike can experience Agama products with great results!
Agama products are designed with quality and precision in mind.

Made in Taiwan

INTRODUCTION		01
CAUTION		02
BAG A	Front Diff Installation	03
	Rear Diff Installation	04
	Center Diff Installation	05
BAG B	Shock Install (Front & Rear)	06-07
BAG C	Front Spindle & CVD Installation	08
BAG D	Front End Installation	09-12
BAG E	Rear Hub & CVD Installation	13
BAG F	Rear End Installation	14-17
BAG G	Center Diff/Brake Installation	18
BAG H	Switch/Antenna tube Installation	19-20
	Clutch Assembly	21
BAG I	Clutch Bell Assembly	22
	Engine Mount Assembly	23
	Servo Saver Installation	23
	Steering Servo Link Assembly	24
BAG J	Steering Post & Front Chassis Support Assembly	25
	Steering Saver & Front Chassis Brace Assembly	25
	Completed Steering Assembly	25
BAG K	Chassis Guard Installation	26
	Throttle/Brake Linkage Assembly	26
BAG L	Completed Throttle/Brake Assembly	27
BAG M	Air Filter Assembly	27-28
CHASSIS INSTALLATION		29-35
FACTORY SETUP SHEET		36-38

Notice: The following items are needed for completion of the PRO KIT, They are not included with this kit (unless noted), and should be obtained from your local hobby shop.
Be sure to read the instructions completely prior to assembly.

ADDITIONAL ITEMS NEEDED FOR COMPLETION

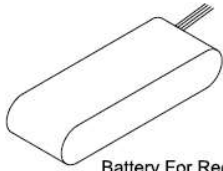

Battery For Receiver
68x37x20mm

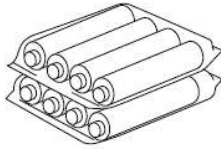

Battery For Transmitter

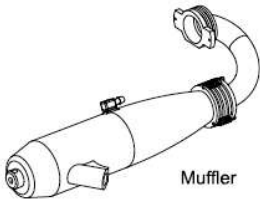

Muffler

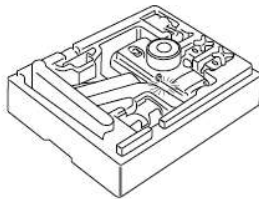

2 Channel Radio

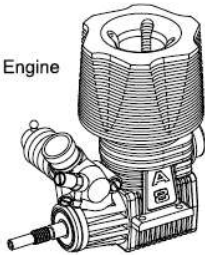

Engine

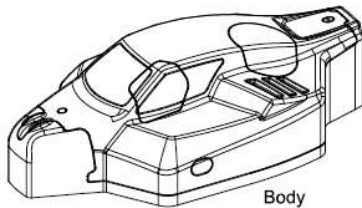

Body

TOOLS NEEDED TO ASSEMBLE

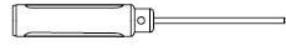

Hex Wrenches

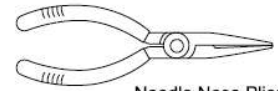

Needle Nose Pliers

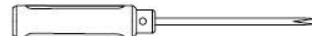

Phillips Type Screw Driver



Scissors

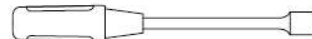

Box Wrench (5.5mm / 7mm / 10mm)



Hobby Knife

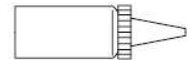

Instant Glue



Pliers

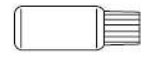

Thread Locker

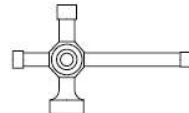

Utility Wrench



Glass or Vinyl Tape



Rubber Glue

ADDITIONAL ITEMS NEEDED FOR STARTING



Air Filter Oil



Fuel bottle

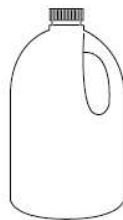

Fuel

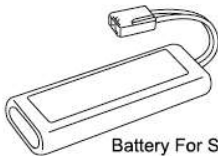

Battery For Starter Box



Glow Plug Ignitor

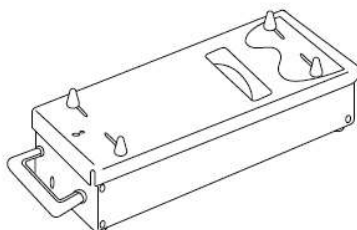

Starter Box

ITEMS NEEDED TO CONTROL CAR

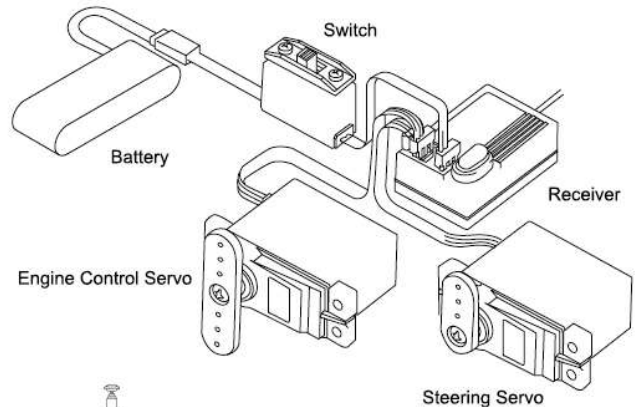

Battery

Switch

Receiver

Engine Control Servo

Steering Servo



Transmitter

STEP A - 1

Front Diff Ring Gear Assembly

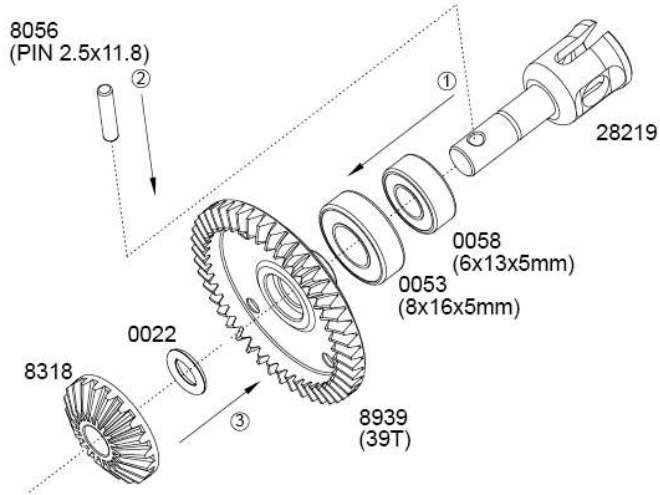

STEP A - 2

Front Diff Case Assembly

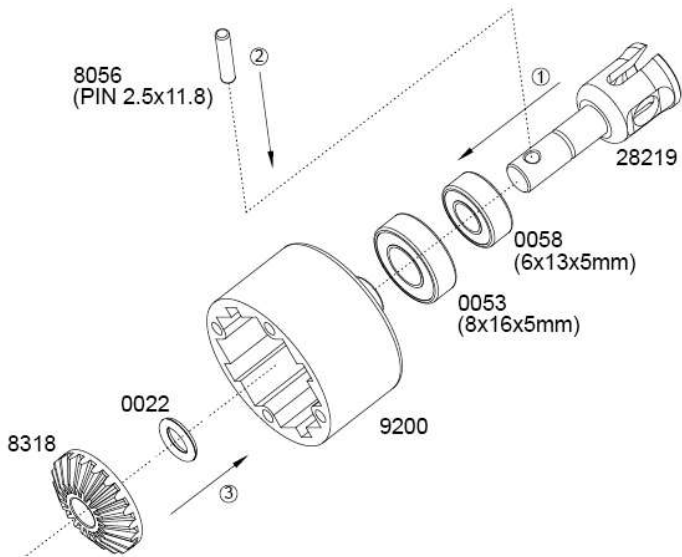

STEP A - 3

Complete Front Diff Assembly

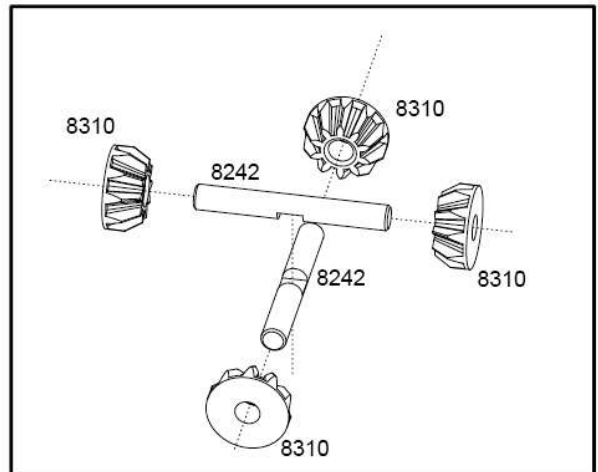
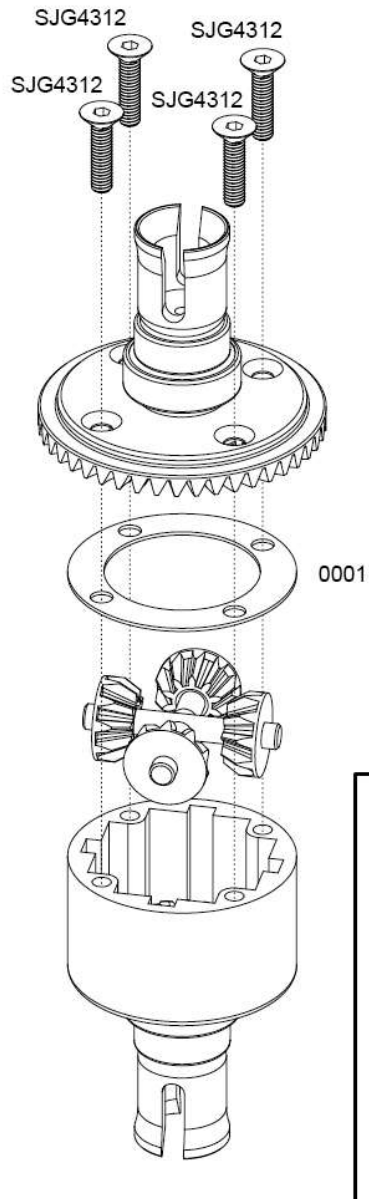

STEP A - 4

Rear Diff Ring Gear Assembly

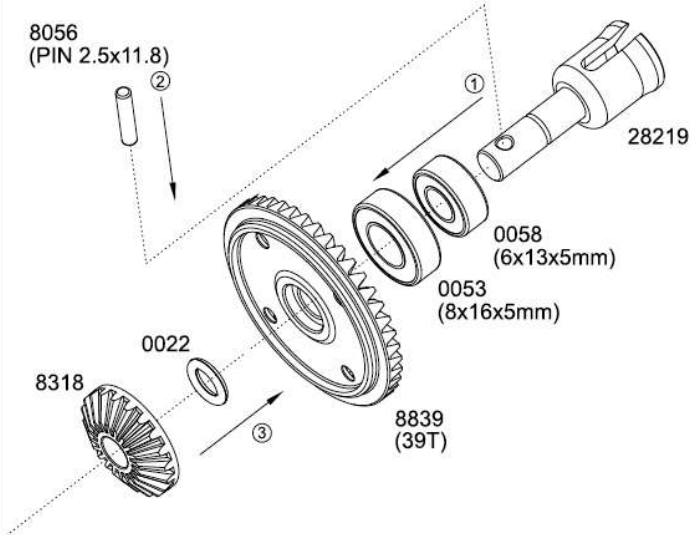

STEP A - 5

Rear Diff Case Assembly

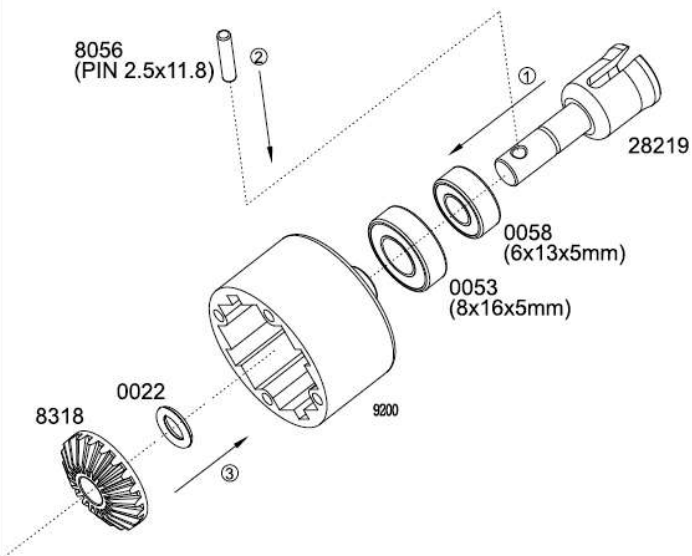

STEP A - 6

Complete Rear Diff Assembly

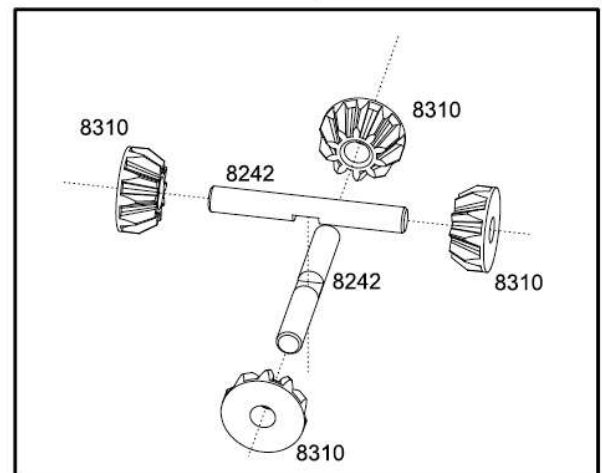
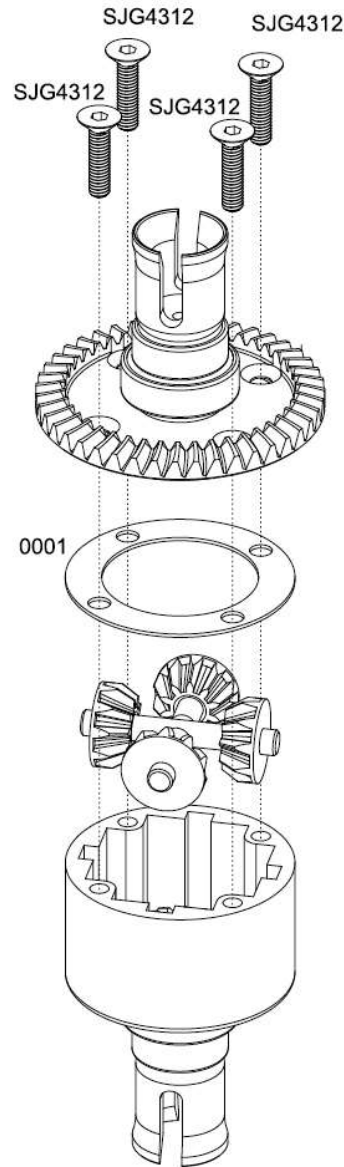

STEP A - 7

Center Diff Ring Gear Assembly

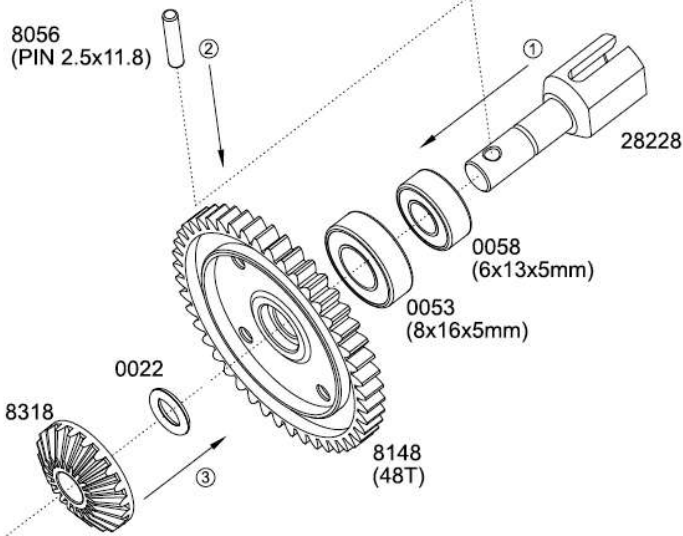

STEP A - 9

Complete Center Diff Assembly

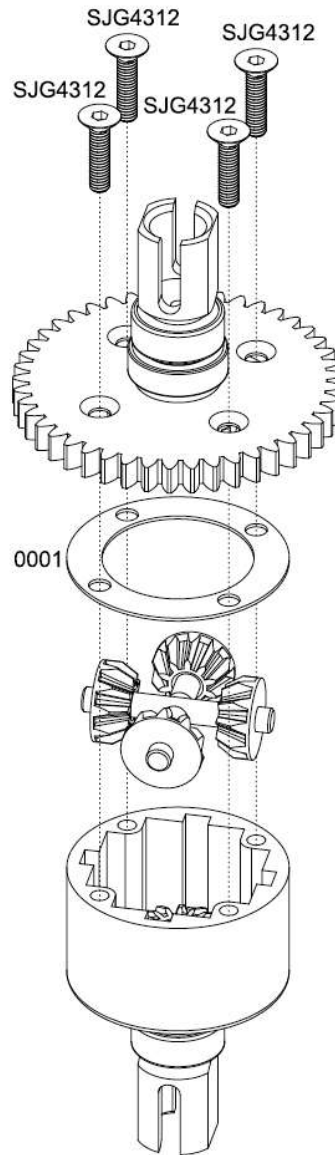

STEP A - 8

Center Diff Case Assembly

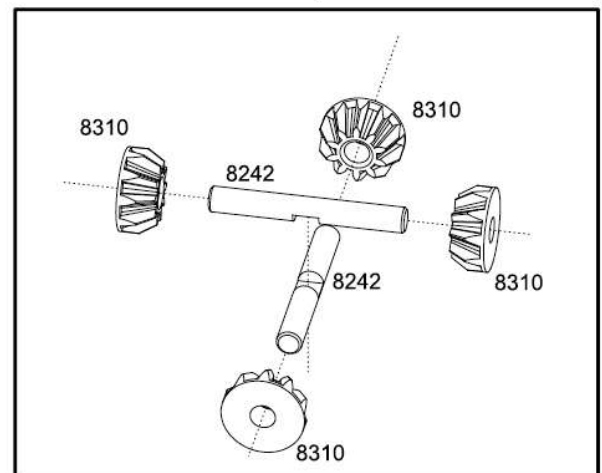
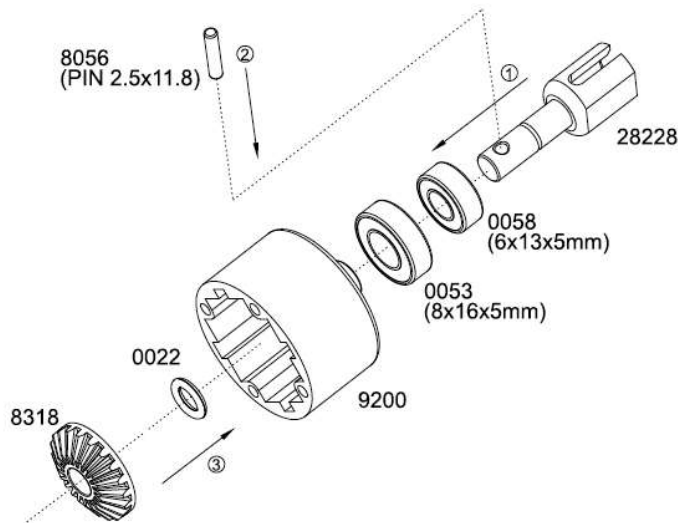

STEP B - 1

Shock Assembly (Front & Rear)

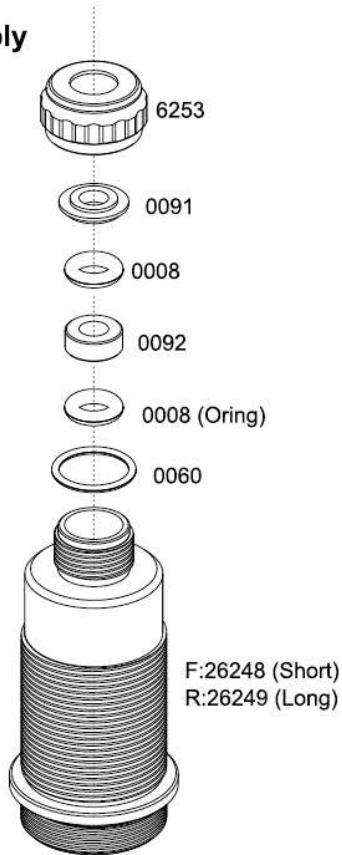

STEP B - 3

Shock Assembly (Front & Rear)

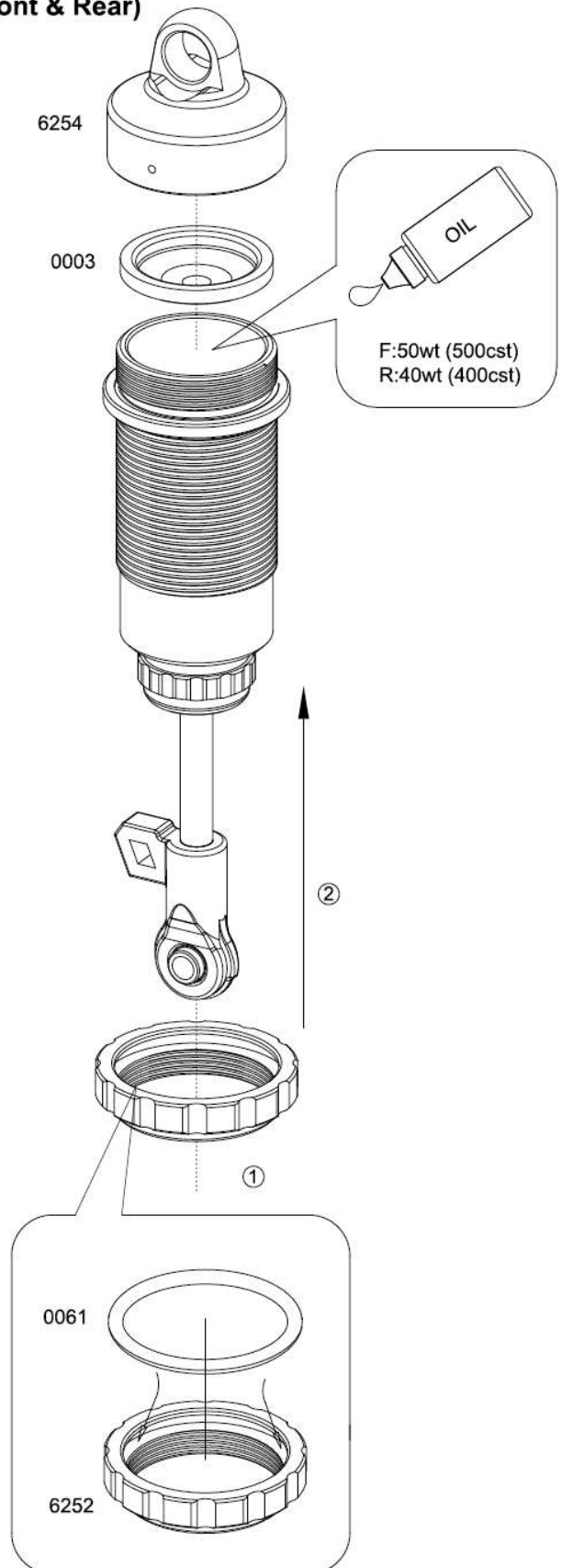

STEP B - 2

Shock Assembly (Front & Rear)

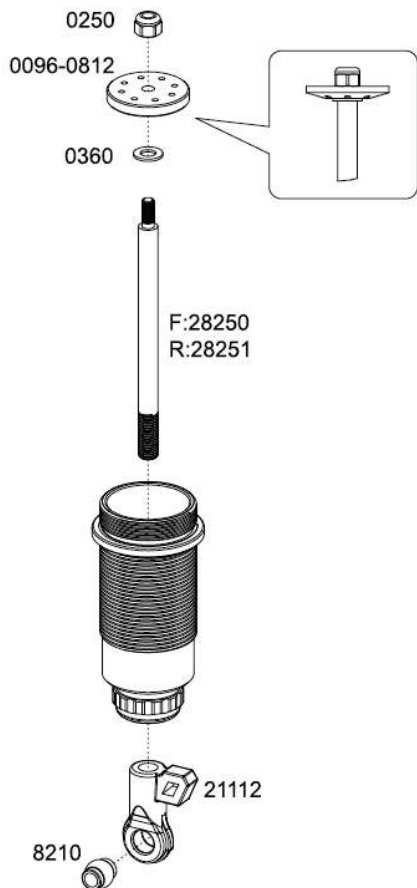

STEP B - 4

Shock Assembly (Front & Rear)

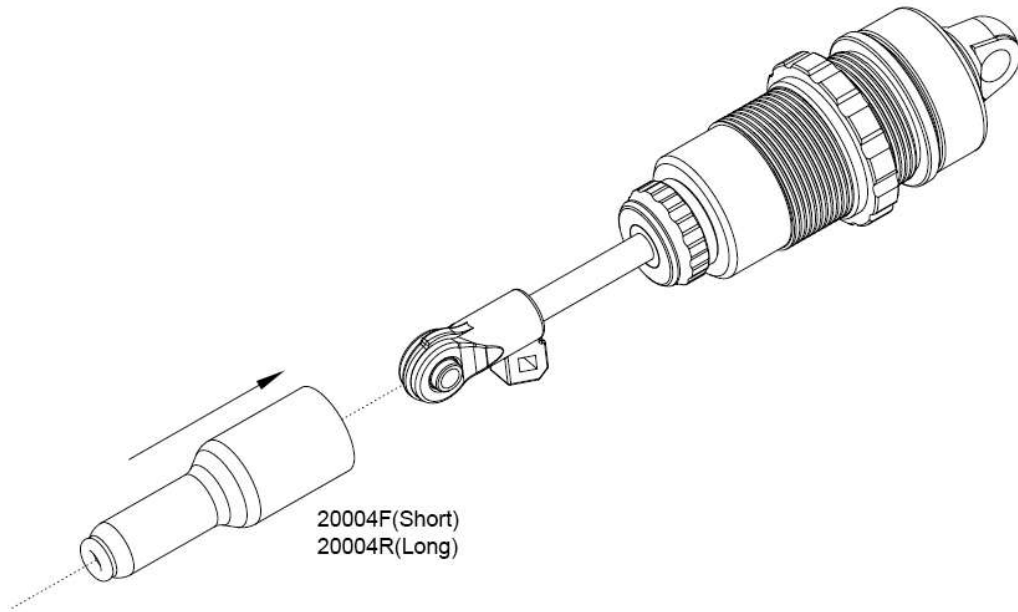

STEP B - 5

Shock Assembly (Front & Rear)

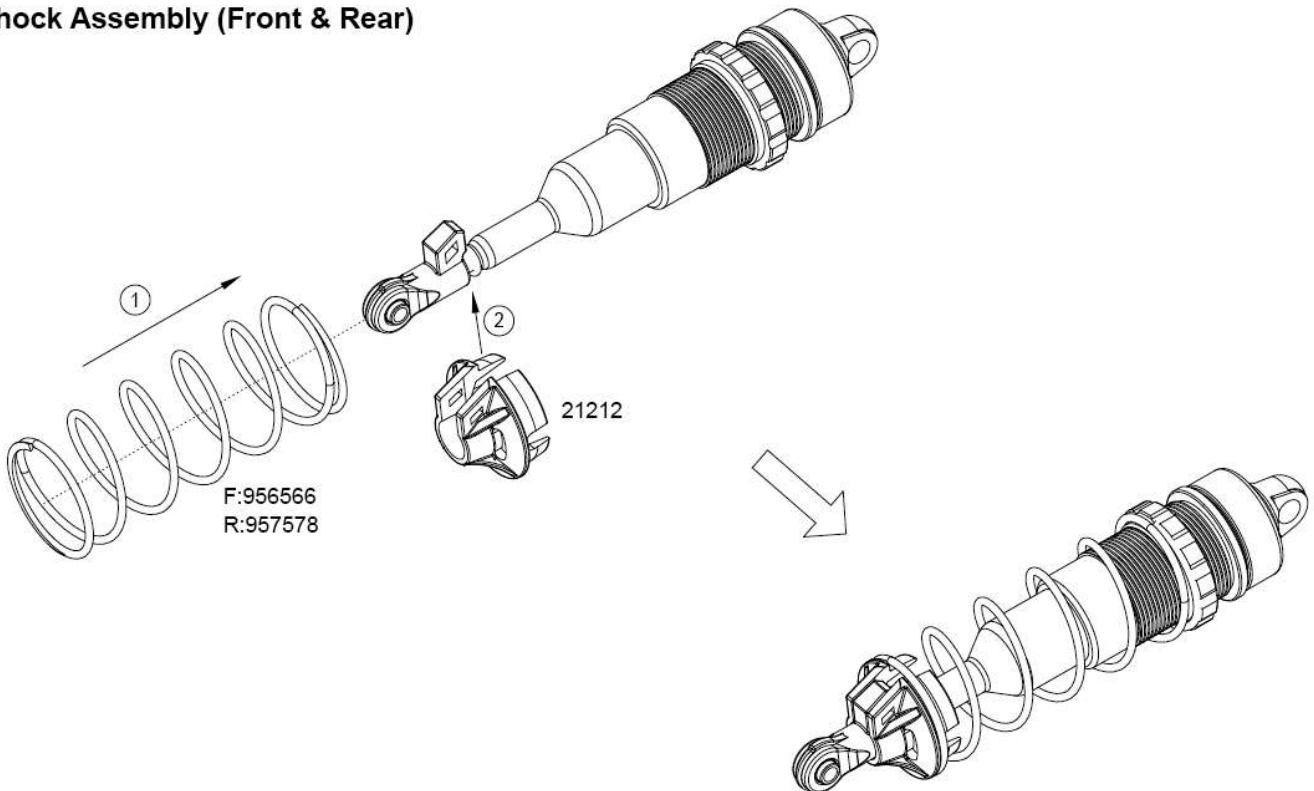

STEP C-1

Front Spindle & CVD Assembly (Left/Right)

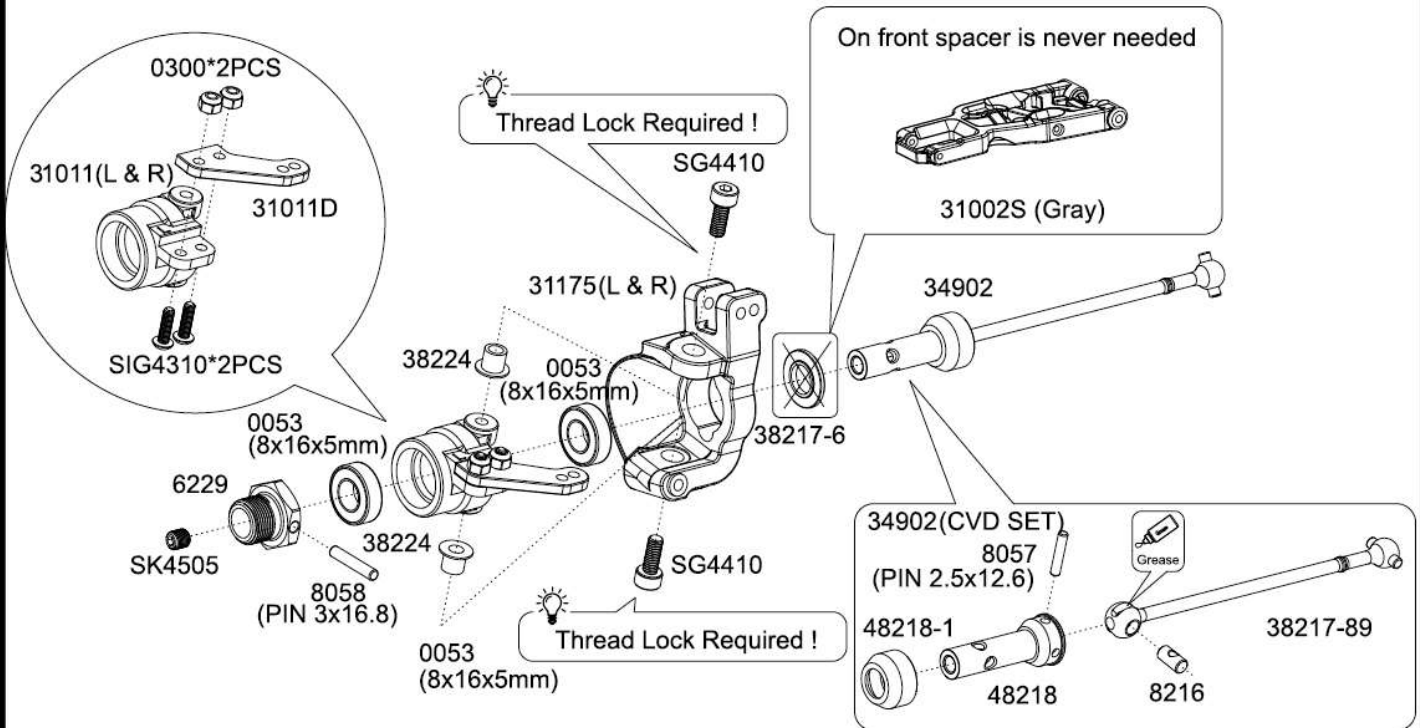

STEP C-2

Front Spindle/Carrier & Suspension Arms Assembly (Left/Right)

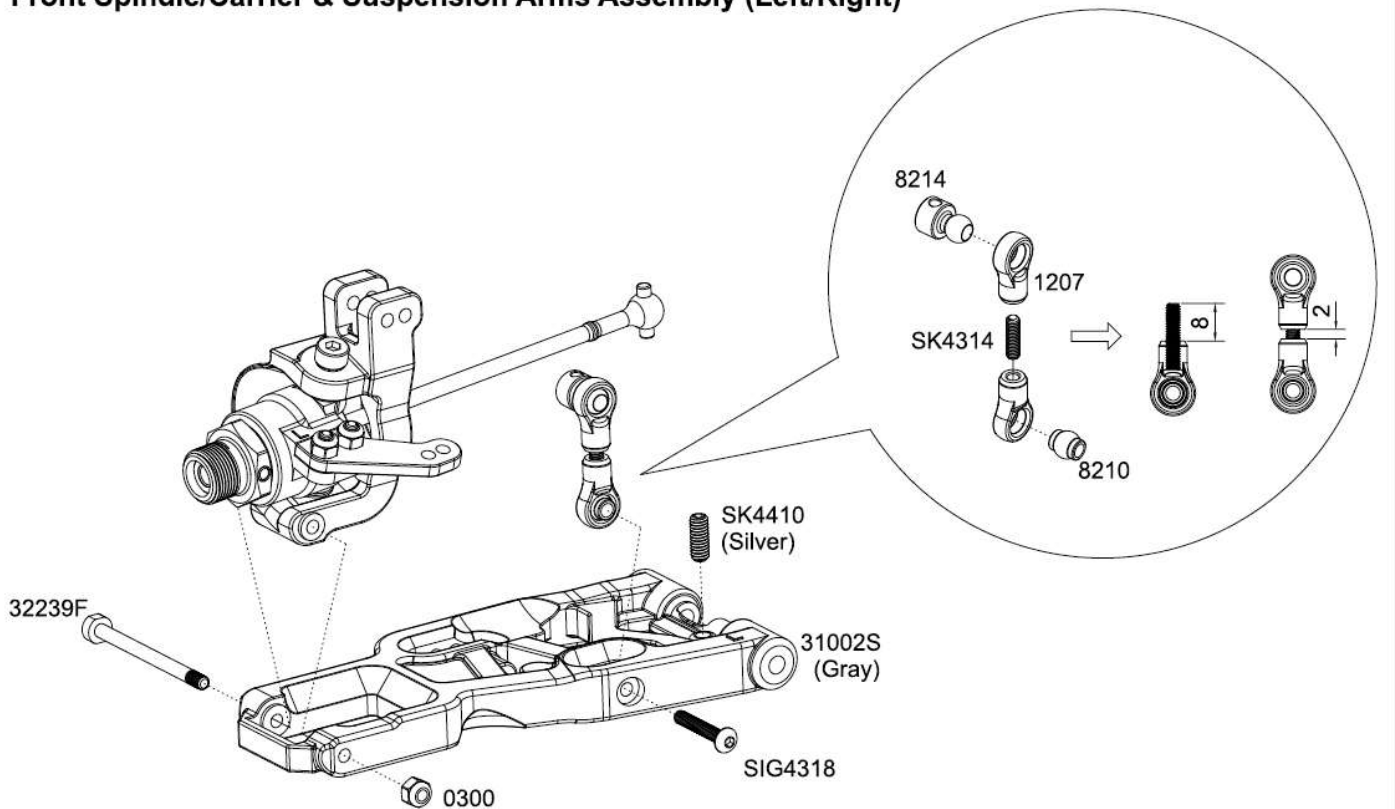

STEP D - 1

Front Diff Case Assembly

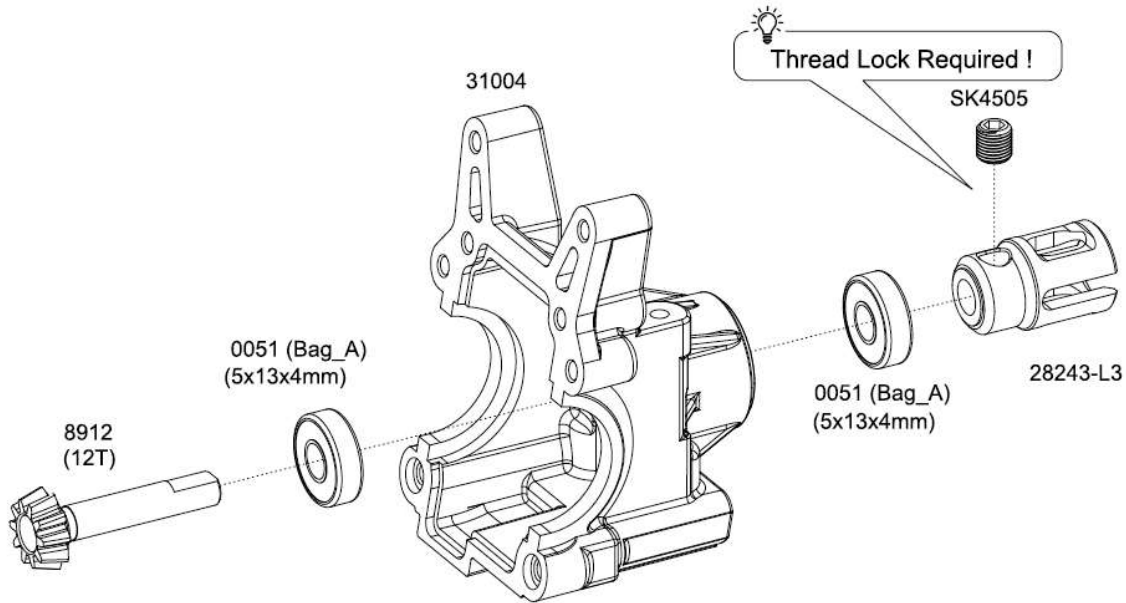

STEP D - 2

Front Diff Installation

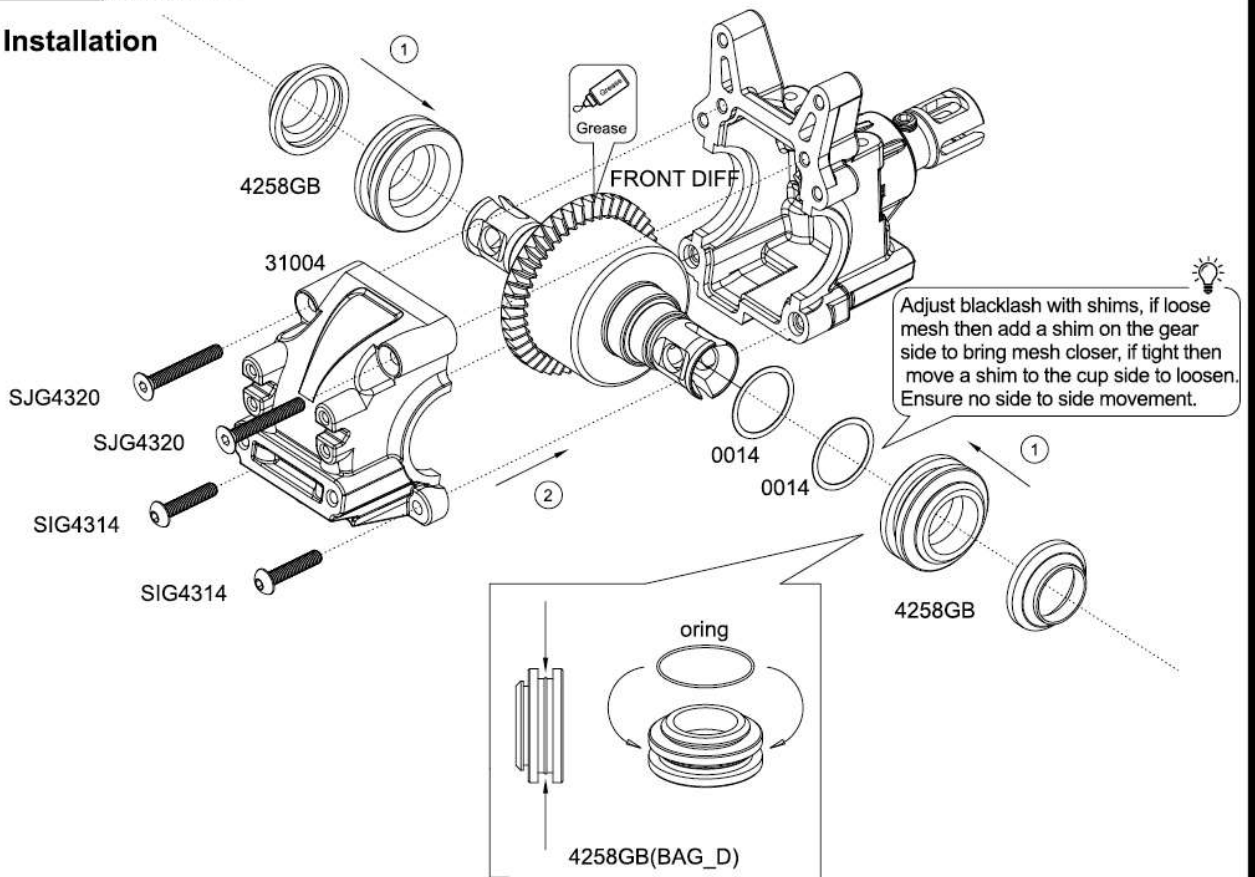

STEP D - 3

Front Suspension Arm Assembly

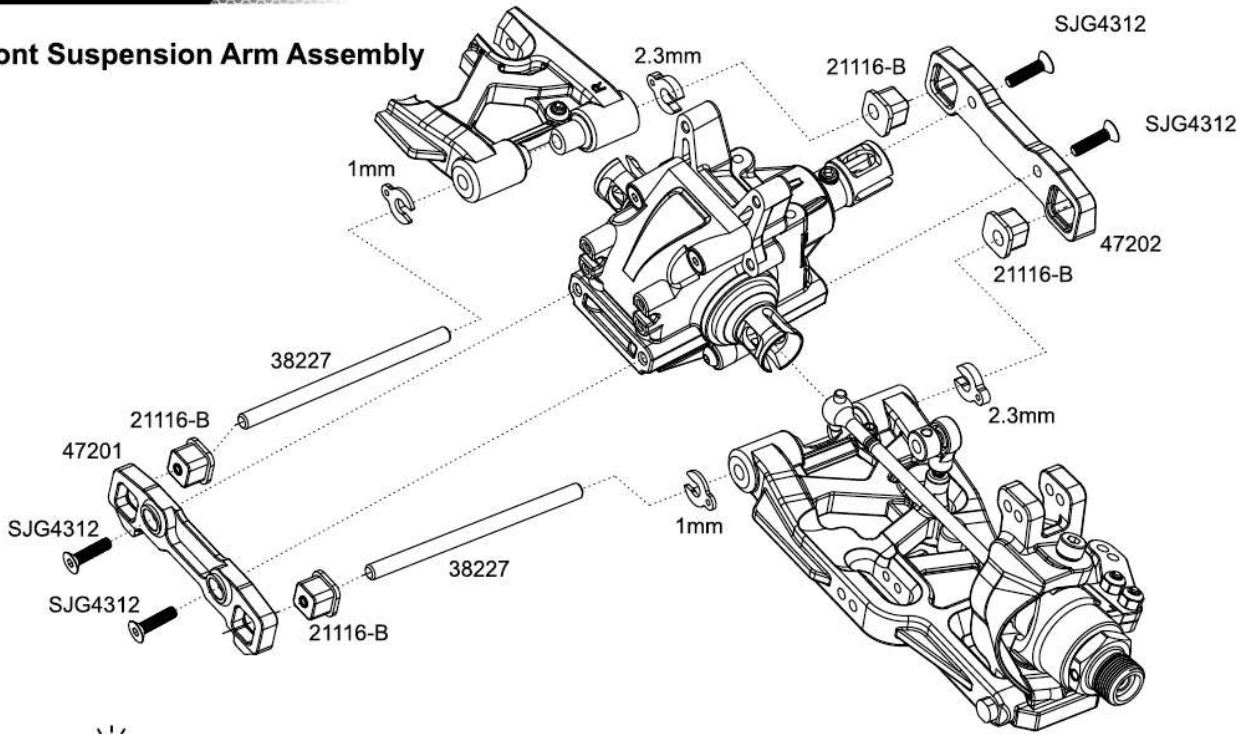

Please as per setup sheet

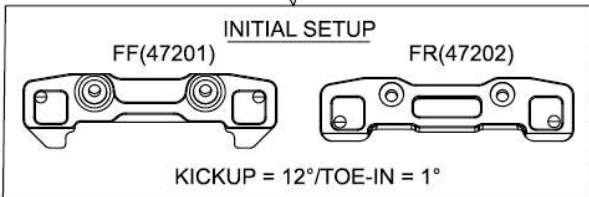

SUSPENSION BUSHINGS CHART

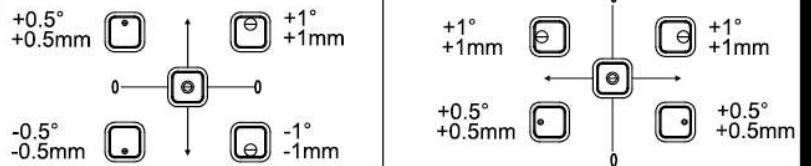

STEP D - 4

Front Swaybar Assembly

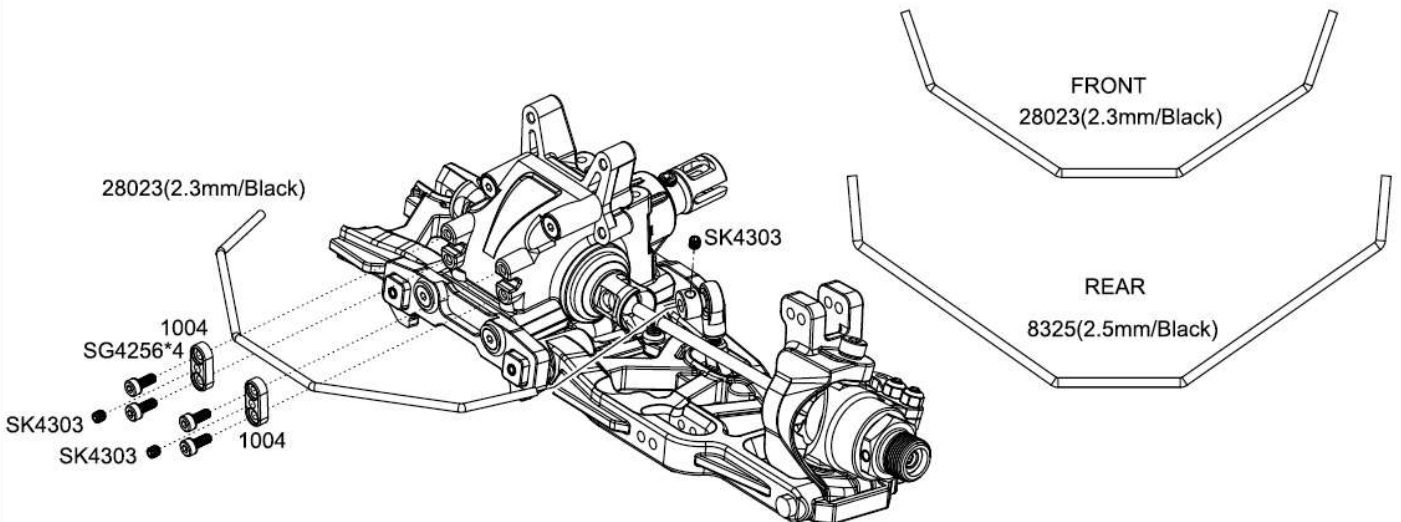

STEP D - 5

Front Shock Tower Assembly

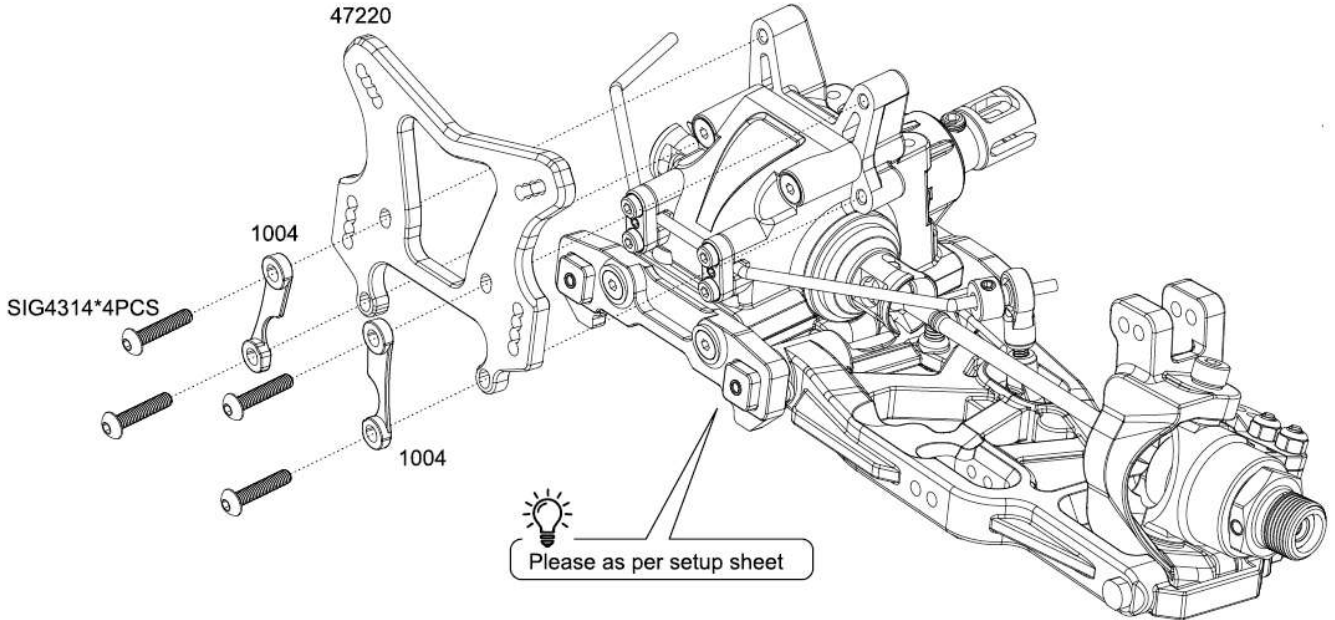

STEP D - 6

Front Camber Link Assembly

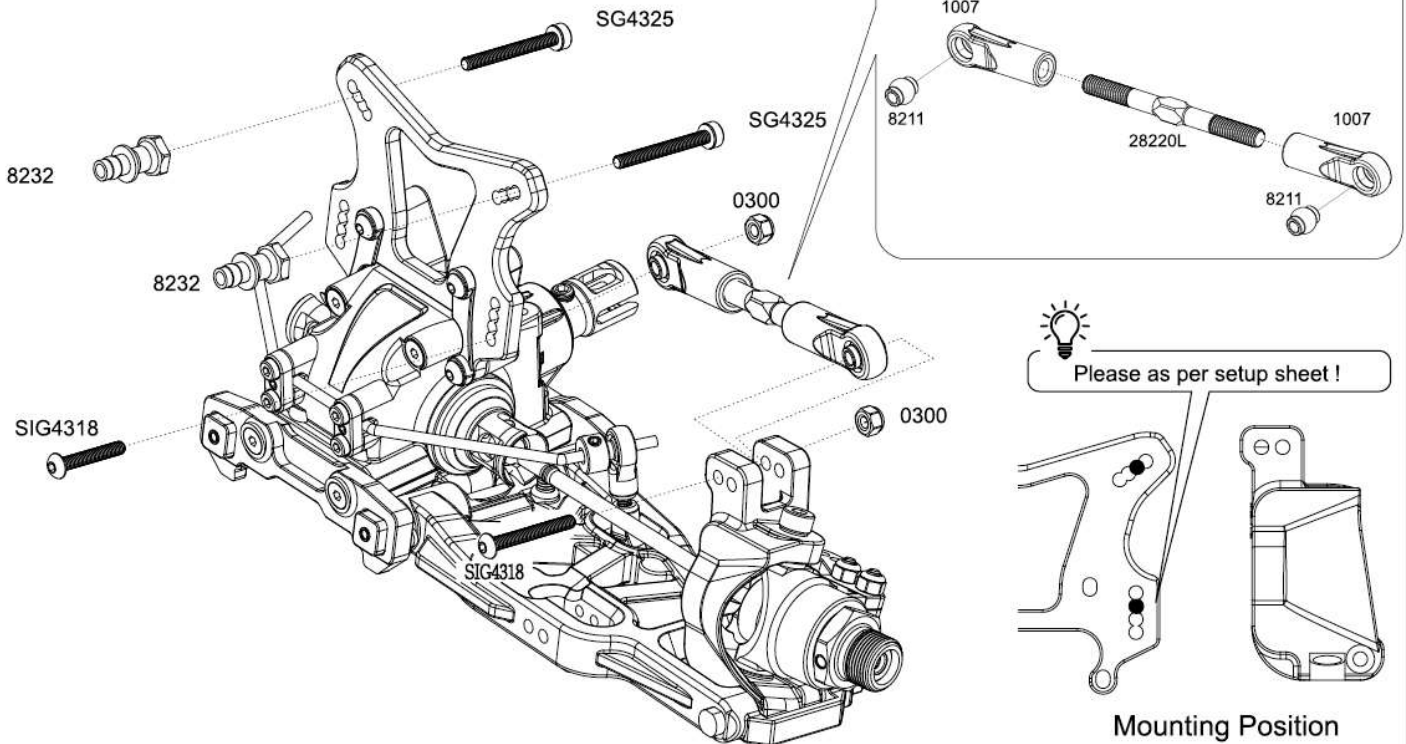

STEP D-7

Front Steering Link Assembly

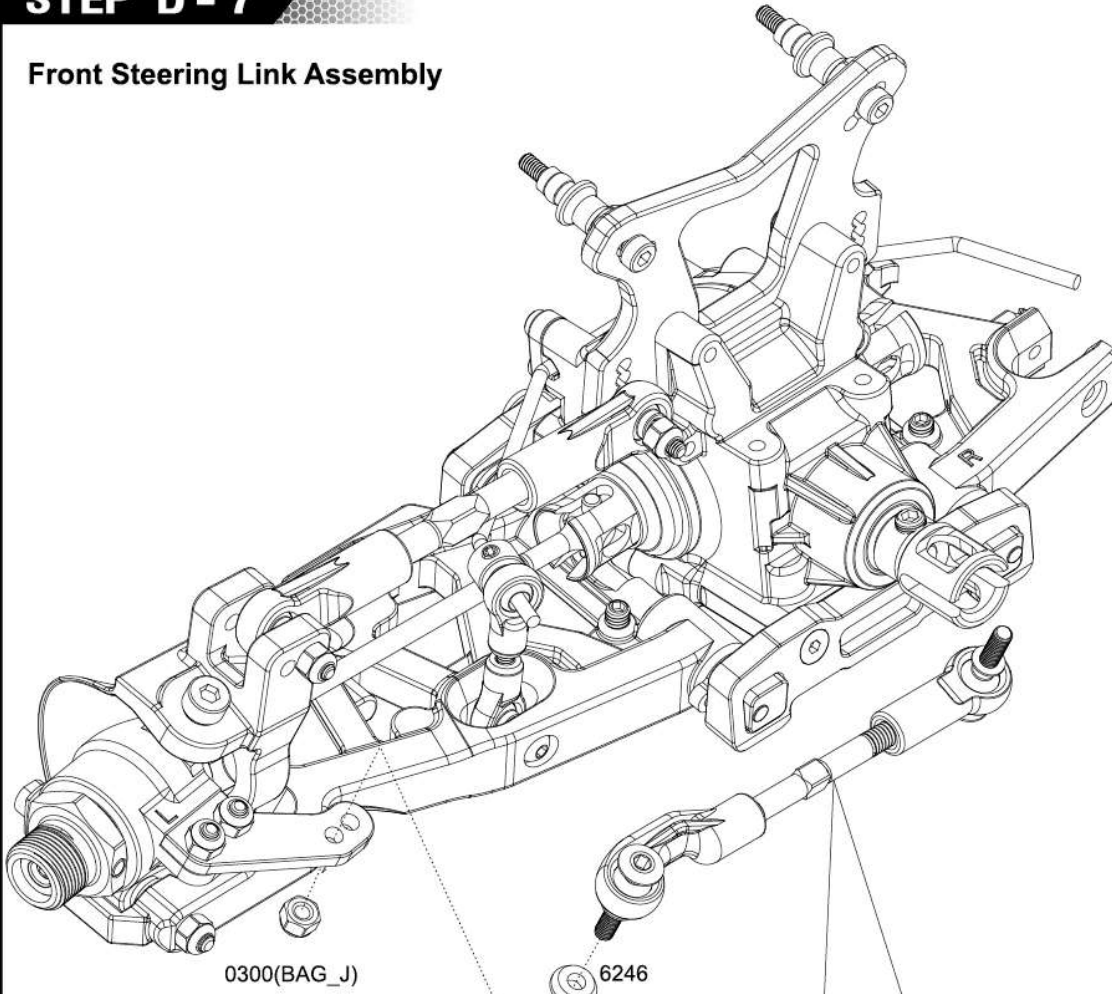

0300(BAG_J)

6246

6246

2212

1307

38222

1307

2212

28.3mm

groove

Right Hand Thread

Left Hand Thread

STEP E - 1

Rear Hub & CVD Assembly (Left/Right)

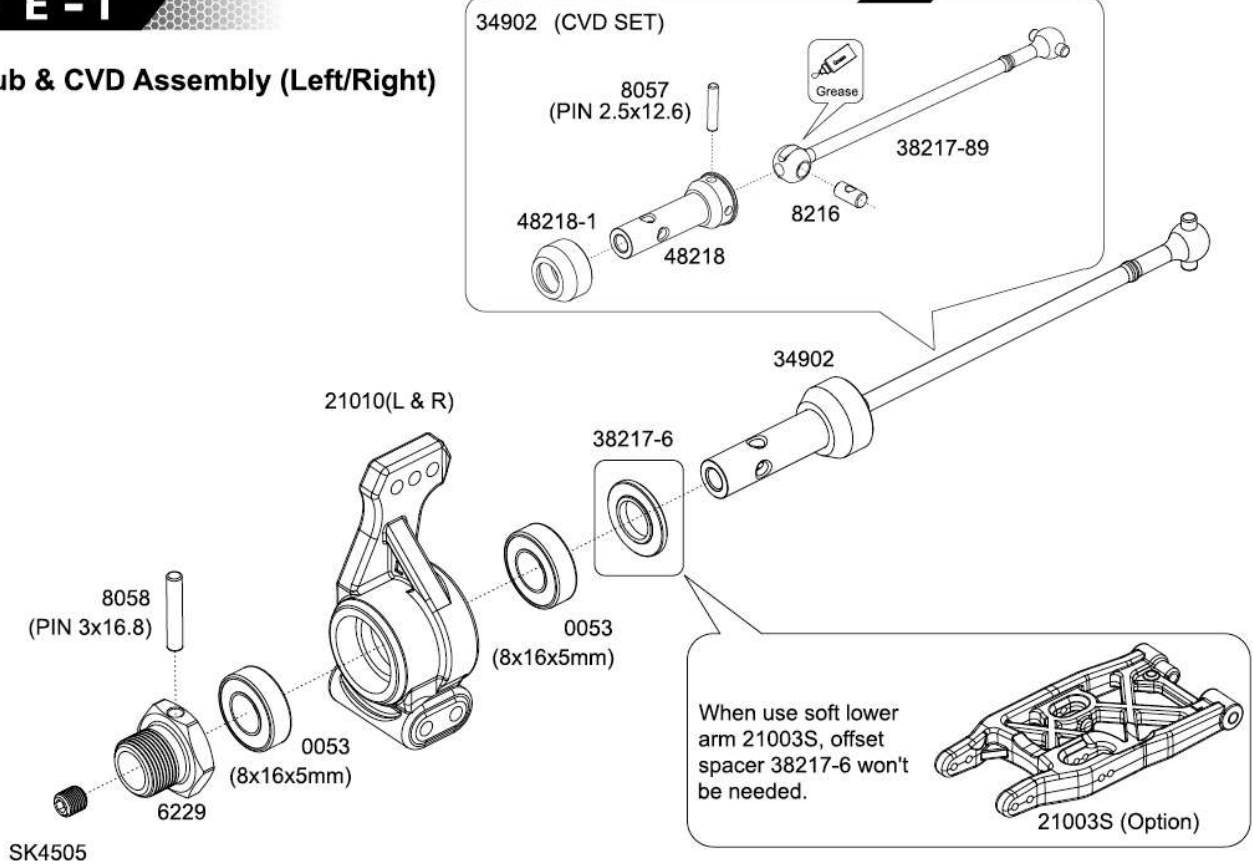

STEP E - 2

Rear Hub & CVD Assembly (Left/Right)

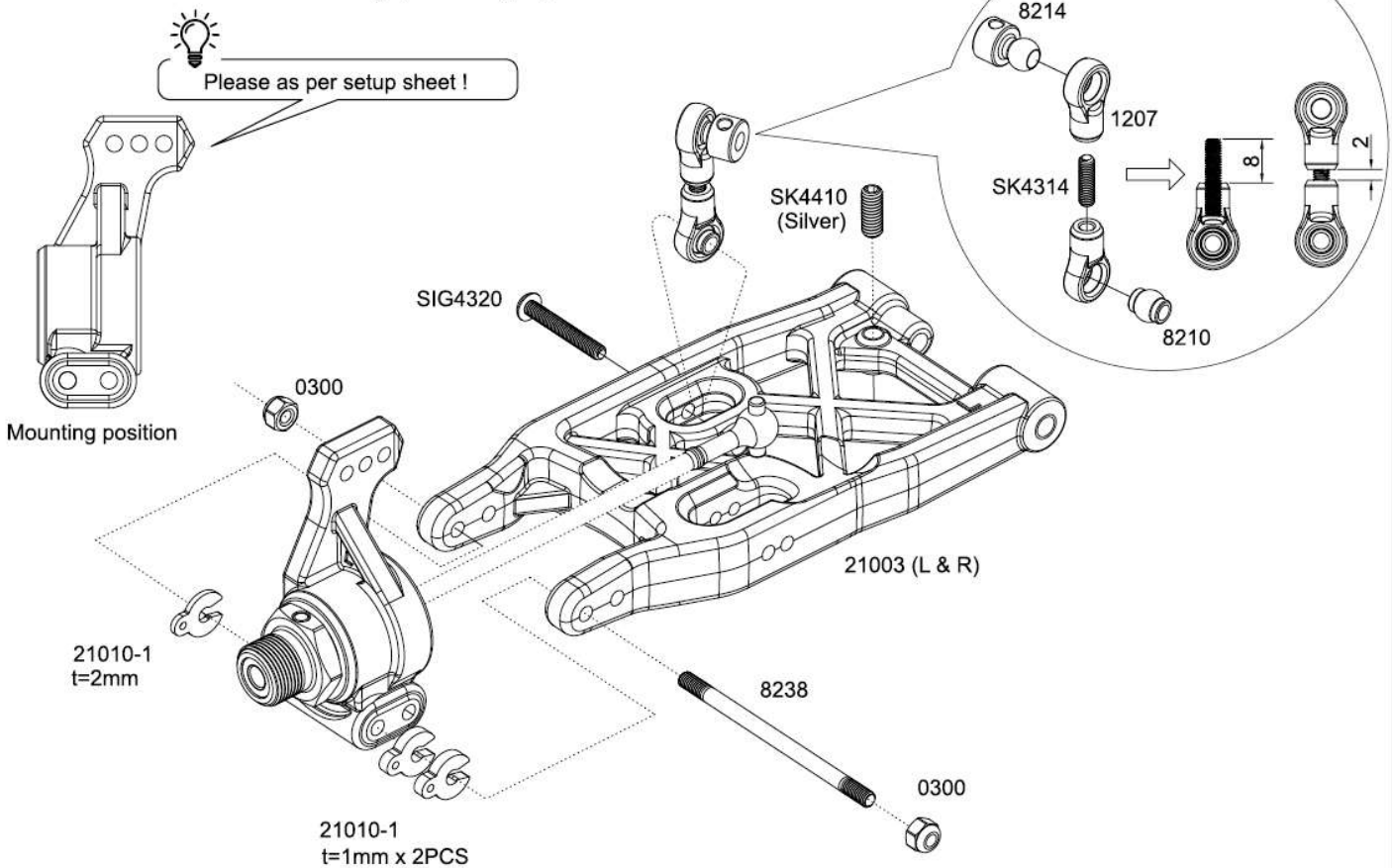

STEP F - 1

Rear Diff Case Assembly

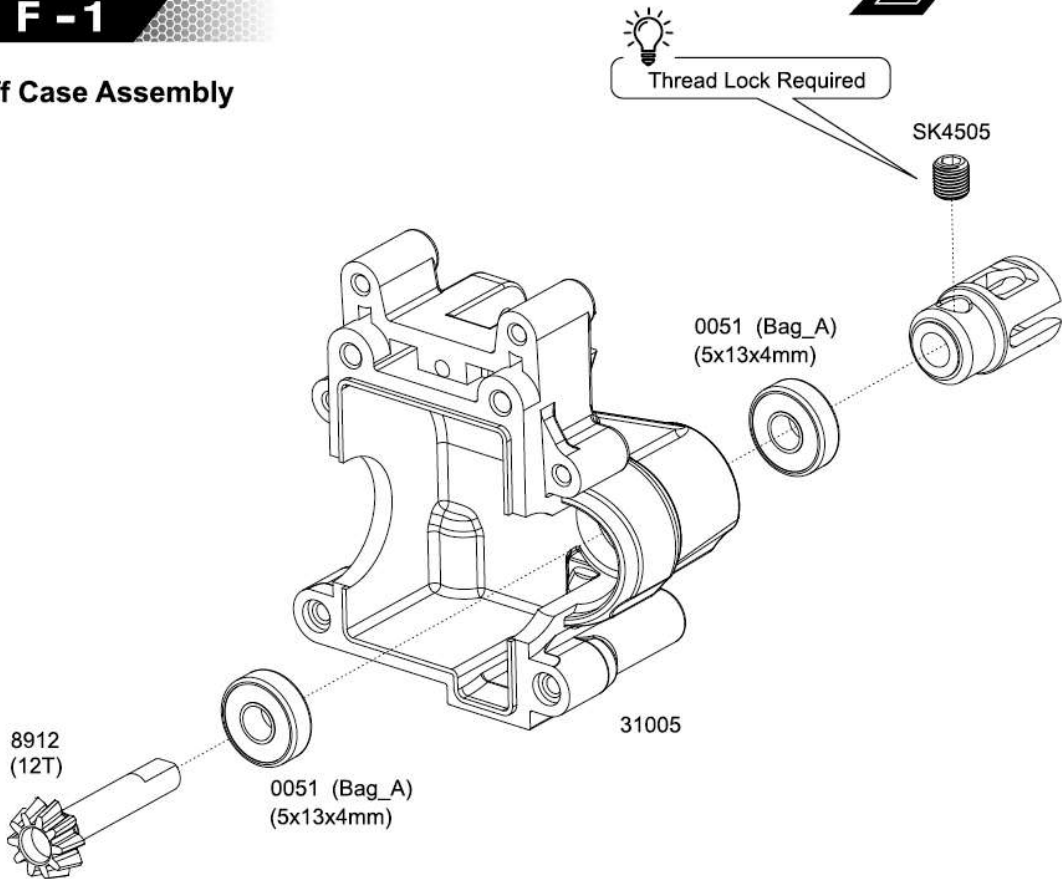

STEP F - 2

Rear Diff Install

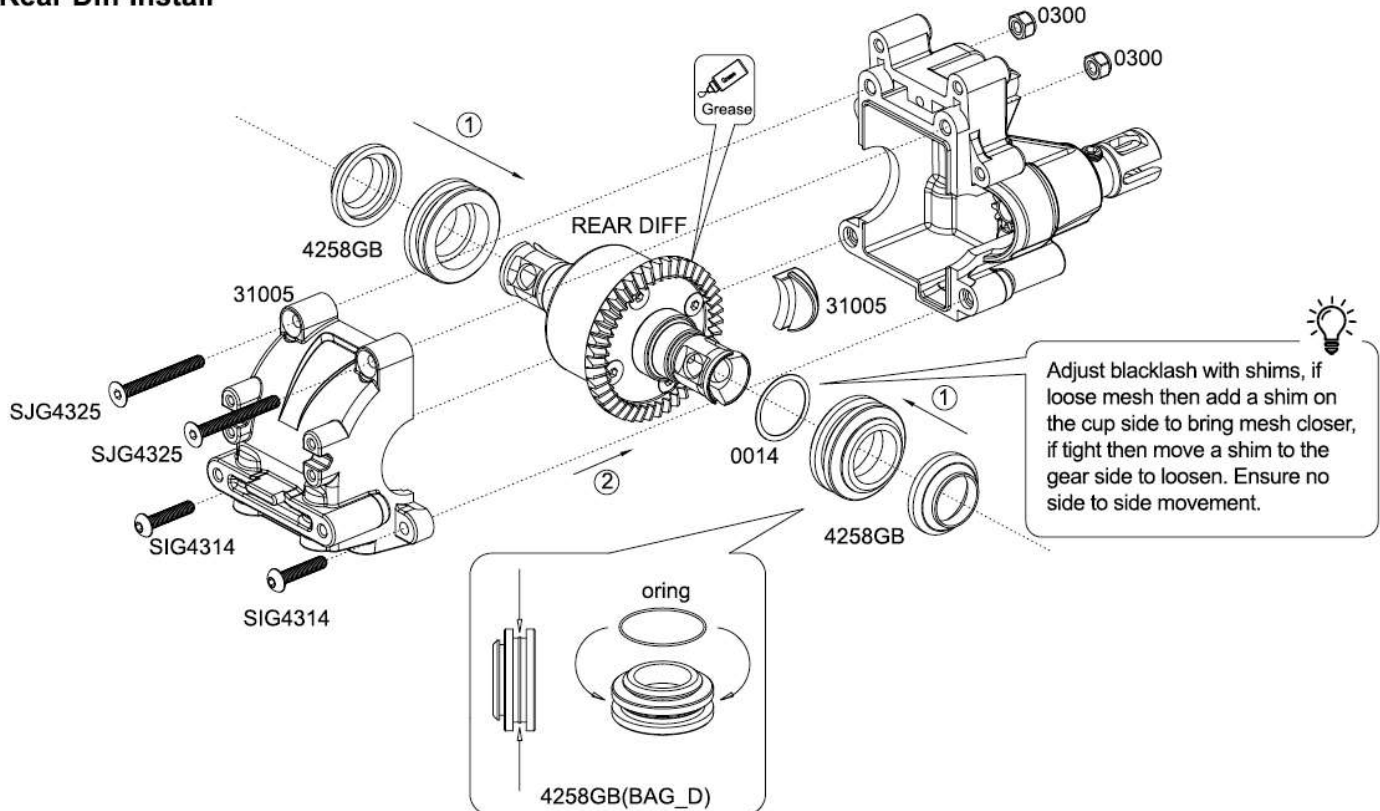

STEP F - 3

Rear Hubs & Suspension Arm Assembly (Left/Right)

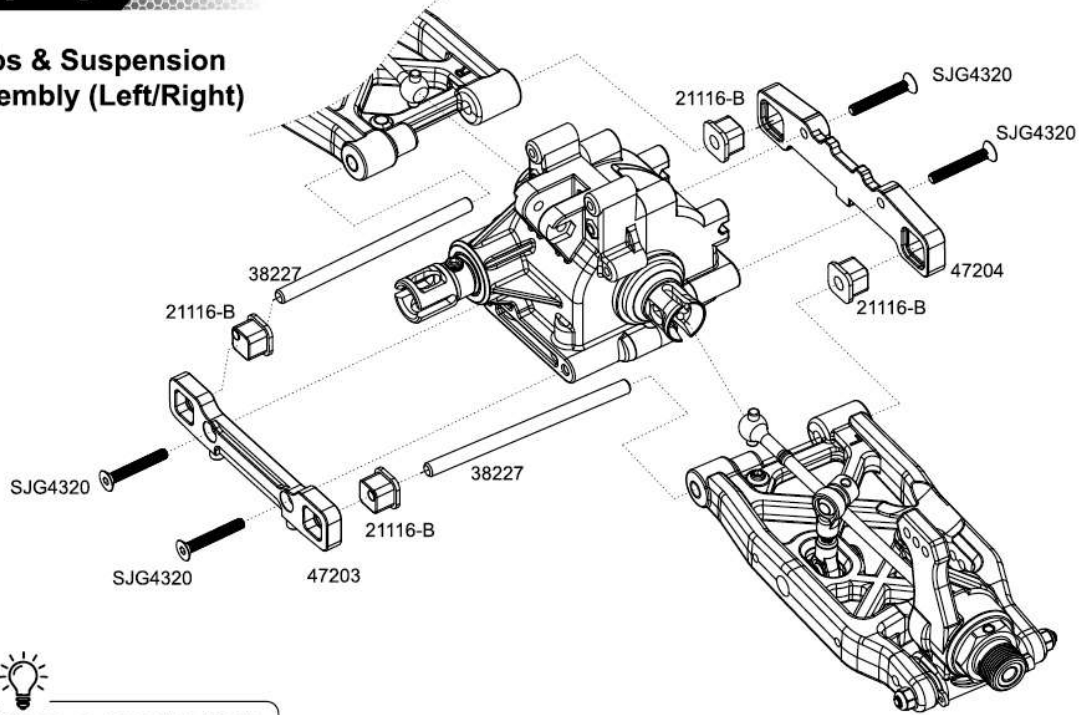

Please as per setup sheet

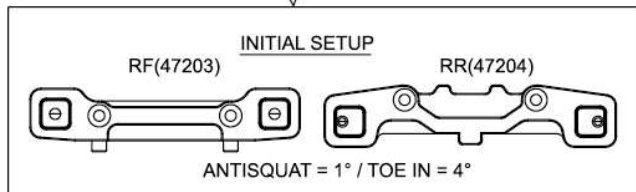

SUSPENSION BUSHINGS CHART

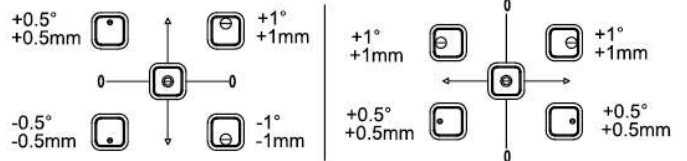

STEP F - 4

Rear Swaybar Assembly

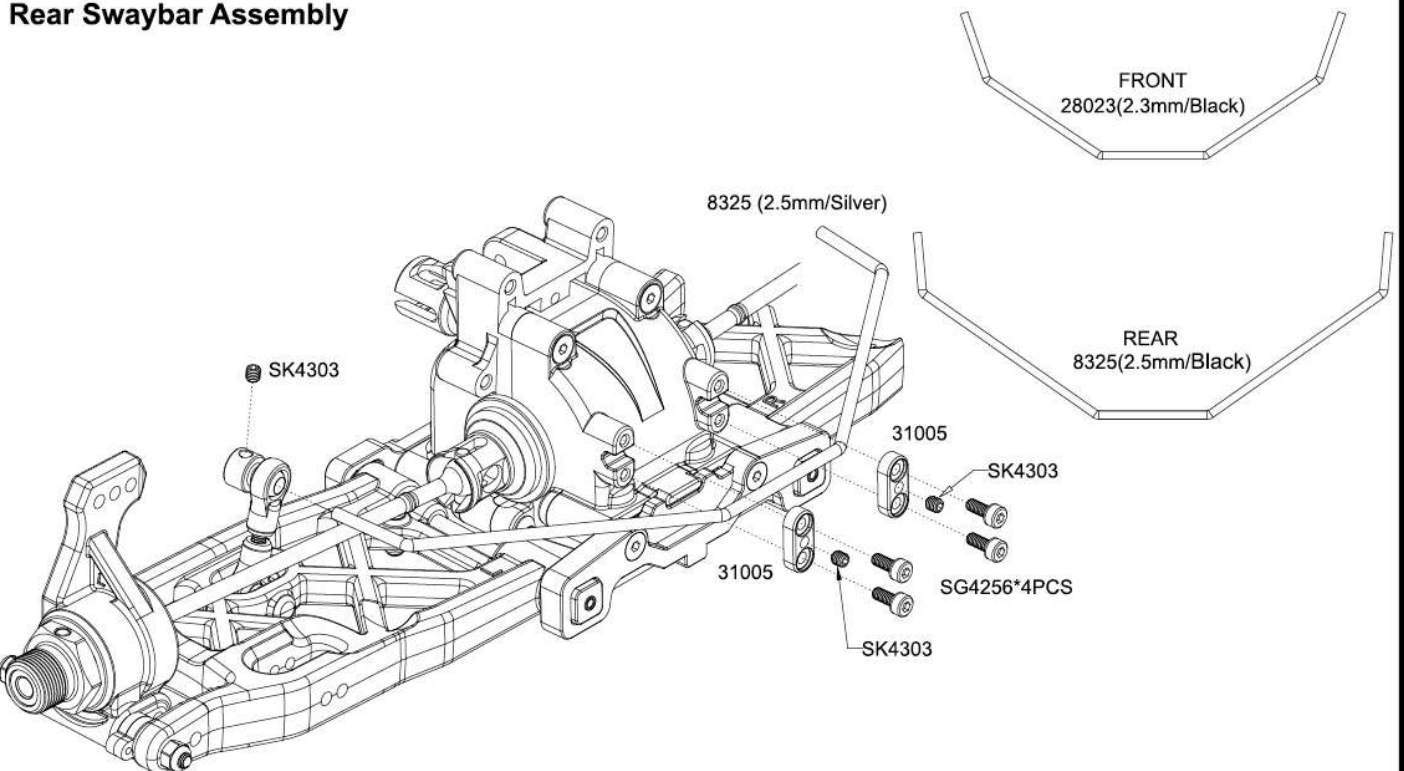

STEP F - 5

Wing Mount Assembly

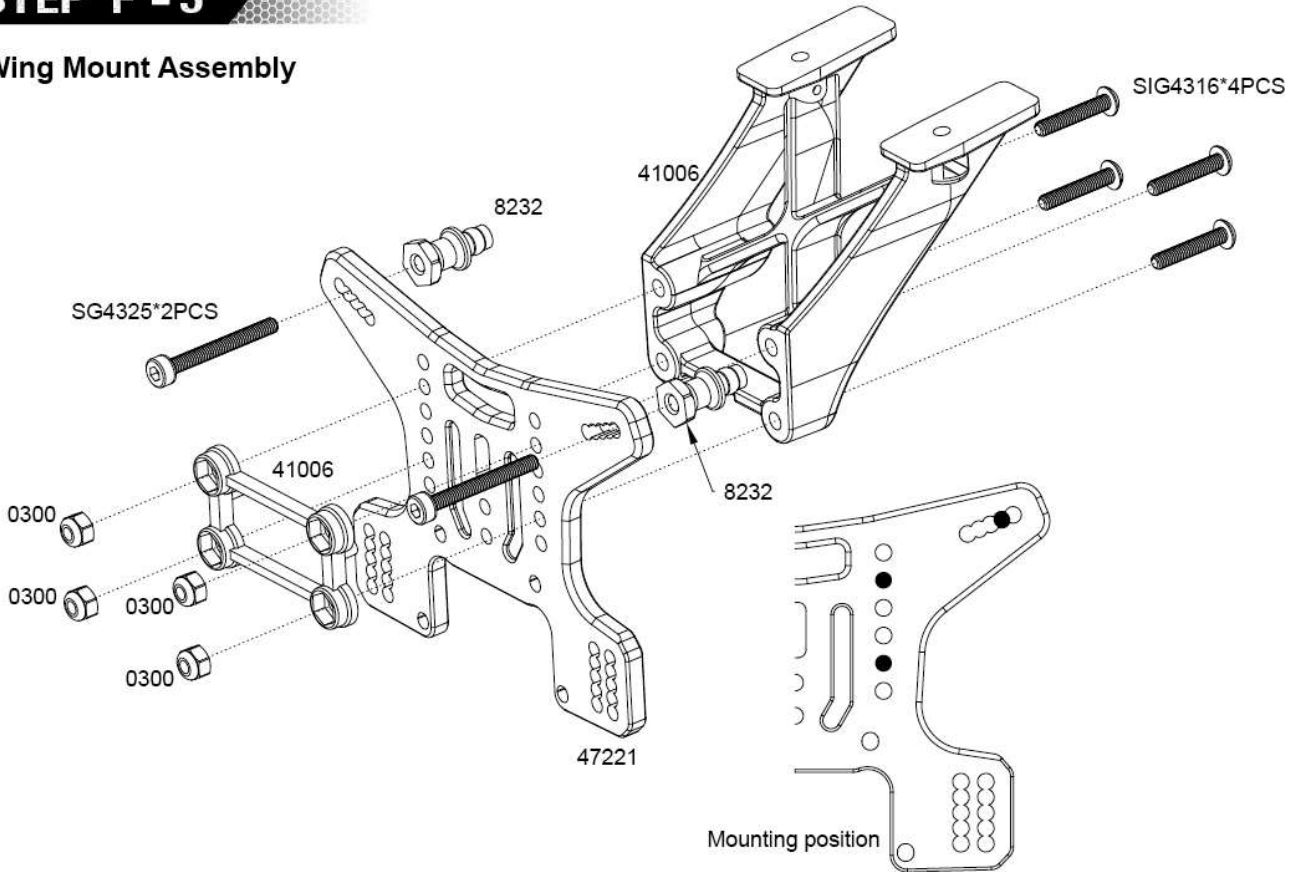

STEP F - 6

Rear Shock Tower Installation

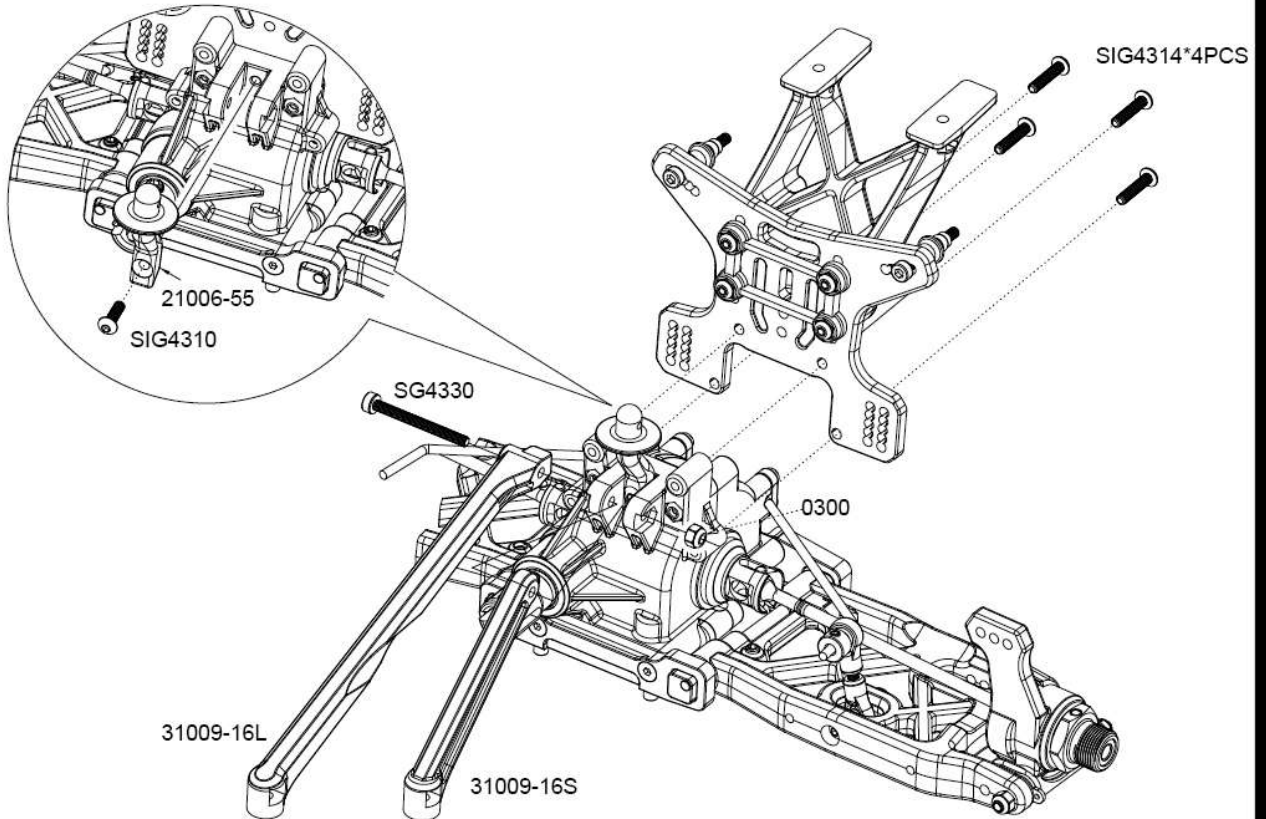

STEP F - 7

Rear Camber Link Assembly (Left/Right)

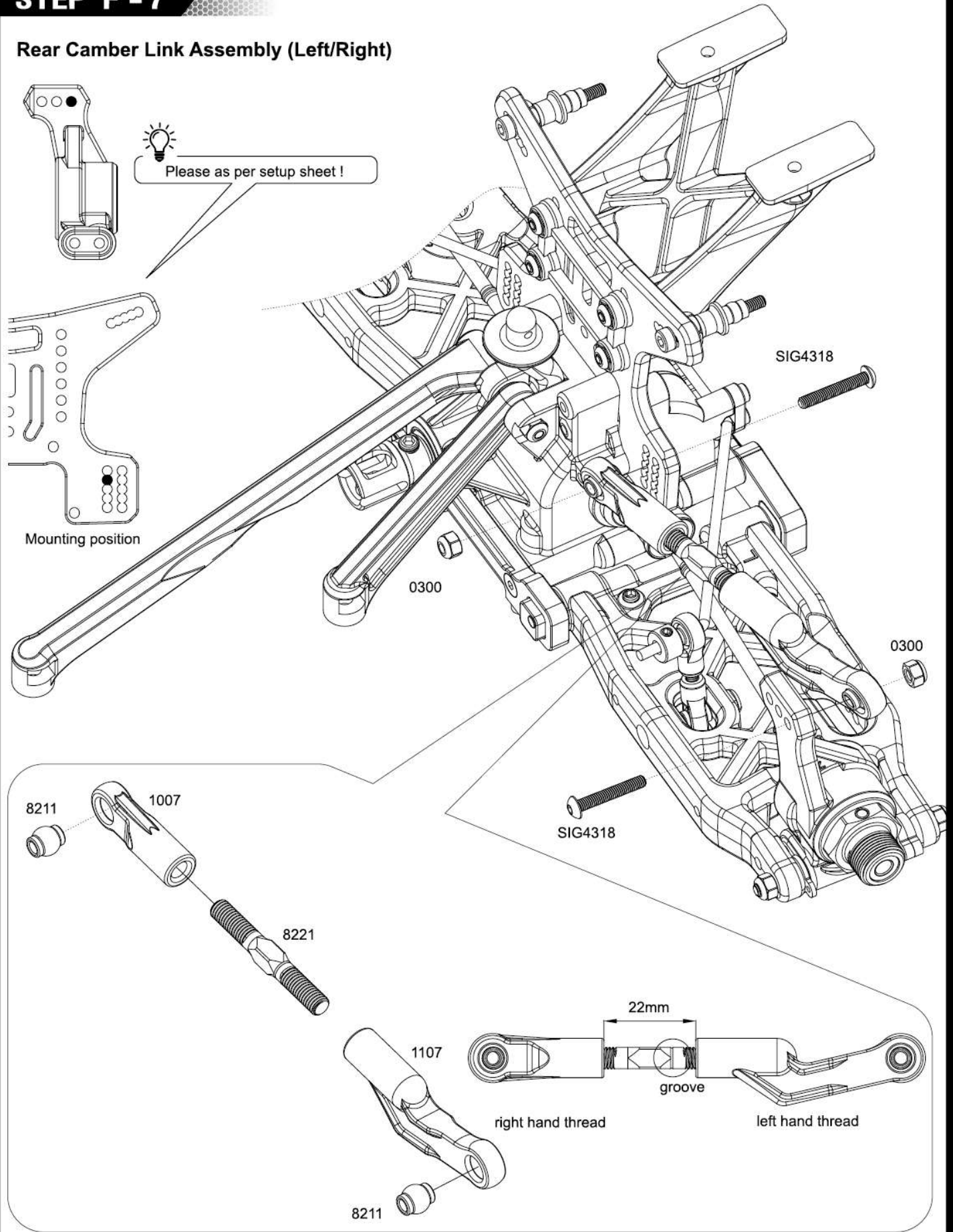

STEP G-1

Center Diff Mount & Front Brake Assembly

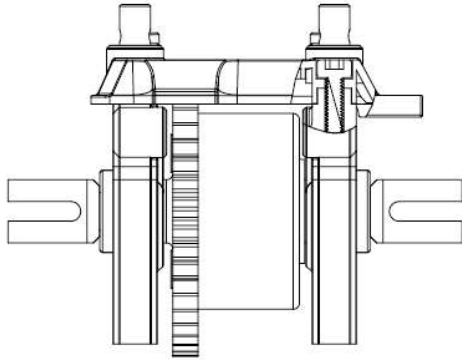

Please tighten the screws until they are flush with the top plastic plate, do not overtighten. Ensure free movement of brake cams.

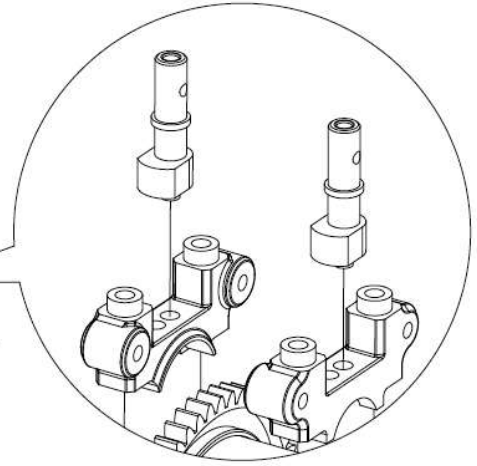
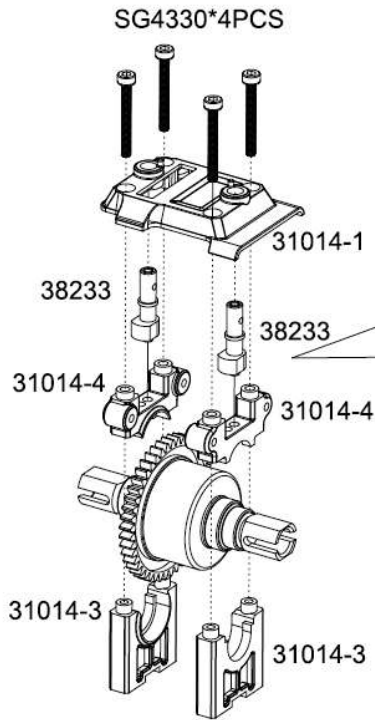

STEP G-2

Center Diff Mount & Brake Assembly

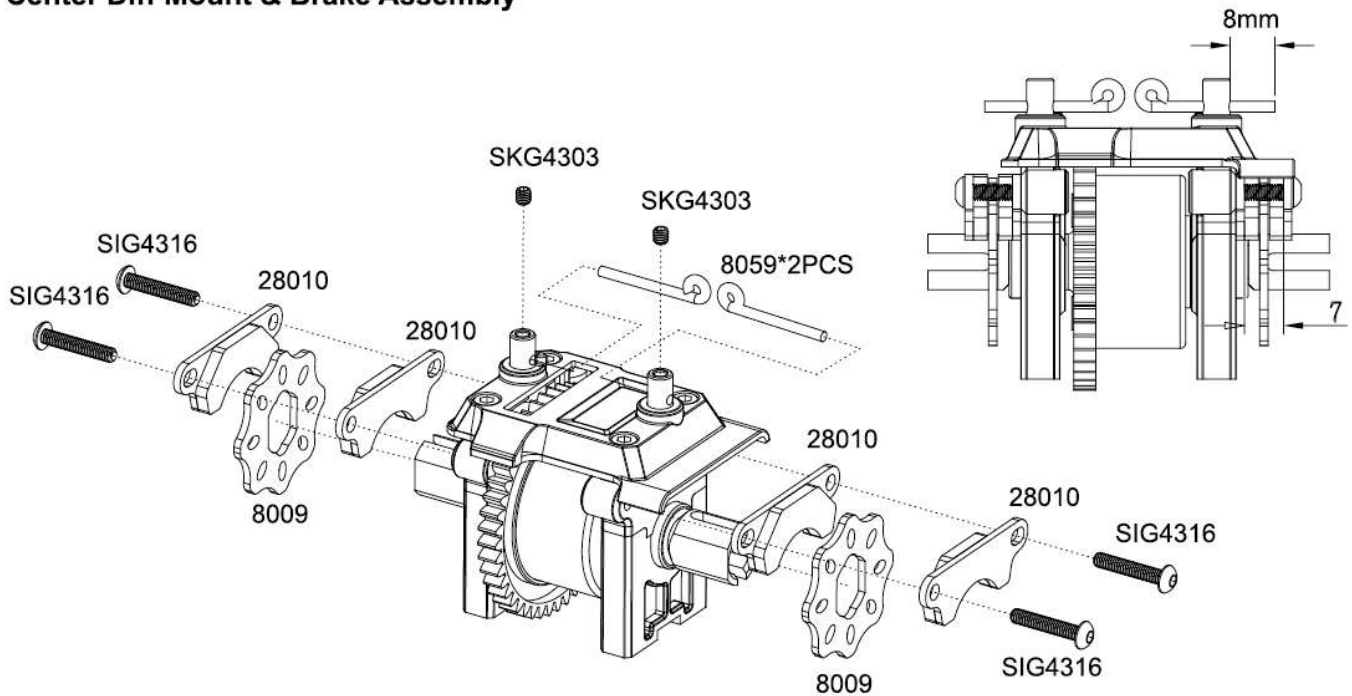

STEP H-1

Receiver/Antenna/Switch Assembly

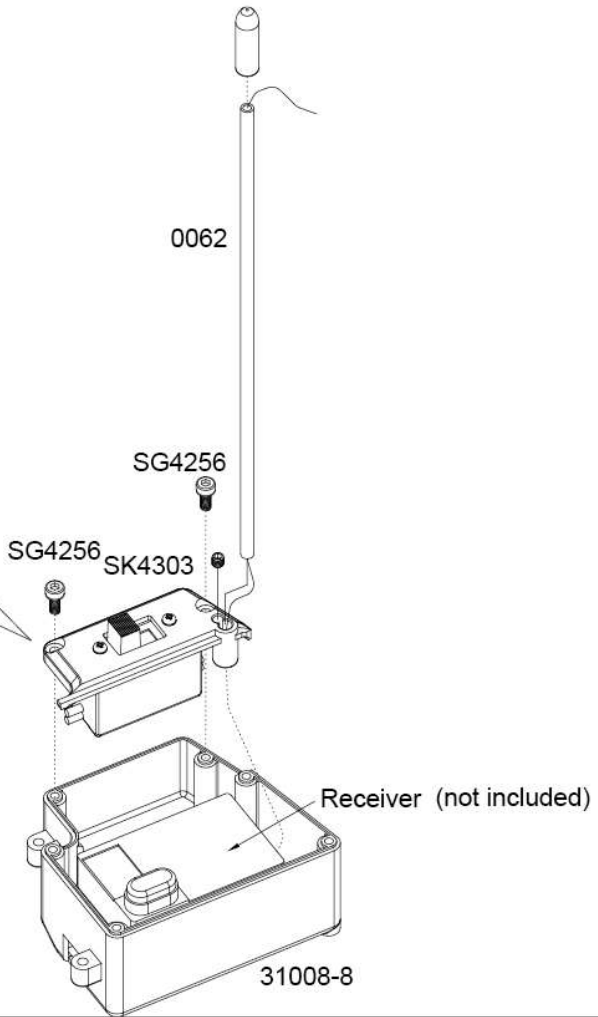
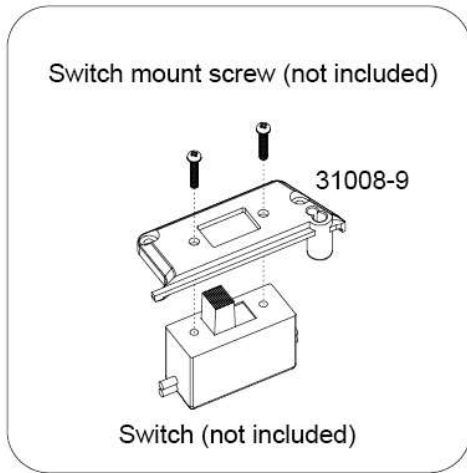

STEP H-2

Servo/Transponder Mount Assembly

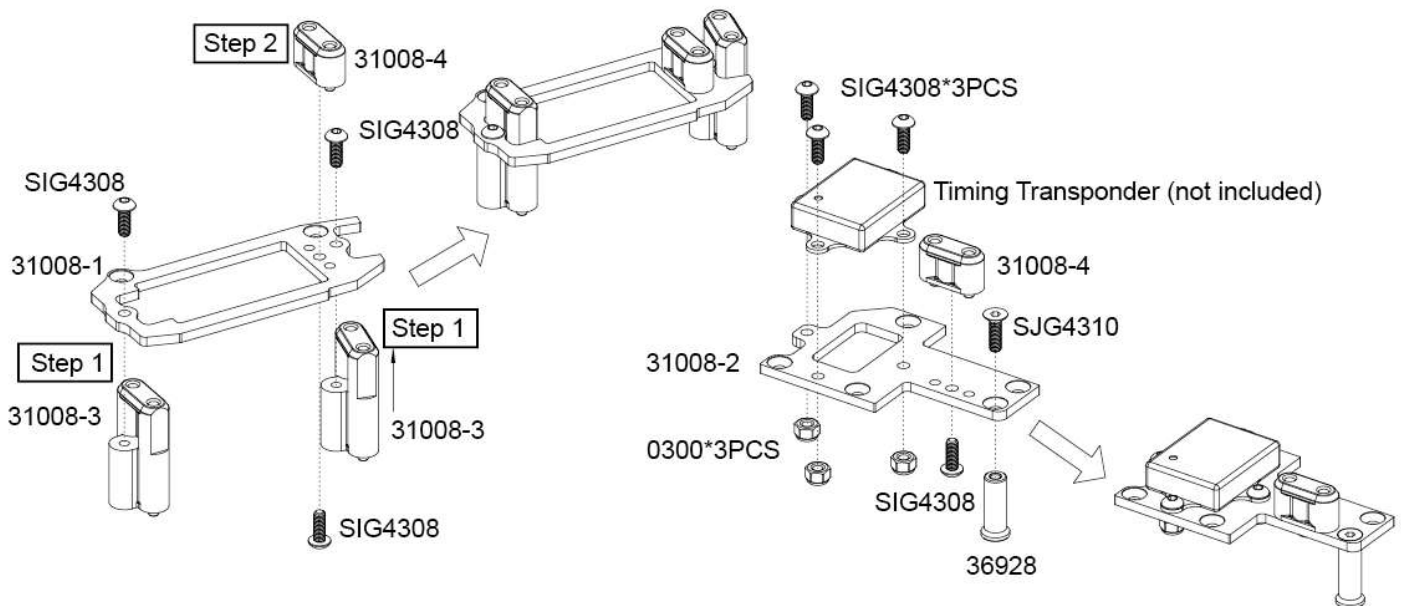

STEP H - 3

Radio Case Assembly

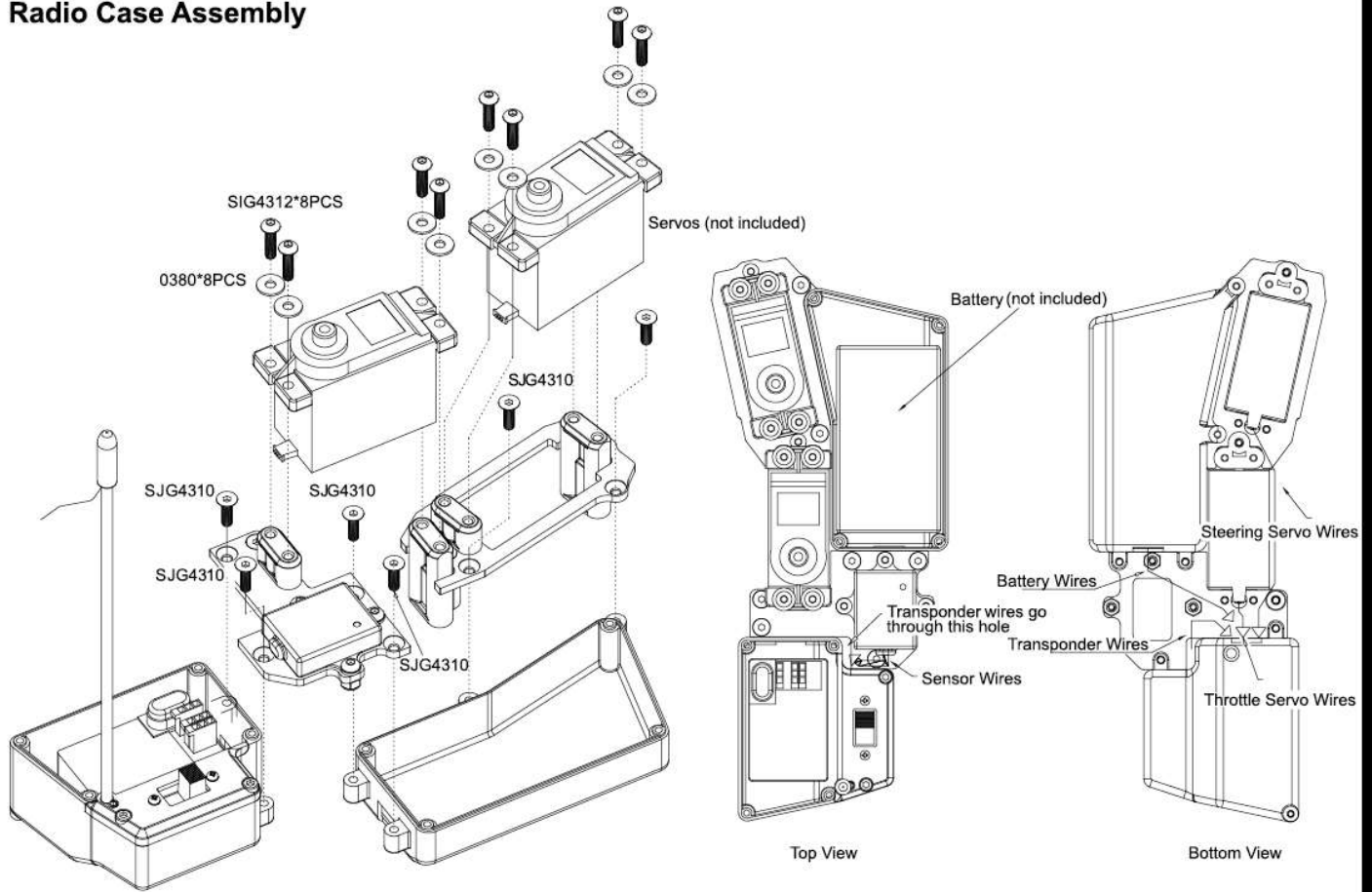

Switch & Servo Assembly (Cable Routing)

STEP H - 4

Radio Case Assembly

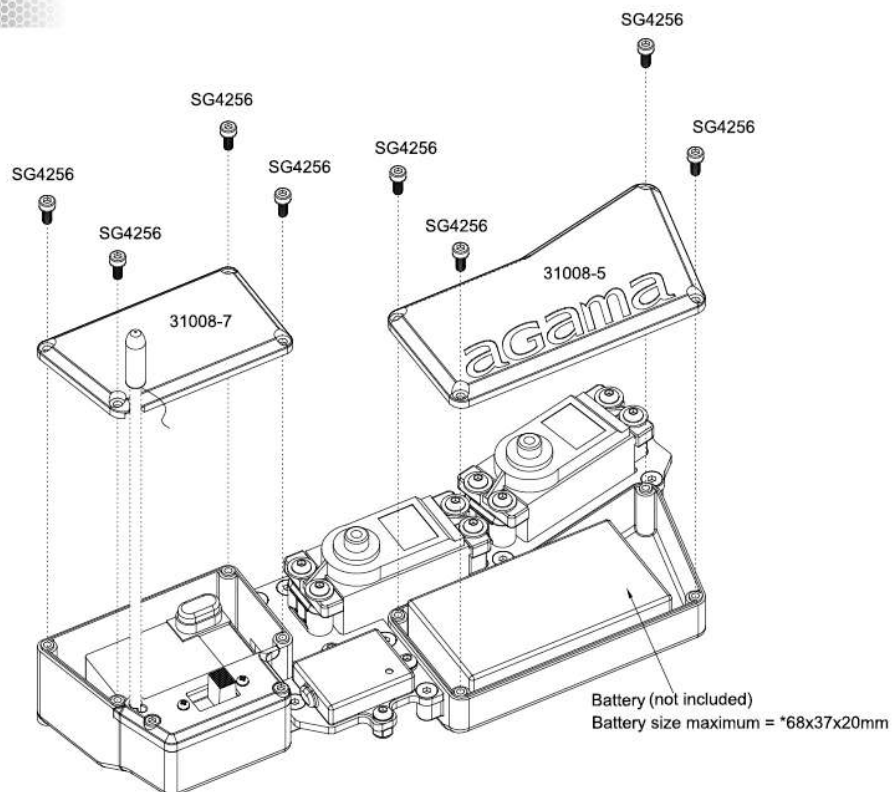

STEP I - 1

Flywheel Assembly

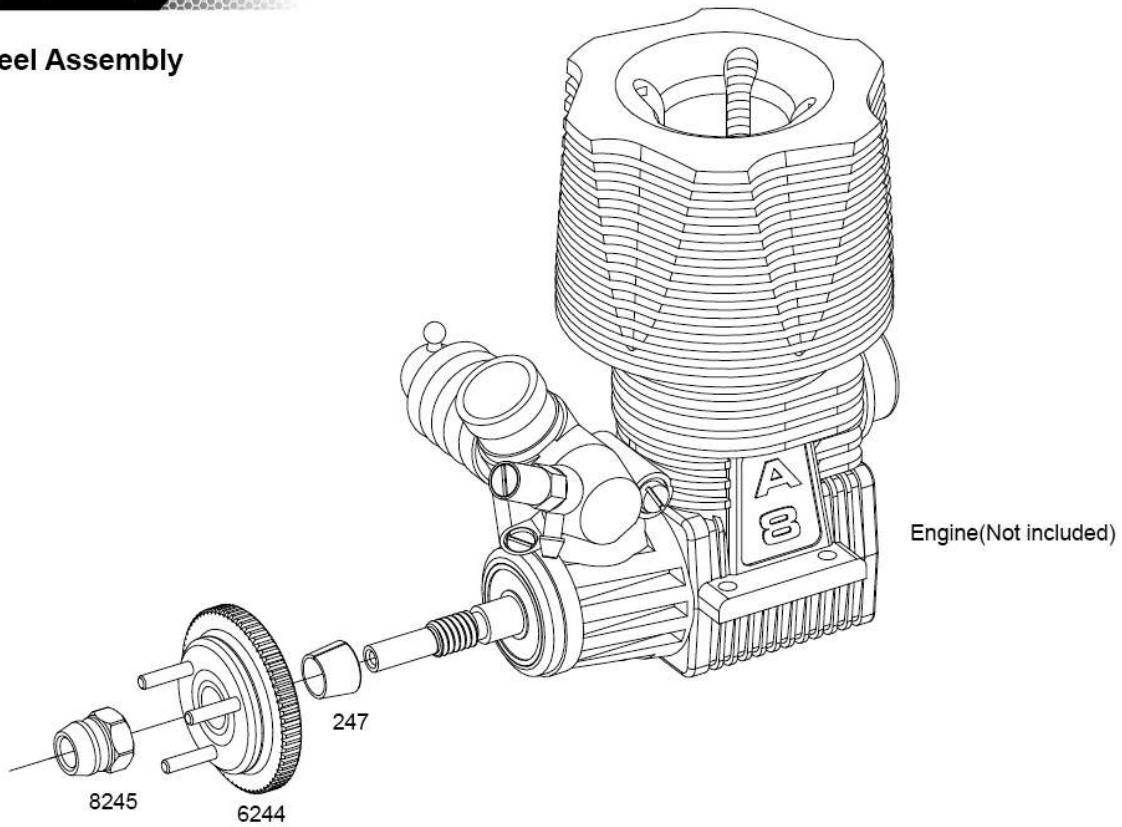

STEP I - 2

Clutch Assembly

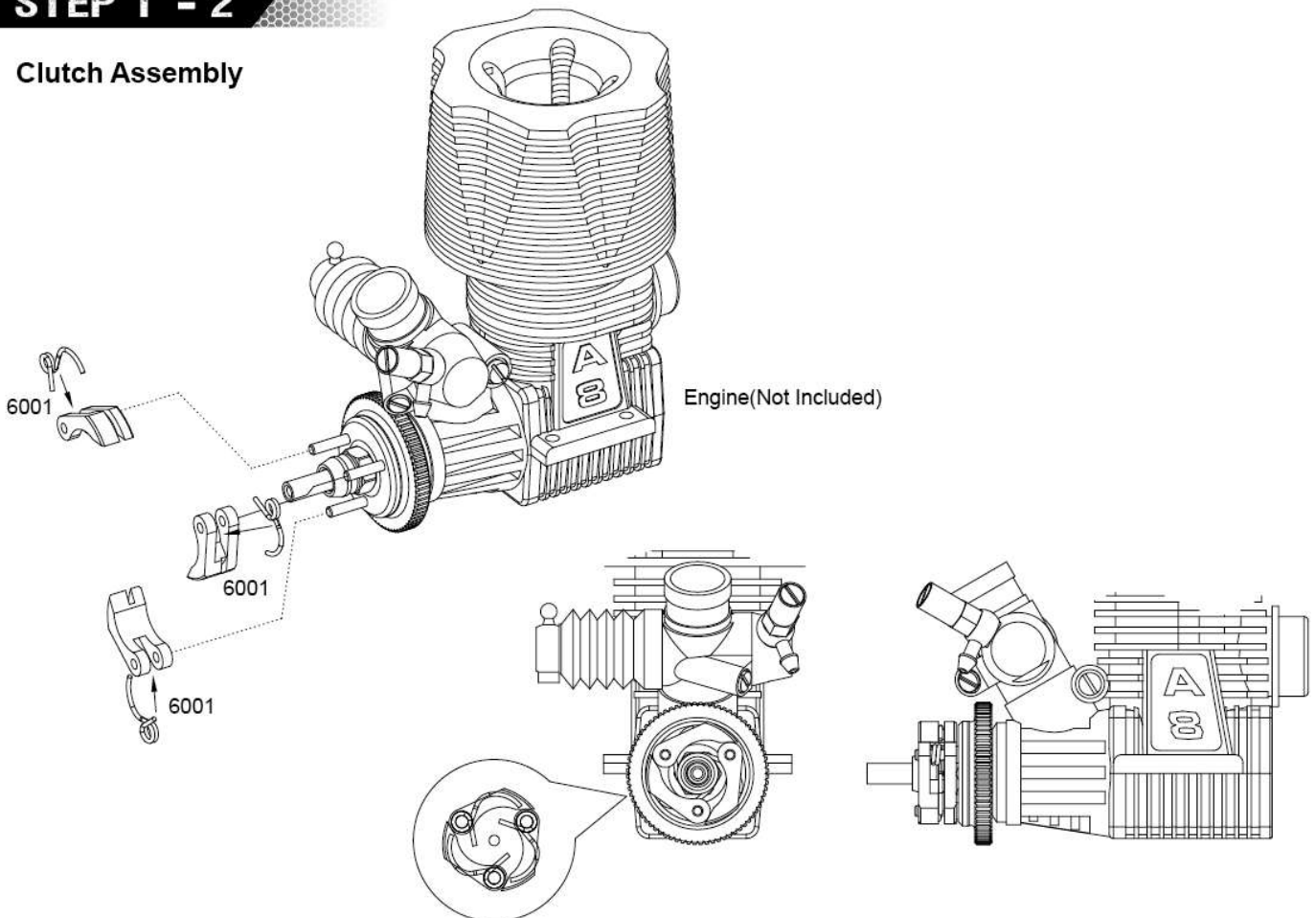

STEP I - 3

Clutch Bell Assembly

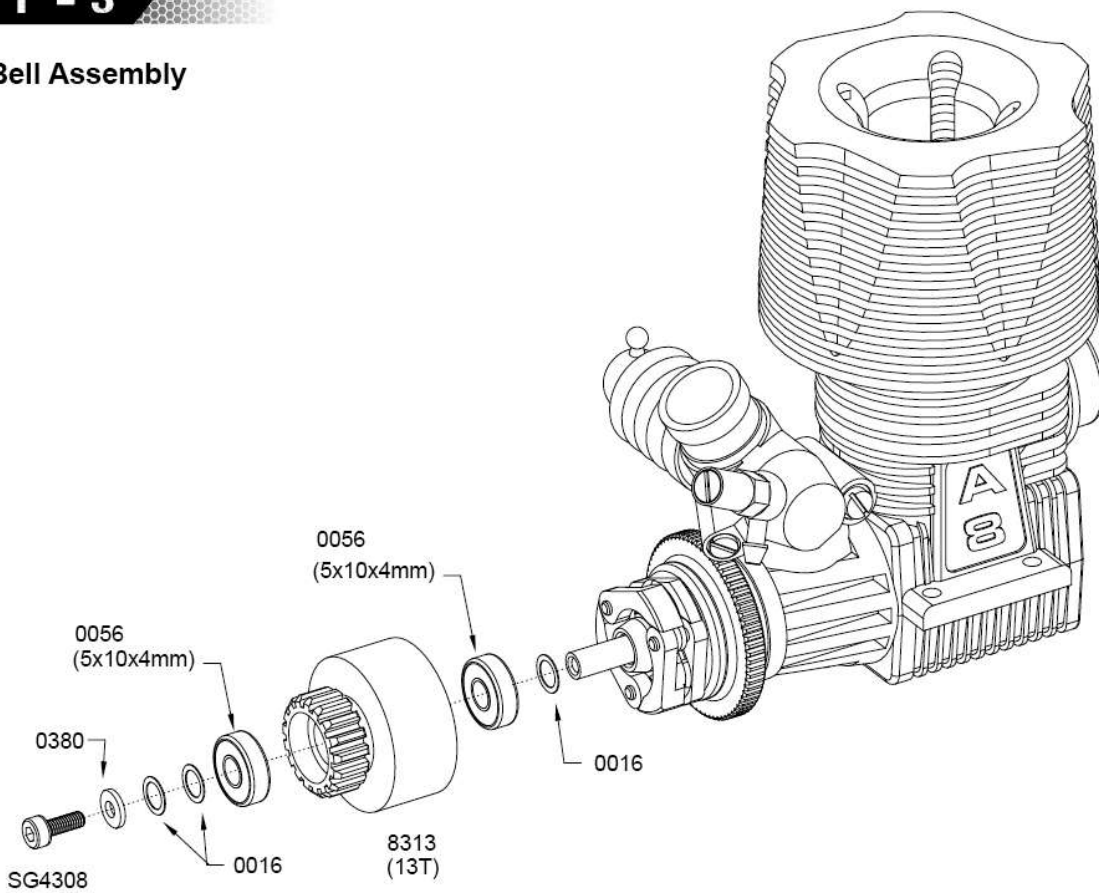

STEP I - 4

Engine Mount & Pipe Assembly

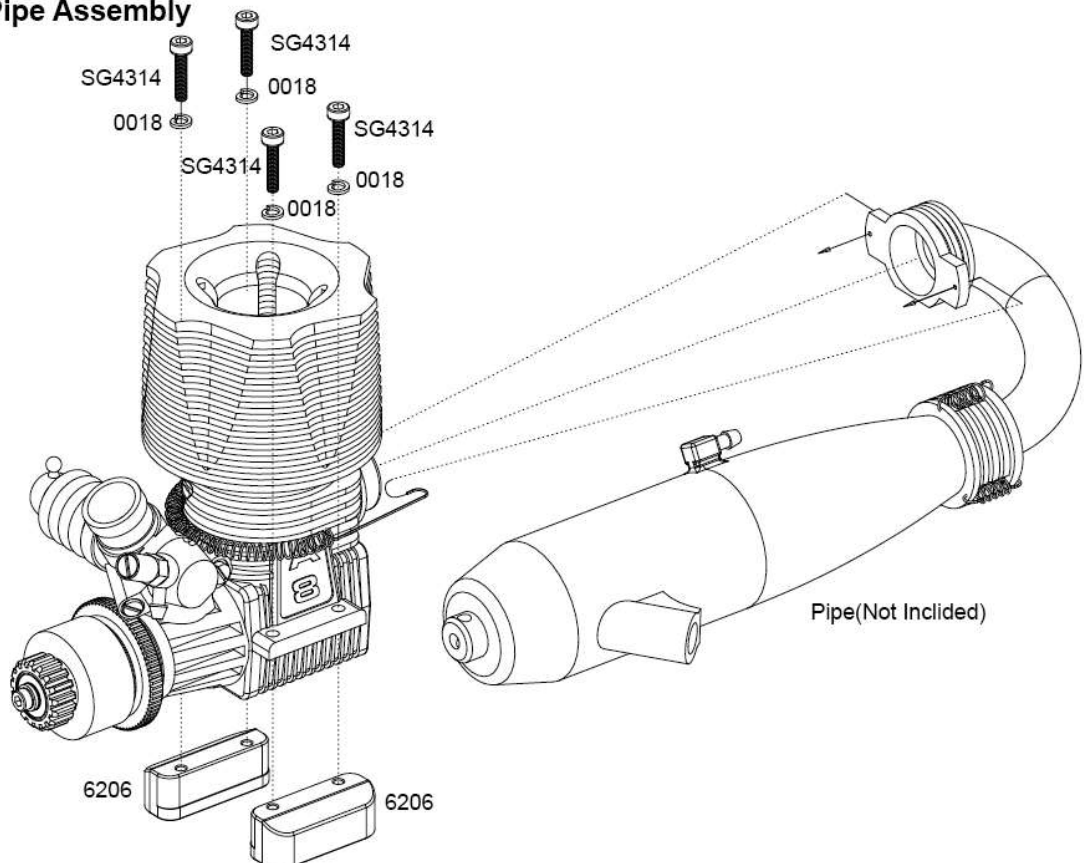

STEP I - 5

Engine Mount & Chassis Assembly

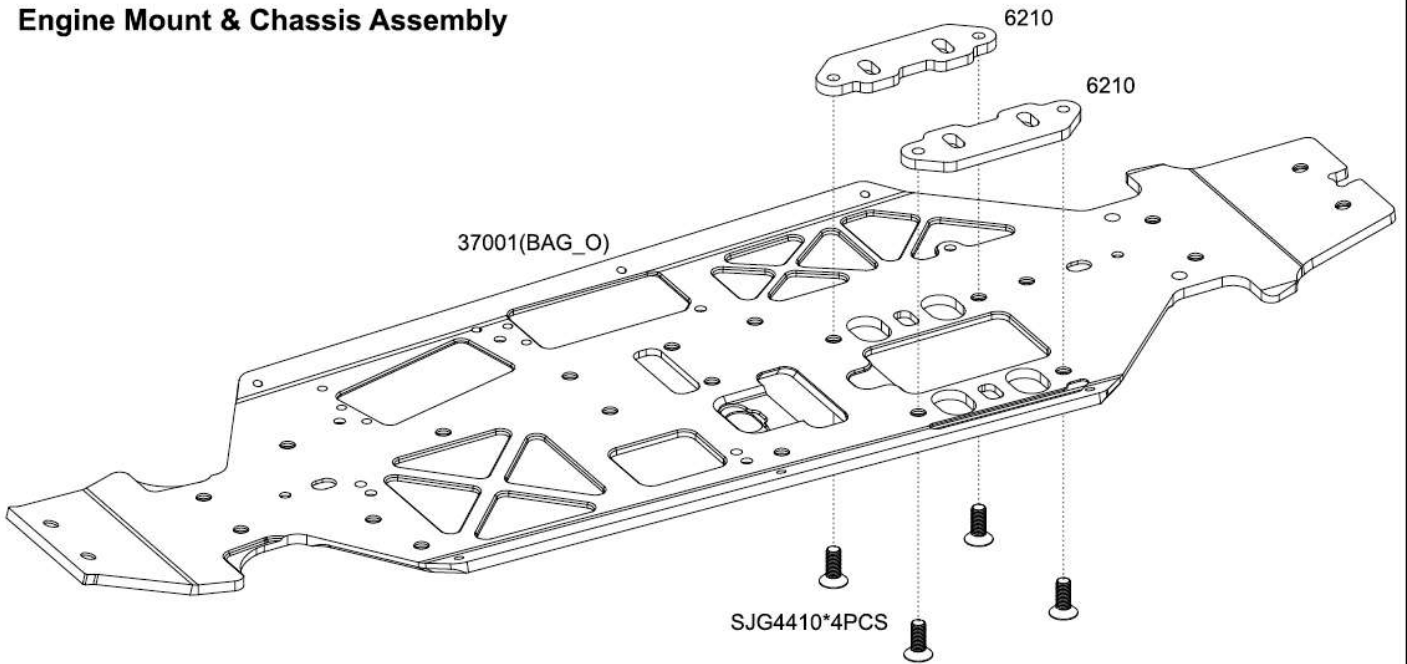

STEP J- 1

Servo Saver Assembly

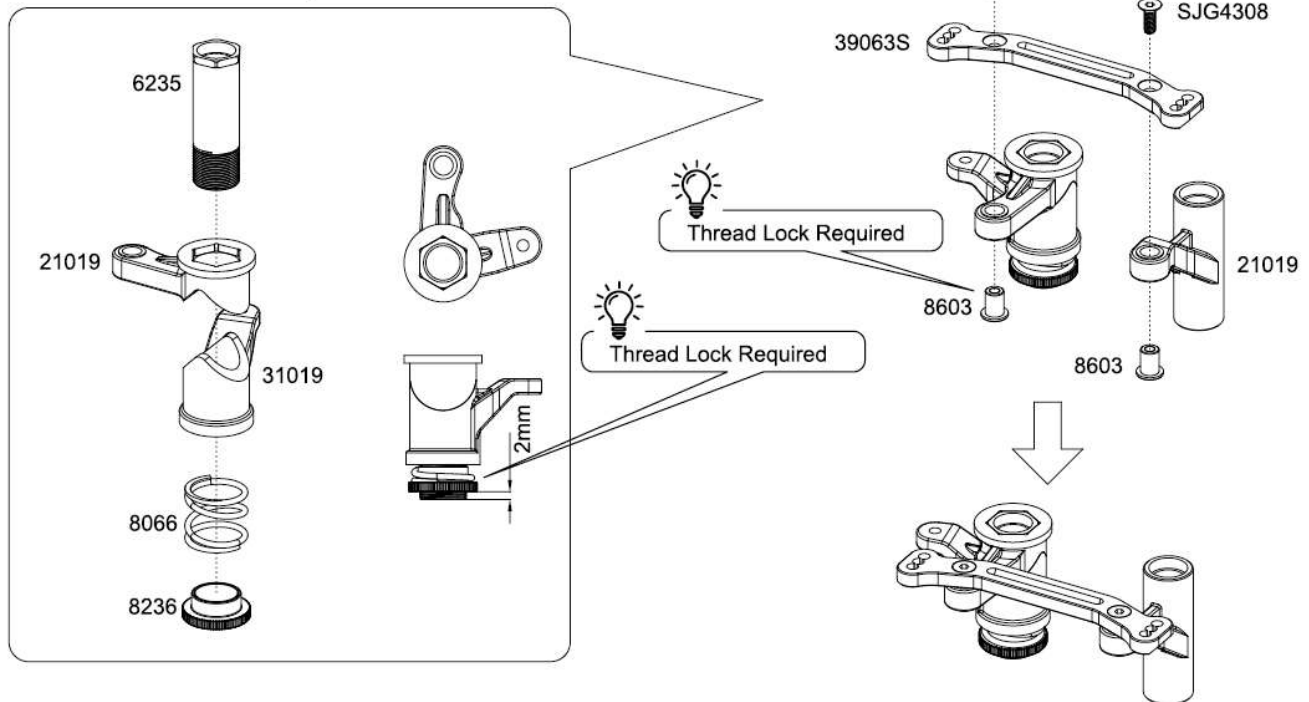

STEP J - 2

Steering Servo Link Assembly

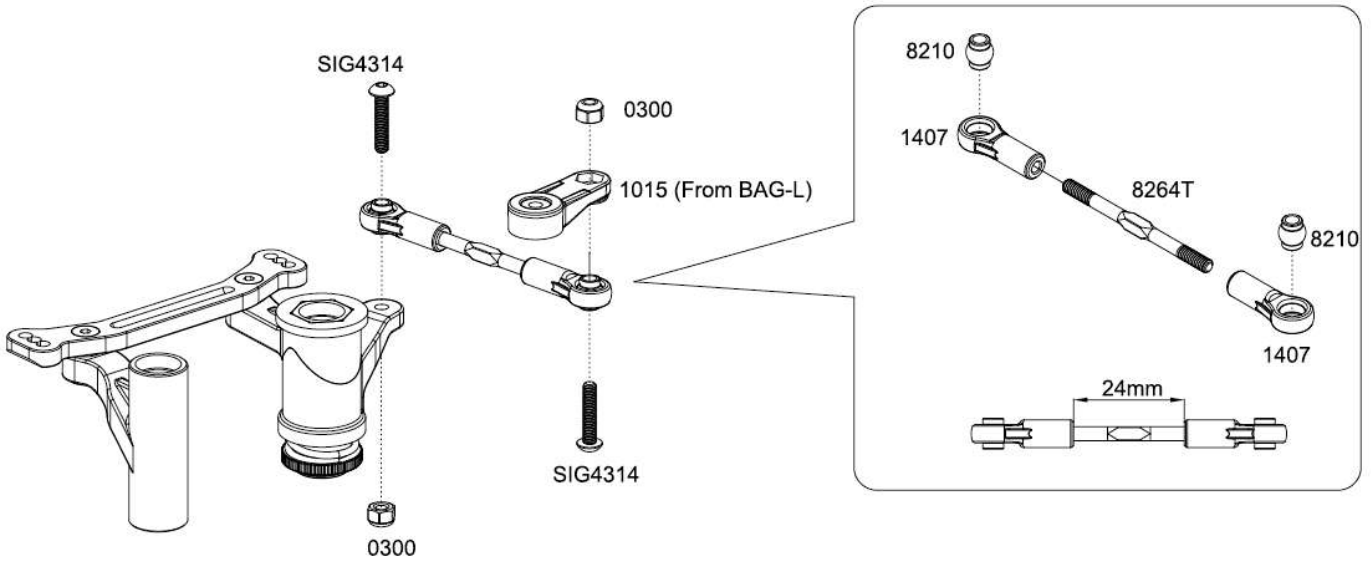

STEP J - 3

Steering Post & Front Chassis Support Assembly

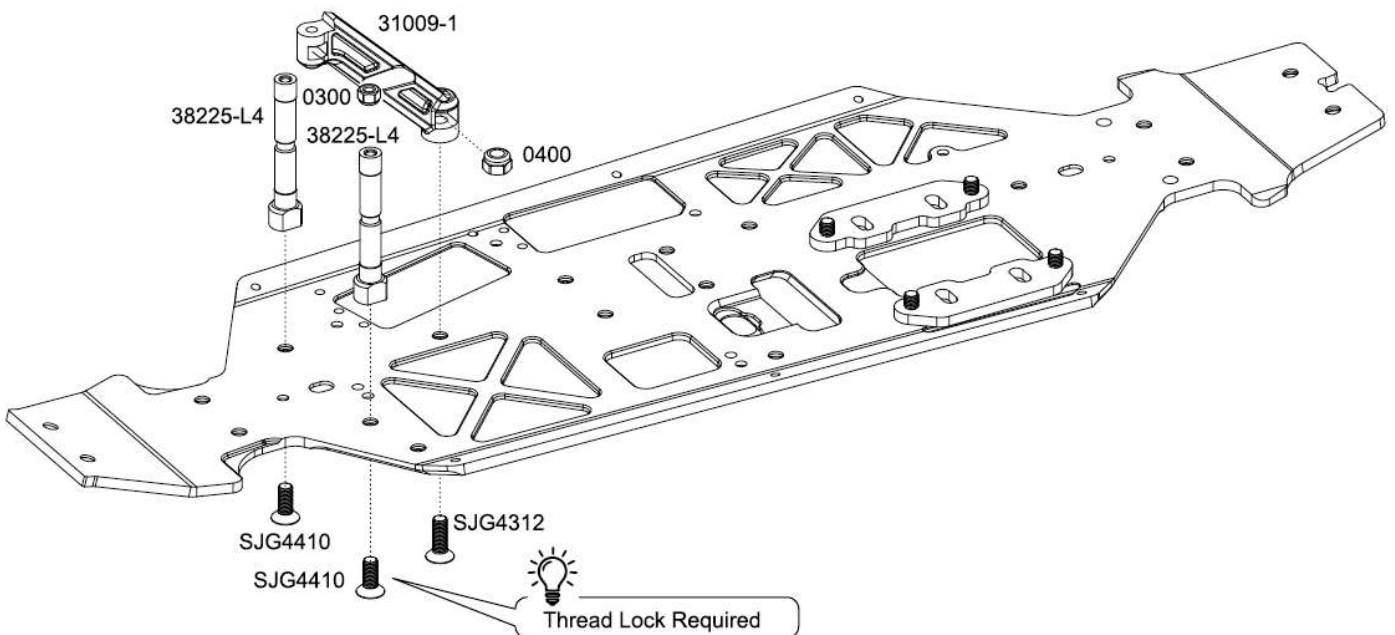

STEP J-4

Steering Saver & Front Chassis Brace Assembly

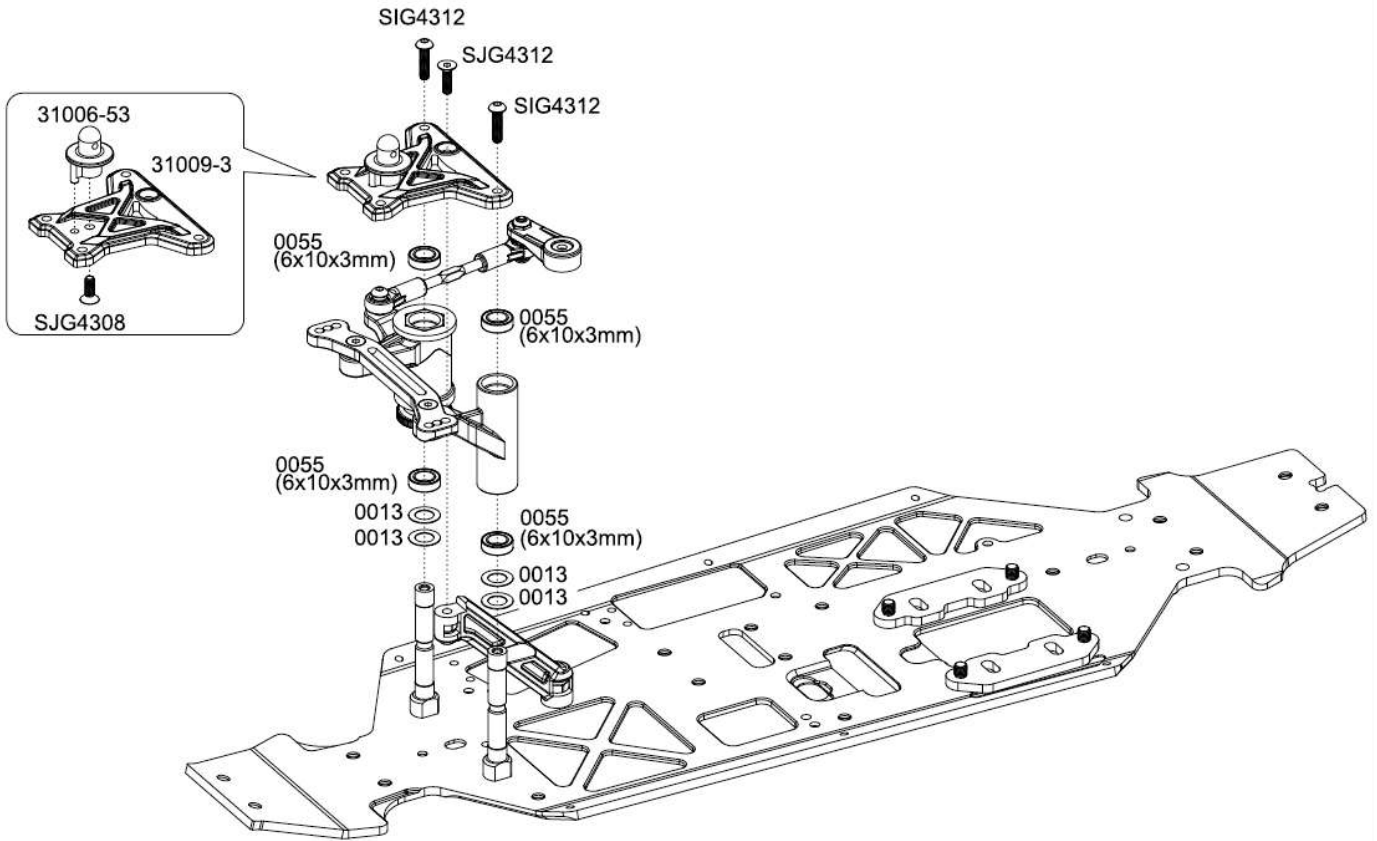

STEP J-5

Completed Steering Assembly

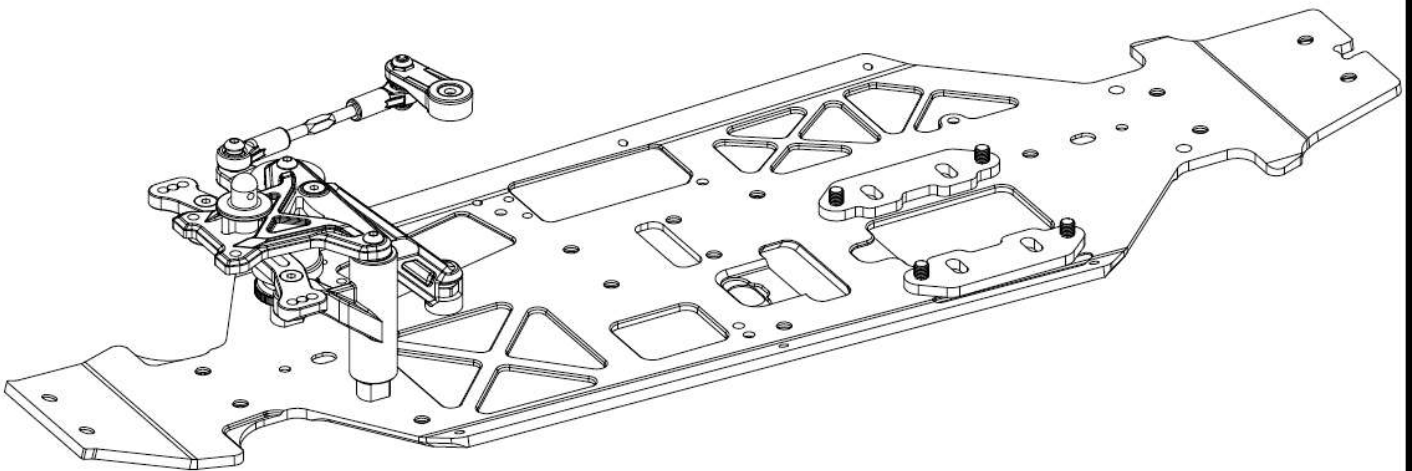

STEP K-1

Chassis Guard Installation

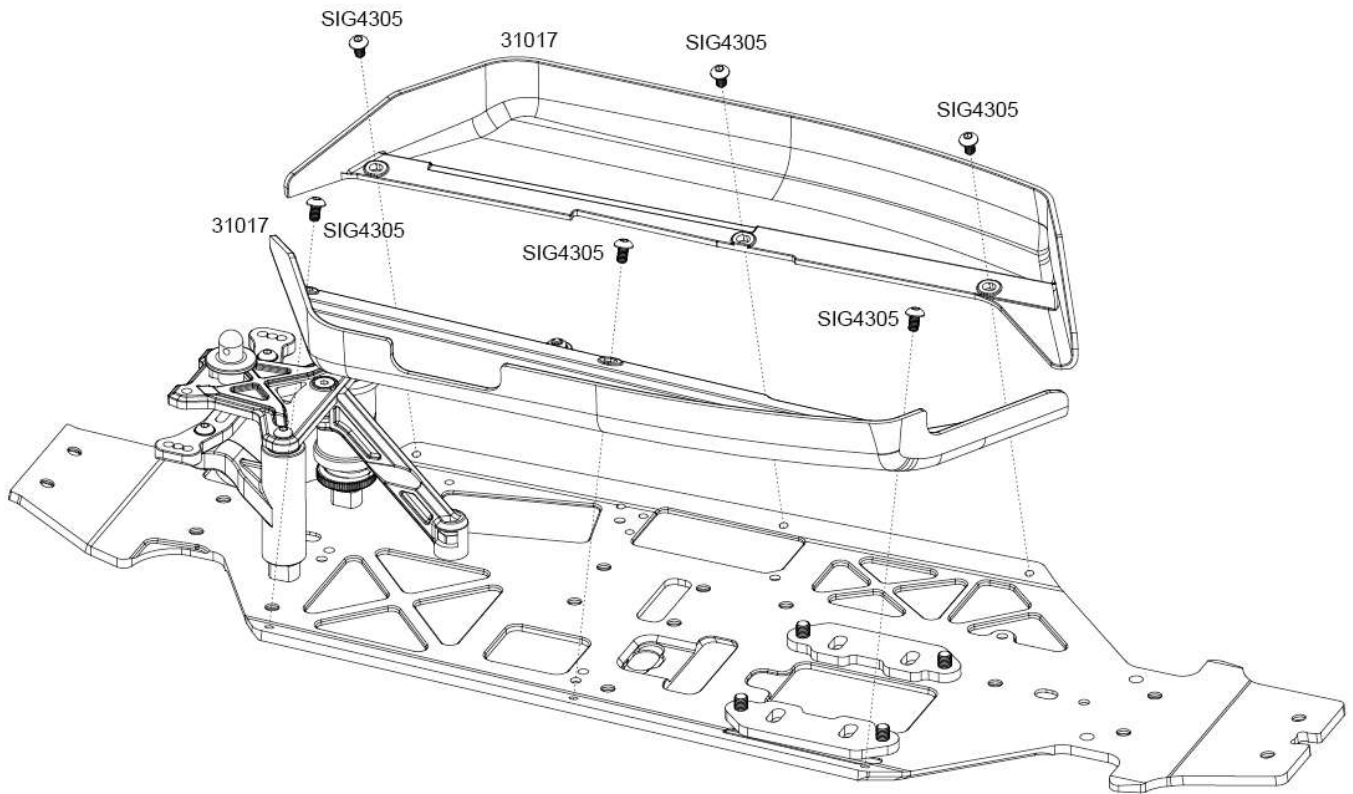

STEP L-1

Throttle/Brake Linkage Assembly

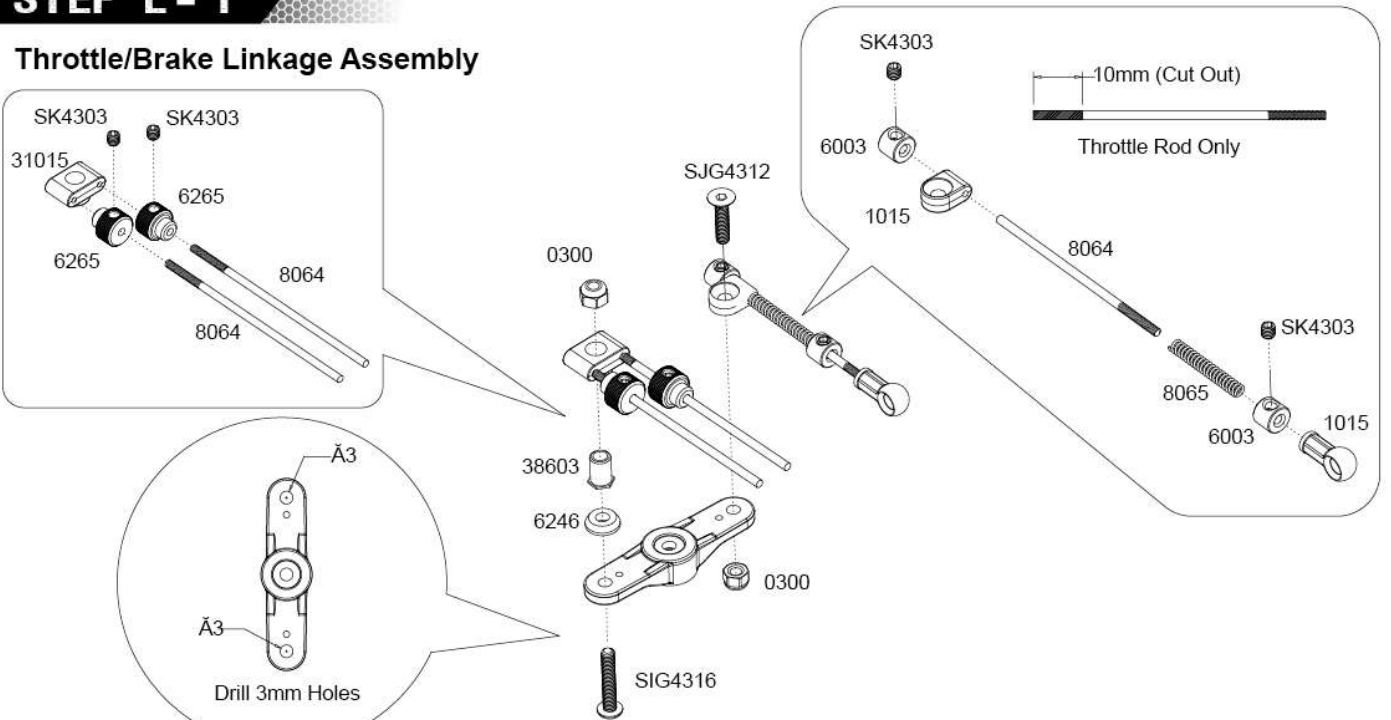

STEP L-2

Completed Throttle/Brake Linkage Assembly

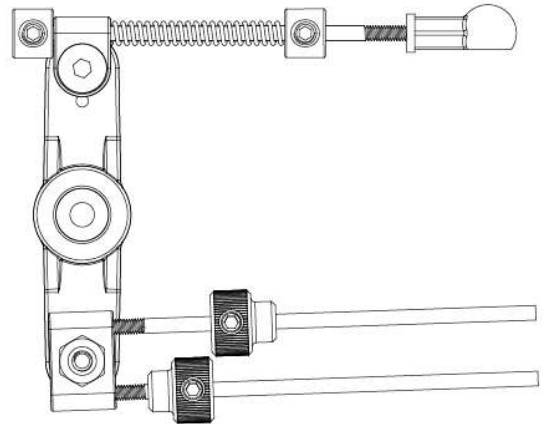
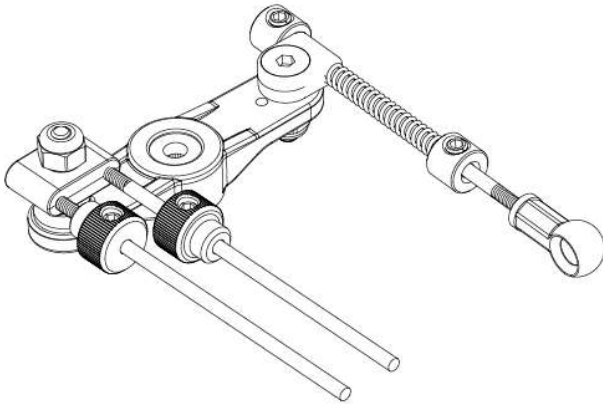

STEP M-1

Air Filter Assembly

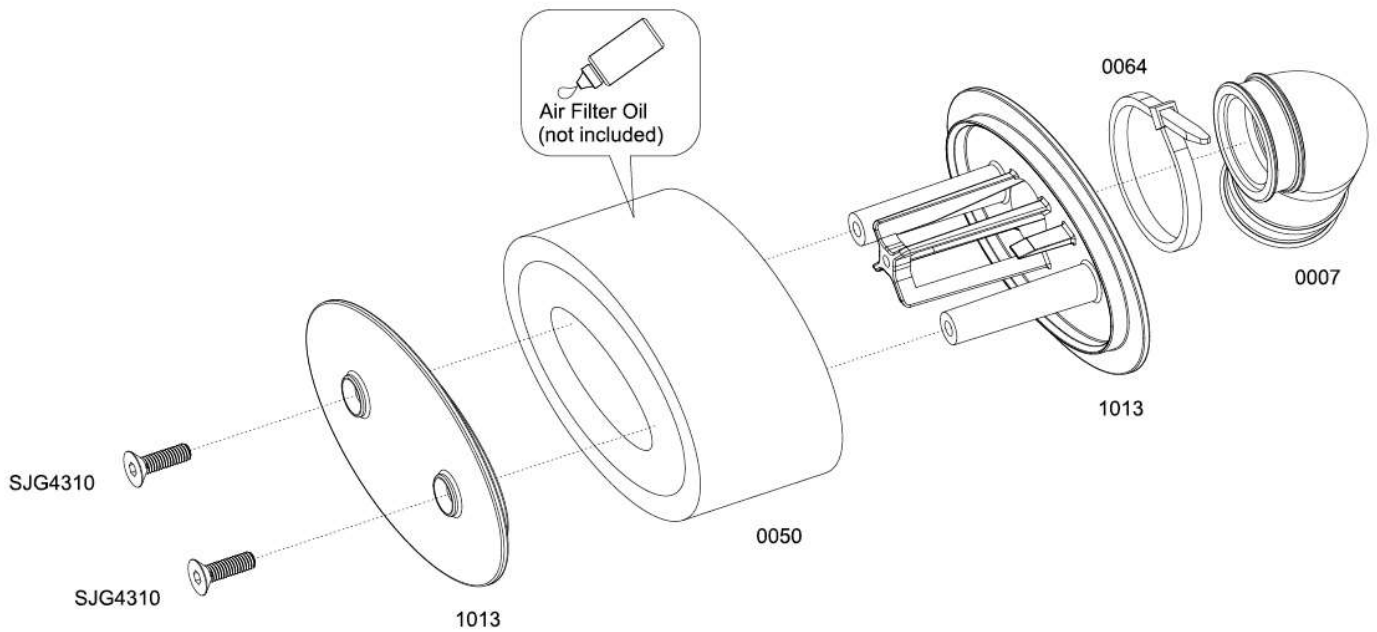

STEP M-2

Air Filter Assembly

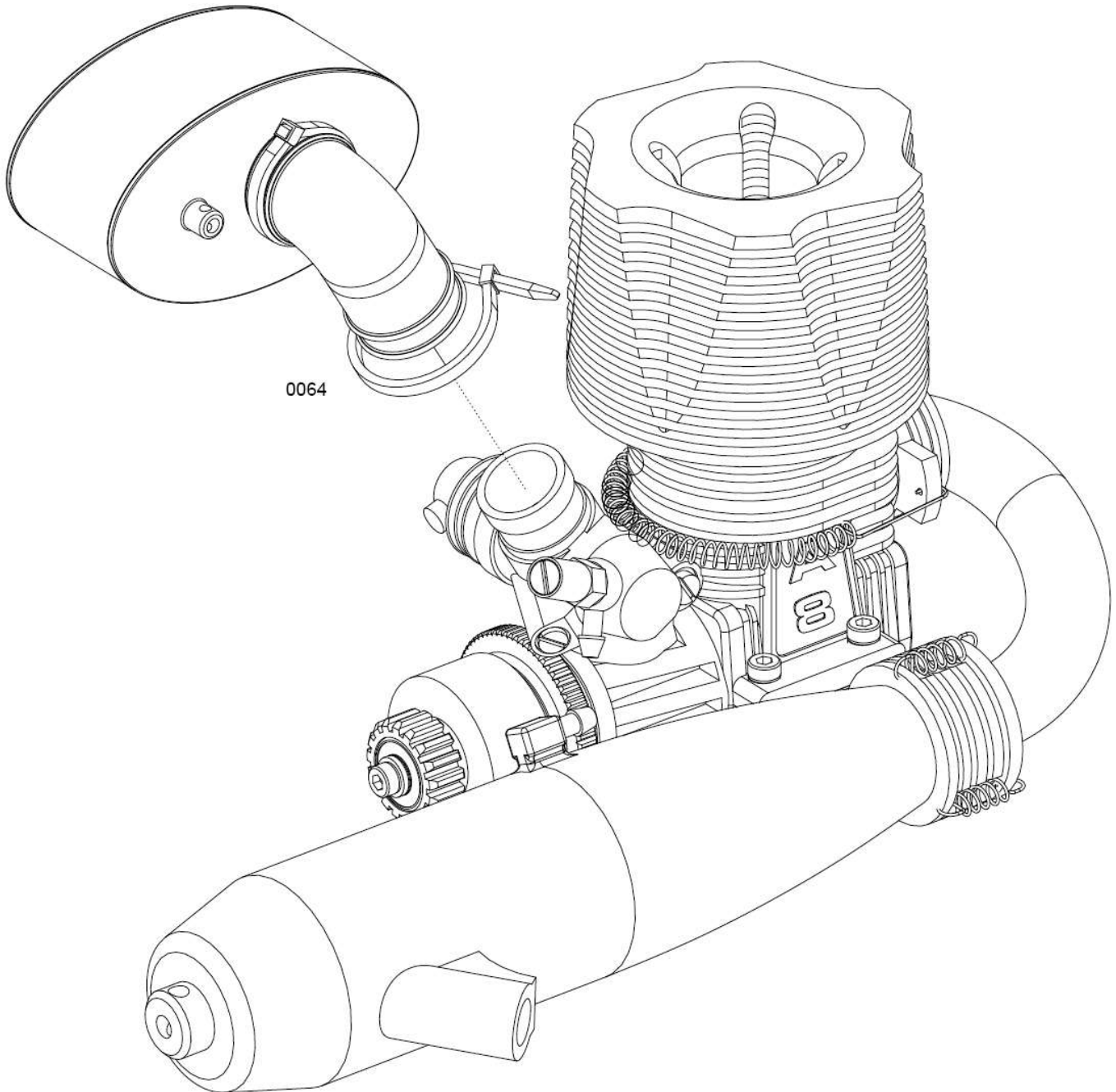

STEP - 1

Center Diff Installation

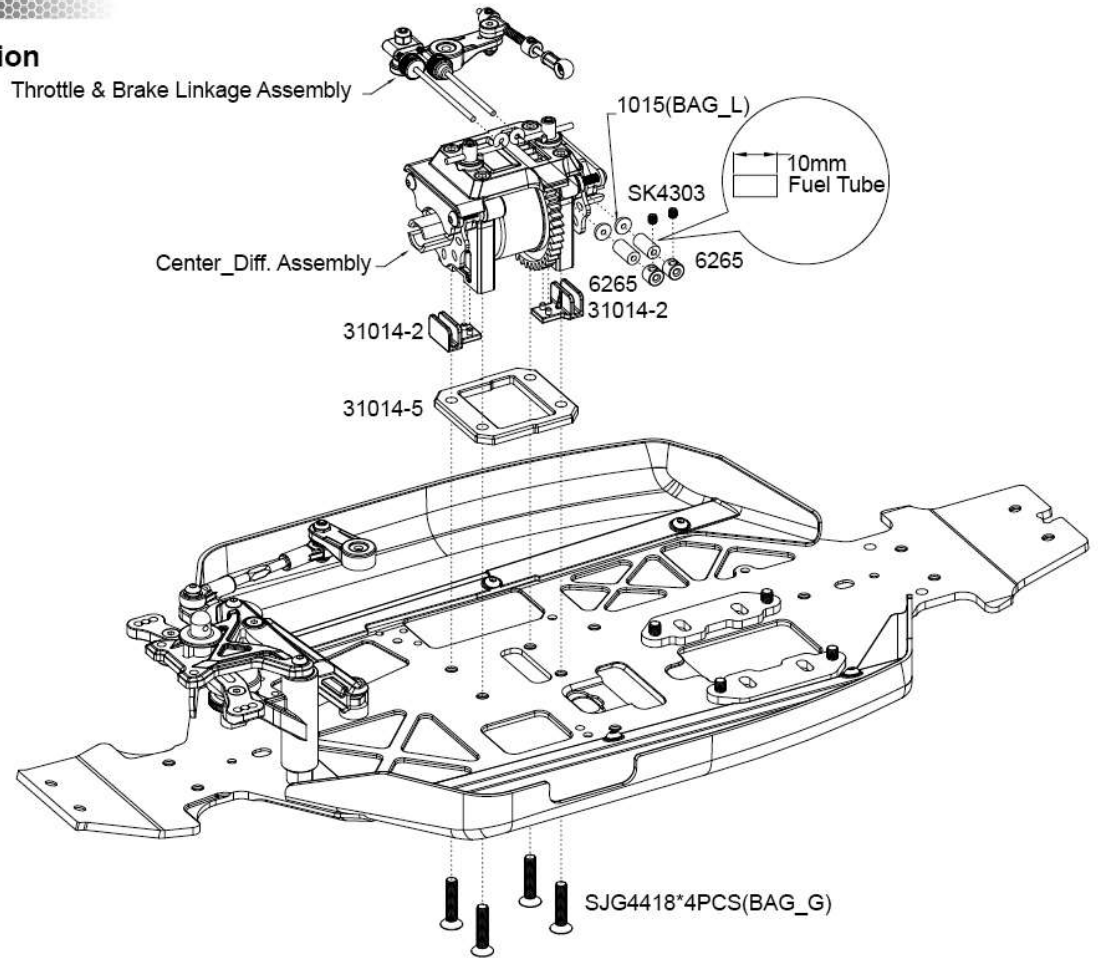

STEP - 2

Front End Installation

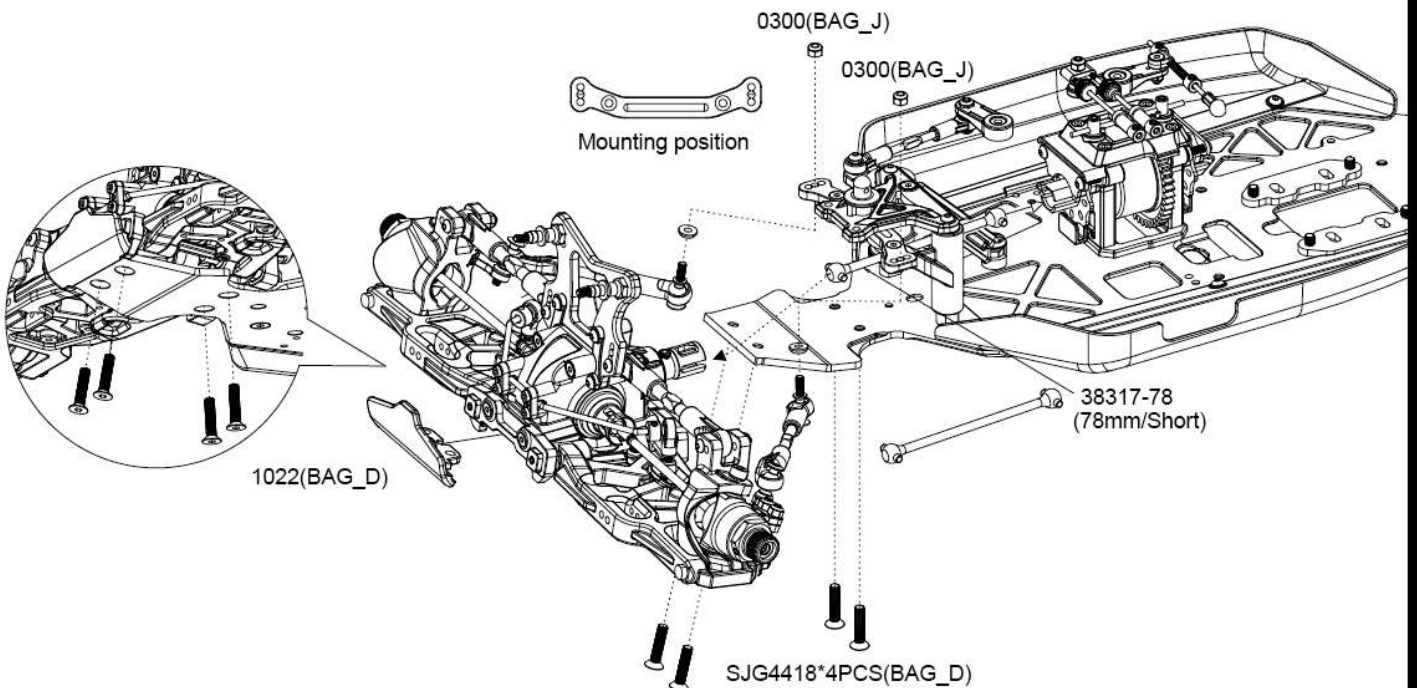

STEP - 3

Front End Installation

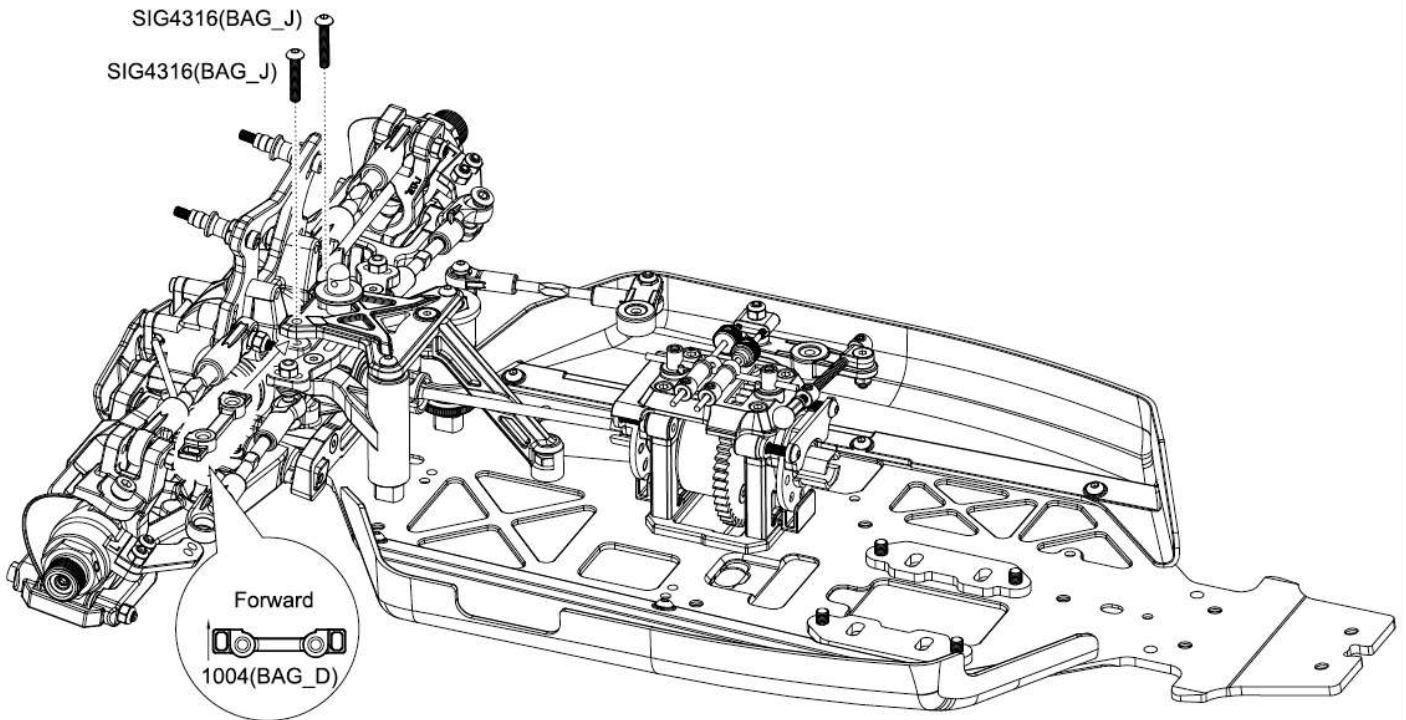

STEP - 4

Rear End Installation

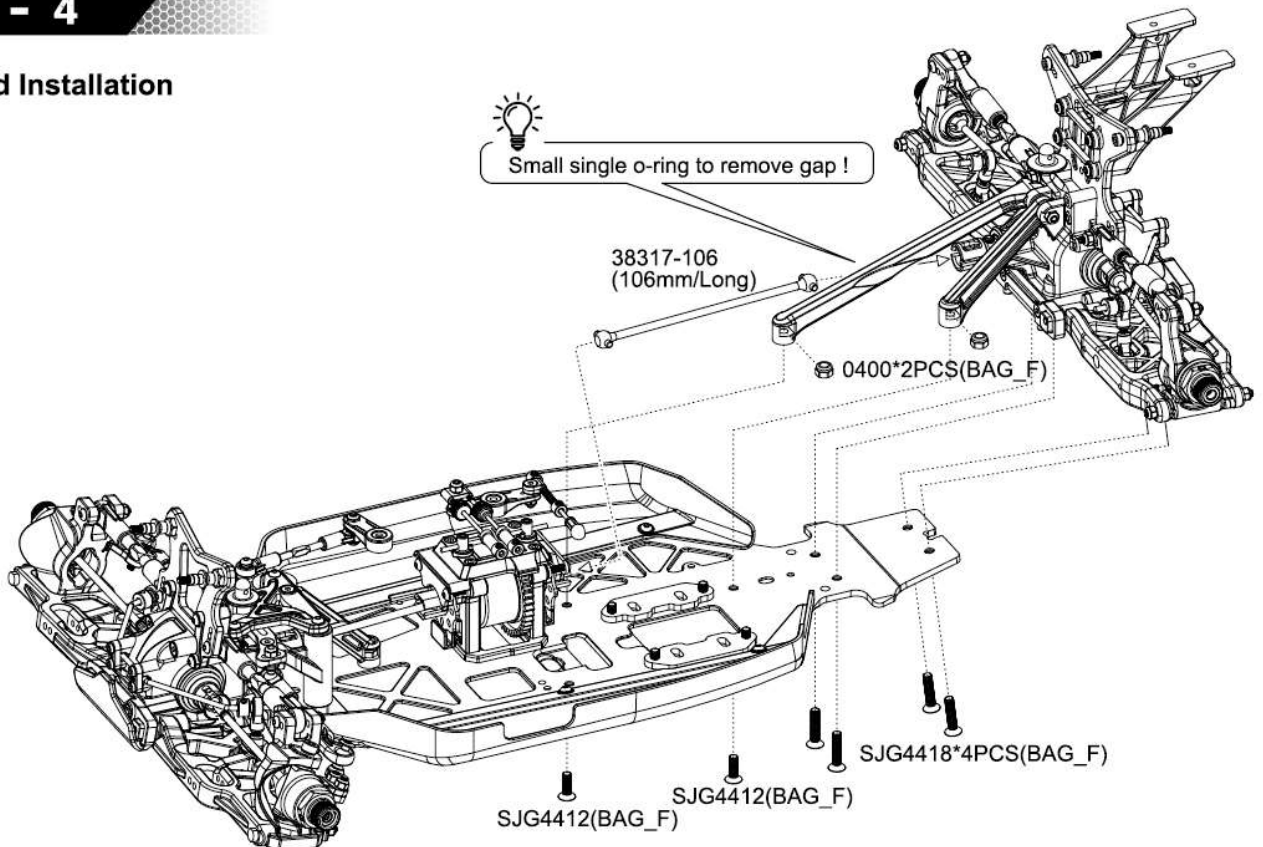

STEP - 5

Radio Tray Installation

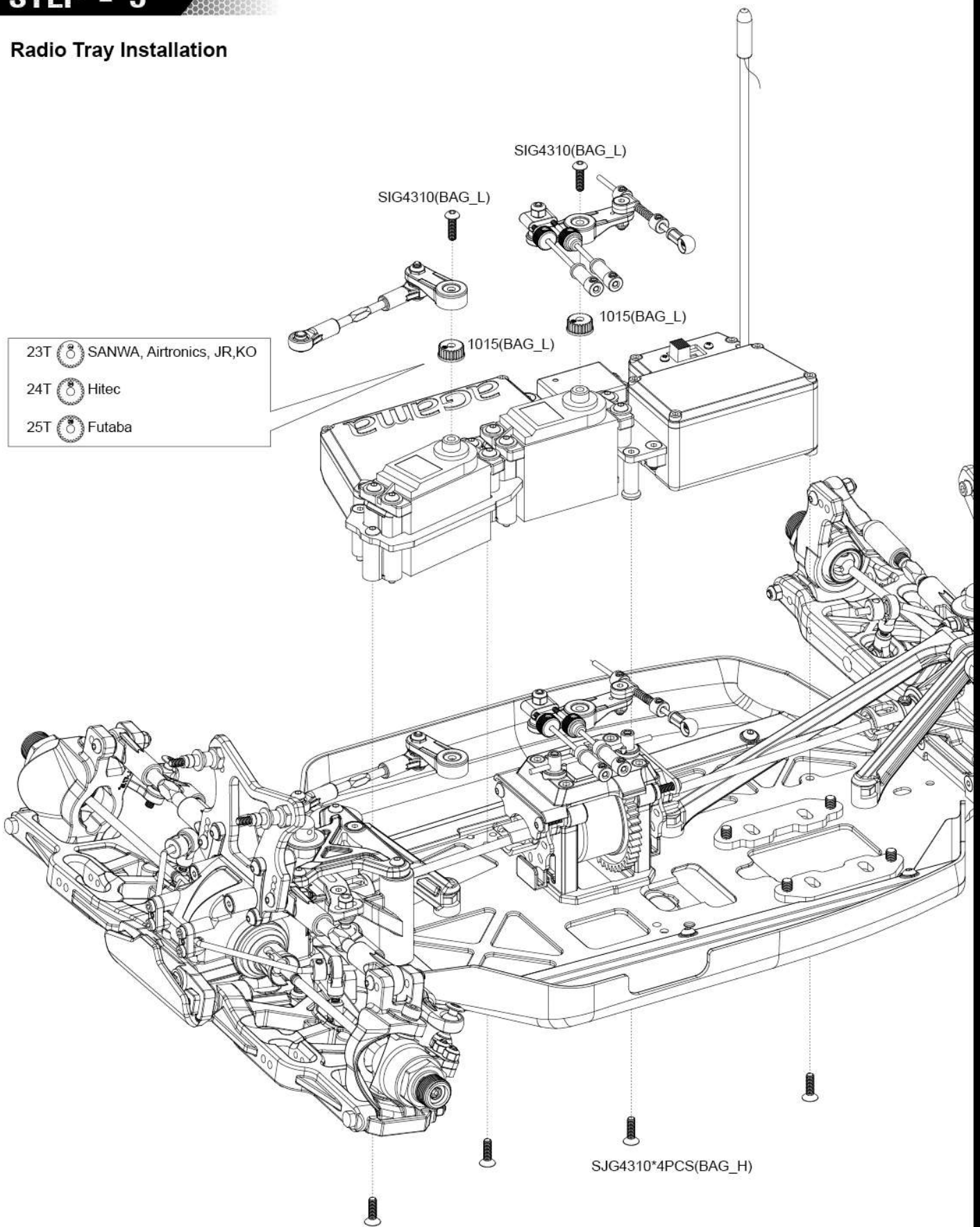

STEP - 6

Engine Set Installation

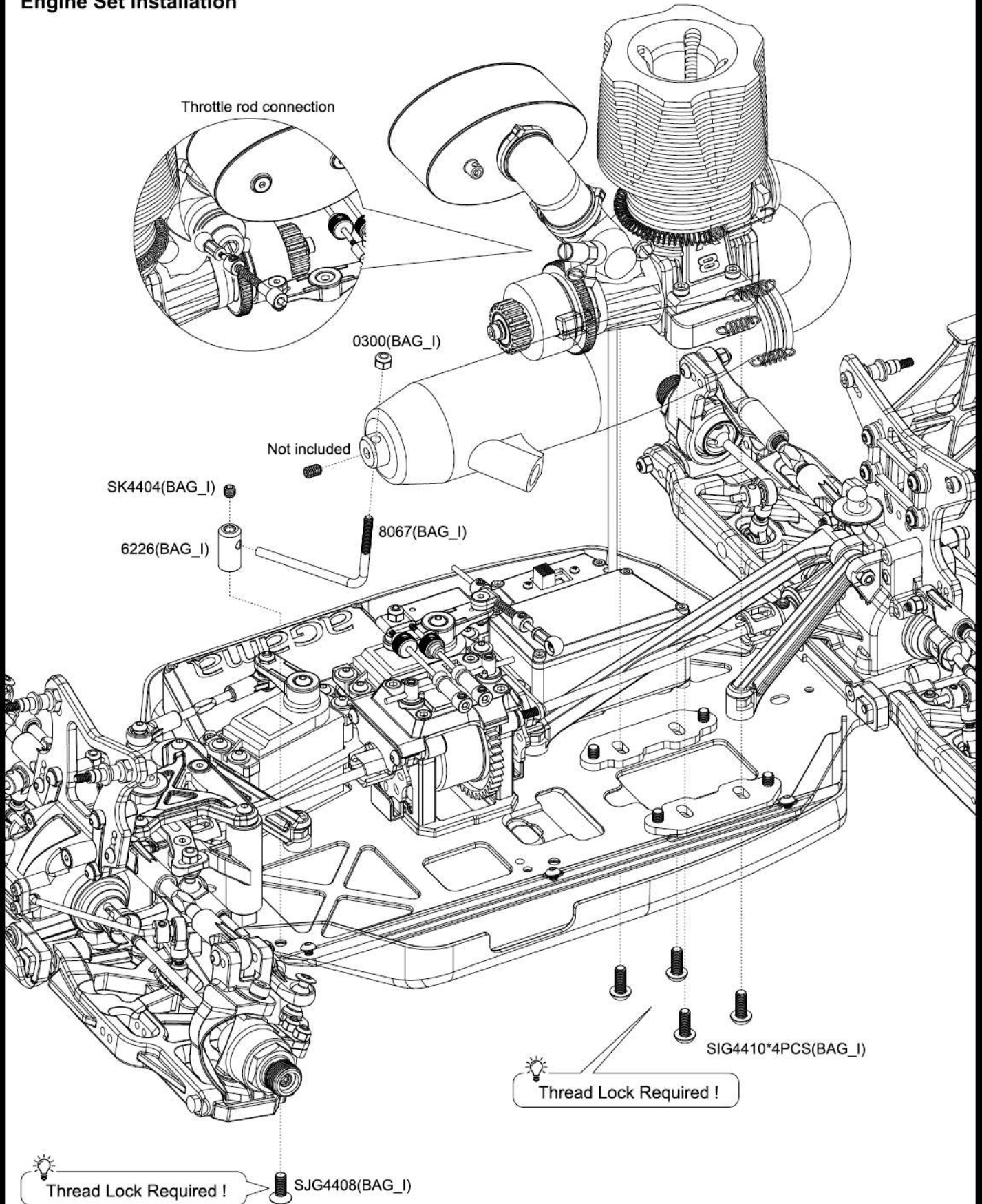

STEP - 7

Fuel Tank Installation



Fuel tank without volume compensator is 124cc.

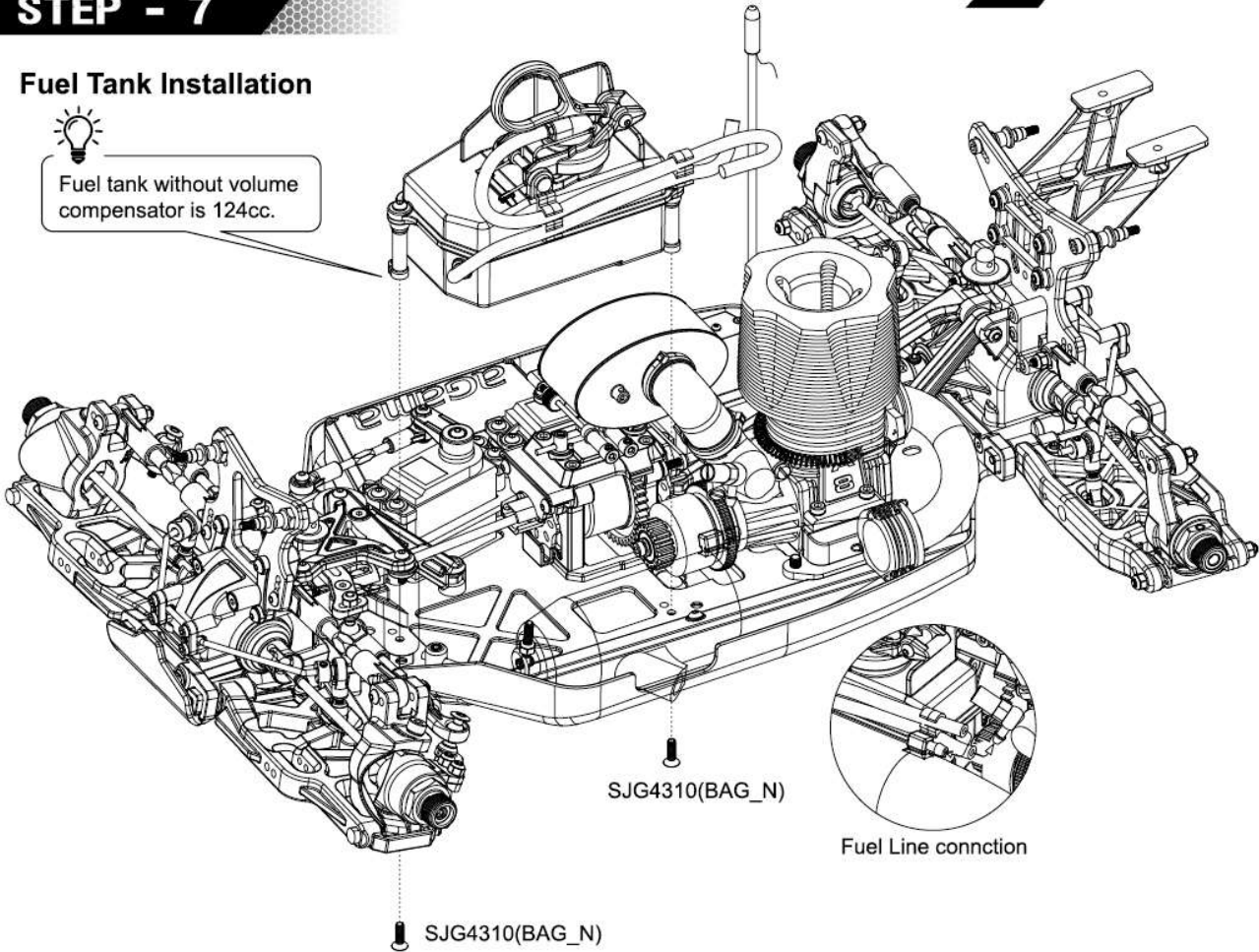

STEP - 8

Front/Rear Shocks Installation

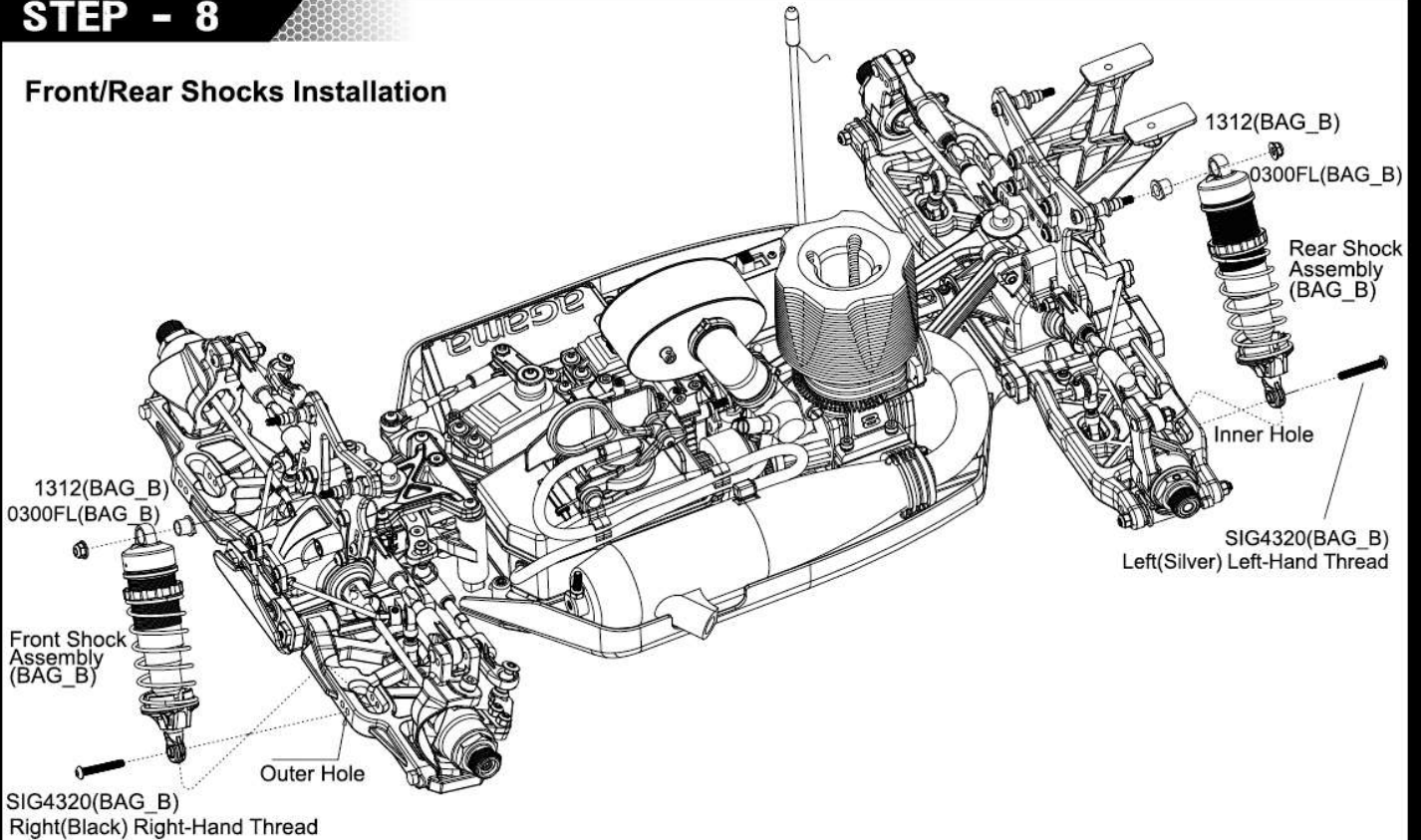

CHASSIS INSTALL

A319

STEP - 9

Tire Installation

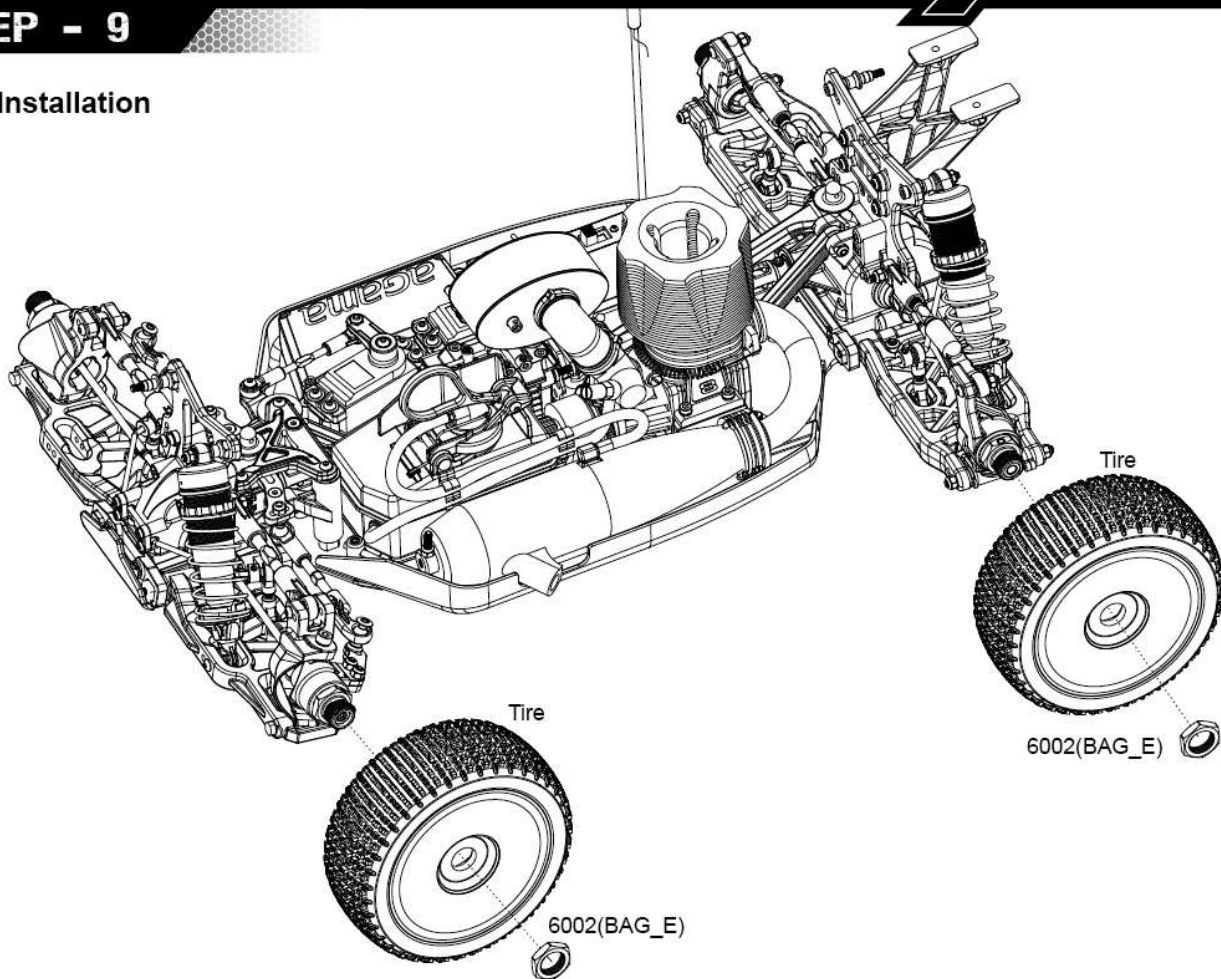

STEP - 10

Wing Installation

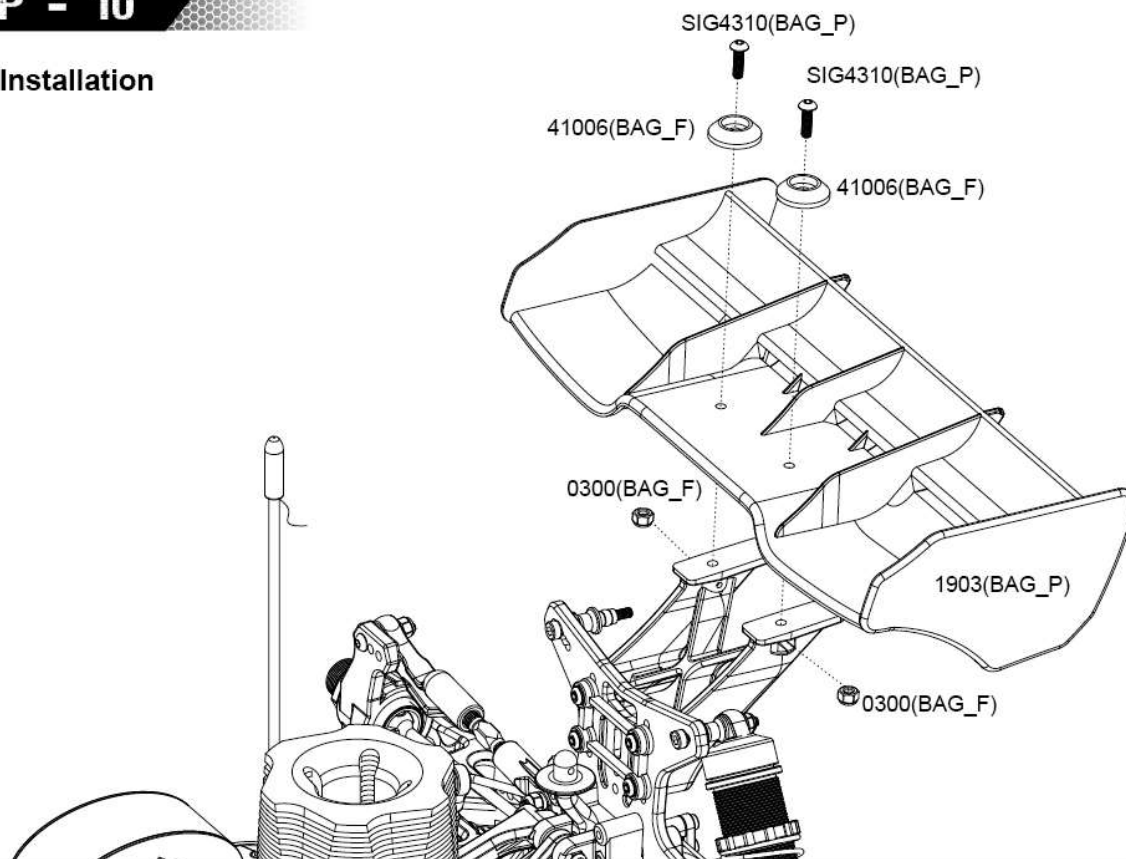

STEP - 11

Body Trimming

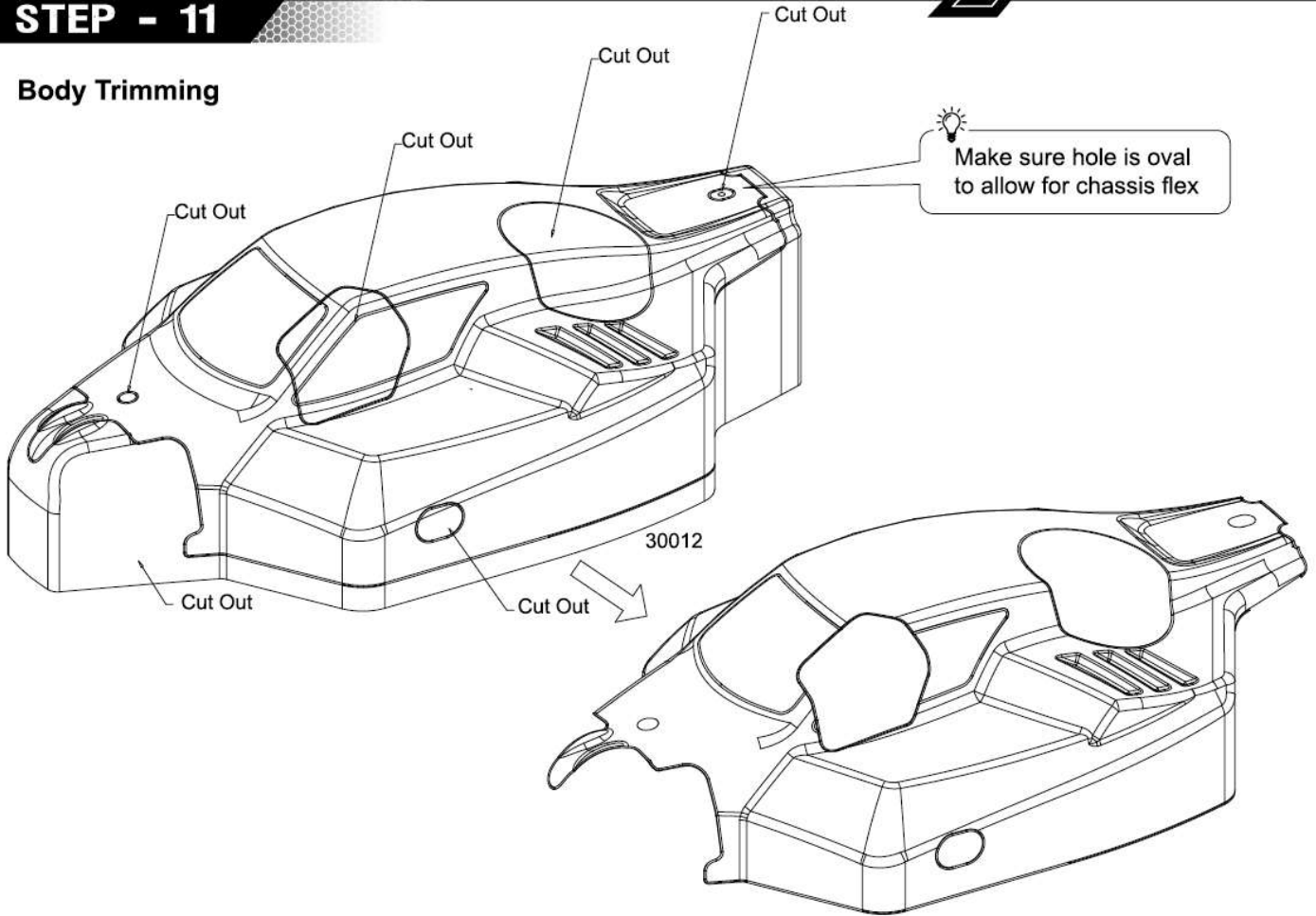

STEP - 12

Cover Mounting

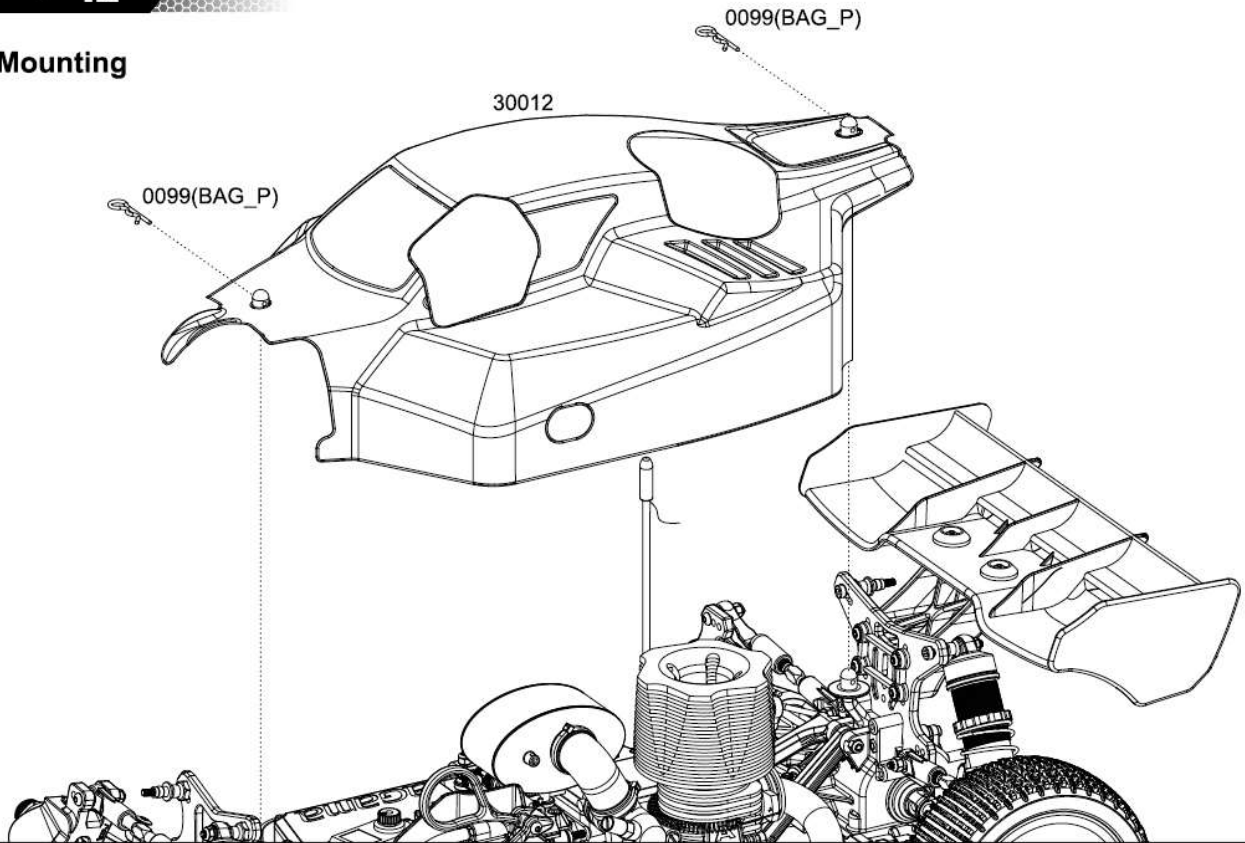

DATE _____

DRIVER _____

All Drivers

TRACK _____

Starting Setup A319

TRACK CONDITIONS Indoor Tight Smooth Hard Packed Blue Groove

Wet Low Bite High Bite Outdoor Open Rough Loose/Loamy

Dry Dusty Med Bite Other

ENGINE BULLITT B-223 Gasket Stock mm Plug BULLITT P3 Muffler BULLITT B-2091 Fuel PRF 25%

Clutch bell 16T 17T 18T Other 13 T Shoes 3 4 Spring 1.0 mm

DIFF Front 10,000 Oil # BETA Center 5,000 Oil # BETA Rear 5,000 Oil # BETA

39 T x 12 T Spur gear 48 T 39 T x 12 T

FRONT SUSPENSION

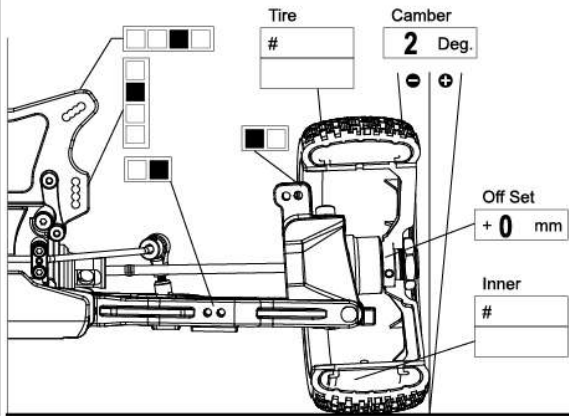

FRONT TOE ANGLE

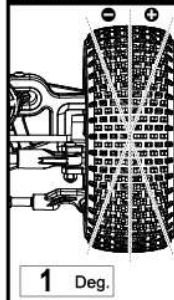

CASTER ANGLE

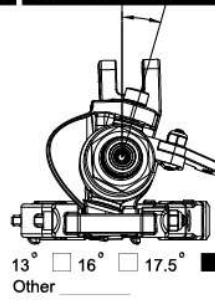

ANTI ROLL BAR

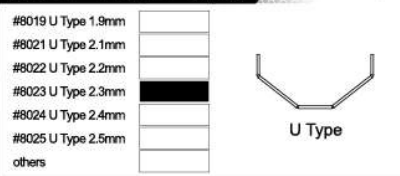

FRONT SHOCK

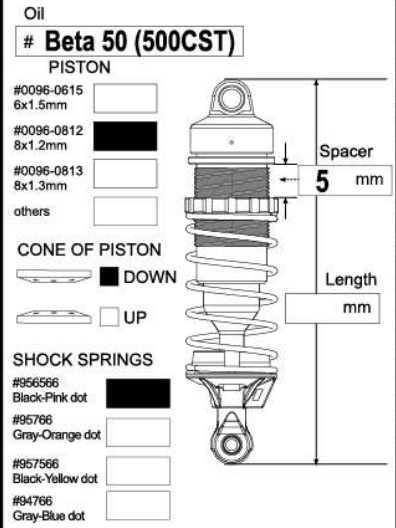

KICK UP

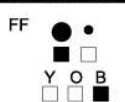

TOE ANGLE



ANTI SQUAT

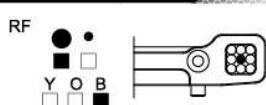

TOE ANGLE

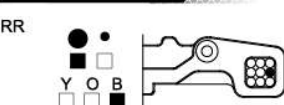

WHEEL BASE

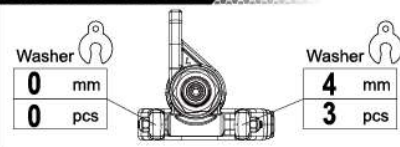

REAR SHOCK

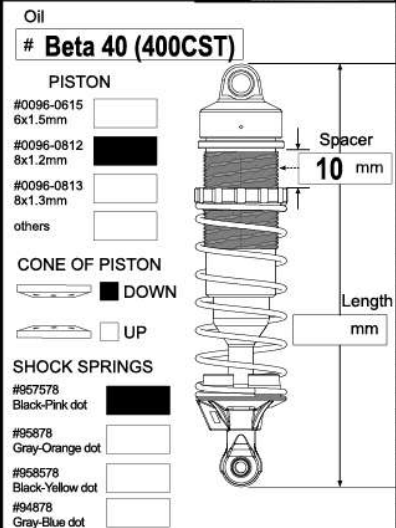

REAR SUSPENSION

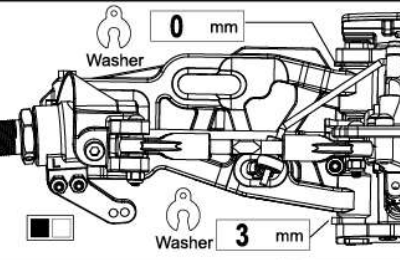
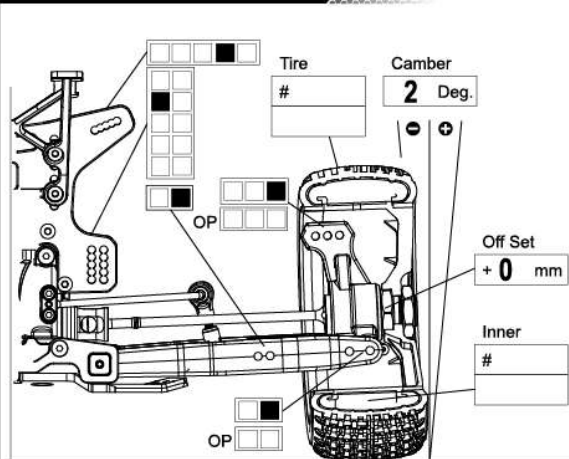

ANTI ROLL BAR

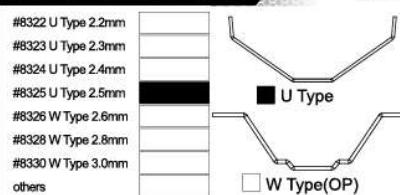

DROOP LIMITER

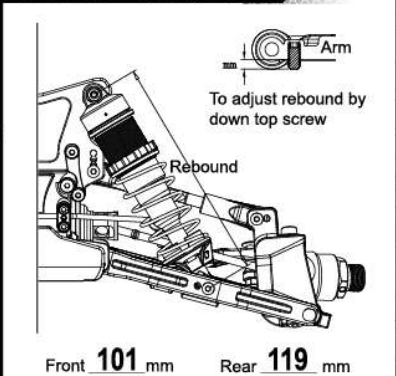

ACKERMAN

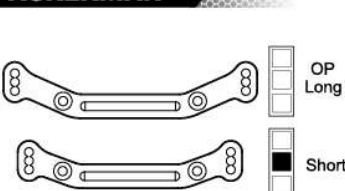

RIDE HEIGHT

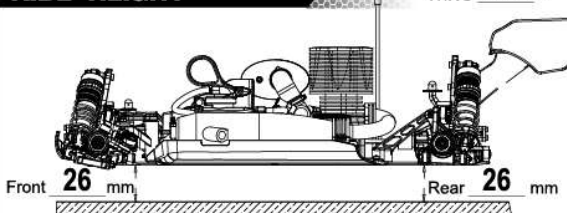

DATE _____

DRIVER _____

TRACK _____

TRACK CONDITIONS

Indoor Tight Smooth Hard Packed Blue Groove

Wet Low Bite High Bite Outdoor Open Rough Loose/Loamy

Dry Dusty Med Bite Other _____

ENGINE

Gasket _____ mm Plug _____ Muffler _____ Fuel _____

Clutch bell 16T 17T 18T Other _____ T Shoes 3 4 Spring _____ mm

DIFF

Front _____ Oil # _____ Center _____ Oil # _____ Rear _____ Oil # _____

T x T _____ Spur gear _____ T _____ T x T _____

FRONT SUSPENSION

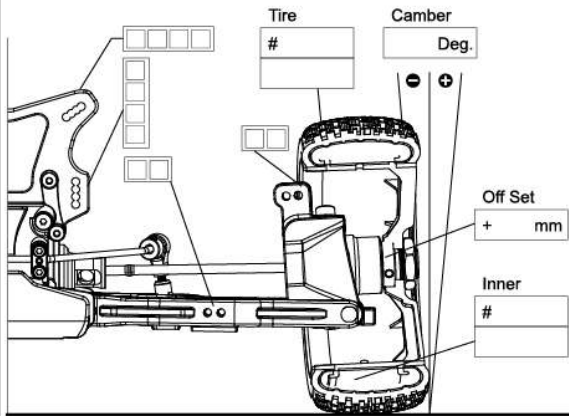

FRONT TOE ANGLE

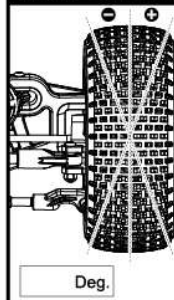

CASTER ANGLE

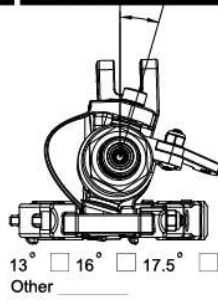

ANTI ROLL BAR

- #8019 U Type 1.9mm
- #8021 U Type 2.1mm
- #8022 U Type 2.2mm
- #8023 U Type 2.3mm
- #8024 U Type 2.4mm
- #8025 U Type 2.5mm
- others _____

FRONT

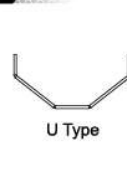

FRONT SHOCK

Oil # _____

PISTON

- #0096-0615 6x1.5mm
- #0096-0812 8x1.2mm
- #0096-0813 8x1.3mm
- others _____

CONE OF PISTON

DOWN UP

SHOCK SPRINGS

- #95656 Black-Pink dot
- #95766 Gray-Orange dot
- #95756 Black-Yellow dot
- #94766 Gray-Blue dot

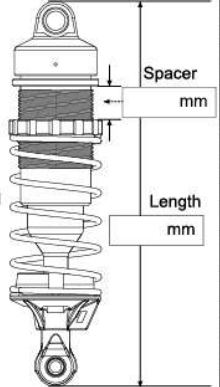

KICK UP

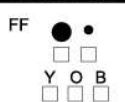

TOE ANGLE



ANTI SQUAT

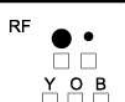

TOE ANGLE

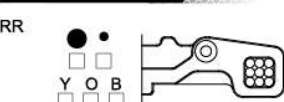

WHEEL BASE

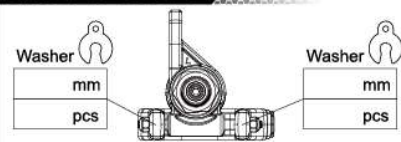

REAR SUSPENSION

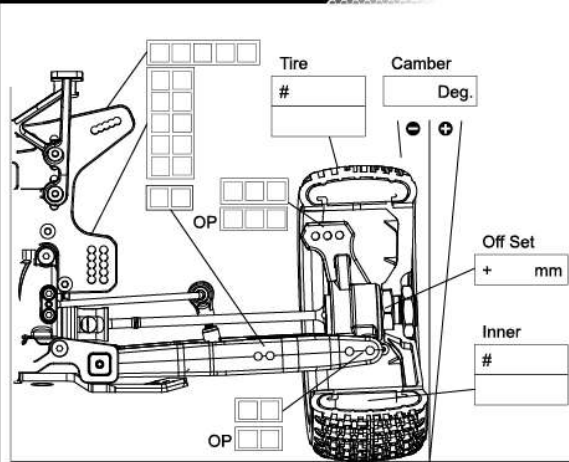

WHEEL BASE

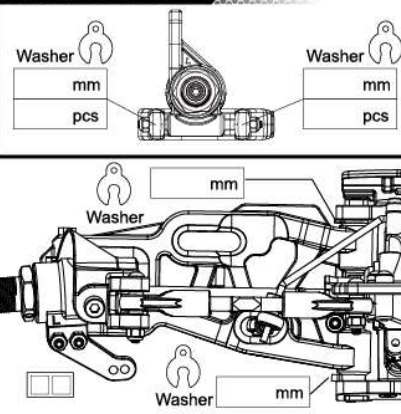

ANTI ROLL BAR

- #8322 U Type 2.2mm
- #8323 U Type 2.3mm
- #8324 U Type 2.4mm
- #8325 U Type 2.5mm
- #8326 W Type 2.6mm
- #8328 W Type 2.8mm
- #8330 W Type 3.0mm
- others _____

REAR

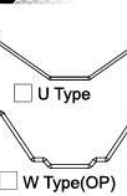

REAR SHOCK

Oil # _____

PISTON

- #0096-0615 6x1.5mm
- #0096-0812 8x1.2mm
- #0096-0813 8x1.3mm
- others _____

CONE OF PISTON

DOWN UP

SHOCK SPRINGS

- #95757 Black-Pink dot
- #95878 Gray-Orange dot
- #95857 Black-Yellow dot
- #94878 Gray-Blue dot

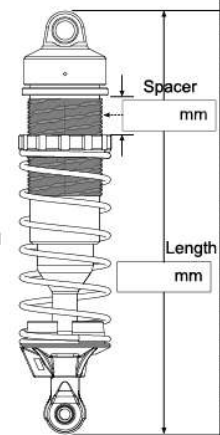

ACKERMAN

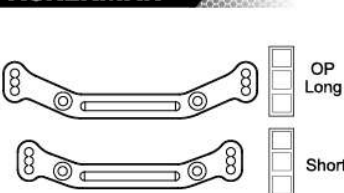

RIDE HEIGHT

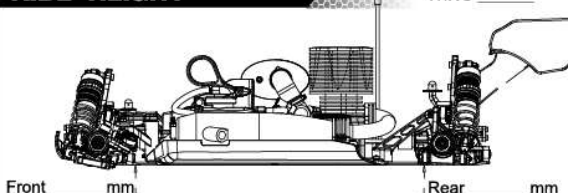

DROOP LIMITER

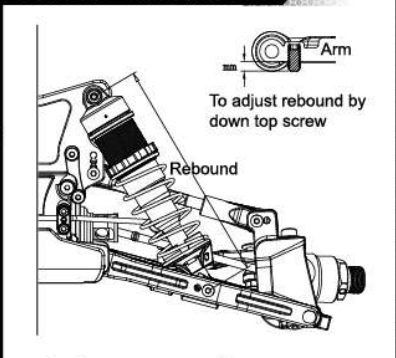

MEMO



A series of horizontal dashed lines for writing, spanning the width of the page below the header.

A319



**1/8 SCALE 4WD NITRO
OFFROAD BUGGY**

U.J. ENTERPRISE CO., LTD.
E-mail: contact@agama-rc.com