



MEDIFY AIR



MA-12-PRO AIRPURIFIER

READ AND SAVE THESE INSTRUCTIONS
INSTRUCTION MANUAL AND WARRANTY INFORMATION

Lifetime warranty if replacing filters on time*

MA-12-PRO/US
Rev:
4/15/24

IMPORTANT SAFETY INSTRUCTIONS:

WHEN USING ELECTRICAL PRODUCTS, ESPECIALLY WHEN CHILDREN ARE PRESENT, BASIC SAFETY PRECAUTIONS SHOULD ALWAYS BE FOLLOWED, INCLUDING THE FOLLOWING:

IF THE POWER CORD OR UNIT DOES NOT WORK, CONTACT MEDIFY CUSTOMER SERVICE

READ ALL INSTRUCTIONS BEFORE USING.

DANGER — TO REDUCE THE RISK OF ELECTRICAL SHOCK:

- Always unplug the air purifier from the electrical outlet immediately after using it and before cleaning or replacing filters.
- Keep the cord away from heated surfaces.
- Always place the air purifier on a firm, leveled surface.
- Always place the air purifier at least 12 inches away from walls and 3 feet from heat sources such as stoves, radiators, or heaters.
- DO NOT reach for an appliance that has fallen into water. Unplug it immediately.
- DO NOT place or store appliance where it can fall or be pulled into a tub or sink.
- DO NOT place in or drop into water or other liquid.
- Keep dry — DO NOT operate in wet or moist conditions.
- Check your air purifier cord and plug connections. Faulty wall outlet connections or loose plugs can cause the outlet or plug to overheat. Be sure the plug fits tightly in the outlet.

WARNING — TO REDUCE THE RISK OF BURNS, FIRE, ELECTRIC SHOCK, OR INJURY TO PERSONS:

- Always unplug the air purifier when not in use.
- Do not operate the air purifier with a damaged cord or plug, or after the air purifier malfunctions, or has been dropped or damaged in any manner. Contact www.medifyair.com for examination, electrical or mechanical adjustment, or repair.
- This air purifier is not intended for use in bathroom, laundry areas, and similar moist indoor locations.
- Do not run the cord under carpeting. Do not cover the cord with throw rugs, runners, or similar coverings.
- Do not route cord under furniture or appliances. Arrange the cord away from traffic areas where it can be tripped over.
- To disconnect the air purifier, first turn controls to the off position, then remove the plug from outlet.
- Do not tilt or move the air purifier while it is in operation. Shut it off and remove the plug from the outlet before moving it.
- Do not insert or allow foreign objects to enter any ventilation or exhaust opening as this may cause an electrical shock or fire, or damage the air purifier.

- Do not block air intakes or exhaust in any manner. Do not use on any soft surface, like a bed, where openings may become blocked.
- Use this air purifier only for its intended use as described in this manual. Any other use not recommended by the manufacturer may cause fire, electrical shock, or injury to persons.
- DO NOT use outdoors.
- This product is intended for household use only.

SAVE THESE IMPORTANT INSTRUCTIONS FOR EASY REFERENCE.

TECHNICAL DATA

- Voltage: 100-240V 50/60Hz
- Rated power: 24W
- Noise level: Min: 28.2dBA, Max: 57.3dBA
- Unit dimensions: 8"H x 8.5"W x 8.5"D
- Unit weight: 2.86 lbs
- Integrated Energy Factor (IEF): 2.7
- Annual Energy Consumption (KW-Hours/year): 125
- EPA Est. No.:88959-CHN-1

STANDARD COVERAGE

CADR: 92 m³/h (54 CFM [smoke])

Effective Area:

101 sq ft every 15 min (4 ACH)

84 sq ft every 12.5 min (4.8 ACH)

68 sq ft every 10 min (6 ACH)

Clean Air Delivery Rate			
Smoke	Pollen	Dust	PM2.5
54 CFM	78 CFM	62 CFM	58 CFM

CONTROL PANEL

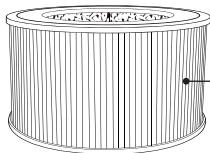
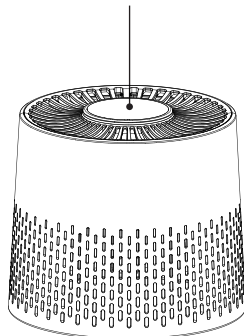

TRUE H13 HEPA/
CARBON FILTER

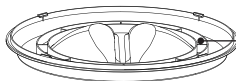

FILTER COVER

CONTROL PANEL

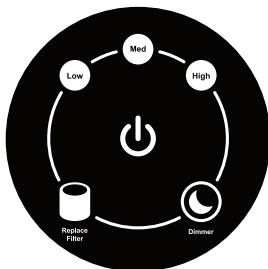

HOW TO USE

This air purifier is used to remove airborne particles from indoor air.

BEFORE TURNING THE UNIT ON

- Take the air purifier out of the box and remove the clear protective plastic bag and also remove clear bag from filter.
- Place the air purifier on a firm, leveled surface and then plug the power cord into a standard AC outlet.

POWER BUTTON AND FAN SPEED SETTINGS

- To turn the air purifier on, press the power  button.
- This air purifier has 3 fan speed settings: low , medium , and high . The higher the fan speed setting, the faster the air will be purified.

Filter Reset

When the accumulated work of the unit reaches a certain time, the filter reset indicator will light up to remind the user to replace the filter.

Reset the accumulated working time of the unit by long pressing the filter reset button  for 3 seconds.

DIMMER

Press the dimmer button  to change the state of the product light, there are 3 states.

- The control panel and light ring light up at the same time;
- The control panel light dimmed and the light ring turns off;
- Turn off the control panel and light ring at the same time.

FILTER REPLACEMENT

REPLACE FILTER LIGHT

The replace filter light illuminates when it is time to replace the true HEPA H13 filter based on the air purifier's hours of use.

REPLACING THE TRUE HEPA H13 FILTER

For optimal performance, replace every 2,500 hours under normal usage conditions. Once the filter has been replaced, press and hold the dimmer  button for 3 seconds to reset the indicator.

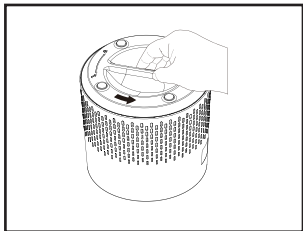

1. Unplug the air purifier. Follow the instructions on the bottom filter cover and rotate to loosen the filter cover.

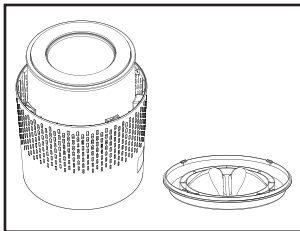

2. Take away the filter cover from the unit.

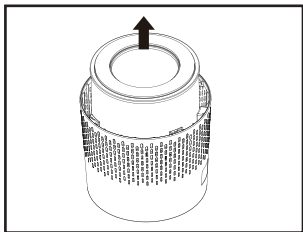

3. Remove the old filter.

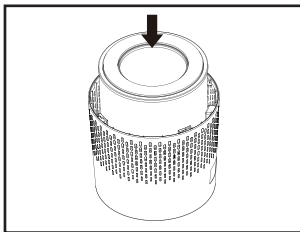

4. Install a new genuine Medify replacement filter.

To purchase genuine Medify replacement True HEPA H13 filters, for model MA-12 visit www.medifyair.com.

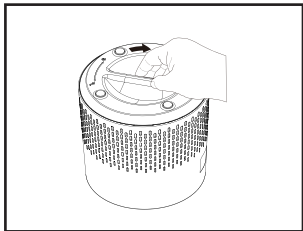

5. Reinstall the filter cover to the product, then rotate to secure the filter cover according to the directions on the filter cover.

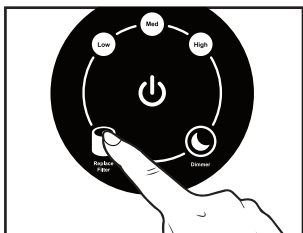

6. Plug the power cord into a standard AC outlet. Press and hold the filter reset button for 3 seconds to reset the indicator.

To purchase genuine Medify replacement filters, visit www.medifyair.com.



This product earned the ENERGY STAR by meeting strict energy efficiency guidelines set by the U.S. EPA. The U.S. EPA does not endorse any manufacturer claims of healthier indoor air from the use of this product. The energy efficiency of this ENERGY STAR qualified model is measured based on a ratio between the model's CADR for dust and the electrical energy it consumes, or CADR/Watt.

TROUBLESHOOTING

PROBLEM	POSSIBLE CAUSE	POSSIBLE SOLUTION
Unit will not operate	Unit is not plugged in	Plug the unit in
	Power button not pressed	Press the power button to turn the power on
	No power to unit	Check circuits, fuses, try a different outlet
Reduced airflow	The back grille may be blocked	Make sure side intakes are not blocked or the front outflow are
	The filter needs to be replaced	Replace the filter
Reduced odor removal	The filter needs to be replaced	Replace the filter
Excessive noise	The unit is not level	Place the unit on a flat and level surface
Replace filter light remains lit after filter replacement	The replace filter indicator needs to be reset	Press and hold the DIMMER button for 3 seconds until the replace filter light turns off

WARRANTY INFORMATION

If you have any additional questions, please contact customer service. All names and trademarks are property of Medify Air. Our company reserves the right to change the product at any time, without prior notice, and the company has no obligation to adjust any products supplied earlier. Please refer to the detailed warranty terms below. To register for the lifetime warranty, please fill out the attached form and mail it to:

Medify Air

150 E. Palmetto Park Road, Suite 200
Boca Raton, Florida 33432

Or complete the lifetime warranty registration available on our website (preferred method):
www.medifyair.com

LIFETIME WARRANTY

Medify guarantees your Medify Air Purifier to be free of defects in material or workmanship for a lifetime period, provided you have completed and returned your warranty registration to Medify Air within the first 30 days of purchase, and that the filters are replaced with original and genuine Medify Air replacement filters at least once every three to four (3-4) months or after 2,500 hours of use. Within the first 30 days, Medify Air will replace the defective unit at no charge to you and reimburse you for any shipping charges. After 30 days, Medify Air's obligation and liability under this Lifetime Warranty is dependent on your use of our genuine filters, purchased on our website or from our authorized resellers, which can be found on our website. Prohibited use beyond power. Can only use a 220v unit with a 220v power supply. Can only use a 110v unit with a 110v power supply. You can break or ruin the circuit boards if you plug a 110v plug into a 220v power supply.

Our Lifetime Warranty remains in effect as long as:

1. You submit your warranty registration to Medify Air within 30 days of purchase.
2. *You change filters with genuine and original Medify Air replacement filters at least once every three to four (3-4) months or after 2,500 hours of use (whichever comes first). Using anything other than a Genuine Medify filter will void your limited lifetime warranty
3. You use a proper power supply based on voltage: 110-120V.
4. There is no evidence of tampering, mishandling, neglect, accidental damage, modification, and/or repair done to the Medify Air purifier by anyone other than authorized Medify Air service personnel.

This Lifetime Warranty is provided by:

Medify Air

150 E. Palmetto Park Road, Suite 200
Boca Raton, Florida 33432

www.medifyair.com
info@medifyair.com
(888) 258-1008

Please visit our website for
details on efficacy test data:
medifyair.com/pages/reports

To purchase genuine Medify replacement filters, visit www.medifyair.com.