

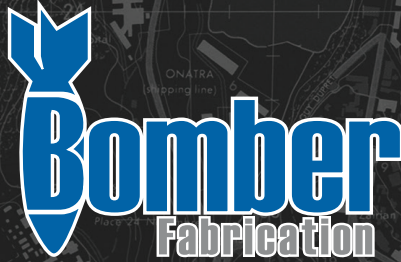

INSTRUCTION MANUAL
AXI03016T1/T2



RR10™ BOMBER

1/10th SCALE ELECTRIC 4WD RTR

ROCK RACER SERIES



HORIZON
H O B B Y

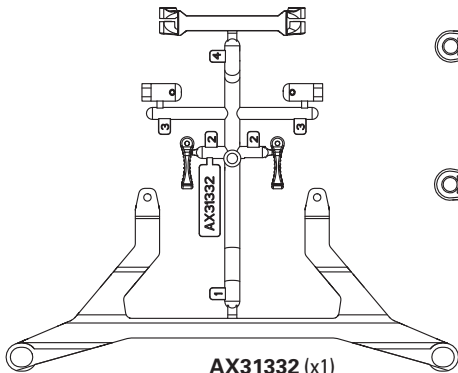

AX31332 (x1)
 RR10 Battery Tray Chassis Components 2
 RR10 Akkufach Karosseriebauteile 2
 Composants du châssis du support de batterie RR10 2
 2 componenti telaio supporto batteria RR10

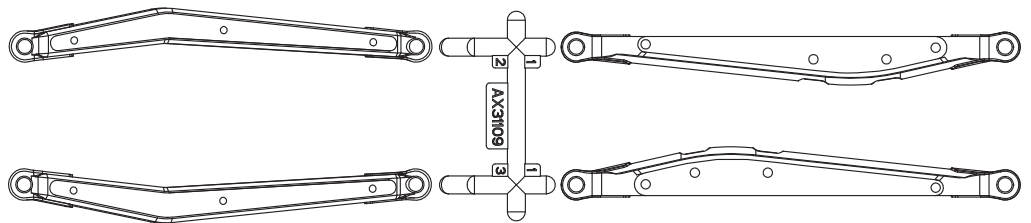

AX31109 (x1)
 Yeti™ Rear 4 Link Set
 Yeti™ 4-gliedriger Gelenksatz hinten
 Ensemble de 4 bras arrière Yeti™
 Set 4 braccetti Yeti™ posteriore

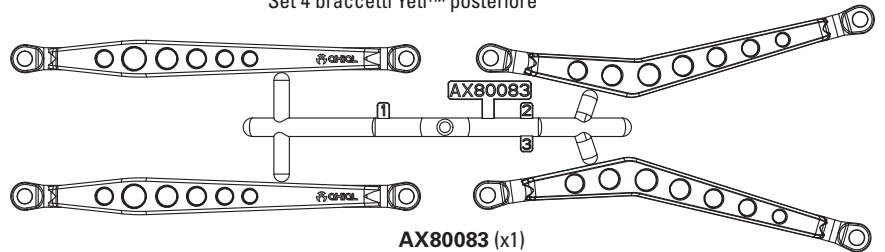

AX80083 (x1)
 Wraith Links Set
 Wraith-Gestängesatz
 Ensemble de bras Wraith
 Set leveraggi Wraith

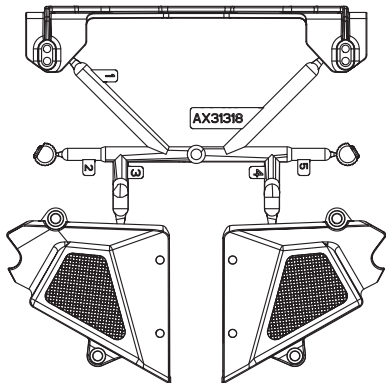

AX31318 (x1)
 RR10 Battery Tray Chassis Components
 RR10 Akkufach Karosseriebauteile
 Composants du châssis du support de batterie RR10
 Componenti telaio supporto batteria RR10

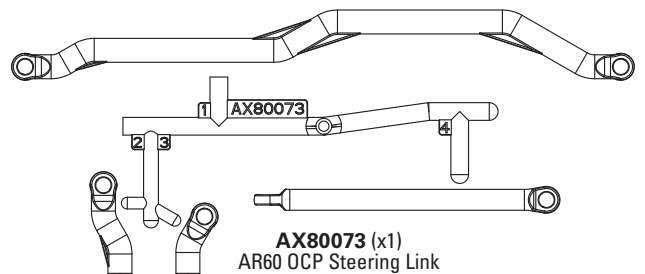

AX80073 (x1)
 AR60 OCP Steering Link
 AR60 OCP-Lenkstange
 Tringlerie de direction AR60 OCP
 Braccetto sterzo AR60 OCP



AX31354 (x1)
 AR60 Heavy Duty C-Hub Carrier
 AR60 robuster C-Nabenträger
 Support de moyeu en C haute résistance AR60
 Supporto caster block Heavy Duty AR60



AX80002 (x2)
 Diff Case - Small
 Differentialgehäuse - Klein
 Boîtier de différentiel - Petit
 Scatola diff. - Piccola

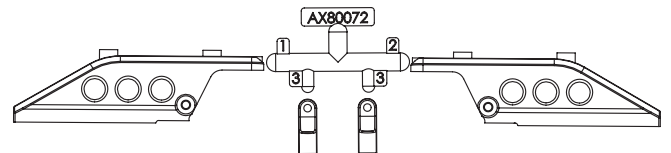

AX80072 (x1)
 Offset Axle 4 Link Mount
 Achse mit viergliedrigem Gestänge und Versatz
 Support d'essieu déporté à 4 bras
 Supporto braccetti 4-link offset assale

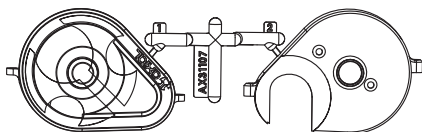

AX31107 (x1)
 2-Speed Hi/Lo Transmission Spur Gear Cover
 2-Geschwindigkeiten Hi/Lo Getriebe Stirnradabdeckung
 Cache de l'engrenage cylindrique de la transmission élevé/faible 2 vitesses
 Carter ingranaggi trasmissione 2 velocità alta/bassa (HI/LO)

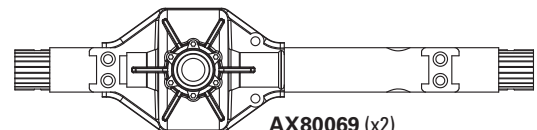

AX80069 (x2)
 Offset Axle Housing
 Achsgehäuse mit Versatz
 Carter d'essieu déporté
 Carcassa assale offset

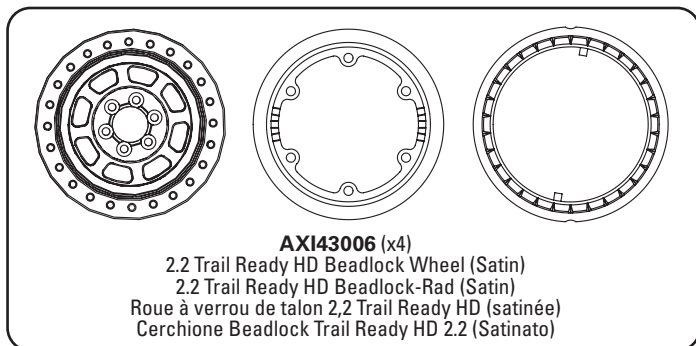

AXI43006 (x4)
 2.2 Trail Ready HD Beadlock Wheel (Satin)
 2.2 Trail Ready HD Beadlock-Rad (Satin)
 Roue à verrou de talon 2,2 Trail Ready HD (satinée)
 Cerchione Beadlock Trail Ready HD 2.2 (Satinato)

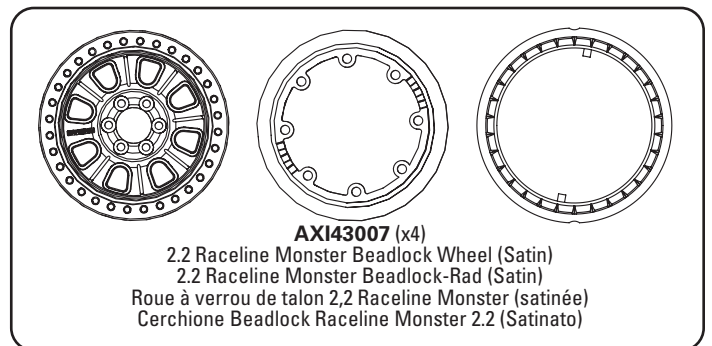

AXI43007 (x4)
 2.2 Raceline Monster Beadlock Wheel (Satin)
 2.2 Raceline Monster Beadlock-Rad (Satin)
 Roue à verrou de talon 2,2 Raceline Monster (satinée)
 Cerchione Beadlock Raceline Monster 2.2 (Satinato)

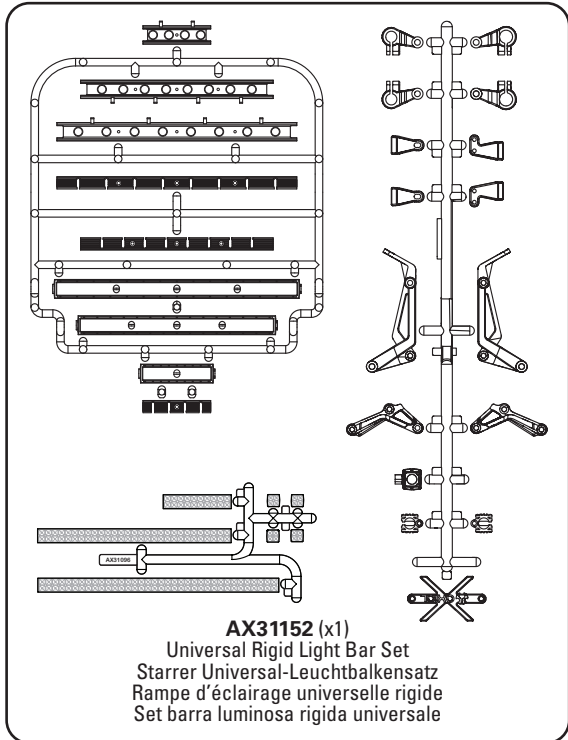

AX31152 (x1)
 Universal Rigid Light Bar Set
 Starrer Universal-Leuchtbalkensatz
 Rampe d'éclairage universelle rigide
 Set barra luminosa rigida universale

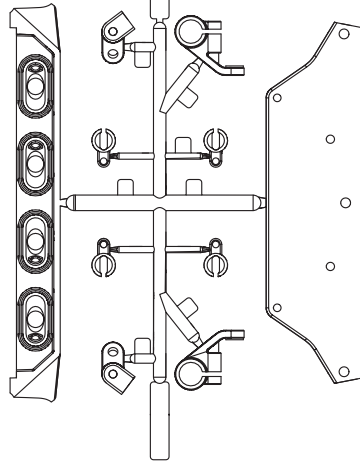

AXI230014 (x1)
 RR10 Rear Light Bar Mount
 RR10 Hintere Leuchtbalkenhalterung
 Support de rampe d'éclairage arrière RR10
 Supporto barra luminosa posteriore RR10

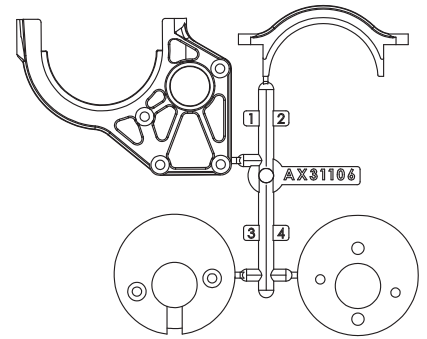

AX31106 (x1)
 2-Speed Hi/Lo Transmission Motor Mount
 2-Geschwindigkeiten Hi/Lo Getriebe Motorhalterung
 Support moteur de la transmission élevé/faible 2 vitesses
 Supporto motore trasmissione 2 velocità alta/bassa (HI/LO)

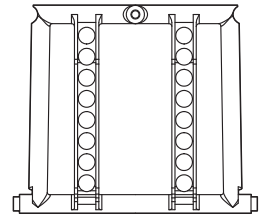

AX31065 (x1)
 Spur Gear 32P 64T
 Stirnrad 32P 64T
 Engrenage cylindrique 32P 64T
 Corona 32P 64T

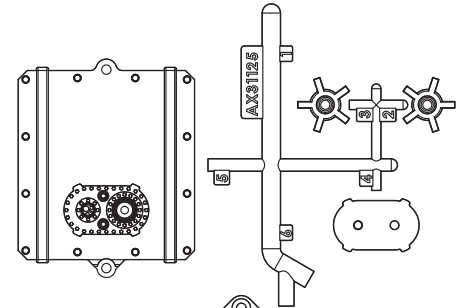
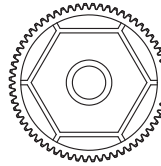

AX31125 (x1)
 Yeti™ Fuel Cell
 Yeti™ Treibstofftank
 Réservoir de carburant Yeti™
 Cella carburante Yeti™

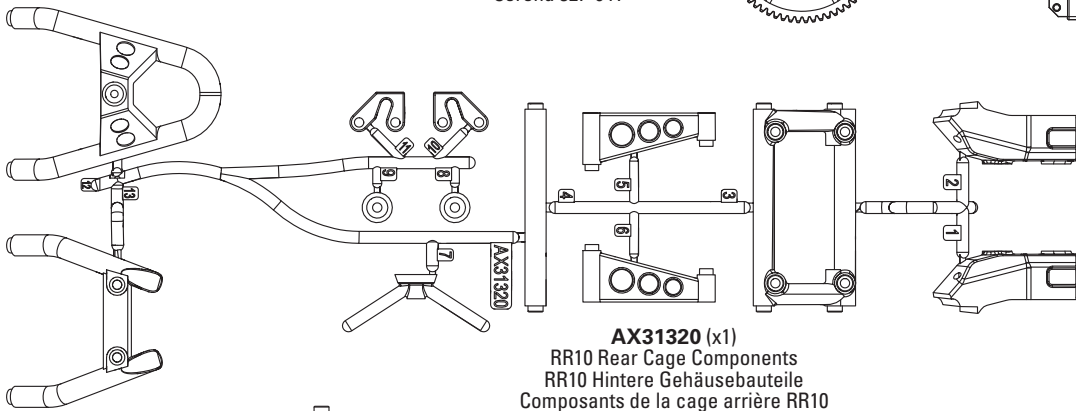

AX31320 (x1)
 RR10 Rear Cage Components
 RR10 Hintere Gehäusebauteile
 Composants de la cage arrière RR10
 Componenti custodia posteriore RR10

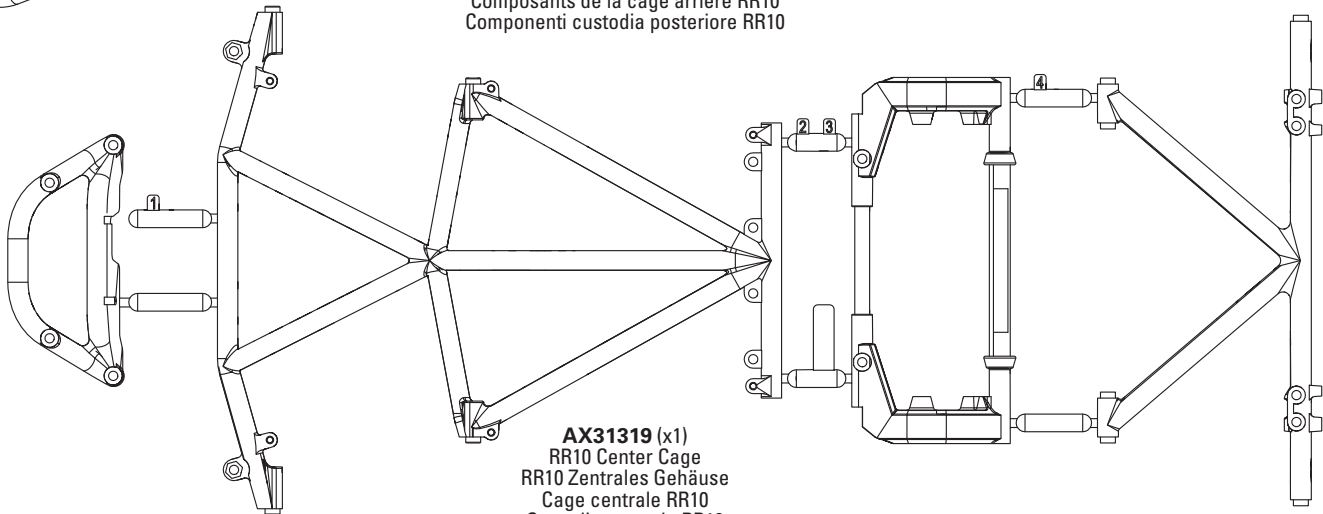

AX31319 (x1)
 RR10 Center Cage
 RR10 Zentrales Gehäuse
 Cage centrale RR10
 Custodia centrale RR10

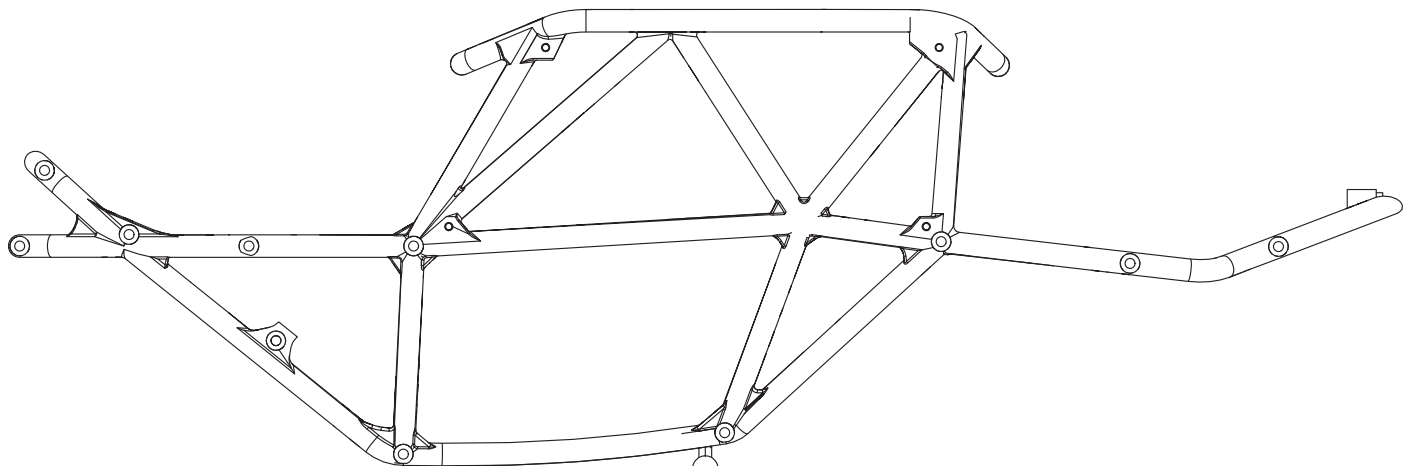

AX31322(x1)
 RR10 Cage Sides (Left and Right)
 RR10 Gehäuseseiten (Links und Rechts)
 Côtés de la cage RR10 (gauche et droite)
 Scocca di protezione laterale (dx e sx) RR10

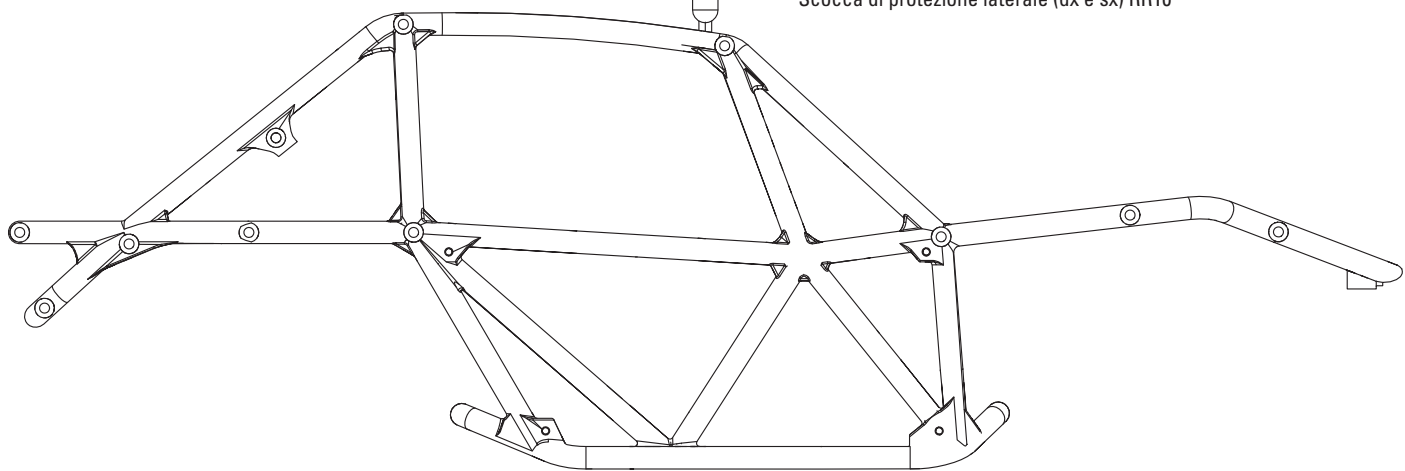

AX31321(x1)
 RR10 Cage Lower Rails
 RR10 Gehäuse untere Schienen
 Rails inférieurs de la cage RR10
 Guide inferiori custodia RR10

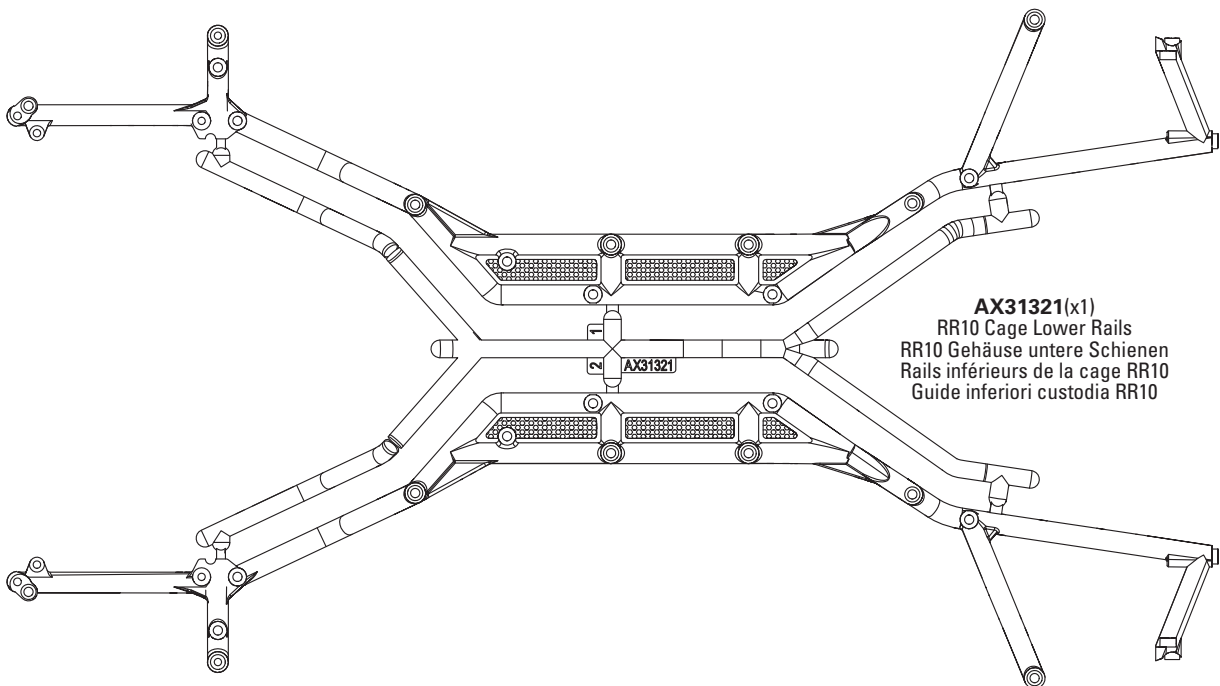

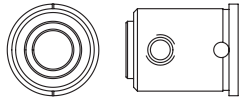
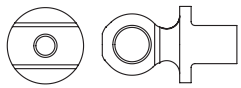

AX31148 (x4)
WB8-HD Driveshaft coupler set
WB8-HD-Antriebswellenkupplungssatz
Ensemble de couplage d'arbre de transmission WB8-HD
Set accoppiamento albero trasmissione WB8-HD

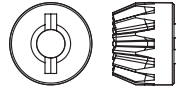
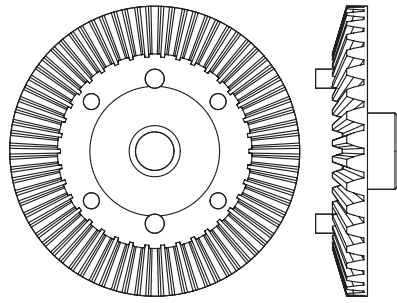

AX30392 (x2)
Bevel Gear Set - 38T/13T
Kegelradgetriebesatz - 38T/13T
Ensemble d'engrenages coniques - 38T/13T
Set ingranaggi conici - 38T/13T



AX31314 (x4)
Aluminum Shock Body 12x47.5mm
Aluminium Stoßdämpfergehäuse 12 x 47,5 mm
Aluminium Carrosserie d'amortisseurs en aluminium 12 x 47,5 mm
Corpo ammortizzatore in alluminio 12x47,5 mm

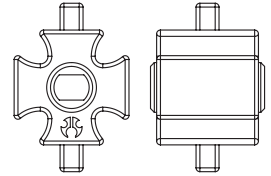

AX30500 (x2)
Heavy Duty Locker
Robuste Sicherung
Blocage haute résistance
Blocco differenziale Heavy Duty

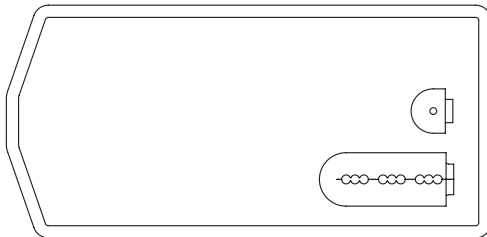

AX31083 (x1)
Radio box seals
Funkbox-Dichtungen
Joints du boîtier de radio
Guarnizioni vano radiocomando

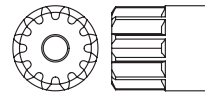

AX30723 (x1)
Pinion 32DP 12T
Zahnradgetriebe, 32DP, 12T
Engrenage à pignons, 32DP 12T
Pignone 32DP, 12T,

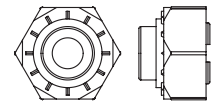

AX30429 (x4)
Narrow 12mm aluminum hub
Schmale Aluminium-Nabe, 12 mm
Moyeu étroit en aluminium de 12 mm
Mozzo stretto in alluminio, 12 mm



AXI231007 (x1)
Metal Servo Horn (23T)
Metallgetriebehorn (23T)
Renvoi du servo métallique (23T)
Servo squadretta in metallo (23 T)



AX30408 (x2)
Steel Input Shaft 5x29mm
Stahl-Eingangswelle 5 x 29 mm
Arbre d'entrée en acier 5 x 29 mm
Albero di entrata in acciaio 5x29 mm

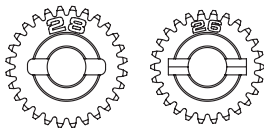

AX31130 (x1)
High Speed Transmission Gear Set (48P 26T, 48P 28T)
Hochgeschwindigkeits-Getriebesatz (48P 26T, 48P 28T)
Ensemble d'engrenages de transmission grande vitesse (48P 26T, 48P 28T)
Set ingranaggi trasmissione alta velocità (48P 26T, 48P 28T)

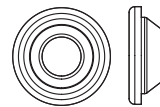

AX30112 (x4)
Shock Diaphragm 13x4.5mm
Stoßdämpfermembran 13 x 4,5 mm
Membrane d'amortisseur 13 x 4,5 mm
Diaframma ammortizzatore 13x4,5 mm



AX30413 (x1)
Slipper spring, 8,5 x 12
Gleitfeder, 8,5 x 12
Ressort de sabot, 8,5 x 12
Molla pattino, 8,5x12

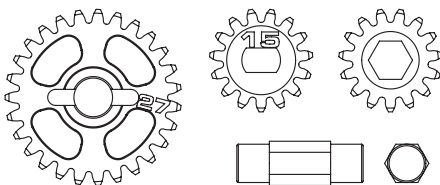

AX31131 (x1)
T-Case Gear Set
T-Case-Getriebesatz
Ensemble d'engrenages de boîte de transfert
Set ingranaggi scatola a T



AX30113 (x4)
Rubber Bump Stop 3.6x7x4mm
Gummianschlag 3,6 x 7 x 4 mm
Butée en caoutchouc 3,6 x 7 x 4 mm
Fine corsa in gomma 3,6x7x4 mm

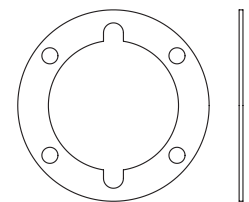

AX30385 (x2)
Diff Gasket 16x25x0.5mm
Differentialdichtung 16 x 25 x 0,5 mm
Joint de différentiel 16 x 25 x 0,5 mm
Guarnizione differenziale 16x25x0,5 mm

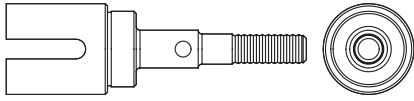

AX30368 (x2)
 Axle, 6 x 39mm
 Achse, 6 x 39 mm
 Essieu, 6 x 39 mm
 Assale ,6 x 39 mm

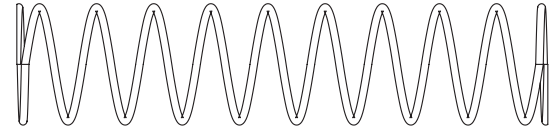

AX30224 (x2) / **AX31315 (Blue)** (x2)
 Spring 14x70mm 1.43 lbs/in
 Feder 14 x 70 mm 1,43 lbs/in
 Ressort 14 x 70 mm 1,43 lb/po
 Molla 14x70 mm 1,43 lbs/in

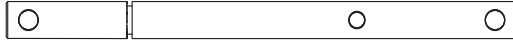

AX31313 (x1)
 Transfer Case Output Shaft (5x69mm)
 Transfergehäuse Antriebswelle (5 x 69 mm)
 Arbre de sortie de la boîte de transfert (5 x 69 mm)
 Albero uscita scatola di trasferimento (5x69 mm)

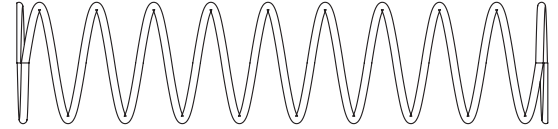

AX30221 (x2) / **AX31336 (Blue)** (x2)
 Spring 14x70mm 3.27 lbs/in
 Feder 14 x 70 mm 3,27 lbs/in
 Ressort 14 x 70 mm 3,27 lb/po
 Molla 14x70 mm 3,27 lbs/in

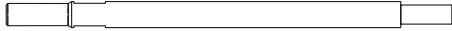

AX30155 (x4)
 Shock Shaft 3x59.5mm
 Kolbenstange, 3 x 59.5 mm
 Bras d'amortisseur, 3 x 59.5 mm
 Albero ammortizzatore, 3x59.5 mm

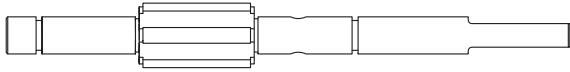

AX31129 (x1)
 2-Speed Hi/Lo Transmission Bottom Shaft (5x75mm)
 2-Geschwindigkeiten Hi/Lo untere Getriebewelle (5 x 75 mm)
 Arbre inférieur de la transmission élevé/faible 2 vitesses (5 x 75 mm)
 Albero inferiore trasmissione 2 velocità alta/bassa (HI/LO) (5x75 mm)

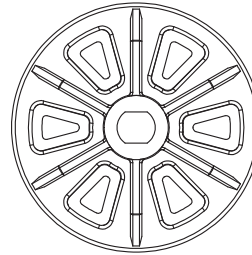

AX31067 (x1)
 Slipper Plate
 Gleitplatte
 Plaque de sabot
 Piastra pattino

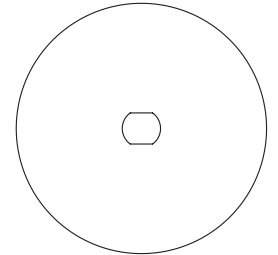

AX31026 (x2)
 Slipper plate washer, 33 x 5 x 1.5mm
 Gleitplattenunterlegscheibe, 33 x 5 x 1,5 mm
 Rondelle de plaque de sabot, 33 x 5 x 1,5 mm
 Rondella piastra pattino, 33x5x1,5 mm

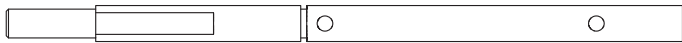

AX31127 (x1)
 2-Speed Hi/Lo Transmission Top Shaft (5x91mm)
 2-Geschwindigkeiten Hi/Lo obere Getriebewelle (5 x 91 mm)
 Arbre supérieur de la transmission élevé/faible 2 vitesses (5 x 91 mm)
 Albero superiore trasmissione 2 velocità alta/bassa (HI/LO) (5x91 mm)

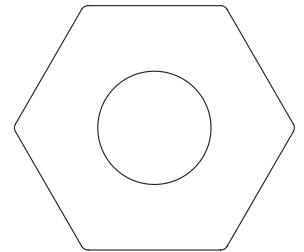

AX31068 (x2)
 Slipper pad, 32.8 x 15.2 x 1mm
 Gleitkissen 32,8 x 15,2 x 1 mm
 Sabot de piston, 32,8 x 15,2 x 1 mm
 Piastra guida, 32,8x15,2x1 mm

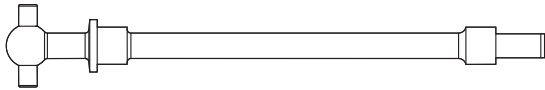

AX30419 (x1)
 AR60 OCP Front Dogbone 7x69mm
 AR60 OCP Vorderes Dogbone 7 x 69 mm
 Dogbone avant AR60 OCP 7 x 69 mm
 Cardano anteriore AR60 OCP 7x69 mm

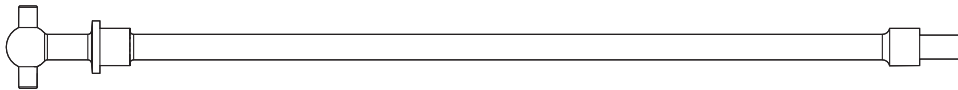

AX30419 (x1)
 AR60 OCP Front Dogbone 7x125mm
 AR60 OCP Vorderes Dogbone 7 x 125 mm
 Dogbone avant AR60 OCP 7 x 125 mm
 Cardano anteriore AR60 OCP 7x125 mm

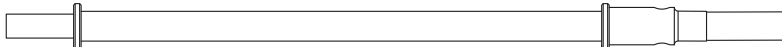

AX30776 (x1)
 AR60 OCP Rear Axle 6x104.2mm
 AR60 OCP Hinterachse 6 x 104,2 mm
 Essieu arrière AR60 OCP 6 x 104,2 mm
 Assale posteriore AR60 OCP 6x104,2 mm



AX30776 (x1)
 AR60 OCP Rear Axle 6x160.2mm
 AR60 OCP Hinterachse 6 x 160,2 mm
 Essieu arrière AR60 OCP 6 x 160,2 mm
 Assale posteriore AR60 OCP 6x160,2 mm



AX30163 (x5)
Pin 2x10mm
Stift 2 x 10 mm
Goupille 2 x 10 mm
Perno 2 x 10 mm

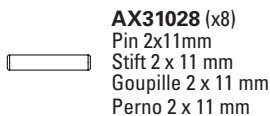

AX31028 (x8)
Pin 2x11mm
Stift 2 x 11 mm
Goupille 2 x 11 mm
Perno 2 x 11 mm



AXA1393 (x2)
E2.5 e-clip
E2.5 E-Clip
E-clip E2.5
E-clip E2.5

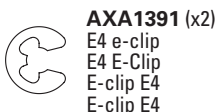

AXA1391 (x2)
E4 e-clip
E4 E-Clip
E-clip E4
E-clip E4



AXA1045 (x1)
M4 Nylon Lock Nut
M4 Nylon-Feststellmutter
Contre-écrou en nylon M4
Controdado nylon M4



AX31250 (x4)
M4 Serrated Nylon Lock Nut
Feststellflanschmutter (schwarz)
Contre-écrou en nylon strié (noir) M4
Controdado dentato nylon (nero) M4

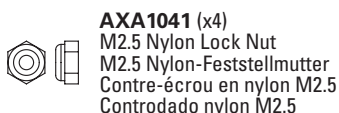

AXA1041 (x4)
M2.5 Nylon Lock Nut
M2.5 Nylon-Feststellmutter
Contre-écrou en nylon M2.5
Controdado nylon M2.5

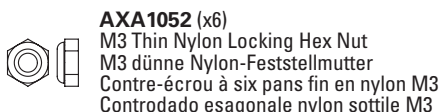

AXA1052 (x6)
M3 Thin Nylon Locking Hex Nut
M3 dünne Nylon-Feststellmutter
Contre-écrou à six pans fin en nylon M3
Controdado esagonale nylon sottile M3



AXA1053 (x3)
M3 Nylon Lock Nut
M3 Nylon-Feststellmutter
Contre-écrou en nylon M3
Controdado nylon M3

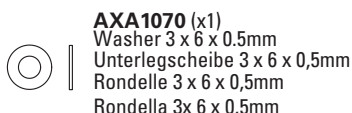

AXA1070 (x1)
Washer 3 x 6 x 0.5mm
Unterlegscheibe 3 x 6 x 0,5mm
Rondelle 3 x 6 x 0,5mm
Rondella 3x 6 x 0,5mm

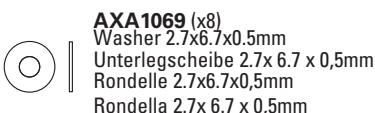

AXA1069 (x8)
Washer 2.7x6.7x0.5mm
Unterlegscheibe 2.7x 6.7 x 0,5mm
Rondelle 2.7x6.7x0,5mm
Rondella 2.7x 6.7 x 0,5mm



AXA1071 (x2)
Washer 4x8x0.5mm
Unterlegscheibe 4x 8 x 0,5mm
Rondelle 4x8x0,5mm
Rondella 4x 8 x 0,5mm



AXA1202 (x8)
O-Ring 3.5 x 2mm
O-Ring 3,5 x 2mm
Joint torique 3,5 x 2mm
O-Ring 3.5 x 2mm

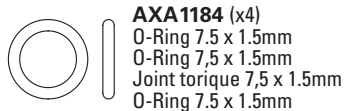

AXA1184 (x4)
O-Ring 7.5 x 1.5mm
O-Ring 7,5 x 1.5mm
Joint torique 7,5 x 1.5mm
O-Ring 7.5 x 1.5mm



AXA1221 (x20)
Bearing 5x11x4mm
Lager 5 x 11 x 4 mm
Roulement 5 x 11 x 4 mm
Cuscinetto 5x11x4 mm



AXA1230 (x6)
Bearing 10x15x4mm
Lager 10 x 15 x 4 mm
Roulement 10 x 15 x 4 mm
Cuscinetto 10x15x4 mm



AXA180 (x12)
M3x3mm Set Screw
M3 x 3 mm Schraubensatz
Vis de fixation M3 x 3 mm
Vite di arresto M3x3 mm



AXA291 (x1)
M4x4mm Set Screw
M4 x 4 mm Schraubensatz
Vis de fixation M4 x 4 mm
Vite di arresto M4x4 mm



AXA186 (x8)
M3x16mm Set Screw
M3 x 16 mm Schraubensatz
Vis de fixation M3 x 16 mm
Vite di arresto M3x16 mm



AXA0187 (x4)
M3x20mm Set Screw
M3 x 20 mm Schraubensatz
Vis de fixation M3 x 20 mm
Vite di arresto M3x20 mm

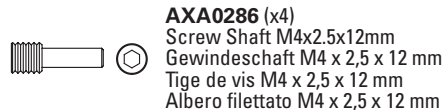

AXA0286 (x4)
Screw Shaft M4x2.5x12mm
Gewindenschaft M4 x 2,5 x 12 mm
Tige de vis M4 x 2,5 x 12 mm
Albero filettato M4 x 2,5 x 12 mm



AXA013 (x5)
M2x6mm Hex Socket Cap Head
M2 x 6 mm Sechskant-Inbusschraube
Douille à six pans d'assemblage creuse M2 x 6 mm
Vite testa cilindrica con esagono incassato M2x6 mm



AXA015 (x16)
M2x10mm Hex Socket Cap Head
M2 x 10 mm Sechskant-Inbusschraube
Douille à six pans d'assemblage creuse M2 x 10 mm
Vite testa cilindrica con esagono incassato M2x10 mm

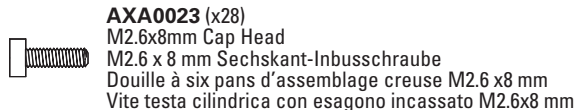

AXA0023 (x28)
M2.6x8mm Cap Head
M2.6 x 8 mm Sechskant-Inbusschraube
Douille à six pans d'assemblage creuse M2.6 x 8 mm
Vite testa cilindrica con esagono incassato M2.6x8 mm

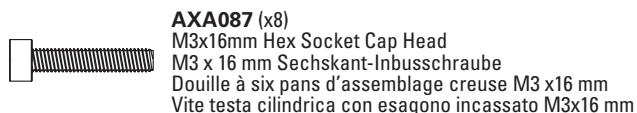

AXA087 (x8)
M3x16mm Hex Socket Cap Head
M3 x 16 mm Sechskant-Inbusschraube
Douille à six pans d'assemblage creuse M3 x 16 mm
Vite testa cilindrica con esagono incassato M3x16 mm

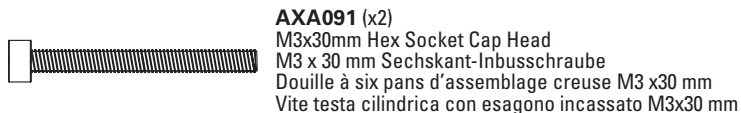

AXA091 (x2)
M3x30mm Hex Socket Cap Head
M3 x 30 mm Sechskant-Inbusschraube
Douille à six pans d'assemblage creuse M3 x 30 mm
Vite testa cilindrica con esagono incassato M3x30 mm

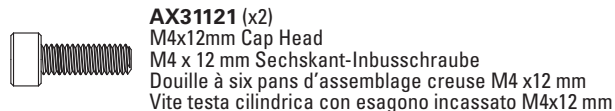

AX31121 (x2)
M4x12mm Cap Head
M4 x 12 mm Sechskant-Inbusschraube
Douille à six pans d'assemblage creuse M4 x 12 mm
Vite testa cilindrica con esagono incassato M4x12 mm



AX31280 (x16)
M2.6x6mm Hex Socket Button Head
M2.6x6mm Sechskant-Rundkopf
Douille à six pans à tête bombée M2.6x6mm
Vite testa tonda con esagono incassato M2.6x6mm



AXA0113 (x11)
M3x6mm Hex Socket Button Head
M3 x 6 mm Sechskant-Rundkopf
Douille à six pans à tête bombée M3 x 6 mm
Vite testa tonda con esagono incassato M3x6 mm



AXA114 (x6)
M3x8mm Hex Socket Button Head
M3 x 8 mm Sechskant-Rundkopf
Douille à six pans à tête bombée M3 x 8 mm
Vite testa tonda con esagono incassato M3x8 mm



AXA115 (x22)
M3x10mm Hex Socket Button Head
M3 x 10 mm Sechskant-Rundkopf
Douille à six pans à tête bombée M3 x 10 mm
Vite testa tonda con esagono incassato M3x10 mm



AXA116 (x49)
M3x12mm Hex Socket Button Head
M3 x 12 mm Sechskant-Rundkopf
Douille à six pans à tête bombée M3 x 12 mm
Vite testa tonda con esagono incassato M3x12 mm



AXA117 (x17)
M3x15mm Hex Socket Button Head
M3 x 15 mm Sechskant-Rundkopf
Douille à six pans à tête bombée M3 x 15 mm
Vite testa tonda con esagono incassato M3x15 mm



AXA118 (x46)
M3x18mm Hex Socket Button Head
M3 x 18 mm Sechskant-Rundkopf
Douille à six pans à tête bombée M3 x 18 mm
Vite testa tonda con esagono incassato M3x18 mm



AXA119 (x1)
M3x20mm Hex Socket Button Head
M3 x 20 mm Sechskant-Rundkopf
Douille à six pans à tête bombée M3 x 20 mm
Vite testa tonda con esagono incassato M3x20 mm



AXA121 (x4)
M3x30mm Hex Socket Button Head
M3 x 30 mm Sechskant-Rundkopf
Douille à six pans à tête bombée M3 x 30 mm
Vite testa tonda con esagono incassato M3x30 mm



AXA144 (x10)
M3x8mm Hex Socket Flat Head
M3 x 8 mm Sechskant-Flachkopf
Douille à six pans à tête plate M3 x 8 mm
Vite testa piana con esagono incassato M3x8 mm



AX31185 (x2)
M3x10mm Hex Socket Flat Head
M3 x 10 mm Sechskant-Flachkopf
Douille à six pans à tête plate M3 x 10 mm
Vite testa piana con esagono incassato M3x10 mm



AXA146 (x17)
M3x12mm Hex Socket Flat Head
M3 x 12 mm Sechskant-Flachkopf
Douille à six pans à tête plate M3 x 12 mm
Vite testa piana con esagono incassato M3x12 mm



AXA0147 (x1)
M3x16mm Hex Socket Flat Head
M3 x 16 mm Sechskant-Flachkopf
Douille à six pans à tête plate M3 x 16 mm
Vite testa piana con esagono incassato M3x16 mm



AXA148 (x8)
M3x18mm Hex Socket Flat Head
M3 x 18 mm Sechskant-Flachkopf
Douille à six pans à tête plate M3 x 18 mm
Vite testa piana con esagono incassato M3x18 mm



AXA150 (x3)
M3x25mm Hex Socket Flat Head
M3 x 25 mm Sechskant-Flachkopf
Douille à six pans à tête plate M3 x 25 mm
Vite testa piana con esagono incassato M3x25 mm



AXA0413 (x2)
M2.6x8mm Hex Socket Tapping Flat Head
M2.6 x 8 mm Sechskant-Flachkopf-Blechschaube
Douille à six pans à tête plate autotaraudeuse M2.6 x 8 mm
Vite autofilettante testa piana con esagono incassato M2.6x8 mm



AXA436 (x1)
M3x12mm Button Head Tapping
M3 x 12 mm Rundkopf-Blechschaube
Vis autotaraudeuse à tête bombée M3 x 12 mm
Vite autofilettante testa tonda M3x12 mm



AXA0439 (x2)
M3x20mm Button Head Tapping
M3 x 20 mm Rundkopf-Blechschaube
Vis autotaraudeuse à tête bombée M3 x 20 mm
Vite autofilettante testa tonda M3x20 mm



AXA441 (x4)
M3x30mm Hex Socket Tapping Button Head
M3 x 30 mm Rundkopf-Blechschaube
Vis autotaraudeuse à tête bombée M3 x 30 mm
Vite autofilettante testa tonda M3x30 mm



AXA0109 (x4)
M3x10mm Oversized Flat Hex Socket
M3 x 10 mm übergroßer Sechskant-Flachkopf
Douille à six pans à tête plate surdimensionnée M3 x 10 mm
Vite testa piana con esagono incassato sovramisura M3x10 mm



AX30450 (x4)
Flange Pipe 3x4.5x5.5
Flanschrohr 3 x 4,5 x 5,5
Tubulure bridée 3 x 4,5 x 5,5
Tubo flangiato 3x4,5x5,5

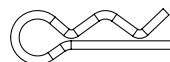

AXA1059 (x2)
6mm Body Clip
6 mm Gehäuseklemme
Clip de carrosserie 6 mm
Clip 6 mm

CHASSIS
KAROSSERIE
CHÁSSIS
TELAIO



**FRONT AXLE
VORDERACHSE
ESSIEU AVANT
ASSALE ANTERIORE**

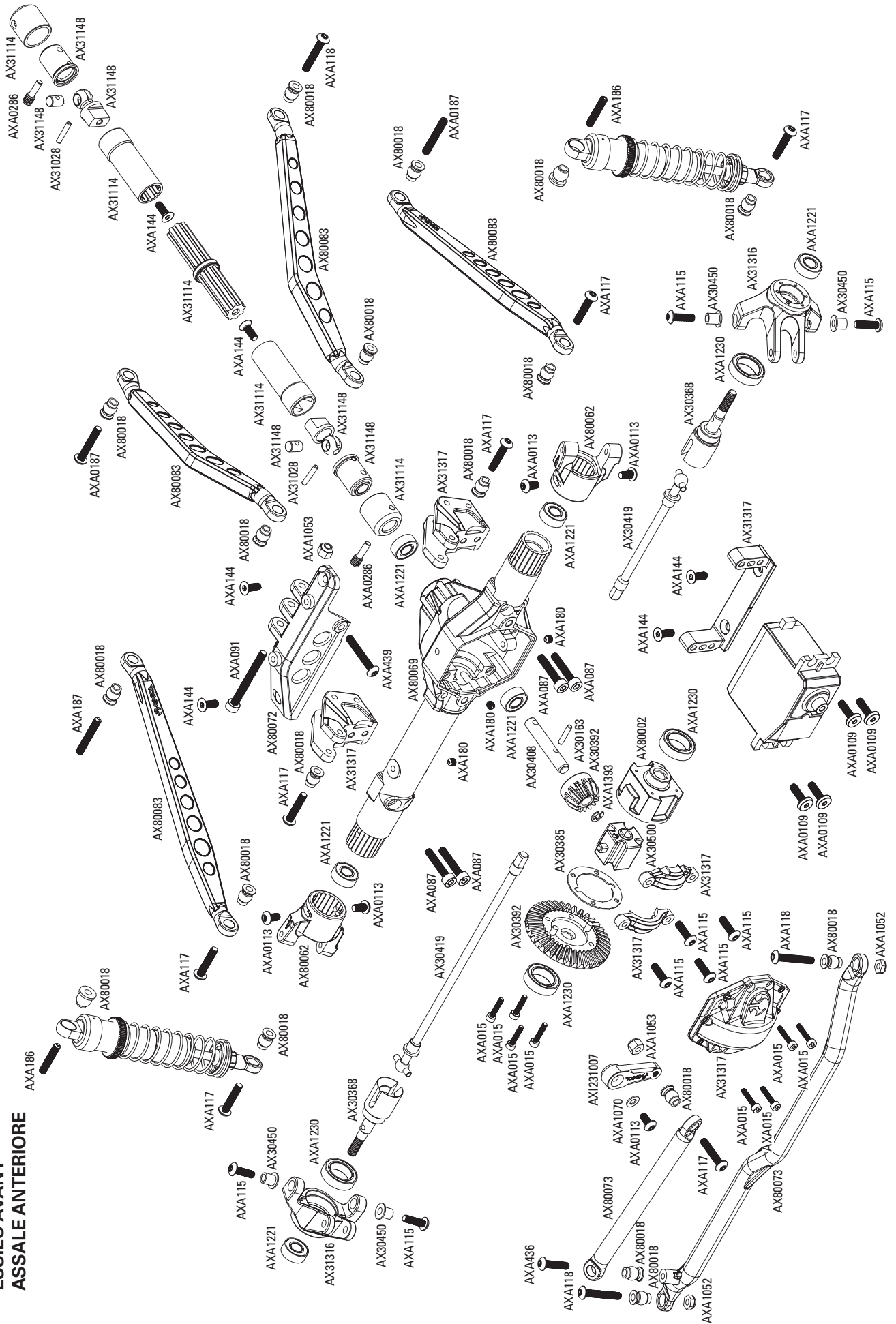



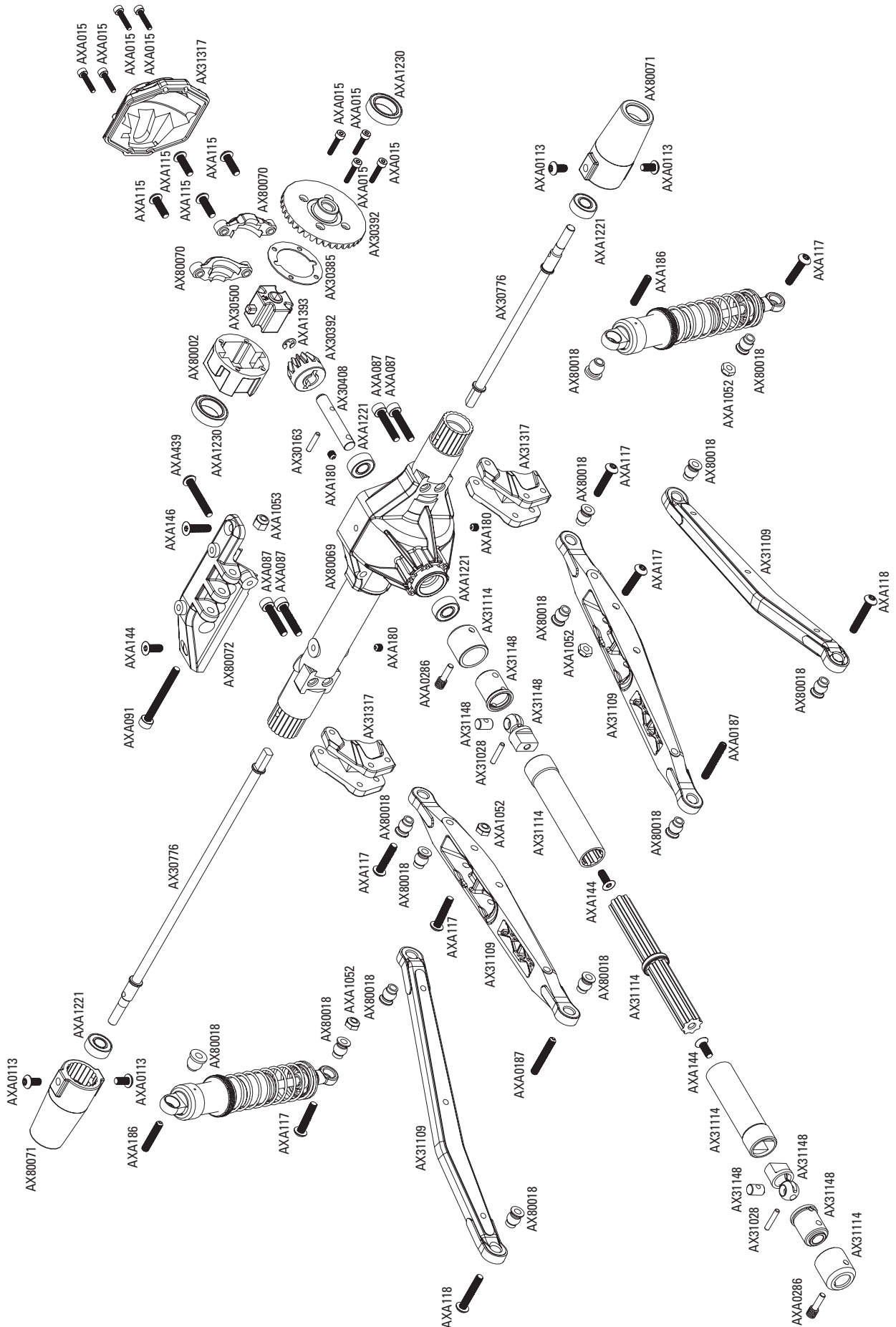



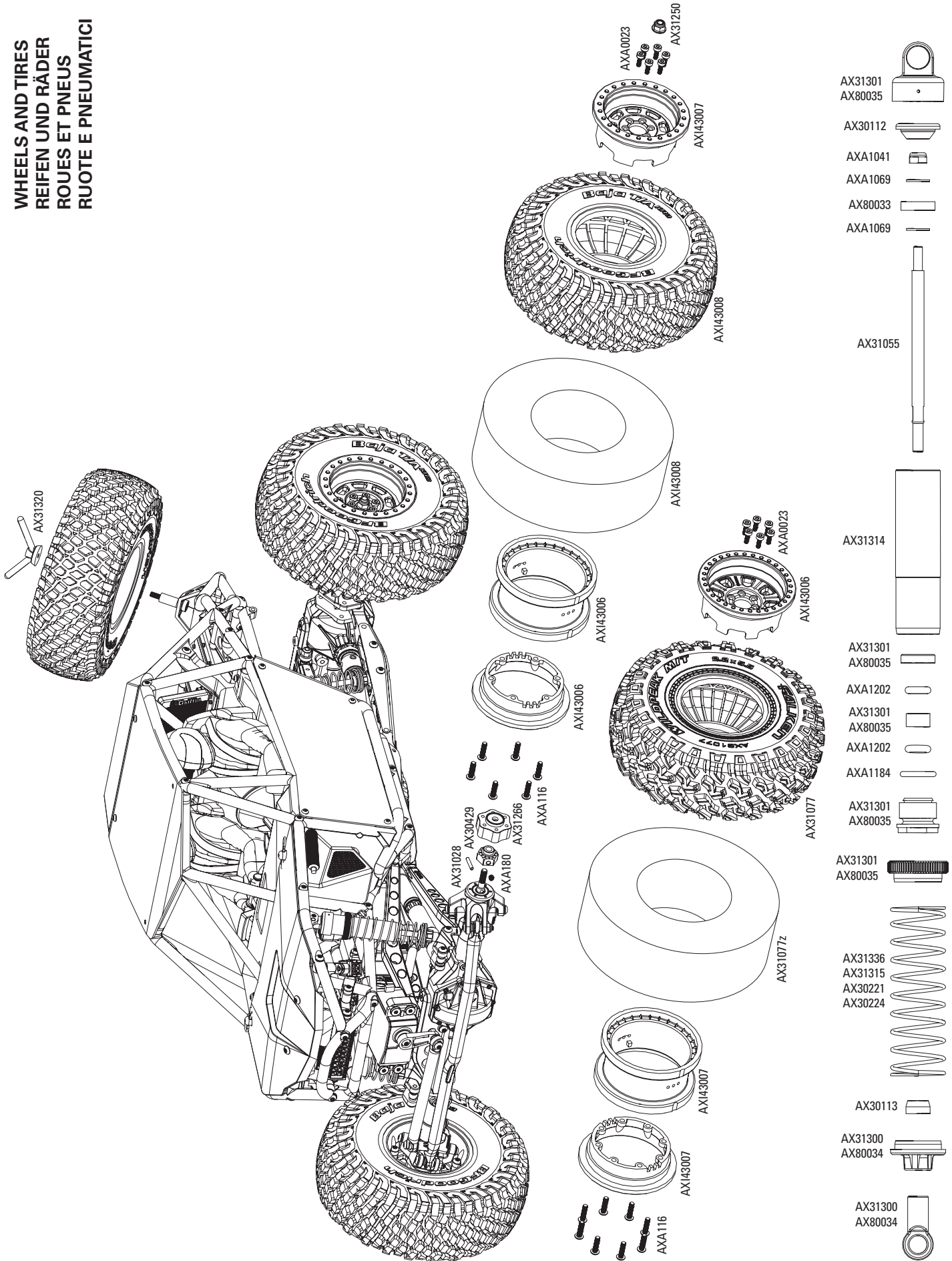

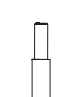
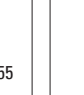
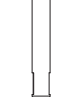
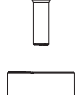
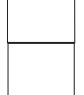
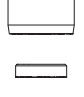
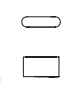
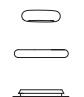

**REAR AXLE
HINTERACHSE
ESSEU ARRIÈRE
ASSALE POSTERIORE**

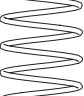

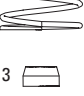
WHEELS AND TIRES
 REIFEN UND RÄDER
 ROUES ET PNEUS
 RUOTE E PNEUMATICI

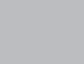

- AX31301 
- AX80035 
- AX30112 
- AXA1041 
- AXA1069 
- AX80033 
- AXA1069 
- AX31055 
- AX31314 
- AX31301 
- AX80035 
- AXA1202 
- AX31301 
- AX80035 
- AXA1184 
- AX31301 
- AX80035 
- AX31336 
- AX31315 
- AX30221 
- AX30224 
- AX30113
- AX31300
- AX80034
- AX31300
- AX80034

PARTS LISTS // TEILELISTEN // LISTE DES PIÈCES // ELENCO COMPONENTI

Part #	Description	Beschreibung	Description	Descrizione
AX30113	Rubber Bump Stop 3.6x7x4 (6pcs)	Gummianschlag 3,6 x 7 x 4 mm	Butée en caoutchouc 3,6 x 7 x 4 mm	Fine corsa in gomma 3,6x7x4 mm
AX30155	Shock Shaft 3x59.5 (2pcs)	Kolbenstange, 3 x 59.5 mm	Bras d'amortisseur, 3 x 59.5 mm	Albero ammortizzatore, 3x59.5 mm
AX30163	Pin 2.0x10mm (6pcs.)	Stift 2 x 10 mm	Goupille 2 x 10 mm	Perno 2 x 10 mm
AX30368	Axle 6x39mm (2pcs)	Achse, 6 x 39 mm	Essieu, 6 x 39 mm	Assale ,6 x 39 mm
AX30385	Diff Gasket 16x25x0.5mm (2pcs)	Differentialdichtung 16 x 25 x 0,5 mm	Joint de différentiel 16 x 25 x 0,5 mm	Guarnizione differenziale 16x25x0,5 mm
AX30392	Bevel Gear Set - 38T/13T	Kegelradgetriebesatz - 38T/13T	Ensemble d'engrenages coniques - 38T/13T	Set ingranaggi conici - 38T/13T
AX30408	Steel Input Shaft 5x29mm (2pcs)	Stahl-Eingangswelle 5 x 29 mm	Arbre d'entrée en acier 5 x 29 mm	Albero di entrata in acciaio 5x29 mm
AX30413	Slipper spring 8.5x12 165 lbs/in - Black (2pcs)	Gleitfeder, 8,5 x 12	Ressort de sabot, 8,5 x 12	Molla pattino, 8,5x12
AX30419	AR60 OCP Front Dogbone	AR60 OCP Vorderes Dogbone	Dogbone avant AR60 OCP	Cardano anteriore AR60 OCP
AX30429	12mm Aluminum Hub (Black) (4pcs)	Schmale Aluminium-Nabe, 12 mm	Moyeu étroit en aluminium de 12 mm	Mozzo stretto in alluminio, 12 mm
AX30450	Flange Pipe 3x4.5x5.5 (4pcs)	Flanschrohr 3 x 4,5 x 5,5	Tubulure bridée 3 x 4,5 x 5,5	Tubo flangiato 3x4,5x5,5
AX30500	Heavy Duty Locker (2pcs)	Robuste Sicherung	Blocage haute résistance	Blocco differenziale Heavy Duty
AX30723	Pinion Gear 32P 12T - Steel (3mm Motor Shaft)	Zahnradgetriebe, 32DP, 12T	Engrenage à pignons,, 32DP 12T	Pignone 32DP, 12T,
AX30776	AR60 OCP Rear Axle Set (2pcs)	AR60 OCP Hinterachse	Essieu arrière AR60 OCP	Assale posteriore AR60 OCP
AX31028	Pin 2x11mm (6pcs)	Stift 2 x 11 mm	Goupille 2 x 11 mm	Perno 2 x 11 mm
AX31049	Helmet Set (Black)	Helm-Set (schwarz)	Ensemble de casque (noir)	Set elmetti (nero)
AX31059	Slipper Plate Washer 33x1mm (2pcs)			
AX31065	Spur Gear 32P 64T	Stirnrad 32P 64T	Engrenage cylindrique 32P 64T	Corona 32P 64T
AX31067	Slipper Plate (2pcs)	Gleitplatte	Plaque de sabot	Piastra pattino
AX31068	Slipper Pad 32.8x15.2x1mm (2pcs)	Gleitkissen 32,8 x 15,2 x 1 mm	Sabot de piston, 32,8 x 15,2 x 1 mm	Piastra guida, 32,8x15,2x1 mm
AX31083	Radio Box Seals	Funkbox-Dichtungen	Joints du boîtier de radio	Guarnizioni vano radiocomando
AX31106	2-Speed Hi/Lo Transmission Motor Mount	2-Geschwindigkeiten Hi/Lo Getriebe Motorhalterung	Support moteur de la transmission élevé/faible 2 vitesses	Supporto motore trasmissione 2 velocità alta/bassa (HI/LO)
AX31107	2-Speed Hi/Lo Transmission Spur Gear Cover	2-Geschwindigkeiten Hi/Lo Getriebe Stirnradabdeckung	Cache de l'engrenage cylindrique de la transmission élevé/faible 2 vitesses	Carter ingranaggi trasmissione 2 velocità alta/bassa (HI/LO)
AX31108	2-Speed Hi/Lo Transmission Case	2-Geschwindigkeiten Hi/Lo Getriebeabdeckung	Boîtier de la transmission élevé/faible 2 vitesses	Scatola trasmissione 2 velocità alta/bassa (HI/LO)
AX31109	Yeti™ Rear 4 Link Set	Yeti™ 4-gliedriger Gelenksatz hinten	Ensemble de 4 bras arrière Yeti™	Set 4 braccetti Yeti™ posteriore
AX31114	WB8-HD Standard driveshaft	WB8-HD Standard-Antriebswelle	Arbre de transmission standard WB8-HD	Albero di trasmissione standard WB8-HD
AX31121	M4x12mm Cap Head (Black) (10pcs)	M4 x 12 mm Sechskant-Inbusschraube	Douille à six pans d'assemblage creuse M4 x12 mm	Vite testa cilindrica con esagono incassato M4x12 mm
AX31125	Yeti™ Fuel Cell	Yeti™ Treibstofftank	Réservoir de carburant Yeti™	Cella carburante Yeti™
AX31127	2-Speed Hi/Lo Transmission Top Shaft (5x91mm)	2-Geschwindigkeiten Hi/Lo obere Getriebewelle (5 x 91 mm)	Arbre supérieur de la transmission élevé/faible 2 vitesses (5 x 91 mm)	Albero superiore trasmissione 2 velocità alta/bassa (HI/LO) (5x91 mm)
AX31129	2-Speed Hi/Lo Transmission Bottom Shaft (5x75mm)	2-Geschwindigkeiten Hi/Lo untere Getriebewelle (5 x 75 mm)	Arbre inférieur de la transmission élevé/faible 2 vitesses (5 x 75 mm)	Albero inferiore trasmissione 2 velocità alta/bassa (HI/LO) (5x75 mm)
AX31130	High Speed Transmission Gear Set (48P 26T, 48P 28T)	Hochgeschwindigkeits-Getriebesatz (48P 26T, 48P 28T)	Ensemble d'engrenages de transmission grande vitesse (48P 26T, 48P 28T)	Set ingranaggi trasmissione alta velocità (48P 26T, 48P 28T)
AX31148	WB8-HD Driveshaft Coupler Set	WB8-HD-Antriebswellenkupplungssatz	Ensemble de couplage d'arbre de transmission WB8-HD	Set accoppiamento albero trasmissione WB8-HD
AX31185	M3x10mm Hex Socket Flat Head (Black) (10pcs)	M3 x 10 mm Sechskant-Flachkopf	Douille à six pans à tête plate M3 x 10 mm	Vite testa piana con esagono incassato M3x10 mm
AX31250	M4 Serrated Nylon Lock Nut (Black) (10pcs)	Feststellflanschmutter (schwarz)	Contre-écrou en nylon strié (noir) M4	Controdado dentato nylon (nero) M4
AX31300	10mm Shock Parts Tree 2 (Blue)	10 mm Stoßdämpfer-Teilebaum	Arbre des pièces d'amortisseurs 10 mm	Set ricambi ammortizzatore 10 mm
AX31301	10mm Shock Caps Parts Tree (Blue)	10 mm Stoßdämpfer-Teilebaum	Arbre des pièces d'amortisseurs 10 mm	Set ricambi ammortizzatore 10 mm
AX31312	35T Electric Motor	35T Elektromotor	Moteur électrique 35T	Motore elettrico 35T
AX31313	Transfer Case Output Shaft (5x69mm)	Transfergehäuse Antriebswelle (5 x 69 mm)	Arbre de sortie de la boîte de transfert (5 x 69 mm)	Albero uscita scatola di trasferimento (5x69 mm)
AX31314	Aluminum Shock Body 12x47.5mm	Aluminium Stoßdämpfergehäuse 12 x 47,5 mm	Carrosserie d'amortisseurs en aluminium 12 x 47,5 mm	Corpo ammortizzatore in alluminio 12x47,5 mm
AX31315	Spring 14x70mm 1.43 lbs/in - Purple (2pcs) (Blue Springs)	Feder 14 x 70 mm 1,43 lbs/in	Ressort 14 x 70 mm 1,43 lb/po	Molla 14x70 mm 1,43 lbs/in
AX31316	AR60 Double Shear Steering Knuckle Set	AR60 Lenkrollen	Rotules de direction AR60	Fusi a snodo AR60

Part #	Description	Beschreibung	Description	Descrizione
AX31317	AR66 Differential Covers	AR66 Differenzialgehäuse	Couvercles de différentiel AR66	Carter differenziale AR66
AX31318	RR10 Battery Tray Chassis Components	RR10 Akkufach Karosseriebauteile	Composants du châssis du support de batterie RR10	Componenti telaio supporto batteria RR10
AX31319	RR10 Center Cage	RR10 Zentrales Gehäuse	Cage centrale RR10	Custodia centrale RR10
AX31320	RR10 Rear Cage Components	RR10 Hintere Gehäusebauteile	Composants de la cage arrière RR10	Componenti custodia posteriore RR10
AX31321	RR10 Cage Lower Rails	RR10 Gehäuse untere Schienen	Rails inférieurs de la cage RR10	Guide inferiori custodia RR10
AX31322	RR10 Cage Sides (Left and Right)	RR10 Gehäuseseiten (Links und Rechts)	Côtés de la cage RR10 (gauche et droite)	Scocca di protezione laterale (dx e sx) RR10
AX31323	RR10 Electronics Box	RR10 Elektronikbox	Boîtier des composants électroniques RR10	Scatola elettronica RR10
AX31324	RR10 Transfer Case	RR10 Transfergehäuse	Boîte de transfert RR10	Custodia di trasferimento RR10
AX31327	RR10 Bomber Body - .040" (Clear)	Carrosserie du Bomber 0,040 clair RR10	Bomber-Karosserie 0,040 Transparent RR10	Scocca Bomber .040 trasparente RR10
AX31328	Interior Set .040 Clear RR10	Ensemble d'intérieur 0,040 clair RR10	Innenausstattungsatz 0,040 Transparent RR10	Set interno .040 trasparente RR10
AX31332	RR10 Battery Tray Chassis Components 2	RR10 Akkufach Karosseriebauteile 2	Composants du châssis du support de batterie RR10 2	2 componenti telaio supporto batteria RR10
AX31333	RR10 Skid Plate	RR10 Gleitbrett	Plaque de protection RR10	Piastra di protezione RR10
AX31336	Spring 14x70mm 3.27 lbs/in - Yellow (2pcs) (Blue Springs)	Feder 14 x 70 mm 3,27 lbs/in	Ressort 14 x 70 mm 3,27 lb/po	Molla 14x70 mm 3,27 lbs/in
AX80002	Diff Case -Small	Differentialgehäuse – Klein	Boîtier de différentiel - Petit	Scatola diff. - Piccola
AX80018	Hardware Parts Tree	Hardware-Teilebaum	Arbre des pièces de quincaillerie	Set bulloneria
AX80033	10mm Shock Parts Tree	10 mm Stoßdämpfer-Teilebaum	Arbre des pièces d'amortisseurs 10 mm	Set ricambi ammortizzatore 10 mm
AX80069	Offset Axle Housing	Achsgehäuse mit Versatz	Carter d'essieu déporté	Carcassa assale offset
AX80071	Straight Axle Adapter Rear	Gerader Achsadapter hinten	Adaptateur d'essieu droit arrière	Adattatore assale dritto posteriore
AX80072	AR60 OCP 4-Link Mount	Achse mit viergliedrigem Gestänge und Versatz	Support d'essieu déporté à 4 bras	Supporto braccetti 4-link offset assale
AX80073	AR60 OCP Steering Link	AR60 OCP-Lenkstange	Tringlerie de direction AR60 OCP	Braccetto sterzo AR60 OCP
AX80083	Wraith Links Set	Wraith-Gestängesatz	Ensemble de bras Wraith	Set leveraggi Wraith
AXA0023	M2.6x8mm Cap Head (Black) (10pcs)	M2.6 x 8 mm Sechskant-Inbusschraube	Douille à six pans d'assemblage creuse M2.6 x8 mm	Vite testa cilindrica con esagono incassato M2.6x8 mm
AXA0109	M3x10mm Oversized Flat Hex Socket (Black) (10pcs)	M3 x 10 mm übergroßer Sechskant-Flachkopf	Douille à six pans à tête plate surdimensionnée M3 x 10 mm	Vite testa piana con esagono incassato sovrasmisura M3x10 mm
AXA0113	M3x6mm Hex Socket Button Head (Black) (10pcs)	M3 x 6 mm Sechskant-Rundkopf	Douille à six pans à tête bombée M3 x 6 mm	Vite testa tonda con esagono incassato M3x6 mm
AXA0147	M3x16mm Hex Socket Flat Head (Black) (10pcs)	M3 x 16 mm Sechskant-Flachkopf	Douille à six pans à tête plate M3 x 16 mm	Vite testa piana con esagono incassato M3x16 mm
AXA015	M2x10mm Cap Head (Black) (10pcs)	M2 x 10 mm Sechskant-Inbusschraube	Douille à six pans d'assemblage creuse M2 x 10 mm	Vite testa cilindrica con esagono incassato M2x10 mm
AXA0187	M3x20mm Set Screw (Black) (10pcs)	M3 x 20 mm Schraubensatz	Vis de fixation M3 x 20 mm	Vite di arresto M3x20 mm
AXA0286	Screw Shaft M4x2.5x12mm (6pcs)	Gewindenschaft M4 x 2,5 x 12 mm	Tige de vis M4 x 2,5 x 12 mm	Albero filettato M4 x 2,5 x 12 mm
AXA0413	M2.6x8mm Hex Socket Tapping Flat Head (Black) (10pcs)	M2.6 x 8 mm Sechskant-Flachkopf-Blechschrabe	Douille à six pans à tête plate autotaraudeuse M2.6 x 8 mm	Vite autofilettante testa piana con esagono incassato M2.6x8 mm
AXA0439	M3x20mm Hex Socket Tapping Button Head (Black) (10pcs)	M3 x 20 mm Rundkopf-Blechschrabe	Vis autotaraudeuse à tête bombée M3 x 20 mm	Vite autofilettante testa tonda M3x20 mm
AXA087	M3x16mm Hex Socket Cap Head (Black) (10pcs)	M3 x 16 mm Sechskant-Inbusschraube	Douille à six pans d'assemblage creuse M3 x16 mm	Vite testa cilindrica con esagono incassato M3x16 mm
AXA091	M3x30mm Hex Socket Cap Head - (Black) (10pcs)	M3 x 30 mm Sechskant-Inbusschraube	Douille à six pans d'assemblage creuse M3 x30 mm	Vite testa cilindrica con esagono incassato M3x30 mm
AXA1041	M2.5 Nylon Locking Hex Nut - Silver (10pcs)	M2.5 Nylon-Feststellmutter	Contre-écrou en nylon M2.5	Controdado nylon M2.5
AXA1045	M4 Nylon Lock Nut (Black) (10pcs)	M4 Nylon-Feststellmutter	Contre-écrou en nylon M4	Controdado nylon M4
AXA1052	M3 Thin Nylon Locking Hex Nut (Black)	M3 dünne Nylon-Feststellmutter	Contre-écrou à six pans fin en nylon M3	Controdado esagonale nylon sottile M3
AXA1053	M3 Nylon Locking Hex Nut (Black) (10pcs)	M3 Nylon-Feststellmutter	Contre-écrou en nylon M3	Controdado nylon M3
AXA1059	6mm Body clip (Black) (10pcs)	6 mm Gehäuseklemme	Clip de carrosserie 6 mm	Clip 6 mm
AXA1069	Washer 2.7x6.7x0.5 (10pcs)	Unterlegscheibe 2.7x 6.7 x 0,5mm	Rondelle 2.7x6.7x0,5mm	Rondella 2.7x 6.7 x 0,5mm
AXA1070	Washer 3x6x0.5 (10pcs)	Unterlegscheibe 3 x 6 x 0,5mm	Rondelle 3 x 6 x 0,5mm	Rondella 3x 6 x 0,5mm
AXA1071	Washer 4x8x0.5mm (10pcs)	Unterlegscheibe 4x 8 x 0,5mm	Rondelle 4x8x0,5mm	Rondella 4x 8 x 0,5mm
AXA114	M3x8mm Hex Socket Button Head (Black) (10pcs)	M3 x 8 mm Sechskant-Rundkopf	Douille à six pans à tête bombée M3 x 8 mm	Vite testa tonda con esagono incassato M3x8 mm
AXA115	M3x10mm Hex Socket Button Head (Black) (10pcs)	M3 x 10 mm Sechskant-Rundkopf	Douille à six pans à tête bombée M3 x 10 mm	Vite testa tonda con esagono incassato M3x10 mm

Part #	Description	Beschreibung	Description	Descrizione
AXA116	M3x12mm Hex Socket Button Head - Black (10pcs)	M3 x 12 mm Sechskant-Rundkopf	Douille à six pans à tête bombée M3 x 12 mm	Vite testa tonda con esagono incassato M3x12 mm
AXA117	M3x15mm Hex Socket Button Head (Black) (10pcs)	M3 x 15 mm Sechskant-Rundkopf	Douille à six pans à tête bombée M3 x 15 mm	Vite testa tonda con esagono incassato M3x15 mm
AXA118	M3x18mm Hex Socket Button Head - Black (10pcs)	M3 x 18 mm Sechskant-Rundkopf	Douille à six pans à tête bombée M3 x 18 mm	Vite testa tonda con esagono incassato M3x18 mm
AXA1184	O-Ring 7.5x1.5mm (S8) - (10pcs)	O-Ring 7,5 x 1.5mm	Joint torique 7,5 x 1.5mm	O-Ring 7.5 x 1.5mm
AXA119	M3x20mm Hex Socket Button Head (Black) (10pcs)	M3 x 20 mm Sechskant-Rundkopf	Douille à six pans à tête bombée M3 x 20 mm	Vite testa tonda con esagono incassato M3x20 mm
AXA1202	O-Ring 3.5x2mm (10pcs)	O-Ring 3,5 x 2mm	Joint torique 3,5 x 2mm	O-Ring 3.5 x 2mm
AXA121	M3x30mm Hex Socket Button Head (Black) (10pcs)	M3 x 30 mm Sechskant-Rundkopf	Douille à six pans à tête bombée M3 x 30 mm	Vite testa tonda con esagono incassato M3x30 mm
AXA1221	Bearing 5x11x4mm (2pcs)	Lager 5 x 11 x 4 mm	Roulement 5 x 11 x 4 mm	Cuscinetto 5x11x4 mm
AXA1230	Bearing 10x15x4mm	Lager 10 x 15 x 4 mm	Roulement 10 x 15 x 4 mm	Cuscinetto 10x15x4 mm
AXA1391	E4 e-clip (10pcs)	E4 E-Clip	E-clip E4	E-clip E4
AXA1393	E2.5 e-clip (10pcs)	E2.5 E-Clip	E-clip E2.5	E-clip E2.5
AXA144	M3x8mm Hex Socket Flat Head (Black) (10pcs)	M3 x 8 mm Sechskant-Flachkopf	Douille à six pans à tête plate M3 x 8 mm	Vite testa piana con esagono incassato M3x8 mm
AXA146	M3x12mm Hex Socket Flat Head - Black (10pcs)	M3 x 12 mm Sechskant-Flachkopf	Douille à six pans à tête plate M3 x 12 mm	Vite testa piana con esagono incassato M3x12 mm
AXA148	M3x18mm Hex Socket Flat Head (Black) (10pcs)	M3 x 18 mm Sechskant-Flachkopf	Douille à six pans à tête plate M3 x 18 mm	Vite testa piana con esagono incassato M3x18 mm
AXA150	M3x25mm Hex Socket Flat Head (Black) (10pcs)	M3 x 25 mm Sechskant-Flachkopf	Douille à six pans à tête plate M3 x 25 mm	Vite testa piana con esagono incassato M3x25 mm
AXA180	M3x3mm Set Screw (Black) (10pcs)	M3 x 3 mm Schraubensatz	Vis de fixation M3 x 3 mm	Vite di arresto M3x3 mm
AXA186	M3x16mm Set Screw (Black) (10pcs)	M3 x 16 mm Schraubensatz	Vis de fixation M3 x 16 mm	Vite di arresto M3x16 mm
AXA291	M4x4mm Set Screw (Black) (6pcs.)	M4 x 4 mm Schraubensatz	Vis de fixation M4 x 4 mm	Vite di arresto M4x4 mm
AXA436	M3x12mm Hex Socket Tapping Button Head (Black) (10pcs)	M3 x 12 mm Rundkopf-Blechschaube	Vis autotaraudeuse à tête bombée M3 x 12 mm	Vite autofilettante testa tonda M3x12 mm
AXA441	M3x30mm Hex Socket Tapping Button Head (Black) (10pcs)	M3 x 30 mm Rundkopf-Blechschaube	Vis autotaraudeuse à tête bombée M3 x 30 mm	Vite autofilettante testa tonda M3x30 mm
AXI43006	2.2 Trail Ready HD Beadlock Wheel (Satin)	2.2 Trail Ready HD Beadlock-Rad (Satin)	Roue à verrou de talon 2,2 Trail Ready HD (satinée)	Cerchione Beadlock Trail Ready HD 2.2 (Satinato)
AXI43007	2.2 Raceline Monster Beadlock Wheel (Satin)	2.2 Raceline Monster Beadlock-Rad (Satin)	Roue à verrou de talon 2,2 Raceline Monster (satinée)	Cerchione Beadlock Raceline Monster 2.2 (Satinato)
AXIC3221	Spring 14x70mm 3.27lbs in Firm Yellow (2)	Feder 14 x 70 mm 0,57 N/mm (3,27 lbs/in), Firm Yellow (2)	Ressort 14 x 70 mm 0,57 N/mm (3,27 lbs/po), Ferme (jaune) (2)	Molla 14x70 mm 0,57 N/mm (3.27lbs/in) Dura, Gialla (2)
AXIC0224	Spring 14x70mm 1.43lbs/in, Purple (2)	Feder 14 x 70 mm 0,25 N/mm (1,43 lbs/in), Violett (2)	Ressort 14 x 70 mm 0,25 N/mm (1,43 lbs/po), Violet (2)	Molla 14x70 mm 0,25 N/mm (1.43lbs/in), Viola (2)
AXIC1481	AE-5L LED Light Set Only	Nur AE-5L LED-Beleuchtungssatz	Ensemble d'éclairage DEL, AE-5L uniquement	Solo set luci LED AE-5L
AXIC8075	1/10 Falken Wildpeak M T R35 Compound 2.2 Tire with Inserts (2)	1/10 Falken Wildpeak M T R35 Verbindung 2.2 Reifen mit Einsätzen (2)	Pneu Falken Wildpeak MT 1/10 R35 Compound 2.2 avec inserts (2)	Pneumatico compound 2.2 1/10 Falken Wildpeak M T R35 con inserti (2)
AXIC1266	IFD Hex Hub Adapter 2 Front 2 Rear.	IFD Hex Nabenadapter 2 vorn 2 hinten.	Adaptateur moyeu hexagonal IFD, 2 avant et 2 arrière.	Adattatore mozzo esagonale IFD 2 anteriori 2 posteriori.
AXIC231007	23T Metal Servo Horn	23T Metall-Servohorn	Renvoi de commande de servo métallique 23T	Squadretta servo in metallo 23T
AXI43006	2.2 Trail Ready HD Beadlock Satin (2)	2.2 TrailReady HD Beadlock Satin (2)	Verrou de talon HD Trail Ready 2.2, satiné (2)	Cerchioni satinati Beadlock HD 2.2 Trail Ready (2)

©2020 Horizon Hobby, LLC. Axial, the Axial logo, RR10, DX3, DSM, IC3, EC3, the Smart Technology logo, and the Horizon Hobby logo are trademarks or registered trademarks of Horizon Hobby, LLC. The Spektrum trademark is used with permission of Bachmann Industries, Inc. Bomber Fabrication and associated logos and designs are property of Randy Slawson, used under license. BFGoodrich® Tires and Baja T/A® KR3 Trademarks are used under License from Michelin. Savvy, King, Odyssey, Raceline, Baja Designs, Falken, PSC, Sleinjager, Fox, and associated logos are property of their respective owners and are used under license. All other trademarks, service marks and logos are property of their respective owners.



EXPLORE

facebook.com/axialinc | instagram.com/axialracing | twitter.com/axialrc
youtube.com/axialvideos | flickr.com/axialrc