

PIPING BAGS

DIRECTIONS FOR USE

1. Remove the coupler ring from the coupler base. Insert the coupler base, narrow end first, into the bag and push it as far down as possible and mark a line on the outside of the bag.

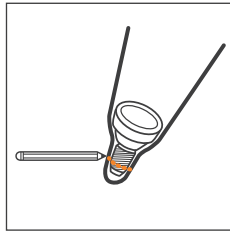

2. Cut along the line.

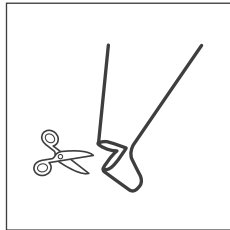

3. Push the coupler base down through the opening of the bag. Place the nozzle over the exposed base extending from the bag. Place the coupler ring over the nozzle and tighten the ring in place.

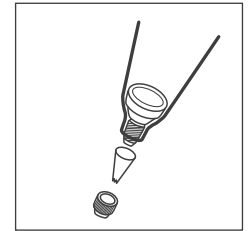

4. To fill the bag, fold the top of the bag down to create a cuff. Fill the bag approximately 75% capacity ensuring you do not overfill it. Close up bag and squeeze contents down to begin piping.

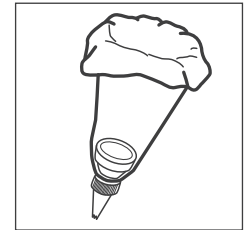

See overleaf for Using Coupler and Care Instructions.

USING COUPLER

The benefit of using a coupler is that it saves time and creates less mess when changing the nozzles.

CARE INSTRUCTIONS

- These Thermoplastic polyurethane (TPU) piping bags are reusable and non-stick.
- The durable material retains flexibility and is designed to not stain, tear or absorb flavours.
- These piping bags have a smooth, seamless interior and non-slip textured exterior for perfect grip and excellent control.
- They have the same non-stick quality of silicone piping bags but do not balloon.
- They are suitable for freezing, hot and cold use with temperature resistance of -40°C to 110°C.
- These piping bags can be washed easily by hand.
- These piping bags are certified food safe and BPA free.
- Please use the coupler provided with these piping bags only. Other couplers/ nozzles may result in potential damage to the piping bags.

