

PX100 SERIES  
PCP - PRE CHARGED PNEUMATIC  
ACHILLES • CLUB PRO  
NO LICENCE REQUIRED

PRECIHOLE SPORTS™  
OWNER'S MANUAL  
Please Register your Air Rifle Online at  
www.preciholesports.com

Specifications	Achilles	Club Pro
Power source	PCP	
Mechanism	Side Lever Loading	
Caliber	4.5 mm (0.177")	4.5 mm (0.177")
Velocity	259 mps / 850 fps	175 mps / 575 fps
Power	20 joules / 15 ft-lb	7.5 joules / 5.5 ft-lb
Max. Pressure	200 bar	160 bar
Weight	2.75 kg	4.0 kg
Total Length	920 mm	1065 mm
Barrel Length	500 mm	580 mm
Shots Per Fill	80	175

Before using this Air Rifle thoroughly read all instructions and warnings in the Manual.



**Disassembly of your air rifle will void your warranty!**

Tampering with the components, or unauthorized modifications and alterations may make the air rifle unsafe to use and also will invalidate the warranty and may attract legal consequences.

We strongly advise against disassembly or modifying your air rifle. The PCP air rifles are charged at very high pressure. Disassembly of air rifle while it is charged may lead to serious injuries or even death. If there is any physical damage to air cylinders the air rifle must be taken for inspection to an authorized Precihole Sports service center.

Please ensure that all the fields below are filled and it carries the inspection date and sign.

Customer Name		
Achilles	<input type="checkbox"/>	Club Pro <input type="checkbox"/>
Serial Number		
Inspection Sign :		
Date :		

NOTICE

- PX100 Achilles air rifle comes with a MZ10 Rotary Magazine, and a rear Aperture sight. Pressure range is between : **200 bar - 90 bar**.
- PX100 Club Pro air rifle comes with a Pellet tray, Front and Rear Aperture sights. The rifle is compatible with the MZ10 Rotary Magazine. Pressure range is between : **160 bar - 70bar**.
- DO NOT discharge the rifle completely i.e. do not go below the minimum specified pressure for your air rifle. This could result in leakage.
- OVERFILLING the air rifle beyond the maximum specified pressure would lead to valve lock and damage the seals. This would also result in low velocity.
- Achilles Air rifle can be dangerous up to 600m and Club Pro upto 450m.
- PX100 Achilles model is a High Power rifle and hence it is normal to hear a loud sound on shooting.

WARNING

- Precision air rifles, because of their design are a special class of guns having very sensitive trigger mechanisms, light trigger pulls and may fire if dropped or jarred abruptly. Careless use of an air rifle can cause serious injuries.
- PCP air rifles are designed specifically for use with dry compressed air. No other gas combination can be used.
- Ensure that you are aware of all the local laws regarding ownership of air rifle. You should always obey all the local laws.
- Anyone under 18 years of age must always be under the 'immediate supervision' of an adult experienced in operating air rifles.

SAFETY INFO

- Always keep the muzzle pointed in a safe direction. Never point it at something you don't want to shoot. Keep the muzzle pointed either upwards or downwards towards the ground.
- Make sure you note the danger distance of the air rifle i.e. how far the pellets can travel. Also ensure that your target has a safe backstop i.e. Think of what you might hit if the pellet misses or goes through the intended target.
- Always keep your finger away from the trigger and out of the trigger guard until ready to shoot.
- An air rifle has a potential of serious injury. Treat every rifle as if it were loaded. Keep it unloaded until ready to shoot. Move the safety lever to off position only when ready to shoot.
- An air rifle "Safety" is a mechanical device. Like all mechanical devices, it can fail. Never rely on an rifle's "Safety" to protect you and others from unsafe handling. A safety is not a substitute for common sense and good safety procedures.
- When removing any air rifle from storage, or when receiving it from another person, check immediately to see if it is loaded.
- Do not drink and shoot. Handling and using an air rifle requires your full and continuous attention, alertness, and unimpaired judgement.

LEARN THE PARTS

Before learning how to operate, lets first identify various parts of your PX100 series air rifle.

**ACHILLES**

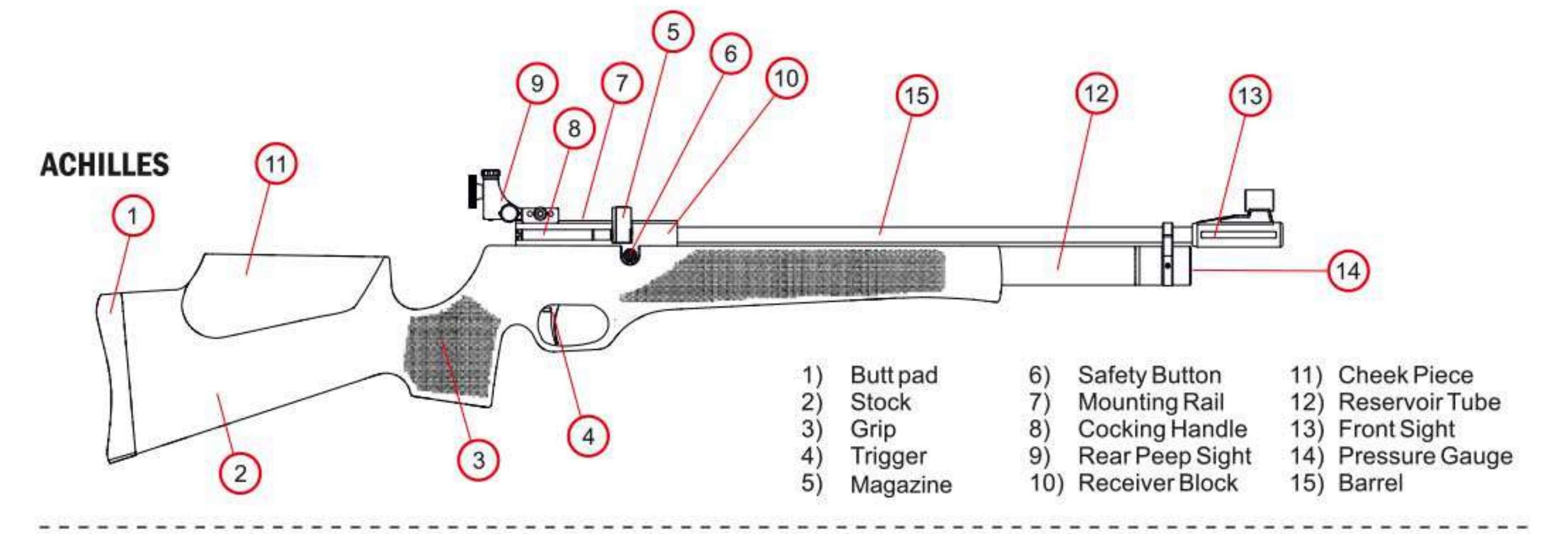

1) Butt pad 2) Stock 3) Grip 4) Trigger 5) Magazine 6) Safety Button 7) Mounting Rail 8) Cocking Handle 9) Rear Peep Sight 10) Receiver Block 11) Cheek Piece 12) Reservoir Tube 13) Front Peep Sight 14) Pressure Gauge 15) Barrel

**CLUB PRO**

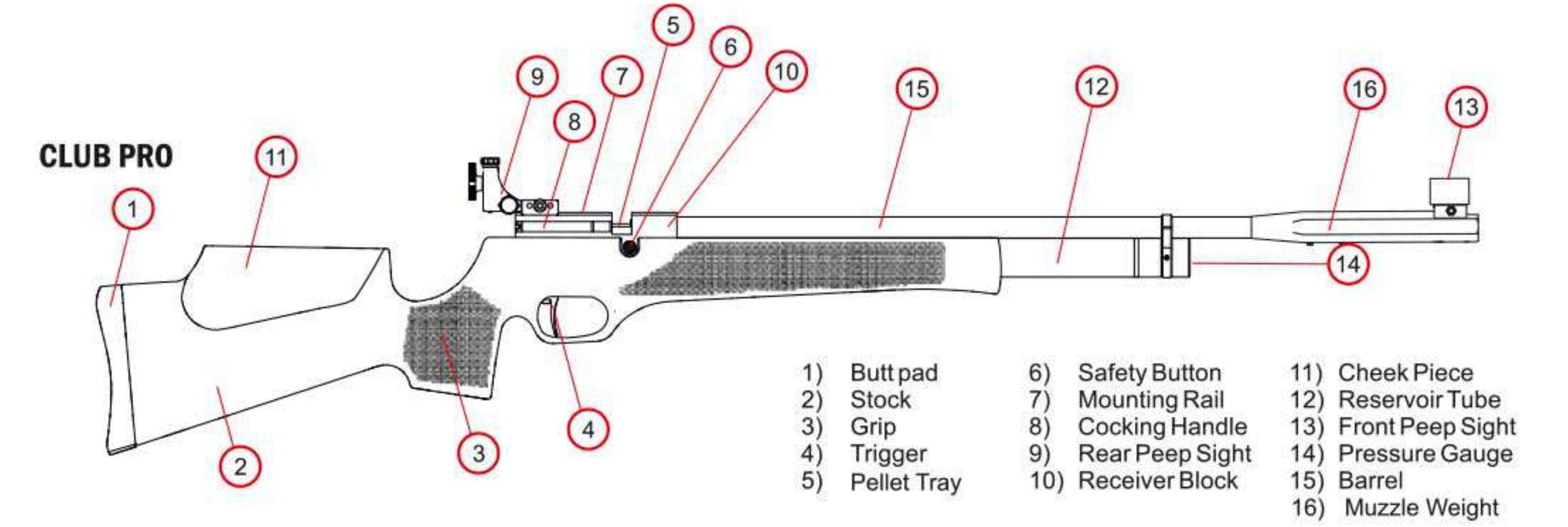

1) Butt pad 2) Stock 3) Grip 4) Trigger 5) Pellet Tray 6) Safety Button 7) Mounting Rail 8) Cocking Handle 9) Rear Peep Sight 10) Receiver Block 11) Cheek Piece 12) Reservoir Tube 13) Front Peep Sight 14) Pressure Gauge 15) Barrel 16) Muzzle Weight

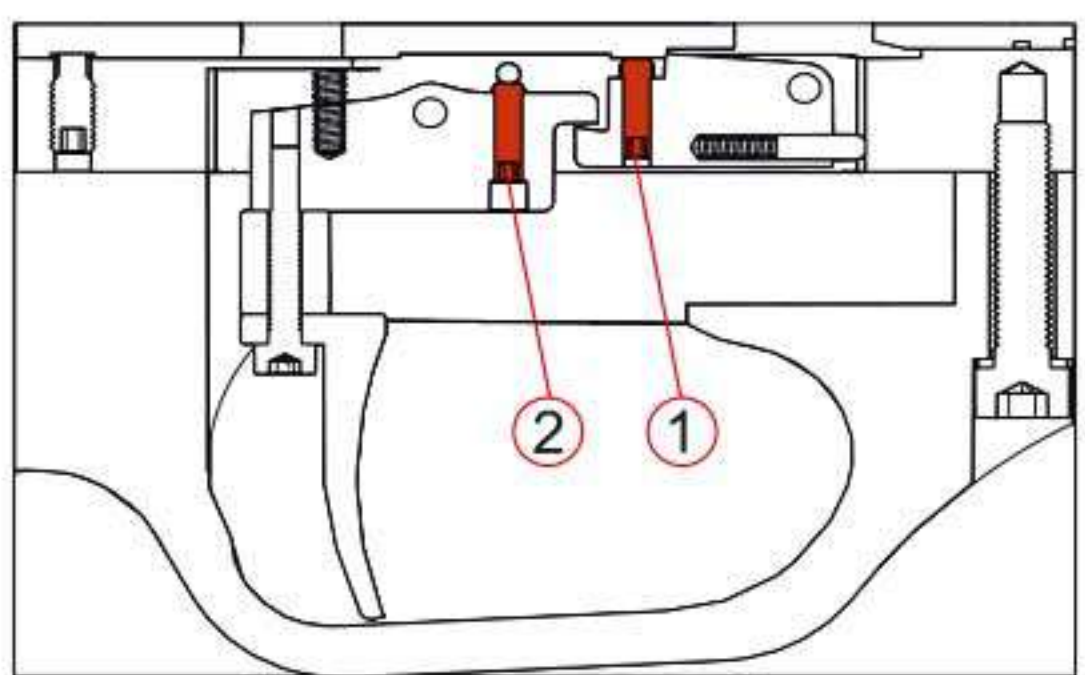

1. Trigger Point / Sear Engagement (Tool required : 1.5 mm Allen Key)  
Turning Clockwise decreases resistance of the second stage and Counter-Clockwise increases resistance of the second stage. Factory setting of the resistance is 250 grams of the trigger pull.  
**WARNING: Turning Clockwise too much will prevent gun from cocking.**  
2. First Stage, Length of pull (Tool required: 1,5 mm Allen Key)  
Turning Clockwise will reduce the amount of first stage travel and Counter-Clockwise will increase the amount of first stage travel.  
**WARNING: Turning Clockwise too much will eliminate the 2nd stage and prevent sear engagement.**

AIR RIFLE MAINTENANCE

- Apply a thin layer of suitable grease occasionally or when dried out to the fillprobe o-rings.
- To prevent rust from forming due to sweat from your hands, exterior surfaces should be wiped down with an oiled cloth after every use to maintain the quality of finish. (Never Use Strong Chemicals or Water).
- Before you begin oiling or cleaning your rifle, always check to make sure it is unloaded. (Do Not over-lubricate the Rifle)
- It is recommended to clean the barrel with a pull through every 500-1000 shots. Do not use harsh firearm bore cleaners.
- After a period of time, the O-rings on the fill probe will need to be replaced. The need for this will become noticeable if air is heard leaking from the fillprobe or the fillprobe is ejected from the port while charging the rifle. Always ensure to replace both O-rings on the fill probe.
- Store in a place that is dry and dark. Store the rifle with a pressure between 200-90 bar for Achilles and 160-70 bar for Club Pro.

WARRANTY INFO

Please refer the terms and conditions, replacement & refund policy available on our website

- All Precihole Sports air rifles come with **6 months** carry in warranty from the date of retail purchase against faulty parts and labour; this applies to **PX100** series **ACHILLES** and **CLUB PRO** and is not transferable.
- Proof of purchase is required (Original sales receipt)
- Some items are **not covered** under the warranty:
- Normal wear and tear
- Failure due to misuse or abuse
- Fitting of non-standard parts
- Unauthorized repairs/ parts/ modifications
- Damage as a result of incorrect lubrication or over-lubrication
- Loss or theft
- Over filling pressure
- Discharging rifle below the minimum specified pressure.

- Repair Service - If your air rifle needs repair, we recommend you take or send it to your nearest Precihole Sports authorized dealer. Any disassembly or modification not performed by an authorized service station will void the warranty. All warranty work must be done by Precihole Sports or an authorized dealer of the company, and should the air rifle be collected or returned for repair purpose, the transportation charges are to be borne by the customer.

OPERATING INSTRUCTIONS

1. FILLING THE PCP AIR RIFLE

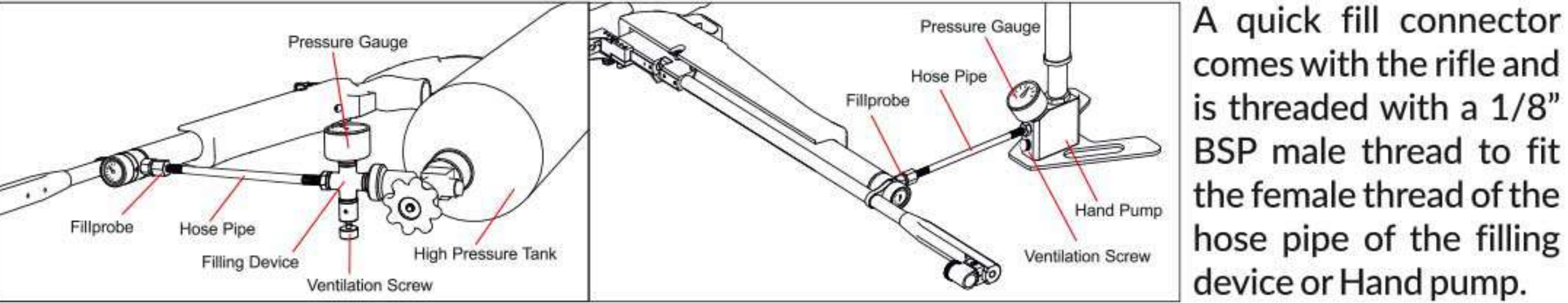

Make sure that the fill probe and filler hole are clear from any dirt. Feel free to use lubricant on the o-rings to increase their life. **NOTE: use any lubricant in moderation.**

**Fillprobe:** Rotate the dust cover to expose the fill probe hole. Insert the fill probe completely into the rifle filler hole located at the end of the air tube.

- FILLING DEVICE:** Close ventilation screw on the charging source. Charge the rifle to a Maximum level specified. (Do not over fill pressure). Always check the pressure on the charging source (filling device). Close the tap on the air bottle. Unscrew the ventilation screw on the filling device to vent the residual air in the hose pipe before removing the fill probe from the rifle.
- HAND PUMP:** When using a hand pump use the ventilation screw on the pump always. Due to continual usage the pump body will become very warm. Allow it to cool down for several minutes before continuing. As pressure increases, more force is required to pump. It is normal if you start to find it hard to pump once the pressure increases. Check the pressure on the Hand Pump gauge as they are more reliable. Do not pump beyond the maximum pressure level specified.

2. COCKING, LOADING AND LOCKING

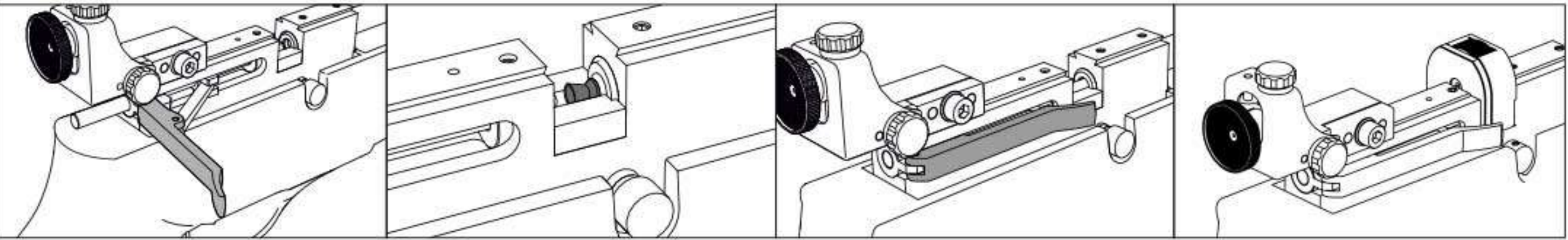

- Pull the cocking lever / handle backward as far as possible till click of sear engaging is felt.
- Insert a pellet of appropriate caliber into the barrel breech or simply lay the pellet in the pellet tray as shown in the picture. Be careful not to squeeze or damage the pellet as this could affect accuracy.
- Close the cocking lever / handle forward till it locks in place. This chambers the pellet into the barrel. The rifle is now cocked and ready to fire.
- While loading the magazine in the rifle, ensure that the cocking lever is held fully back and then slide the magazine in place. For more details read the operating manual of the magazine.

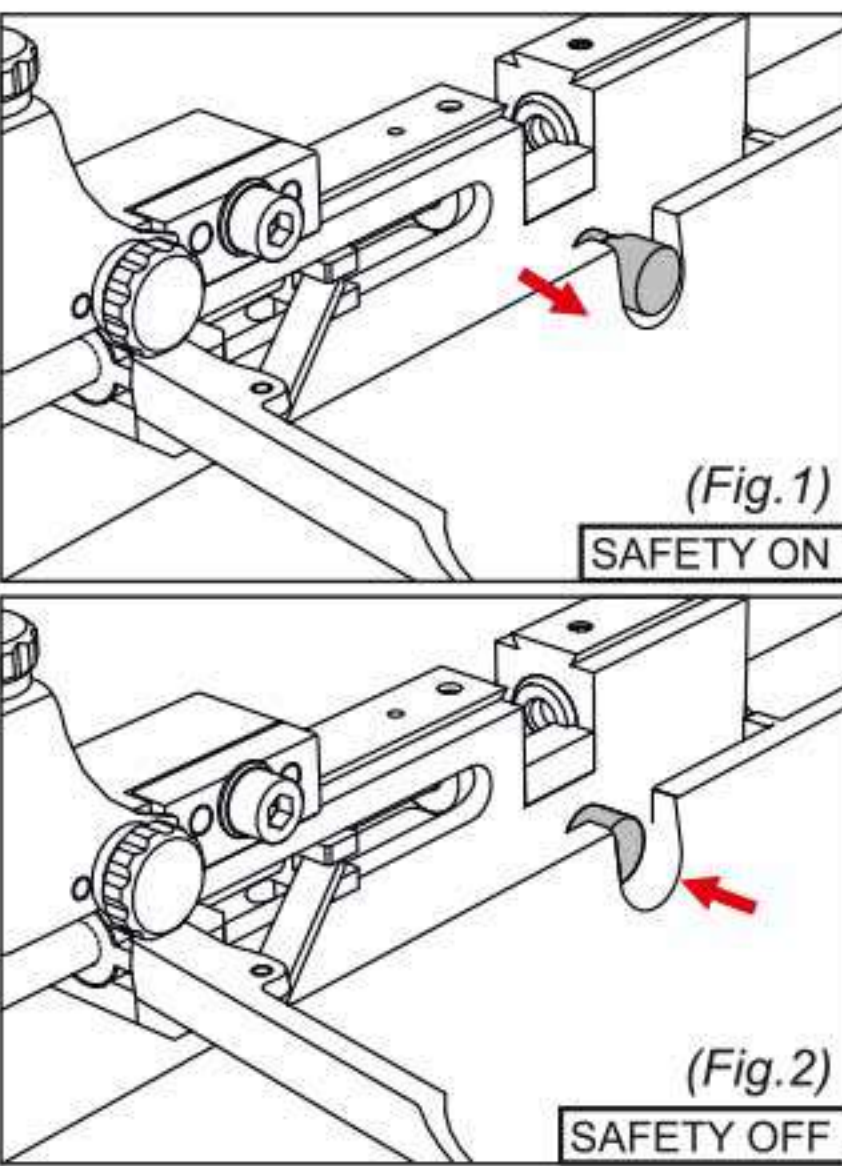

3. AIR RIFLE SAFETY LOCK

Safety button can be set to 'ON' and 'OFF' position manually. To set the safety to 'ON', push the safety lever to the right. The rifle has to be in cocked position while moving safety from 'ON' to 'OFF' or vice versa. In this position, the hammer is blocked and the air rifle cannot fire. (Fig. 1) You can use this position to do dry fire training.

To move the safety to 'OFF', push safety lever to the left after cocking the rifle. In this position, the rifle is ready to shoot (Fig. 2)

**CAUTION: Until you are actually ready to shoot, keep the safety in the 'ON' position (Fig. 1)**

4. SIGHT ADJUSTMENT

**Precision Aperture Rear Sight:**

Elevation and windage on the Precihole Sports rear sight are controlled by micro click adjustable knobs. The shift in point of impact at 10m distance:

0.65 mm per click / 4 clicks per ring in the Club Pro.

0.83 mm per click / 3 clicks per ring in the Achilles.

- If the shot impacts low, Turn the elevation knob clockwise to raise the point of impact. If it impacts high, Turn the elevation knob counter - clockwise. to lower the point of impact.
- If the shot impacts left, Turn the windage knob counter-clockwise to move the point of impact to the right. If it impacts right, Turn the windage knob clockwise to move the point of impact to the left.

5. FIRING YOUR AIR RIFLE

**Ensure the cocking handle is fully closed before firing the rifle as its performance will be affected if not fully closed.** Close the cocking handle till it locks in place. Aim at your intended target and disengage the safety and prepare to shoot. Pull the trigger gently and the rifle will fire. To reload rifle, pull the cocking handle to its rear-most position and follow the section 2. (Cocking, Loading & Locking).

**NOTE:** Many factors affect the velocity, including the ammunition brand and weight, lubrication, barrel condition and temperature.

PRECIHOLE SPORTS PVT. LTD.

A-272, Road 16A, Opp. ESIC Hospital, Wagle Estate, Thane (W) - 400604  
+91 8879320376 / 77 | info@preciholesports.com  
www.preciholesports.com | facebook.com/preciholesports

