

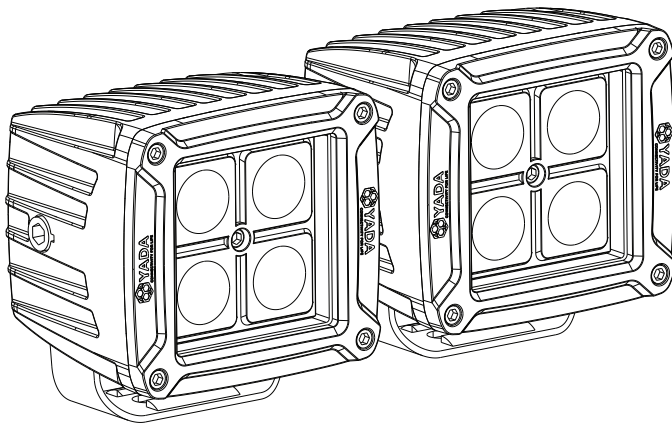

# 4" LED SPOT LIGHTS 2-PACK

LM533000 / LM533248  
Care & Use Instructions



Important, retain for future reference:  
Read carefully

## RECOMMENDED MOUNTING POSITIONS

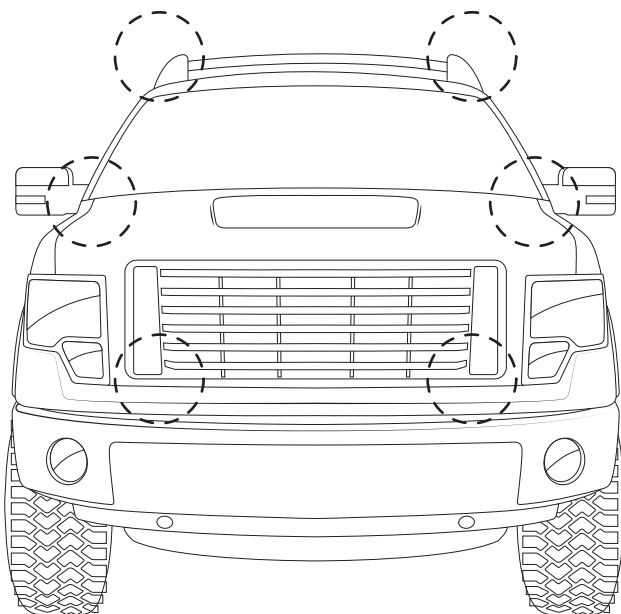

## WARNINGS

### IMPORTANT SAFETY INSTRUCTIONS

1. SAVE THESE INSTRUCTIONS— This manual contains important safety and operating instructions.
2. Before using this product, read all instructions and cautionary markings.
3. Do not expose the bare wires to rain, moisture, or snow.
4. Use of an attachment not recommended or sold by the manufacturer may result in a risk of fire, electric shock, or injury to persons.
5. Do not operate with damaged Spot Lights – replace it immediately.
6. Do not operate Spot Lights if it has received a sharp blow, been dropped, or otherwise damaged in any way; take it to a qualified serviceperson.
7. Do not disassemble Spot Lights; take it to a qualified serviceperson when service or repair is required. Incorrect reassembly may result in a risk of electric shock or fire.
8. To reduce risk of electric shock, unplug Spot Lights before attempting any maintenance or cleaning. Turning off controls will not reduce this risk.

## CAUTIONS

Check your state or provincial laws before installing. Vehicle owner must comply with all applicable laws. This product is intended solely for off road purposes. Manufacturer and seller assume no liability for installation or use, which are solely the responsibility of the purchaser. This product is not DOT approved and is designed and intended for off road uses only.

1. Do not install or use product if it, in any way, impairs the safe operation of your vehicle.
2. Follow manufacturer's instructions to ensure the product is properly and safely installed.

## INSTALLATION

### Tools Required:

- Power Drill and 8.5mm Drill Bit (not included)
- Wrench (not included)
- 5mm Hex Key

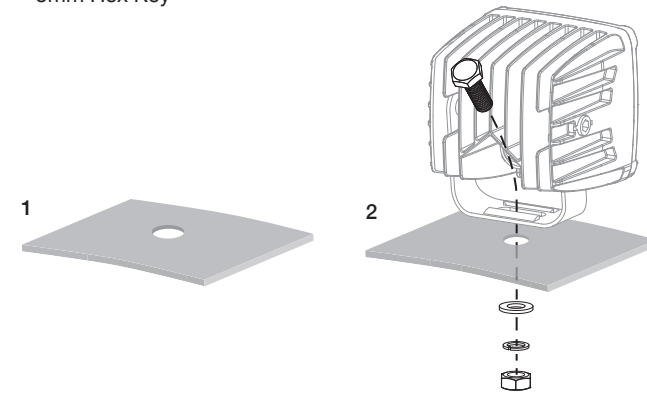

1. Choose a suitable mounting location for the Spot Light. Make sure the location is strong enough to hold the Light.
  - Mark one hole for the Mounting Bracket for a precise installation.
  - Make sure nothing beneath will be damaged after the hole is drilled.
  - Drill the hole with a 8.5mm Drill Bit.
2. Secure the Mounting Bracket to the surface with the M8 Hex Cap, M8 Spring Washer, M8 Washer and M8 Hex Nut with a wrench.
3. Adjust the Light to your desired beam angle and tighten the Screws at both sides with the 5mm Hex Key. Be sure not to over-tighten the screws after the adjustment.

3. Check your state or provincial laws before installing. Vehicle owner must comply with all applicable laws.
4. This product is intended solely for off road purposes. Manufacturer and Seller assume no liability for installation or use, which are solely the responsibility of the purchaser.
5. This product is not DOT approved and is designed and intended for off road uses only.
6. The Manufacturer and Seller are not responsible or liable for consequential, incidental, or indirect damages, whether to person or property, resulting from the installation or improper use of this product.

## SPECIFICATIONS

Beam Type:	Spot Lights
Color Temp:	6500K
Raw Lumens:	3,000LM (Each Pod)
Effective Lumens:	800LM (Each Pod)
LED Power (Raw):	18.7W (Each Pod)
LED Power (Effective):	11W (Each Pod)
AMPS:	0.9A(12V) / 0.45A(24V)
Voltage:	DC 12/24V
IP Rating:	IP67-Waterproof

### Wire connection

- Black wire (-) negative, ground connection
- Red wire (+) positive, driving light
- Fuse light at power source
- Use 16-14 gauge wire

Make sure the two hardwiring cables are connected to the Spot Lights, and the weatherproof 2 pin connectors are securely fastened.

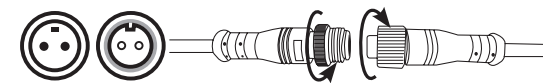

## PACKAGE INCLUDES

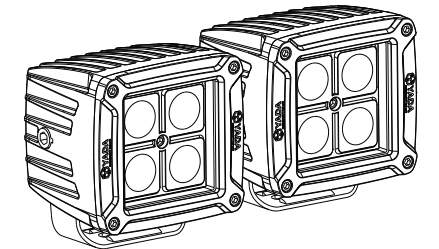

2 x 4" Spot Pod Lights

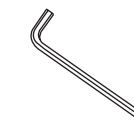

5mm Hex Key

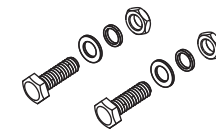

2 x M8 Hex Caps  
2 x M8 Hex Nuts  
2 x M8 Spring Washers  
2 x M8 Washers

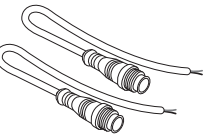

2 x Hardwiring  
Cables

## TOOLS NEEDED (NOT INCLUDED)

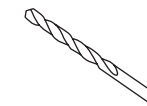

5/16" (8.5mm Drill Bit)

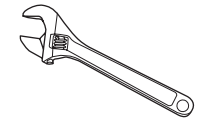

Wrench



Power Drill

## WARRANTY

### YADA LIMITED WARRANTY

YADA warrants, to the original purchaser, that its products are free from defects in material and workmanship for 1 year from the date of original purchase. Where permitted by law, YADA's liability shall be limited to that set forth in this limited express warranty. This limited express warranty shall be the exclusive remedy of the purchaser and YADA makes no other warranty of any kind aside from the limited express warranty stated above.

**NOTE:** Warranty only applies for North American customers of purchases made in North America.

### CONDITIONS OF WARRANTY

If during the 1 year warranty period your new product is found to be defective, YADA will repair such defect, or replace the product, without charge for parts or labor subject to the following conditions:

1. All repairs must be performed by YADA.
2. All warranty claims must be accompanied by a copy of the sales receipt or bill of sale.
3. The equipment must not have been altered or damaged through negligence, accident, improper operation, or failure to follow the product instructions for installation, use, or care.
4. The replacement of parts is excluded from the warranty when replacement is necessary due to normal wear and tear.
5. Repair or replacement parts supplied by YADA under this warranty are protected only for the unexpired portion of the original warranty.
6. This is a "repair or replace" warranty only, and does not cover the costs incurred for the installation, removal or reinstallation of the product, or damage to any mobile phone, electronic device or vehicle.

### OWNER'S RESPONSIBILITIES:

YADA will make every effort to provide warranty service within a reasonable period of time. SHOULD YOU HAVE ANY QUESTIONS ABOUT SERVICE RECEIVED OR IF YOU WOULD LIKE ASSISTANCE IN OBTAINING SERVICE, PLEASE CALL TOLL FREE 1.866.294.9244 DURING REGULAR BUSINESS HOURS, MONDAY THROUGH FRIDAY 8:00 AM TO 5:00 PM (Pacific Standard Time). For customer service and technical support, please call us at 1.866.294.9244 or email us at [customercare@horizon-brands.com](mailto:customercare@horizon-brands.com). If at that time it is determined that a replacement unit is needed, the support representative will issue a Return Authorization and instruct on how to get a new unit. YADA makes no

other warranty of any kind aside from the limited express warranty stated herein.

**DISCLAIMER OF WARRANTIES, INCLUDING WARRANTY OF MERCHANTABILITY AND WARRANTY OF FITNESS FOR PARTICULAR PURPOSE; EXCEPT AS SPECIFICALLY SET FORTH HEREIN, NO WARRANTY OR REPRESENTATION, EXPRESS OR IMPLIED, IS MADE AS TO THE SPOT LIGHTS. YADA AND/OR ITS AFFILIATES EXPRESSLY DISCLAIMS, WITHOUT LIMITATION, ANY STATUTORY WARRANTIES AND ALL IMPLIED WARRANTIES, INCLUDING ANY IMPLIED WARRANTY OF MERCHANTABILITY OR FITNESS FOR A PARTICULAR PURPOSE.**

YADA and/or its affiliates are not responsible for a user's intended or actual use of the Spot Lights. In no event shall YADA and/or its affiliates have any liability for any losses (whether direct or indirect, in contract, tort or otherwise) incurred in connection with the Spot Lights, including but not limited to damaged property, personal injury and/or loss of life. Neither shall YADA and/or its affiliates have any liability for any decision, action taken based on relying on the stability or performance of the Spot Lights. YADA and/or its affiliates, the manufacturer, distributor and seller shall not be liable for any injury, loss or damage, incidental or consequential, arising out of the use or intended use of the product.



2975 Red Hill Ave., Ste. 100, Costa Mesa, CA 92626, U.S.A.  
1.866.294.9244 | [customercare@horizon-brands.com](mailto:customercare@horizon-brands.com)  
©2022 ADC Solutions Auto, LLC. All rights reserved.  
[www.letsyada.com](http://www.letsyada.com)

CONNECT WITH US @letsyada

Made in China

ML-533000\_V1