



360 2K ROADCAM

APP-Controlled with GPS



BT532767

User Manual

**Important, retain for future reference:
Read carefully**

QUICK INSTALLATION GUIDE

Before you begin... Gather these items.

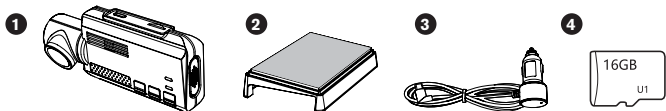

1. Mount the Roadcam

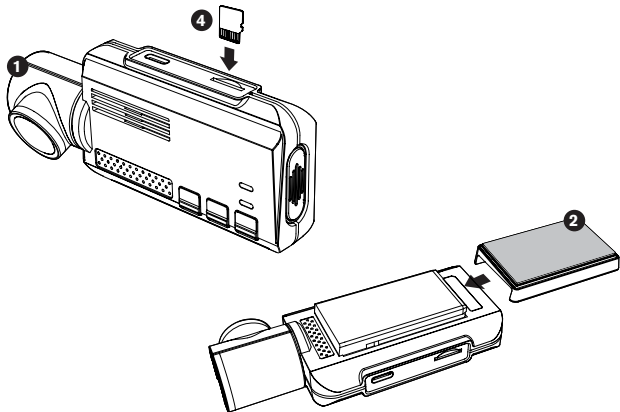

2. Connect to Power

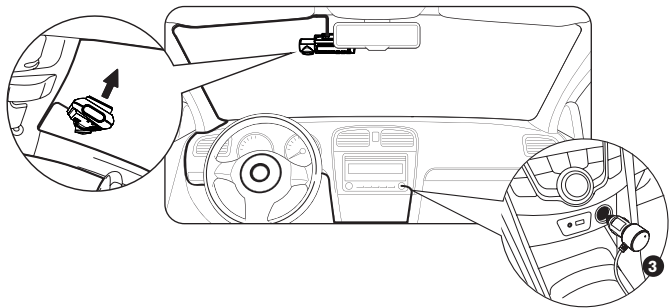
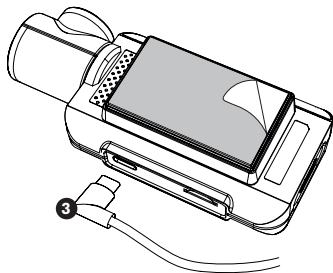

INTRODUCTION

Please read all of the installation instructions carefully before installing the product. Improper installation will void manufacturer's warranty. The installation instructions do not apply to all types of vehicles, and are written as guidelines to assist in installing the system.

Consult an experienced technician if you are not comfortable installing the product. You can also contact YADA at **1.866.294.9244** to speak to one of our installation specialists if you have any specific questions regarding the 360 2K Roadcam APP-Controlled with GPS.

BEFORE using the 360 2K Roadcam APP-Controlled with GPS, please read the safety information provided in this user manual. ALWAYS use the product as outlined in this user manual.

Please make sure to read and understand all local laws and regulations regarding cameras and their use in a vehicle. Laws vary by state.

PRODUCT SPECIFICATIONS

Lens:	360 degrees
Video Resolution:	2160 x 2160, 1632 x 1632
Circular Video:	Seamless loop recording
Memory Card:	MicroSD (maximum support 128GB)
Microphone:	Supported
Built-in Audio:	Supported
Operating Temperature:	14°F~140°F (-10°C~60°C)
Operating Voltage:	Cigarette Charger - DC 12/24V / DC 5V (USB-C)
Battery:	Built-in Super Capacitor

PACKAGE CONTENTS

1. 1 x 360 2K Roadcam
2. 1 x Windshield Mount with 3M VHB™ Double-Sided Tape
3. 1 x 12V/24V Power Adapter
4. 1 x 16GB MicroSD Card

1

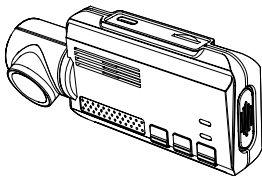

2

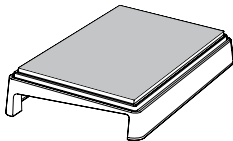

3

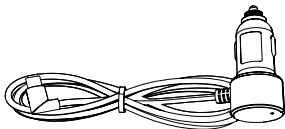

4



PRODUCT OVERVIEW

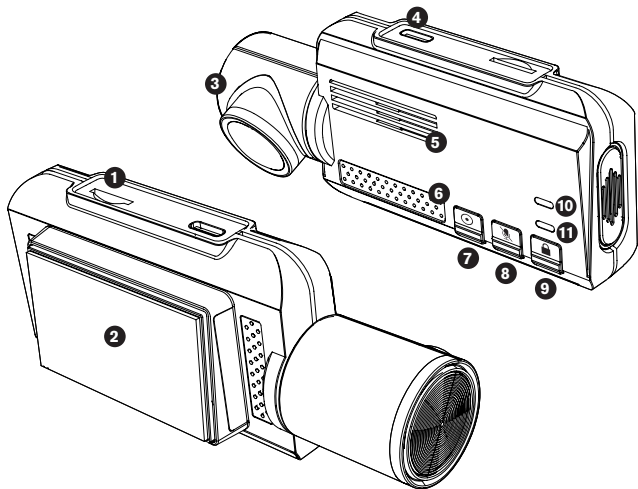

1. MicroSD Card Slot

2. 3M VHB™ Windshield Mount

3. Camera Lens

4. USB-C Power Port

5. Speaker

6. Microphone

7. Record/Pause Button

8. Microphone On/Off Button

9. Lock Video Button

10. GPS Indicator Light

11. Recording Indicator Light

CAMERA DIMENSIONS

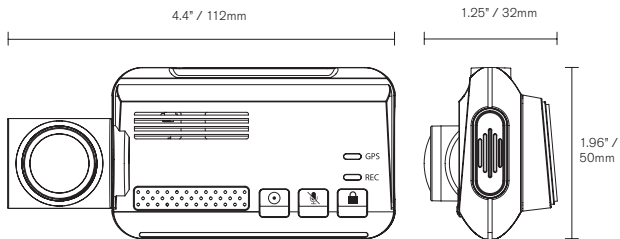

INSTALLATION

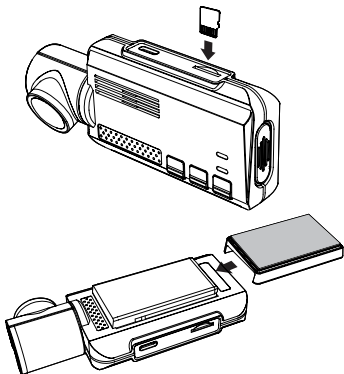

1. Insert the MicroSD card.
2. Insert the windshield mount to the back of the Roadcam.

INSTALLATION

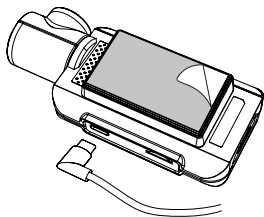

3. Peel off the 3M VHB™ adhesive tape backer from the windshield mount.
4. Plug the USB-C power cable into the DC input port.

Note: Power on and test camera before mounting.

5.

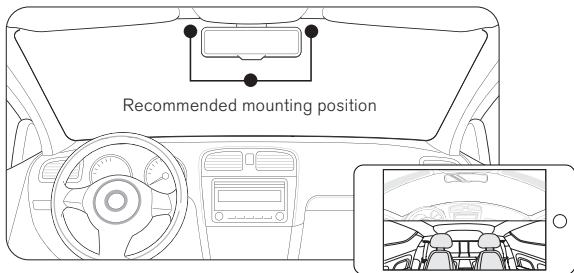

Check the live screen on Yada Drive APP and determine the most suitable mounting position. (See page 11 on setting up the APP).

Warning: Do not install the product in a location where it can obstruct driver's field of vision.

INSTALLATION

6.

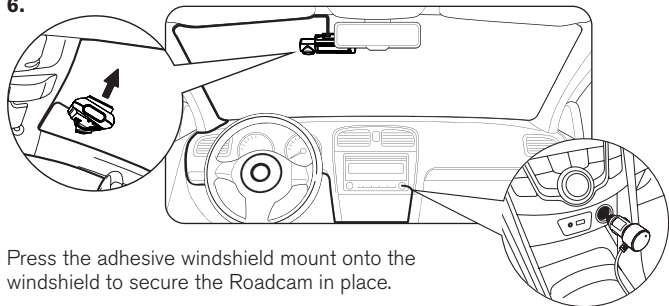

Press the adhesive windshield mount onto the windshield to secure the Roadcam in place.

Route and hide the power cable in the headliner and pillars in your vehicle. Plug the cigarette charger cable into your vehicle's 12/24V DC outlet, you are all set!

CONFIGURATION & MENU SETTINGS

Initial Setup

Set the date & time before installing and using the Roadcam. This date & time is the time stamp for all recorded media files.

- This is the default recording setting. The Roadcam will start recording automatically once it is turned on.
- Stop loop video: press the ⏸ button once to pause or resume recording.
- Press the 🎤 button during recording to turn the microphone on or off.
- Lock video: press the 🔒 button during recording to lock that recorded file.

G-Sensor Setting: The Roadcam's integrated G-Sensor will automatically save and lock the recorded file if activated by an impact event or accident. Select to turn the G-Sensor on or off. The default setting is low.

DOWNLOADING THE APP



The 360 2K Roadcam auto sync function enables you to control and play back recorded media files using your smartphone with the YADA Drive APP. Scan the QR code on the right or search "YADA Drive" in the APP Store or Google Play.



Compatible with iPhone 4s and higher, iPad3, iPad Mini, iPad Air and higher, and iPod touch 5th Generation and higher. Requires iOS 9.0 or higher.



Compatible with phones with Android™ 5.0 or higher.

APP SETUP

Auto-sync the Roadcam with your smart device

1. Turn on the power of the Roadcam, it will enter WiFi pairing mode automatically.
2. Launch the YADA Drive APP and tap on the Dash Cam category.
3. Select 360 2K Roadcam from the list of Dash Cams. Tap on **Set Up Device**.



Android device

4. The APP will search for Roadcam's SSID "YADA_DVR05_2K_XXXXXX" and connects to Roadcam automatically.

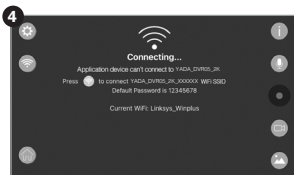

5. You should see the live view of the Roadcam if the connection is successful.

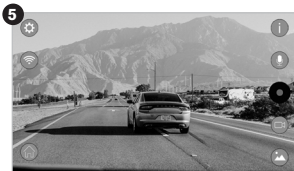

APP SETUP

iOS device (Follow steps 1-3 from previous page's instructions)

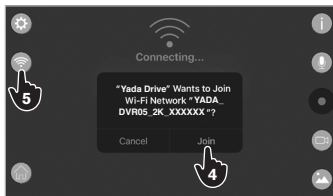

4. Tap **Join** on the main interface when it prompts you to join the Roadcam's SSID.

5. If there is any problem with auto pairing, tap the  icon and go to the WiFi settings page. On the WiFi settings page choose SSID "YADA_DVR05_2K_XXXXXX" and enter the password. (The default password is 12345678.)

6. Tap on the YADA Drive icon to return to the APP.

7. You should see the live view of the Roadcam.

NOTE: Tap on the  icon for more on-screen instructions.

12

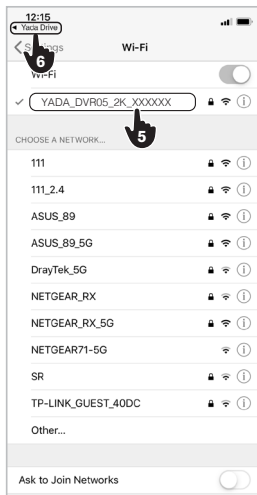

Main Interface



Display Mode

Select from 6 different viewing modes.

*Rotate the Camera Lens into front facing when switching to Normal 180° viewing mode.

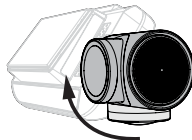

180° Normal 180°



360° Normal 360°



360° 360° VR



Fish Eye



2 in 1



4 in 1



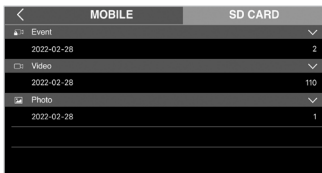

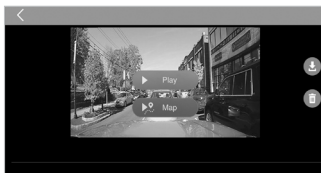

Gallery

Tap the  icon on the main interface to enter the media gallery. Tap the **SD CARD** tap to access the media files stored in the MicroSD card. Scroll down the list to select the file arranging from newest to oldest.





SD CARD tap

Tap the  icon to download the selected file into your smartphone, or tap the  icon to delete the file from the MicroSD card.





MOBILE Tap

Tap the **MOBILE** tap to access the downloaded files in your smartphone. You can manage files even if your phone is not auto sync with the Roadcam. Tap the  icon to share the selected file, or tap the  icon to delete the file.



GPS Information

You can tap  **Play** to play the footage or tap  **Map** to show GPS location while the footage is playing back.



GPS Signal Status 1

This status indicates GPS receiver is waiting for GPS signal when the footage is recorded. GPS trip data will resume once it picks up the signal. If this status appeared repeatedly please call our technical support to assist in troubleshooting.



GPS Signal Status 2

This status indicates map tracking is not working. Mobile data must be turned on for map tracking to process.

ADDITIONAL FEATURES

Automatic ON / OFF

When the Roadcam is connected to the vehicle's power, it will power on and start recording when the vehicle engine starts. When the engine is off, the Roadcam will stop recording and turn off automatically.

Gravity Induction Recording Protection System

In a vehicle collision, the Roadcam will lock the video of the accident and save it as a special image. At the same time, the icon of the lock will be displayed in the middle of the display screen. The locked image will not be overwritten by looped recordings.

Note: The G-Sensor supports sensitivity adjustment and it can be done in the video and camera settings page according to actual needs.

Note: The Roadcam is designed to be powered on while the vehicle is running. The built-in capacitor is only designed for storing documents when the vehicle's engine is off. The capacity of the built-in capacitor is limited. Please connect the Roadcam to the vehicle's on-board power supply for daily use.

Help / FAQs

- 1) Problem: The Roadcam is unable to take pictures and record videos.
Solution: Check if the MicroSD card has enough space and lock it.
- 2) Problem: The Roadcam stops automatically when it is recording a video.
Solution: Because HD video data takes a lot of space, please use a high-speed MicroSD card compatible with SDHC, high-speed MicroSD cards will have a U1 logo.
- 3) Problem: The image looks foggy.
Solution: Please check whether there is dirt or fingerprints on the lens. Clean the lens using lens cleaner or lens wiper before using.
- 5) Problem: The image looks too dark.
Solution: If the Roadcam captures an image that is too dark, adjust the exposure level to your desired brightness.

SAFETY INFORMATION

IMPORTANT SAFETY INSTRUCTIONS

1. **SAVE THESE INSTRUCTIONS** – This manual contains important safety and operating instructions of the 12V/24V cigarette lighter adapter for Model BT532767.
2. Before using the product, read all instructions and cautionary markings.
3. Do not expose cigarette lighter adapter to rain, moisture, or snow.
4. Use of an attachment not recommended or sold by the product manufacturer may result in a risk of fire, electric shock, or injury to persons.
5. To reduce risk of damage to cigarette lighter connector and cord, pull by cigarette lighter connector rather than cord when disconnecting cigarette lighter adapter.
6. Make sure cord is carefully secured so that it will not be stepped on, tripped over, or otherwise subjected to damage or stress.
7. Do not operate cigarette lighter adapter with damaged cord or cigarette lighter connector – replace it immediately.
8. Do not operate cigarette lighter adapter if it has received a sharp blow, been dropped, or otherwise damaged in any way; take it to a qualified serviceperson.
9. Do not disassemble cigarette lighter adapter; take it to a qualified serviceperson when service or repair is required. Incorrect reassembly may result in a risk of electric shock or fire.
10. To reduce risk of electric shock, unplug cigarette lighter adapter before attempting any maintenance or cleaning. Turning off controls will not reduce this risk.

WARNING: A failure to read and follow these warnings and instructions may result in a serious accident, including damaged property or a serious injury, including loss of life.

- Adhere to all applicable traffic laws and motor vehicle regulations applicable to the device.
- Consult local laws and regulations for any restrictions on installation or use.
- Never allow children to play with the device. Small parts may be a choking hazard.
- If the temperature changes rapidly, the system may not operate normally.
- When strong light directly enters a camera, objects may not be displayed clearly.
- The colors of objects on the 360 2K Roadcam APP-Controlled with GPS may differ from those of the actual object.
- Do not use alcohol or thinner to clean the camera. This will cause discoloration. To clean the camera, wipe with a clean cloth dampened with mild cleaner diluted with water and then wipe with a dry cloth.

MAINTENANCE & WARRANTY

Cleaning

- If dirt, rain water droplets, snow or mud adhere to the camera lens, rinse with water and wipe with a dry cloth.
- Do not use alcohol or thinner to clean the camera. This will cause discoloration. To clean the camera, wipe with a clean cloth dampened with mild cleaner diluted with water and then wipe with a dry cloth.

Warranty

YADA LIMITED WARRANTY

YADA warrants, to the original purchaser, that its products are free from defects in material and workmanship for 1 year from the date of original purchase. Where permitted by law, YADA's liability shall be limited to that set forth in this limited express warranty. This limited express warranty shall be the exclusive remedy of the purchaser and YADA makes no other warranty of any kind aside from the limited express warranty stated above.

Note: Warranty only applies for North American customers of purchases made in North America.

CONDITIONS OF WARRANTY

If during the 1 year warranty period your new product is found to be defective, YADA will repair such defect, or replace the product, without charge for parts or labor subject to the following conditions:

1. All repairs must be performed by YADA.
2. All warranty claims must be accompanied by a copy of the sales receipt or bill of sale.
3. The equipment must not have been altered or damaged through negligence, accident, improper operation, or failure to follow the product instructions for installation, use, or care.
4. The replacement of parts is excluded from the warranty when replacement is necessary due to normal wear and tear.
5. Repair or replacement parts supplied by YADA under this warranty are protected only for the unexpired portion of the original warranty.
6. This is a "repair or replace" warranty only, and does not cover the costs incurred for the installation, removal or reinstallation of the product, or damage to any mobile phone device or vehicle.

OWNER'S RESPONSIBILITIES:

YADA will make every effort to provide warranty service within a reasonable period of time. SHOULD YOU HAVE ANY QUESTIONS ABOUT SERVICE RECEIVED OR IF YOU WOULD LIKE ASSISTANCE IN OBTAINING SERVICE, PLEASE CALL TOLL FREE 1.866.294.9244 DURING REGULAR BUSINESS HOURS MONDAY THROUGH FRIDAY 8:00 AM TO 5:00PM.

Note: Toll Free # is for North America Customers ONLY. See Customer service section for customer contact numbers for other regions/offices.

For customer service and technical support, please call us at 1.866.294.9244. If at that time it is determined that a replacement unit is

needed, the support representative will issue a Return Authorization and instruct on how to get a new unit.

YADA makes no other warranty of any kind aside from the limited express warranty stated herein.

DISCLAIMER OF WARRANTIES, INCLUDING WARRANTY OF MERCHANTABILITY AND WARRANTY OF FITNESS FOR PARTICULAR PURPOSE: EXCEPT AS SPECIFICALLY SET FORTH HEREIN, NO WARRANTY OR REPRESENTATION, EXPRESS OR IMPLIED, IS MADE AS TO THE 360 2K ROADCAM APP-CONTROLLED WITH GPS. EXCEPT AS EXPRESSLY SET FORTH HEREIN, YADA AND/OR ITS AFFILIATES EXPRESSLY DISCLAIMS, WITHOUT LIMITATION, ANY STATUTORY WARRANTIES AND ALL IMPLIED WARRANTIES, INCLUDING ANY IMPLIED WARRANTY OF MERCHANTABILITY OR FITNESS FOR A PARTICULAR PURPOSE.

YADA and/or its affiliates do not guarantee or promise that the user of 360 2K Roadcam APP-Controlled with GPS will not be in an accident or otherwise not collide with an object and/or person. Our 360 2K Roadcam APP-Controlled with GPS is not intended in any way to be a substitute for careful and cautious driving or for the consistent adherence to all applicable traffic laws and motor vehicle safety regulations.

The 360 2K Roadcam APP-Controlled with GPS is not intended to be a substitute for rearview mirrors or for any other motor vehicle equipment mandated by law. Even when properly installed, our 360 2K Roadcam APP-Controlled with GPS has a limited field of vision and does not provide a comprehensive view of the rear area of the vehicle.

22 YADA and/or its affiliates are not responsible for a user's intended or actual

use of the 360 2K Roadcam APP-Controlled with GPS. In no event shall YADA and/or its affiliates have any liability for any losses (whether direct or indirect, in contract, tort or otherwise) incurred in connection with the 360 2K Roadcam APP-Controlled with GPS, including but not limited to damaged property, personal injury and/or loss of life. Neither shall YADA and/or its affiliates have any liability for any decision, action or inaction taken by any person in reliance on the 360 2K Roadcam APP-Controlled with GPS, or for any delays, inaccuracies and /or errors in connection with the 360 2K Roadcam APP-Controlled with GPS and its functioning.

YADA and/or its affiliates shall have no responsibility or liability for damage and/or injury resulting from accidents occurring with vehicles having the installed, and YADA and/or its affiliates, the manufacturer, distributor and seller shall not be liable for any injury, loss or damage, incidental or consequential, arising out of the use or intended use of the product.

GENERAL INFORMATION

Customer Service/Contact

IF YOU ARE EXPERIENCING ANY ISSUES WITH THE PRODUCT DURING OPERATION, DO NOT RETURN THE PRODUCT TO THE STORE. CONTACT YADA DIRECTLY FOR INSTRUCTIONS ON HOW TO RETURN/ EXCHANGE THE PRODUCT.

FCC Compliance Statement:

This device complies with Part 15 of the FCC rules. Operation is subject to the following two conditions: (1) This device may not cause harmful interference, and (2) this device must accept any interference received, including interference that may cause undesired operation.

Warning: Changes or modifications to this unit not expressly approved by the party responsible for compliance could void the user's authority to operate the equipment. The manufacturer is not responsible for any radio or TV interference caused by unauthorized modifications or change to this equipment. Such modifications or change could void the user's authority to operate the equipment.

Note: This equipment has been tested and found to comply with the limits for Class B digital device, pursuant to part 15 of the FCC Rules. These limits are designed to provide reasonable protection against harmful interference in a residential installation. This equipment generates, uses and can radiate radio frequency energy and, if not installed and used in accordance with the instructions, may cause harmful interference to radio or television reception, which can be determined by turning the equipment or and on, the user is encouraged to try to correct the interference by one or more of the following measures:

- Reorient or relocate the receiving antenna.
- Increase the separation between the equipment and the receiver.
- Connect the equipment into an outlet on a circuit different from that to which the receiver is connected.
- Consult the dealer or an experienced radio/TV technician for help.

This equipment complies with FCC RF radiation exposure limits set forth for an uncontrolled environment.

⚠ WARNING: This product can expose you to chemicals including Di(2-ethylhexyl)phthalate (DEHP) and Diisononyl Phthalate (DINP), which are known to the State of California to cause cancer and birth defects or other reproductive harm.

For more information go to www.P65Warnings.ca.gov.

360 2K Roadcam APP-Controlled with GPS

BT532767

Responsible Party:

YADA

2975 Red Hill Ave., Ste. 100, Costa Mesa, CA 92626

Tel: 1.866.294.9244

3M™ VHB is a trademark of 3M Company.

Android is a trademark of Google Inc.

iPhone, iPad, Mac and iPod touch are trademarks of Apple Inc.



Product code / Code de produit / Código del producto : BT532767

Register this product within 30 days of purchase to receive one **(1) additional year** of warranty coverage (beyond the standard 1-year warranty), along with special product offers and announcements.

Enregistrez ce produit dans les 30 jours suivant l'achat pour recevoir une couverture **supplémentaire de 1 AN** (au-delà de la garantie standard d'un an), ainsi que des offres et des annonces spéciales.

Registre este producto dentro de los 30 días siguientes a la compra para recibir un **(1) año adicional** de cobertura de garantía (más allá de la garantía estándar de un año), junto con ofertas de productos y anuncios especiales.

www.letsyada.com/register



@letsyada



Please contact our customer service before returning this product to the store. Our friendly representatives are happy to help with any questions or concerns you have.

Veuillez communiquer avec notre service à la clientèle avant de retourner le produit au magasin. Nos représentants se feront un plaisir de vous assister pour toute question ou préoccupation.

Póngase en contacto con nuestro servicio a clientes antes de regresar este producto a la tienda. A nuestros amables representantes les dará mucho gusto ayudarle con cualquier pregunta o inquietud que tenga.

**Mon-Fri, 8am-5pm PST / Lundi au vendredi, 8h à 17h HNP /
Lun-vie, 8 a. m. a 5 p. m. Hora del Pacífico
customercare@horizon-brands.com / 1.866.294.9244**



CONNECT WITH US |    @letsyada

2975 Red Hill Ave., Ste. 100, Costa Mesa, CA 92626
1.866.294.9244 | customercare@horizon-brands.com

© 2022 ADC Solutions Auto, LLC.

www.letsyada.com

ML-532767_V1