



ONE YEAR LIMITED WARRANTY & SATISFACTION GUARANTEE

This product is warranted to the original purchaser for one year from the date of purchase, against manufacturer's defects under normal use. Additionally, our top-notch customer service team can help you with any questions or issues. For full details, scan the QR Code.

JUST A FEW STEPS AWAY:



Open the Camera App on your phone



Point to the code and focus your camera on the code



Click the notification that pops up*

*If you're having trouble, download a QR Code App

If you have any questions about the unit or its operation, please call or email customer service.

+1(727)386-9117 ☎ Mon-Fri 9:00 AM - 5:00 PM (EST)

✉ support@zulay.net



Cold Press Masticating Juicer INSTRUCTION MANUAL

TROUBLESHOOTING

During juicing, the motor stopped:

- Check the power cord and make sure it is plugged in correctly.
- Check that all the parts are correctly assembled.
- If too many ingredients are inserted at one time, this can cause the juicer to stop.
- When the juicer stops because there are too many ingredients inserted in it, press the "R" for 3 seconds, then switch to "OFF" and then to "ON". Repeat as needed.
- Reversing will push the ingredients up, and "ON" function will pull the ingredients down.
- After using more than 15 minutes continuously, the overload protection feature may stop the juicer. Let the juicer cool for 30 minutes to 2 hours before juicing again.
- If there are hard seeds within the ingredients, remove them before juicing. Hard seeds can damage the juicer.

Plastic parts are discolored:

- After juicing, if the juicer is not cleaned right away, the remaining pulp inside the juicing bowl assembly can dry up, making disassembling and cleaning difficult. This can also affect the juicer's performance and color.
- Ingredients that are rich in carotenoids, such as carrots and spinach, may dye plastic parts. When the parts are dyed with carotenoids, rub vegetable oil or lemon juice into the dyed areas and use a mild detergent to clean.

If you have any questions about the unit or its operation, please call or email customer service.

☎ +1 (727) 386-9117 ☉ Mon-Fri 9:00 AM - 5:00 PM (EST)

✉ support@zulay.net

Thank you For Your Purchase

Thank you for choosing Zulay Kitchen's Cold Press Masticating Juicer. This user manual includes important information to help you operate the juicer safely and create your favorite juices.

Please read this manual prior to using the juicer. The simple maintenance actions are important to keep it operating.

If any issues ever come up, please feel free to reach out to our caring Kitchen Happiness customer service team.

We hope you enjoy using your new Juicer and sharing delicious drinks with your family and friends!

SAFETY INFORMATION

Please read this manual before using the unit and keep it for future reference. Operate the machine as directed.

- Ensure that you do not submerge the motor or base of the unit in water or other liquids to avoid the risk of electrical shock.
- Make sure that you closely supervise children when they are using the appliance.
- Always unplug the appliance from the outlet before cleaning, handling parts, or when it's not in use.
- Keep your hands and other objects away from the moving parts of the unit to avoid the risk of injury.
- Do not use this appliance if the power cord is damaged. Using the appliance with a damaged cord can be dangerous and may result in electrical shock or fire. Please contact customer service immediately.
- Using attachments that are not recommended or sold by the manufacturer can be dangerous and may result in fire, electric shock, or injury.
- This appliance is intended for indoor use only.
- To prevent the risk of accidental entanglement, avoid letting the power cord hang over the edge of the table or counter.
- Ensure that the juicer is properly assembled before turning on the motor.
- Turn switch to OFF position after using juicer. Make sure the motor stops completely before disassembling.
- Never insert your fingers or any objects into the juicer opening while it is running. If food gets stuck in the opening, use the food tamper to push it down. If this is not effective, turn off the motor and disassemble the juicer to remove the remaining food.

TROUBLESHOOTING

Appliance doesn't work:

- Check if the power cord is properly plugged in.
- Please ensure that the juicing bowl, strainer, auger, and drum lid are properly assembled to the base. Refer to page 5 for guidance if needed.
- Juicer will not operate if the parts are not properly assembled and if the arrows do not align.

During operation, the juicing bowl shakes:

- The auger and strainer are set up to crush and squeeze the ingredients. It is normal for the juicing auger and the strainer to vibrate.
- If the ingredient contains strong fiber, the vibration from the juicing bowl assembly may be stronger, to handle this cut the ingredients into 2-inch pieces to decrease the vibration.

Strange noise from the juicer:

- Check if the parts are assembled correctly. Try reassembling the parts and listen for the strange noise.
- Do not run the juicer without any ingredients.
- Operating the juicer without ingredients can cause damage to the auger.
- If the juicer is operated without ingredients or liquid, the noise level can increase and also can lead to damage.
- The friction noise from the juicing auger and the strainer will reduce when ingredients are inserted into the juicer.
- If the noise occurs when ingredients are inserted into the juicer, check the size of the ingredients. Do not insert any hard ingredients that are more than 2 inch thick.
- The noise can occur if the juicer is operated on an uneven or slanted surface. Place the juicer on a horizontally flat surface when operating.

HOW TO DISASSEMBLE AND CLEAN

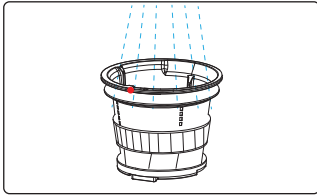

5. Place the removed parts under running water.

Note: Never immerse the base in water.

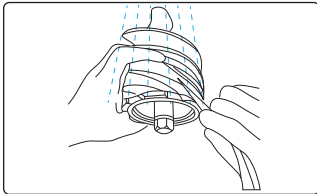

6. Clean the parts with the included brush and use dish soap as needed. Thoroughly clean the auger to make sure there are no starchy residues from vegetables or fruits. Dry completely before using.

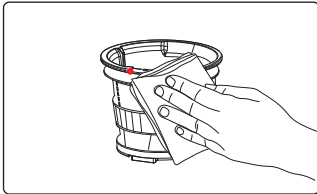

7. Thoroughly dry all the parts before assembling the unit.



8. If needed, clean the base with a slightly damp cloth. Ensure the unit is unplugged. Never immerse the base in water.

NOTE: Please note that these parts are not suitable for dishwasher use and should be washed by hand only.

SAFETY INFORMATION

- Do not operate this appliance if any of the parts of the unit are damaged, as this could cause injury or further damage to the appliance.
- Do not use the appliance for any purpose other than its intended use, as described in the manual.
- The appliance is designed for use in limited periods of time, no more than 30 minutes at a time. Extended use beyond this timeframe may cause the juicer's motor to overheat. If this happens, allow the appliance to rest for at least two hours before resuming operation.
- This appliance is not intended for use by persons (including children) with reduced physical, sensory or mental capabilities, or lack of experience and knowledge, unless they are supervised by a person responsible for their safety and given proper instruction.
- Keep the unit away from heat sources. Do not place the unit on or near a heated stovetop. Never place the unit inside an oven, over or near open flames, or in any other location that could cause damage from fire or heat.
- Do not use the juicer to extract vegetable oil from ingredients. It may reduce performance of the juicer and even damage it.
- Do not reinsert the extracted pulp into the juicer. This can cause the juicer to stop.
- Do not plug or unplug the appliance with wet hands.

Technical Specifications

Rated Voltage:	120V
Rated Frequency:	60Hz
Rated Power:	250W
RPM:	58rpm



CALIFORNIA PROPOSITION 65
This product may contain a chemical known to the state of California to cause cancer, birth defect or other reproductive harm.

For more information go to:
WWW.P65Warnings.ca.gov

PRODUCT ORIENTATION

Below is a diagram showing the parts of your juicer. Refer back to this as needed when reading the rest of the manual.

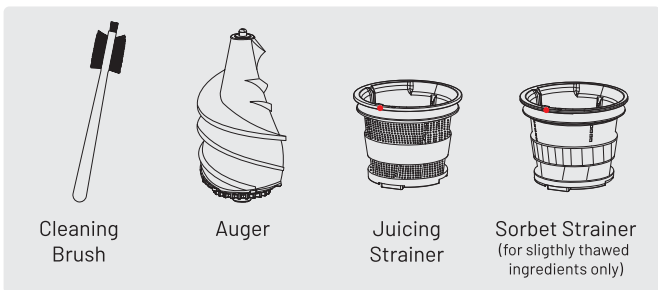
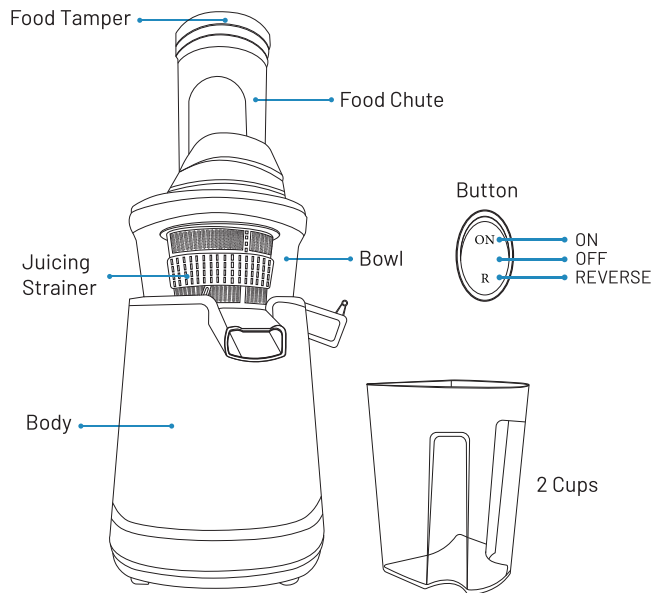

HOW TO DISASSEMBLE AND CLEAN

To simplify the cleaning process, run the juicer for an extra 30 seconds after juicing to eliminate any remaining pulp and juice.

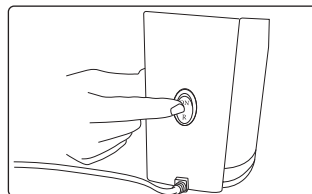

1. Switch to "OFF" and unplug the power cord from the wall outlet.

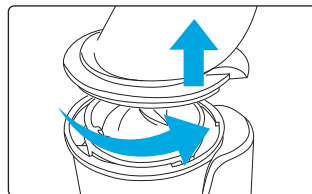

2. Turn the drum lid counter clockwise to open.

Note: When moving the appliance, always lift it by grabbing the body.

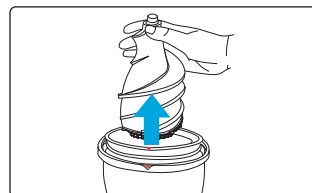

3. Pull the auger straight up.

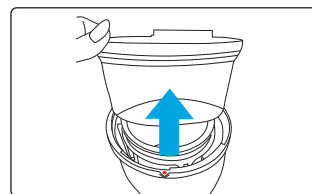

4. Remove the strainer and the juicing bowl by pulling them up.

Note: Immediately clean the juicer after each use. If remaining residue in the juicer dries up, it can make disassembling and clean-up difficult. The excess build up can cause poor performance in future uses.

HOW TO OPERATE THE JUICER

1. Place your juicer on a sturdy surface and plug it in. Ensure it's assembled as described in HOW TO ASSEMBLE the juicer.
2. Wash your ingredients well. Remove skin if it's citrus. Cut the ingredients into 2-inch long pieces.
3. Turn the machine on by switching the button to "ON" in the back of the juicer. Insert cut ingredients into the feeding tube.
4. Use the food tamper to push the ingredients into the chute.
5. After you finish juicing, switch the button to the middle position to turn in off. Unplug the unit.

If the juicer stops due to stuck ingredients:

First, switch the button to the "OFF" position (in the middle), and then switch it to "R" and hold it for 2-3 seconds to reverse the juicer. Release the button and push it again as needed. Once the food becomes unstuck, switch it back to the "ON" position and use the food tamper as necessary.

ON: Pulls the food down for juicing.

OFF: Stops the juicer's operation.

REVERSE: Pushes the food back up to clear any blockages.

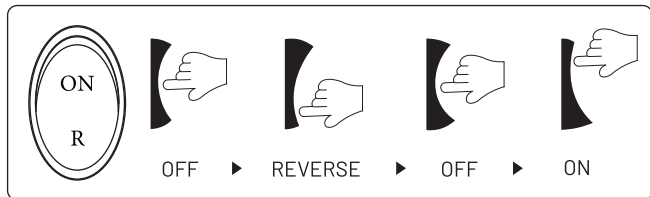

NOTE: If the juicer does not work after trying the previous steps, you should disassemble and thoroughly clean all parts before attempting to operate the juicer again.

HOW TO ASSEMBLE

This diagram shows the sequence in which the parts are attached to each other.

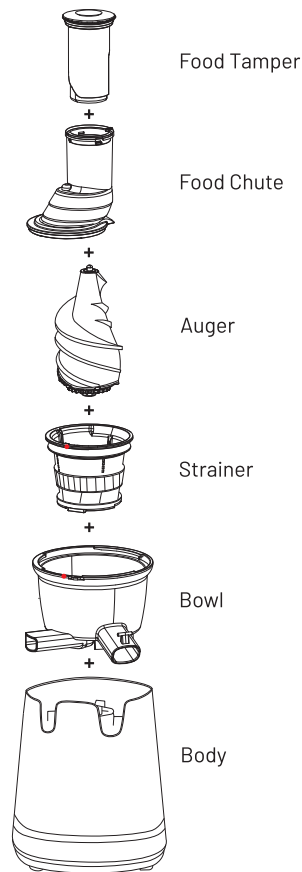

Food Tamper

Food Chute

Auger

Strainer

Bowl

Body

HOW TO ASSEMBLE

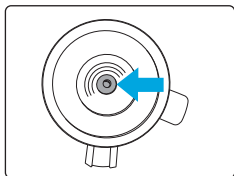

1. Ensure the silicone ring is properly attached to the bowl.

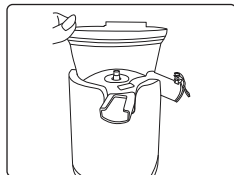

2. Place the juicing bowl on the base, ensuring that the front hole aligns with the pulp spout and the juice spout is positioned on the right hole of the base.

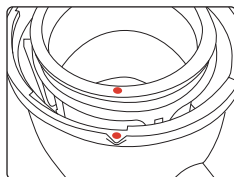

3. Assemble the strainer into the juicing bowl, ensuring the red dot on the strainer is aligned with the red dot on the juicing bowl.

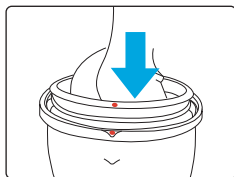

4. Place the auger into the strainer, ensuring that the wider bottom part of the auger is inserted downwards into the strainer.

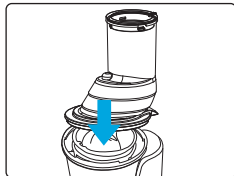

5. Place the drum lid on the top of your assembly. Align the "ON" sign on the drum lid with the red dot on the juicing bowl.

HOW TO ASSEMBLE

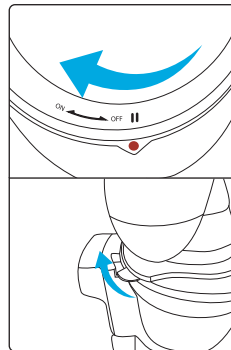

5. Turn the drum lid clockwise, aligning the juicing bowl's red dot with the "OFF" sign. Now the drum lid is locked in place. Ensure that the back part is securely locked.

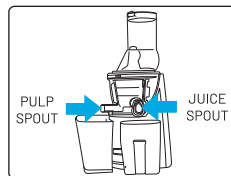

6. Place the pulp cup under the pulp spout and place the juice cup under the juice spout as shown in the illustration.

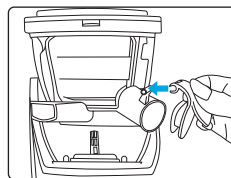

7. Attach juice cap to the juice chute.