

A SERVICE OPTION FOR NATURAL NAILS
REQUIRING STRENGTH, PROTECTION,
AND LIGHT SHAPE ENHANCEMENT.

CND PLEXIGEL™ Builder-Sculpted on a Form

STEP-BY-STEP GUIDE



Treatment time:

45-60 min



Suggested price:

\$65-75



Cost per treatment

\$5.17



SAMPLE MENU DESCRIPTION:

Get the look of long, beautiful nails that last without harsh chemicals or the risk of damage to your natural nails. First, you'll experience a safe, relaxing manicure. Next, your nail professional will hand-sculpt your nails to your desired length, focusing on shaping, smoothing, and building strength. Finally, your nails will be finished with a fabulous color of your choosing.





What you'll need:



CND Plexigel is versatile and convenient brush-in-a-bottle gel nail enhancement system that provides up to 3+ weeks of strength, length, and shape.

CND PLEXIGEL™ BONDER CND879

CND PLEXIGEL™ BUILDER CND880

CND PLEXIGEL™ PROTECTOR TOP COAT CND882

CND FUTURE FORMS, 200 COUNT CND883



COOLBLUE™
Hand Cleanser

CND158



OFFLY FAST™
Moisturizing Remover

CND450



SCRUBFRESH™ Nail
Surface Cleanser

CND159



CND™ Files and Buffers

CND175

CND176

Accessories/Equipment Required

We recommend using the items below:

- **CND™ LED Lamp** N1844
- **Sposh Terry Hand towels** JL714
- **Intrinsics plastic-backed, lint-free pads** CX122T
- **Complete Pro 99% Isopropyl Alcohol** CP186
- **Stainless Steel Cuticle pusher** NB159
- **Cuccio 1/2 Jaw Manicure nippers** CUC653
- **Ultra Fingernail Clipper with File** ULT07
- **Cuccio Under the Nail Cleaner Curette** CUC655
- **Ikonna IP-DXR Cordless Portable Drill, Rose Gold** YC105
- **3/32" Carbide Nail Bits Large Barrel, Silver, Fine Grit** NB271





Protocol

Step 1

PERFORM A MANICURE.

P

1. Have the client wash their hands with soap and running water for 20-30 seconds and towel dry.
2. Massage **COOLBLUE™** Hand Cleanser into the client's hands.
3. If necessary, remove any existing nail color from the natural nail using an acetone-based polish remover (**OFFLY FAST™** Moisturizing Remover) and a plastic-backed lint-free pad.*
4. If necessary, trim the length from each nail, using nail clippers.
5. Shape the free edge of each nail with a fine 240-grit file (**Kanga™ File** or **Koala Buffer™**).
6. Gently slide a **cuticle pusher** along the nail plate toward the proximal nail fold (cuticle area) and along each lateral fold (sides of nail) to lift and loosen any cuticle (non-living tissue) from the nail plate.**
7. Gently guide a **curette** along the nail plate to remove non-living tissue on the nail.
8. If necessary, use a **manicure nipper** to carefully remove any loose pieces of skin or hangnails.

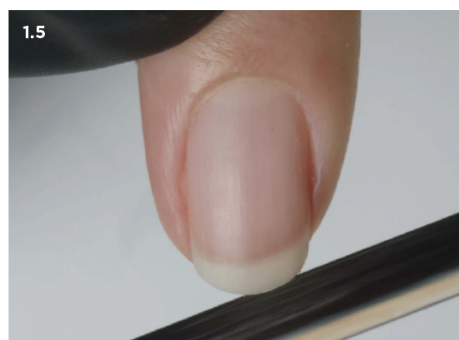

* Acetone-based polish removers like **CND™ OFFLY FAST™** is the quickest and safest way to remove nail color. Non-acetone-based polish removers will dissolve enamel more slowly and "smear" the color onto the cuticle area risking over-exposure.

** For clients who build excessive cuticle between services, apply a small amount of **CND™ CuticleAway™ Professional Cuticle Remover** evenly around the cuticle of each nail and perform cuticle service. Be sure to scrub nails thoroughly with soap and running water for at least 20-30 seconds to thoroughly remove the cuticle remover and towel dry.

R E P

REMOVE SHINE.

9. Remove shine from the natural nail surface with a fine 240-grit buffer (**Koala Buffer™**) in the direction of the natural nail growth. Optional: Use an enhancement prep bit at low speed with very gentle pressure with E-File.

ELIMINATE SURFACE CONTAMINANTS AND PURIFY NAIL PLATE LAYERS.

10. Thoroughly cleanse and temporarily dehydrate the nail plate layers with **SCRUBFRESH™** using a lint-free, plastic-backed pad. Pull back the skin and scrub the nail as if removing red nail polish.

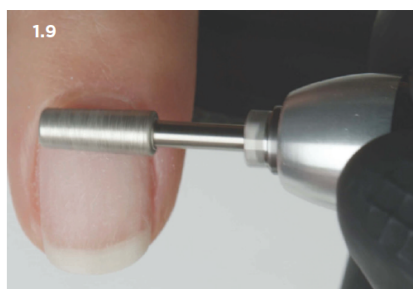



Protocol

Step 2

APPLY CND PLEXIGEL™ BONDER

1. Roll the bottle gently to blend.
2. Apply a thin layer of CND PLEXIGEL™ Bonder to all five nails, sealing the edge after each application. Always leave a tiny free margin around the perimeter of the nail to avoid the skin.
3. Cure for 10 seconds in the CND™ LED Lamp using preset button 1. Do not remove the top film after removing nails from the lamp.



Step 3

APPLY SCULPTING FORM

1. Prepare the form by cutting the back tab to allow for symmetrical placement on the finger.
2. Mold the form in to a gentle c-curve by holding the bottom tabs and rolling the form back and forth until the c-curve mimics the natural nail.
3. Place the form under the free edge and press along the lateral sides to analyze where the sidewall of the nail aligns with to the form.
4. Remove the form and use cuticle scissors to pre-tailor the form if necessary.
5. Place the form under the free edge, ensuring it fits snugly against the free edge line. This will help prevent product “seepage” under the nail during sculpting.
6. Squeeze the front tabs together and press tabs up toward the nail to create a perfect fit, making sure the sidewall lines are straight and align to the nail.
7. Cut the excess tabs underneath the finger to assure a proper distance of the hand to the bulbs of the CND™ LED lamp.

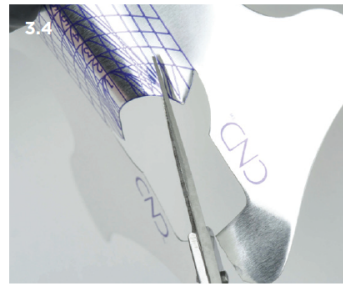
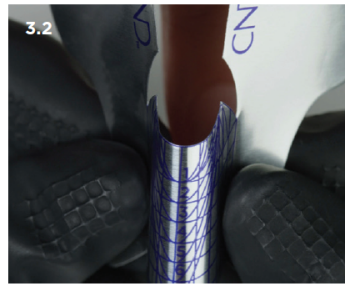
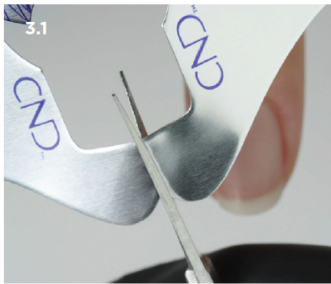



Protocol

Step 4

APPLY CND PLEXIGEL™ BUILDER

OPTIONAL: For clients with heat sensitivity, apply a thin layer of CND PLEXIGEL™ Shaper to the natural nail and cure for one minute in the CND™ LED Lamp using preset button 2B.

1. Apply a thin, even layer of CND PLEXIGEL™ Builder to the natural nail.
2. Apply a drop of gel to the form to create desired length and shape.
 - a. Use the tip of the brush to feather the gel into Zone 2.
 - b. Flash cure for 2-3 pulses in the CND™ LED Lamp on Button 1. Repeat on remaining nails.
3. Remove the form and cure for one minute in using preset button 2B.
4. Apply a second layer of Builder to create shape and architecture.
 - a. Apply gel down the vertical center of the nail and feather to taper on both sides.
 - b. Use gravity pull by turning the finger over to help further define the apex.
 - c. Flash cure as needed to prevent gel from running and to control the sensation of heat on the nail.
5. Cure for one minute using preset button 2B.
6. In needed, fill in any low spots. Touch the tip of the brush to one side of the low spot and lift up creating a thin strand of product. Pull the strand across the low spot and touch the opposite side. Allow the gel to level.
7. Cure for one minute using preset button 2B.

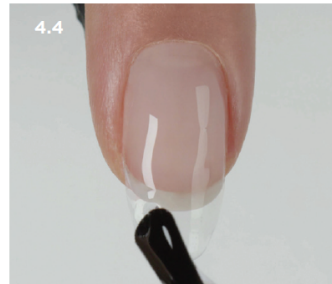
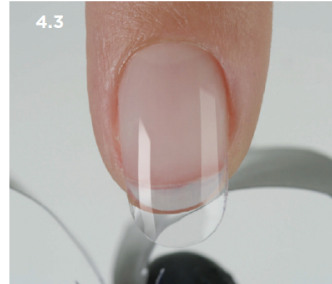
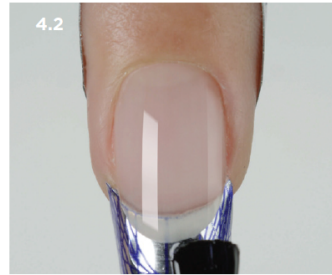

Step 5

PERFECT THE SHAPE

1. Remove the top film with cotton pad saturated with 99% Isopropyl Alcohol.
2. Refine the nail shape using a 180-grit file and buffer (Boomerang Padded File or Blizzard File™)
Optional: Use a medium grit diamond bit at ½ speed with E-File.
 - a. Shape and define the left side of the nail
 - b. Shape and define the right side of the nail
 - c. Bevel zone 3 to establish the C-curve
 - d. Refine and blend the cuticle line
 - e. Refine and smooth apex
 - f. Shape front form and refine lower arches
3. Remove dust and cleanse the nail with 99% Isopropyl Alcohol.

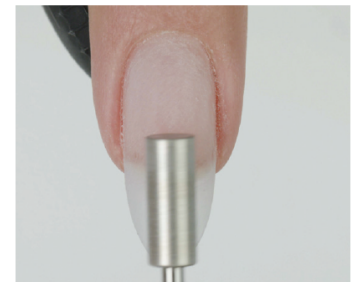



Protocol

Step 6

APPLY CND PLEXIGEL™ PROTECTOR TOP COAT

Use to seal and protect clear enhancements or prior to applying CND™ VINYLUX™ Long Wear Polish.

1. Roll the bottle gently to blend.
2. Apply a layer of CND PLEXIGEL™ Protector Top Coat to all five nails sealing the free edge after application.
3. Cure for one minute in the CND™ LED Lamp using preset button 3.
4. Lightly wipe to remove top film with lint-free pad or cosmetic sponge saturated with 99% Isopropyl Alcohol.



Step 7

ADD COLOR

(Option for gel polish)

If using CND™ SHELLAC™ Gel Polish, skip Protector Top Coat and CND™ SHELLAC™ Base Coat.

1. Shake CND™ SHELLAC™ Color vigorously to blend.
2. Apply two thin layers of color coat to all five nails using the 5- point polish method.
3. Cure each layer for one minute in the CND™ LED Lamp using preset button 2S.
4. Apply a layer of CND™ SHELLAC™ Top Coat to all five nails.
5. Cure for one minute using preset button 3.
6. Lightly wipe to remove top film with cotton pad or cosmetic sponge saturated with 99% Isopropyl Alcohol.

