

# SHELLAC™ Brand Application & Removal



**45 MIN** SHELLAC™ Brand 14+ Day Nail Color combines the ease of polish with high-performance wear and stunning shine. A true innovation in chip-resistant, long-lasting nail color.

## Application on Fingernails:

### STEP 1:

## P.E.P. - Natural Nail Preparation (No Buffing)

For more detailed information see the *CND P.E.P. Technique Step-By-Step*.

### 1. P - Perform a manicure.

- a. Have the client wash their hands with soap and water and towel dry.



- b. Massage **COOLBLUE™** Hand Cleanser into the client's hands to cleanse skin.



- c. Remove any existing nail color from the natural nail using an acetone-based polish remover (**OFFLY FAST™** Moisturizing Remover) and a plastic-backed lint-free pad.

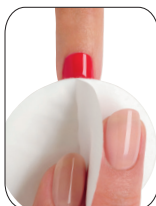

- d. If necessary, trim the length from each nail, using nail clippers.

- e. Shape the nail edge (tip of the nail) with a **soft grit Kanga™ File** or **Koala Buffer™**.

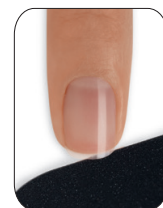

- f. Apply a small amount of **CuticleAway™** Professional Cuticle Remover evenly around the cuticle of each nail.\*



- g. Gently slide a **cuticle pusher** along the nail plate to lift cuticle.

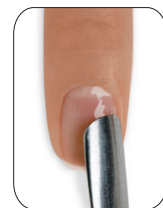

- h. Remove any excess **CuticleAway™** from the nail and use a **curette** to remove cuticle.



- i. Clean with soap and water, rinse and towel dry.\*

- j. Use a **manicure nipper** to carefully remove any loose pieces of skin or hangnails. Use a gentle touch and never cut skin as it can lead to infection.



\* Dry P.E.P. is an excellent option for clients with great natural nails, who do not build excessive cuticle between services. Eliminating the wet cuticle treatment can shorten the service time and increase adhesion for some clients.

2. **E - Eliminate** surface contaminants, dust, lint or skin and
- P - Purify** nail plate layers.

- a. Cleanse and temporarily dehydrate the nail plate with **SCRUBFRESH™** Nail Surface Cleanser and a lint-free, plastic-backed pad. Pull back the skin and scrub the nail as if removing red nail polish.

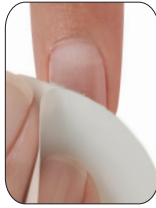

## **STEP 2:** SHELLAC™ Base Coat Application

Enhance service and speed with the **CND 5 Point Polish Method** - an easy, systematic approach for polish perfection that will bring out the best in SHELLAC™ Brand 14+ Day Nail Color. (For more detailed information see the **CND 5 Point Polish Method** Step-by-Step.)

1. Shake to blend.
2. Apply one thin layer of **SHELLAC™ Base Coat** to extension edge and nail surface.
3. Apply to **five nails** and **cure** each hand for **10 seconds (preset button 1)** in the **CND™ LED Lamp**. Do not remove the top film after removing the nails from the lamp.

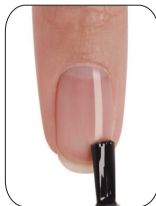

## **STEP 3:**

## SHELLAC™ Color Coat Application

### Solid Color:

1. Shake vigorously to blend.
2. Apply one thin layer of **SHELLAC™ Color Coat** to extension edge and nail surface (this layer will be slightly semi-sheer if applied correctly).



3. Apply to **five nails** and **cure** each hand for **one minute (preset button 2S)** in the **CND™ LED Lamp**.\* Do not remove the top film after removing the nails from the lamp.



4. Apply a second thin layer of Color Coat to the nail surface. The second layer will provide additional coverage and color, refining and perfecting the tiny free margins with each layer.



5. Apply to **five nails** and **cure** each hand for **one minute (preset button 2S)** in the **CND™ LED Lamp**.\* Do not remove the top film after removing the nails from the lamp.



\*If using the **CND™ UV Lamp**, cure for two minutes.

## French Manicure:

1. Shake vigorously to blend.
2. Apply one thin layer of your chosen pink to extension edge and nail surface.

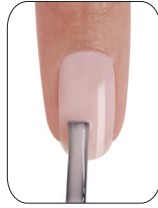

3. Apply to **five nails** and **cure** each hand for **one minute (preset button 2S)** in the **CND™ LED Lamp.\*** Do not remove the top film after removing the nails from the lamp.



4. Apply a second thin layer of Color Coat to the nail surface. The second layer will provide additional coverage and color, refining and perfecting the tiny free margins with each layer.

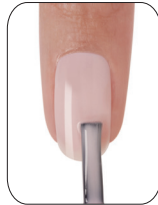

5. Apply to **five nails** and **cure** each hand for **one minute (preset button 2S)** in the **CND™ LED Lamp.\*** Do not remove the top film after removing the nails from the lamp.



6. Apply a thin layer of white **SHELLAC™ Color Coat** to the tips of the nails and extension edge, in an arched smile line, to flatter the nail shape. Carefully detail with the **CND™ ProSeries Gel Flat Oval Brush** lightly moistened with **99% Isopropyl Alcohol** to perfect the smile line.



*Note: Applying the white tip on top of a pink base will assure that the detailing brush doesn't remove the critical Base Coat layer during this refinement step.*

7. Apply to **five nails** and **cure** each hand for **one minute (preset button 2S)** in the **CND™ LED Lamp.\*** Do not remove the top film after removing the nails from the lamp.



*\*If using the CND™ UV Lamp, cure for two minutes.*

© 2017 Creative Nail Design, Inc. 17/09 #CND0598

## STEP 4:

## SHELLAC™ Top Coat Application

1. Shake to blend.
2. Apply one thin layer of **SHELLAC™ Top Coat** to each extension edge and nail surface.



3. Apply to **five nails** and **cure** each hand for **one minute (preset button 3)** in the **CND™ LED Lamp.\***



4. Remove the top film with a plastic-backed, lint-free pad saturated with **99% Isopropyl Alcohol**.

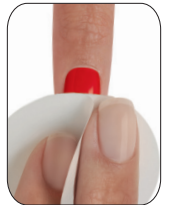

5. Condition the nails and surrounding soft tissue with **SOLAROIL™ Nail & Cuticle Care** and send a bottle home with the client for daily conditioning.



CND 

Nails. Fashion. Beauty.

## Removal from Fingernails:

### STEP 1:

# SHELLAC™ Brand Removal

1. Have the client wash their hands with soap and water and towel dry.



2. Massage **COOLBLUE™** into the client's hands to cleanse skin.



3. Wrap each finger with a **CND™ Foil Remover Wrap**.

- a. Saturate the cotton pad on the **CND™ Foil Remover Wrap** with **OFFLY FAST™**.



- b. Place wrap under the finger with the edge of the cotton pad underneath the extension edge of the nail.

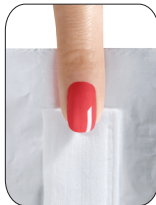

- c. Fold the cotton pad over the top of the nail.



- d. Wrap the **CND™ Foil Remover Wrap** around the finger, ensuring a snug fit.



- e. Squeeze the top center of the foil together to secure.

4. Leave the **CND™ Foil Remover Wrap** on the finger for the **designated time** based on the **SHELLAC™ Top Coat** used during application.



SHELLAC™ TOP COAT	REMOVAL TIMES
<i>XPRESS5™</i>	5 MINUTES
ORIGINAL	8 MINUTES
DURAFORCE™	15 MINUTES
SPECIAL EFFECTS	8-10 MINUTES

5. Securely grip each finger and apply slight pressure to the fingernail.

6. If necessary, gently slide off any remaining product with an orangewood stick in the direction of nail plate growth. Be careful not to scrape away the surface layers of the natural nail plate.



7. Rub the nail with a plastic-backed, lint-free pad saturated with **OFFLY FAST™** to remove any residue.



## Application on Toenails:

### STEP 1:

## P.E.P. - Natural Nail Preparation (No Buffing)

For more detailed information see the *CND P.E.P. Technique Step-By-Step*.

### 1. P - Perform a pedicure.

- a. Wash client's feet with soap and water, or soak in a pedicure tub with your choice of **CND™ Spa Collection** or **SPAPEDICURE™** soak products. Towel dry.

- b. Massage **COOLBLUE™** into hands to cleanse skin.



- c. Remove any existing nail color from the natural nail using an acetone-based polish remover (**OFFLY FAST™** Moisturizing Remover) and a plastic-backed lint-free pad.



- d. If necessary, trim the length from each nail, using nail clippers.

- e. Shape the nail edge (tip of the nail) with a **soft grit Kanga™ File** or **Koala Buffer™**.



- f. Apply a small amount of **CuticleAway™** evenly around the cuticle of each nail.



- g. Gently slide a **cuticle pusher** along the nail plate to lift cuticle.

- h. Remove any excess **CuticleAway™** from the nail and use a curette to remove cuticle.

- i. Clean with soap and water, rinse and towel dry.

- j. Use a **manicure nipper** to carefully remove any loose pieces of skin or hangnails. Use a gentle touch and never cut skin as it can lead to infection.



2. **E - Eliminate** surface contaminants, dust, lint or skin and  
**P - Purify** nail plate layers.

- a. Cleanse and temporarily dehydrate the nail plate with **SCRUBFRESH™** and a lint-free, plastic-backed pad. Pull back the skin and scrub the nail as if removing red nail polish.



### STEP 2:

## SHELLAC™ Base Coat Application

Enhance service and speed with the **CND 5 Point Polish Method** - an easy, systematic approach for polish perfection that will bring out the best in **SHELLAC™** Brand 14+ Day Nail Color. (For more detailed information see the **CND 5 Point Polish Method** Step-by-Step.)

1. Shake to blend.

2. Apply one thin layer of **SHELLAC™ Base Coat** to each extension edge and nail surface.



3. Apply to **five nails** and **cure** each foot for **10 seconds (preset button 1)** in the **CND™ LED Lamp**. Do not remove the top film after removing the nails from the lamp.





### STEP 3:

## SHELLAC™ Color Coat Application

1. Shake vigorously to blend.

2. Apply one thin layer of **SHELLAC™ Color Coat** to extension edge and nail surface (this layer will be slightly semi-sheer if applied correctly).

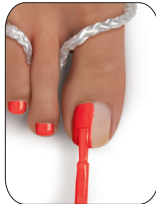

3. Apply to **five nails** and **cure** each foot for **one minute** (**preset button 2S**) in the **CND™ LED Lamp**.\* Do not remove the top film after removing the nails from the lamp.



4. Apply a second thin layer of Color Coat to the nail surface. The second layer will provide additional coverage and color, refining and perfecting the tiny free margins with each layer.

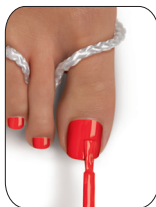

5. Apply to **five nails** and **cure** each foot for **one minute** (**preset button 2S**) in the **CND™ LED Lamp**.\* Do not remove the top film after removing the nails from the lamp.



### STEP 4:

## SHELLAC™ Top Coat Application

1. Shake to blend.

2. Apply one thin layer of **SHELLAC™ Top Coat** to extension edge and nail surface.

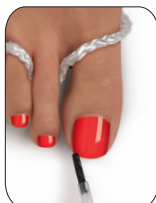

3. Apply to **five nails** and **cure** each foot for **one minute** (**preset button 3**) in the **CND™ LED Lamp**.\*



4. Remove the top film with a plastic-backed, lint-free pad saturated with **99% Isopropyl Alcohol**.

5. Condition the nails and surrounding soft tissue with **SOLAROIL™** and send a bottle home with the client for daily conditioning.



## Removal from Toenails:

### STEP 1:

## SHELLAC™ Brand Removal

1. Wash client's feet with soap and water, or soak in a pedicure tub with your choice of **CND™ Spa Collection** or **SPAPEDICURE™** soak products. Towel dry.

2. Massage **COOLBLUE™** into hands to cleanse skin.



3. Wrap the large toenail with a **CND™ Foil Remover Wrap** and wrap the smaller toes with cotton and foil.

### To use the wrap:

a. Saturate the cotton pad on the **CND™ Foil Remover Wrap** with **OFFLY FAST™**.



b. Place wrap under the toe with the edge of the cotton pad underneath the extension edge of the nail.

c. Fold cotton pad over the top of the nail and wrap around toe, ensuring a tight, snug fit.

d. Squeeze the top center of the foil together to secure.

\*If using the **CND™ UV Lamp**, cure for two minutes.

**To use cotton and foil:**

- a. Saturate cotton with **OFFLY FAST™**.
- b. Place saturated cotton on each small toenail.
- c. Cut a piece of foil large enough to wrap all four smaller toes.
- d. Place foil under toes and wrap toes to secure cotton in place on top of nails.

4. Leave the **CND™ Foil Remover Wrap** and cotton and foil on the toes for the **designated time** based on the **SHELLAC™ Top Coat** used during application.



SHELLAC™ TOP COAT	REMOVAL TIMES
<i>XPRESS5™</i>	5 MINUTES
ORIGINAL	8 MINUTES
DURAFORCE™	15 MINUTES
SPECIAL EFFECTS	8-10 MINUTES

- 5. Securely grip each toe and apply slight pressure to the toenail.
- 6. Using a twisting motion, pull the **CND™ Foil Remover Wrap** or cotton and foil from the toenail. If a significant amount of **SHELLAC™ Nail Color** remains on the nail (due to extended wear or other unique situations), rewrap the nail and allow **OFFLY FAST™** to penetrate a few more minutes.
- 7. If necessary, gently slide off any remaining product with an orangewood stick in the direction of nail plate growth. Be careful not to scrape away the surface layers of the natural nail plate.
- 8. Rub the nail with a plastic-backed, lint-free pad saturated with **OFFLY FAST™** to remove any residue.



**PRODUCTS REQUIRED**

- COOLBLUE™** Hand Cleanser
- OFFLY FAST™** Moisturizing Remover
- CuticleAway™ Professional Cuticle Remover
- SCRUBFRESH™** Nail Surface Cleanser
- CND™** Gel Flat Oval Brush #6\*
- CND™** Files and Buffers
- SHELLAC™** Base Coat
- SHELLAC™** Color Coat
- SHELLAC™** Top Coat
- CND™** Foil Remover Wraps
- SOLAROIL™** Nail & Cuticle Care

**ACCESSORIES/EQUIPMENT REQUIRED**

- CND™** LED Lamp
- Hand towels
- Hand soap
- Cotton & Foil
- Plastic-backed, lint-free pads
- Disinfectable dust brush\*
- 99% Isopropyl Alcohol
- Cuticle pusher
- Manicure nippers
- Nail clippers
- Curette

\*Optional