



# Gusto Smoke Infuser

## User Manual



Precision Appliance Technology, Inc.

Website: [www.vestaprecision.com](http://www.vestaprecision.com)

# TABLE OF CONTENTS

IMPORTANT SAFETY INFORMATION .....	3
PRODUCT COMPONENTS.....	4
OPERATING INSTRUCTIONS.....	5
Preparing the Gusto .....	5
Using the Gusto .....	5
MAINTENANCE .....	8
Cleaning and storage .....	8
TECHNICAL PARAMETERS .....	11
LIMITED WARRANTY AND AFTER SALES SERVICE .....	12
Returns.....	12
Exchanges .....	12
Warranty Replacements .....	13
Shipping Charges.....	13
Damaged and Defective Items.....	14
What Does This Limited Warranty Not Cover? .....	14

## IMPORTANT SAFETY INFORMATION

When using this appliance, basic safety precautions should always be followed including:

1. Read and understand all instructions.
2. Operate the appliance indoors only on a dry, stable, hard surface.
3. Do not use the appliance on a hot surface or in wet conditions.
4. Do not operate the appliance if it malfunctions or is damaged.
5. Use this appliance for its intended use only.
6. Only apply enough flame to the chips to create a smolder and generate the smoke for the desired use.
7. Children should not use this appliance. When in use around children, close supervision by an adult is necessary and the appliance should be kept out of their reach.
8. This appliance is not intended for use by people with reduced physical, sensory or mental capabilities or who lack experience with cooking appliances.
9. Always use food-grade chips recommended by the manufacturer as suitable for smoke infusing.

# PRODUCT COMPONENTS

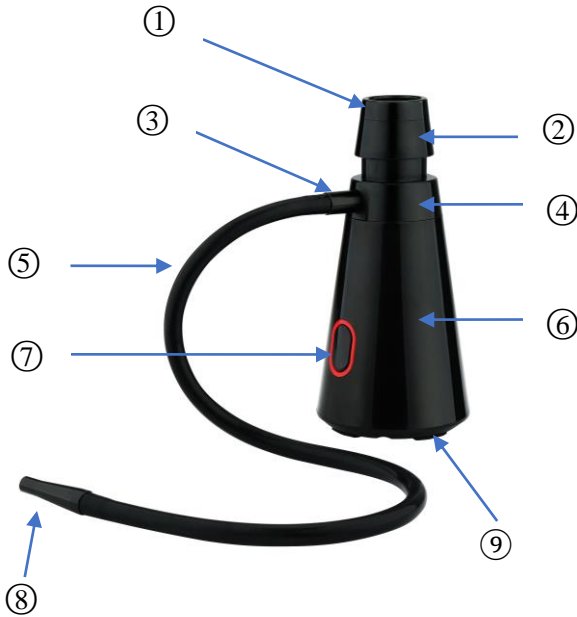

- |                               |                  |
|-------------------------------|------------------|
| 1. Burn Chamber Cover         | 2. Burn Chamber  |
| 3. Smoke Outlet               | 4. Smoke Chamber |
| 5. Smoke Tube                 | 6. Main Body     |
| 7. On/Off Switch              | 8. Smoke Nozzle  |
| 9. Battery Cover (underneath) |                  |

Not Shown:

Filter Screens   Ashtray   Glass Disc

# OPERATING INSTRUCTIONS

## Preparing the Gusto

Press the smoke nozzle onto the smoke hose and then press the smoke hose onto the smoke outlet.

Remove burn chamber cover by unscrewing counterclockwise and check that the screens and ash tray are in place.

## Using the Gusto

1. Unscrew the burn chamber cover counterclockwise.
2. Load the wood chips into the burn chamber.
3. Replace the burn chamber cover by screwing it onto the burn chamber finger tight.
4. Place the smoke nozzle into the desired container.
5. Press the On/Off Switch to turn on the Gusto.

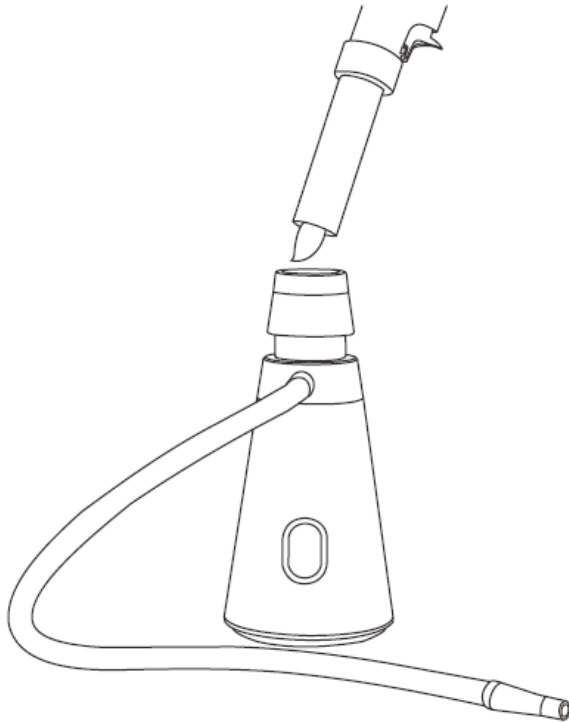

6. Ignite the chips with a long tip butane lighter.
7. Align the nozzle with the food or beverage to be smoked.

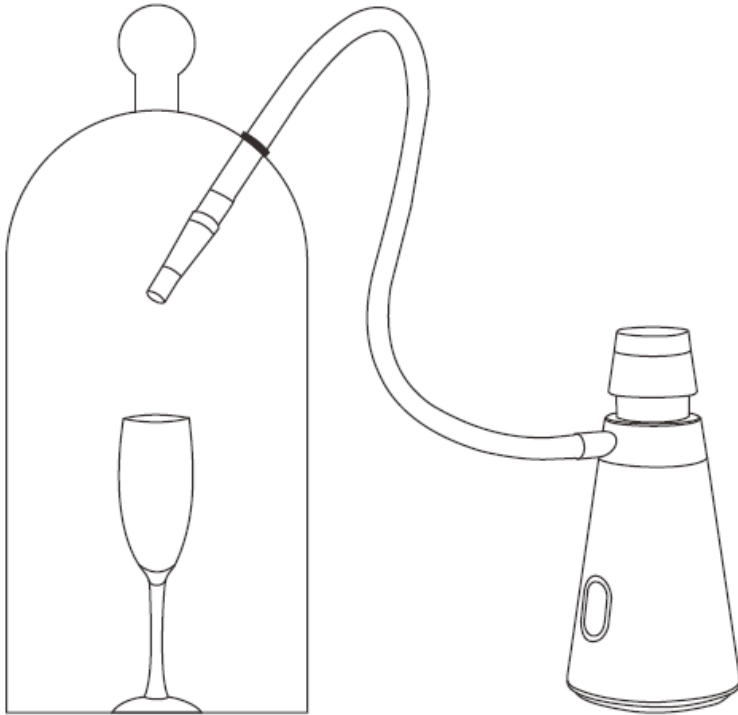

For more effective smoke effects,  
use a dome or cloche as shown above.

8. Press the On\Off Switch to turn off the Gusto when the smoke ends or the desired level of smoke is generated.

# MAINTENANCE

## Cleaning

After using, remove unused wood chips and ashes from the burn chamber to avoid clogging the smoke chamber, outlet, and tube. If burning oily wood chips, be sure to clean the filters, ashtray, burn chamber, smoke chamber, smoke tube, and smoke nozzle in warm soapy water, rinsing and drying well afterward.

### Remove and clean the burn chamber

- Unscrew the burn chamber cover counterclockwise.
- Remove the burn chamber by unscrewing counterclockwise.
- Remove the burn chamber filter (Filter A), the ashtray, and the smoke chamber filter (Filter B).
- Clean all of these components with warm soapy water, rinse well, and dry thoroughly before re-assembly in reverse order.

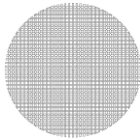

Filter A

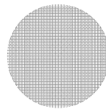

Filter B

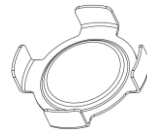

Ashtray

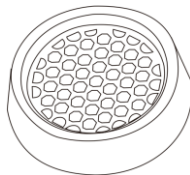

Burn chamber cover



Burn chamber

**NOTE:** In order to achieve the best smoke effect, keep the air passage clear and when installing the filter, curve it slightly like a dome.





## Clean the pipe assembly

- Remove the smoke outlet, smoke tube, and smoke nozzle assembly.

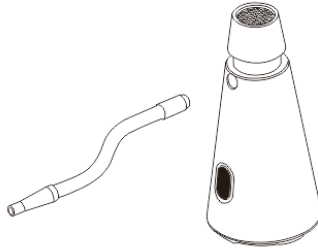

- Remove the nozzle and outlet from the two ends of the tube and clean them all in warm soapy water, rinsing well. Dry them thoroughly before re-assembly.



## Clean the smoke chamber

- With the burn chamber and smoke outlet removed, unscrew the smoke chamber counterclockwise.

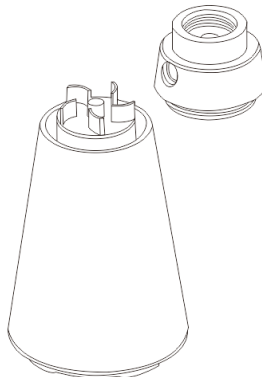

- Pull up to remove the fan blade assembly. Clean the fan blades and smoke chamber with warm soapy water and rinse

thoroughly. The device body should not be immersed in water for cleaning. Wipe out any oily residue from the device body, then wipe it with damp cloth. Dry all parts completely after cleaning before re-assembly.

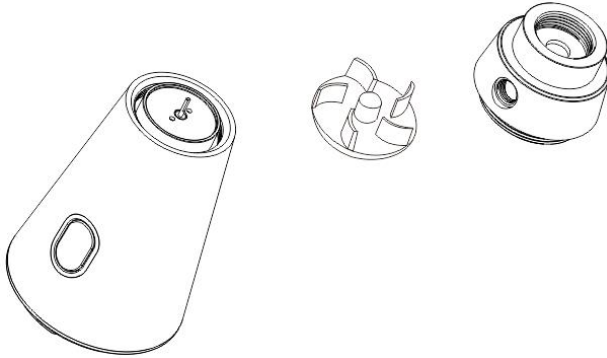

## Storage

When the Gusto will not be used for a long time, clean the device per the above instructions and remove the batteries before storing in a cool and dry place, preferably in the original packaging.

### How to remove the batteries

- Gently press the button on the battery cover and remove the battery cover.
- Gently pull the battery holder out of the main body
- Remove the batteries from the battery holder.
- Replace the battery holder and battery cover.

**NOTE: Batteries should be recycled according national and local regulations. Batteries should be removed before storing long term or discarding the device.**

## TECHNICAL PARAMETERS

Voltage: DC6V=4\*1.5VDC、AA (5#) dry battery

Power: 0.25W

Dimension: D84x100x180 mm

# LIMITED WARRANTY AND AFTER SALES SERVICE

## Returns

If you are not fully satisfied, our products come backed with a 30 day, no questions asked, money-back guarantee. To be eligible for a full refund, you must:

- Have purchased your product in the last 30 days directly from Vesta Precision
- Have the original order number or email that was used during your purchase
- Email your request for your return and full refund

*Full refunds can only be provided within 30 days of purchase directly from Vesta Precision. Devices purchased through resellers, retail partners, or other websites are not eligible for a return and full refund. Please consult their return policies for more information. We cannot provide a full refund for any damaged devices not covered under our limited warranty.*

## Exchanges

We provide products with a few different options. Retail exchanges are eligible within 30 days of original date of purchase. To be eligible for an exchange, you must:

- Have purchased your product in the last 30 days directly from the Vesta Precision
- Have the original order number or email that was used during your purchase
- Email us to request an exchange

*Retail exchanges can only be provided within 30 days of purchase directly from Vesta Precision. Products purchased through resellers, retail partners, or other websites are not eligible for a retail exchange. Please consult their exchange policies for more information. We cannot provide a retail exchange for any damaged devices not covered under our limited warranty.*

## **Warranty Replacements**

Our products come with a 2-year limited warranty. Warranty replacements are eligible within 2 years of original date of purchase. To be eligible for a warranty replacement, you must:

- Have purchased the product within the last 2 years
- Have the original order number or email that was used during your purchase. If purchased through a reseller, retail partner, or other website, you must provide a copy of your original receipt
- Email us to request warranty service

*Warranty replacements can only be provided within 2 years of original purchase date. We cannot provide a warranty replacement for any damaged devices not covered under our limited warranty.*

## **Shipping Charges**

Shipping charges incurred in connection with the return, exchange, or warranty replacement are paid for by Vesta Precision via prepaid waybill issued by the support team.

## Damaged and Defective Items

If you received a damaged or defective product, notify us immediately for assistance via phone, email, or web support. Please note that if we do not have an exact replacement for your unit, we will replace it with a similar unit of equal or greater value.

## What Does This Limited Warranty Not Cover?

This limited warranty does not cover damages directly or indirectly arising or resulting from or during

- non-intended use of the product for any purpose not described in the user manual, and
- non-intended use with another product or other damage or loss suffered by such use or in combination with any other item
- accident, misuse, abuse, vandalism, power surges or acts of God (including lightning and other weather conditions)
- improper or inadequate maintenance
- unauthorized disassembly or modification
- repairs by an unauthorized service technician

WE ARE NOT RESPONSIBLE FOR AND THIS LIMITED WARRANTY DOES NOT EXTEND TO ANY CONSEQUENTIAL, INDIRECT, SPECIAL, INCIDENTAL OR PUNITIVE DAMAGES ARISING OUT OF OR RELATING TO THE UNIT. Some jurisdictions do not allow the exclusion or limitation of incidental or consequential damages, so the above limitation may not apply to you. This limited warranty is not transferable and is limited to the original purchaser.



Precision Appliance Technology, Inc.

Questions or Problems?

Contact support via

Website: [www.vestaprecision.com](http://www.vestaprecision.com)

Email: [support@vestaprecision.com](mailto:support@vestaprecision.com)

Phone: +18335045101 (US)

+442039363041 (EU)