

Before curing, the tempered glass did not adhere properly!

❗ Adhesive doesn't spread completely on the screen! Please check the manual and the video for re-installation.

- 1 Remove the JIG from the device.(Refer to step7)
Remove the tempered glass on the device and flip it over and place it on the tissue.

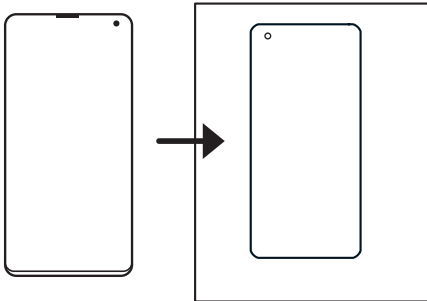

❗ Re-installation Video before curing



- 2 The adhesive on the device is absorbed using a tissue and removed.
Remove using alcohol wipes and cleaning Cloth.

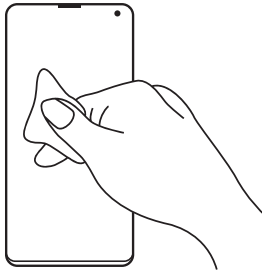

- 3 The adhesive on the tempered glass is absorbed using a tissue and removed.
Remove using alcohol wipes and cleaning Cloth.Be careful not to scratch.

⚠️ • If too much force is used when cleaning the tempered glass, tempered glass may be damage so be careful.

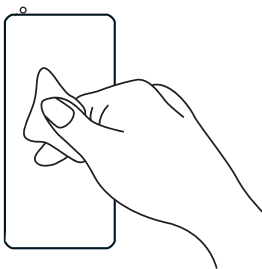

- 4 Attach the protective film removed from STEP5 to the tempered glass.
Proceed from STEP1 and reattach (use extra adhesive).

