

Marshall

ENGLISH

MARSHALL FRIDGE

PRODUCT MANUAL

MARSHALL.COM

4.4 Product dimensions (height x width x depth):
820mm x 500mm x 570mm Unit weight 26 kg

3.2 Product Dimensions (height x width x depth):
780mm x 455mm x 470mm Unit weight 23.5 kg

3.2 Accessories: Removable Shelves, Thermostat, Marshall Script Logo, Authentic Amp Parts

4.4 Accessories: Freezer Compartment, Drip Tray, Removable shelves, Thermostat, Marshall Script Logo, Authentic Amp Parts

PRODUCT	Model MF 3.2	Model MF 4.4
POWER SUPPLY	110V/60Hz or 220V~240V/50Hz	110V/60Hz or 220V~240V/50Hz
CAPACITY	92L	126L

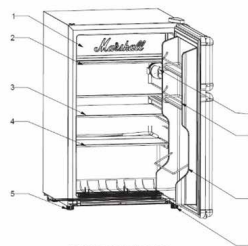

WARNING! SAFETY INSTRUCTIONS

**PLEASE READ THIS MANUAL CAREFULLY BEFORE PLUGGING IN.
FOLLOW ALL INSTRUCTIONS AND HEED ALL WARNINGS.**

CAUTION

This section contains important information pertaining to the operating instructions of the Marshall Fridge (hereinafter referred to as "refrigerator"). It also contains information about how to use your refrigerator safely. Read this information carefully before using your refrigerator. Read and follow all safety rules and operating instructions before the first use of this refrigerator. Keep this manual in the place accessible by a user at all times.

ELECTRICAL REQUIREMENTS

- This appliance must be grounded. In the event of an electrical short circuit, grounding reduces the risk of electrical shock by providing an escape wire for the electrical current
- This appliance is equipped with a cord that has a grounding wire with a grounding plug. The plug must be plugged into an outlet that is properly installed and grounded.

WARNING!

Improper use of the grounding plug can result in a risk of electric shock. Consult a qualified electrician if the grounding instructions are not completely understood or if doubt exists as to whether the appliance is properly grounded.

ELECTRICAL CONNECTION

- There is no power on the exterior control panel of the refrigerator. The switches do not light up; the knobs and jacks are aesthetic only.
- The voltage should be limited within these ranges: 187V to 242V for UK, EU, Australia, China and 100V to 124V for North America or

the main motor will be damaged.

- Do not under any circumstances cut or remove the third ground prong from the power cord supplied. For personal safety, this appliance must be properly grounded.
- Have the wall outlet and circuit checked by a qualified electrician to make sure the outlet is properly grounded. When a standard 2-prong wall outlet is encountered, it is customer's responsibility and obligation to have it replaced with a properly grounded 3-prong wall outlet. For voltage and outlet style please refer to our website www.marshall.com.
- The appliance should be positioned so that the wall outlet is easily accessible.
- The cord should be secured behind the refrigerator and not left exposed or dangling to prevent accidental injury.
- Never unplug the refrigerator by pulling the power cord. Always grip the plug firmly and pull straight out from the receptacle.
- Repair or replace immediately all power cords that have become frayed or otherwise damaged. Do not use a cord that shows cracks or abrasion damage along its length or at either end.
- When moving the refrigerator be careful not to damage the power cord.

DANGER

- It is recommended that a separate circuit, serving only your refrigerator be provided. Use receptacles that cannot be turned off by a switch or pull chain.
- Do not connect or disconnect the electric plug when your hands are wet.
- Unplug the refrigerator or disconnect power

before cleaning or servicing. Failure to do so can result in electrical shock or death.

- Do not attempt to repair or replace any part of your refrigerator unless it is specifically recommended in this manual.
- All other servicing should be referred to a qualified technician.
- Risk of fire or explosion. Flammable refrigerant used. Do not puncture refrigerant tubing.

WARNING

- To ensure proper ventilation, the front of the refrigerator must be completely unobstructed. Choose a well-ventilated area with temperatures above 60°F (16°C) and below 90°F (32°C).
- The refrigerator must be installed in an area protected from the weather or other external conditions, such as wind, rain, water spray or drips.
- The refrigerator should not be located next to ovens, grills or other sources of high heat.
- Do not kink or pinch the power supply cord of refrigerator.
- Make sure that the pipes are not pinched, kinked or damaged during installation.
- Do not use mechanical devices or other means to accelerate the defrosting process, other than those recommended by the manufacturer.
- Do not damage the refrigerator circuit.
- Do not use electrical appliances inside the food storage compartments of the appliance, unless they are of the type recommended by the manufacturer.
- (UK specification only / Plug Type G) plug contains 13 amperes fuse.

CAUTION

- Risk of fire or explosion. Flammable refrigerant used. Consult repair manual/owner's guide before attempting to service this product. All safety precautions must be followed.
- Risk of fire or explosion. Dispose of property in accordance with federal or local regulations. Flammable refrigerant used.
- Risk of fire or explosion due to puncture of refrigerant tubing. Follow handling instructions carefully. Flammable refrigerant used.

DO NOT USE AN EXTENSION CORD: Use an exclusive wall outlet. Do not connect the refrigerator to extension cords together with any other appliance in the same wall outlet. Do not splice the cord.

IMPORTANT WARNING: Never clean the refrigerator parts with flammable fluids as this can cause a fire hazard or explosion. Do not store or use gasoline or any other flammable fluids that can cause a fire hazard or explosion.

DANGER: Risk of child containment! Never allow children to operate, play with or crawl inside the appliance. Do not let children pull or play with the knobs or put them in their mouths.

Before you dispose of your old refrigerator

- Have the door removed
- Leave shelves in place so that children may not easily climb inside.

For more safety information specific to your region, visit the website: www.marshall.com.

INSTALLATION INSTRUCTIONS

BEFORE USING YOUR REFRIGERATOR

- Remove exterior and interior packaging; wipe the outside thoroughly with a soft, dry cloth and the inside with a damp, lukewarm cloth.
- Before connecting the refrigerator to the power source, let it stand upright for approximately 2 hours. This will reduce the possibility of a malfunction in the cooling system from handling during transportation.

INSTALLING YOUR REFRIGERATOR

This appliance is designed to be free standing only and should not be recessed or in-built. Avoid placing the refrigerator near any heat source, direct sunlight or moisture. Let air circulate freely.

FOLLOW STEPS BELOW CAREFULLY

- Select a place with a level floor.
- Allow 10cm or 4 inches of space between the back of the refrigerator and any adjacent wall.
- Avoid direct sun and heat. Direct sunlight may affect the coating. Heat sources nearby will cause higher electricity consumption.
- Avoid damp places.
- The product is for household use only and avoid exposure to outdoor elements.
- Hold the base and lift carefully. Do not tilt more than 45 degrees and never hold the door for support. Never place it upside down or on its side.
- Push the refrigerator into place using the two hind wheels and tilt back slightly.
- Plug the refrigerator into an exclusive, properly installed-grounded wall outlet. Do not under any circumstances cut or remove the third (ground) prong from the power cord. Any questions concerning power and/or grounding should be directed to a certified electrician or an authorised call center. For voltage and outlet style, visit the website: www.marshall.com.
- After plugging the appliance into a wall outlet, allow the refrigerator to cool down for 2-3 hours before placing food in the refrigerator and chiller compartments.
- Do not place heavy objects on top of the refrigerator.

Certification

To view all Marshall Fridge certifications, visit the website: www.marshall.com.

OPERATING INSTRUCTIONS

SETTING THE TEMPERATURE CONTROL

- The temperature control panel is located on the upper part of the refrigerator. The first time you turn on the refrigerator, set the temperature control to 4.
- The range of temperature control is from position 1 to 7. After 24 to 48 hours, adjust the temperature control to the setting that best suits your needs. Level 4 is recommended.
- To turn off the refrigerator, change the temperature control to OFF.

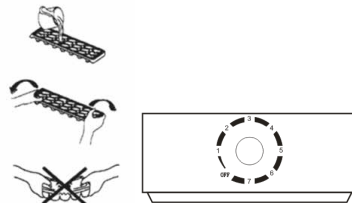

CHILLER COMPARTMENT (4.4 FRIDGE ONLY)

This compartment is designed for production of ice cubes and short-term storage (3-4 days) of some commercially frozen foods. The temperature in this compartment does not get cold enough to freeze food safely for long periods and works best when the food is already frozen.

The chiller door is susceptible to breaking due to excessive ice build-up. This part is not covered under your warranty. Defrost when your ice reaches 1/4 inch thickness.

REVERSING THE DOOR SWING OF YOUR APPLIANCE

Your refrigerator is built with a reversible door. You have the choice of either opening it from the left or the right side. In order to reverse the opening direction of your door, please follow these instructions:

WARNING: It is highly recommended a licensed professional technical reverse the door.

- Unplug the power cord from wall outlet and empty all contents from the refrigerator.
- Remove hinge cover and unscrew hinge screws. Remove top hinge.
- Uninstall the support legs and unscrew the bottom hinge screws.
- Change the position of lower hinge to the opposite side of the appliance, support the door onto the lower hinge, replace screws and support legs.
- Remove plastic plugs and align door to the upper hinge. Reattach upper hinge with screws and fit hinge cover over hinge.
- Press the plastic pins into the open holes.

- Plugs (3)
- Hinge Cover
- Screws (3)
- Hinge (upper)
- Hinge (lower)
- Screws (3)
- Leg (right)
- Leg (left)

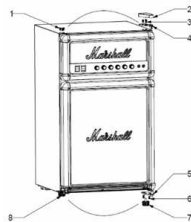

CARE AND MAINTENANCE

Refrigerator exterior care

Use a dry cloth to dust off fret cloth fabric, very gently. Use a damp cloth for metal surfaces.

Food Storage

Allow hot dishes to cool to room temperature before storing. Place food items in proper airtight containers.

LED Light Replacement

Light bulb must be replaced by a licensed professional technician.

CAUTION

Failure to unplug the refrigerator could result in electrical shock or personal injury.

CLEANING YOUR REFRIGERATOR

- It is recommended to clean your refrigerator monthly.
- Before proceeding with cleaning and maintenance operations, make sure the power cord of the refrigerator is disconnected.
- Turn the temperature control to OFF, unplug the refrigerator and remove the food, shelves and trays.
- Wash the inside surfaces with warm water and baking soda. The solution should be about 2 tablespoons of baking soda to a quart of water.
- Wash the shelves and trays with a mild detergent solution.
- The outside of the refrigerator should be cleaned with a soft, dry cloth.
- Do not use solvent-based cleaning agents or abrasives on the interior. These cleaners may damage or discolor the interior.

DEFROSTING YOUR REFRIGERATOR (4.4 FRIDGE ONLY)

The defrosting of your refrigerator should take place whenever ice build-up inside the chiller compartment reaches 1/4 inch of thickness. Set the thermostat dial to "0" position. To speed up the defrosting process, remove all frozen foods from the chiller section. Leaving the door partially ajar for a short period of time will also speed up the process. You must remember to close the refrigerator door before the defrost cycle terminates and normal operating conditions resume automatically. The drip tray should be in position directly below the chiller compartment to catch condensed water during defrosting. Never use sharp or pointed instruments to remove ice from the chiller compartment. The chiller compartment contains refrigerated gas lines that if accidentally punched/pierced, will render the

TROUBLE SHOOTING GUIDE

Problem	Possible cause/solution
1) Does not work	<ul style="list-style-type: none"> No power to refrigerator. Not plugged in. The circuit breaker tripped or a blown fuse. The refrigerator temperature control is set at OFF position.
2) Turns on and off frequently	<ul style="list-style-type: none"> The room temperature is hotter than normal. A large amount of food has been added to the refrigerator. The door is opened too often. The door is not closed completely. The temperature control is not set correctly. The door gasket does not seal properly. The refrigerator does not have the correct clearances.
3) Does not cool sufficiently	<ul style="list-style-type: none"> Door is opened often and left open. Refrigerator is too close to the wall or heat source. Too much food or beverages stored inside the refrigerator. Temperature is not correctly regulated.
4) Vibration	<ul style="list-style-type: none"> Check to assure that the refrigerator is level.
5) Loud noise	<ul style="list-style-type: none"> The rattling noise may come from the flow of the refrigerant, which is normal. As each cycle ends, you may hear Gurgling sounds caused by the flow of refrigerant in your refrigerator. Contraction and expansion of the inside walls may cause popping and crackling noises. The refrigerator is not leveled. The refrigerator contact with surrounding objects. Interior shelves may be out of place.
6) The door will not close properly	<ul style="list-style-type: none"> The refrigerator is not leveled. The gasket is dirty or bent. The shelves, bins or baskets are out of position.
7) Smell	<ul style="list-style-type: none"> Food or beverage are not properly covered. Refrigerator requires cleaning.

If symptoms persist or not covered within the troubleshooting guide, please contact a qualified technician or refer to our website: www.marshall.com.

REFRIGERATOR WARRANTY

For warranty information specific to your region, please visit the website: www.marshall.com.

This limited warranty gives you specific legal rights, and you also may have other rights that vary from state to state or country to country. Some places do not allow limitations on implied warranties or the exclusion or limitation of incidental or consequential damages, so the above limitations or exclusions may not apply to you.

For legal information specific to your region, visit the website: www.marshall.com.

refrigerator inoperable and void the manufacturer's warranty.

POWER FAILURE

You should minimise the number of door openings while the power is off. During power failures in excess of 2 hours, please take steps to protect your food.

HOLIDAYS

For short holidays, leave the control knob at its normal setting. During absences greater than three weeks:

- Remove all food.
- Disconnect the power cord from electrical outlet.
- Clean the refrigerator thoroughly.
- Leave the door open to avoid possible formations of condensate, mold or odors.

IF YOU MOVE

- Remove all loose items inside the refrigerator.
- To avoid damaging the leveling legs, turn them all the way into the base.
- The refrigerator should be in the upright position during transportation.
- Tape the door if you judge necessary.

ENERGY SAVING TIPS

- The refrigerator should be located in the coolest area of the room; away from heat producing appliances and out of direct sunlight.
- Cool down food to room temperature before placing in the refrigerator.
- Wrap food properly and wipe containers dry before placing them in the refrigerator.
- Organise and label food to reduce door opening and extended searches. Remove as many items as needed at one time and close the door as soon as possible.

DISPOSAL

This product should not be disposed with other household wastes throughout the EU. To prevent possible harm to the environment or human health from uncontrolled waste disposal, recycle it responsibly to promote the sustainable reuse of material resources. The disposal of this refrigerator is subject to the Waste from Electrical and Electronic Equipment (WEEE) Directive of the European Union. For more detailed information about the recycling of your refrigerator, please contact your local authority, household waste disposal service, or the retail store where your refrigerator was purchased.