

# AEOLUS

## Professional Pet Drying Equipments Supplier

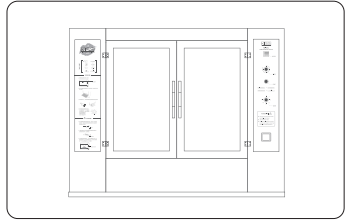

TD-907

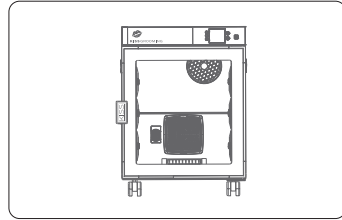

TD-907T

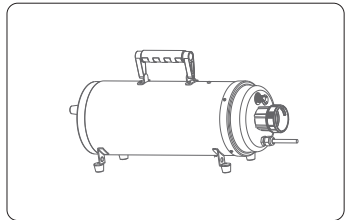

TD-900XT

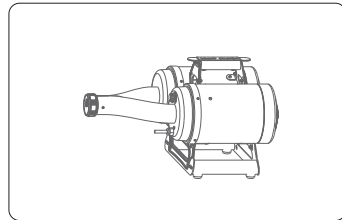

TD-900CG

Distributor Contacts



AEOLUS

Producer : Shanghai TOEX International Trading Co., Ltd.  
Address : Floor 5, Building 6, No.675 Zhujin Road,  
Songjiang District, Shanghai, 201615, China

Manufacturer : Shanghai Xunyuan Industrial Co., Ltd.  
Address : Building 8, No. 65 Huandong First Road,  
Jinshan District, Shanghai, China



AEOLUS

# Ionic Pet Dryer

TD-905/ TD-906

New  
Generation

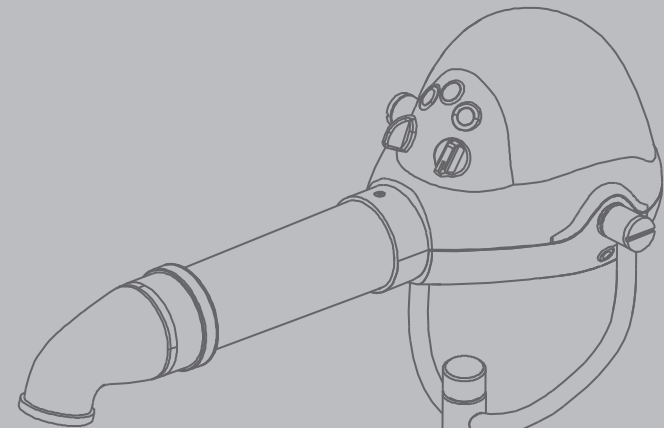

Owner's Guide

# Brief Introduction

Thank you for purchasing our products! Kiss TD-905/906 Ionic Pet Dryers are designed for pet drying with heating air and negative ions. Thus our products can make the hair of pets dried and smooth. TD-905 Ionic Pet Dryers are wall-hanging driers and TD-906 Ionic Pet Dryers are stand dryers.

Please read the details of this manual before using this product.

# Product Characteristics

## **1. TD-905 Ionic Wall-hanging Dryer**

Variable wind speed and temperature control.

The maximum wind speed is 38m/s.

Japanese made heavy duty 1HP fan, air-cooled brushless motor, reliable heating element and air adjustment.

Temperature range is from 25°C (77F) to 75°C (167F).

Maintenance-free brushless motor, does not require oiling or greasing of internal parts.

Energy efficient, economic to run.

Extremely quiet (lower than 40 db).

Fashionably designed by Italian Master Designer.

ABS body compartment, resistant to harsh chemicals and scratches.

Double layer housing on the heater prevents over-heating.

The outlet tube is made from heat resistant PPS material (resisting over 260°C (500F) temperature).

Durable hanging arm could be lifted and lowered thousands of times.

Advanced tourmaline brushes generate negative ions that aid in containing internal cuticle moisture and taming unruly hair and straightening curly coats.

Ultra high Negative Ion Concentration at 8 millions/cm<sup>3</sup> for unbeatable hair moisturizing and straightening affects. Negative ions also help in purifying the air and creating a healthier environment.

## **2. TD-906 Ionic Stand Dryer**

Experience hands-free fluff drying.

This gentle, powerful finishing dryer produces wind speed of 38m/s.

Temperature range is from 25°C (77F) to 75°C (167F).

Japanese made heavy duty 1 HP fan, air-cooled brushless motor, reliable heating element and air adjustment.

Variable air speed and temperature controls, suitable for all kinds of breeds.  
 Sturdy powder coated stand with durable locking casters.  
 Balanced weight design provides stability.  
 Available in two lovely colors, PINK FLAMINGO and PEARLIZED WHITE SWAN.  
 As a result of our advanced technology, the noise level is greatly reduced.  
 The washable foam filter is easy to remove and clean.  
 Nozzle rotates 360°, easily positioned at any angle.  
 Advanced tourmaline brushes generate negative ions that aid in containing internal cuticle moisture and taming unruly hair and straightening curly coats.  
 Ultra high Negative Ion Concentration at 8 millions/cm<sup>3</sup> for unbeatable hair moisturizing and straightening affects. Negative ions also help in purifying the air and creating a healthier environment.

ITEM	Net Weight (kg)	Gross Weight (kg)	Dimension		Volume (cbm)
			W×D×H(cm)	W×D×H (inch)	
TD-905	12.2	13.8	65.7×33.6×26.2	25-55/64×13-15/64×10-5/16	0.058
			90.8×21×26.2	35-3/4×8-17/64×10-5/16	0.030
TD-906	12.0	14.0	65.7×33.6×26.2	25-55/64×13-15/64×10-5/16	0.058
			72.5×53×12	28-35/64×20-55/64×4-23/32	0.046

## Safety instruction

1. Pet dryer needs a single outlet which is at least 10A and has ground wire for itself. Please connect pet dryer with a correct outlet and do not share with other appliances.

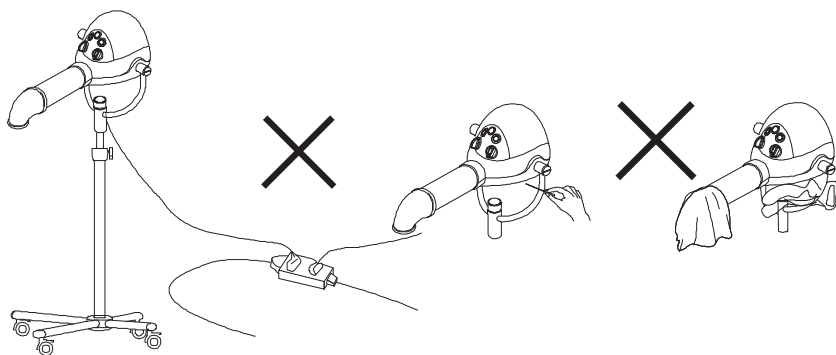

2. Before switch on or turn off the power every time, please adjust the wind and temperature to the lowest, this can extend the lifetime of the machine.

3. Do not insert pins or any metal things into the clearance of the machine, otherwise that would be easy to get an electric shock and short circuit.
4. Do not use a cloth or bag to stop the nozzle or filter; otherwise it would damage the machine.
5. If the machine has been used for some time and a malfunction occurs, users should ask the professional person to repair it.
6. If the supply cord is damaged, it must be replaced by the manufacturer or its service agent or a similarly qualified person in order to avoid a hazard.
7. Please keep children away when you operate the machine.
8. Do not hit the housing with fierce shock or drop the machine from high, which will damage the frame and motor.
9. Cardiopath or people with pacemaker are forbidden to use this machine.
10. Appliance is not intended for use by persons (including children) with reduced physical, sensory or mental capabilities, or lack of experience and knowledge, unless they have been given supervision or instruction concerning use of the appliance by a person responsible for their safety.
11. Children should be supervised to ensure that they do not play with the appliance.
12. Make sure the local voltage and frequency of the power meet the requirements on the label of the product..
13. Indoor use only.
14. Do not use when here are flammable anesthetic gas, oxygen or the mixture of oxygen and oxidize ammonia.
15. Do not place the product on an uneven or soft ground.
16. Avoid using the product in dusty, vibrating and wet environment and in chemical storage place.
17. Use only mild neutral detergent to clean.

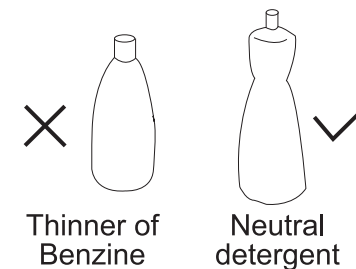
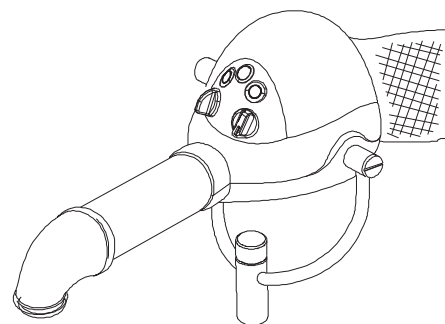

# Overview

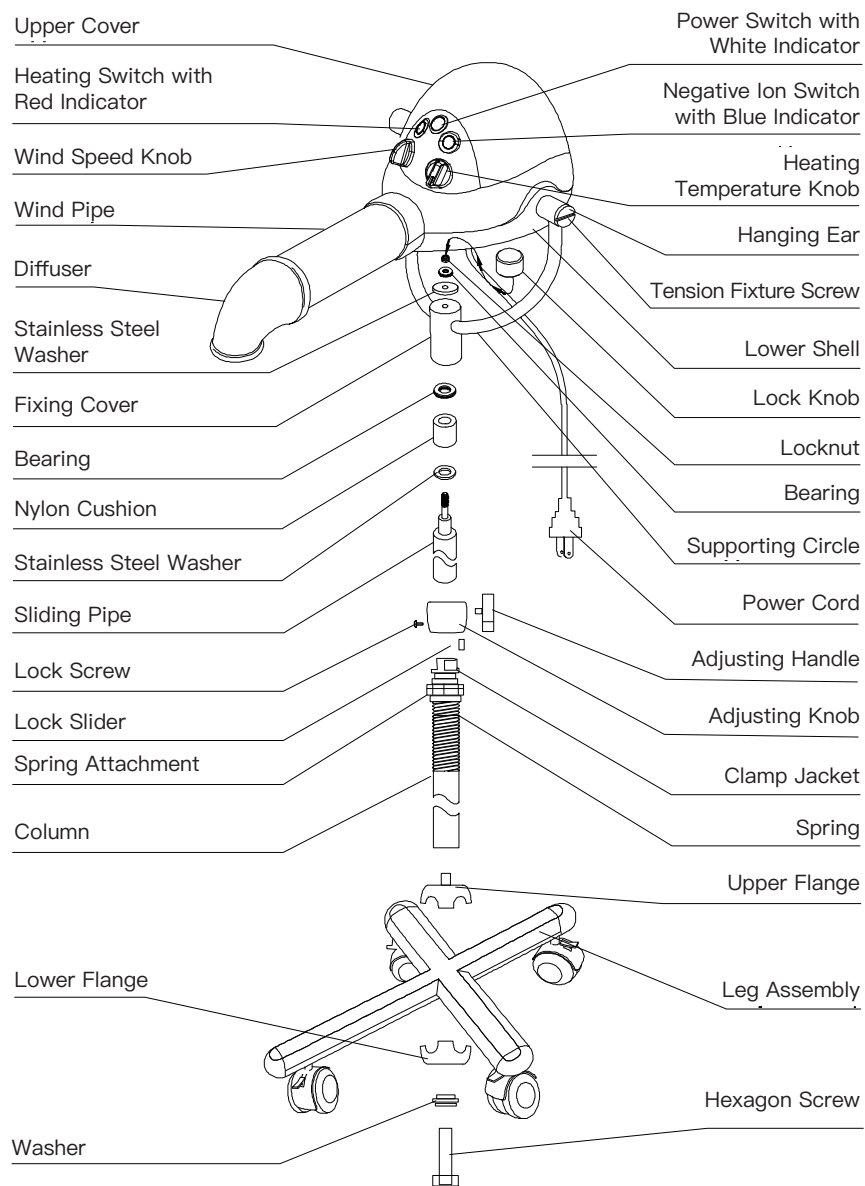

# Installation

## TD-905 Ionic Wall-hanging Dryer

### Before Installation

1. Users must choose a solid wall sturdy enough to support the arm assembly and the machine head.
2. We recommend that the height of wall bracket installation is 1840/1950mm from floor to the bottom of the bracket. (See Fig.1)
3. Notice that a power socket with proper power must be ready on the wall within the distance of 500mm from the wall bracket.

### Installation

Tools: an impact drill, a screwdriver, a spanner.

1. The wall plate and the wall bracket are fixed together with bolts before delivery from factory. Use a wrench to separate them (See Fig.2).
2. Use the wall plate as a template to drill three holes on the wall (See Fig.3). The hole should fit the bolts we supplied.
3. Use the bolts to attach the wall plate to the wall and tighten the nuts (See Fig.4).
4. Attach the wall bracket to the wall plate and tighten the bolts (See Fig.5).

Caution: Because the wall bracket and wall plate will bear a heavy load, a correct and firm installation is needed.

5. Remove the stoppers, screws, protector plate and hook lock from the arm (See Fig.6). Attach the arm to the hanger and reinstall all the stopper, screws, protector plate and hook lock.

### Caution:

- a. Before assembling or using the arm, the stopper must be removed. Otherwise the arm will be hard to lower and the stainless steel pipe will be damaged.
- b. The hook lock must be tightly inserted in position, or the dryer head may fall off and cause injuries!

6. Attach the arm to the wall bracket.
7. The dryer windpipe fixture angle could be adjusted by moving the windpipe up and down easily. After long time operation, the joint between the dryer head and hanging ear may get loose. When finding the tension screws on both sides get loose, turning the slot on it clockwise could tighten the screws. (See Fig.7) .

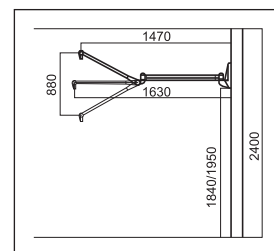

Fig. 1

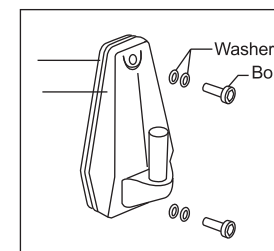

Fig. 2

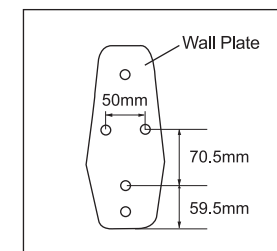

Fig. 3

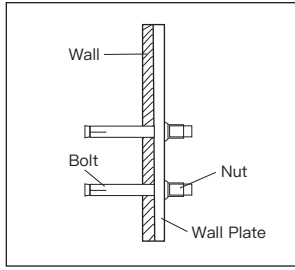

Fig. 4

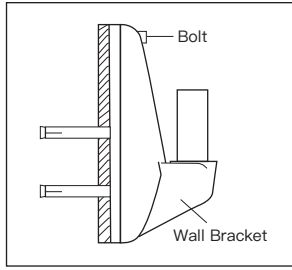

Fig. 5

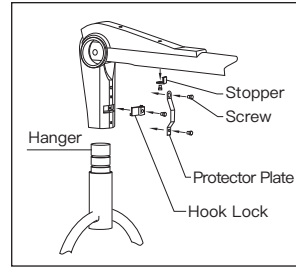

Fig. 6

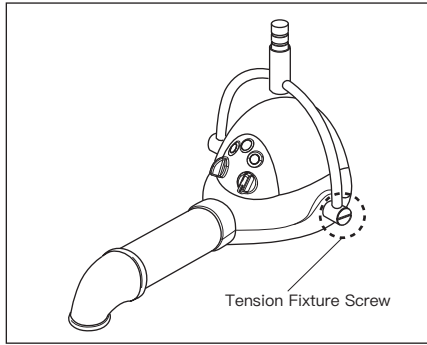

Fig. 7

The tension fixture screws could be adjusted when needed.

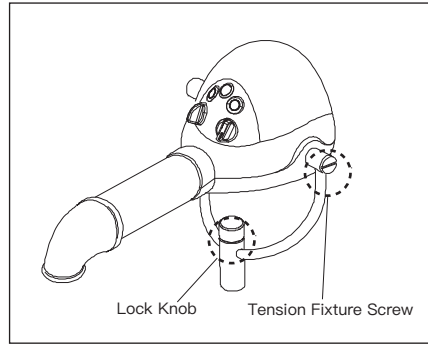

Fig. 8

The turning lock knob could be used for suitable friction force.

## TD-906 Ionic Stand Dryer

### Installation

1. Insert the sliding pipe into the fixing cover and rotate the knob on the fixing cover to fix.
2. Lock tightly at the height you need with the triangular height-adjusting handle.
3. The dryer windpipe fixture angle could be adjusted by moving the windpipe up and down easily. After long time operation, the joint between the dryer head and hanging ear may go loose. When finding the tension screws on both sides get loose, turning the slot on it clockwise could tighten the screws. (See Fig.8).
4. After long time operation, the joint between the supporting circle and sliding pipe may go loose and cause accidental windpipe movement. If needed, turn lock knob for suitable friction force to fix the dryer head. (See Fig.8).

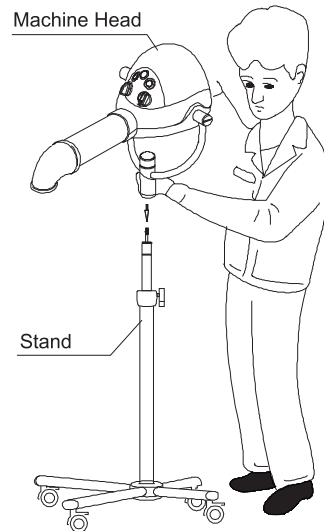

## Operation

1. Connect the plug to the power socket and locate the dryer to point the nozzle at the pet.
2. Turn on the power switch and the dryer starts to blow. Turn the wind speed knob to adjust the wind speed.
3. Turn on the heater switch and the wind will be heated. Turn the heater knob to set the temperature of the wind.
4. If negative ions are needed, turn on the negative ion switch and the wind will blow with negative ions.

## Modes Program

WIND TEMP (°C)	WIND SPEED (m/s)	CURRENT (A)	PEAK VALUE CURRENT(A)	POWER (W)	PEAK VALUE POWER(W)	GREEN LIGHT	RED LIGHT
		240V	240V	240V	240V		
20	0-25	0.21	0.33	50	78	OFF	ON
30	0-25	7.5	11.7	1800	2800	ON	ON
40	0-25	7.5	11.7	1800	2800	ON	ON
50	0-25	7.5	11.7	1800	2800	ON	ON
60	0-25	7.5	11.7	1800	2800	ON	ON
70	0-25	7.5	11.7	1800	2800	ON	ON

### Note:

It takes 3-5 minutes for the hot air from the machine to reach a stable temperature.

# Maintenance

1. Fold the arm of TD-905 Ionic Wall-hanging Dryer alongside to the wall when the dryer is idle.
2. Use a soft cloth (with mild neutral detergent only) to clean the metal filter net under the machine head at least 1 time per day.
3. Use a soft cloth (with mild neutral detergent only) to clean the surface of the machine.

# Package Inspection

The manufacturer is not liable for any damage caused by a third party "Transport or Delivery Company".

The day the unit is delivered, an inspection of the outer packing should be made for any damage to the packing box.

Then the unit should be unpacked carefully; all components, accessories and the product itself should be inspected for any damage or loss.

If any damage is evident, the carrier or dealer should be notified immediately.

# Correct Disposal of this Product

This marking indicates that this product should not be disposed with other household wastes throughout the EU. To prevent possible harm to the environment or human health from uncontrolled waste disposal, recycle it responsibly to promote the sustainable reuse of material resources. To return your used device, please use the return and collection systems or contact the retailer where the product was purchased. They can take this product for environmental safe recycling.