

## Trade Installation Guide

### Supported Products

All Friendly Fibre products including

- EQ\_Tile - 25, 40 and 50 mm Thickness
- EQ\_Disc - 25, 40 and 50 mm Thickness
- Spectrum 2.0 Products

Glasswool and mineral fibre products are NOT supported

NOTE: We cannot guarantee the supplied fixings are suitable for all walls.

Flexi Clips are manufactured from 3mm MDF consult your fire officer before specifying.

### Assembly Components

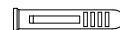
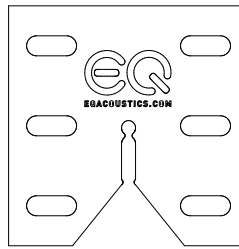

← ● Flexi Clip

← ● EQ\_Fibre Screws  
20 - 35mm

← ● Wall Plug

1

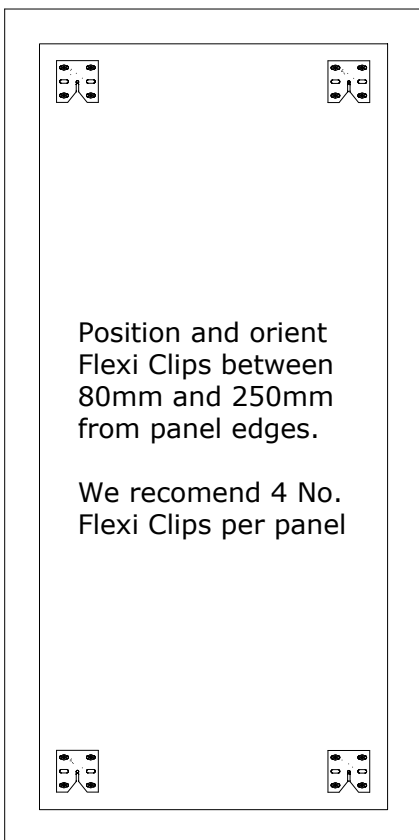

Position and orient Flexi Clips between 80mm and 250mm from panel edges.

We recommend 4 No. Flexi Clips per panel

2

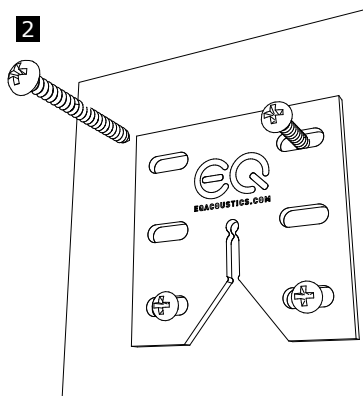

Secure Flexi Clips to panel using EQ\_Fibre Screws.

Only use the EQ\_Fibre Screws for attaching the Flexi Clips - *Other screws are NOT supported*

3

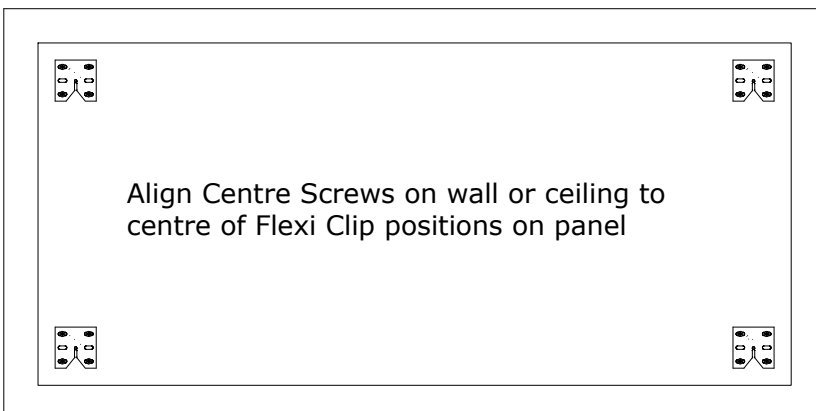

Align Centre Screws on wall or ceiling to centre of Flexi Clip positions on panel

4

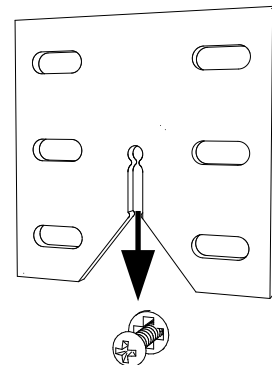

Slide the panel onto the Centre Screw until all Flexi Clips lock