

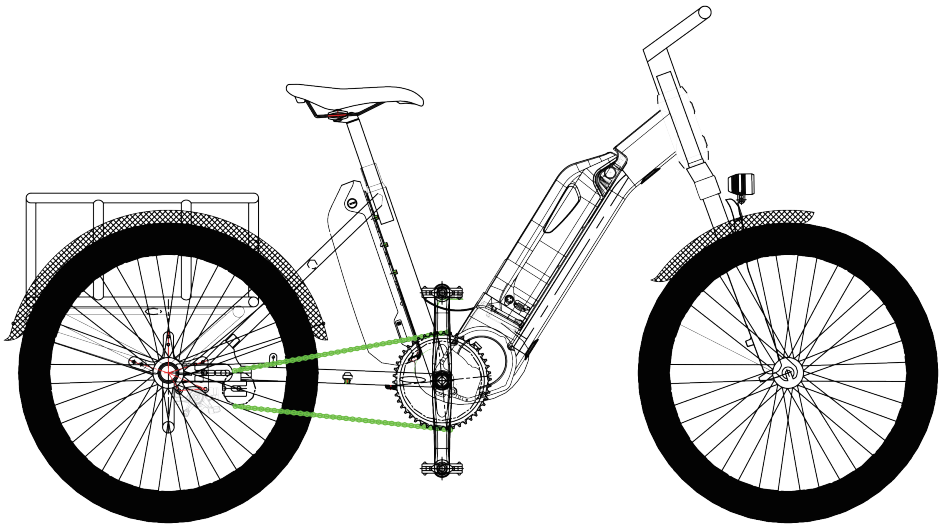

eTrikes

C A N A D A



Contents

Before You Ride.....	1
Components	2,3
eTc Commuter	3
Tire inflation	4
Handlebar Installation.....	5
Handlebar adjustment (continued).....	6
Handlebar adjustment (continued).....	7
Battery	8
Charger	8
Remove the battery	9
Digital Assistance Controller and Lighting	10
1 - Controller interface	10
2 - Switching the controller on and off	10
3 - "Pedestrian mode" function	10
4 - Selection of the level of assistance	11
5 - Switching on the tricycle lighting	11
Shifting speeds.....	12,13
Braking.....	14
Brake adjustment	14
Brake maintenance	14
Parking brake	15
Using Your Electric Tricycle	16
Before riding on your e-trike, do not forget to carry out the following checks	16
To start	16
To stop	17
Maintenance of Your Electric Tricycle	18
Worn parts to be replaced immediately if damaged	19
LCD Error Codes	19
SERVICE	20
ETC products	20
WARRANTY CERTIFICATE.....	20

Before You Ride

1. After receiving your new e-trike, please **read this manual**



carefully. You will need to familiarize yourself with the electrical assistance, driving, starting and braking before you hit the road.

2. Your tricycle has been designed by professionals. You must under no circumstances modify, add, remove or render unusable any part, piece or function of your e-trike. We cannot be held responsible for any malfunction or accident caused by a modification on your part.

3. The charger must not be covered during charging, it must be in a ventilated and secure place. The charger is for indoor use only, out of the reach of children and moisture. Do not use a different charger than the one provided to charge your battery.

4. Your tricycle is not designed to ride on water, this could damage your battery, motor and trike. If you drive or park in the rain, make sure you cover your tricycle and the entire electrical system with a specially designed tricycle cover.

5. Check the pressure of your tires as often as possible, driving with a tire with the wrong pressure is dangerous

6. Keep an eye on your battery, a weak battery affects its operation and autonomy, and could damage it.

7. Check the braking system, if it does not work properly it is dangerous and could lead to an accident.

8. Adjust your handlebar and seat before riding your tricycle.

9. ALWAYS double check the front wheel, handlebars and seat to ensure all fasteners are tight before riding.

10. Canada has the requirements as follows:

A) 500 watt maximum motor size

B) Speed must be set to a maximum of 32Km/h.

C) There is a Pedestrian Mode function allowing the tricycle to run at a fixed speed of 6Km/h without pedaling.

D) Each province has different age requirements for riding an electric bike. Most require you be at least 16 years old. Check local regulations before you ride.

E) These laws may vary in your area, so its your responsibility to adhere to them.

eTrikes Canada will not be held responsible for any misuse etc according to our Terms and Conditions as stated on our Website and reverse side of our invoices.

Please check the E Bike rules in your local area

Tire inflation

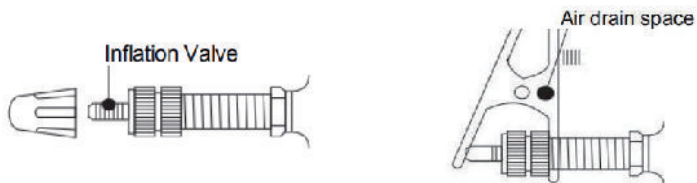

To inflate your tires:

1. Open the inflation valve by unscrewing its cap.
2. Attach the pump to the valve (be careful to secure your pump so that the air does not escape) and inflate it to a maximum pressure of 30 P.S.I. depending on your weight and load.
3. Once your tire has been inflated, close the valve with its cap.

Handlebar Installation

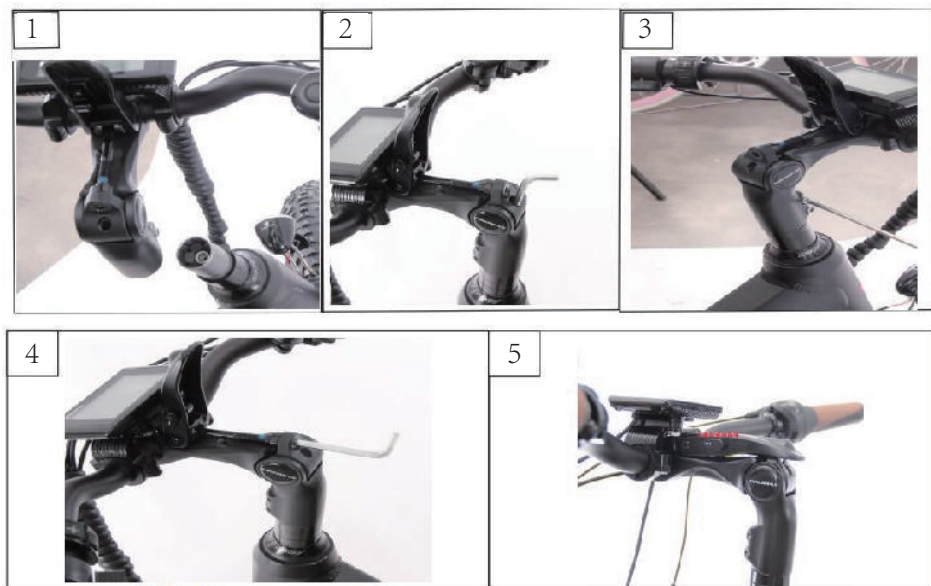

1. Insert the stem into the bracket
2. Tighten the stem screw by M5 Allen wrench
3. Tighten the stem screw by M4 Allen wrench
4. Adjust the handle bar to the suitable height and tighten the stem screw by M5 Allen wrench
5. Close the top cover

Handlebar Adjustment(continued)

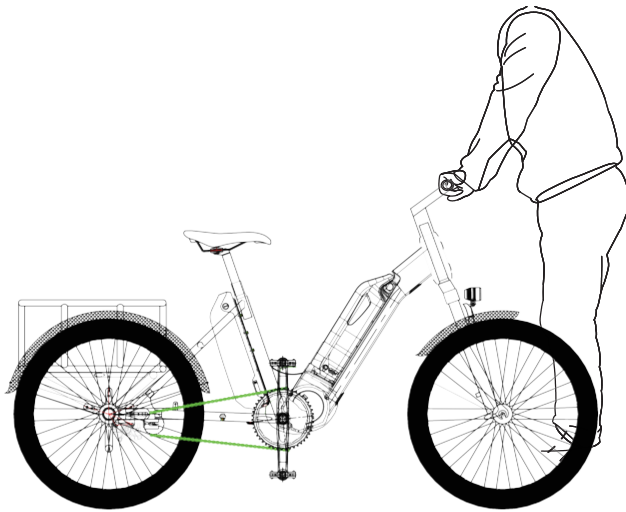

Once the handlebar is installed and properly screwed in, you will have to face it, put your hands on the handlebar, lock the wheel with your legs so it will be straight and move the handlebar so it fits perfectly in line with the axis of the wheel.

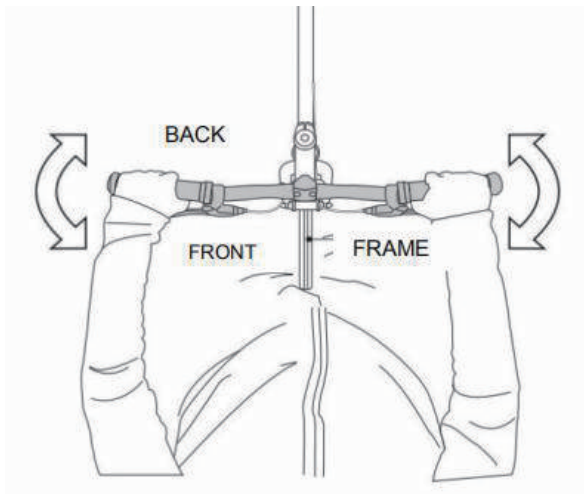

Handlebar Adjustment(continued)

The front wheel must be aligned with the frame and perpendicular to the handlebars

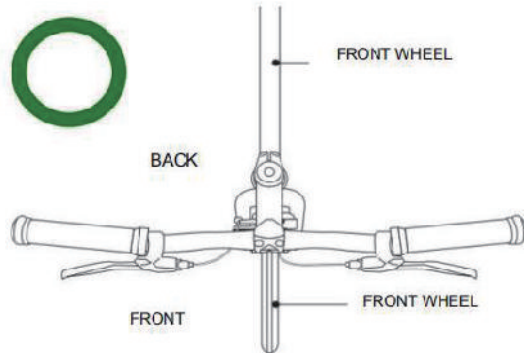

Be careful, If the wheel is not perpendicular to the handlebars, it will cause damage to your tricycle and prevent you from riding.

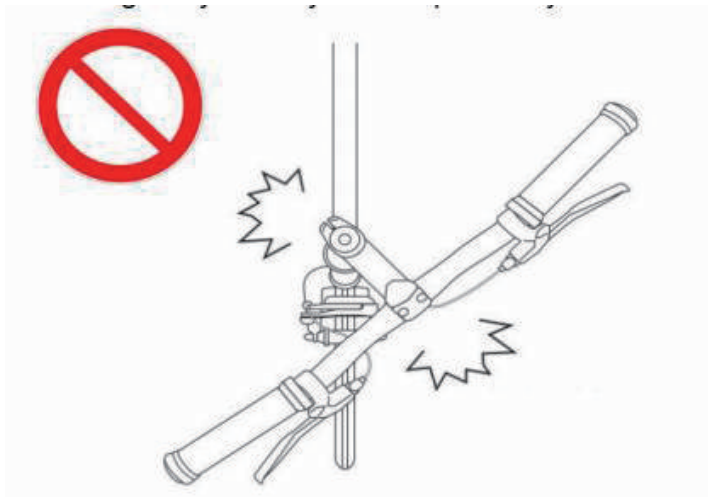

As soon as the adjustment is complete, tighten the handlebar neck screw firmly to lock the handlebar.

Recommended clamping force 14 N.m

Battery

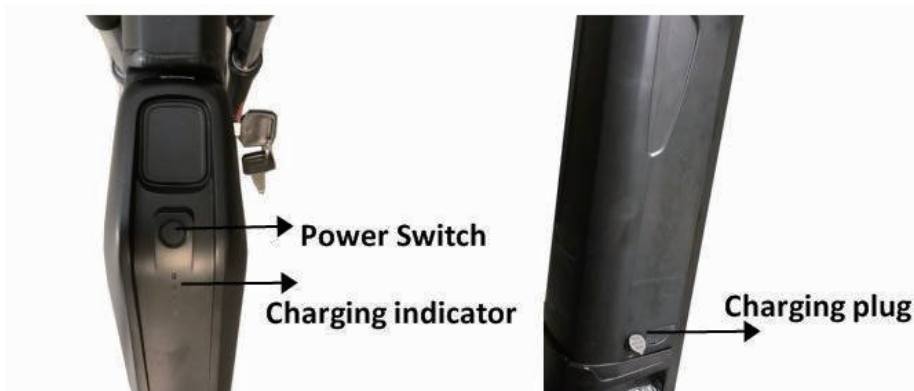

Taking care of the battery is essential for its proper functioning and to maximize its performance and autonomy.

Charger:

For regular and long-distance use, it is recommended to recharge the battery before making the trip. You will need to charge the battery at least once a month, even if you do not use the tricycle.

- Fully charge the battery before the first trip and after each use, even after a short trip, is ideal.
- Charge the battery in a temperate environment (15 - 25 °C)
- Plug the charger connector into the battery socket
- You can charge the battery while it is on the trike or be removing it from the frame using the key
- Plug the main plug into a suitable socket (120 volt with ground)
- Remove the mains plug from the socket
- Remove the connector from the battery socket



Danger of death due to electric shock

Do not operate the charger at temperatures above 50°C and relative humidity Excessive humidity can lead to an electrical malfunction.No metal objects should touch the contacts or the battery socket. Avoid dirt and contact with chemical cleaning substances and products.Do not cover the charger.Do not charge under direct sunlight.Do not charge the battery at temperatures below 0°C.The battery must always be charged in a ventilated area - The battery must be clean and dry before charging To disconnect, start with the mains plug, then the battery.Do not use the battery if it emits an unusual smell or heats up abnormally.Do not disassemble the charger.Do not expose charger and battery to flames.

Remove the battery

- 1、 To remove the battery from its slot you must unlock it using the key on the side of the battery and push it to the left (photos below).



Do not dispose of the battery with your household waste. Take it back to your supplier or to a specialized recycling collection point. You will contribute to the protection of your environment.

Digital Assistance Controller and Lighting

1 - Interface

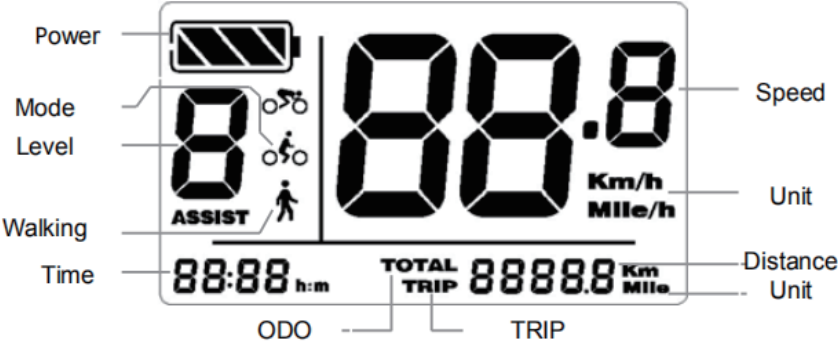

Button



2 - Switching the controller on and off

To turn the unit on, press and hold the button to start the display. A long press again will switch it off.
The display switches off automatically if there is no activity for ten minutes (default).

3 -"Pedestrian mode" function

This function allows the tricycle to run at a fixed speed of 6 km/h without pedaling. Use it only on private roads and clear of obstacles. It must only be started if the cyclist is stationed on the tricycle
To switch to pedestrian mode, press the button - for two seconds, to turn it off, press the button again -

4 - Selection of the level of assistance

The tricycle has 5 levels of assistance indicated from 0 to 5

Level 0 allows you to drive without assistance, levels 1 to 5 switch on the electric assistance, 1 being a low assistance and 5 being the highest (you will force less but consume more battery)

To select the different levels, briefly press the buttons - or + (the default level at startup is 1)

5 - Switching on the tricycle lighting

Press and hold the button + for 2 seconds , do the same operation to stop it.

The lighting of the tricycle is powered by the battery ; it may be prudent to have battery-powered emergency lighting in the event that the battery of the assistance is empty during the journey.

Do not clean the controller display with an abrasive sponge and any cleaning agent that may damage the plastic materials.

Thumb Throttle - activates once you reach a minimum speed of 3Km/h.



MAINTENANCE

Disconnecting the shifting cable when removing the rear wheel from the frame

Disconnect the cable from the cassette joint when removing the rear wheel from the frame.

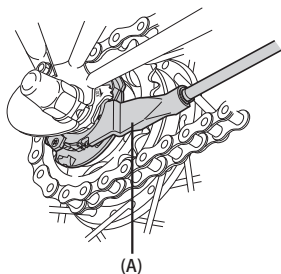

(A) Cassette joint

1. Set the REVOSHIFT lever/shifting lever to 1.

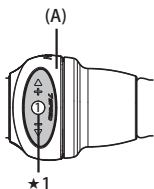

★ 1

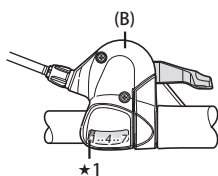

★ 1

★ 1 Set to 1

(A) REVOSHIFT lever

(B) RAPIDFIRE Plus shifting lever

2. Pull out the outer casing from the outer casing holder of the cassette joint, and remove the inner cable from the slit in the bracket.

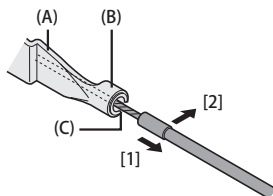

(A) Bracket

(B) Outer casing holder

(C) Slit

3. Remove the inner cable fixing bolt unit from the cassette joint pulley.

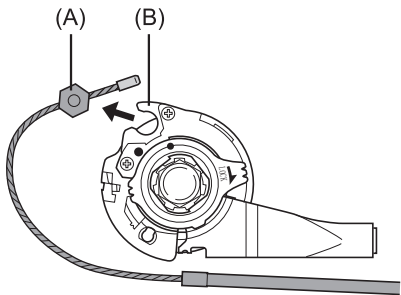

- (A) Inner cable fixing bolt unit
(B) Cassette joint pulley

TECH TIPS

When it is difficult to remove the outer casing from the outer casing holder of the cassette joint

Insert a 2 mm hexagon wrench or a #14 spoke into the hole in the cassette joint pulley and turn the pulley to slacken inner cable [1].

First, remove the inner cable fixing bolt unit from the pulley [2], and then remove the outer casing from the outer casing holder [3].

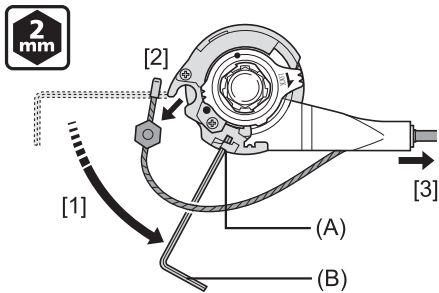

- (A) Hole in pulley
(B) 2 mm hexagon wrench or #14 spoke

* When remounting the cable, refer to the section “Installation of the shifting cable”.

Braking

Your tricycle is equipped with a powerful braking system, it is also equipped with a parking brake.

Brakes are key elements for your safety. They must be regularly checked, maintained and adjusted. Before using your tricycle on an open road, practice emergency braking on a private road without traffic.

Parking brake

Your tricycle has a parking brake that works on the front and back wheels. It is very useful to park the tricycle, because unlike a bike, it does not have a stand to stabilize it. The parking brake is activated from two small levers (picture below)



To activate the front or back parking brake, press the brake handle concerned, then while keeping the brake handle tight, pull the small lever with your index finger (pictured above).

To release the parking brake, tighten the brake handle and the small lever will be released automatically, do the same for each side.

If the braking has serious malfunctions, it is essential to consult a cycle professional before continuing to use your tricycle.

Brake maintenance

Ideally, maintenance should be done by a professional.

The main wearing parts are:

- Pads for disc brakes
- Discs
- Hydraulic fluid

After each wear part has been replaced, it is essential to fine tune the system

Schematic diagram of front basket assembly

Tighten 4 screws with M6 hexagon socket screw



Using Your Electric Tricycle

Before using the tricycle, read this manual carefully
Before riding on your e-trike, do not forget to carry out the following checks:

- The battery must be fully charged
- Tires must be inflated to the correct pressure
- The brakes must work perfectly.
- Your handlebar must be properly adjusted and secured
- Your seat is at the right height
- The lights are working
- All nuts, bolts and screws are perfectly screwed and secured.

Wear all necessary safety equipment such as:

- CE approved cycling helmet
- Pair of gloves, useful in case of a fall
- Shoes suitable for cycling (avoid sandals for example)
- Ideally a visible garment such as a fluorescent safety vest

To start

- Turn the battery switch to ON as described on page 7
- Sit on the tricycle
- Remove the parking brake(s) if necessary (see page 14)
- Start the assistance as described on pages 9 to 10
- If necessary, switch on the tricycle lighting as shown on page 10
- Start pedaling, your hands should grip the handlebars, choose the assistance mode (see pages 9 to 10) and select the speed using the rotating handle (page 12), the higher the number of gears engaged, the higher the speed of the tricycle will be.
- Your chest should be straight, look at the road and anticipate.
- Let drivers and cyclists know if you want to change direction with your arm
- If they are available, it is best to use cycle paths
- Drive with lighting as soon as visibility becomes poor
- In case of descending and turning, use both brake levers simultaneously and gradually, do the same in case of emergency braking but more firmly.
- Be aware that due to its weight, a tricycle will have more inertia when braking than a conventional bike
- On wet roads the braking distance will be increased, keep a greater

safety distance with the vehicle in front of you

In all cases, respect the rules of the current traffic regulations.

To stop

- Choose a stable and secure location
- Put at least one foot on the ground • If on a slope, keep a tight brake lever • Engage the parking brakes (see page 14)
- Switch off the tricycle lighting as shown on pages 10 • Switch off the electric power supply as described on pages 9 to 10
- Get off the tricycles turn the battery switch to **OFF** as described on page 5
- If necessary, remove the battery as described on page 8
- If necessary, place an anti-theft chain by passing it over a part of the frame
- If necessary, place the battery in charge using the charger provided

If your tricycle is dirty, clean it thoroughly with a foaming, non-aggressive product such as dishwashing liquid diluted in water.

Store your tricycle in a dry place or protect it with a suitable waterproof cover.

Maintenance of Your Electric Tricycle

It is recommended to have your tricycle checked and maintained once a year by a cycle professional to maintain a perfect level of safety and performance. For routine maintenance, follow the table below:

Intervention	Frequency
Checking tire pressure	For each use
Checking tire wear,thread,sidewall	150 km or weekly
Checking the tightness of the wheel bolts,seat,handlebar,ect.	For each use
Chain tension: For proper operation, the chain must have a vertical movement of 10 mm in the center of the distance between the sprocket and the bottom bracket.	150 km or weekly
Lubrication of the transmission chains with a special silicone chain oil is preferred: clean the chains thoroughly with a degreaser (e. g. brush and soapy water) before lubrication.	Weekly and after washing or heavy rain
Lighting control	For each use
Checking the clearance: steering, wheel axles, yoke and crankset	500 km or monthly
Brake efficiency test	For each use
Checking brake lining wear (pads and/or pads), disc wear and cable condition	500 km or monthly
Fixing and holding of baskets	For each use
Maintenance of the transmission, gearshift system, freewheel and differential if present	2000 km or per year
Cleaning and checking of electrical connections and wires	Monthly

Worn parts to be replaced immediately if damaged

- Worn, torn or cracked tire
- Brake pad or brake pad worn or cut Split or veiled rim
- Broken, twisted or missing wheel spoke Light bulb or LED
- Brake cable or chain and derailleur rusted, wire-wound or broken

Electrical cable stripped or torn off

- Bolt, screw or nut screwed, rusty or missing

Tightening torques (N.m)

Pedals on the cranks	30
Tightening the handlebars on the stem	10
Tightening the stem	14
Tightening the headset	23
Brake levers	3.5
Brake calipers	7
Derailleur lever	3
Seat on its trolley	20
Seat post collar	10
Wheel with motor	30
Wheel without motor	25
Baskets and luggage racks	8

It is important to respect the recommended tightening torques in order to ensure that the parts are firmly held together and to avoid damaging the threads. It is therefore necessary to use a torque wrench graduated in Newton-meter

LCD Error Codes

Error code	Error definition	How to troubleshoot
"04"	The throttle has not returned home	Check if throttle has returned home
"05"	Throttle fault	Check the throttle
"07"	Overvoltage protection	Check the battery voltage
"08"	Motor hall signal cable fault	Check the motor module
"09"	Motor phase cable fault	Check the motor module
"11"	Controller temperature sensor failure	Check the controller
"12"	Current sensor failure	Check the controller
"13"	Battery temperature fault	Check the battery
"14"	Motor temperature fault	Check motor
"21"	Speed sensor fault	Check installation position of speed sensor
"22"	BMS communication fault	Replace the battery
"30"	Communication fault	Check the controller connection

SERVICE

For any after-sales service request or spare parts order, please contact us by email or by phone to the information as below.

WARRANTY CERTIFICATE

Our tricycles are guaranteed for one year for the frame,electrical and mechanical parts including the battery except for wear parts such as tires, tubes, cables, nuts and bolts and brake pads.

Certificate of guarantee to send us with the copy of your invoice

Read our full Terms and Conditions
and Warranty Information here:
www.etrikescanada.com/pages/terms-conditions

Acquisition date:	
Model:	Colour:
Frame Serial Number:	

Name/Last Name:	
Address:	
Zip Code:	
City:	Country:
Tel:	

Reseller Stamp	This warranty does not cover damage caused by improper use of the tricycle or due to negligence or the use of non-original parts. Damage resulting from personal operations of maintenance or improper storage of the tricycle.
----------------	---------------------------------------------------------------------------------------------------------------------------------------------------------------------------------------------------------------------------------