

VSTICK PNP

Before beginning assembly, please read these instructions thoroughly.

EP
version

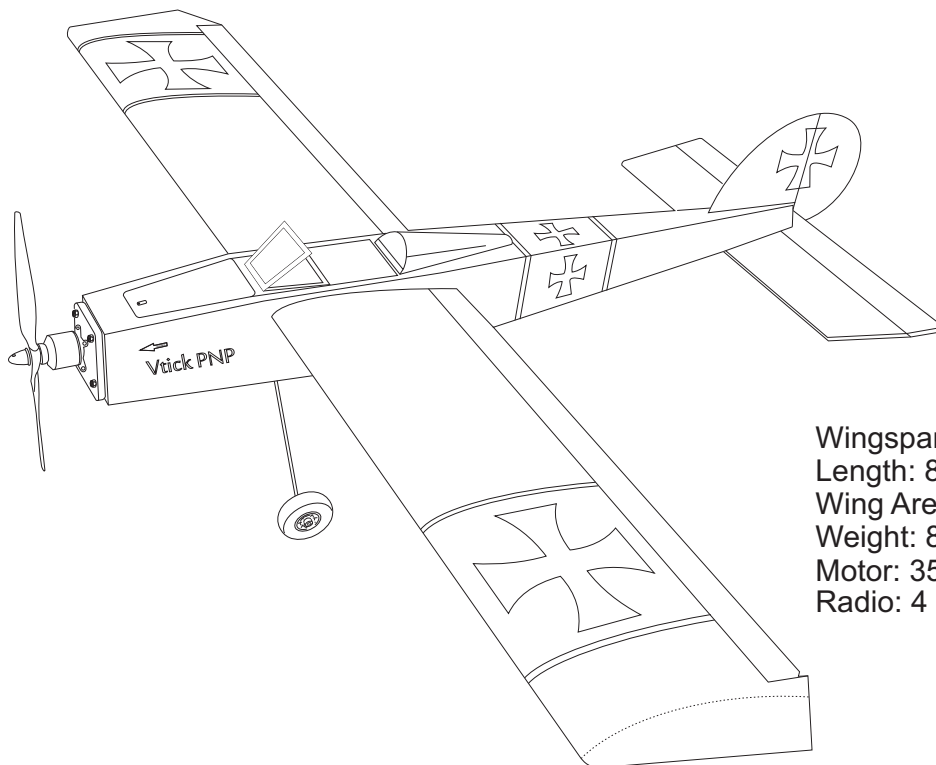

Wingspan: 1198mm (46.5")
Length: 860mm (34")
Wing Area: 22.7dm² (322Sq Inch)
Weight: 850-950g (1.9-2.1lbs)
Motor: 350-500watts
Radio: 4 chanel , 4 servos



UNDER SAFETY PRECAUTIONS

This radio control model is not a toy!

- It is highly recommended that first-time builders seek advice of experienced modelers before beginning assembly.
- Assemble this kit only in places out of children's reach!
- Take enough safety precautions prior to operating this model. You are responsible for this model's assembly and safe operation!
- Always keep this instruction manual ready at hand for quick reference, even after completing the assemble.
- Taking out liability insurance is recommended.

***SPECIFICATIONS ARE SUBJECT TO CHANGE WITHOUT NOTICE.**

The pre-covered film on ARF kits may wrinkle due to variations of temprature. Smooth out as explained at right.

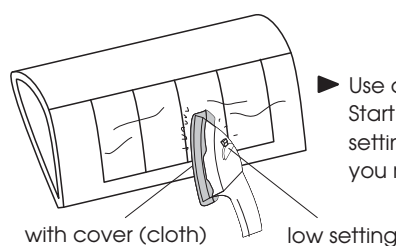

► Use an iron covered with a cloth!
Start at low setting. Increase the setting if necessary. If it is too high, you may damage the film.

ITEM REQUIRED FOR OPERATION (Not included in kit!)



CAUTION : For details concerning the equipment listed below (size, make, etc.) check with your hobby shop.

GP version

EP version

1 Radio Set

A minimum 4 channel radio for airplanes (with 5 standard servos), and nicad or alkaline batteries are required.

4-channel (minimum) radio system for aircraft 4 servos (standard servos). Please be sure to use servos with enough torque (3.0 - cm minimum).

■ Y-Harness 2pcs

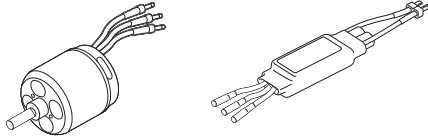

- Pre-installed Outer Rotor Motor. 350 watts
- Pre-installed ESC 18-25A
- 3 cells lipo (11.1V) recomended 2000 - 2500 Mah

TOOLS REQUIRED (Purchase separately!)

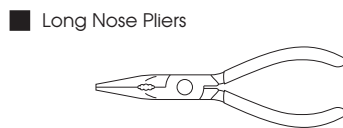
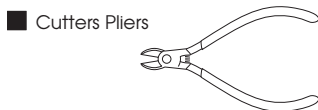
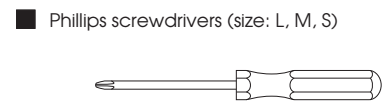
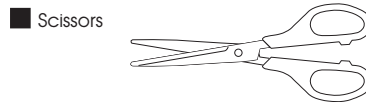

BEFORE YOU BEGIN

accepts no responsibility for accidents, damage or breakage if other manufacturers parts are used.

- 1 Read through the manual before you begin, so you will have an overall idea of what to do.
- 2 Check all parts. If you find any defective or missing part, contact your local dealer or our VMARSHOP.
- 3 Symbols used throughout this instruction manual, comprise:

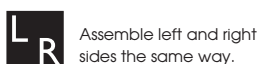
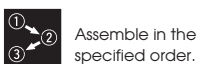
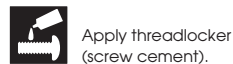
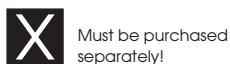
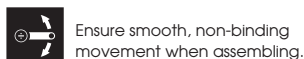
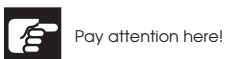

● Do not overlook This symbol!

1 wing



Warning!

Set all screws securely. If they come off during flight you will lose control of your aircraft!

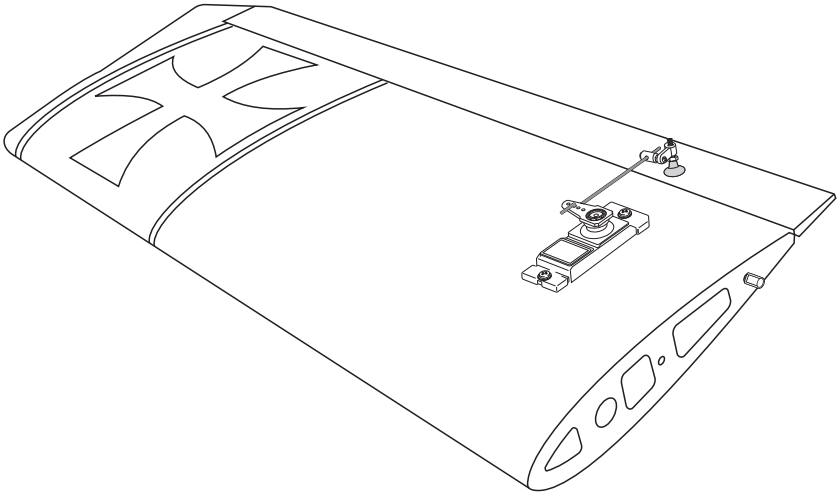

Typical control horn installations

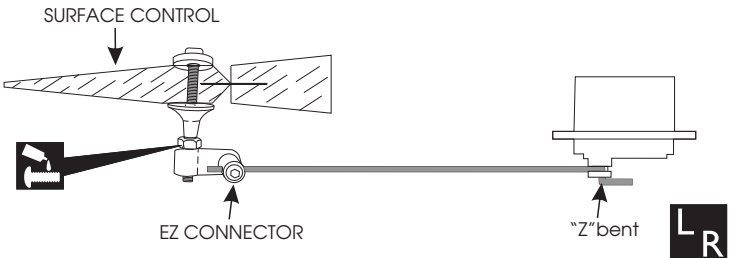
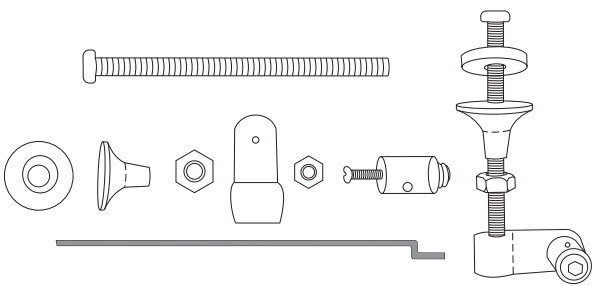

2 Installing main landing gear

L R

2 x 10mm TP Screw 4

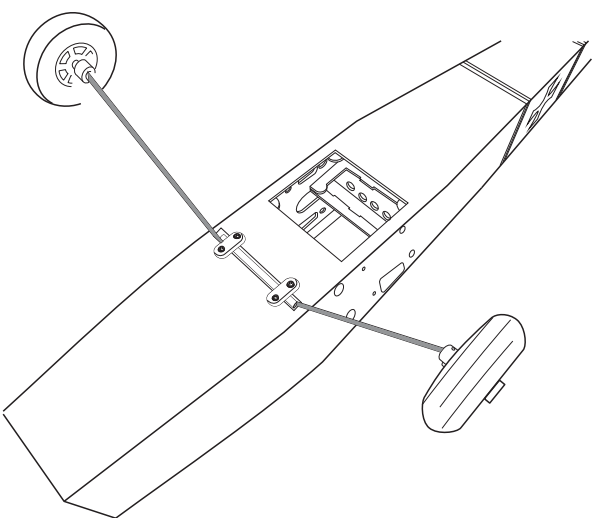
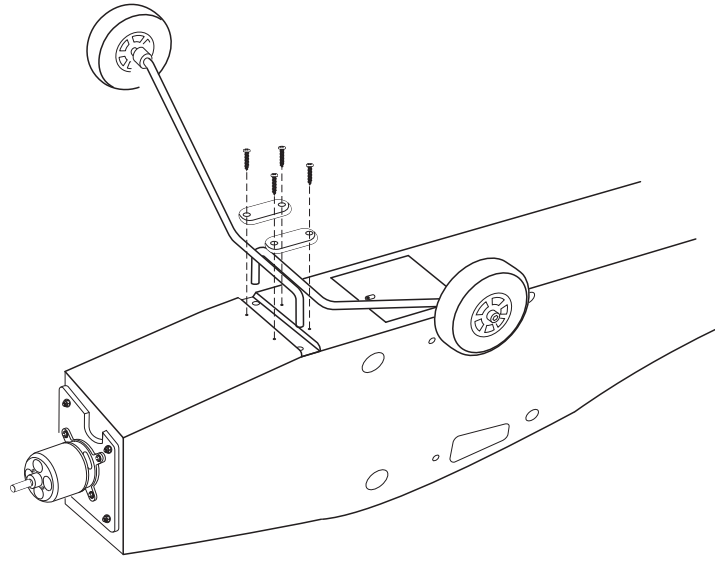

Cut off shaded portion.	Drill holes with the specified diameter.	Assemble left and right sides the same way.	Pay close attention here!
Must be purchased separately!	Assemble as many time as specified.		

3 Installing vertical stabilizer to the fuselage

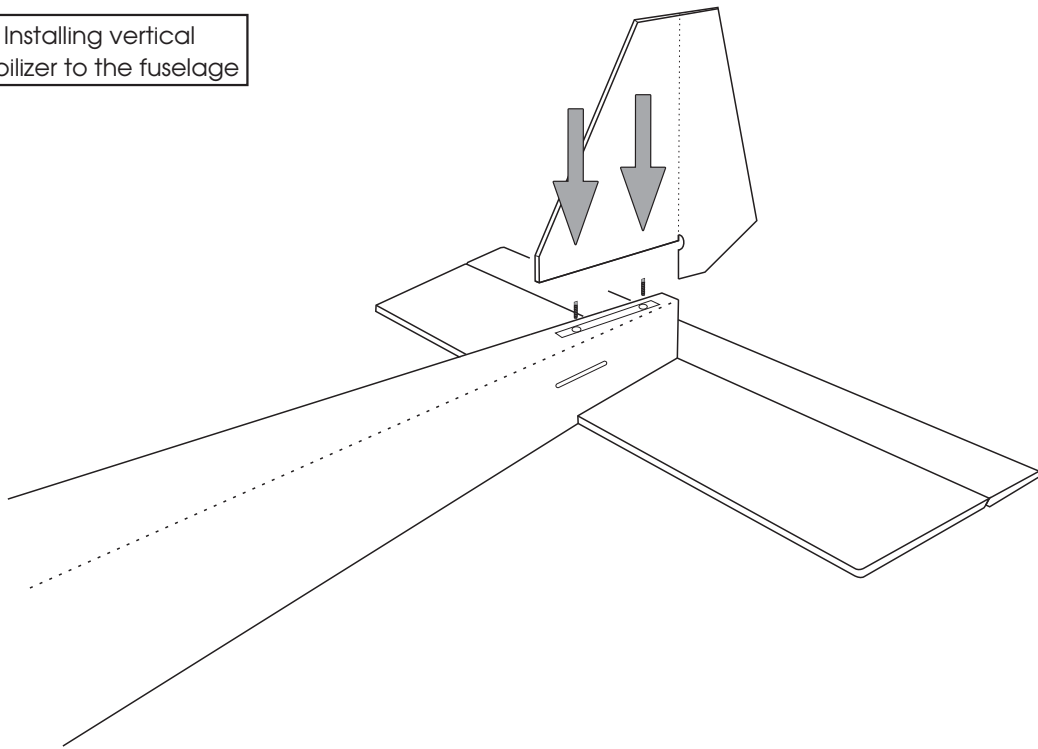

L R

4 Installing horizontal stab to the fuselage

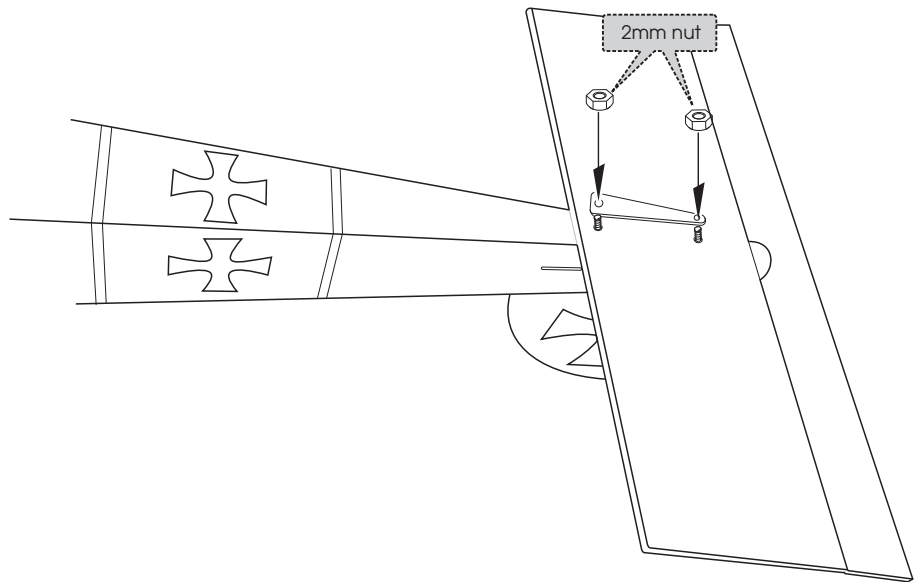

5 Installing tail wheel

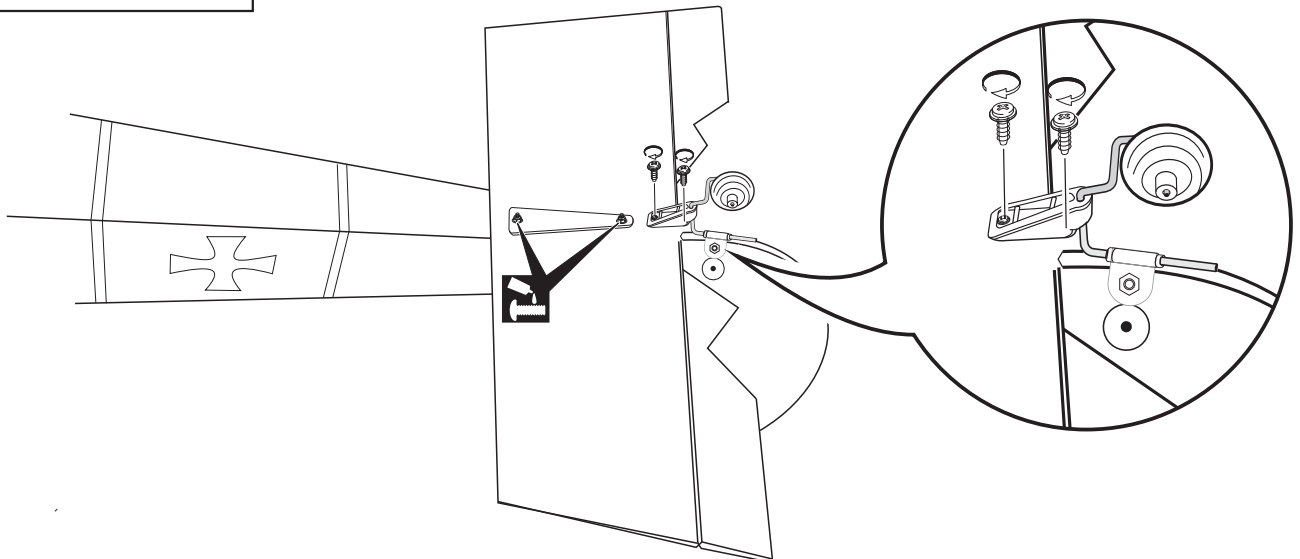

6 Attach wing to the fuselage

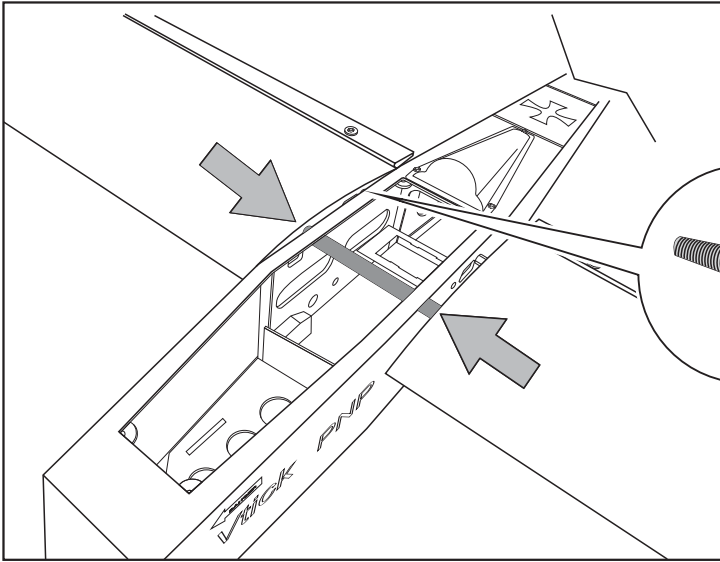

High wing configuration

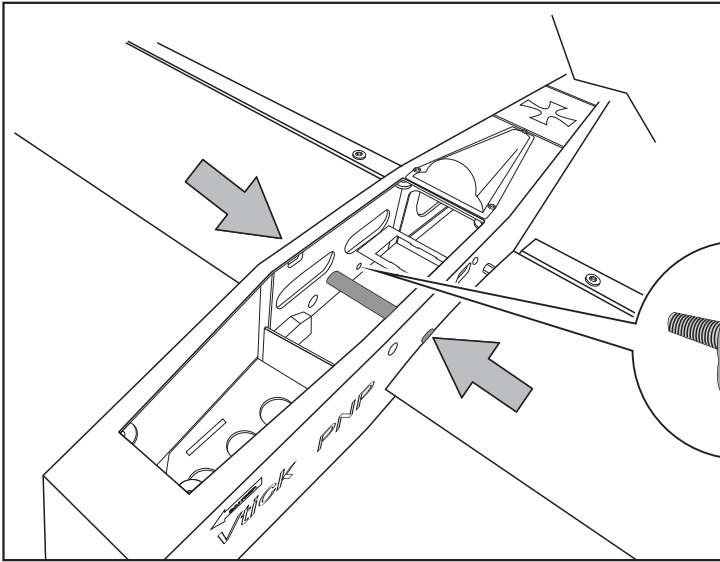

Low wing configuration

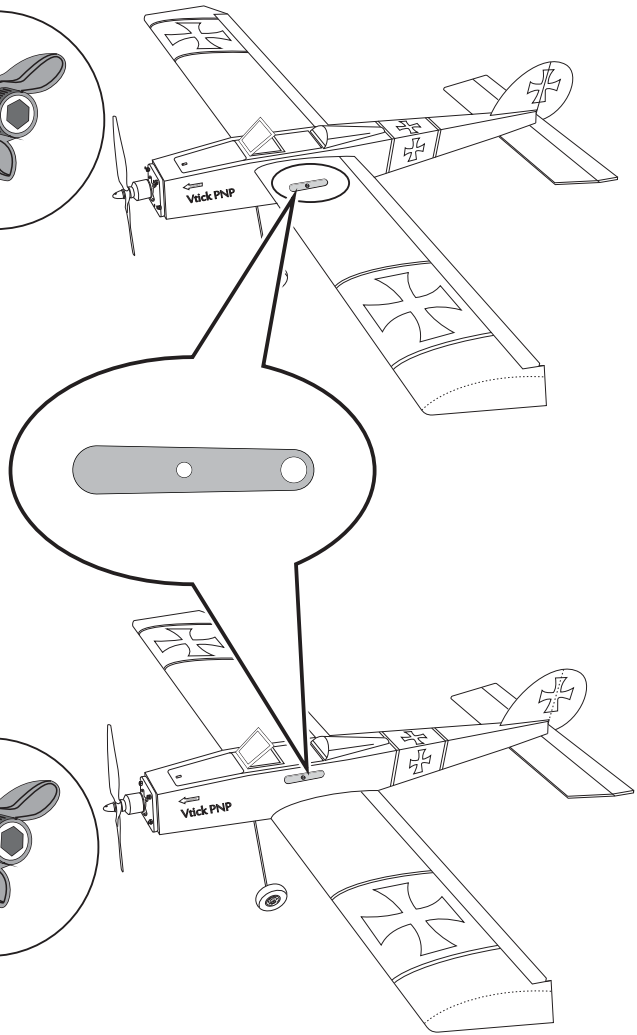

L R

7 Connect control rod to elevator and rudder

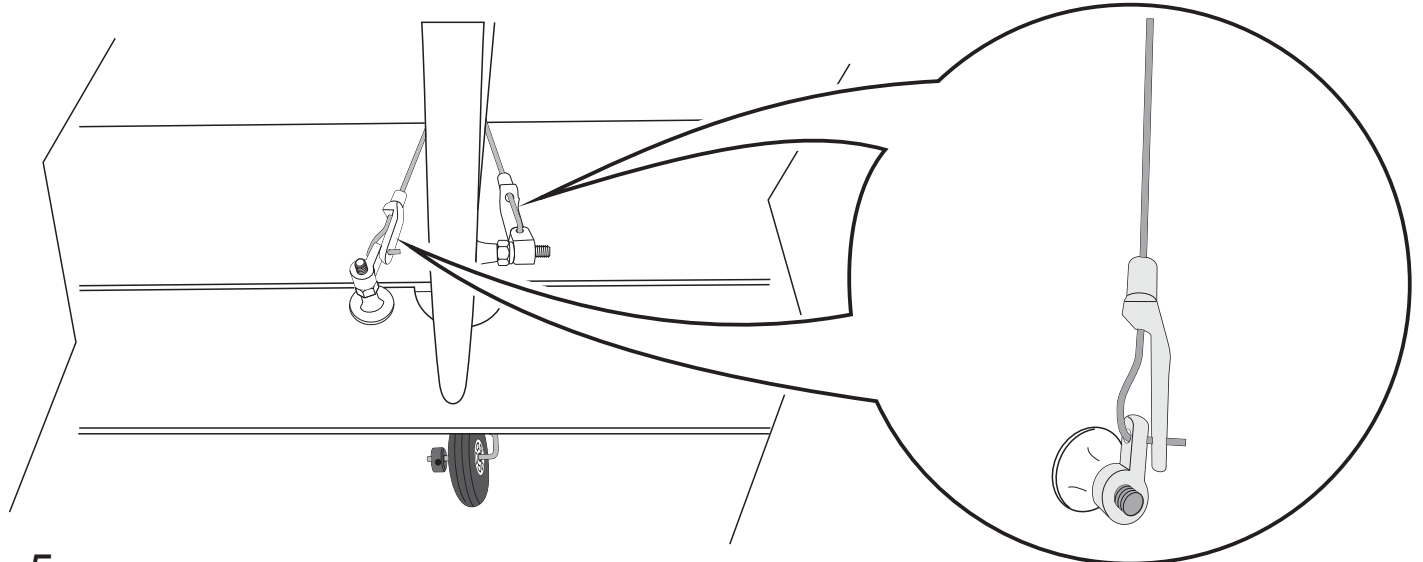

8

C of G position



In order to obtain the CG specified, reposition the receiver and other equipment

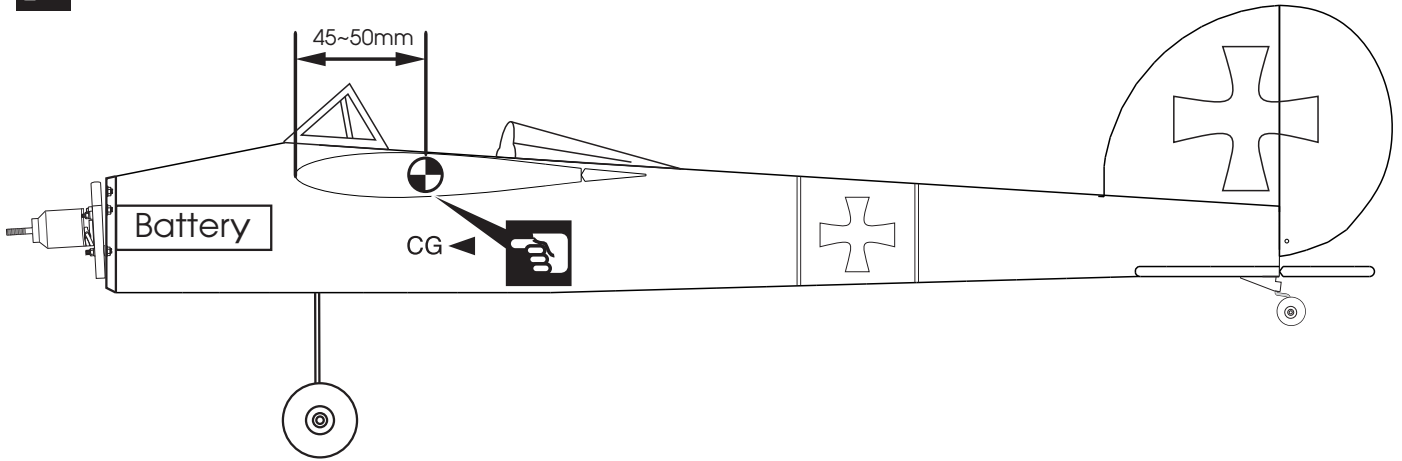

Warning!

Do not fly before confirming the correct location of the CG. If the CG is incorrect, you lose control of your airplane which leads to accidents!

9

Surface control movement

SURFACE CONTROL MOVEMENT

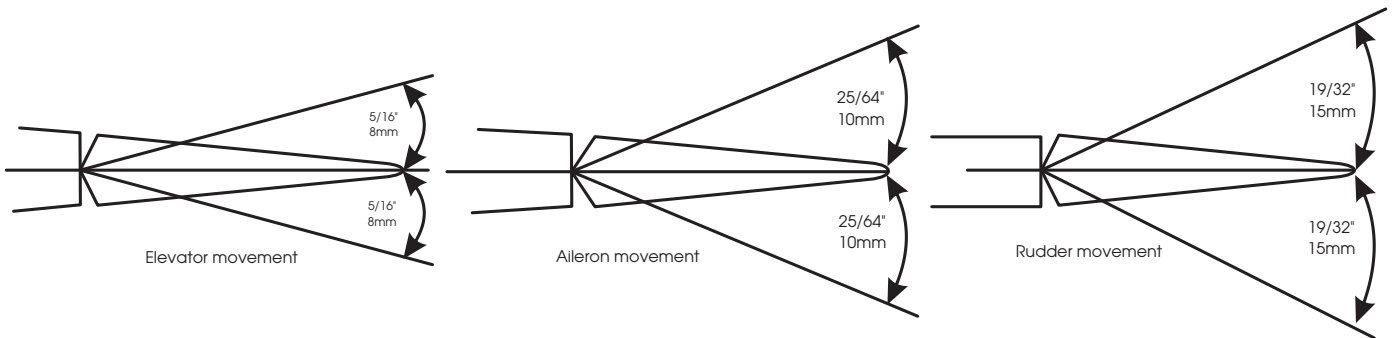

	High rate	Low rate
ELEVATOR	5/16" (8mm) up 5/16" (8mm) down	15/64" (6mm) up 15/64" (6mm) down
RUDDER	19/32" (15mm) right 19/32" (25mm) left	7/16" (11mm) right 7/16" (11mm) right
ALERON	25/64" (10mm) up 25/64" (10mm) down	5/16" (8mm) up 5/16" (8mm) down

