

SLINGSHOT

Self Retracting Pull Style Tarping System

PART #: T-SLINGSHOT / T-SLINGSHOT2
T-SLINGSHOT3



We appreciate your purchase of a tarp system. We promise that all our tarp systems are built from the highest quality material available, therefore we can also vow to stand behind the quality of our product.

WARNING:

- Never operate tarp system under power lines, this may cause injury due to electrocution.
- Never operate tarp system while moving.

CAUTION:

- Read through instructions for entire system and follow directions thoroughly to ensure the system functions properly.

TOOLS REQUIRED:

- Ratchet
- 3/8", 1/2", 9/16", and 3/4" Sockets and Wrenches
- Screw Driver
- Drill
- 3/8" and 1/2" Drill
- Tape Measurer
- 1-1/2" Hole Saw

CONTENTS – SLINGSHOT

INSTALLATION INSTRUCTIONS

INCLUDED PARTS:

* = OPTIONS

QTY	Part #	Description	No.
1	T-SSTA	SlingShot Tarp Axle	4
1	T-SHMA	Slingshot Mounting Adapter	5
1	T-ABWF	Axle Bearing w/ Flange	6
2	T-ATSMB	Tarp Spool Mounting Bracket	2
5	T-5161834HXBLT	5/16-18 X 3/4 Hex Bolt, 5/16 Flat Washer	n/s
5	T-516NYNUT	5/16 Nylon Nut	n/s
2	T-AEFC	Aluminum End Foot Cap	15
4	T-HOOK02	J-Hook	n/s
1	T-516PR	Pull Rope	n/s
2	T-RETAIN01	Single Retainer	n/s
1	T-SCLPB	Cab Level Steel Pull Bar	15
1	T-SSHWK	Slingshot Hardware Bag	n/s
*1	T-AWD	Aluminum Wind Deflector	1
*1	T-92AH	92" Aluminum Housing	n/s

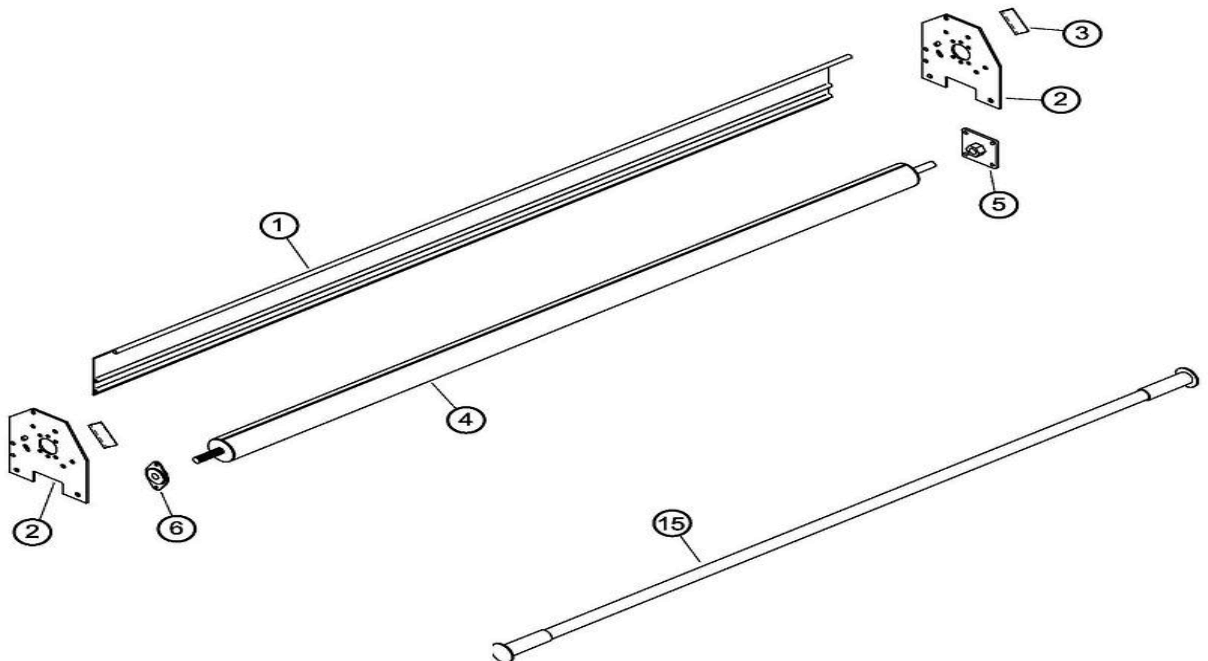

INSTALLATION INSTRUCTIONS

SLINGSHOT – SELF RETRACTING TARPING SYSTEM

Mounting The Tarp Spool Mounting Brackets

1) Mount the TARP SPOOL MOUNTING BRACKET (#3) as far forward as possible on the passenger side of dump body. Use the supplied 1/2" x 1" bolts and drill the two mounting bracket holes 1-3/4" down from the top edge of the box. The rubber bumper that came attached to the mounting bracket should face towards the rear of the truck.

2) Mount the other TARP SPOOL MOUNTING BRACKET (#3) with the AXLE BEARING (#4) as far forward as possible on the Driver side of the dump box. Use the supplied 1/2" x 1" bolts and drill the two mounting bracket holes 1-3/4" down from the top edge of the box. The rubber bumper should face towards the rear of the truck

Installing The Tarp And SlingShot

3) Measure the distance between the two TARP SPOOL MOUNTING BRACKETS (#3). The SLINGSHOT TARP AXLE (#1) should be approximately 2-inches shorter than this dimension. If the SLINGSHOT TARP AXLE(#1) is too long, remove the aluminum end cap from the end of the SLINGSHOT TARP AXLE with the non-threaded shaft and cut the SLINGSHOT TARP AXLE to the correct length using a standard radial or hack saw. Replace the aluminum end cap onto the SLINGSHOT TARP AXLE. Install the TARP into the SLINGSHOT TARP AXLE by sliding the 5/16" square nuts into the slot and then screwing the 5/16" bolts with washers (#12-13-14) through the grommets in the tarp. Slide the NON-THREADED SHAFT (#6) into the AXLE BEARING (#4) on the Driver side of the dump box. Remove the nut from the Threaded Shaft of the SLINGSHOT TARP AXLE and install this shaft into the SLINGSHOT MOUNTING ADAPTER (#5) on the Passenger side of the dump box. Use your hand to turn the SLINGSHOT TARP AXLE (#1) a couple turns to secure the Threaded Shaft to the SLINGSHOT MOUNTING ADAPTER

Mounting The Pull Bar And Tailgate Latches

4) Slide the Rear Pull Bar into the pocket on the rear of the tarp. Using The #3 Grommets in the

center section of the TARP or by cutting a slit into the rear pocket, tie the rope through the grommet and around the rear pull bar. Mount the SINGLE RETAINERS to the outer top edge both the Driver and Passenger Side of the tailgate. These latches hold the pull bar assembly to the tailgate.

Pre-Loading The Slingshot

5) Using your hands rotate the SLINGSHOT TARP AXLE (#1) to pre-load SLINGSHOT TARP AXLE (#1). Use the chart below to determine the number of required preload turns:

Tarp Length	Number of Turns
10 – 14 ft.	35 turns
14 – 20 ft.	40 turns
20 – 26 ft.	45 turns
26 – 32 ft.	50 turns

DO NOT EXCEED 60 TURNS OF PRELOAD.

Pull Rope And Storage Hook Installation

6) Tie the PULL ROPE in the center of the PULL BAR. Bolt two J HOOKS to the tailgate to allow the entire length of the PULL ROPE to be stored when the load is covered. Bolt two J HOOKS to the front driver side of the truck to allow the entire length of the PULL ROPE to be stored when the load is uncovered.

(Optional) Installing The Wind Deflector

7*) Install the optional WIND DEFLECTOR (#2) by measuring the distance between the TARP SPOOL MOUNTING BRACKETS (#3). If the WIND DEFLECTOR (#1) is too long mark the width and cut the wind deflector to the correct length using a standard radial or hack saw. Attach the WIND DEFLECTOR to the TARP SPOOL MOUNTING BRACKETS using the six supplied 5/16-18x1-1/4 SlotT-23 Thread Cutting Screw

(Optional) Mounting of the Enclosed Housing

8*) Using a tape measurer identify the location of the mounting holes on the housing and then mark on the holes on the truck bed for pre-drilling using a marker or a template can be made with hole locations on it by laying a piece of card board on the ground tracing around the edge of the housing and placing the holes in the proper place.