

KYM Industries

“We Cover Your Load”

Crank and Pull

Cab Level Crank Manual Tarp System Installation Instructions



We would like to congratulate you on your purchase of your new KYM INDUSTRIES tarp system. Our products are constructed of the highest quality materials. If you need support at any time through the installation process feel free to contact your rep at **888-577-5218**.

WARNING:

- Never operate tarp system while moving.

CAUTION:

- Read through instructions for entire system and follow directions thoroughly to ensure the system functions properly.

TOOLS REQUIRED:

- Ratchet
- 3/8", 1/2", 9/16", and 3/4" Sockets and Wrenches
- Pipe Wrench
- Welder- Steel and Aluminum
- Screw Driver
- Drill
- 3/8" and 1/2" Drill
- 1-1/2" Hole Saw

CONTENTS – CRANK AND PULL



INSTALLATION INSTRUCTIONS

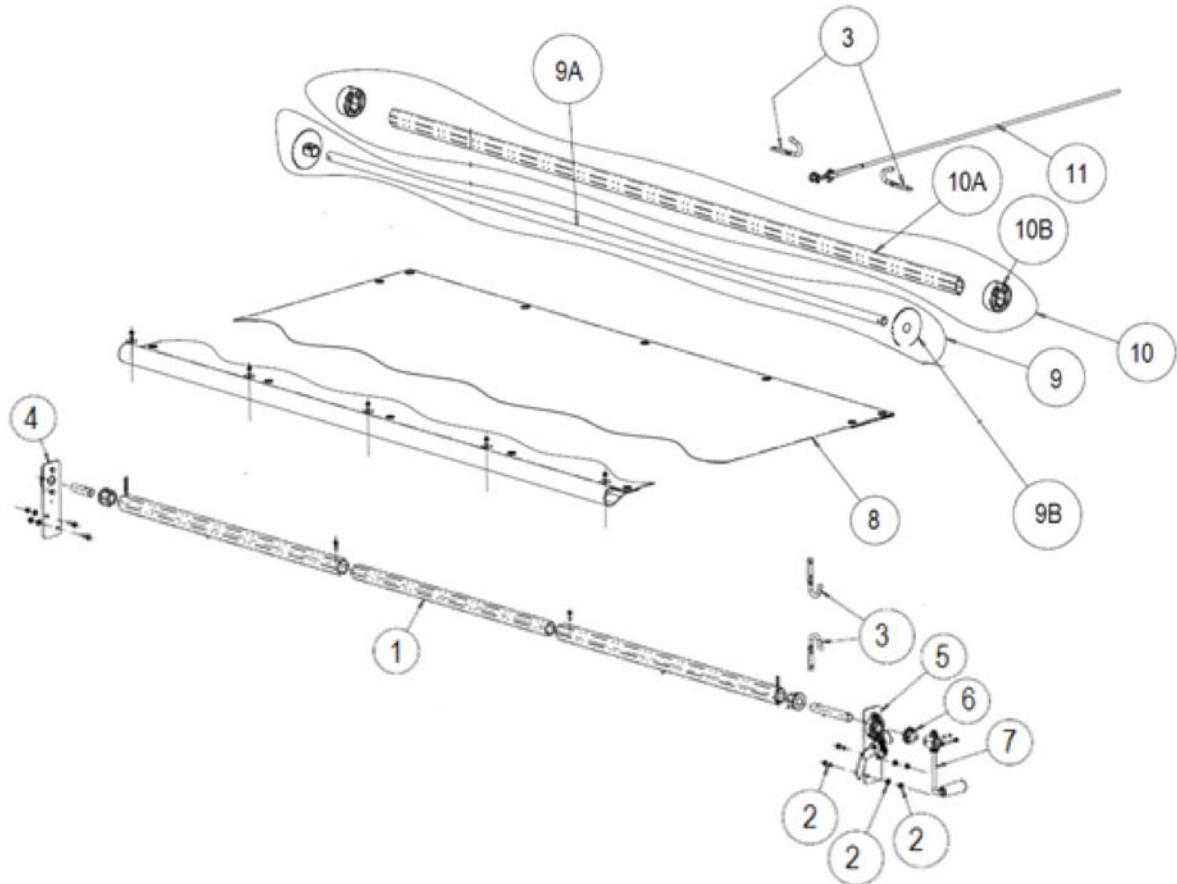

Item #	Description	TSI Part Number
1	Cab Level Tarp Axle	T-CABLATA
2	Assorted Hardware	T-CABLCKHW
3	Box Hooks for Derby Rope	T-312JH
4	Passenger Side Mounting Bracket & Bearing	T-CABLMB
5	Driver Side Mounting Bracket, Bearing, & Break	T-CABLMBWB
6	Sprocket Attachment	T-CABAS1
7	Crank Handle	T-CLCH
8	Tarp	T-MISC. TARP
9	Standard Pull Bar Assembly	T-CABLCK2
9A	Steel Pull Bar	T-312JH
9B	Aluminum End Foot Cap	T-CABLMB
10	Aluminum Pull Bar Assembly	T-CABCK3
10A	Aluminum Pull Bar	T-CABAS1
10B	PATROT Tarp Centering Flanges	T-CLCH

1. Determine the location of the tarp roller. The tarp roller should be mounted above the cab on the dump body's cab guard. To prevent damage from loads being dumped into the body, the tarp roller should be mounted outside of the dump body's load area. Also, verify the location is accessible for winding the tarp up. (Figure 1)

2. Clamp the bearing bracket assemblies (item 4&5) to the dump body in the locations determined in step 1. The bearing bracket assembly with the detent lever (item 5) is to be mounted on the driver's side of the dump body. Make sure the brackets are aligned vertically as well as from front to back by measuring from a common point on each side of the body. Verify the bearing bracket assemblies are mounted high enough to accommodate the tarp when rolled onto the roll bar assembly.

3. Mark the bearing bracket mounting hole's locations onto each side of the dump body. Remove the brackets and drill 13/32" holes in the four marked locations.

4. Assemble the bearing brackets to the dump body using the four 3/8-16 x 1 cap screws, lock washers and nuts supplied. Do not tighten fasteners at this time, just hand tighten to hold brackets in position.

5. Locate the inner hex tube (item 1) and make a pencil mark in the center of the tube's length. Insert the inner hex tube half way into the driver's side roll tube assembly. Insert the passenger's side roll tube assembly onto the opposite end of the inner hex tube. Measure the distance between the inside of the mounted bearing brackets (for measurements less than 81.75": The driver's and passenger's side roll tube assemblies will need to be shortened by an equal amount to obtain the proper width). Separate the roll tubes, so the length of the

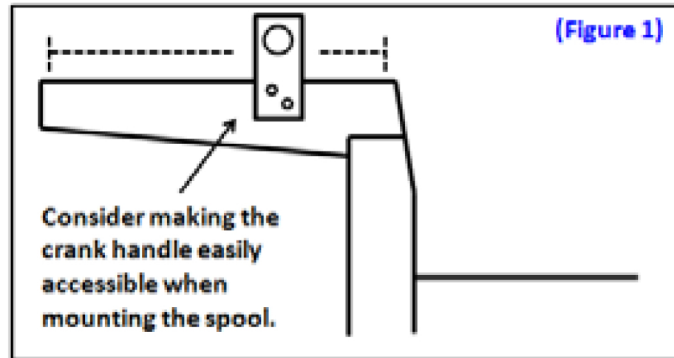

of the complete roll tube assembly from adaptor to adaptor is 1/4" less than the distance between mount brackets. Locate the pencil mark, and verify that the inner hex tube is centered inside the outer roll tube assemblies. Screw each roll tube assembly to the inner hex tube using one 1/4" x 1" self drilling and tapping screw 2" from the end of the outer tube.

6. Unfold tarp and make sure the black webbing reinforcement is facing down. The (5) STAINLESS STEEL grommets will attach to the tarp roller with provided Tek screws and washers. The (3) BRASS grommets go to the rear of the trailer for pull rope attachment.

7. Center the tarp on the tarp roller assembly and screw in place with five evenly spaced 1/4" x 1" self-drilling tapping screws and fender washers. Make sure the screws are centered in the hex tube and the screws on each end are at least 2" from the end of the roll tube assembly. Be careful not to screw into the shaft adaptors on each end.

8. Remove one of the bearing bracket assemblies and slide the tarp roll assembly in to the remaining bearing. Slide removed bearing bracket over shaft and reassemble to the dump body. Tighten 3/8" bracket mounting bolts at this time.

9. Center the tarp roll assembly between the mounting brackets and tighten set screws in each bearing race.
10. Assemble sprocket (item 6) onto the 1" shaft of the driver's side roll tube assembly (item 1). With the detent lever in the open position, slide the sprocket down the shaft until it is tight against the bearing.
11. Assemble crank handle assembly (item 7) onto the driver's side roll tube shaft using the 1/4" X 2" screw and lock nut provided.
12. Assemble pull rope assembly (item 11) to the center grommet on the rear of the tarp (item 8). (See figure 3.)
13. Assemble two rope storage hooks (item 3) to the dump body tailgate to wrap the pull rope for storage when tarp is covering the body. The hooks should be mounted horizontally and may be bolted (bolts not included) or welded to the dump body. The recommend distance between the hooks is 15-17". (See figure 3.)
14. Assemble two rope storage hooks (item 3) to the side dump body near the crank handle

assembly to wrap the pull rope for storage when tarp is retracted. The hooks should be mounted vertically and may be bolted (bolts not included) or welded to the dump body. (See figure 2.)

Optional Accessory

Optional Pull Bar Kit Installation [T-CABLCK2]

Note: For tarps narrower than 6 feet the center tube (item 9A or 10A) will need to be shortened and re-drilled.

1. Slide rear pull bar (item 9A or 10A) into the pocket in the rear of the dump body tarp. Center the bar in the tarp. The same amount of bar should be exposed on each side of the tarp.
4. After the rear bar is centered to fit the tarp, the excess bar may be cut off to limit the amount of bar protruding outside the body. If the rear bars are cut, the cut ends should be painted to prevent premature rusting.
3. Attach the Aluminum End Foot Caps (Item 9B) or the PATRIOT Tarp Centering Flanges (item 10B) to both sides of the pull bar to complete the assembly

