

LYON ¼-turn

Assembly instruction
Instrucciones de instalación

1069721

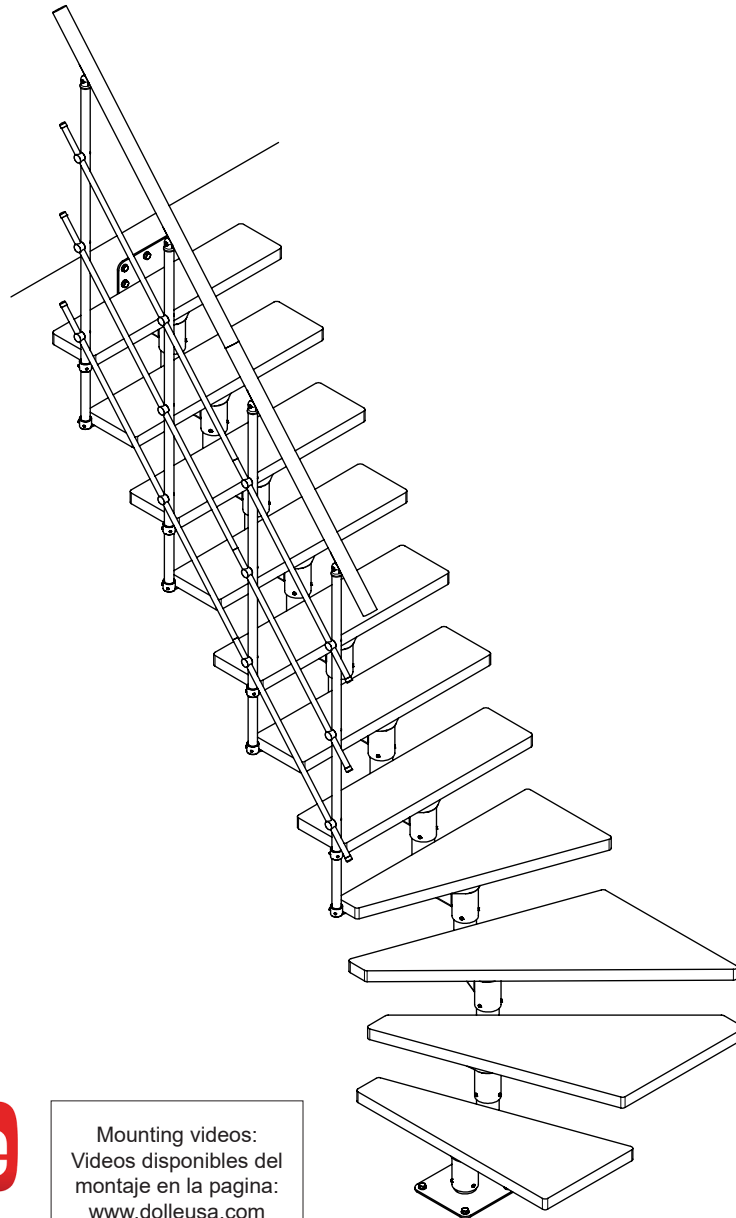

Mounting videos:
Videos disponibles del
montaje en la pagina:
www.dolleusa.com

Review these instructions completely before beginning installation.
Questions - call customer service 855-DOLLE US or 763-452-7492 - Monday - Friday 8:00-5:00 central.
info@dolleusa.com. Metric tools required.

Revise estas instrucciones en su totalidad antes de iniciar la instalación.
Si tiene alguna pregunta, llame al servicio al cliente al 855-DOLLE desde los EE.UU o al 763-452-7830
de lunes a viernes de 8:00 a 5:00, hora central de los EE.UU. info@dolleusa.com. Se necesitan her-
ramientas métricas.





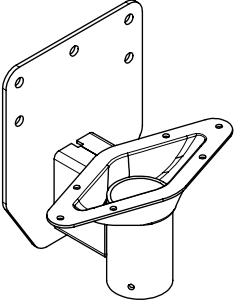
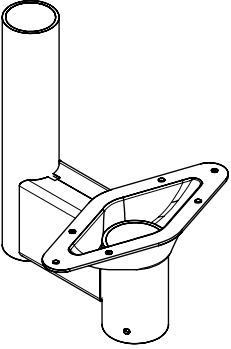
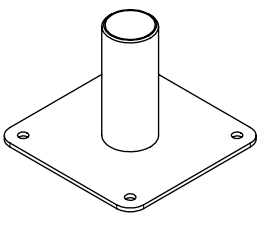

Part list • Lista de componentes

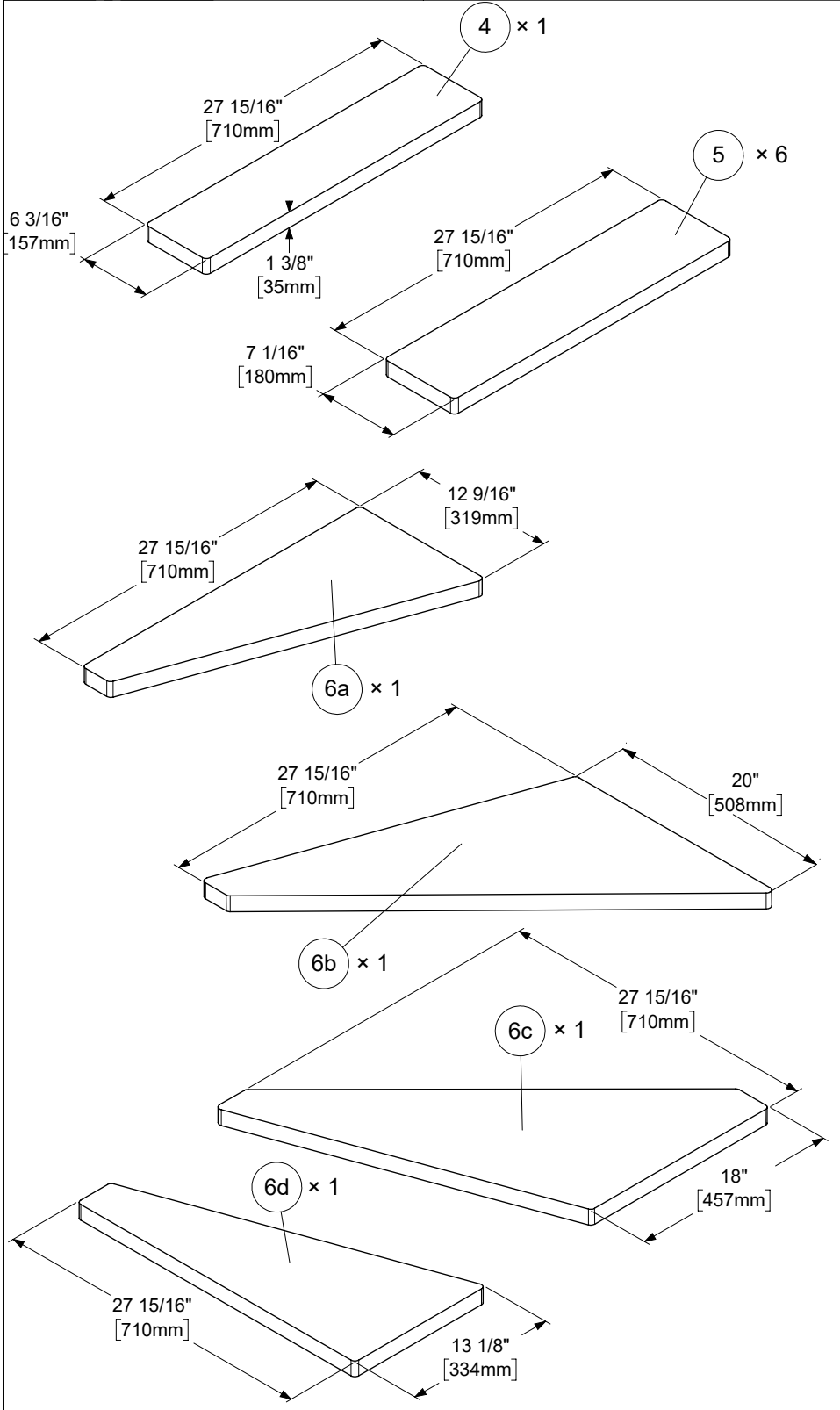
Please check that all items are included before assembly

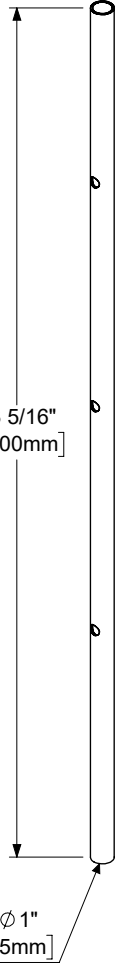
Verifique que todos los componentes estén incluidos antes del montaje.

<p>1</p>  <p>× 1 K2-40540</p>	<p>2</p>  <p>× 10 K2-40530</p>	<p>3</p>  <p>× 1 K2-40520</p>
--	---	--

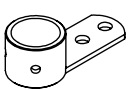

<p>7</p>  <p>43 5/16" [1100mm] Ø 1" [25mm]</p> <p>× 4 K1-40510</p>	<p>8</p>  <p>× 4 K1-32726</p>
<p>9</p>  <p>× 4 K1-32725</p>	<p>10</p>  <p>× 12 K1-32775</p>
<p>11</p>  <p>× 6 K1-32770</p>	<p>12</p>  <p>× 8 K2-40560</p>
<p>13</p>  <p>× 4 K3-08041 Ø 1/2" x 1 9/16" [12mm] [40mm]</p>	

14

$\varnothing 9/16"$
[15mm]

39 3/8"
[1000mm]

× 6
K1-40550

15

$\varnothing 1 9/16"$
[40mm]

39 3/8"
[1000mm]

× 2
K1-40570

<p>30</p> <p>× 9 K3-06003 Ø10 x 60 mm</p>	<p>31</p> <p>× 2 K1-13500</p>	<p>32</p> <p>× 9 K3-04001 Ø10 mm</p>	<p>33</p> <p>× 12 K3-05056 M6 x 5 mm</p>	<p>34</p> <p>× 56 K3-05003 M8 x 6 mm</p>	<p>35</p> <p>× 88 K3-06030 ST6 x 30 mm</p>
---	-----------------------------------	--	--	--	--

<p>36</p> <p>× 12 K1-04040 M6 x 16 mm</p>	<p>37</p> <p>× 4 K3-01002 ST5 x 18 mm</p>	<p>38</p> <p>× 4 K3-03020 M5 mm</p>	<p>39</p> <p>× 8 K3-06022 Ø5 x 35 mm</p>	<p>40</p> <p>× 16 K3-05013 M6 x 6 mm</p>	<p>41</p> <p>× 2 K3-06015 Ø8 x 70 mm</p>
---	---	---	--	--	--

<p>42</p> <p>× 2 K3-04028 Ø8 mm</p>	<p>43</p> <p>× 2 K3-08004 Ø10 x 60 mm</p>	<p>45</p> <p>× 9 K3-08001 Ø12 x 60 mm</p>
---	---	---

Tools required • Herramientas necesarias

Metric Tool Required for Installation • Herramientas métricas necesarias para la instalación

NOT SUPPLIED • NO SUMINISTRADAS

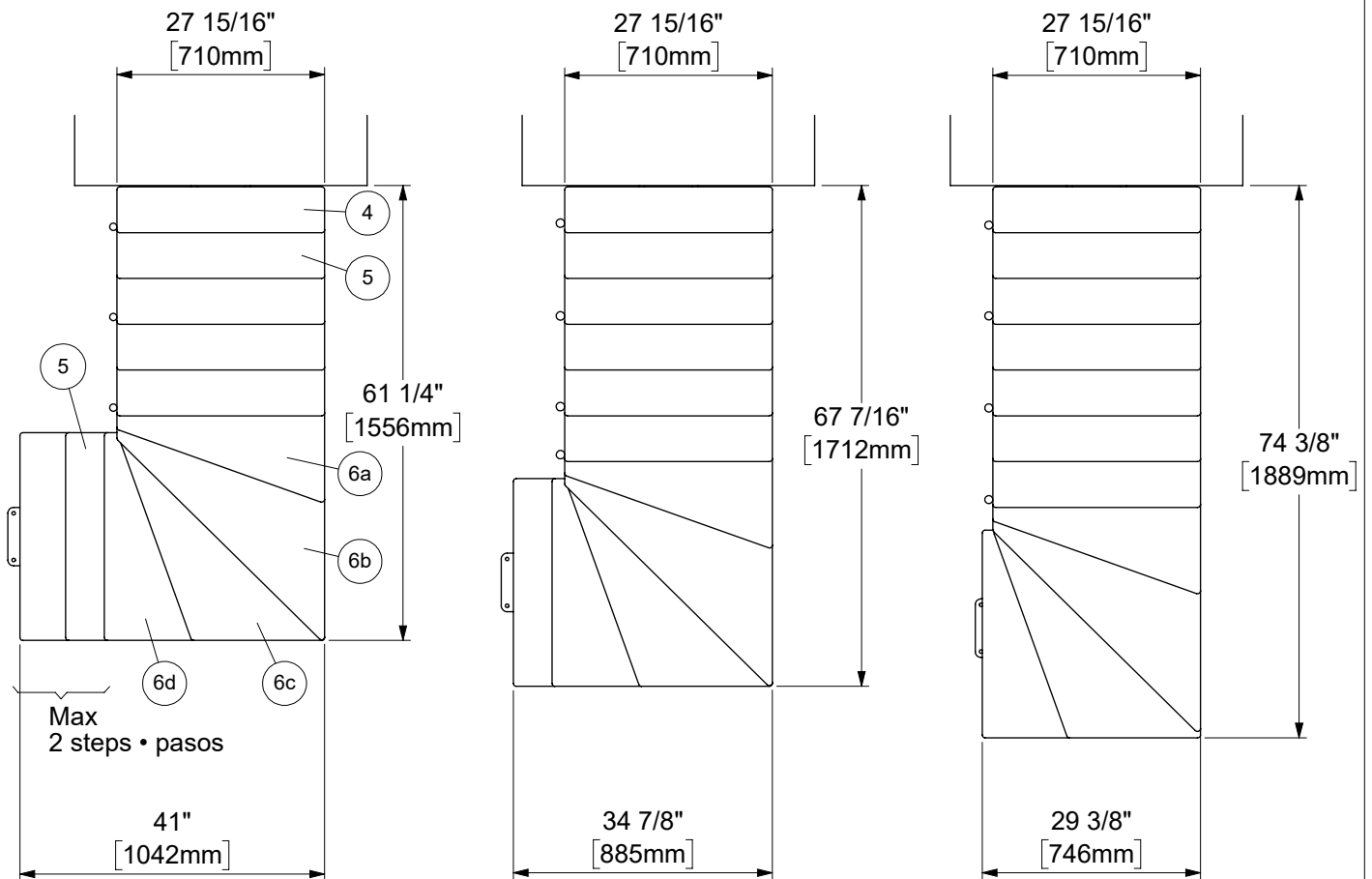
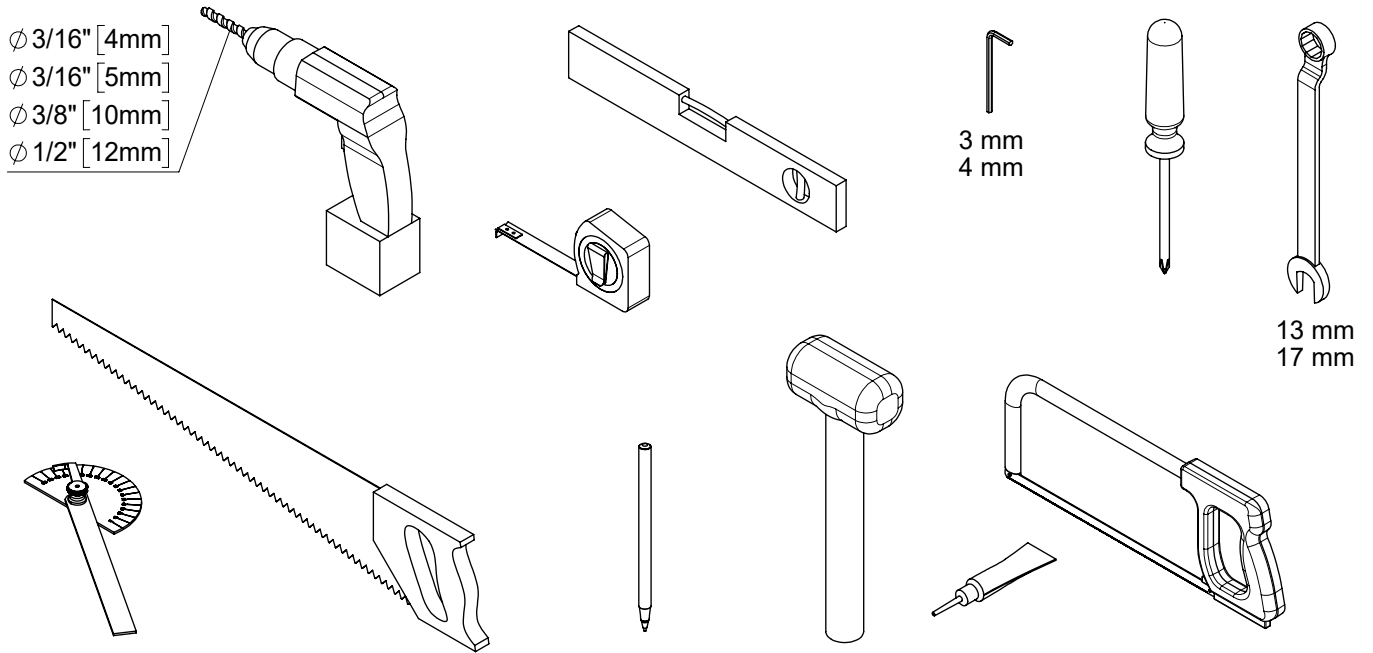

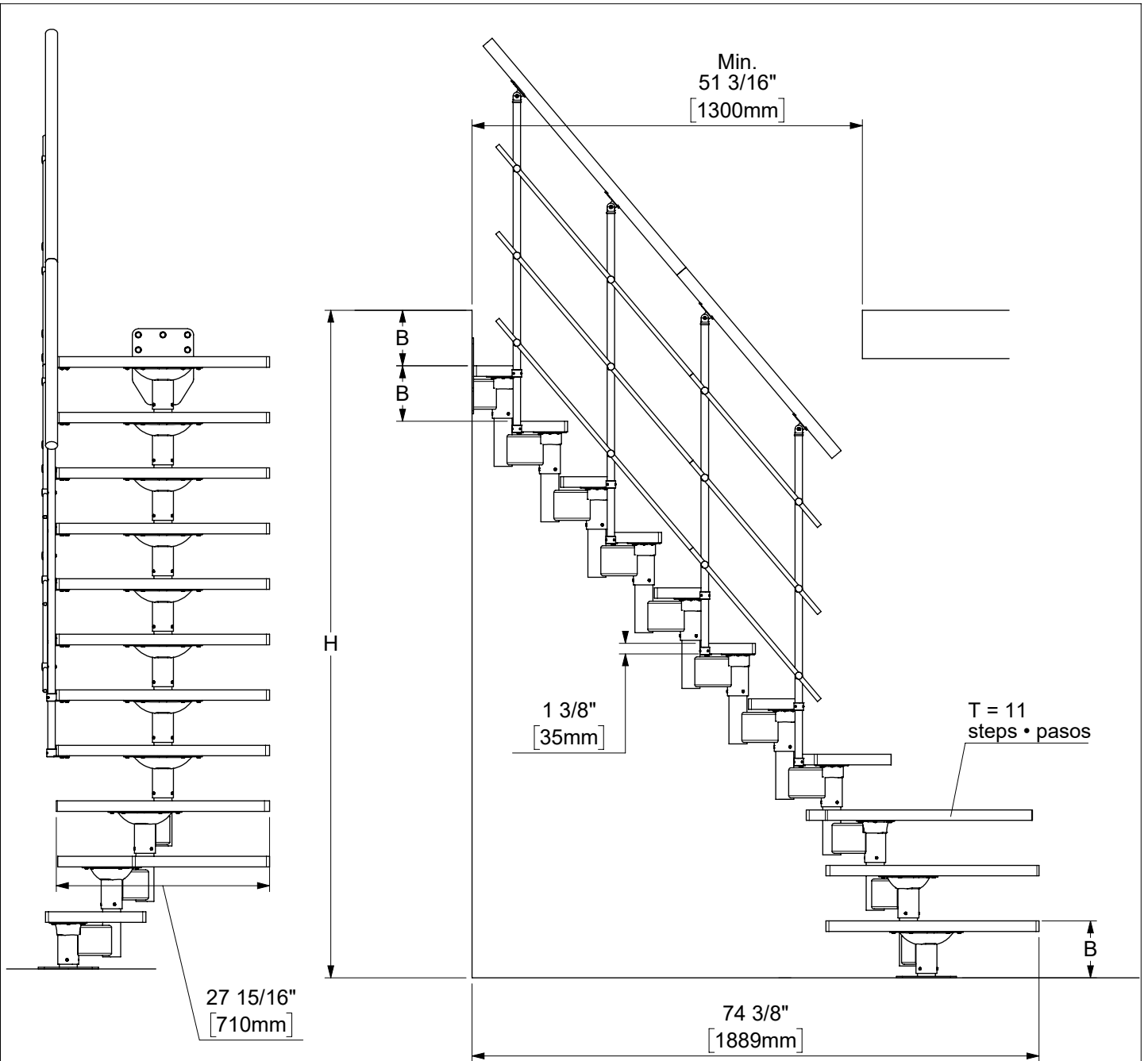

$$B = \frac{H}{T+1}$$

B min	B max
7 1/16" [180mm]	8 11/16" [220mm]

T	H min	H max
11	85 1/16" [2160mm]	103 15/16" [2640mm]

Example • Ejemplo

H = 2500 mm or • o H = 100"
T = 11 steps • pasos

$$B = \frac{100"}{11 + 1} = 8 \frac{5}{16}"$$

$$B = \frac{2500\text{mm}}{11 + 1} = 208,3\text{mm}$$

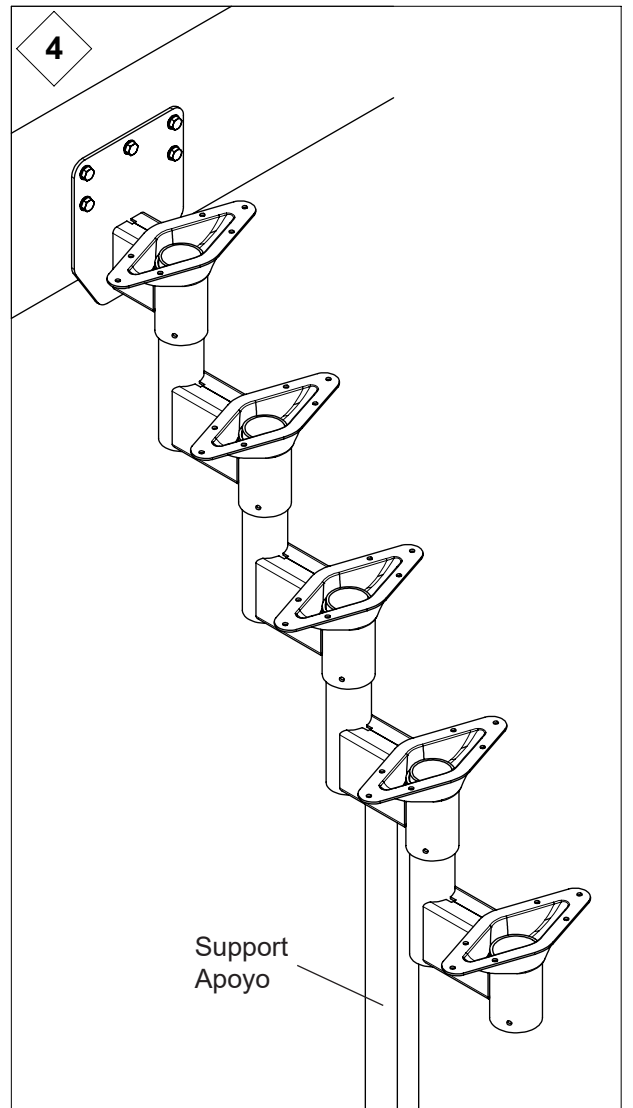
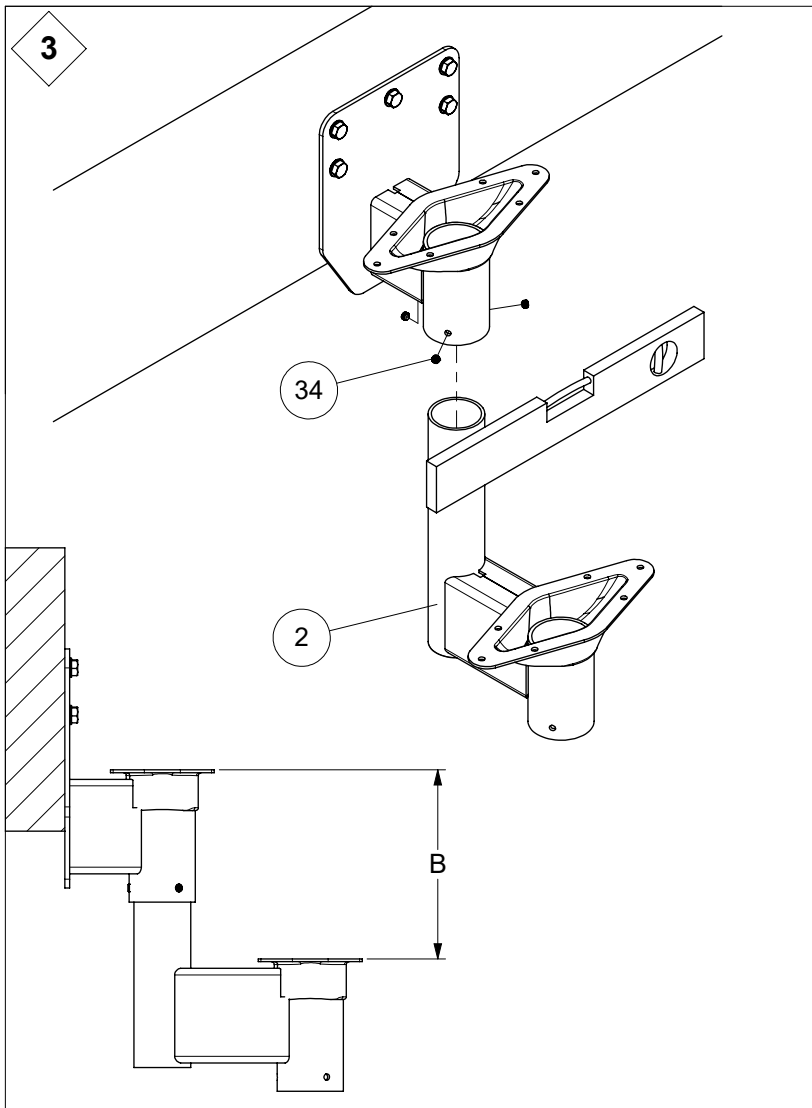
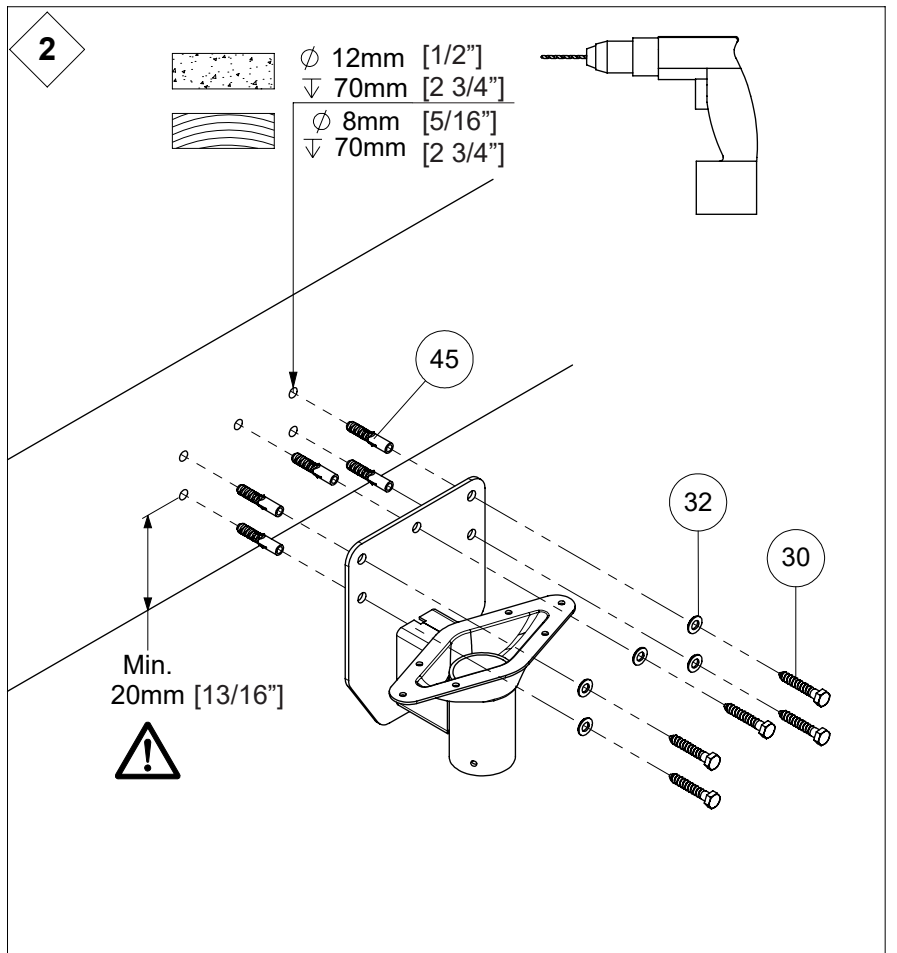
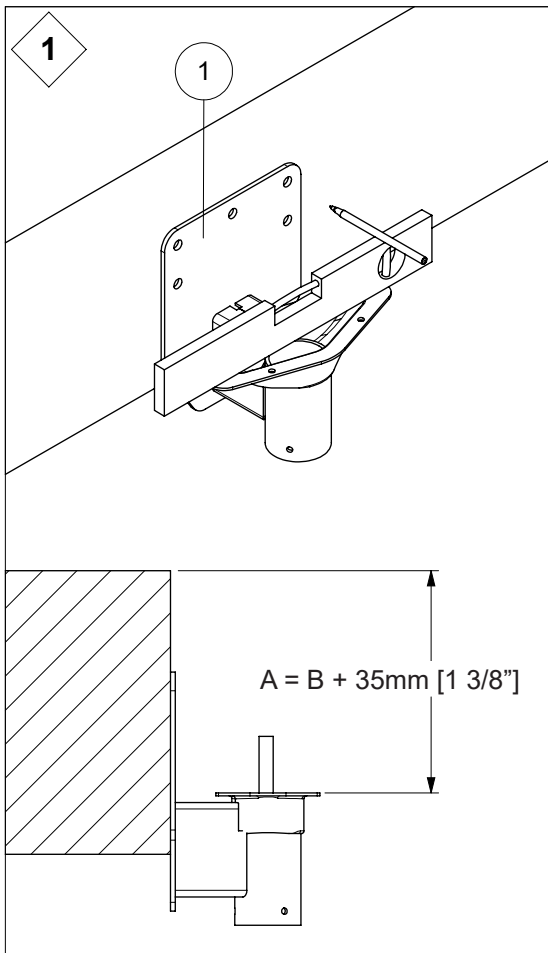

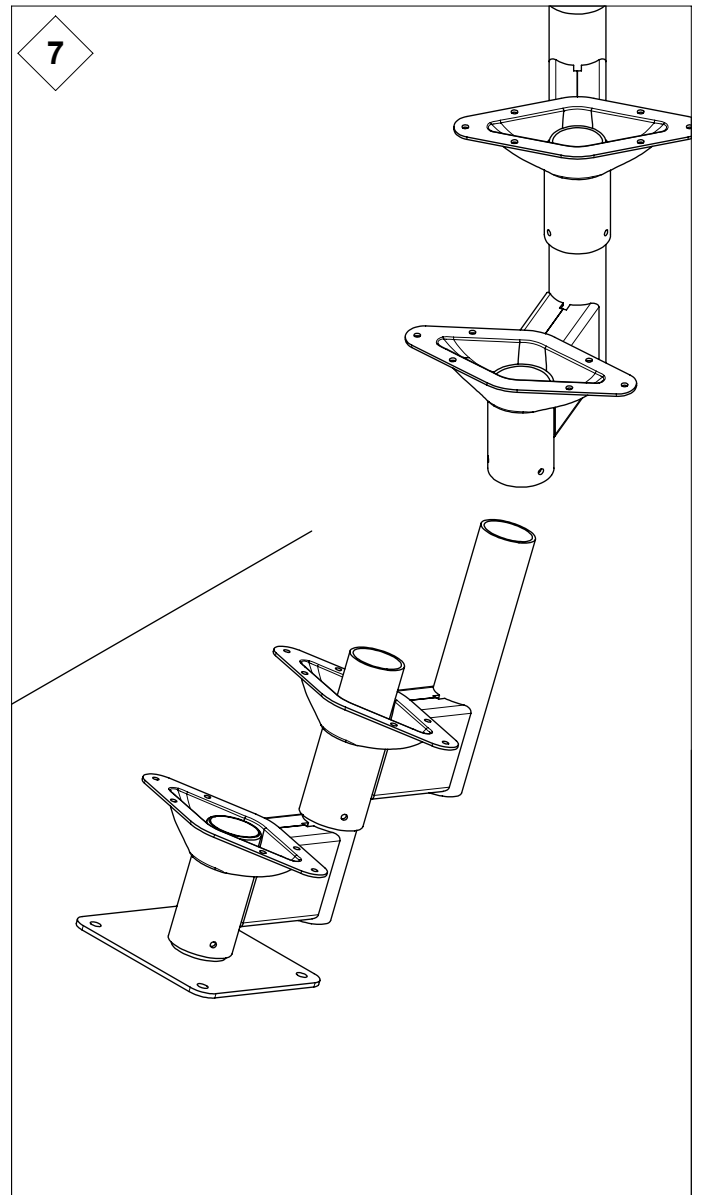
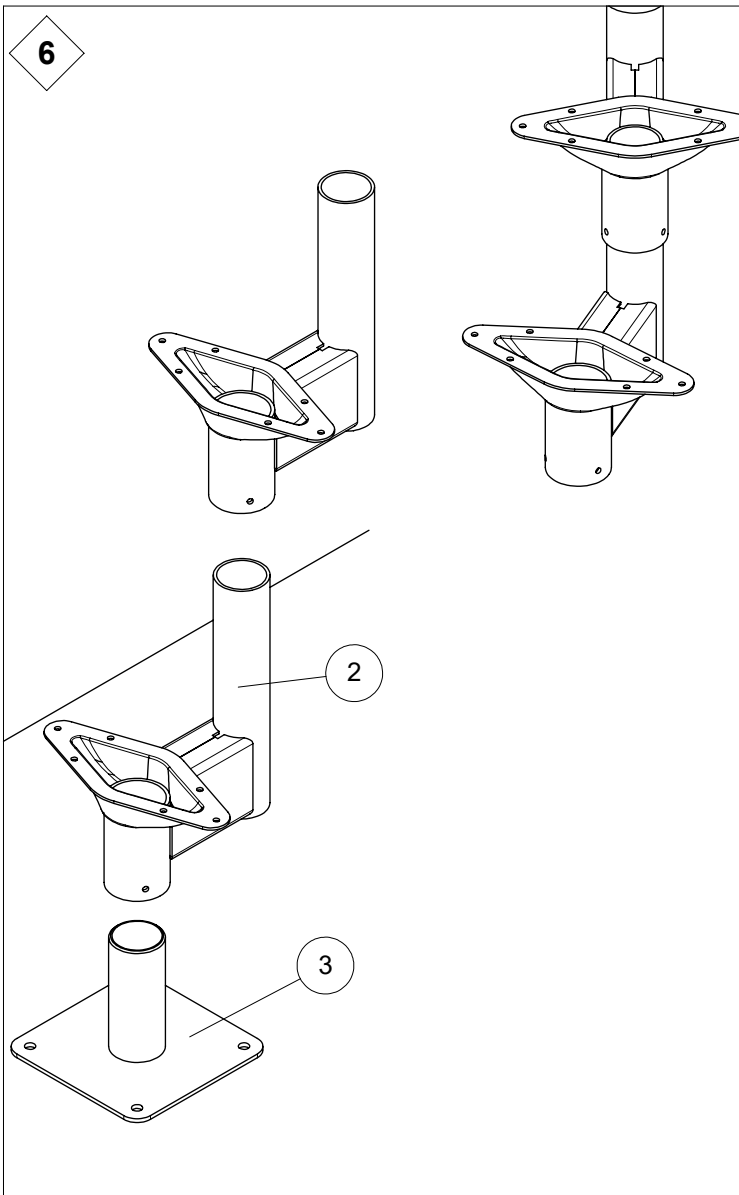
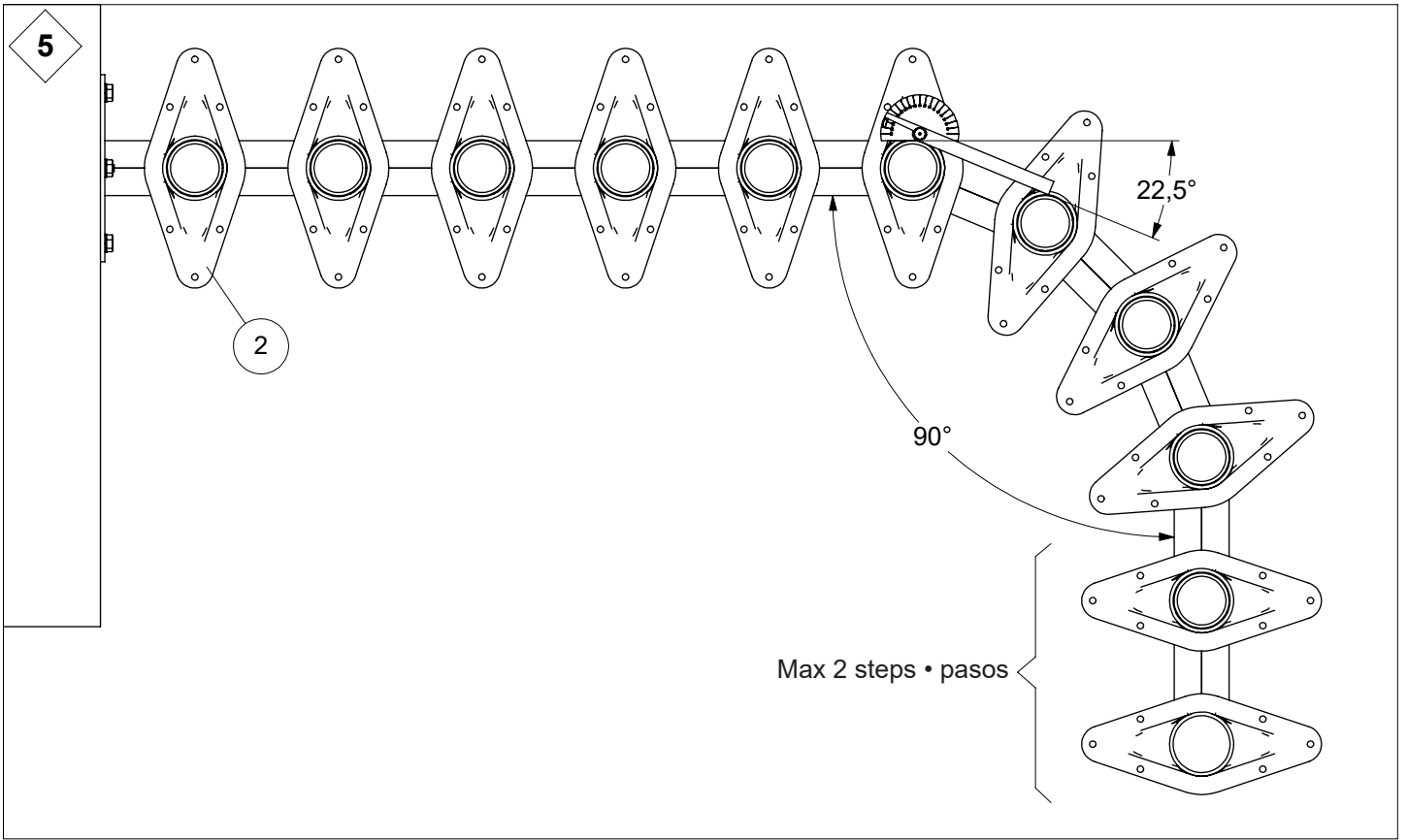

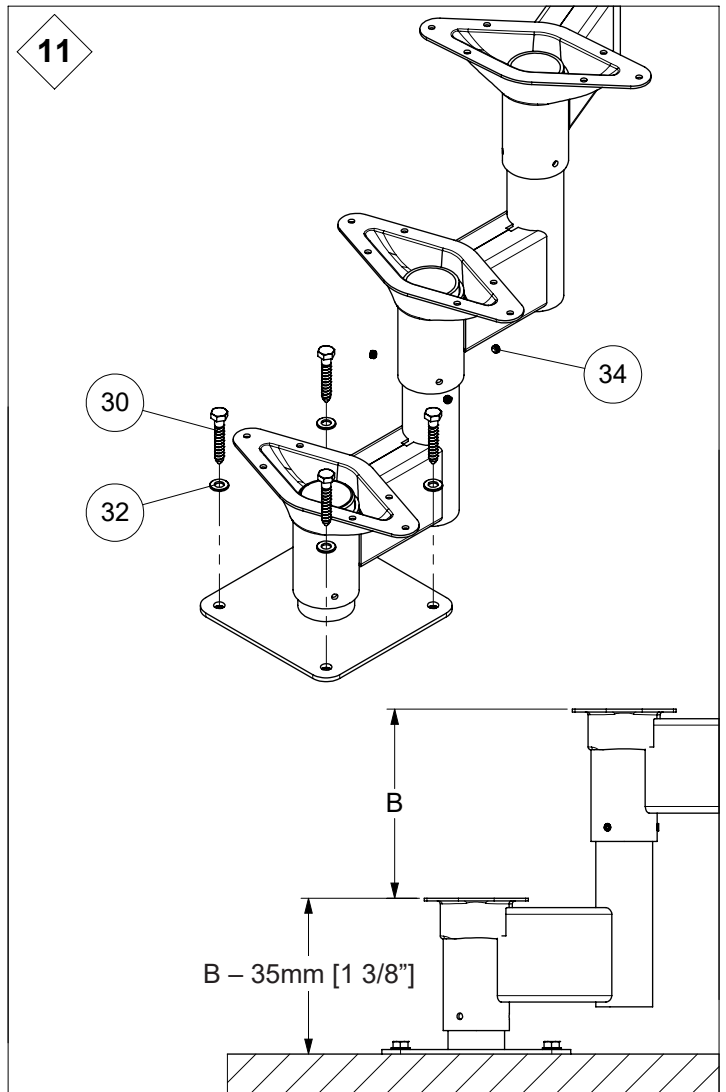
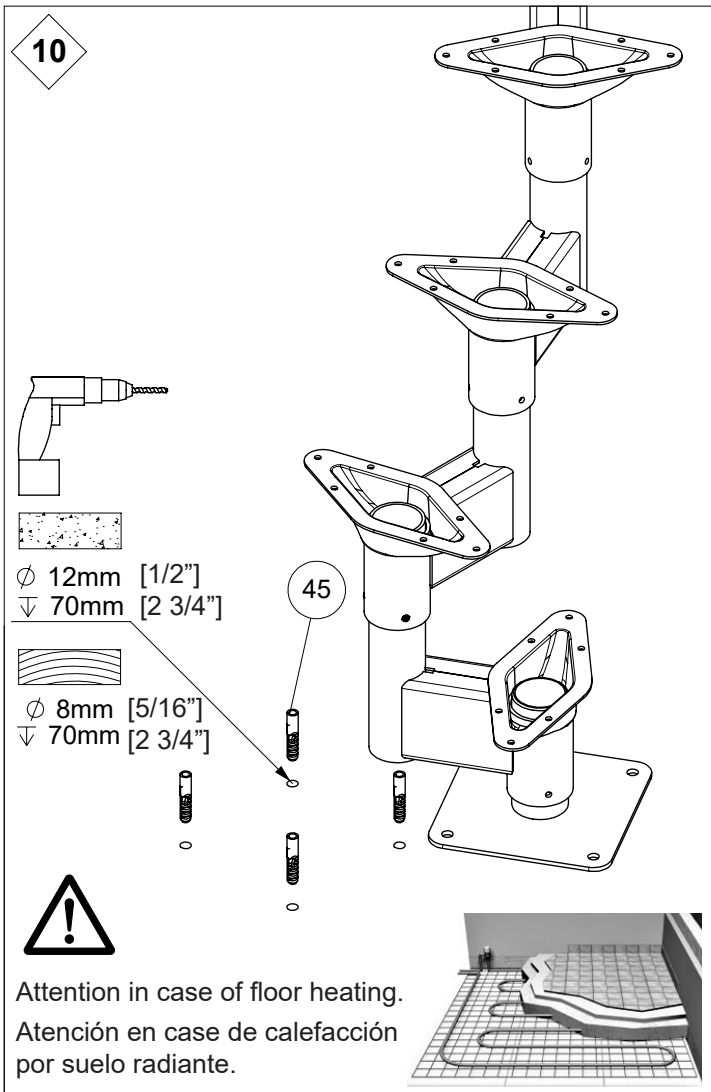
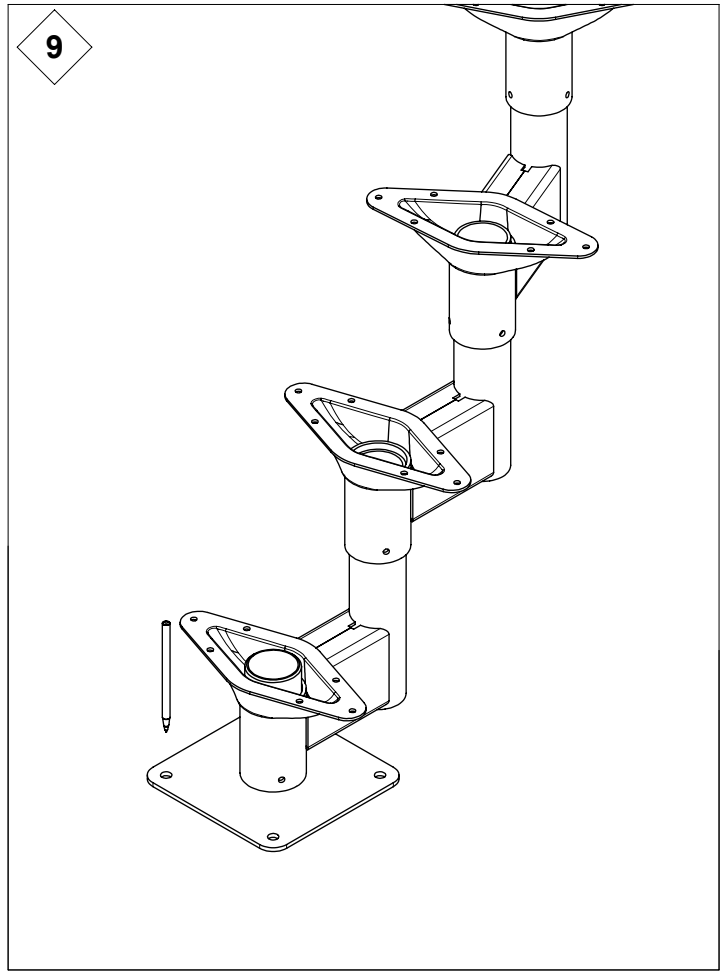
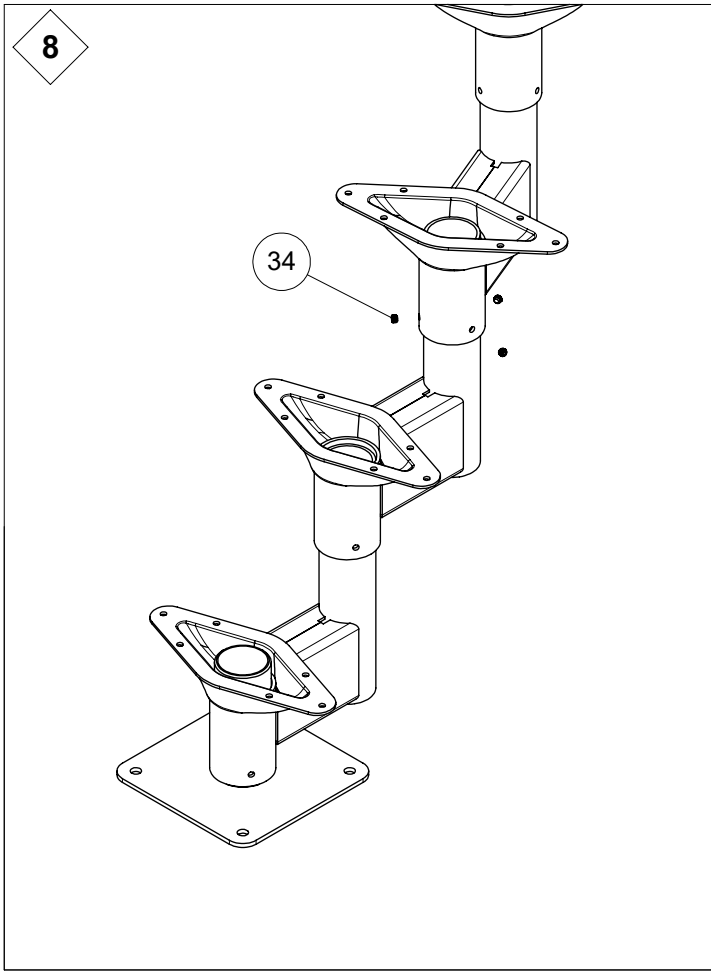

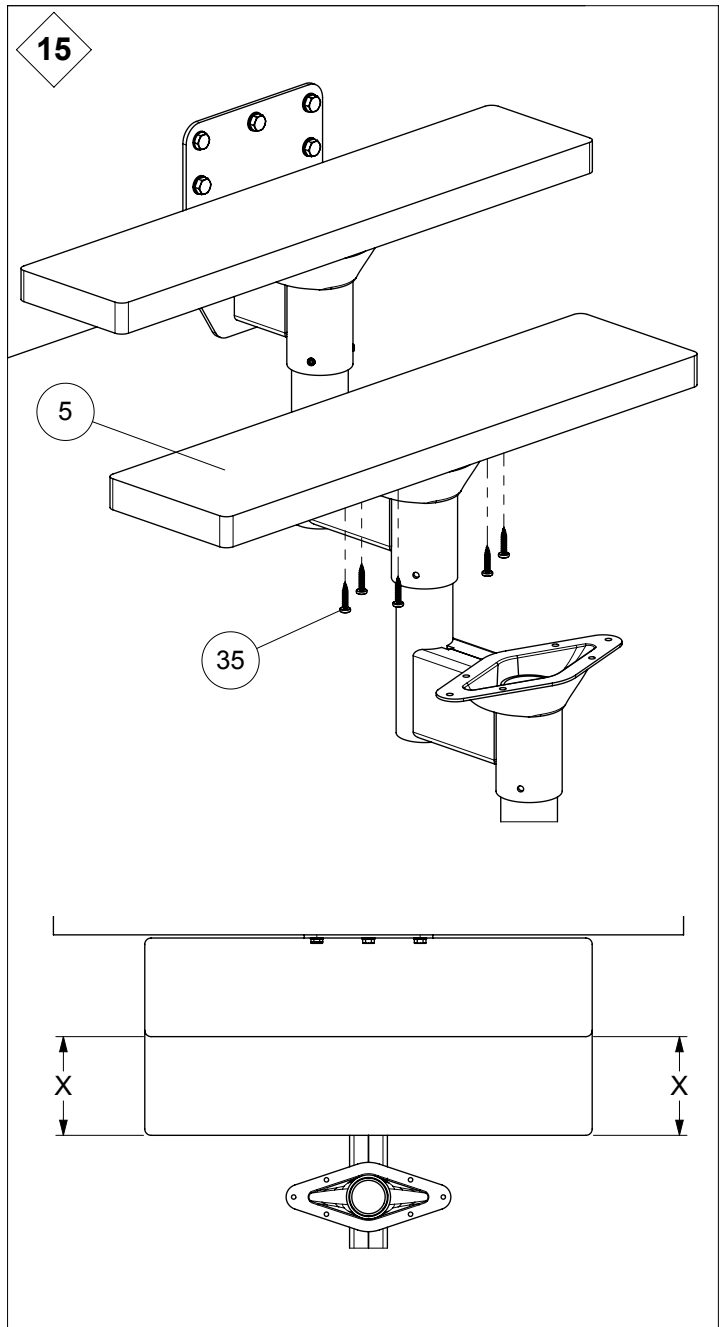
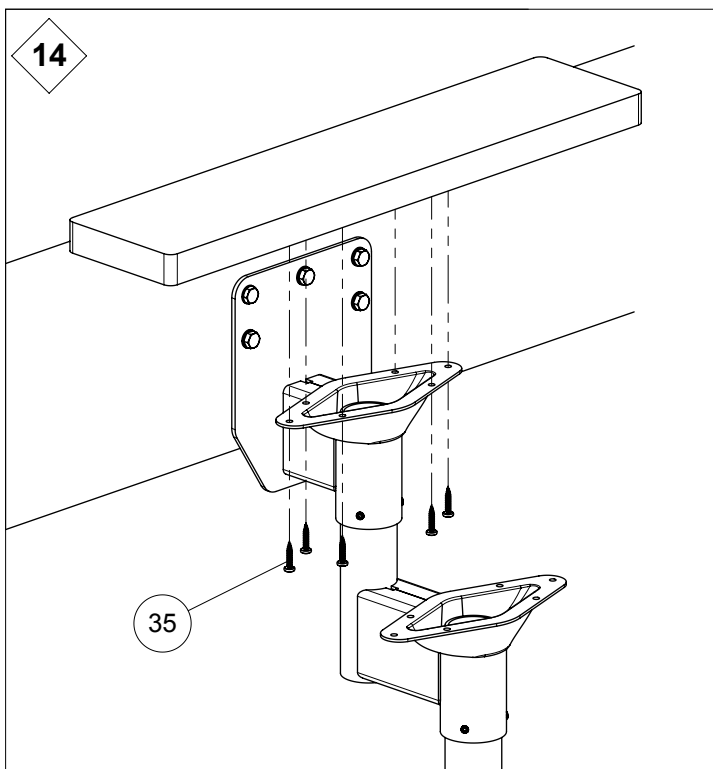
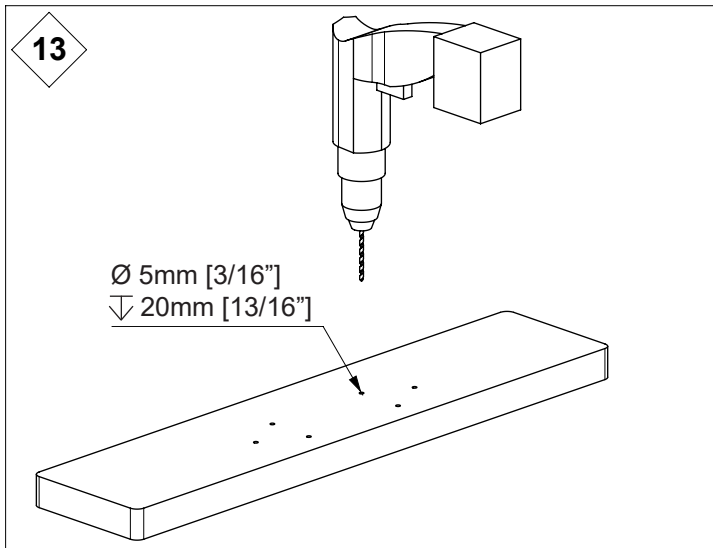
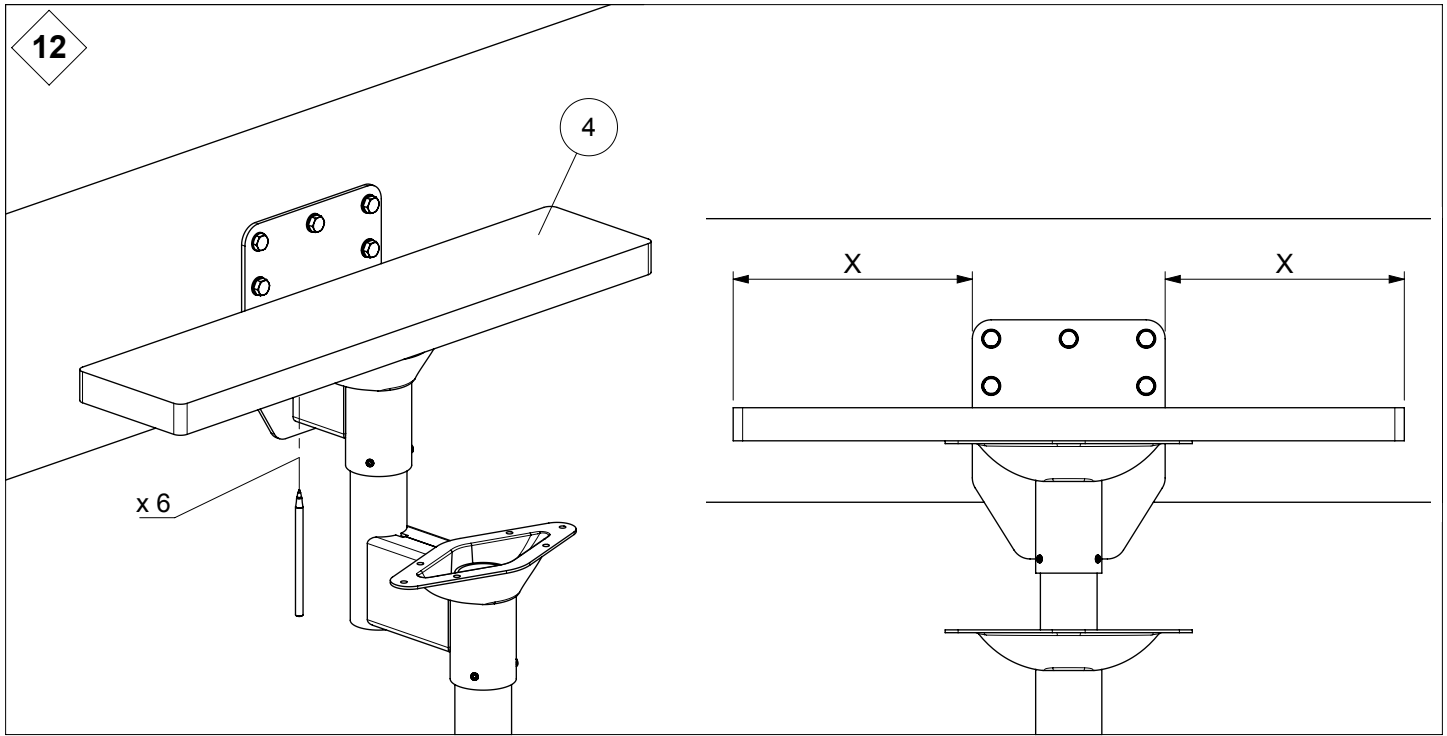

16

