



INSTALLATION INSTRUCTIONS

SKU: **SP-A040F**

FRONT A-ARM GUARDS CAN-AM OUTLANDER/RENEGADE G2 (2012-16)

01

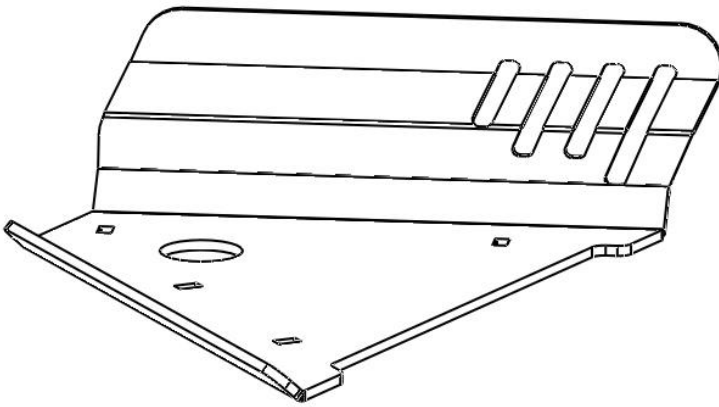

02

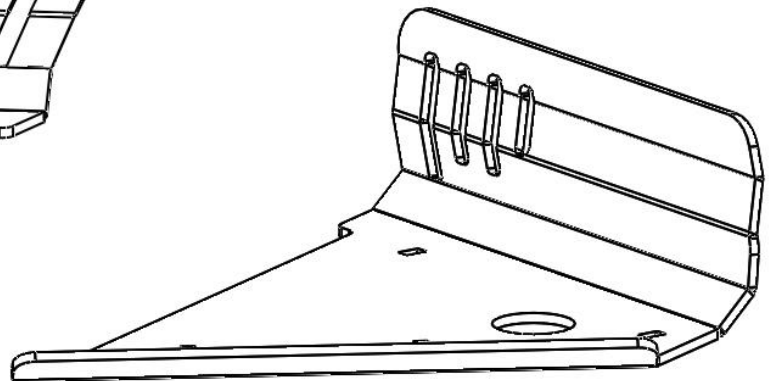

SAFETY WARNING

Please **read and understand** all instructions and safety warning prior to install the product. Failure to do so could result in product damage, personal injury or even death.

- Stay alert! Watch what you are doing and use common sense while handling this product.
- Inspect product for damage prior to installation, do not use if product is in unsafe condition.
- Do not install product while under the influence of drugs, alcohol or medication.
- Always use safety equipment to prevent injuries. Approved face and eye protection must always be worn by the installer, as well as others in the work area.
- Do not over reach. Keep proper footing and balance at all times.
- Dress properly. Do not wear loose clothing or jewelry. Keep your hair, clothing and gloves away from moving parts.
- Keep your work area clean and well lit.

Item	Part No.	Description	Qty.
COMPONENTS			
Those items are shown on the first page.			
01	A040-01	Front Left Aluminum A-arm Guard	1
02	A040-02	Front Right Aluminum A-arm Guard	1
HARDWARE			
Those items are included with each kit to install components.			
03	A-1505	M6-1.00 Flange Lock Nut	8
04	A-2658	M6-1.00 x 20mm Carriage Bolt	8
05	A-4014	1" Rubber Clamp / 0.281-hole dia.	8

INSTALLATION INSTRUCTIONS

PREPARATION

- Using a jack under center of front end, lift until the front wheels leave the ground.
- Remove the wheels.
- Remove both factory plastic A-arm guards.
- Using the image below as a guide, insert and pinch the rubber clamps on the a-arm, on each side.

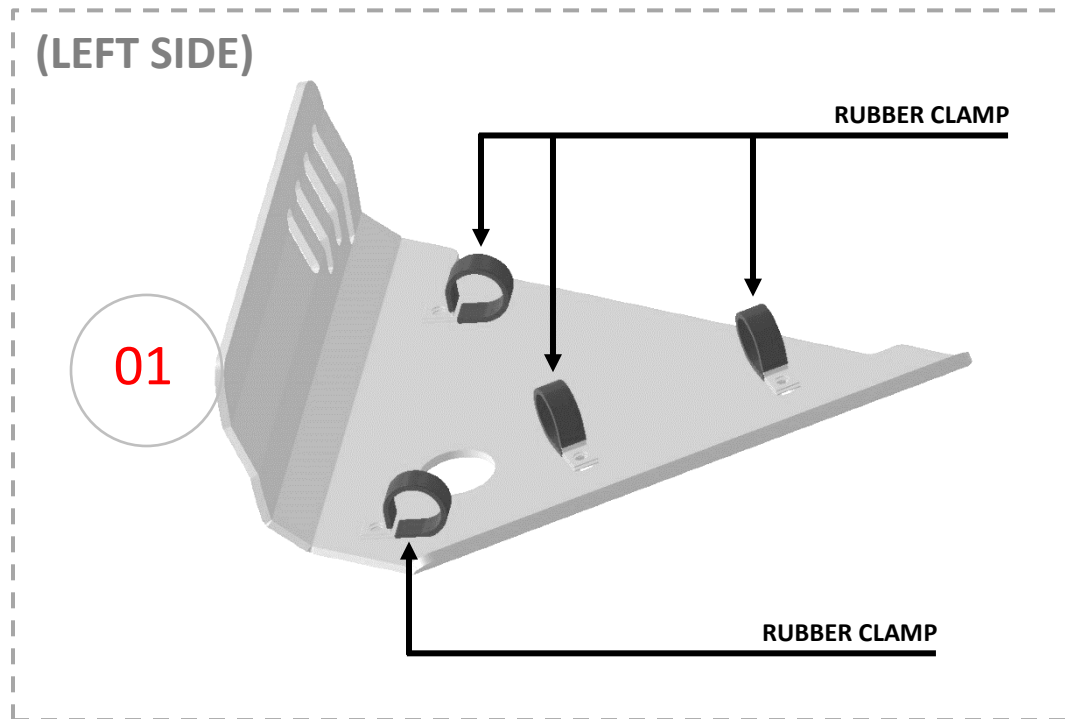

INSTALLATION

1. Install the guards to the suspension arms. Use the M6x20mm carriage bolts and the M6 lock nuts to secure the guards to the rubber clamps mounted on the suspension arms.
2. Tight all the hardware appropriately once the guards are correctly installed.
3. Put the wheels back on the ATV. Torque all lugs to factory specification.

NOTE: Be sure that the a-arm guards will clear the others components of the suspension. Re-adjust the guards if it's necessary.

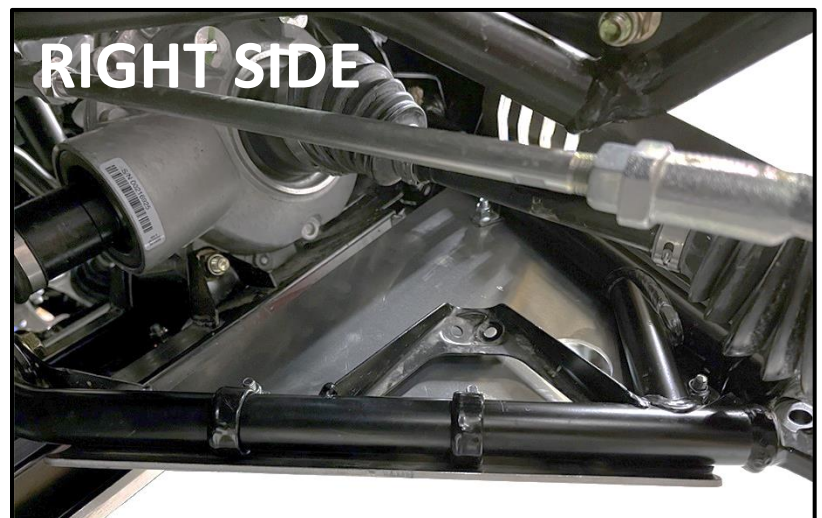



INSTALLATION INSTRUCTIONS

SKU: **SP-A040R**

REAR A-ARM GUARDS CAN-AM OUTLANDER/RENEGADE G2 (2012-16)

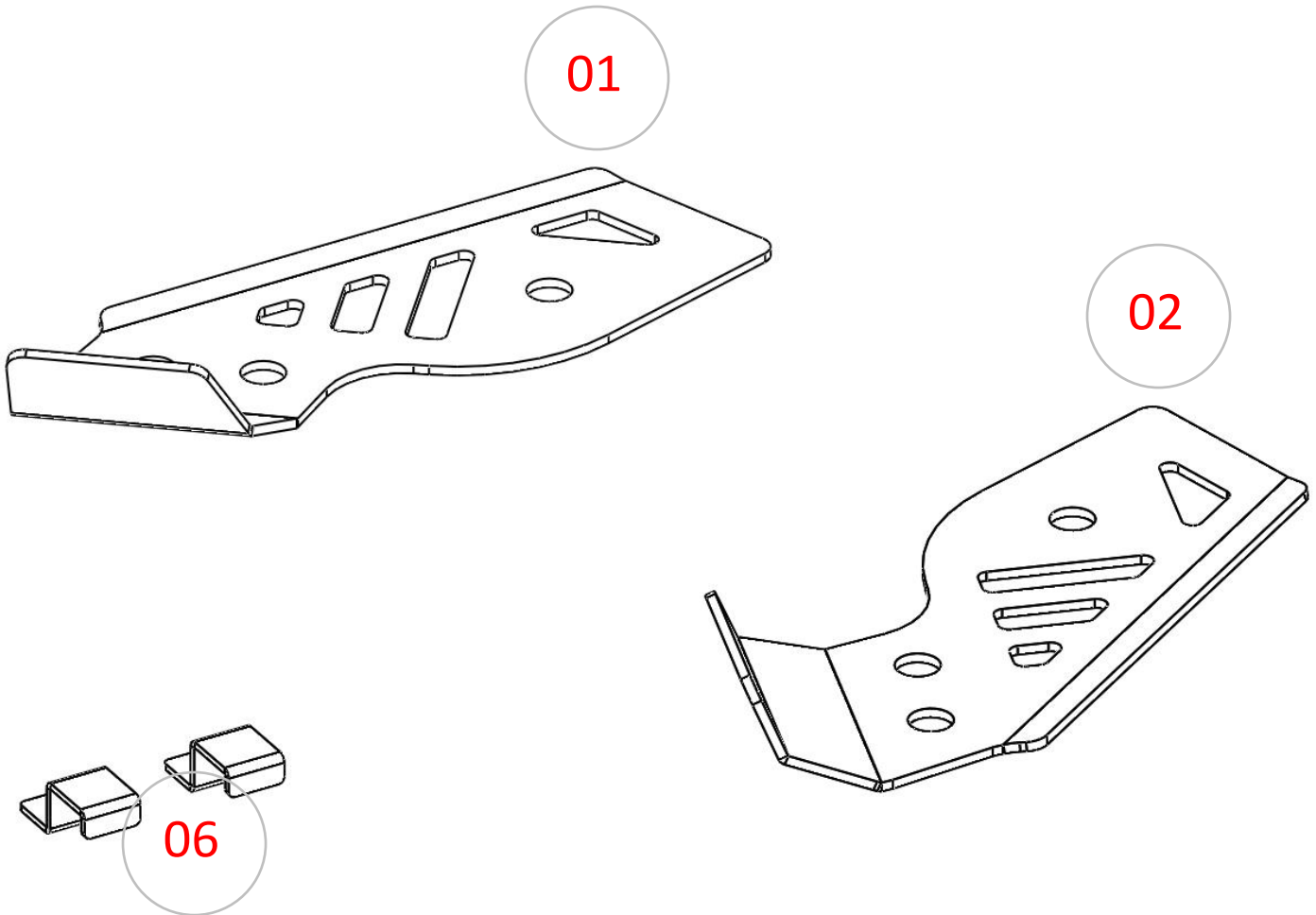

SAFETY WARNING

Please **read and understand** all instructions and safety warning prior to install the product. Failure to do so could result in product damage, personal injury or even death.

- Stay alert! Watch what you are doing and use common sense while handling this product.
- Inspect product for damage prior to installation, do not use if product is in unsafe condition.
- Do not install product while under the influence of drugs, alcohol or medication.
- Always use safety equipment to prevent injuries. Approved face and eye protection must always be worn by the installer, as well as others in the work area.
- Do not over reach. Keep proper footing and balance at all times.
- Dress properly. Do not wear loose clothing or jewelry. Keep your hair, clothing and gloves away from moving parts.
- Keep your work area clean and well lit.

Item	Part No.	Description	Qty.
COMPONENTS			
Those items are shown on the first page.			
01	A040-03	Rear Left Aluminum A-arm Guard	1
02	A040-04	Rear Right Aluminum A-arm Guard	1
HARDWARE			
Those items are included with each kit to install components.			
03	A-1205	M6 Cup Washer	6
04	A-2605	M6-1.00 x 20mm Hex Flange Bolt	4
05	A-2607	M6-1.00 x 25mm Hex Flange Bolt	2
06	B-5605	Mounting Clamp	2

INSTALLATION INSTRUCTIONS

PREPARATION

- Using a jack under center of rear end, lift until the rear wheels leave the ground.
- Remove the wheels.
- Remove both factory plastic A-arm guards.

INSTALLATION

4. Install the guards to the suspension arms, using the factory mounting point. Use the M6x20mm bolts with (4x) M6 cup washers

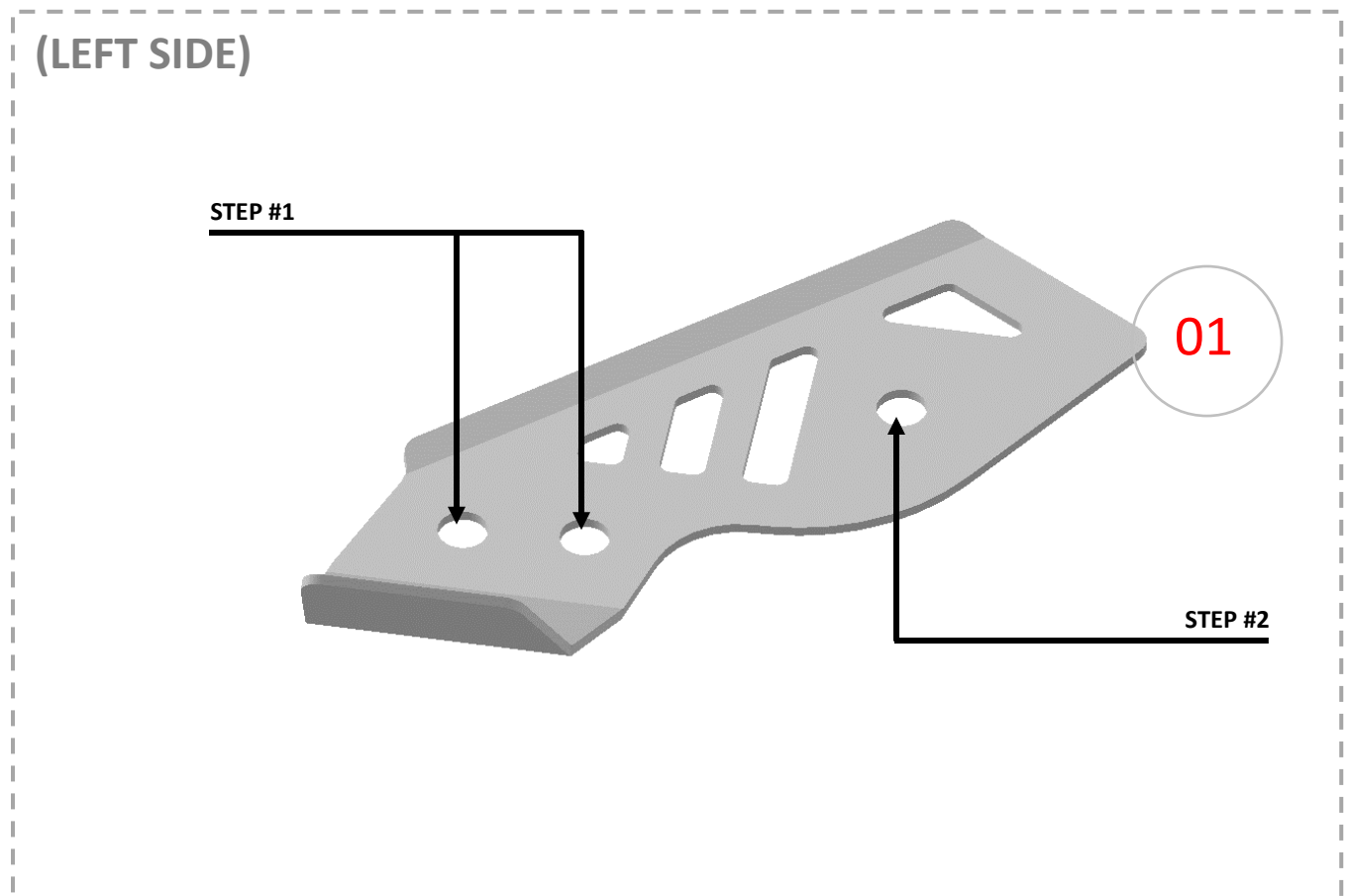

5. Secure the guards to the suspension arms. Use the mounting clamps (items 06) with the M6x25mm bolts and the remaining M6 cup washers.
6. Tight all the hardware once the guards are correctly installed & adjusted.
7. Put the wheels back on the ATV. Torque all lugs to factory specification.

NOTE: Be sure that the a-arm guards will clear the others components of the suspension. Re-adjust the guards if it's necessary.