

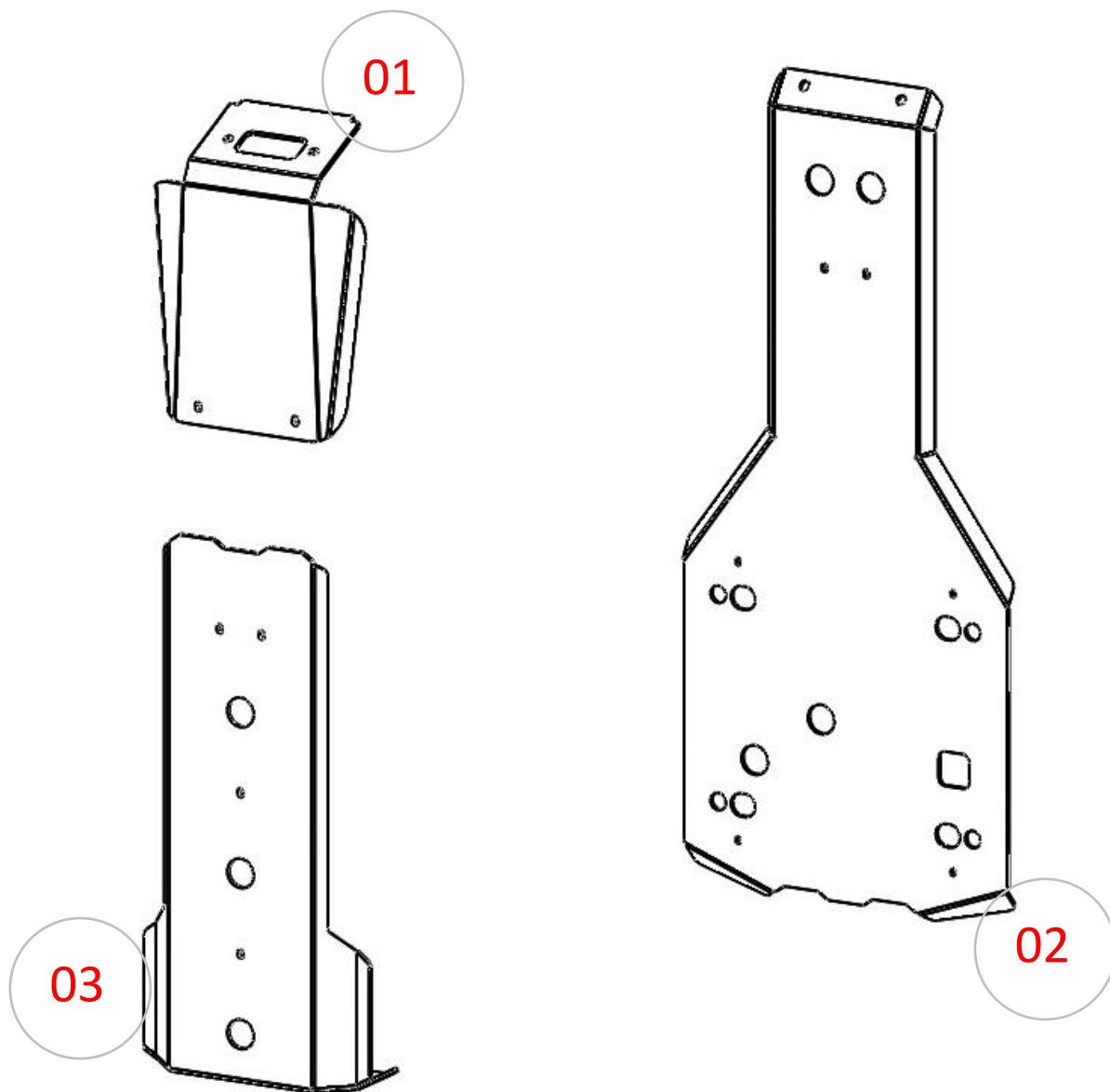

INSTALLATION INSTRUCTIONS

SKU: **SP-3163** | **3169**

CENTRAL PLATES CAN-AM OUTLANDER MAX G2 (2013+)



SAFETY WARNING

Please **read and understand** all instructions and safety warning prior to install the product. Failure to do so could result in product damage, personal injury or even death.

- Stay alert! Watch what you are doing and use common sense while handling this product.
- Inspect product for damage prior to installation, do not use if product is in unsafe condition.
- Do not install product while under the influence of drugs, alcohol or medication.
- Always use safety equipment to prevent injuries. Approved face and eye protection must always be worn by the installer, as well as others in the work area.
- Do not over reach. Keep proper footing and balance at all times.
- Dress properly. Do not wear loose clothing or jewelry. Keep your hair, clothing and gloves away from moving parts.
- Keep your work area clean and well lit.

Item	Part No.	Description	Qty.
COMPONENTS			
Those items are shown on the first page.			
01	3162-01 3162-06	Front Aluminum Central Plate (3162-06 for models 2023+)	1
02	3162-03	Middle Aluminum Central Plate	1
03	3162-05	Rear Aluminum Central Plate	1

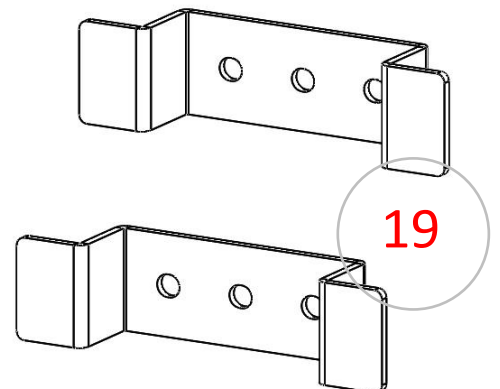
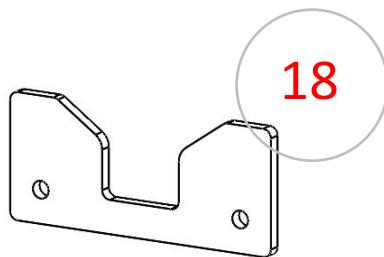

Item	Part No.	Description	Qty.
HARDWARE (3162-01)			
Those items are included with each kit to install the front plate.			
04	A-1008	M10 Flat Washer	2
05	A-1507	M8-1.25 Flange Lock Nut	2
06	A-1509	M10-1.50 Flange Lock Nut	2
07	A-2813	M8-1.25 x 40mm Hex Flange Bolt	2
08	A-3008	M10-1.50 x 30mm Hex Bolt	2

HARDWARE (3162-03)			
Those items are included with each kit to install the middle plate.			
09	A-1505	M6-1.00 Flange Lock Nut	5
05	A-1507	M8-1.25 Flange Lock Nut	2
10	A-2621	M6-1.00 x 60mm Hex Flange Bolt	4
11	A-2658	M6-1.00 x 20mm Carriage Bolt	1
12	A-2809	M8-1.25 x 30mm Hex Flange Bolt	2
13	A-4001	Rubber Strip / Adhesive Back, 1x2" x 1/8" Thick	6
14	B-5222	12mm ID. x 11/16" OD. x 1-3/8" Lg. Bushing	4
15	B-5601	Bracket	1

HARDWARE (3162-05)			
Those items are included with each kit to install the rear plate.			
16	A-1103	5/16" x 1.250" OD. Flat Fender Washer	1
09	A-1505	M6-1.00 Flange Lock Nut	2
05	A-1507	M8-1.25 Flange Lock Nut	4
11	A-2658	M6-1.00 x 20mm Carriage Bolt	2
17	A-2807	M8-1.25 x 25mm Hex Flange Bolt	3
07	A-2813	M8-1.25 x 40mm Hex Flange Bolt	1
13	A-4001	Rubber Strip / Adhesive Back, 1x2" x 1/8" Thick	4
18	B-5602	Bracket	1
19	B-5603	Bracket (clamp)	2

INSTALLATION INSTRUCTIONS

PREPARATION

- We recommend to standing the ATV up on its end, to be able to install easily the plate under the bike.
- Remove the factory skid plate.
- On the frame (or directly on the plates), stick the provided rubber strips. **Refer to the image below.**

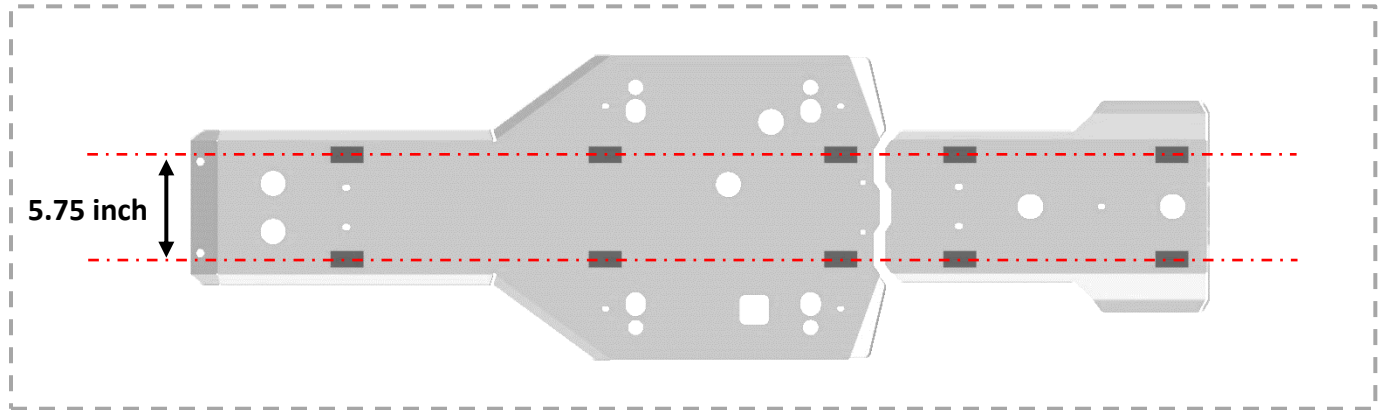

INSTALLATION (do not tight until all was fixed correctly)

1. Install the bracket (18) to the rear plate. Use (2x) M6-1.00 x 20mm carriage bolts and (2x) M6 lock nuts.
2. Start with the bottom of the rear plate. Use (1x) M8-1.25 x 40mm hex flange bolt, (1x) 5/16" fender washer (over the frame) and (1x) M8 lock nut. **Refer to the schema below.**

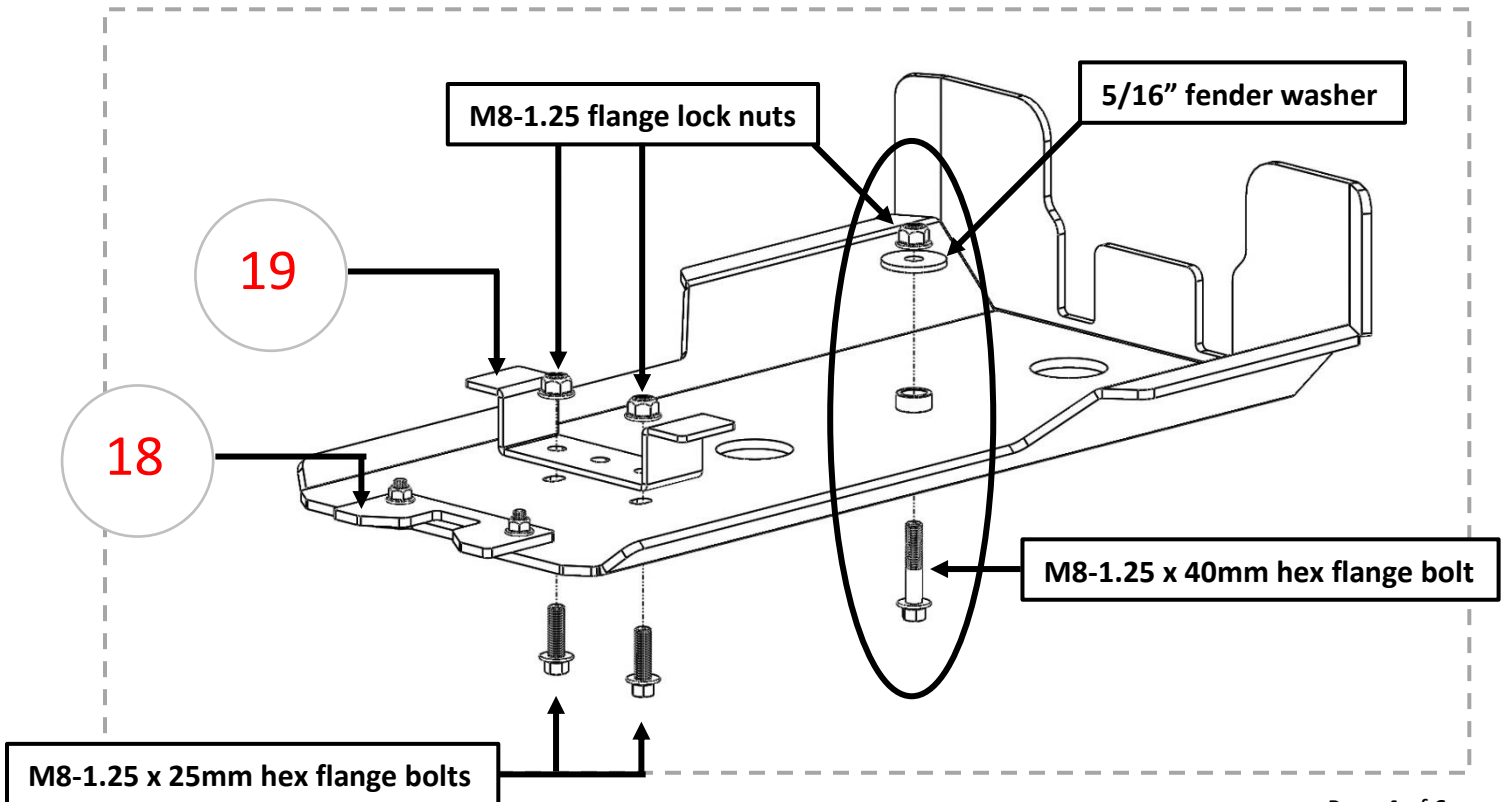

3. Secure the front portion of the rear plate using (2x) brackets (19), (3x) M8-1.25 x 25mm bolts and (3x) M8 lock nuts. Refer to the schema over (rear plate shown is the plate for the one-seater).
4. Install the bracket (15) to the bottom of the middle plate. Use (1x) M6-1.00 x 20mm carriage bolt and (1x) M6 lock nut.
5. Secure the underside of the middle plate to the frame. See instructions & schema below.
 - a) Use (4x) M6-1.00 x 60mm hex flange bolts, (4x) 1-3/8" Lg. spacers and (4x) M6 lock nuts.
NOTE: Insert the spacer between the plate and the frame.
 - b) Use (2x) M8-1.25 x 30mm hex flange bolts and (2x) M8 lock nuts.
NOTE: Use a 5/16" drill bit and drill 2 holes where will be bolted the M8 bolts.

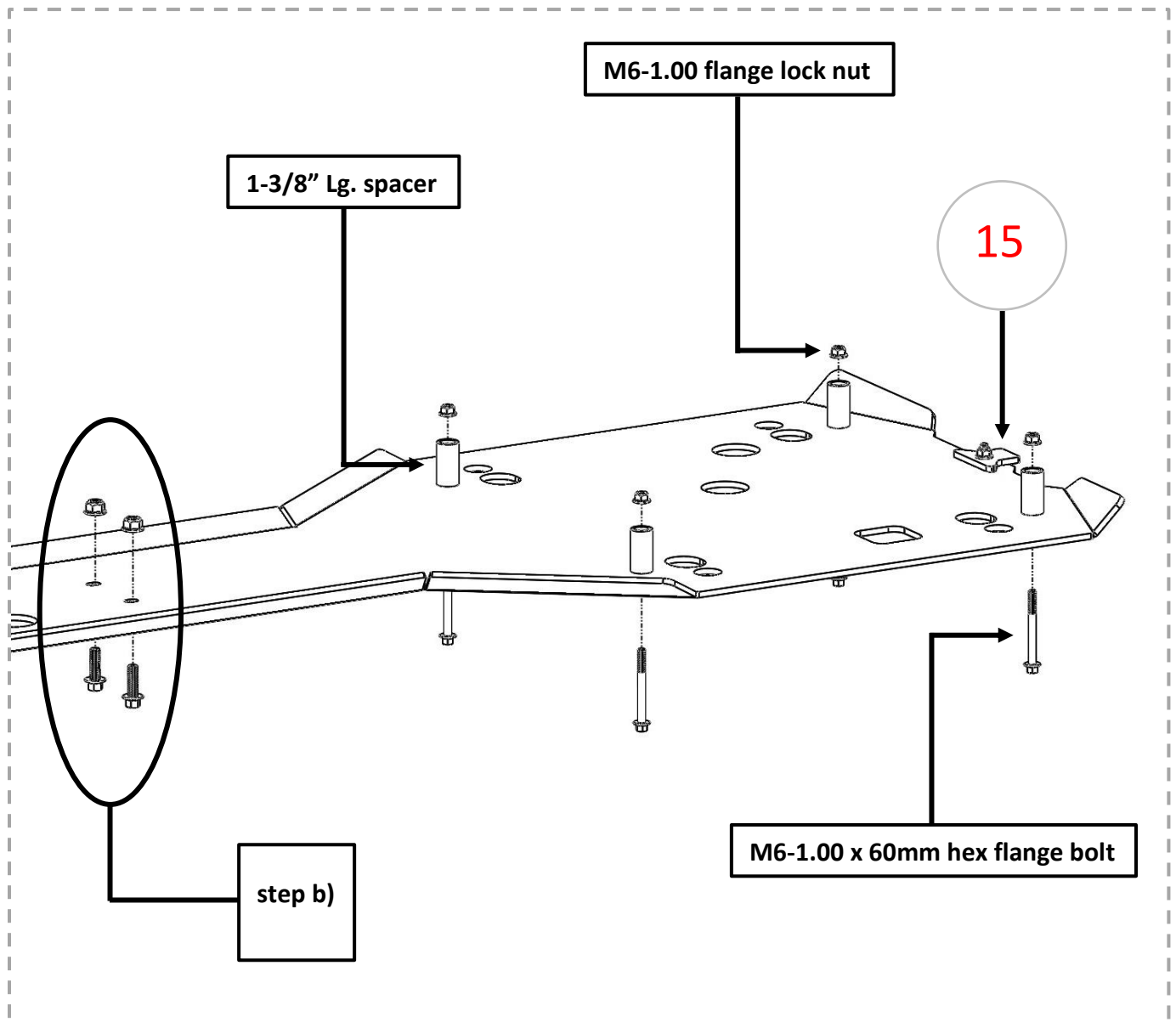

6. If you have a winch, unbolt the fairlead from the ATV. **Keep OEM hardware for later.**
7. Disassemble the hook of the winch cable, and remove cable of the fairlead.
8. Pass the winch cable through the front skid plate and the fairlead. Reconnect the hook to the winch.
9. Install the front plate to the ATV. **See instructions & schema below.**
 - a) Use **(2x)** M8-1.25 x 40mm hex flange bolts and **(2x)** M8 lock nuts.
 - b) Use **(2x)** M10-1.50 x 30mm hex bolts, **(2x)** M10 washers and **(2x)** M10 lock nuts.



NOTE: Use the OEM hardware if you have a winch.

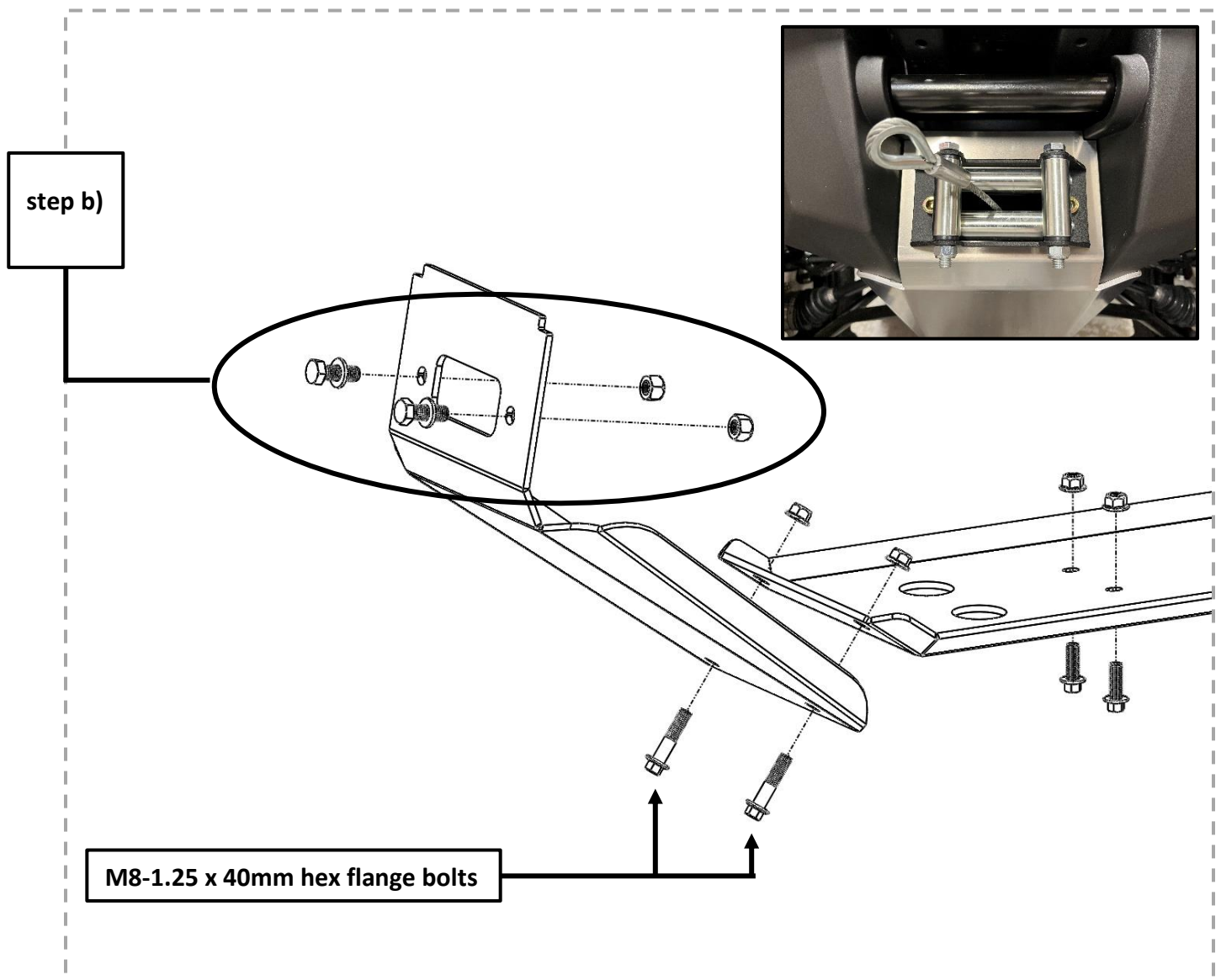

10. Once the 3 plates are correctly installed, tight all the bolts appropriately.