

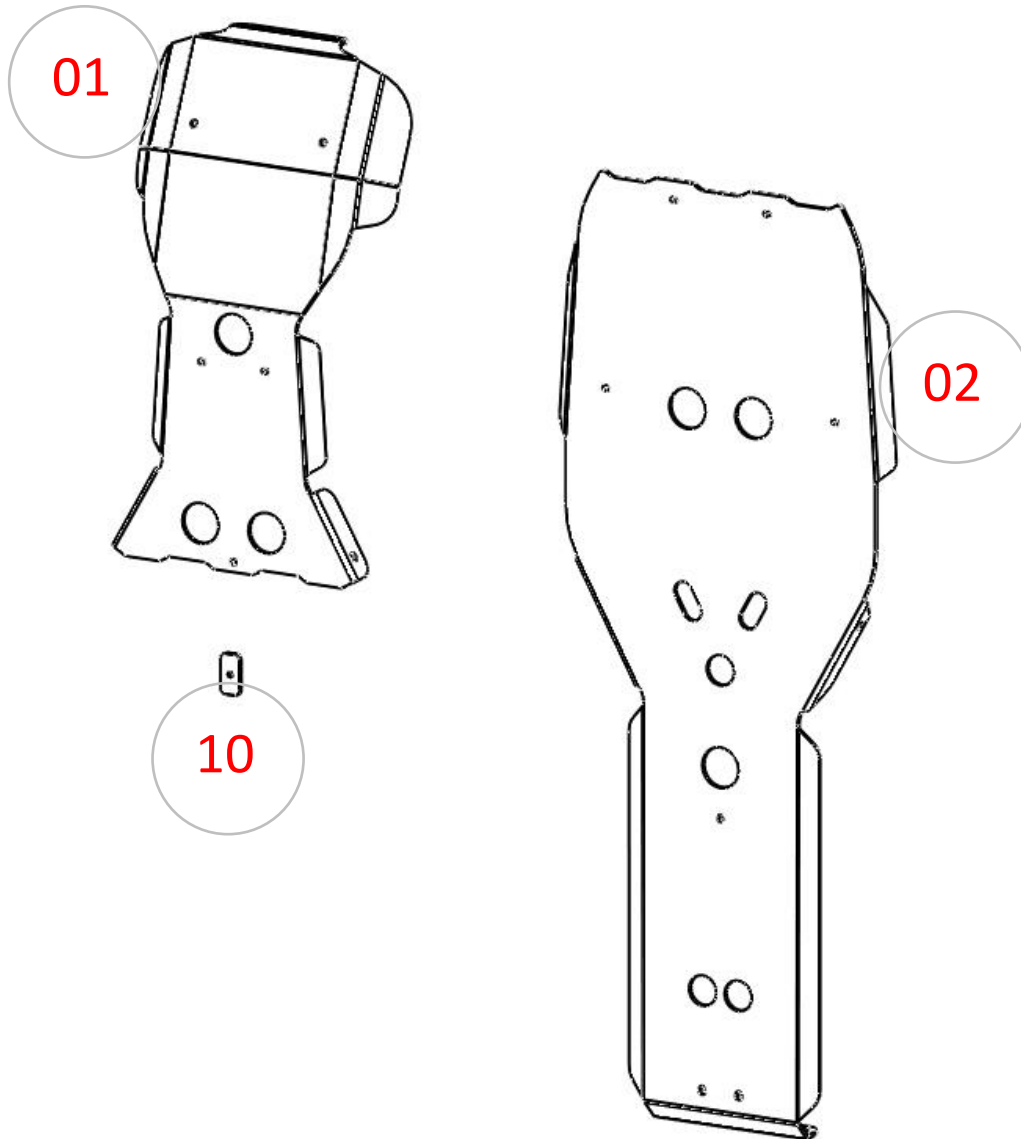

INSTALLATION INSTRUCTIONS

SKU: **SP-3160**

CENTRAL PLATES SUZUKI KINGQUAD 450/500/700/750 (2005+)



SAFETY WARNING

Please **read and understand** all instructions and safety warning prior to install the product. Failure to do so could result in product damage, personal injury or even death.

- Stay alert! Watch what you are doing and use common sense while handling this product.
- Inspect product for damage prior to installation, do not use if product is in unsafe condition.
- Do not install product while under the influence of drugs, alcohol or medication.
- Always use safety equipment to prevent injuries. Approved face and eye protection must always be worn by the installer, as well as others in the work area.
- Do not over reach. Keep proper footing and balance at all times.
- Dress properly. Do not wear loose clothing or jewelry. Keep your hair, clothing and gloves away from moving parts.
- Keep your work area clean and well lit.

Item	Part No.	Description	Qty.
COMPONENTS			
Those items are shown on the first page.			
01	3160-01	Front Aluminum Central Plate	1
02	3160-02	Rear Aluminum Central Plate	1
HARDWARE (3160-01)			
Those items are included with each kit to install the front plate.			
03	A-1505	M6-1.00 Flange Lock Nut	1
04	A-1507	M8-1.25 Flange Lock Nut	2
05	A-2605	M6-1.00 x 20mm Hex Flange Bolt	2
06	A-2658	M6-1.00 x 20mm Carriage Bolt	1
07	A-2807	M8-1.25 x 25mm Hex Flange Bolt	2
08	A-4001	Rubber Strip / Adhesive Back, 1x2" x 1/8" Thick	2
09	A-4026	1-1/8" Steel Clamp / M6-1.00 Nut	2
10	B-5600	Bracket	1
HARDWARE (3160-02)			
Those items are included with each kit to install the rear plate.			
04	A-1507	M8-1.25 Flange Lock Nut	2
05	A-2605	M6-1.00 x 20mm Hex Flange Bolt	7
11	A-2821	M8-1.25 x 60mm Hex Flange Bolt	2
08	A-4001	Rubber Strip / Adhesive Back, 1x2" x 1/8" Thick	10
09	A-4026	1-1/8" Steel Clamp / M6-1.00 Nut	5

INSTALLATION INSTRUCTIONS

PREPARATION

- We recommend to standing the ATV up on its end, to be able to install easily the plate under the bike.
- Remove the factory skid plates. **NOTE:** Save OEM hardware for later.
- On the new skid plates, stick the provided rubber strips. **Refer to the image below.**

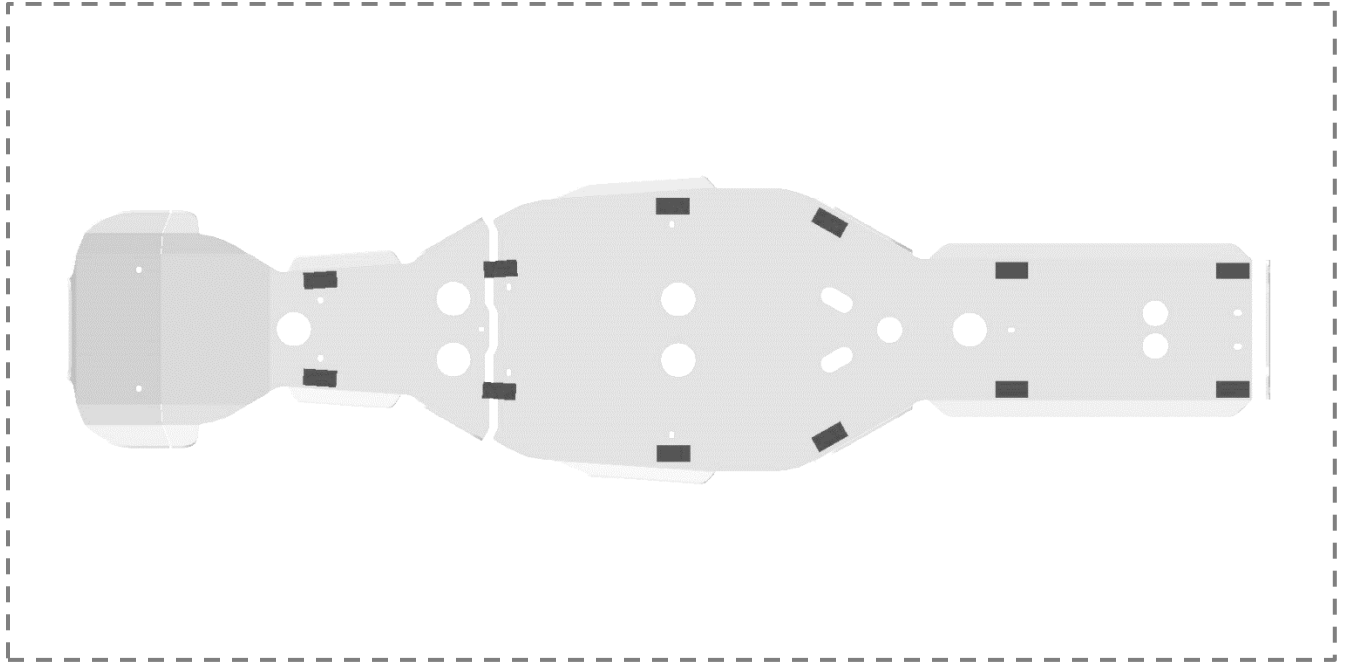

- Install the bracket (3160-03) on the front plate. Use (1x) M6-1.00 x 20mm carriage bolt and (1x) M6-1.00 lock nut. **See image below.**

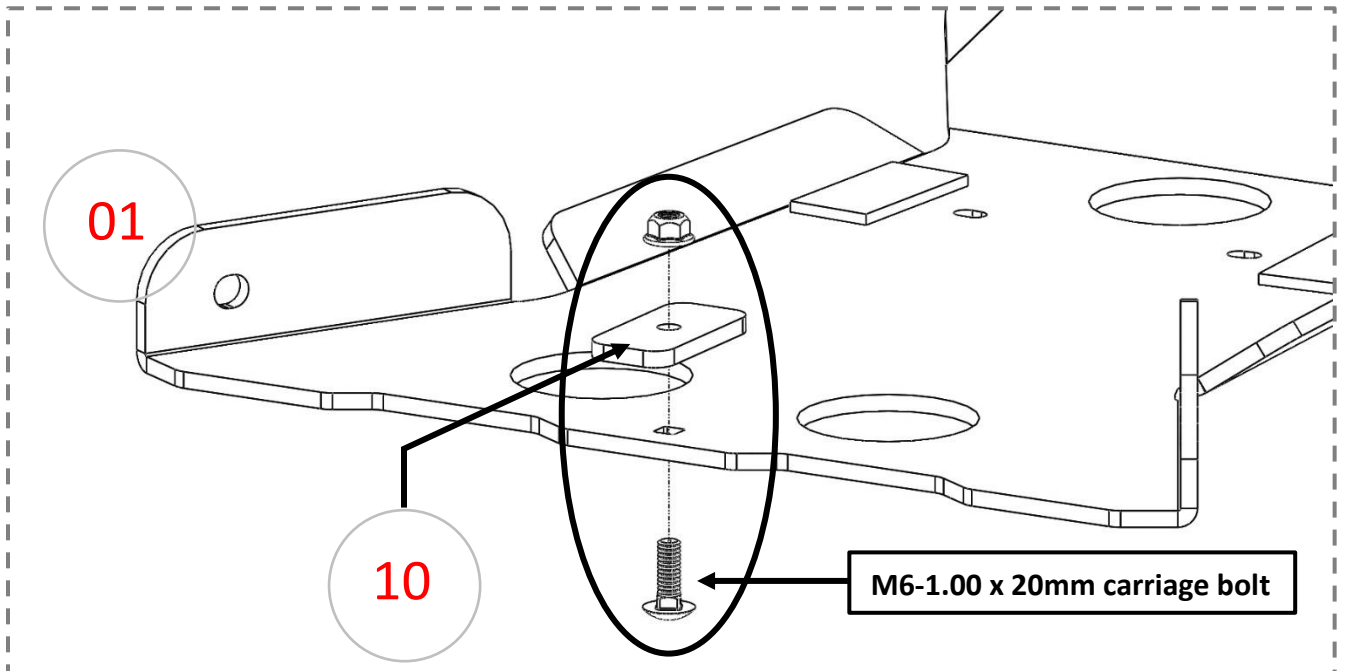

INSTALLATION (do not tight until all was fixed correctly)

1. Start with the bottom of the rear skid plate. Use **(2x)** M8-1.25 x 60mm hex flange bolt and **(2x)** M8-1.25 lock nut. See image below.

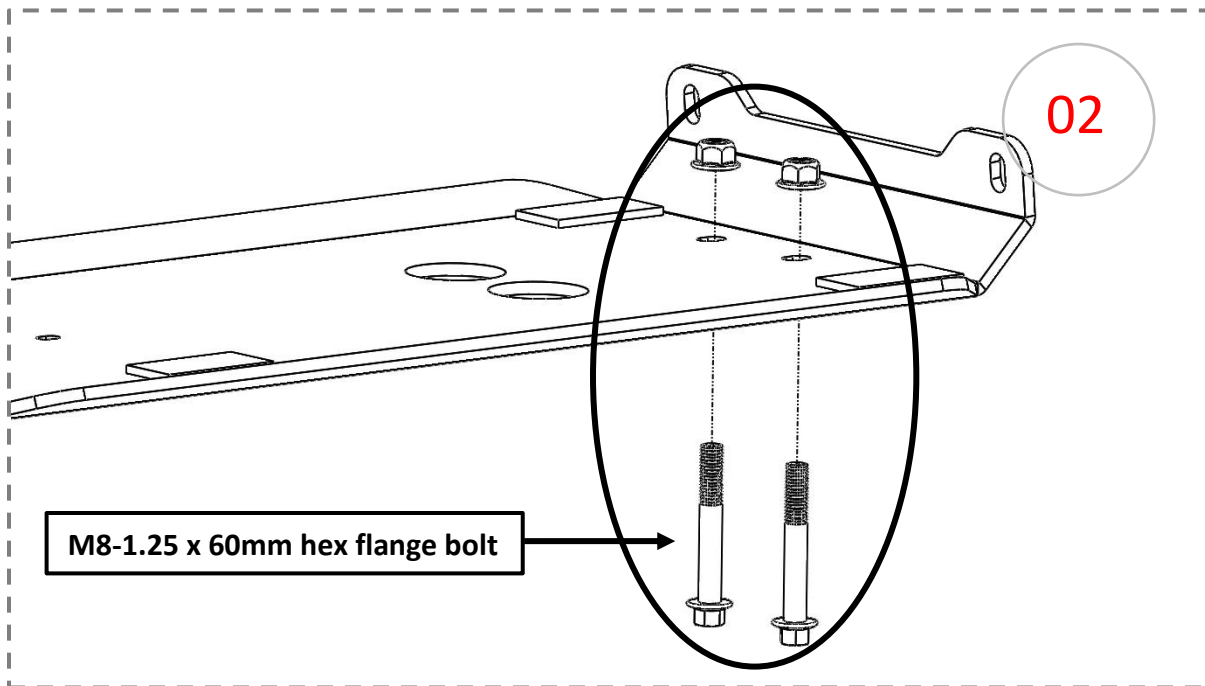

2. Using **(5x)** 1-1/8" clamp and **(5x)** M6-1.00 x 20mm hex flange bolt, secure the underside of the plate to the frame. See image below.

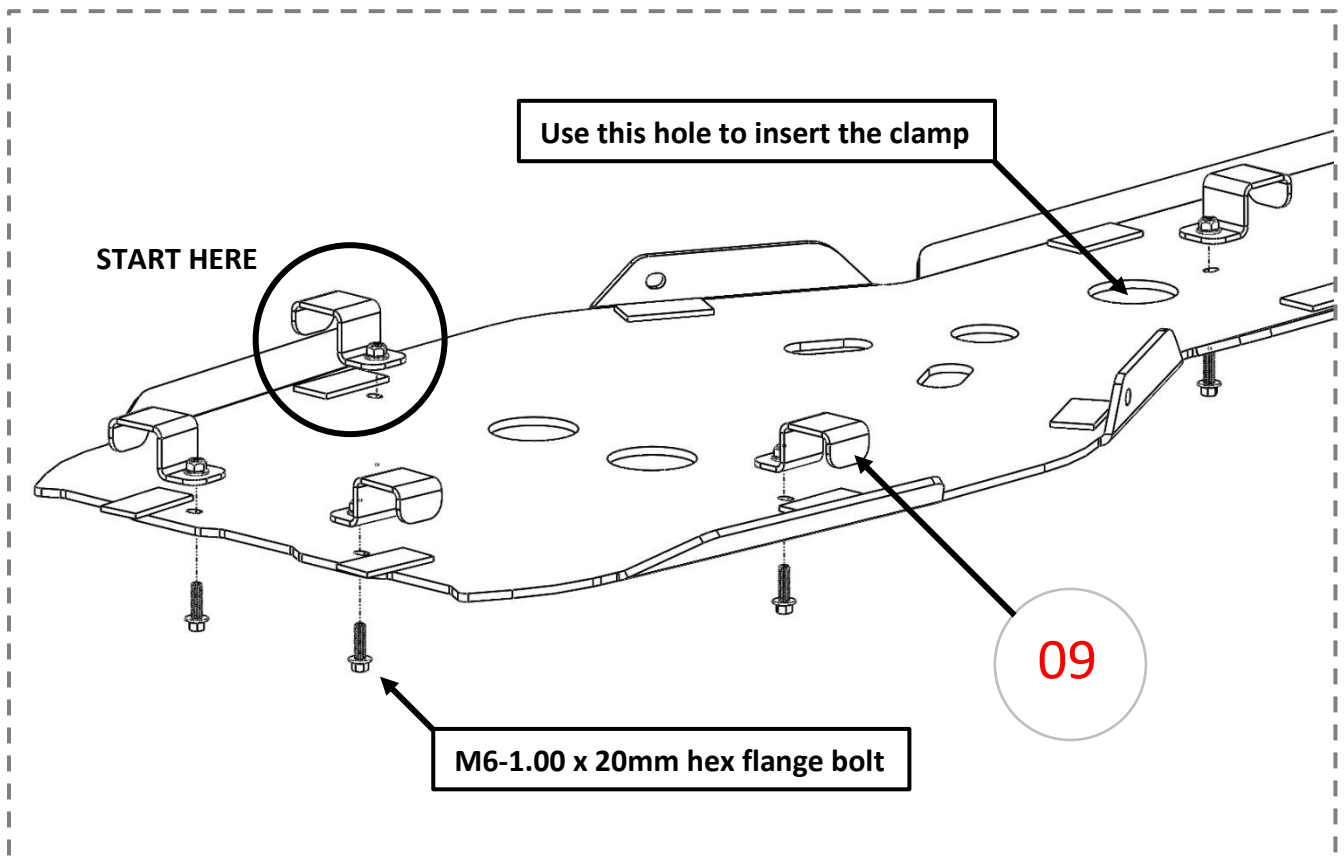

- Once all will be fixed, use the OEM bolts (4x) to secure the back and the sides of the rear skid plate to the factory mounting points.

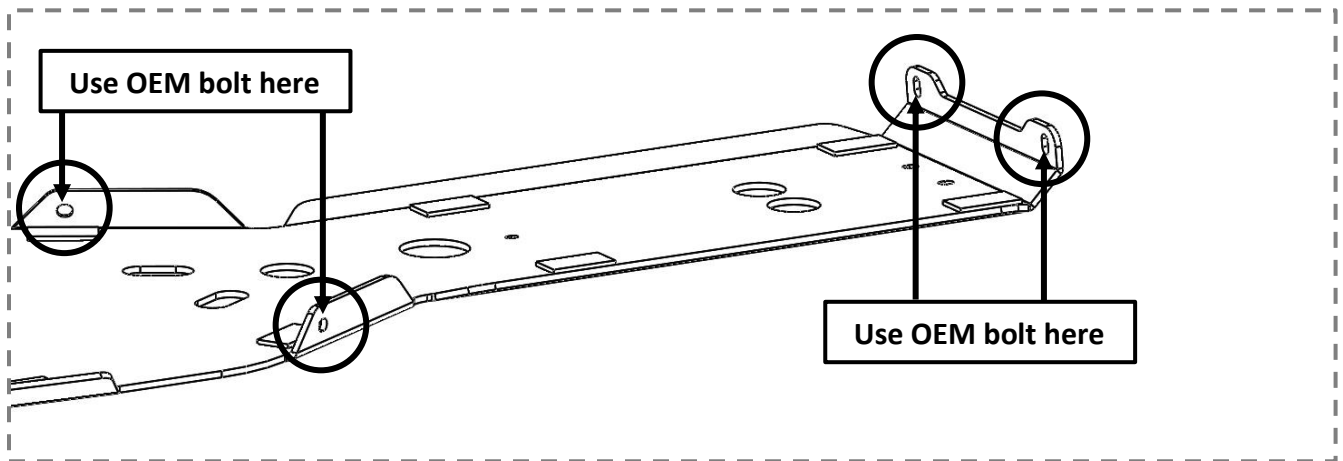

- Install the front skid plate to the frame. Use (2x) 1-1/8" clamp and (2x) M6-1.00 x 20mm hex flange bolt. See image below.

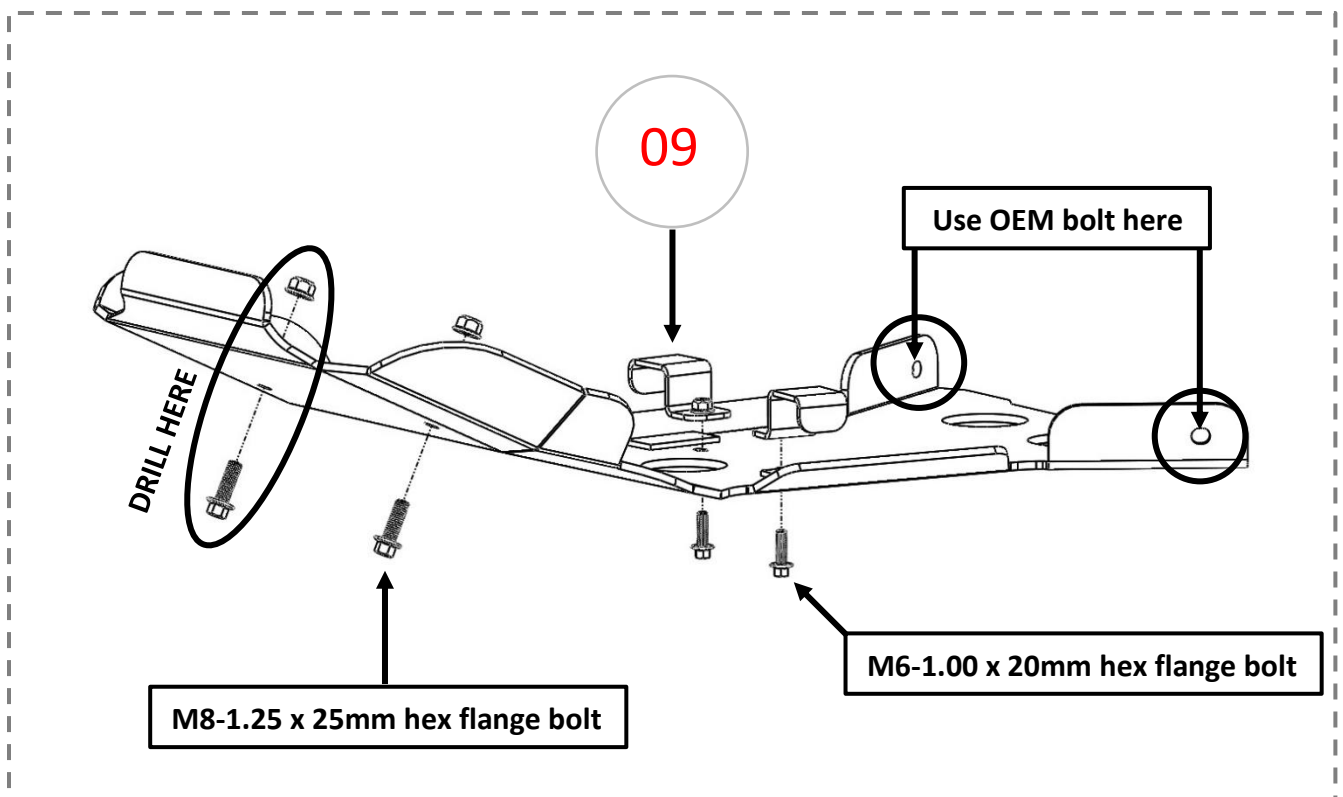

- Use the OEM bolts (2x) to secure the bottom of the front plate to the factory mounting points.
- Once all is fixed correctly, use a 5/16" drill bit and drill a hole through the plastic (refer to the image above). Use the holes of the front skid plate as a guide.
- Secure both drilled holes using (2x) M8-1.25 x 25mm hex flange bolt and (2x) M8-1.25 lock nut.
- Once both skid plates are correctly installed, tight all the bolts appropriately.
Note: Do not over tight OEM bolts that are bolted to the factory mounting points. Those threads can break easily.