

PYRAMID

32271 Yamaha MT-09 Headlight Guard Fitting Instructions

1X TFT Peaks (pair)

C32271

Important note: you will **NEED** a T8 Torx head bit to be able to install this product.

- This Pyramid headlight guard is quick and easy to fit.
- Temporarily remove the headlight shroud by unscrewing the bolts shown in the image below (marked with letter 'A').
- Temporarily remove the two Torx bolts on either side of the headlight (marked with letter 'B'). Fit the Pyramid headlight guard using the same two Torx head bolts.
- Refit the headlight shroud in its original position.

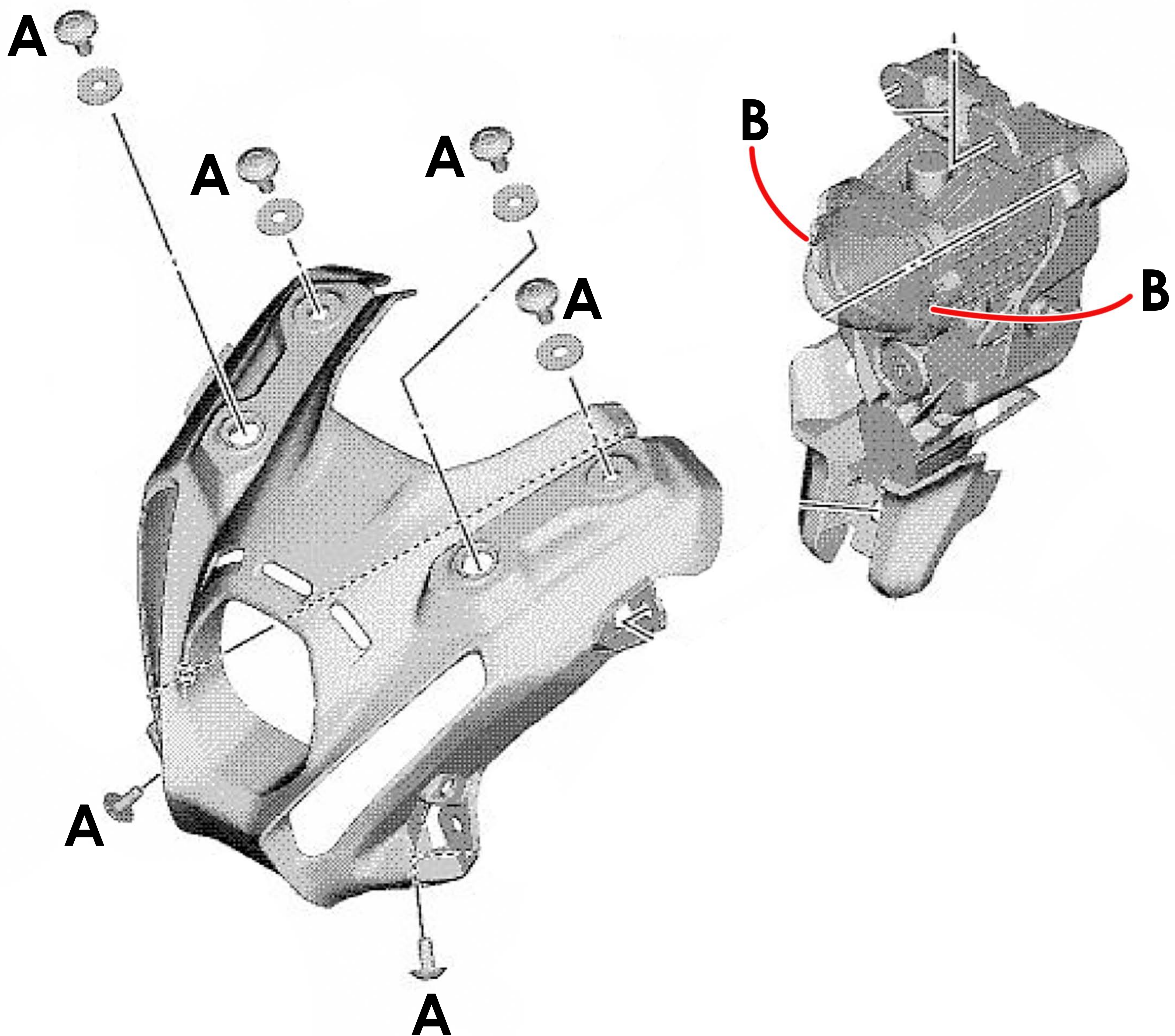

Any questions?
sales@pyramid-plastics.co.uk
+44 (0)1427 677990
www.pyramid-plastics.co.uk

