

22152 Yamaha MT-09 Front Infill Panels 2024> Fitting Instructions

Kit Includes:

1.	X1	C22152A	Infill Panel 'A' (LHS)
2.	X1	C22152B	Infill Panel 'B' (RHS)
3.	X1	CFK22152A	Mounting Bracket 'A' (LHS)
4.	X1	CFK22152B	Mounting Bracket 'B' (RHS)
5.	X4	CBOLM60035	M6x16mm Flanged-Button Bolt
6.	X4	CNUTM60008	M6 Cage Nut
7.	X4	CCAPM60002	M6 Bolt Head Cap
8.	X1	CBUM0007	Rubber Stopper
9.	X1	CFOA0001	40mm Strip

The installation process is replicated on both sides. This consists of the relevant panel and fixing bracket, together with an equal share of the supplied fixings. Please note: LHS denotes the left-hand side from the rider's point of view and likewise RHS denotes the right-hand side.

OEM Parts (From the Motorcycle):

10.	X2	OEM Fixing	M8 Bolt
11.	X2	OEM Fixing	M10 Bolt

Assembly Instructions

- Begin by removing the OEM M8 bolt (**Item 11**) and OEM M10 bolt (**Item 12**) from the LHS, illustrated in '**FIG. 2**' & '**FIG. 3**'.
- Attach the LHS Mounting Bracket (**Item 3**) using the OEM M8 & M10 bolts and fully tightening them. Please note, the cage nuts (**Item 6**) come pre-assembled with the bracket.
- Cut the foam strip (**Item 9**) to a suitable size, in preparation for placement on the extended arm of the mounting bracket. Once cut, remove the foam backing and press firmly on the bracket.
- Mount Infill Panel 'A' to the bracket using 2 x M6 bolts (**Item 5**). Loosely thread the bolts and position the panel accordingly. Please use '**FIG. 2**' for reference. Tighten the M6 bolts until sufficient resistance is felt.
- Place 2 x bolt head caps (**Item 7**) on the heads of the 2 x M6 bolts.
- Repeat this process for the RHS Infill Panel. Please note, the bracket requires a supportive rubber stopper (**Item 8**) which is illustrated by '**FIG. 3**'.
- Installation of the Front Infill Panels is complete.

Please Note:
We advise that all fixings are checked periodically.

Any questions?
sales@pyramidmoto.co.uk
+44 (0)1427 677990
www.pyramidmoto.co.uk



Follow us on social media and feel free to leave us a review!

FIG. 1



22152 Yamaha MT-09 Front Infill Panels 2024> **Fitting Instructions**

The images below help identify the components within the provided kit list, as well as their application.

FIG. 2

Circled area indicates where the trimmed foam strip (**Item 9**) should be placed.

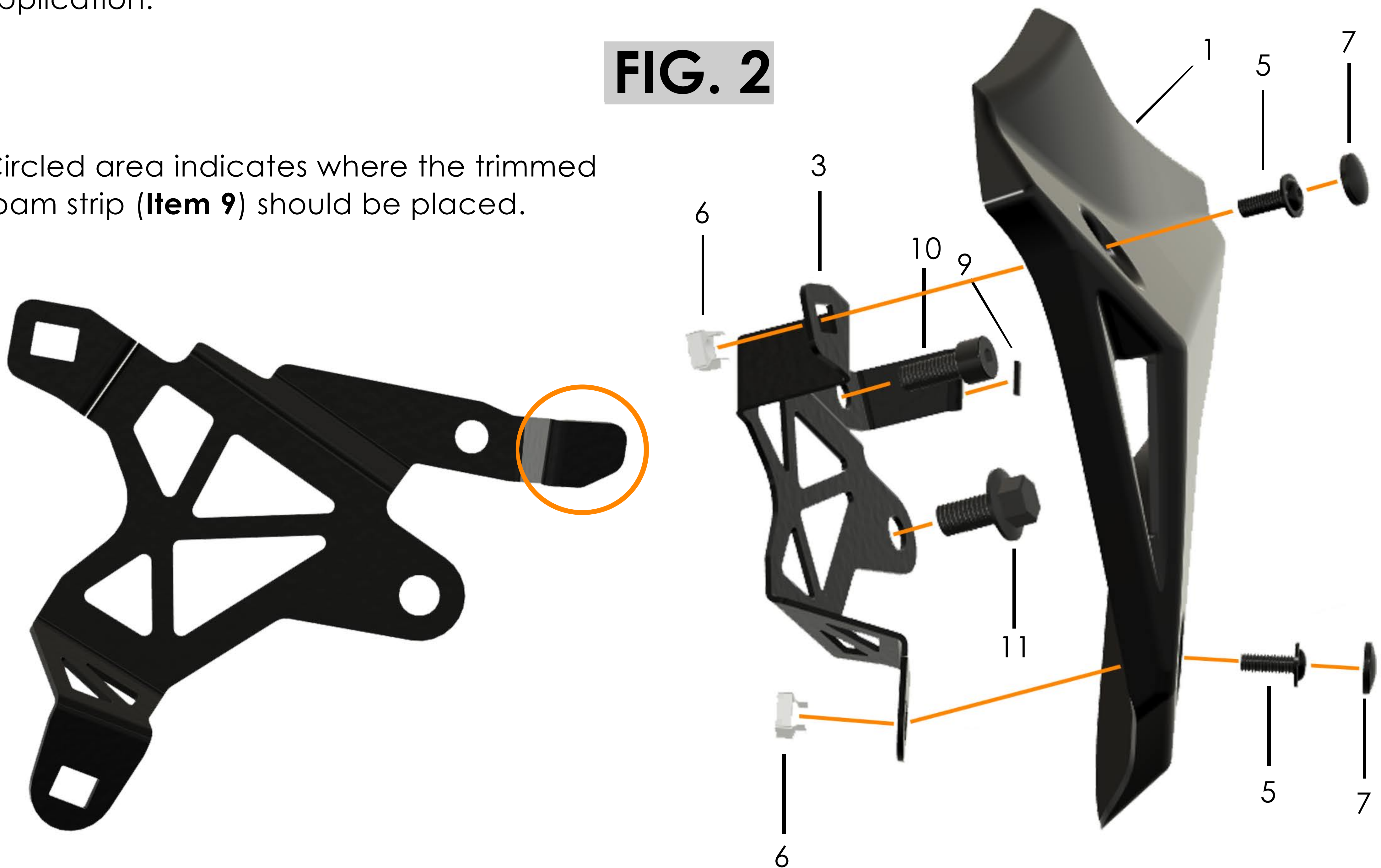
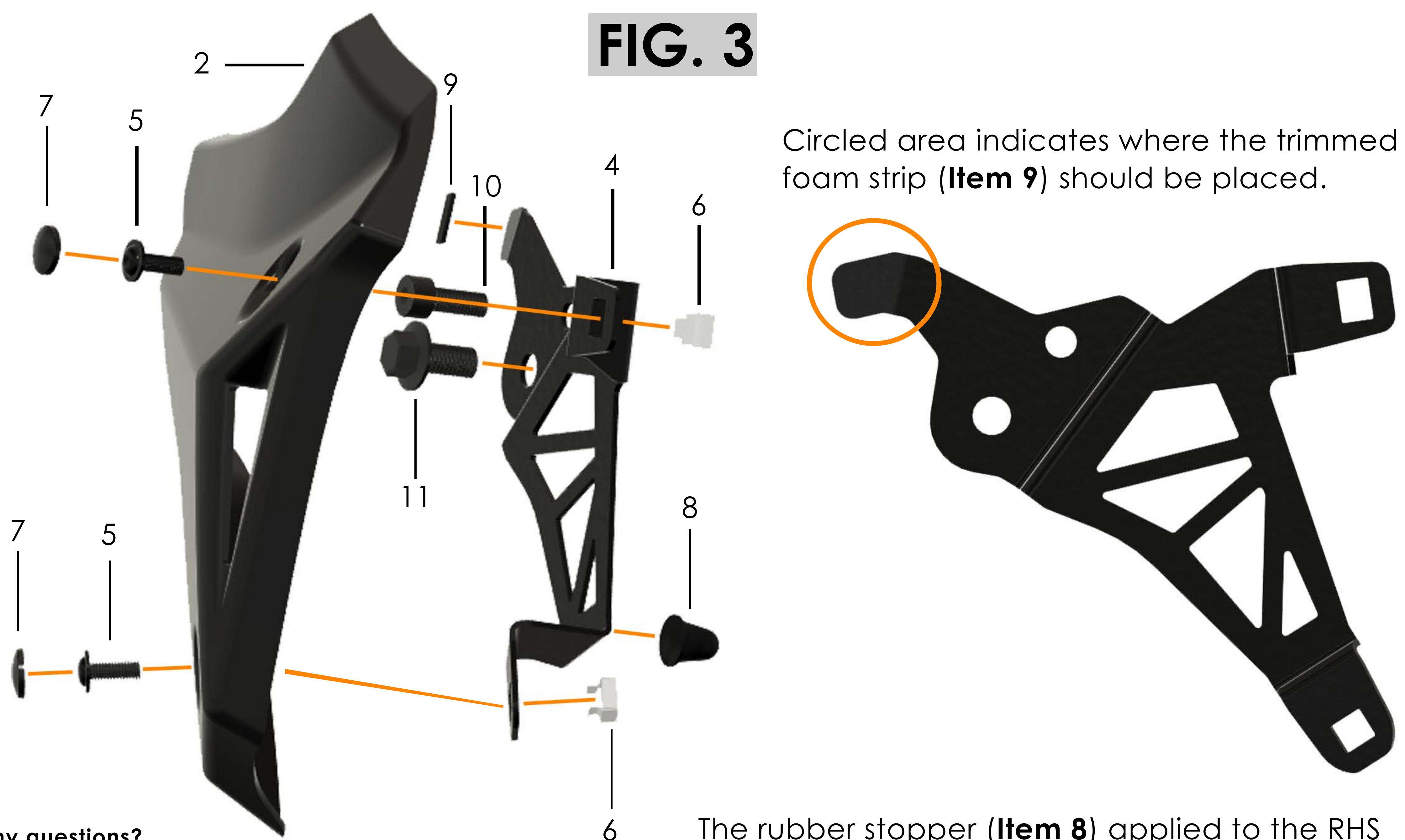

FIG. 3

Circled area indicates where the trimmed foam strip (**Item 9**) should be placed.



Any questions?
sales@pyramidmoto.co.uk
+44 (0)1427 677990
www.pyramidmoto.co.uk



Follow us on social media and
feel free to leave us a review!

The rubber stopper (**Item 8**) applied to the RHS bracket (**Item 4**) is placed at the base of the bracket so that it rests against the engine.